

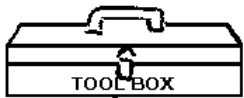

By National Cycle

**PARTS LIST**

Index	Part No.	Description	Qty.
1	90-970106-000	Highway Bar, Left	1
2	90-970107-000	Highway Bar, Right	1
<b>BAG 413</b>			
3	51-515720-000	Screw, M8 x 20	4
4	51-515990-000	Screw, M10-1.25 x 90	1
5	37-371590-000	Frame Bracket	2
6	51-513050-000	"U" Bolt	2
7	42-431010-000	Whizlock Nut, Chrome	4
8	49-490311-200	Washer, Flat	4
9	49-495632-000	Spacer	1
10	51-515345-000	M6 x 45 Screw	1



- Ball End Hex Key, 6mm
- Hex Key, 8mm and 5mm
- 10mm and 14mm Socket
- Wrench 14mm
- Wrench, 1/2"
- Handle with 3/8" Drive
- Torque Wrench
- Service Manual

**INSTALLATION TO VTX 1800 R/S**

1. Ensure that the motorcycle is on flat level ground.
2. It is recommended that the motorcycle sit for at least one hour prior to installation to allow the engine to cool.
3. Remove the three radiator mounting bolts and allow the radiator to hang from the hoses (10mm Socket).

**Install Frame Bracket**

4. From the front, place the "U" Bolt on the frame down tube near the top of the engine. **Loosely** install Frame Bracket with Flat Washers and Whizlock Nuts (1/2" Wrench.) **Figure 1.** Orient assembly so Whizlock Nuts face radiator and "U" bolt faces engine. Do not tighten. **Figure 2.**

**INSTALLATION AND OWNER'S MANUAL**

P4010

for HONDA® VTX1800 R/S

**NOTE:** Right and Left side of Motorcycle is determined while sitting on the bike.

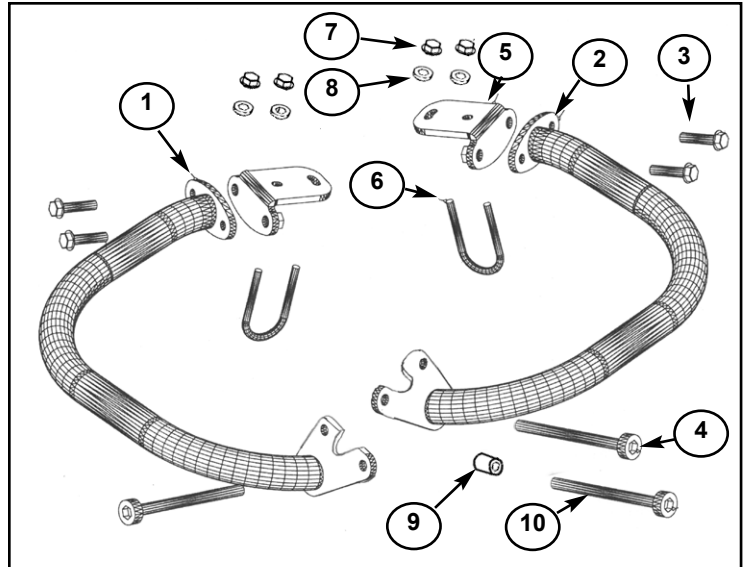

Parts List

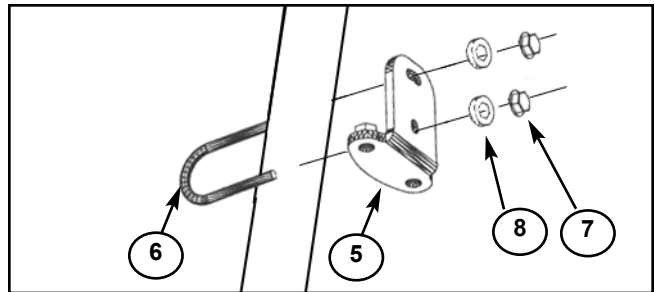

Figure 1

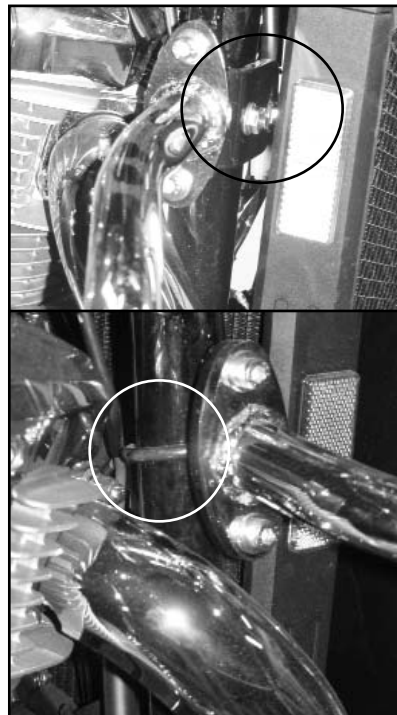

Figure 2

Rotate Clamp Assembly so Whizlock Nuts Face Radiator and "U" Bolt Faces Engine.

5. Remove the two lower frame mounting bolts on the right side of the frame down tube (14mm Socket.) The upper, short bolt will be reused, the lower bolt will not, but the nut will. Refer to figure 4 for position.

6. Install the Highway Bar to the lower frame mounting point using the stock bolt in the upper location (14mm Socket and Wrench) and a M10-1.25 x 90 Bolt in the lower location (8mm Hex Key.) Do not fully tighten at this time. **Figure 3.**

7. Align the holes at the upper mount point of the Highway Bar with the holes in the Frame Bracket. Install with supplied M8 x 20 Bolts (6mm Hex Key.) Adjust "U" Bolt Assembly as needed. Do not fully tighten M8 x 20 Bolts. **Figure 3.**

8. Repeat procedure 1-4 on Left side of motorcycle. **For step 5 and 6 "Lower Mount Point" re-use stock bolts and nuts at both upper and lower locations on left side of motorcycle.** (14mm Socket and Wrench) Proceed with installation.

### Tighten Fasteners

#### Lower Mount Point

9. Tighten all 4 Bolts (left and right side) at the lower mount point to specified torque in your service manual (14mm Socket.)

#### Upper Mount Point

10. Tighten all M8 x 20 Bolts (left and right side) at the upper mount point to 14 ft.lbs (6mm Ball End Hex Key.)

11. Tighten the 4 Whizlock Nuts firmly (1/2" wrench, open ended.)

12. Install the center radiator mount point using the supplied spacer and M6 x 45 Screw. **Figure 4.** Reinstall the two lower radiator mount screws using stock screws. Tighten to specified torque (10mm Socket).

### MAINTENANCE / CAUTION

The high quality chrome finish of your National Cycle Chrome Highway Bar can be maintained with any quality chrome cleaner and / or polish applied with a soft cloth.

Check hardware for tightness regularly. Never ride with loose mounting hardware. Check to be sure your Highway Bar does not contact any part of the motorcycle at a full turn left and right. Correct any problem before using the motorcycle.

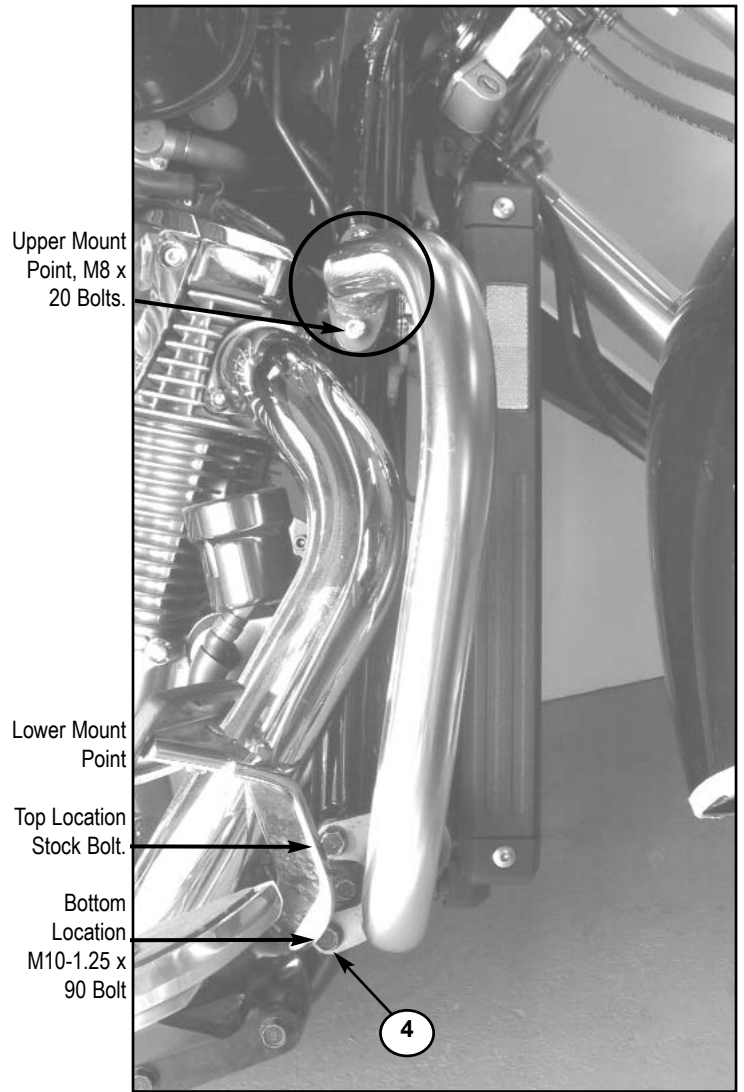

Figure 3

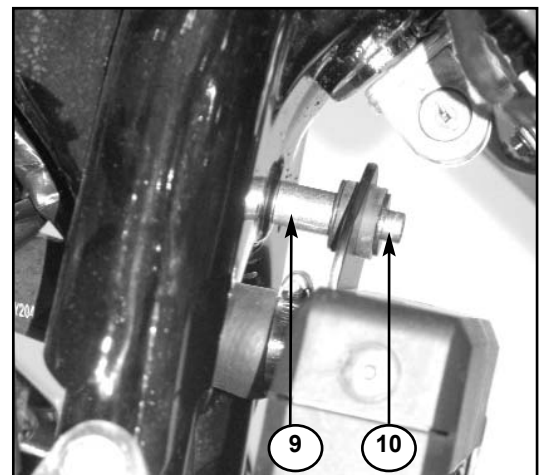

Figure 4