



By National Cycle

**INSTALLATION AND OWNER'S MANUAL**  
**P9BR008 and Supplemental Bag No. 951 (bag 951 is used when mounting P9BR008 with Cruiselineer Bags).**  
**HONDA® VT750 DC Spirit (Black Window)**

**NOTE:** Right and Left side of Motorcycle is determined while sitting on the bike.

**PARTS LIST for Kit P9BR008**

Index	Part No.	Description	Qty.
1	37-371154-000	Side Plate Assembly, Left	1
2	37-371155-000	Side Plate Assembly, Right	1
<b>BAG 363</b>			
3	49-495684-000	Spacer, .75 x .375 x .42 ID	2
4	49-495685-000	Spacer, .75 x .702 x .42ID	2

Index	Part No.	Description	Qty.
<b>BAG 363 continued</b>			
5	34-342716-000	Guide Washer Inside	4
6	34-342725-000	Guide Washer Outside	4
7	80-871015-000	Spring, Curved	4
8	49-490205-000	Washer, Flat	4
9	51-517175-000	Screw, Button Head M10 x 75	4
10	42-483020-000	Nut, Acorn*	4

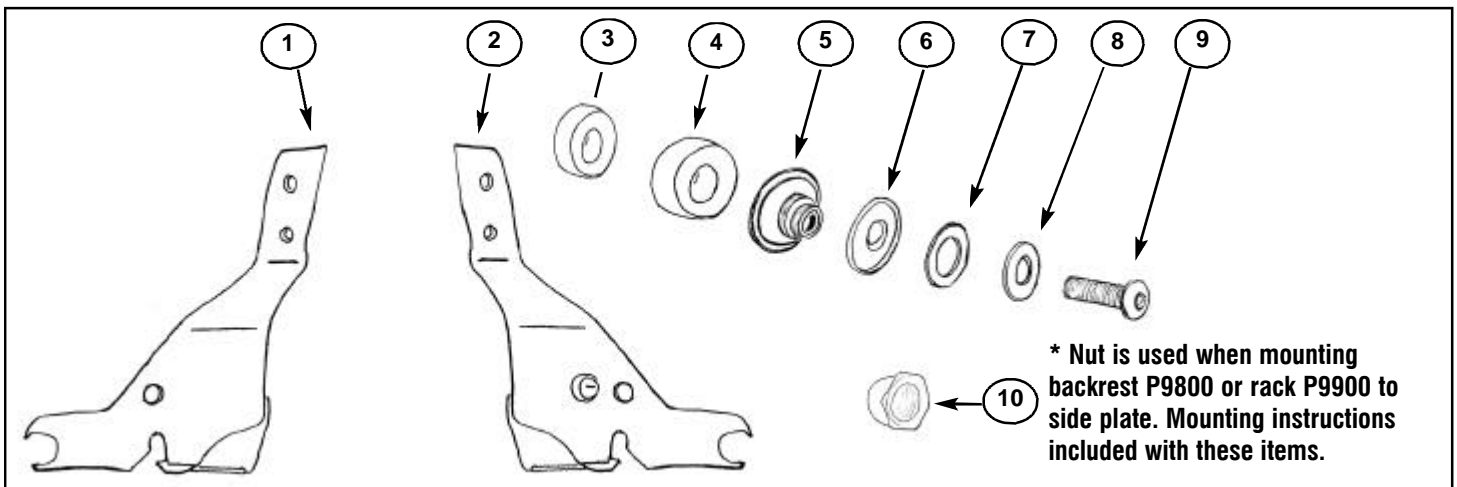

**PARTS LIST for Supplemental Bag 951 (Not included with this kit)**  
 Use bag 951 when mounting Paladin P9BR008 with Cruiselineer Saddlbags.

Index	Part No.	Description	Qty.
11	51-515990-000	Screw, Socket Head M10 x 90	4

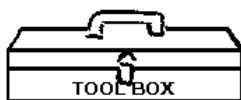
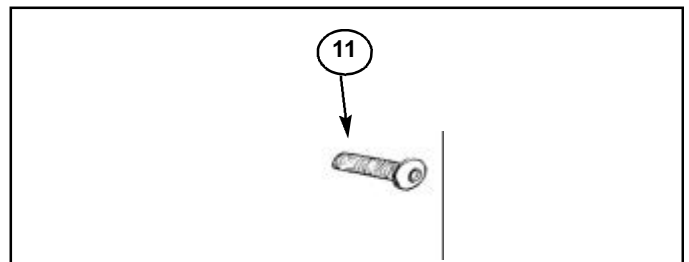

Wrench, 14mm  
 Hex Key Wrench, 6mm

Additional tools required when mounting Paladin Backrest with National Cycle Cruiselineer Saddlbags:  
 Hex Key Wrench, 8mm

**PREPARATION**



\*Apply a coat of high quality polish or wax to the chrome side plates before assembly.



\*This will keep latches gliding smoothly onto guide washers.

\*Position the motorcycle securely so it cannot fall.

\*Loosen all four bolts on the fender struts, (wrench, 14mm).

## INSTALLING THE GUIDE WASHERS, WITHOUT CRUISELINER SADDLEBAGS

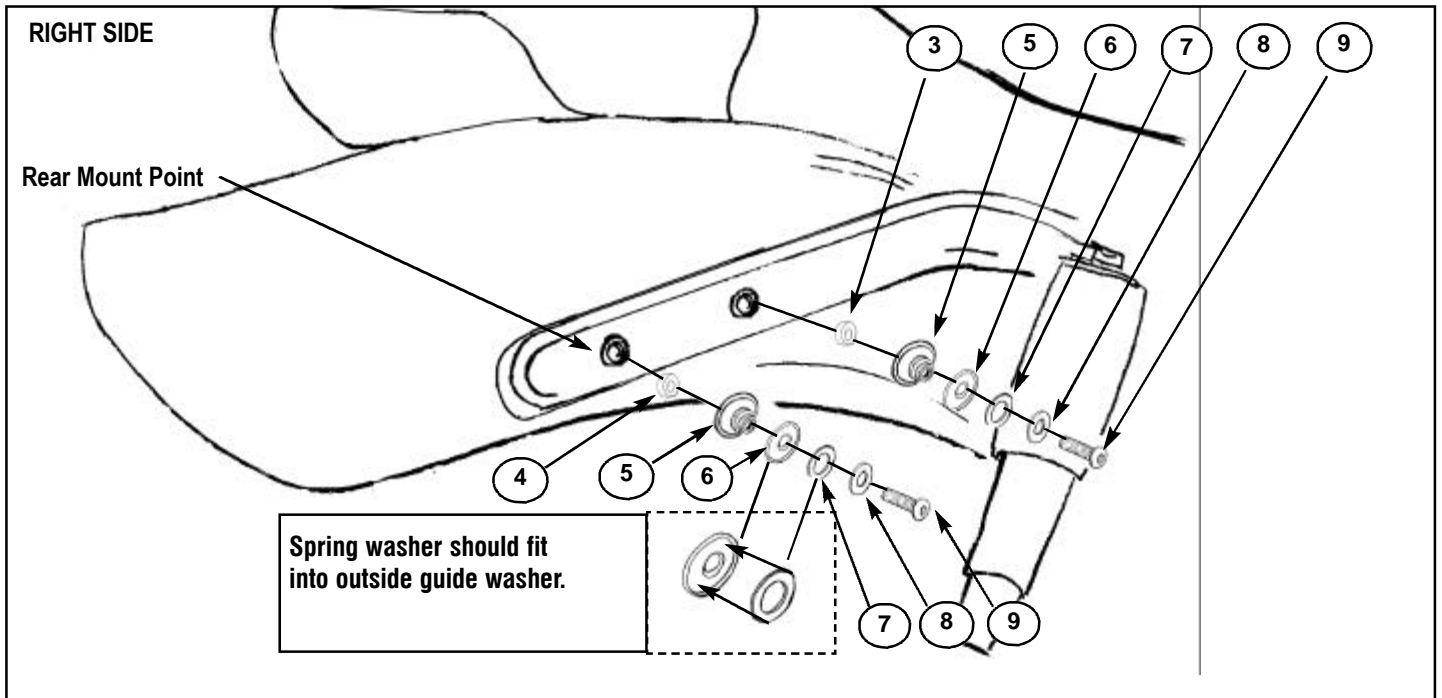

1. Remove the *rear* bolts from the fender struts.
2. Assemble and install the guide washer assembly using the M10 x 75 button head screws and the .702" long spacer. **Do not tighten.**
3. Remove the *front* bolts from the fender struts.
4. Assemble and install the guide washer assembly using the M10 x 75 button head screws and the 3/8" long spacer. **Do not tighten.**
5. **After all screws are started** tighten the front fender strut bolts to 20 ft lbs torque

## INSTALLING THE GUIDE WASHERS, WITH CRUISELINER SADDLEBAGS (Written instruction continued on page 3.)

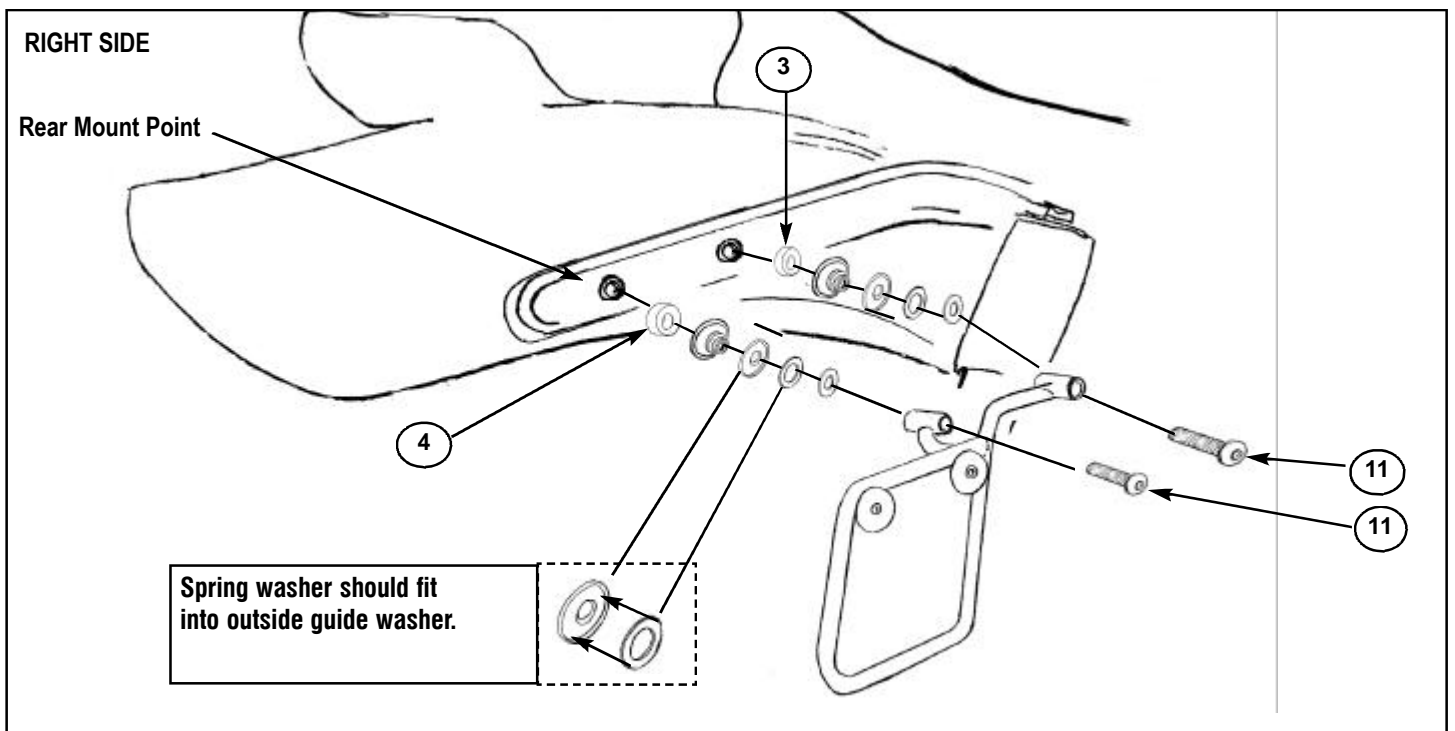

**Note: refer to the saddlebag installation instructions for the turn signal relocation.**

1. Remove both bolts from one fender strut.
2. Insert an M10 x 90 screw (from Bag 951) through the *front* saddlebag frame mount. Assemble and install the guide washer assembly and the 3/8" long spacers. Start the front screw, **do not tighten**.
3. Insert an M10 x 90 screw (from Bag 951) through the *rear* saddlebag frame mount. Add the guide washer assembly and the .702" long spacer to the screw. Position the saddlebag frame and start the screw into the rear bolt hole in the fender strut. **Do not tighten**.
4. Repeat steps 1 through 3 on the other side of the motorcycle.
5. Tighten the screws to 20 ft lbs.

## MAINTENANCE

The high quality chrome finish of your National Cycle Paladin rack assembly can be maintained with any quality chrome cleaner and /or polish.

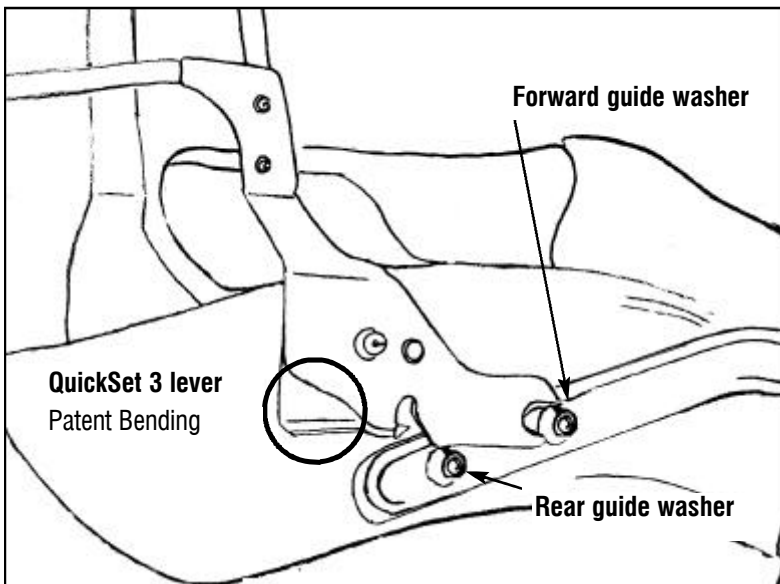

### Using the QuickSet 3® feature to remove your Paladin System.

Check that QuickSet 3 is unlocked. Stand at the rear of the motorcycle and grab ahold of the system at the side plates. Lift up on the QuickSet 3 lever while rotating the system up and pull back and out of the forward guide washer.

For re-installation, first make sure the QuickSet 3 feature is unlocked. Holding the system as you do in removal, guide the side plate into the forward guide washer. Make sure you fully seat the notch of the side plate into the washer. Lift the Quickset 3 lever and guide the rear notch in the side plate back onto the rear guide washer.

**When mounting the luggage rack or backrest assembly, listen for the audible "click" indicating that the latches are in place and side plate is completely seated onto guide washers.**

## ⚠ WARNING

Maximum load for the Luggage Rack is 5 Kg (11 lbs).

When mounting the Backrest assembly, listen for the audible "click" indicating that the latches are in place. Always lock the QuickSet 3® Side Mount Plate before using your motorcycle. This insures the utmost in safety.

Never ride your motorcycle with loose accessory mounting hardware. Check the hardware for tightness regularly.

Today's motorcycles are built with enough frame rigidity to withstand the moderate loads imposed on them by the foreseeable addition of an accessory. If the accessory(ies) adversely affects your motorcycle's stability, immediately remove the accessory(ies). Do not ride a motorcycle that exhibits unsafe handling traits.

Have experienced service personnel correct any problem before riding with the accessory(ies) installed. For further questions concerning handling problems associated with an accessory(ies), contact your dealer, motorcycle manufacturer, or accessory manufacturer.

All concepts embodied in this item are covered in patents applied for.

©2001 National Cycle, Inc. PO Box 158, Maywood, IL 60153-0158 USA  
708-343-0400 / Fax: 708-343-0625 / [www.nationalcycle.com](http://www.nationalcycle.com) / e mail: [info@nationalcycle.com](mailto:info@nationalcycle.com)