 *R12R models with lower spoiler- Spoiler must be removed to install the Z7103 Engine Guards. Please refer to page 6.

Thank you for purchasing a ZTechnik product . Please read these instructions carefully and thoroughly before beginning work. Before installing accessory, carefully consider whether one possesses the necessary technical skills and workshop tools to complete the installation properly. Otherwise, any Motorcycle Retailer will be glad to install this accessory.

Dealers, if installing the Engine Guard for a customer, please give him or her this manual. It contains the instructional and reference material needed to properly maintain and use this product.

At time of purchase report any missing parts directly to ZTechnik. The following information is necessary: BAG NUMBER on outside of plastic fastener bag and DATE STAMP located on the end panel of the outer box. **Thank you.**

The following symbols are used in these instructions:



ATTENTION: Special notes and cautionary measures.



NOTE: Tips for facilitation of operation, control and adjustment, as well as maintenance work.

PARTS LIST

Item	Description	Part No.	Qty.	Tools and Notes
1	Guard, Left	90-970526-000	1	
2	Guard, Right	90-970527-000	1	
3	End Cap	34-345536-000	2	Factory installed. Repl. Set (one side) order Bag#1194
4	Screw, M6 x 15	51-516317-000	2	Factory installed. Repl. Set (one side) order Bag#1194
5	Nut	42-420300-000	2	Factory installed. Repl. Set (one side) order Bag#1194
6	Bushing	44-441921-000	2	Factory installed. Repl. Set (one side) order Bag#1194
Bag #969				
7	Bushing, Left Top	34-345568-000	1	
8	Bushing, Right Top	34-345569-000	1	
9	Nut, Flange	42-433036-000	2	13mm Box Wrench
10	Washer, Flat	49-490317-000	2	
11	Washer, Split	49-491301-000	2	
12	Screw, M8 x 30	51-515734-000	2	6mm Hex Wrench
13	Screw, M8 x 35	51-511738-000	1	6mm Hex Wrench
14	Screw, M8-1.25 x 60	51-515763-000	1	6mm Hex Wrench

PARTS LIST IDENTIFICATION CONTINUES ON PAGE 2



TOOLS

T20 Torx (For removal of RT Panel)
 T50 Torx
 13mm Box Wrench
 6mm Hex Wrench
 Speed Ratchet (Optional)

T30 Torx (For removal of R12R Lower Spoiler if applicable)

PARTS LIST IDENTIFICATION

LEFT SIDE

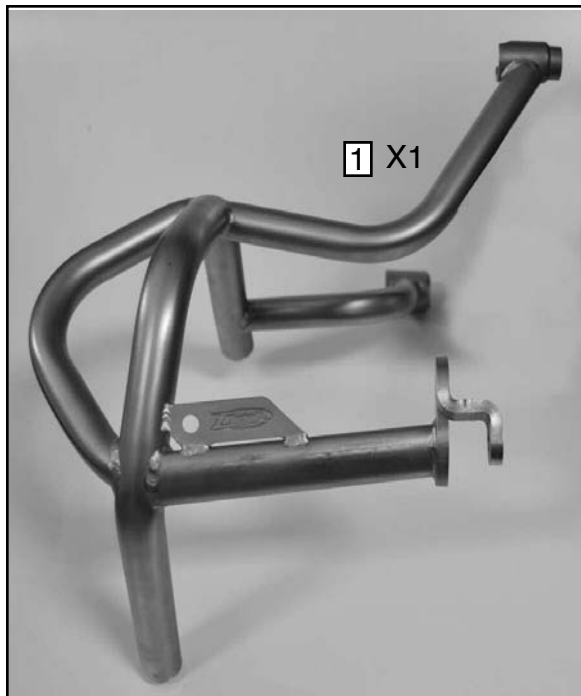

RIGHT SIDE

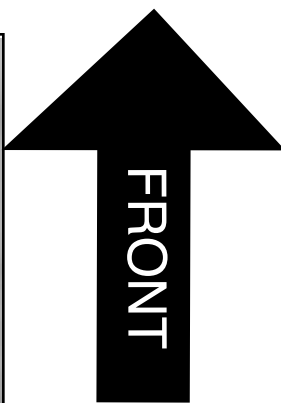
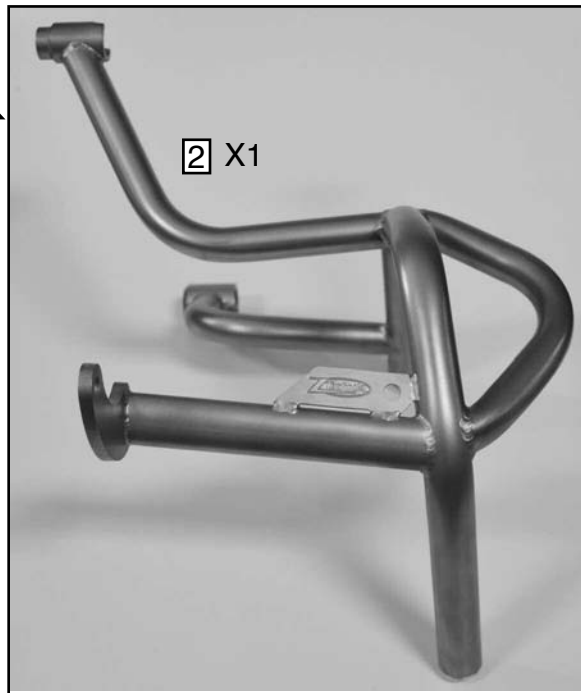

HARDWARE FOR LEFT SIDE

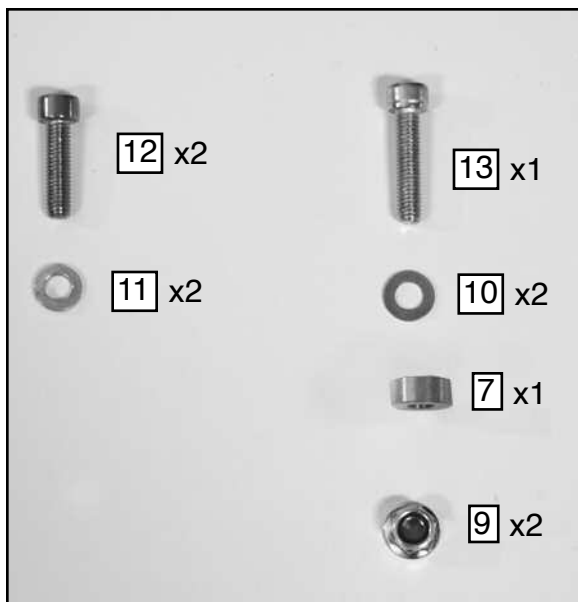

HARDWARE FOR RIGHT SIDE

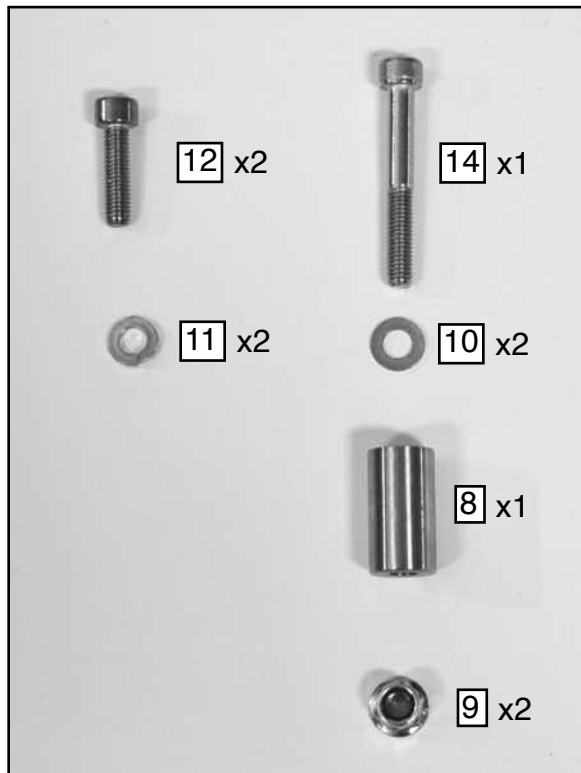

PREPARATION

1. Position the motorcycle securely on its center (main) stand.



Right and Left side of motorcycle is determined while sitting on the bike.

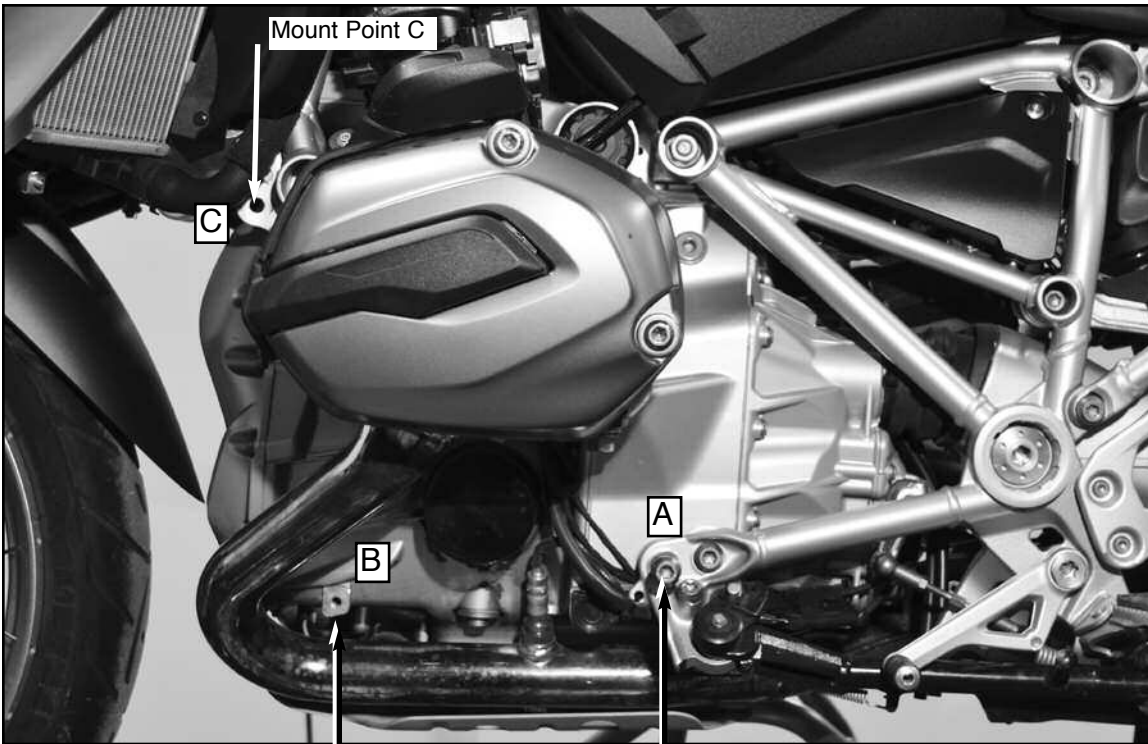

Figure 1

Mount Point B

Mount Point A

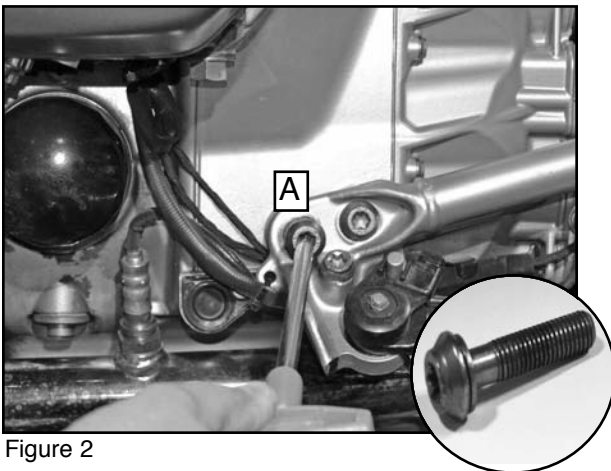

Figure 2

INSTALLATION LEFT SIDE GUARD- GS and RT

 Installation is shown on the R1200GS. The R12RT installation is the same except when installing Guard to the RT, remove the left and right side panel from the motorcycle as shown below. (T20 Torx Wrench)



Figure 3

1. From the Left side of the motorcycle remove the stock screw with captured washer at Mount Point A. These parts will be re-used. **Figure 1 and 2 (T50 Torx Wrench)**

Figure 1 and 2 (T50 Torx Wrench)

2. Carefully maneuver the Guard into place. Mount Point B will slip between engine and muffler.

Figure 3

INSTALLATION Continued

4. Loosely install engine guard at Mount Point A using the stock screw with captured washer.
Figure 1 and 4 (T50 Torx Wrench)

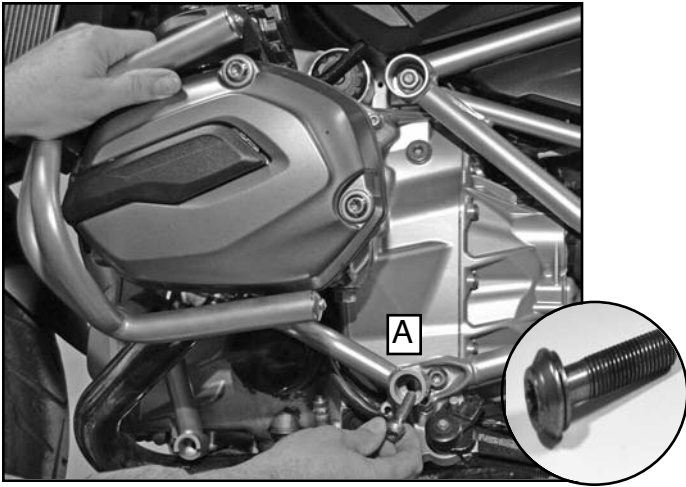

Figure 4

5. Loosely install engine guard at Mount Point B using one each:
M8x30 Screw (12), Split Washer (11)
Figure 1 and 5 (6mm Hex Wrench)

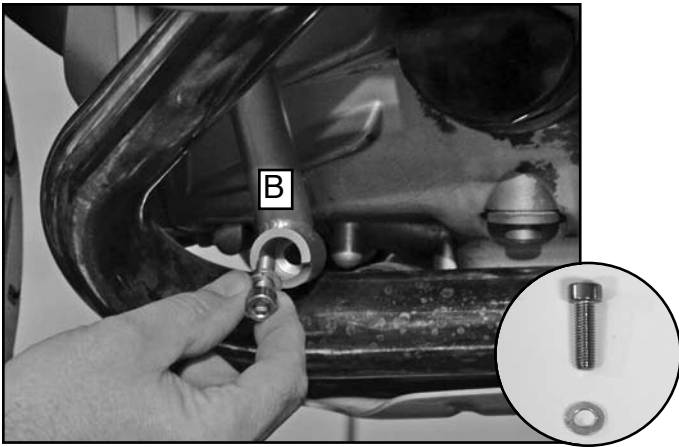

Figure 5

6. Loosely install engine guard at Mount Point C using one each:
M8x35 Screw (13) with Flat Washer (10) on outside.
Bushing (7) between Guard and motorcycle frame bracket.
Nut (9) on inside.

Figure 1 and 6 (6mm Hex Wrench)

7. Check adjustment. Center the Guard around the cylinder head. **Tighten all hardware securely starting with the lower fasteners, then the top fastener.**

 **For RT- Re-install the side panel. (T20 Torx Wrench)**

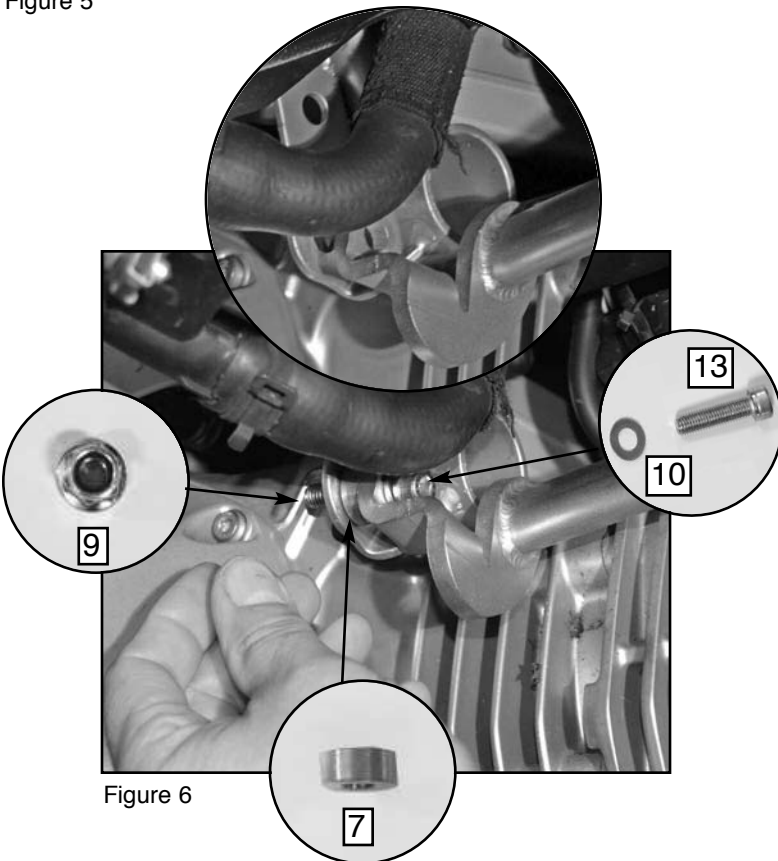

Figure 6

INSTALLATION RIGHT SIDE GUARD- GS and RT

 When installing Guard to the RT, remove the right side panel from the motorcycle as shown in Figure 7.

Figure 7 (T20 Torx Wrench)

8. Install Mount Point A and B as you did for the Left Side.

9. Loosely install Guard at Mount Point C using one each:

M8x60 Screw (14) with Flat Washer (10) on outside.

Bushing (8) between Guard and motorcycle frame bracket.

Nut (9) on inside.

Figure 8 (6mm Hex Wrench)



Figure 7

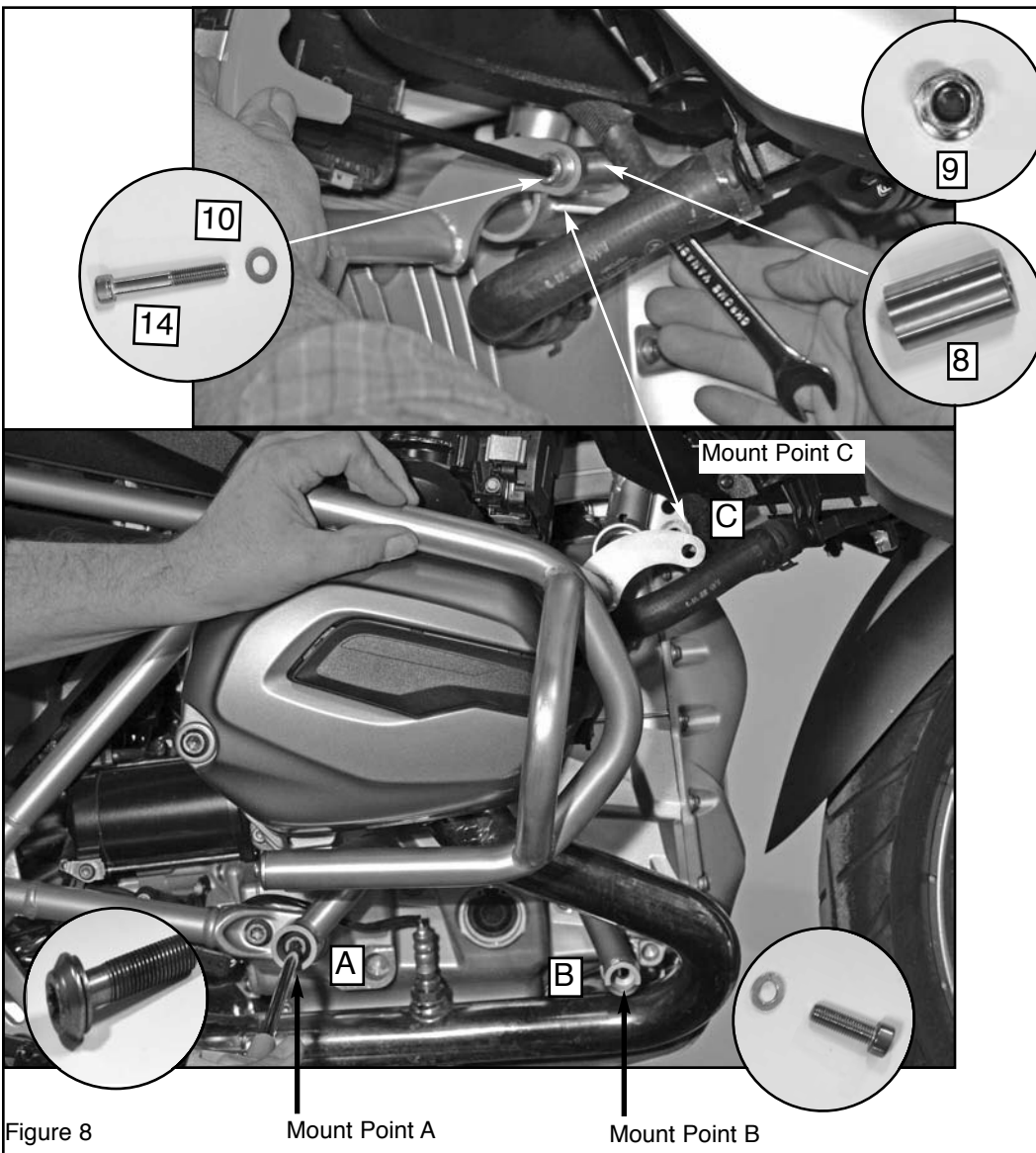

Figure 8

Mount Point A

Mount Point B

INSTALLATION RIGHT SIDE GUARD- GS and RT, Continued

10. Check adjustment. Center the Guard around the cylinder head. **Tighten all hardware securely starting with the lower fasteners, then the top fastener.**

 Re-install the side panel to the RT (T20 Torx Wrench)

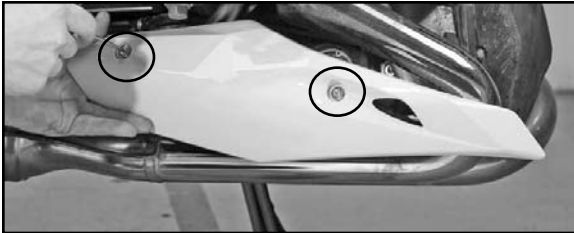



Figure 1



Figure 2

R12R MODELS WITH LOWER SPOILER

 Spoiler on left and right must be removed before you can install a Z7103 Engine Guard.

1. Remove spoiler plastic from bracket.
Figure 1 (T22)

2. Remove bracket from bike.
Figure 2 (T50 and T30)

MAINTENANCE OF THE ENGINE GUARD

The special finish of your new Z7103 ZTechnik Stainless Steel Engine Guards is durable and more environmentally friendly than chrome or powder coated finishes on steel. Clean your Engine Guards with a soft brush using mild soap and water.



WARNING If the addition of an accessory(ies) adversely affects your motorcycle's stability immediately remove the accessory(ies). Do Not ride a motorcycle that exhibits unsafe handling traits. Have experienced service personnel correct any problem before riding with the accessory(ies) installed. For further questions concerning handling problems associated with an accessory(ies), contact your dealer, motorcycle manufacturer, or accessory manufacturer.