

ALERONES LATERALES "DOWNFORCE" PARA - SIDE SPOILER "DOWNFORCE" -
SEITENFLÜGEL "DOWNFORCE"

KAWASAKI ZX-10R '16-

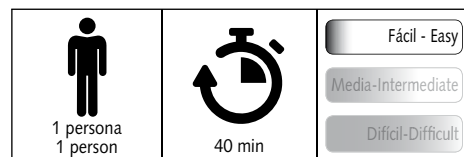

Ref.: 9882

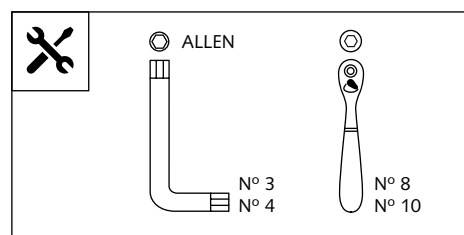

ID	PIEZA / PART	DESCRIPCIÓN	DESCRIPTION	QTY	REF.
1		Base alerón derecha	Right main plain spoiler	1	9882NM3
2		Winglet Negro derecho Winglet Verde derecho	Right Black winglet Right green winglet	2	9882V/NM3
3		Base alerón izquierda	Left main plain spoiler	1	9882NM3
4		Winglet Negro izquierdo Winglet Verde izquierdo	Left Black winglet Left green winglet	2	9882V/NM3
5		Soporte metálico R•	R• metal support	1	SOPOR-4P-6-9882
6		Soporte metálico R••	R•• metal support	1	SOPOR-4P-6-9882
7		Soporte metálico L•	L• metal support	1	SOPOR-4P-6-9882
8		Soporte metálico L••	L•• metal support	1	SOPOR-4P-6-9882
9		Tuerca autoblocante M4	M4 locking nut	4	TUERCAE985-0290
10		Arandela de goma Øint 4,5 Øext 11x2mm	Øinner 4,5 Øouter 11x2mm rubber washer	4	ARAND-EPDM--722
11		Arandela de Nylon M4X0,5	M4X0,5 Nylon washer	8	ARNV0000000311
12		Arandela de Nylon M5X1	M5X1 Nylon washer	4	ARNV0000000245
13		Tuerca grafilada M5	M5 Special nut	2	TUERC-D6923-255
14		Tornillo Allen M5x16 Ø11 ISO 7380	M5x16 Ø11 ISO 7380 Allen screw	2	TORNI-I7380-493
15		Tornillo Allen M5x11 Ø11 ISO 7380	M5x11 Ø11 ISO 7380 Allen screw	4	TORNI-AI----520
16		Tornillo Allen M4x11 Ø9 ISO 7380	M4x11 Ø9 ISO 7380 Allen screw	4	TORNI-I7380-800
17		Tapón tornillo M5 ISO 7380	M5 ISO 7380 Allen screw cap	4	TAPON-----85
18		Espuma adhesiva protectora	Protective adhesive foam	1	ESPUMA-----9882

ALERONES LATERALES "DOWNFORCE" PARA - SIDE SPOILER "DOWNFORCE" - SEITENFLÜGEL "DOWNFORCE" KAWASAKI ZX-10R '16-

INSTRUCCIONES DE MONTAJE - MOUNTING INSTRUCTIONS - MONTAGEANLEITUNG

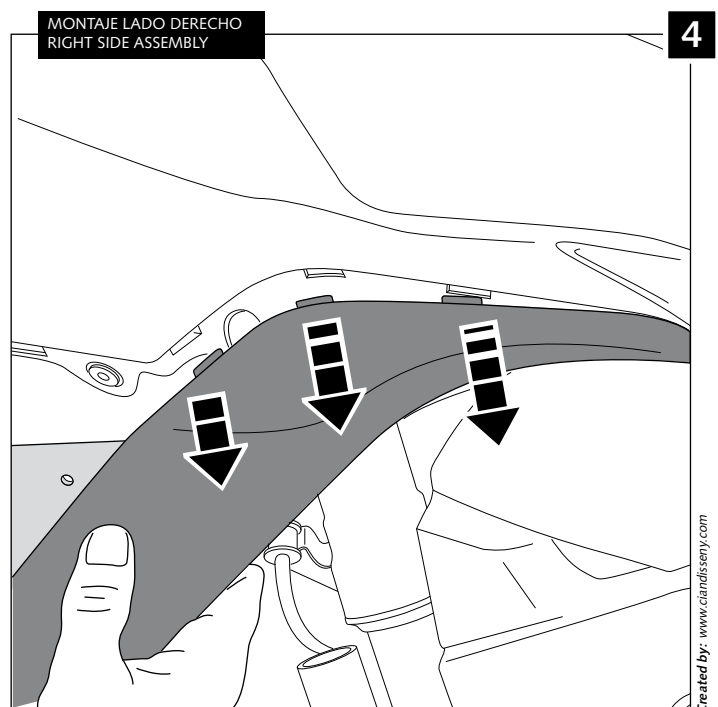
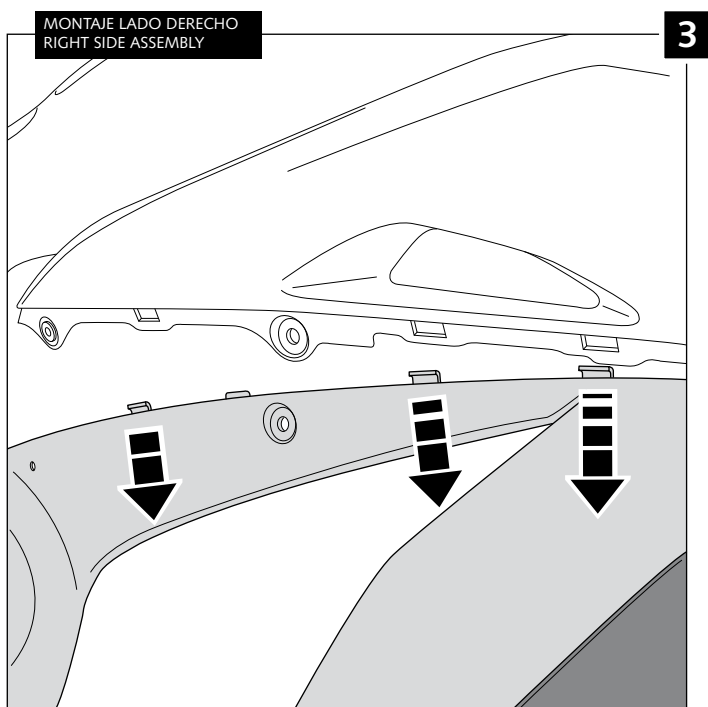
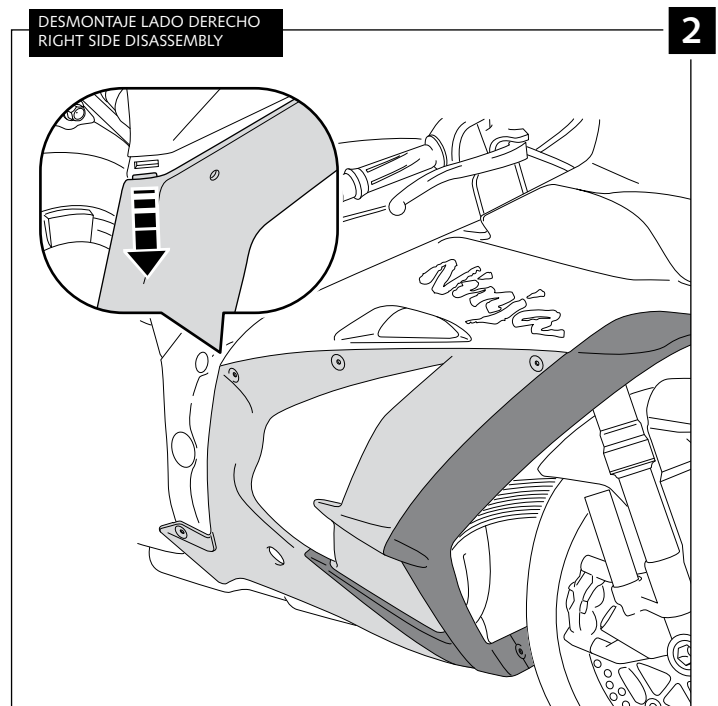
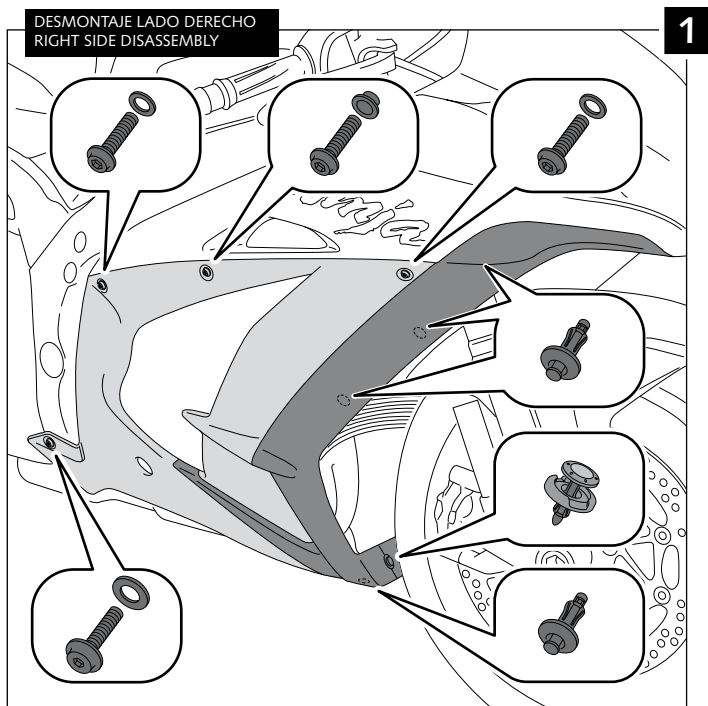

ALERONES LATERALES "DOWNFORCE" PARA - SIDE SPOILER "DOWNFORCE" -
SEITENFLÜGEL "DOWNFORCE"

KAWASAKI ZX-10R '16-

INSTRUCCIONES DE MONTAJE - MOUNTING INSTRUCTIONS - MONTAGEANLEITUNG

DESMONTAJE LADO DERECHO
RIGHT SIDE DISASSEMBLY

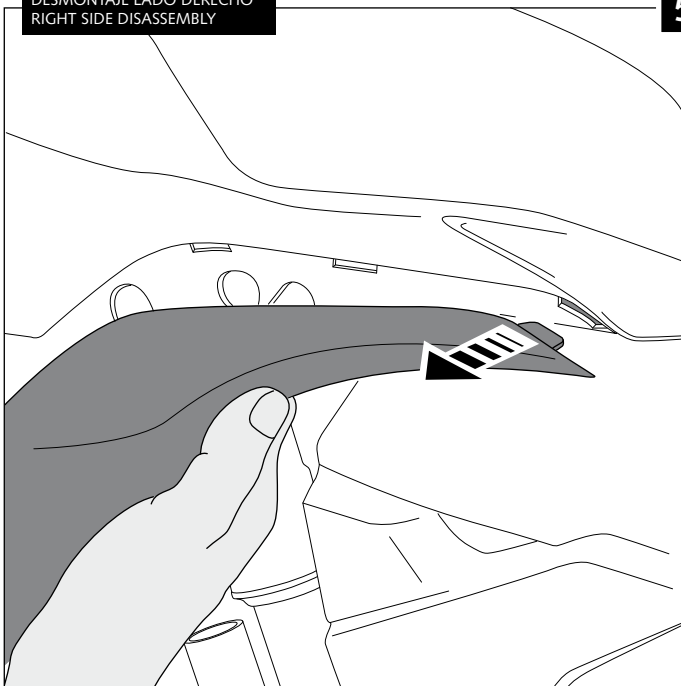

5

MONTAJE LADO DERECHO
RIGHT SIDE ASSEMBLY

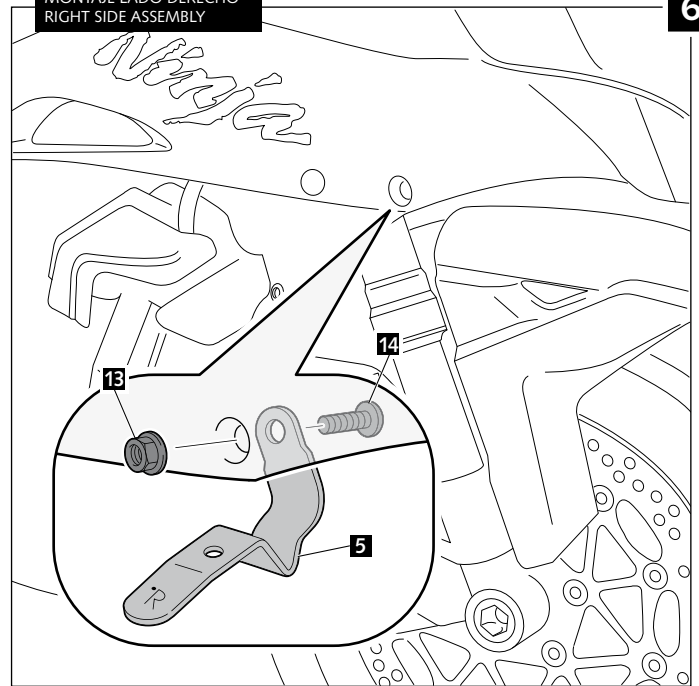

6

MONTAJE LADO DERECHO
RIGHT SIDE ASSEMBLY

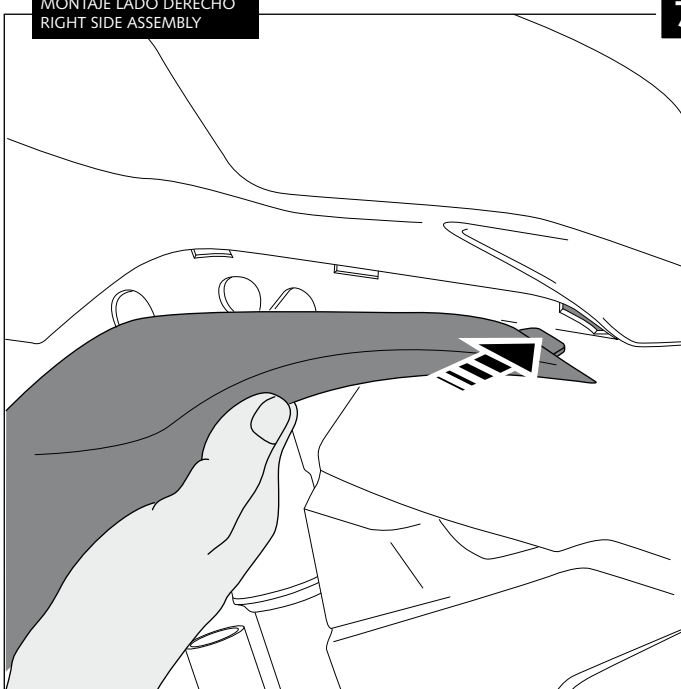

7

MONTAJE LADO DERECHO
RIGHT SIDE ASSEMBLY

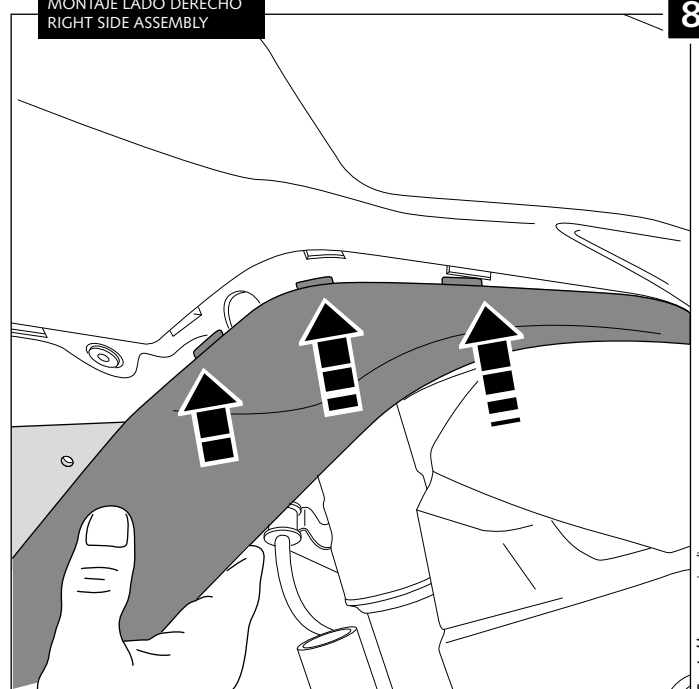

8

ALERONES LATERALES "DOWNFORCE" PARA - SIDE SPOILER "DOWNFORCE" -
 SEITENFLÜGEL "DOWNFORCE"
KAWASAKI ZX-10R '16-

INSTRUCCIONES DE MONTAJE - MOUNTING INSTRUCTIONS - MONTAGEANLEITUNG

MONTAJE LADO DERECHO
 RIGHT SIDE ASSEMBLY

9

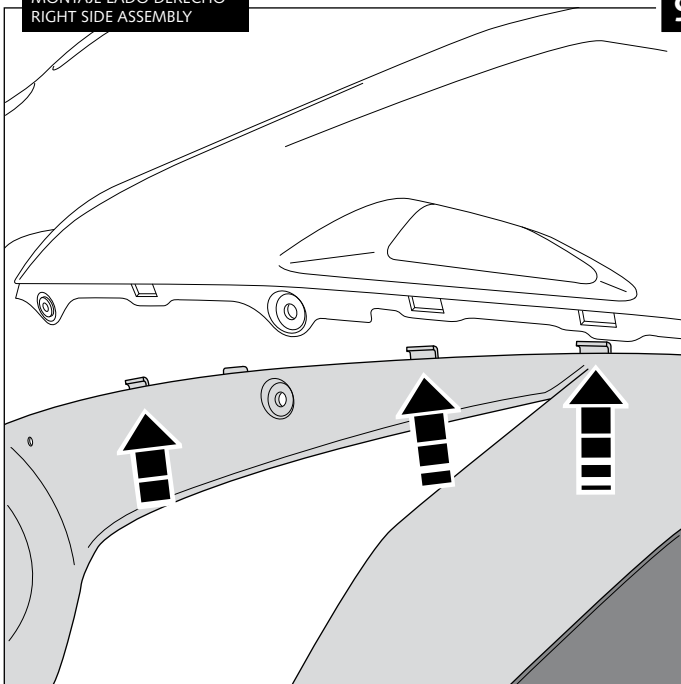

MONTAJE LADO DERECHO
 RIGHT SIDE ASSEMBLY

10

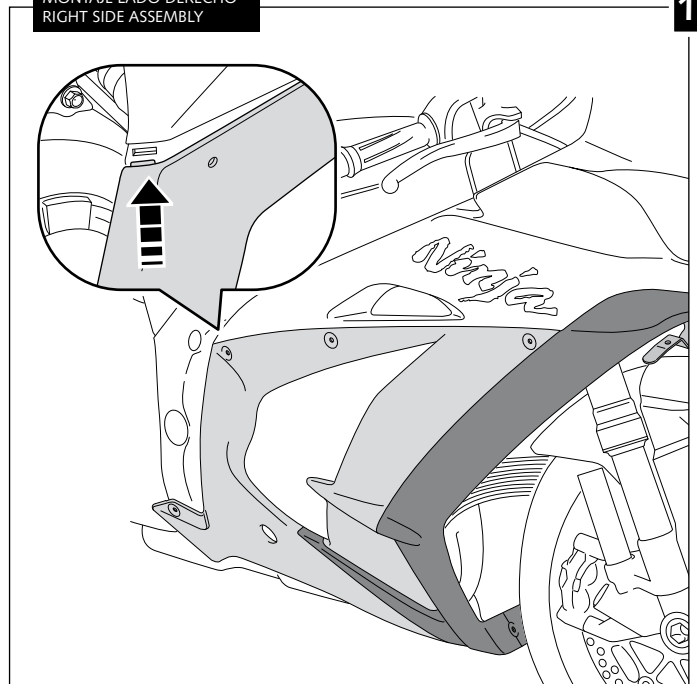

MONTAJE LADO DERECHO
 RIGHT SIDE ASSEMBLY

11

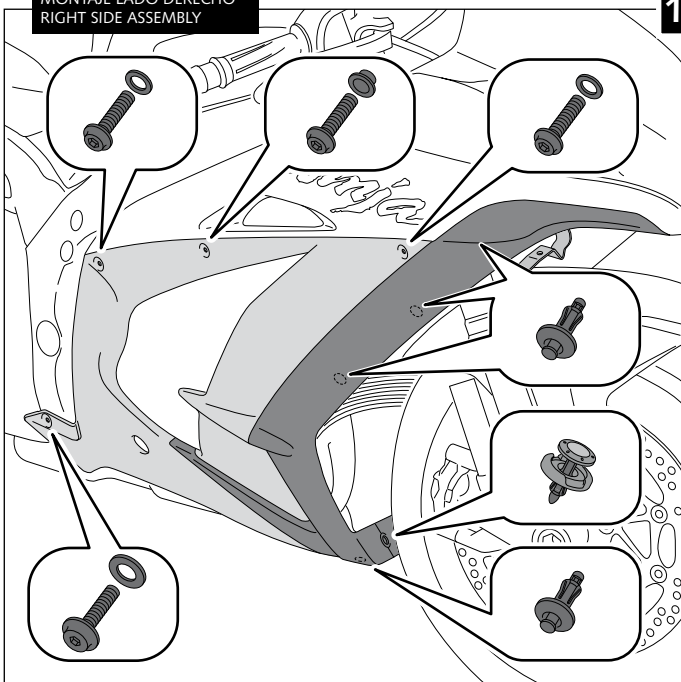

MONTAJE LADO DERECHO
 RIGHT SIDE ASSEMBLY

12

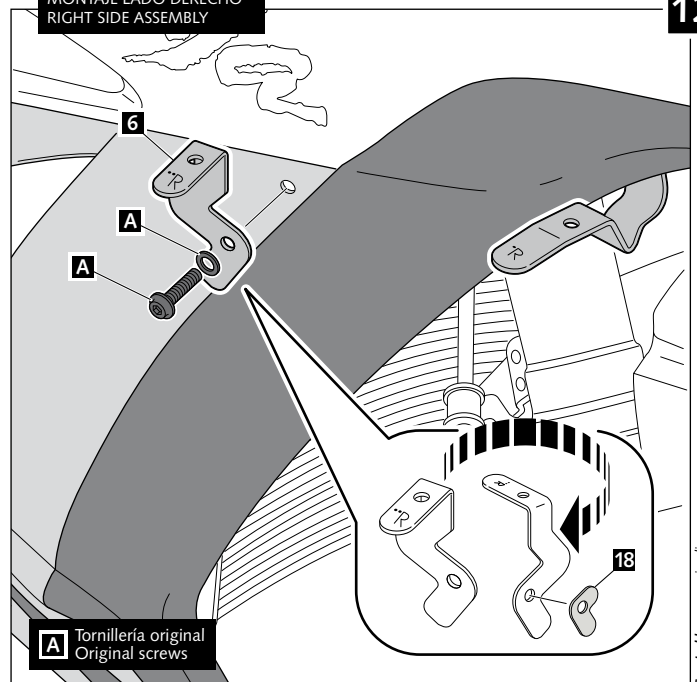

A Tornillería original
 Original screws

ALERONES LATERALES "DOWNFORCE" PARA - SIDE SPOILER "DOWNFORCE" -
 SEITENFLÜGEL "DOWNFORCE"
KAWASAKI ZX-10R '16-

INSTRUCCIONES DE MONTAJE - MOUNTING INSTRUCTIONS - MONTAGEANLEITUNG

