

DUCATI PANIGALE 1199/R - 899

M O U N T I N G I N S T R U C T I O N S

VIDEO

REF 3566

SIDE SPOILER DOWNFORCE



| ID | PIEZA/PART | DESCRIPCIÓN | DESCRIPTION | QTY | REF |
|----|------------|---|---|--------|-----------------|
| 1 | | Base alerón derecha | Right main plain spoiler | 1 | 10622 |
| 2 | | Winglet Negro derecho Winglet Rojo derecho | Right black winglet Right red winglet | 1 1 | 10624 |
| 3 | | Base alerón izquierda | Left main plain spoiler | 1 | 10622 |
| 4 | | Winglet Negro izquierdo Winglet Rojo izquierdo | Left black winglet Left red winglet | 1 1 | 10624 |
| 5 | | Soporte metálico derecho | Right metal suport | 1 | SOPOR2P6-R-3566 |
| 6 | | Soporte metálico izquierdo | Left metal suport | 1 | SOPOR2P6-L-3566 |
| 7 | | Tuerca autoblocante M4 | M4 Locking nut | 4 | TUERCAE985-0290 |
| 8 | | Arandela de goma Ø4,5 x Ø11 x 2mm | Ø4,5 x Ø11 x 2mm Rubber washer | 4 | ARAND-EPDM--722 |
| 9 | | Arandela de nylon M4x0,5 | M4x0,5 Nylon washer | 8 | ARNV00000000311 |
| 10 | | Tornillo Allen M4x12 Ø9 ISO 7380 | M4x12 Ø9 ISO 7380 Allen screw | 4 | TORNI-I7380-800 |
| 11 | | Casquillo Ø13 x Ø8,5 x 3,5 | Ø13 x Ø8,5 x 3,5 Arrowhead | 4 | CASQUI-----775 |
| 12 | | Arandela de nylon M5x1 | M5x1 Nylon washer | 4 | ARNV00000000245 |
| 13 | | Tornillo Allen M5x11 Ø11 ISO 7380 | M5x11 Ø11 ISO 7380 Allen screw | 4 | TORNI-AI----520 |
| 14 | | Tornillo Allen M5x20 Ø11 ISO 7380 | M5x20 Ø11 ISO 7380 Allen screw | 4 | TORNI-I7380-730 |
| 15 | | Tapón tornillo Allen M5 ISO 7380 | M5 ISO 7380 Allen screw cap | 4 | TAPON-----85 |
| 16 | | Espuma adhesiva protectora 15x10mm (se suministra montada con ID5/6) | 10x15mm protective adhesive foam (supplied already mounted on items ID5/6) | 8 | ESPUMA-----264 |

DUCATI PANIGALE 1199/R - 899

INSTRUCCIONES DE MONTAJE - MOUNTING INSTRUCTIONS - MONTAGEANLEITUNG

1

DISASSEMBLY
DESMONTAJE

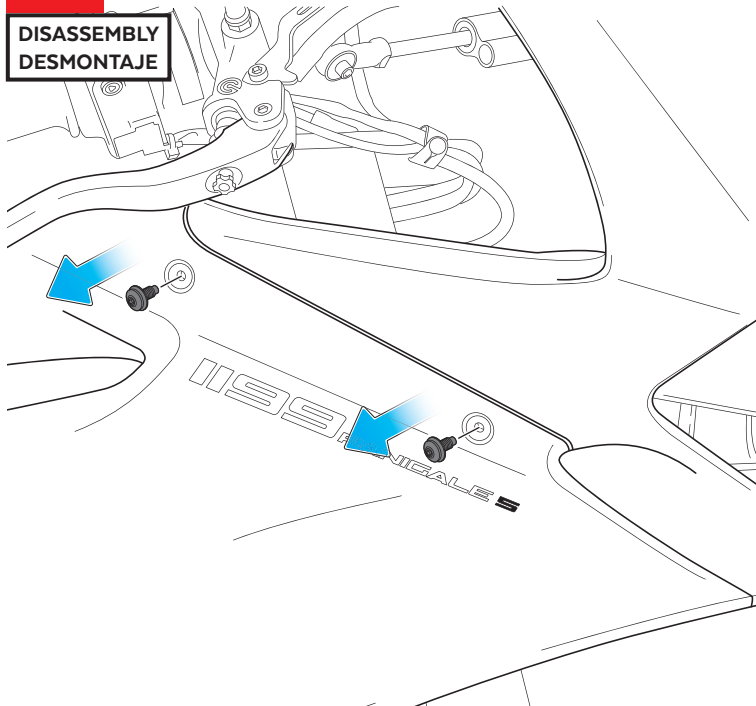

Se muestra el montaje del lado derecho a modo de ejemplo, realizar los mismos pasos para el montaje del lado izquierdo.
The right side assembly is shown as an example, so the same steps can be performed for the left side assembly.

2

ASSEMBLY
MONTAJE

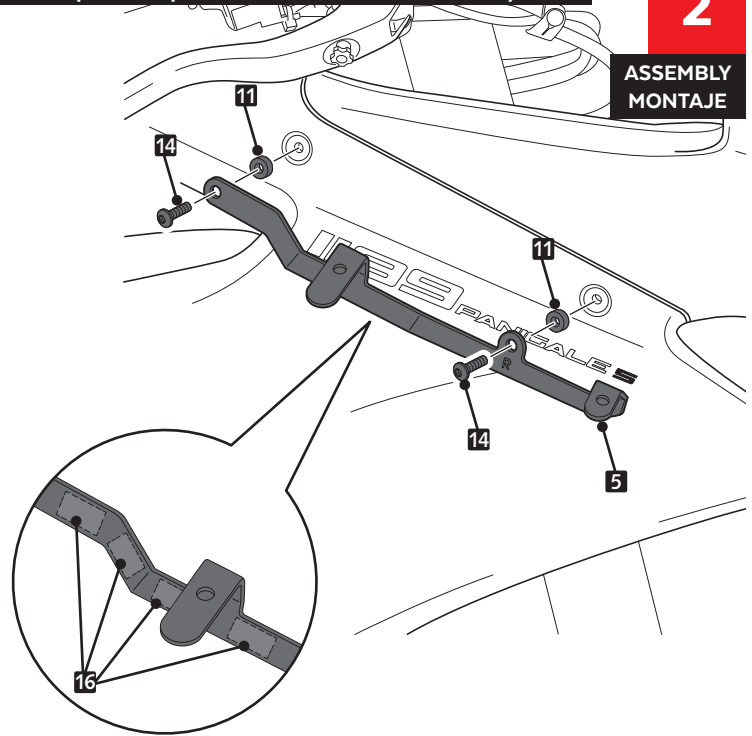

3

ASSEMBLY
MONTAJE

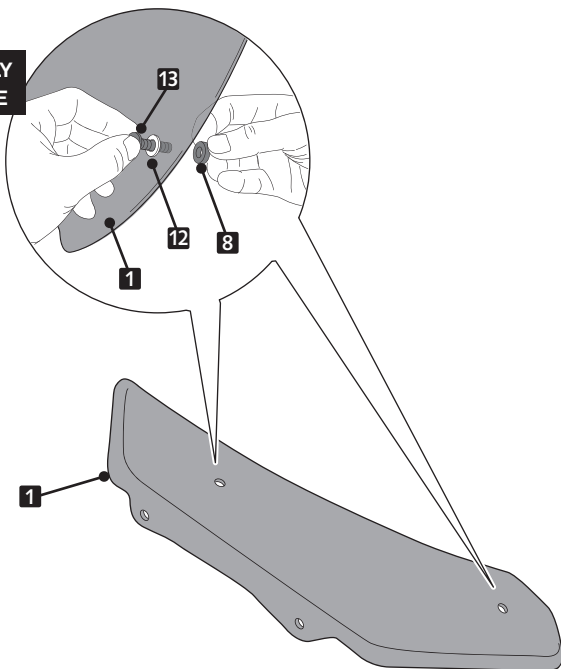

4

ASSEMBLY
MONTAJE

