



**EVOTECH**<sup>®</sup>  
P E R F O R M A N C E

Ducati Diavel 1260  
Tom Tom Sat Nav Mount

Installation Instructions



## Kit Contents PRN014567-014650

- (A) 1 x Main Plate
- (B) 1 x Pivot Plate
- (C) 1 x Sub Mounting Bracket
- (D) 1 x Tom Tom Mounting Plate
- (E) 2 x M5 Black Washer
- (F) 2 x M5 x 8mm Black Button head Bolts
- (G) 2 x Lobe Screw
- (H) 2 x Locking Washer
- (I) 2 x Rubber Washer
- (J) 2 x M6 x 16 Button Head Bolts
- (K) 4 x M5 x 12mm Black Button head Bolts

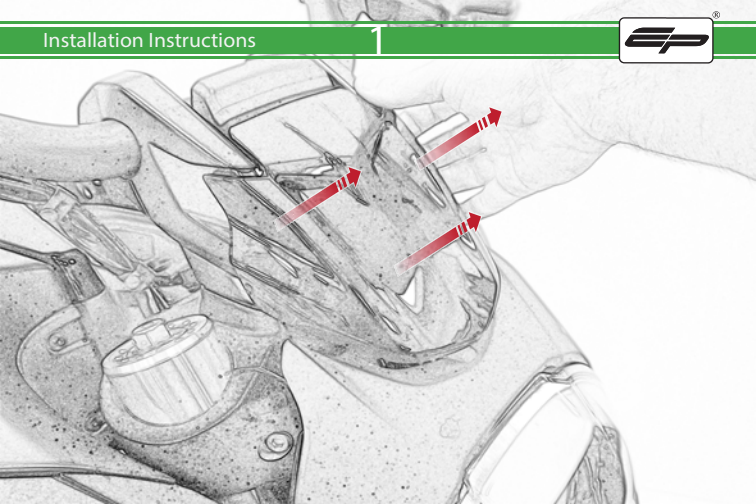

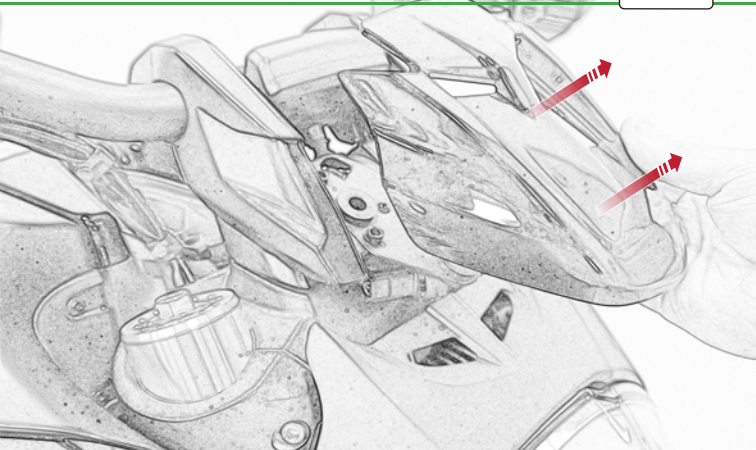

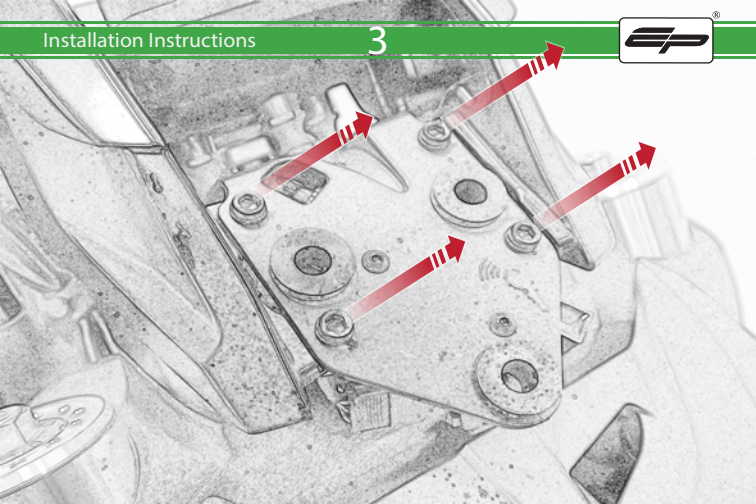

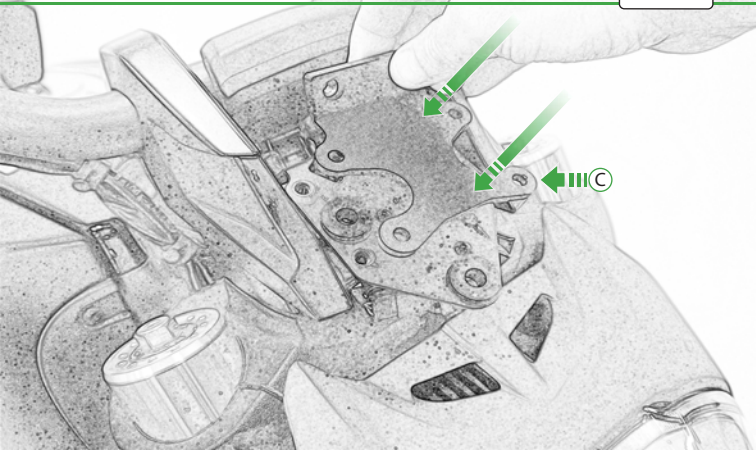



← OEM PART

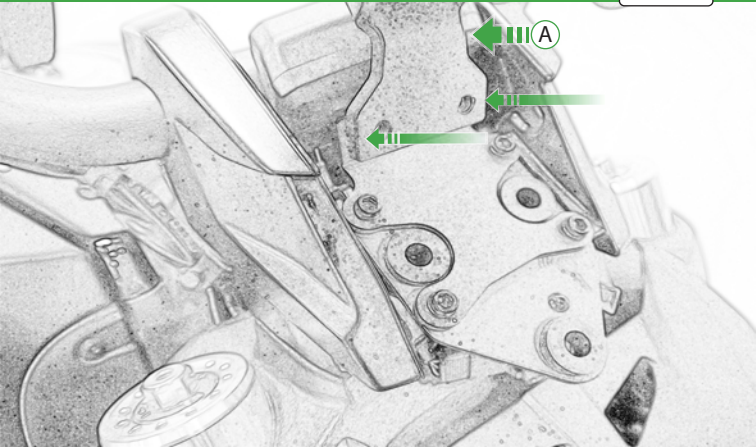



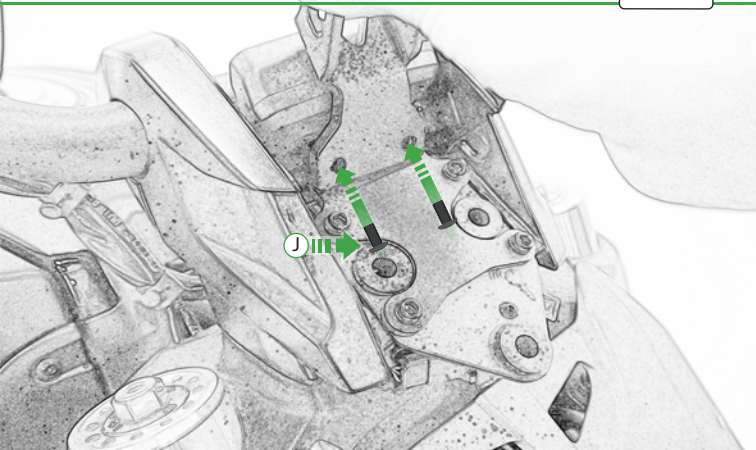

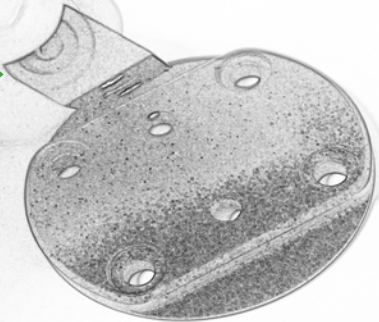

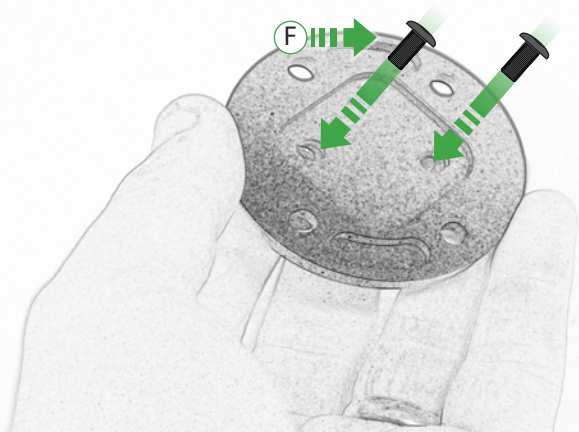

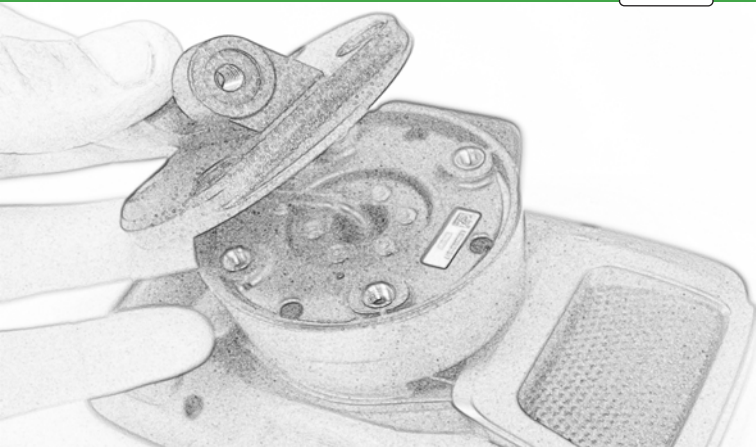

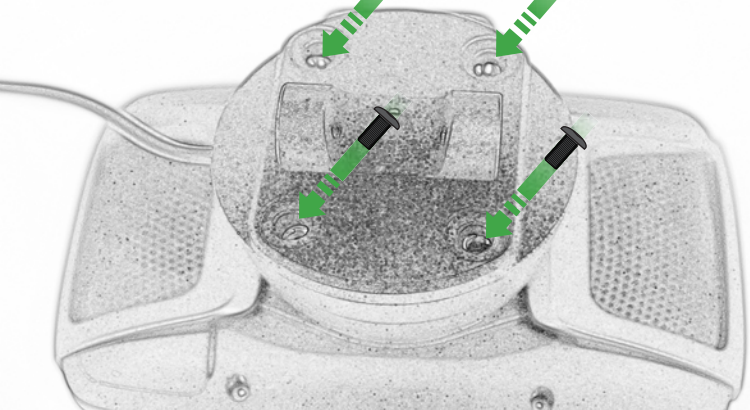

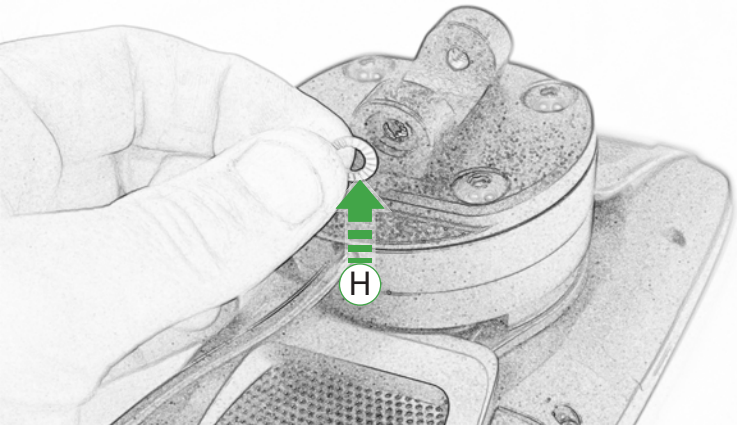

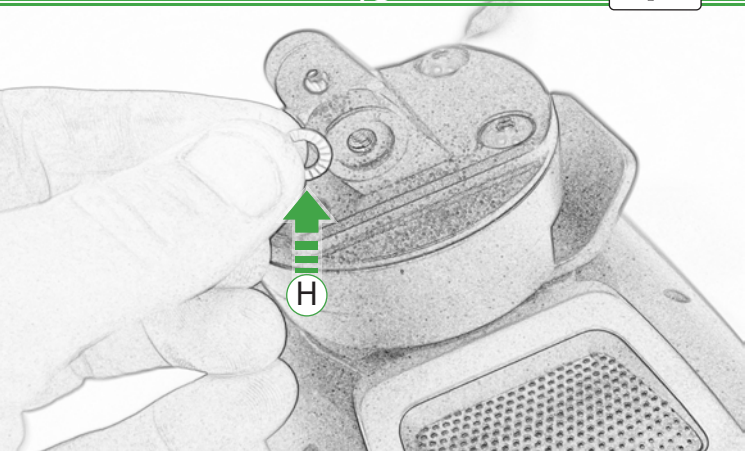

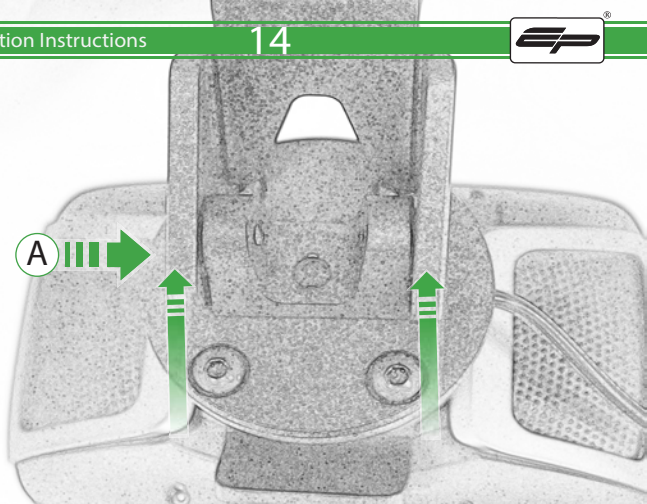



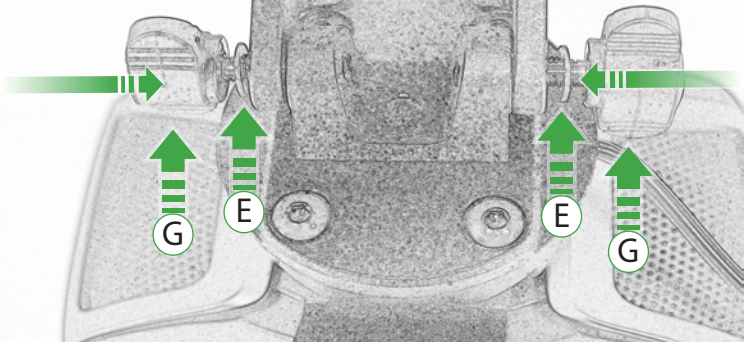

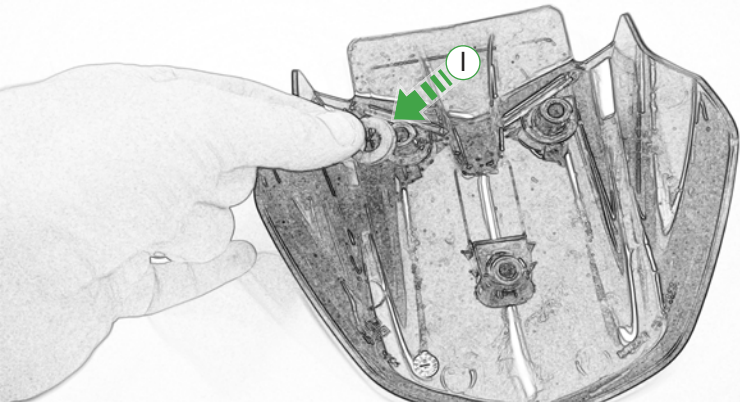

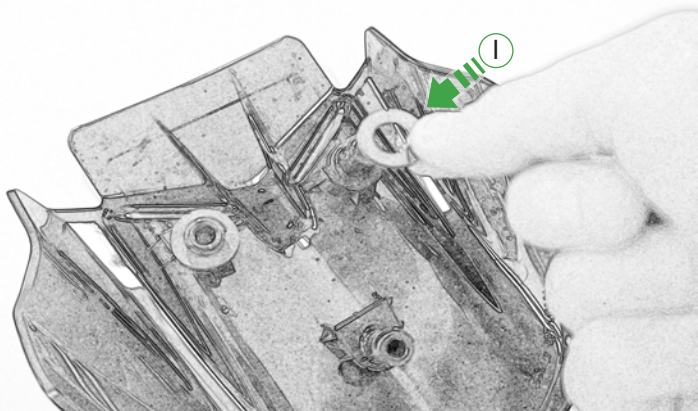



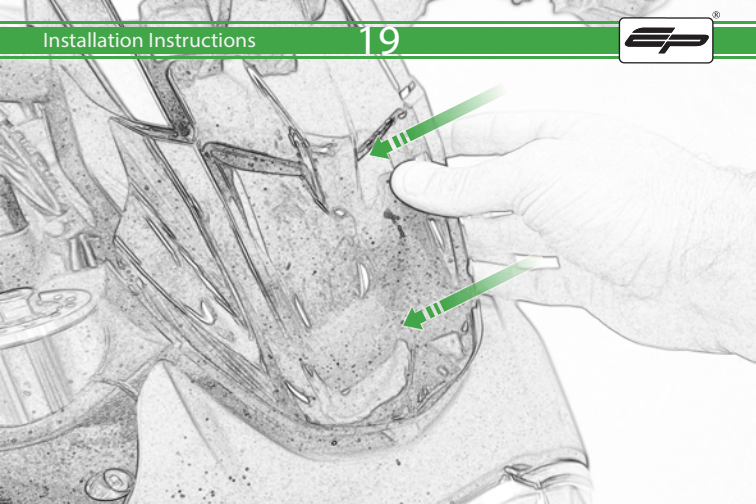



 **ESSENTIAL CHECKS** 

It is recommended that periodic inspections are made to ensure that all bolts are tightened to the specified torque settings.

Should the bike be involved in an accident a thorough inspection should be made and any components that have taken an impact, no matter how small, be replaced



**EVOTECH**®  
P E R F O R M A N C E

[www.evotech-performance.com](http://www.evotech-performance.com)