



EVOTECH[®]
P E R F O R M A N C E

BMW R 1200 / 1250 GS / GSA
S 1000 XR Handguard

Installation Instructions



Kit Contents PRN014553-014556

- (A) 1 x R/H Handguard
- (B) 1 x L/H Handguard
- (C) 2 x Bar End Outer
- (D) 2 x Bar End Middle Spacer
- (E) 2 x M10 x 70 SS Caphead
- (F) 2 x M5 Washer
- (G) 2 x M5 x 25 Black Button Head
- (H) 2 x Spacer
- (J) 2 x Bar End Inner

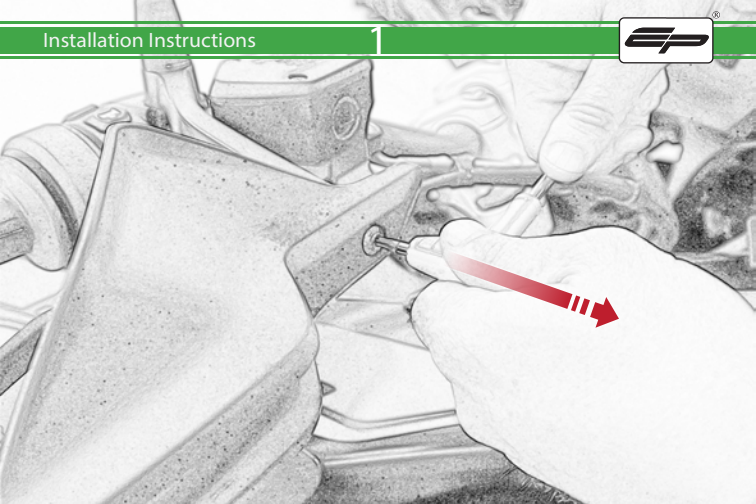

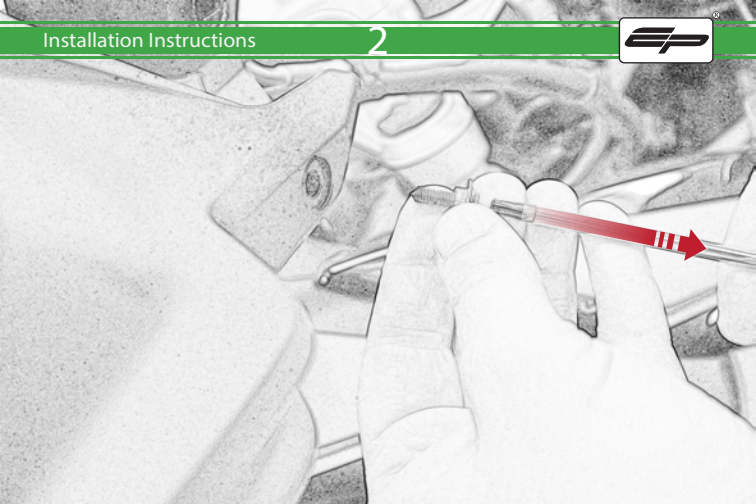



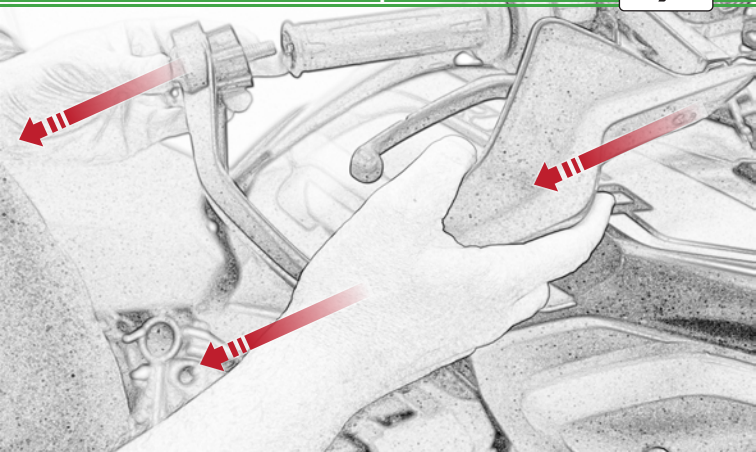

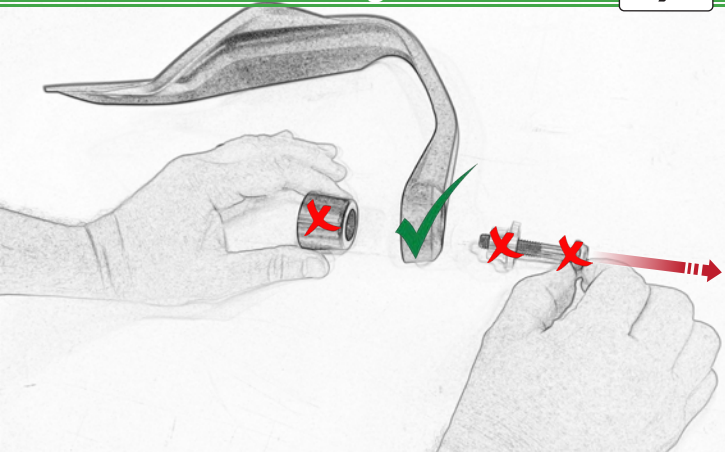

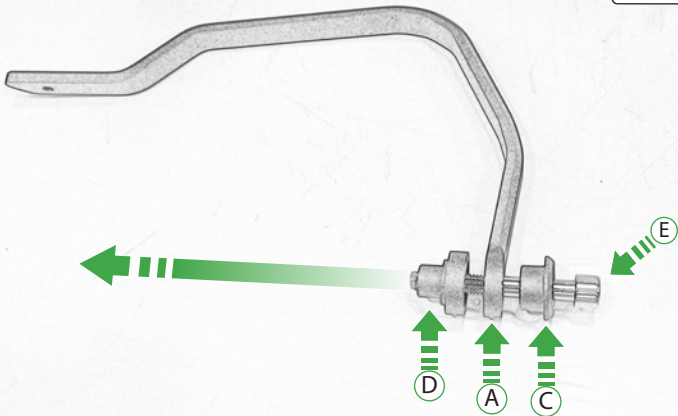

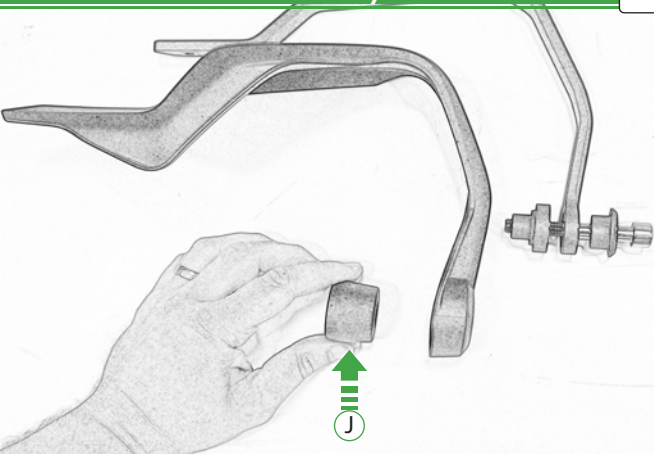

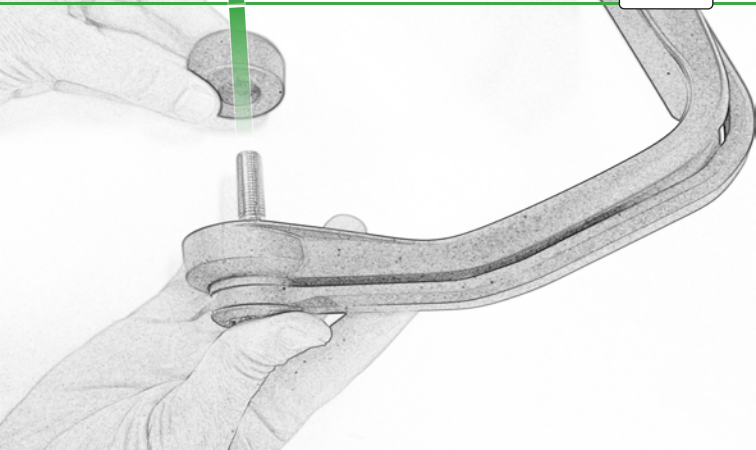

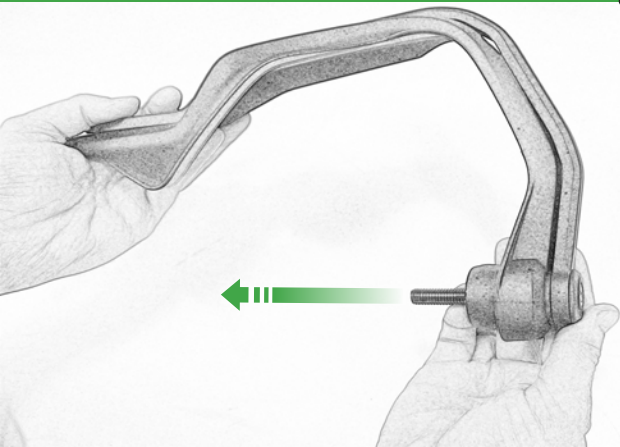



Do Not Fully
Tighten

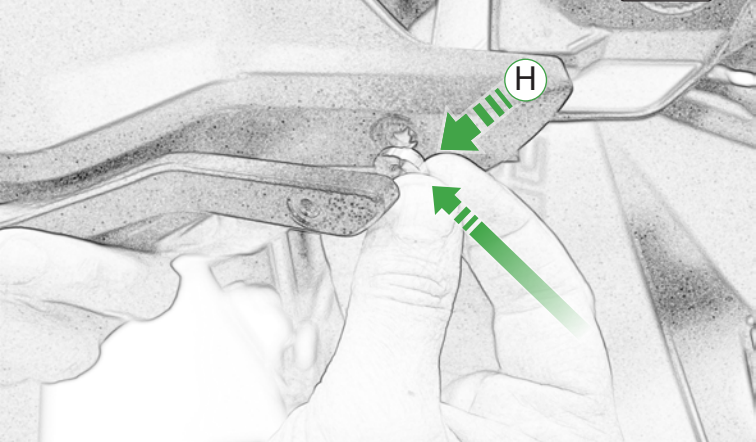



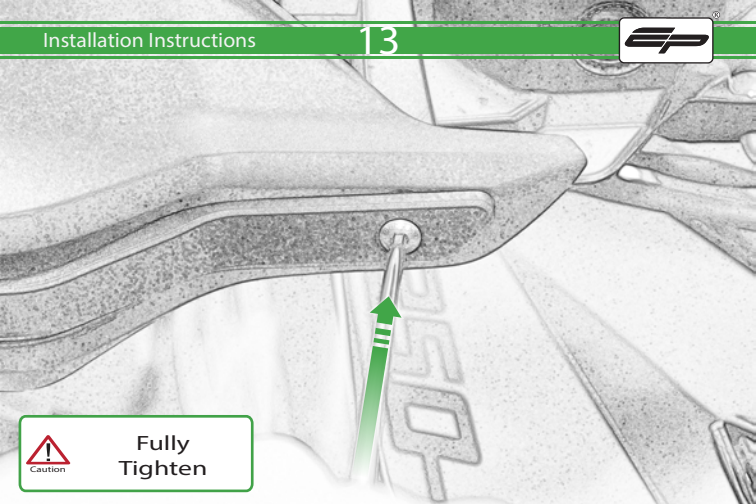

Caution

**Fully
Tighten**

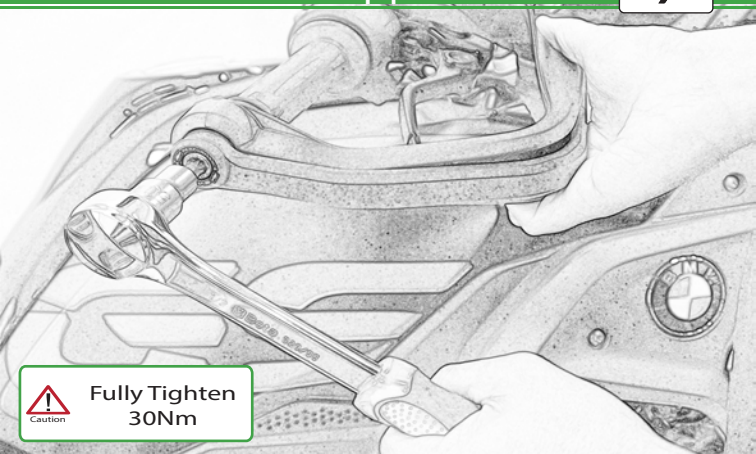

Caution

**Fully Tighten
30Nm**



Repeat Stages

1 - 14

For Left Hand Side



 **ESSENTIAL CHECKS** 

It is recommended that periodic inspections are made to ensure that all bolts are tightened to the specified torque settings.

Should the bike be involved in an accident a thorough inspection should be made and any components that have taken an impact, no matter how small, be replaced



EVOTECH®
P E R F O R M A N C E

www.evotech-performance.com