



Quantum® Hardcoated VStream® Windscreens for  
 2017-19 Honda® X-ADV  
 N20060 VStream Sport Windscreen  
 N20061 VStream Sport-Touring Windscreen  
 N20062 VStream Touring Windscreen

Thank you for purchasing a National Cycle product. Read these instructions carefully and thoroughly before beginning work. Dealers, if installing this windscreen for a customer, please give them this manual. It contains information needed to properly maintain and use this product.

**PACKAGE CONTENTS**

Item Description	Part No.	Qty.
VStream® Windscreen	N20060/61/62	1

**TOOLS REQUIRED**

5mm Hex Key or Driver

**NOTES**

All OEM hardware will be reused.

**PREPARATION**

1. Place vehicle securely on its centerstand.
2. Remove the four 5x20 Panhead Hex Screws (B) and 5mm Thrust Washers (C) securing the Windscreen (A) to the Windscreen Holder (F). The 5mm Wellnuts (D) and 9mm Washers (E) should stay captive in the Windshield Holder.

**All OEM hardware will be reused.**

3. Replace the stock Windscreen with your new VStream Windscreen and reinstall the four Panhead Hex Screws (B) and 5mm Thrust Washers (C). Tighten each Screw while holding each Wellnut from behind the Windscreen Holder until the Wellnut expands.

Double-check the tightness of all four Screws.

**You're all done.**

**Enjoy the ride with your new VStream Windscreen!**

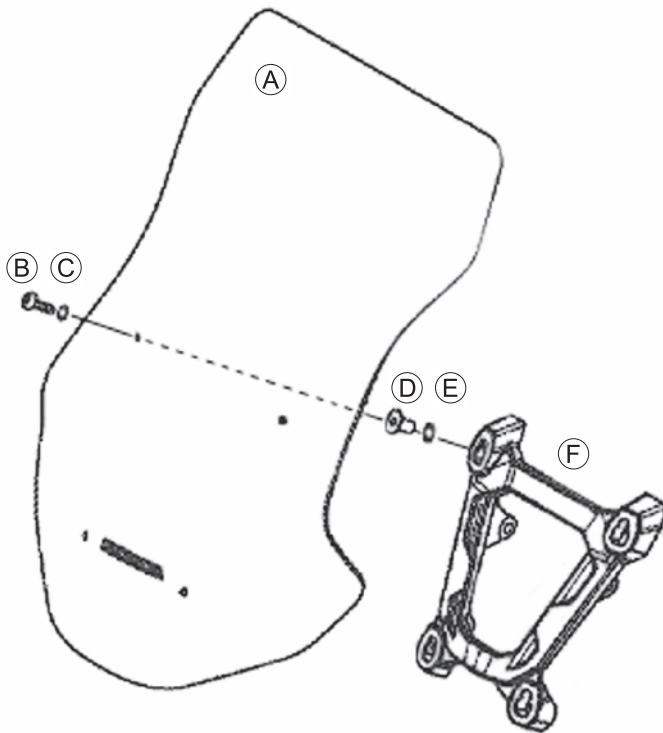

**VStream®  
Windscreens**



VStream® Windscreen Patent No. 7,387,328



## CLEANING AND MAINTENANCE

To clean the screen, wash with a clean soft cloth and plenty of warm water and, if necessary, a non-abrasive soap such as dishwashing liquid. Flannel or soft chamois make good cleaning cloths. Paint, glue residue or grease removal: Moisten cotton wad with naphtha or turpentine followed by a wash as above.

National Cycle **Shield Wash™** (N1401-01) makes a good daily cleaner and comes with a handy travel-size bottle. Shield Wash is safe for all windshields and helmet visors

Do not clean polycarbonate in hot sun or high temperatures. Do not clean the screen with household glass cleaners. Do not allow brake fluid, alcohol, or strong solvents to contact the screen.

## RAIN REPELLENT

Do not use rain protective products made for glass. We recommend National Cycle's **RainZip®** (N1410-01) to keep your windshield clear in rainy weather.



Register Your Windshield Online at [www.nationalcycle.com](http://www.nationalcycle.com)

### National Cycle 3-Year Limited Warranty

National Cycle hereby warrants to the original registered owner of a National Cycle polycarbonate windshield for a period of three years from the date of purchase against breakage. This limited warranty is expressly limited to the replacement of the polycarbonate windshield. This limited warranty does not include scratches, coating failure, cosmetic wear and tear, replacement of hardware, or any consequential damages or expenses including labor cost of installation, removal and/or replacement, inconvenience, inbound freight expenses or damage to any other component of the motorcycle or any other accessories. Certain chemicals, generally known as acidic hydrocarbons, are known to cause polycarbonate damage and will not be covered under this limited warranty. Please refer to the cleaning instructions supplied with all National Cycle windshields.

Visit [www.nationalcycle.com](http://www.nationalcycle.com) for further details, or call or write National Cycle

## ⚠ WARNING

Never ride your motorcycle with loose accessory mounting hardware. Check the hardware for tightness regularly.

Today's motorcycles are built with enough frame rigidity to withstand the moderate loads imposed on them by the foreseeable addition of an accessory(ies). If an accessory(ies) adversely affects your motorcycle's stability, immediately remove the accessory(ies). Do not ride a motorcycle that exhibits unsafe handling traits.

Have experienced service personnel correct any problem before riding with the accessory(ies) installed. For further questions concerning handling problems associated with an accessory(ies), contact your dealer, motorcycle manufacturer, or accessory manufacturer.

**Sunlight reflected off the inside curvature of the windshield can, at certain times of day, cause extreme heat buildup on the motorcycles instruments and possibly even melt them. Exercise care in parking to avoid this. Park your motorcycle facing the sun or place an opaque object over this area.**