



**EVOTECH**®  
P E R F O R M A N C E

[www.evotech-performance.com](http://www.evotech-performance.com)

Triumph Scrambler 1200 XC / XE Tail Tidy

Installation Instructions



## Kit Contents PRN014766

- |                                |                                 |
|--------------------------------|---------------------------------|
| Ⓐ 1 x EP Connector Type 10     | Ⓜ 2 x M6 x 25 Button Head Bolts |
| Ⓑ 1 x EP Connector Type 25     | Ⓝ 2 x M6 x 30 Button Head Bolts |
| Ⓒ 1 x Led Number Plate Light   | Ⓞ 2 x M4 x 12 Button Head Bolts |
| Ⓓ 1 x Neoprene                 | Ⓟ 2 x M4 x 25 Screws            |
| Ⓔ 1 x Wire Heat Seal           | Ⓠ 2 x M4 Flange Nuts            |
| Ⓕ 1 x Number Plate Light Block | Ⓡ 4 x M6 Flange Nuts            |
| Ⓖ 1 x Undertray                | Ⓢ 6 x M6 x 20 Button Head Bolts |
| Ⓗ 1 x Main Bracket             |                                 |
| Ⓘ 1 x Light Housing            |                                 |
| Ⓝ 1 x LED Rear Light           |                                 |
| Ⓚ 2 x Short Spacer             |                                 |
| Ⓛ 2 x Longer Spacer            |                                 |

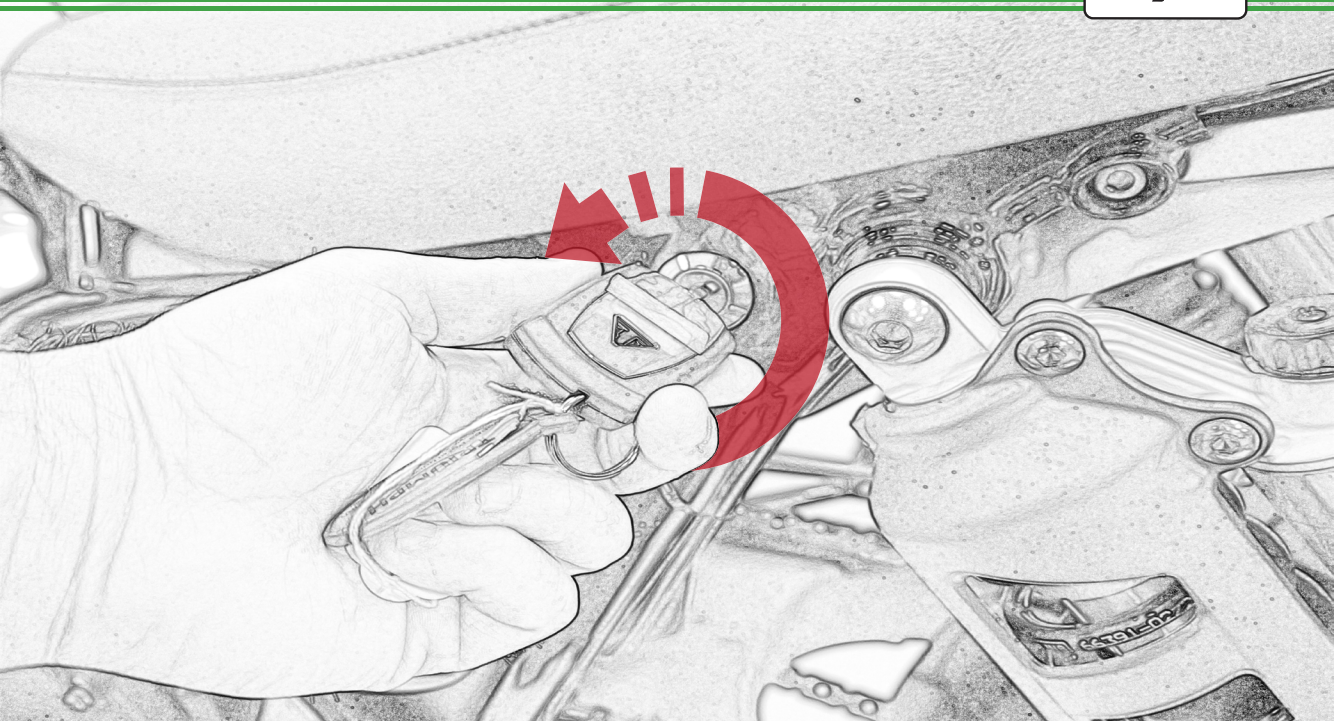

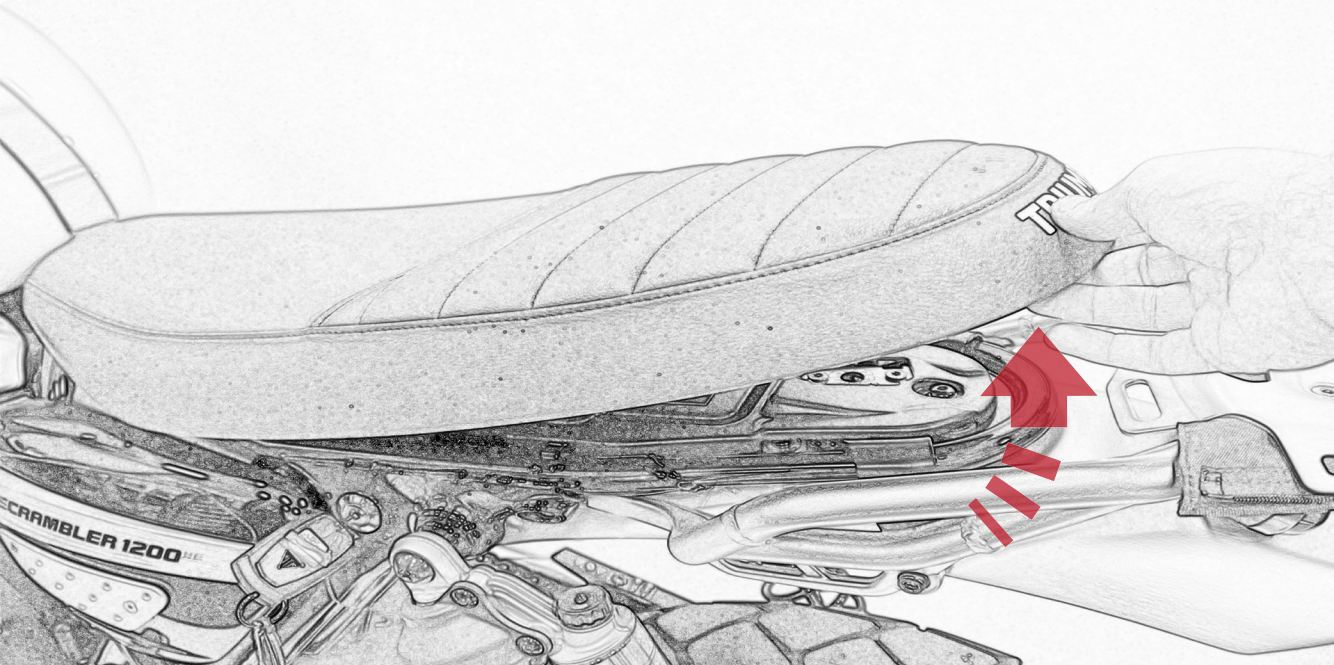

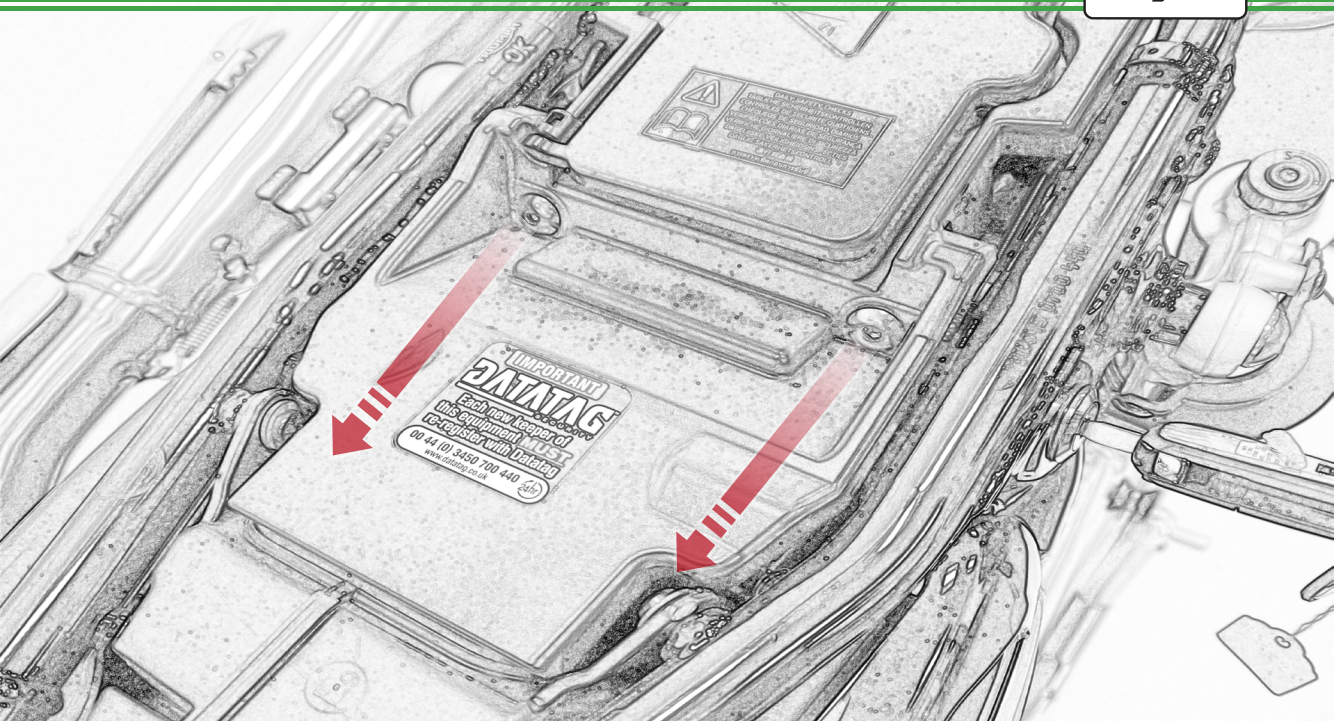

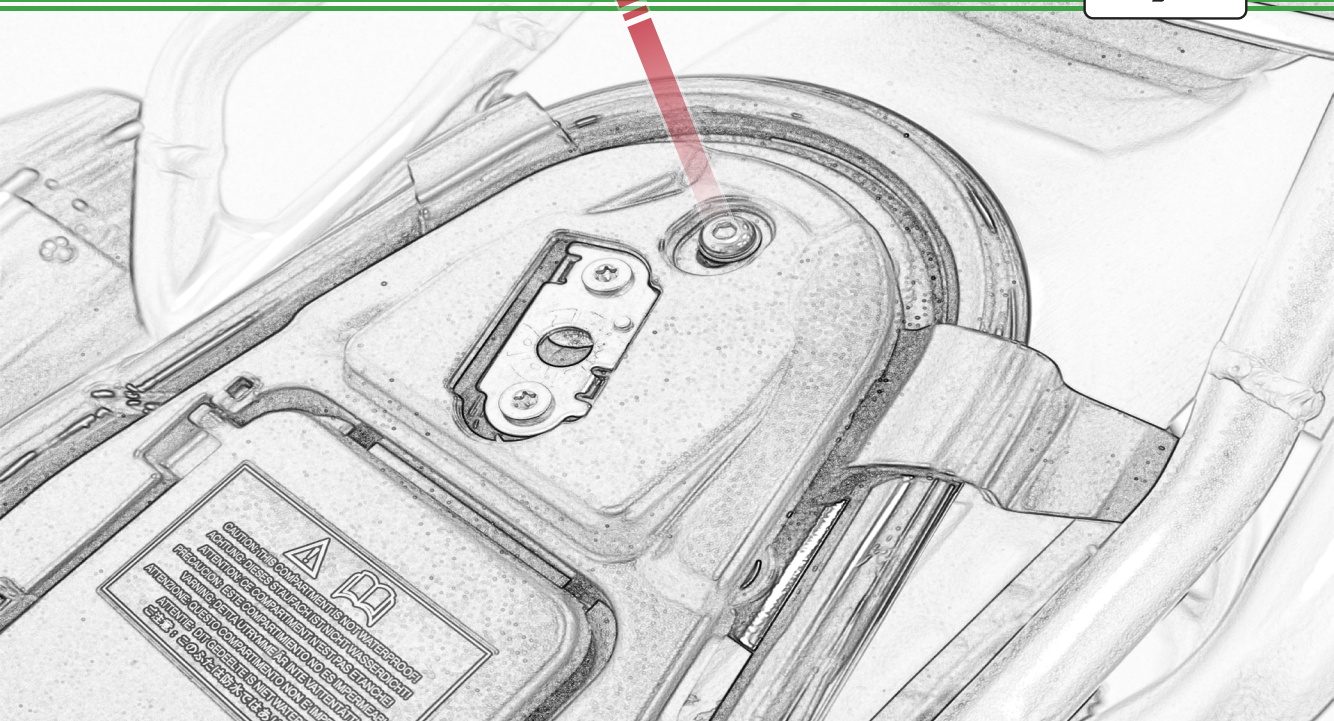

**CAUTION** THIS COMPARTMENT IS NOT WATERPROOF  
**ATTENTION** CE COMPARTIMENT N'EST PAS ÉTANCHÉ  
**PRECAUTION** ESTE COMPARTIMENTO NO É À PROOF  
**AVVERTENZA** QUESTO COMPARTIMENTO NON È IMBOTTITO  
**ATTENZIONE** QUESTO COMPARTIMENTO NON È IMBOTTITO  
**CAUTION** THIS COMPARTMENT IS NOT WATERPROOF  
**ATTENTION** CE COMPARTIMENT N'EST PAS ÉTANCHÉ  
**PRECAUTION** ESTE COMPARTIMENTO NO É À PROOF  
**AVVERTENZA** QUESTO COMPARTIMENTO NON È IMBOTTITO

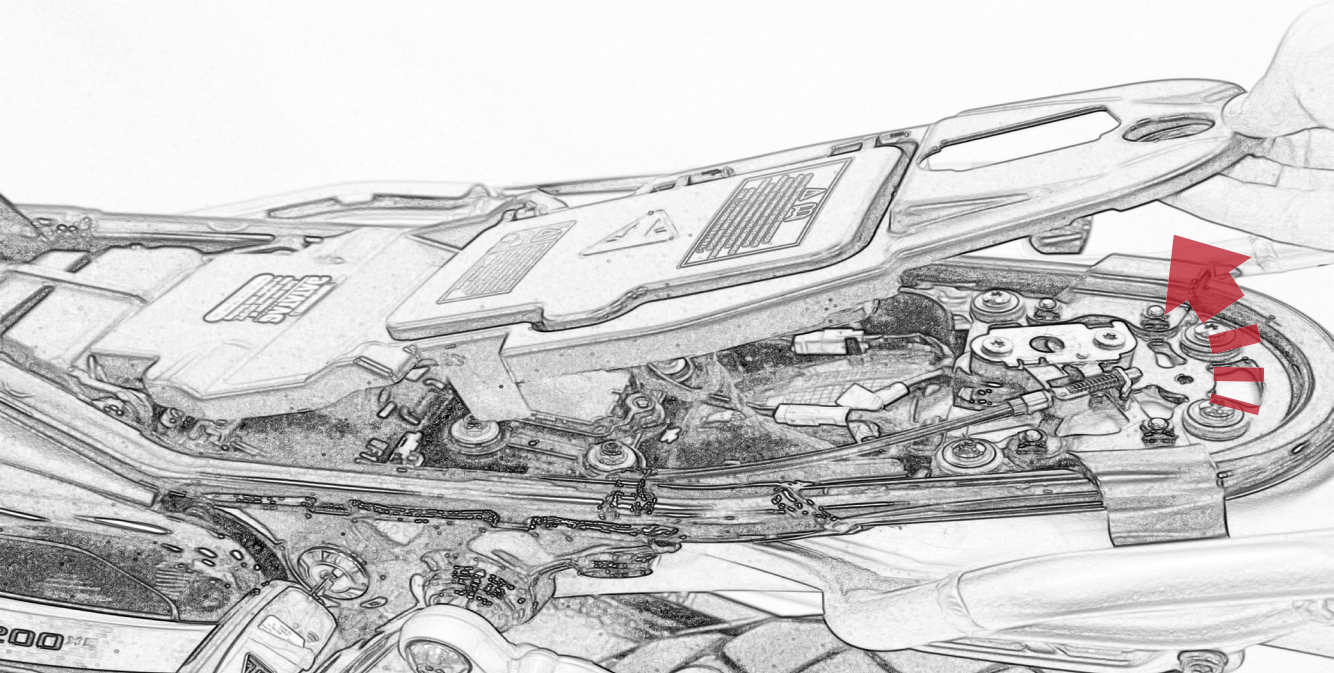

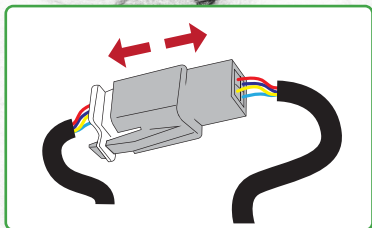
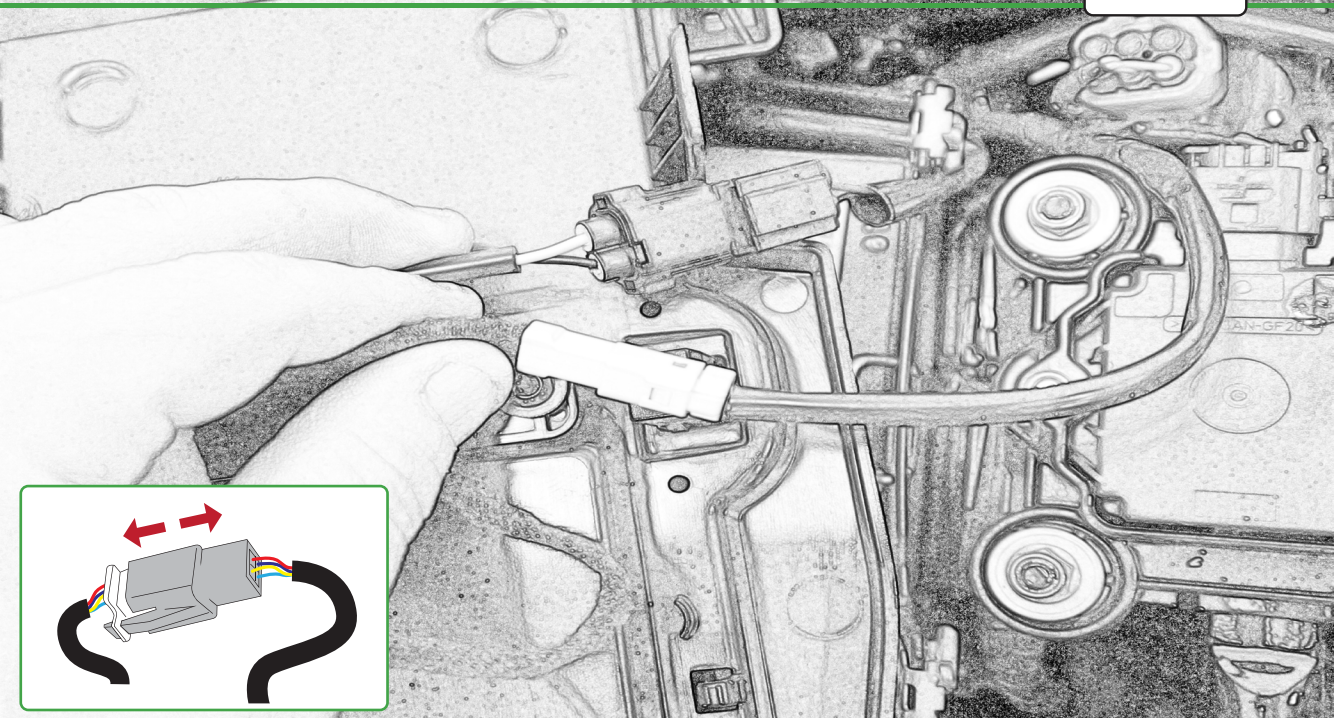





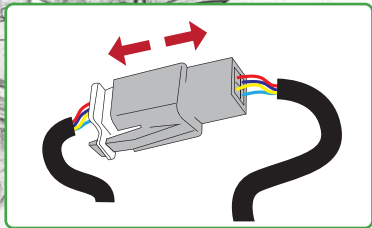

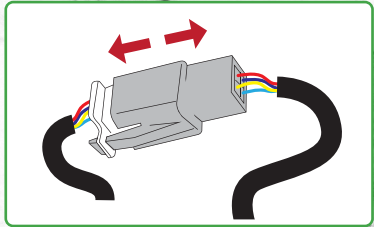

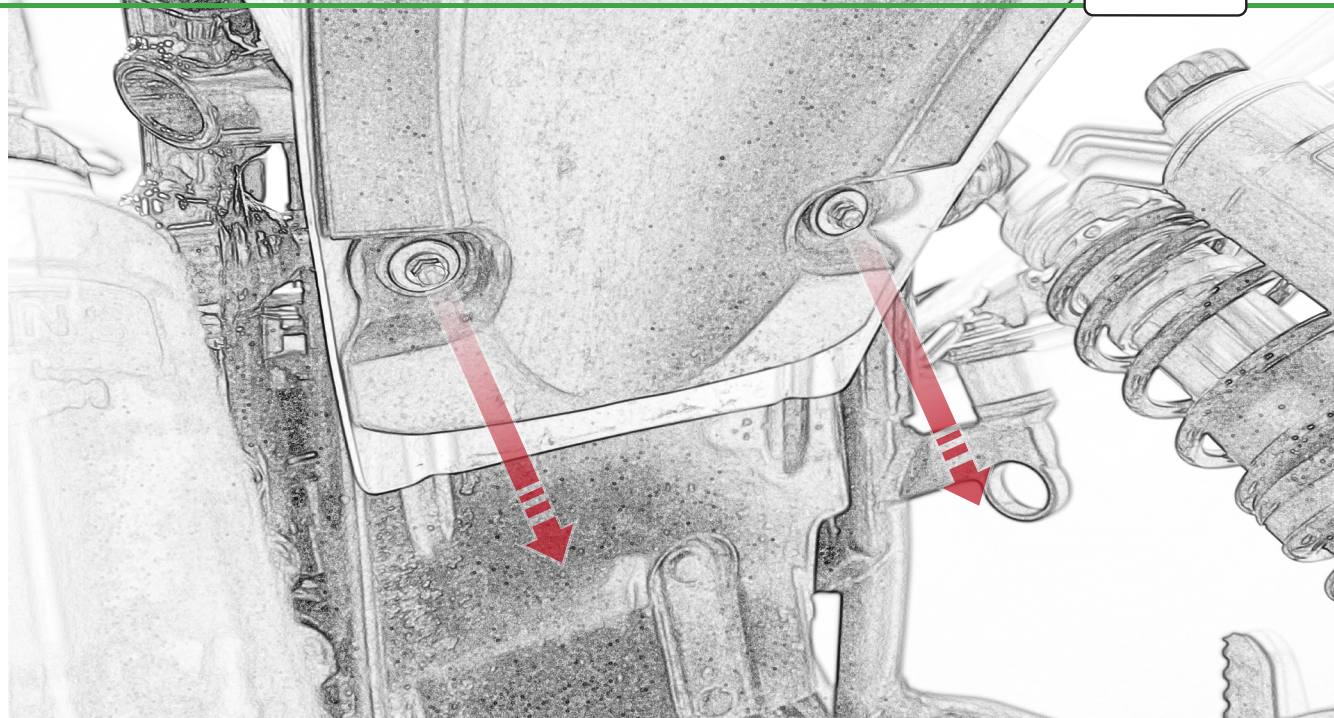

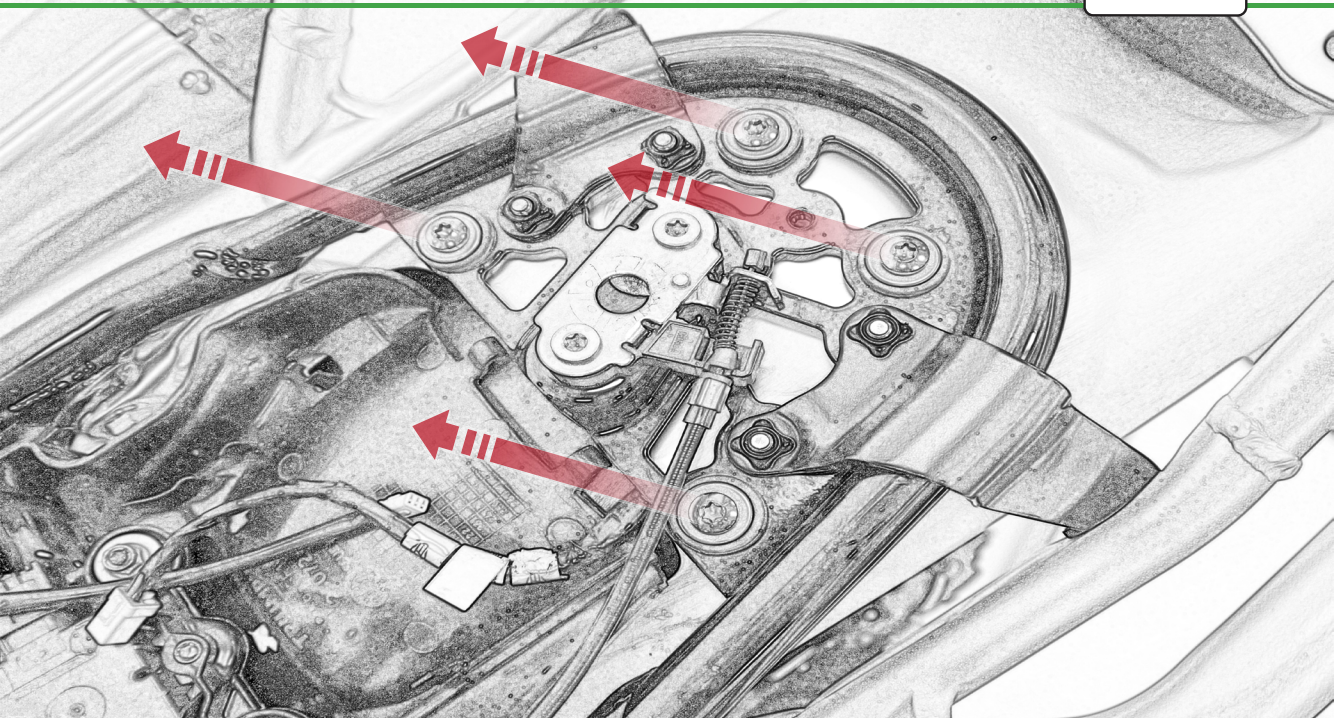

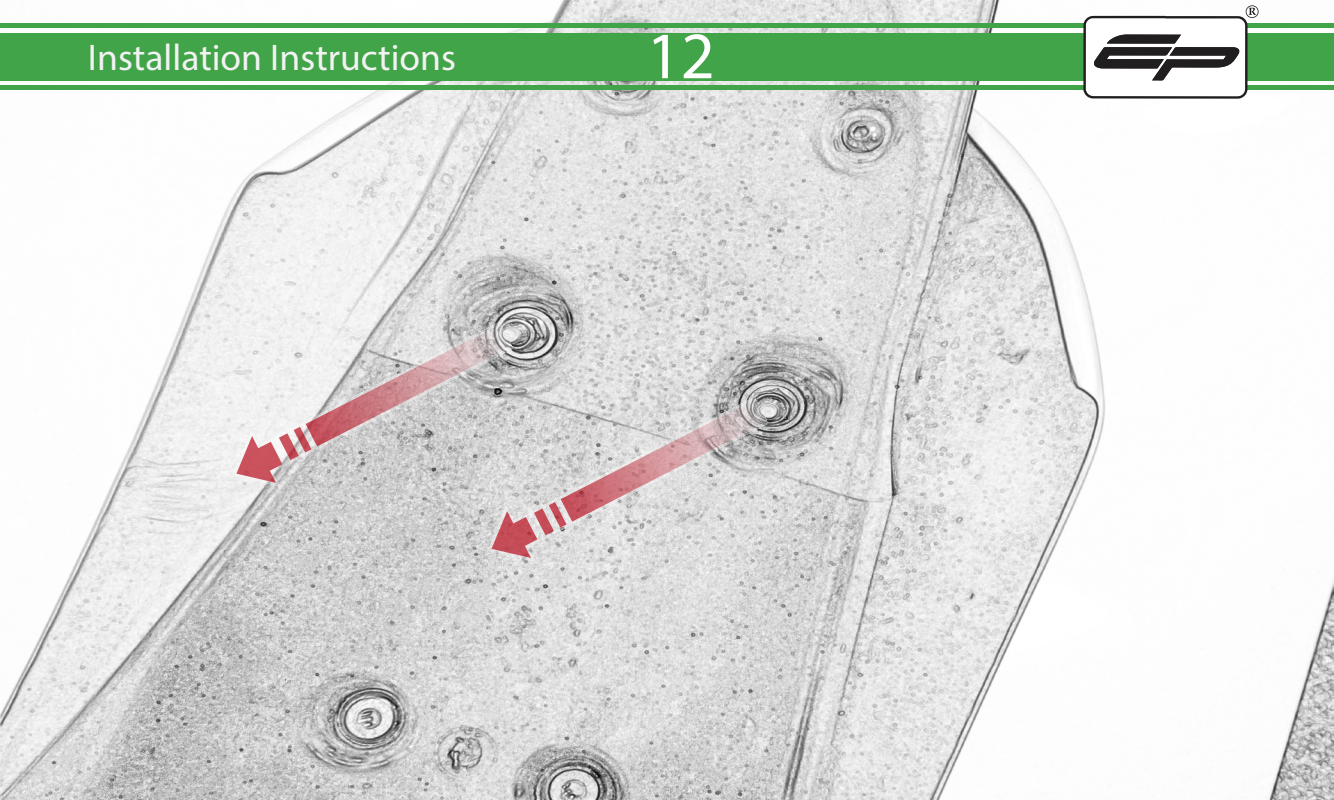

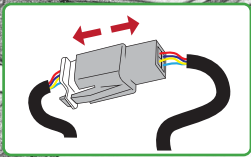
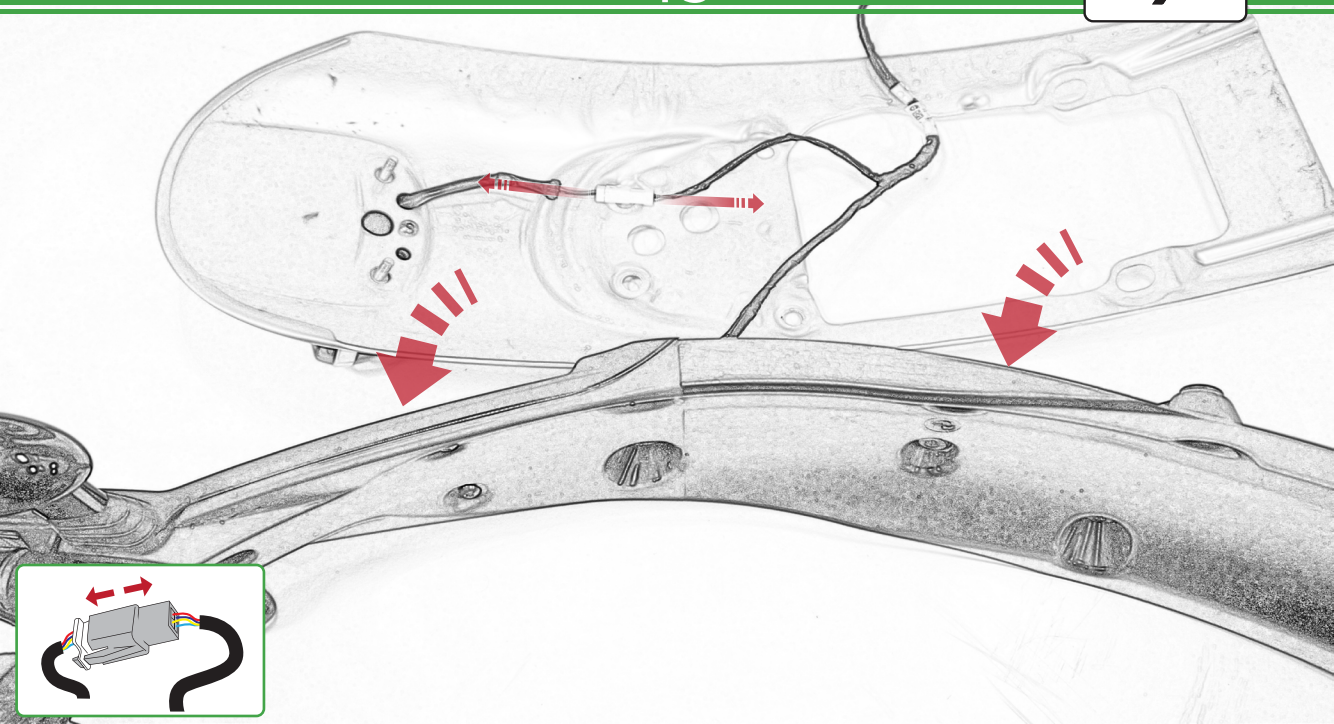

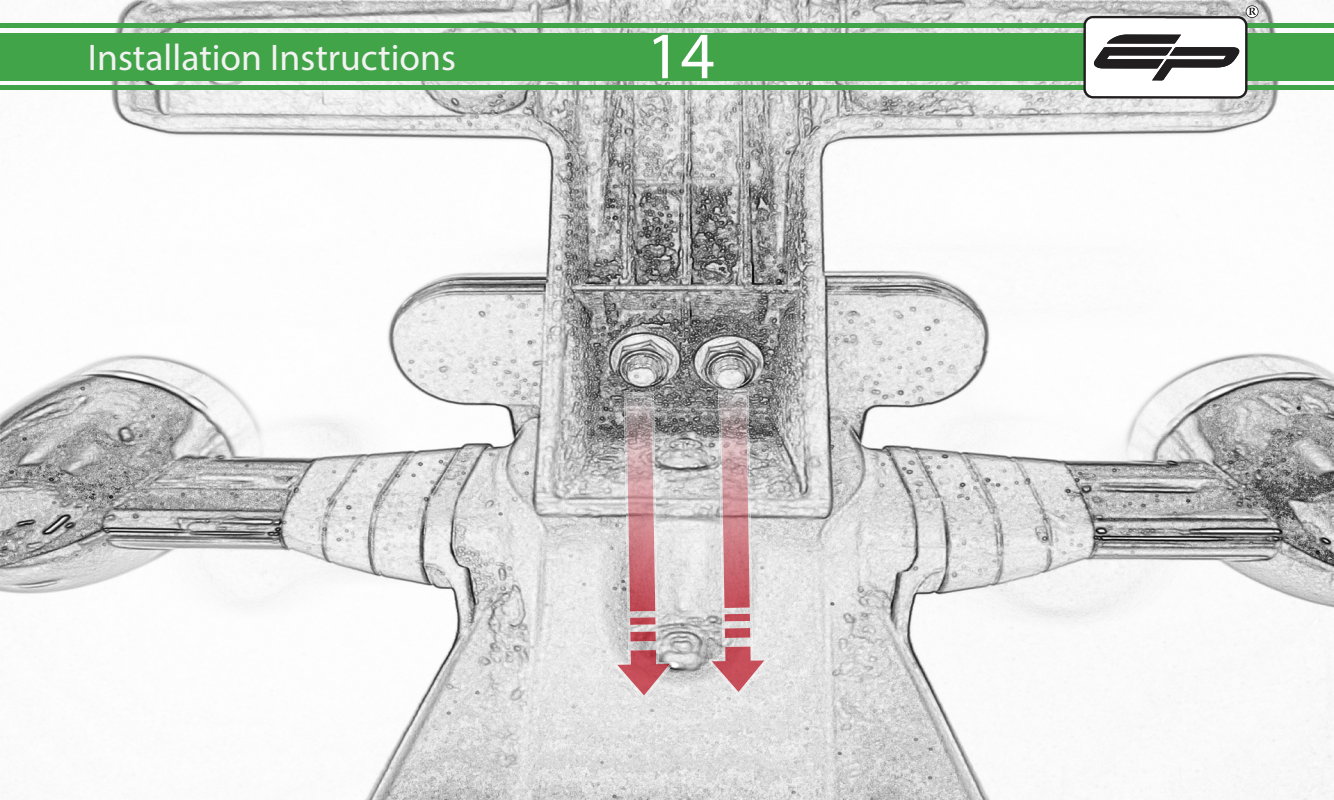



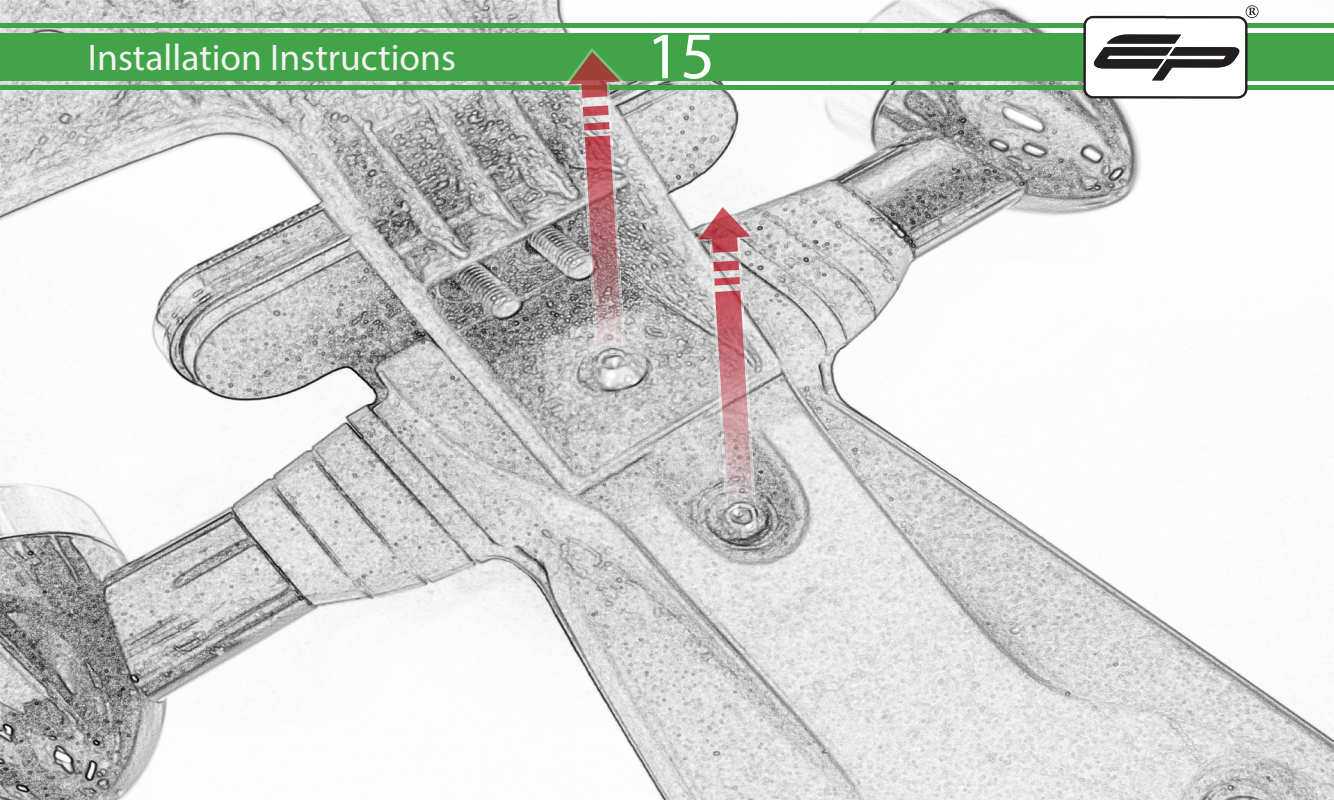

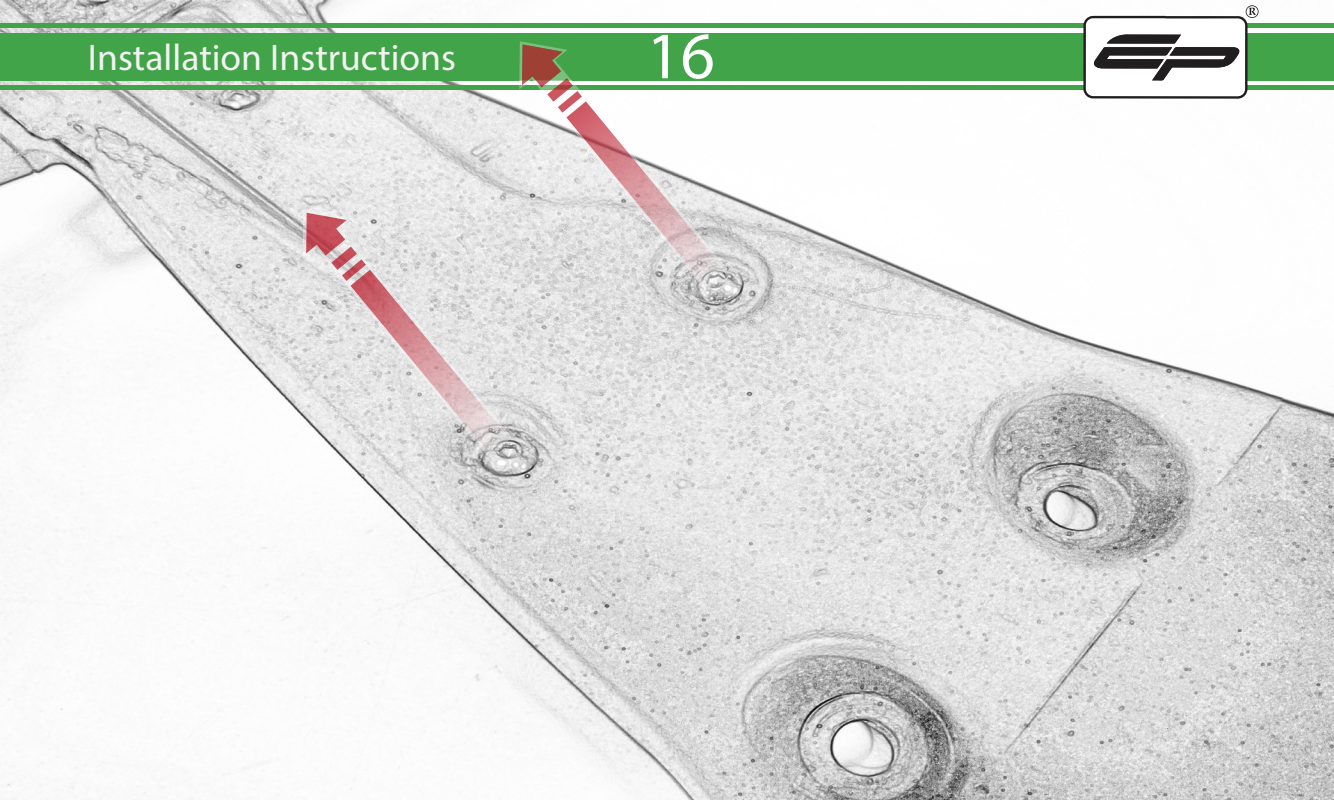

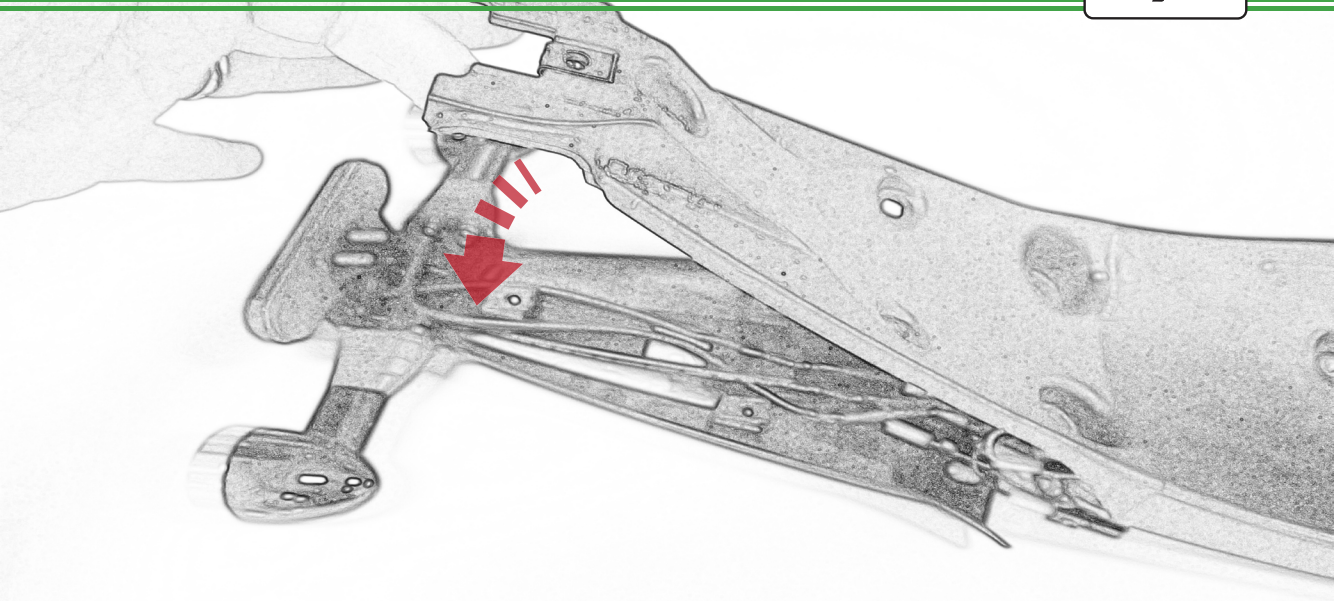

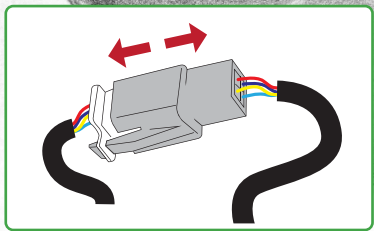
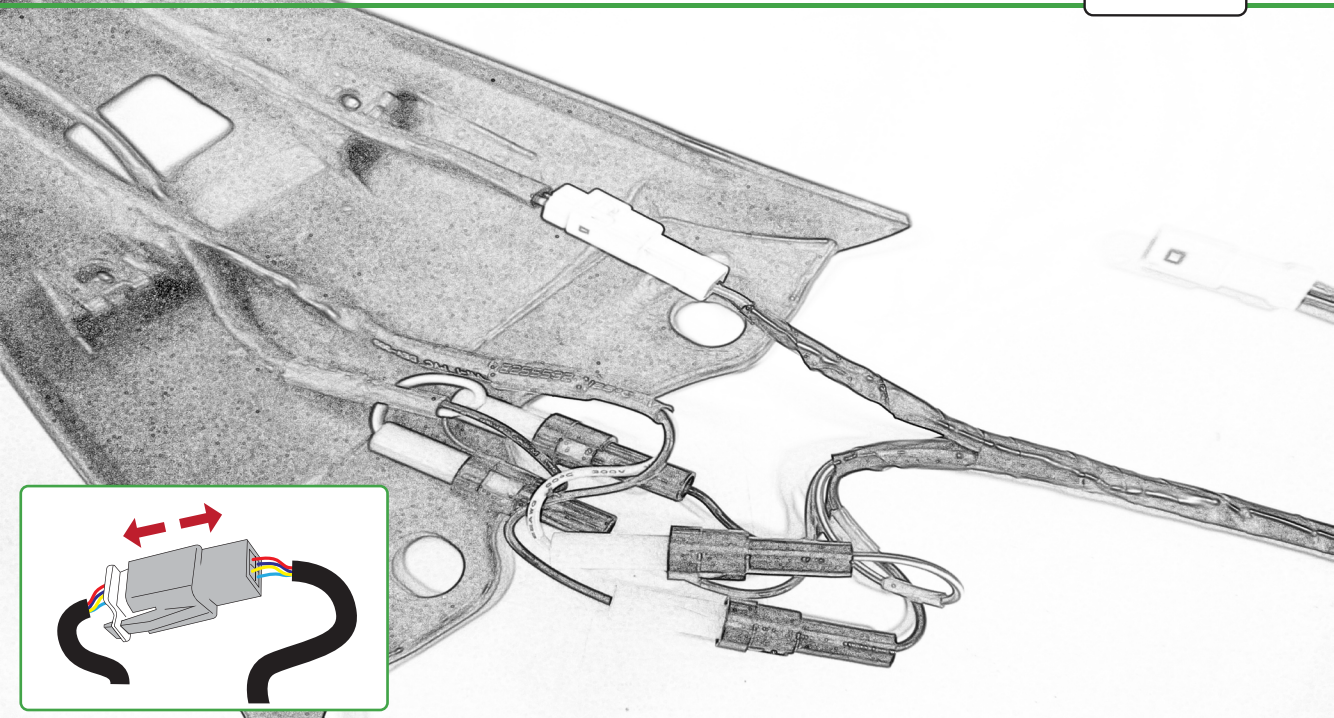

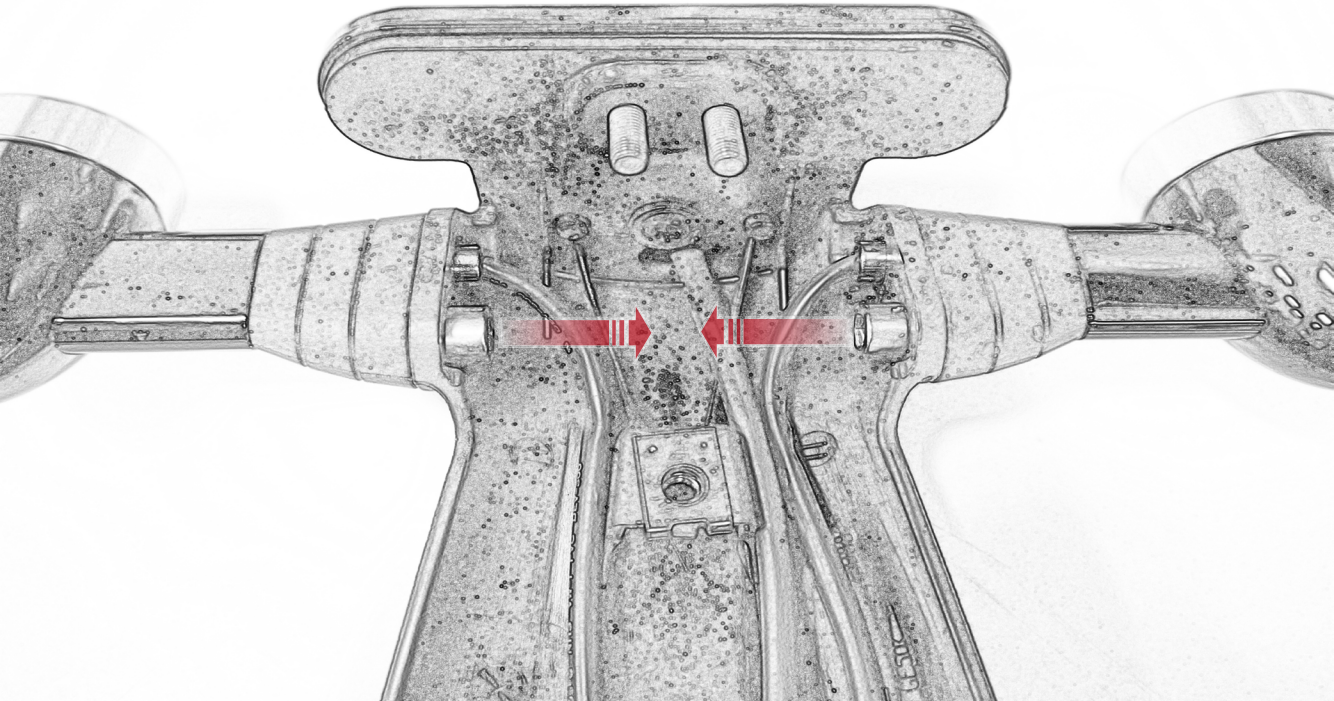

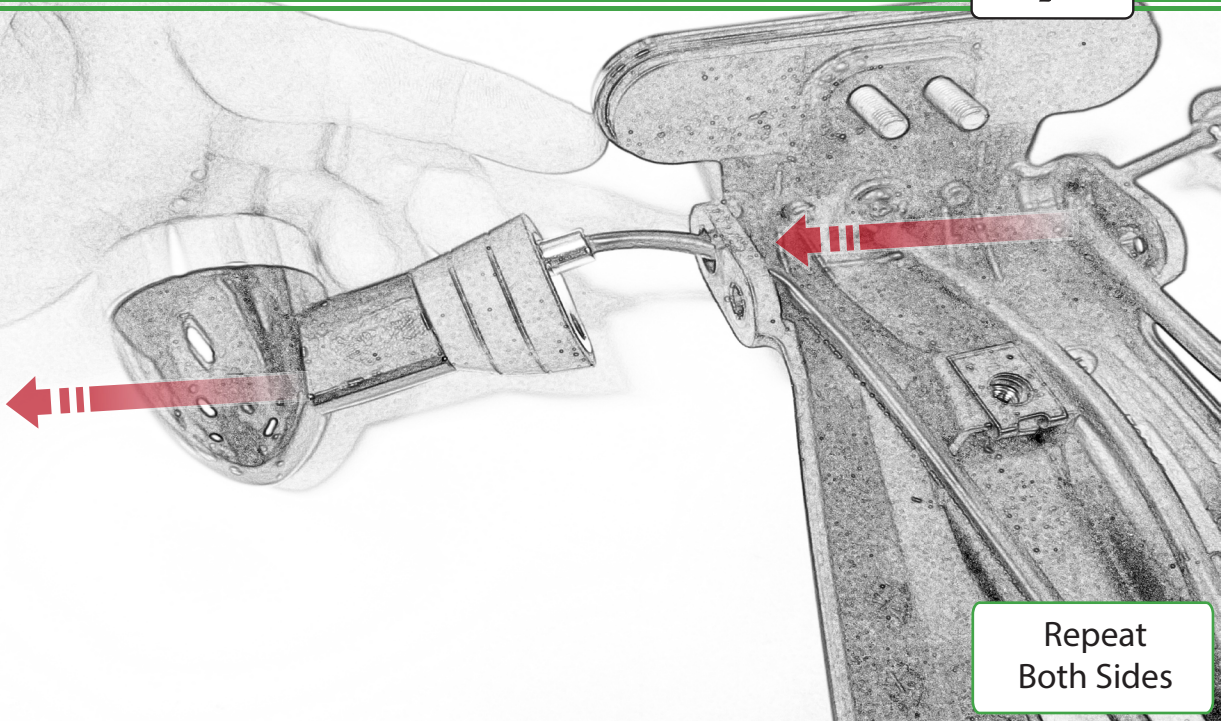

Repeat  
Both Sides

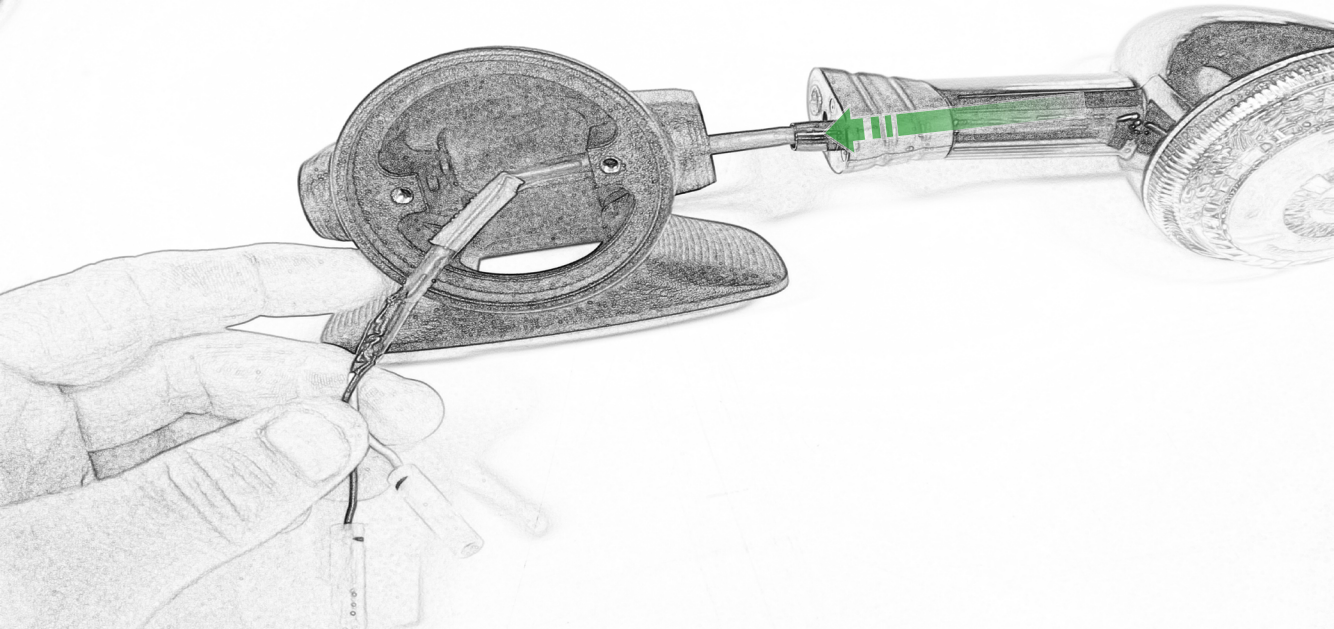

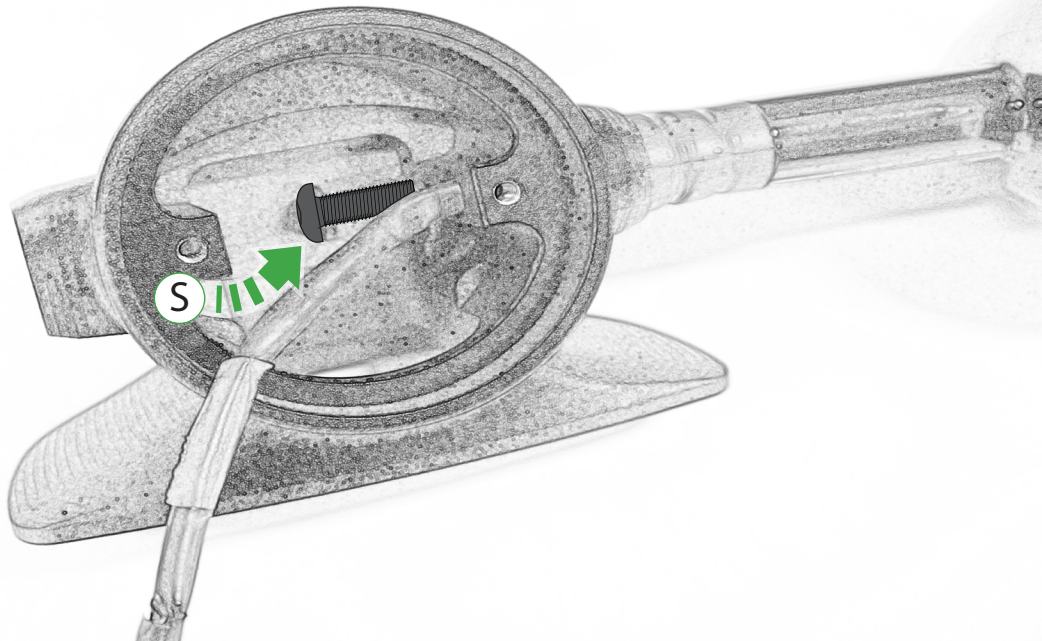



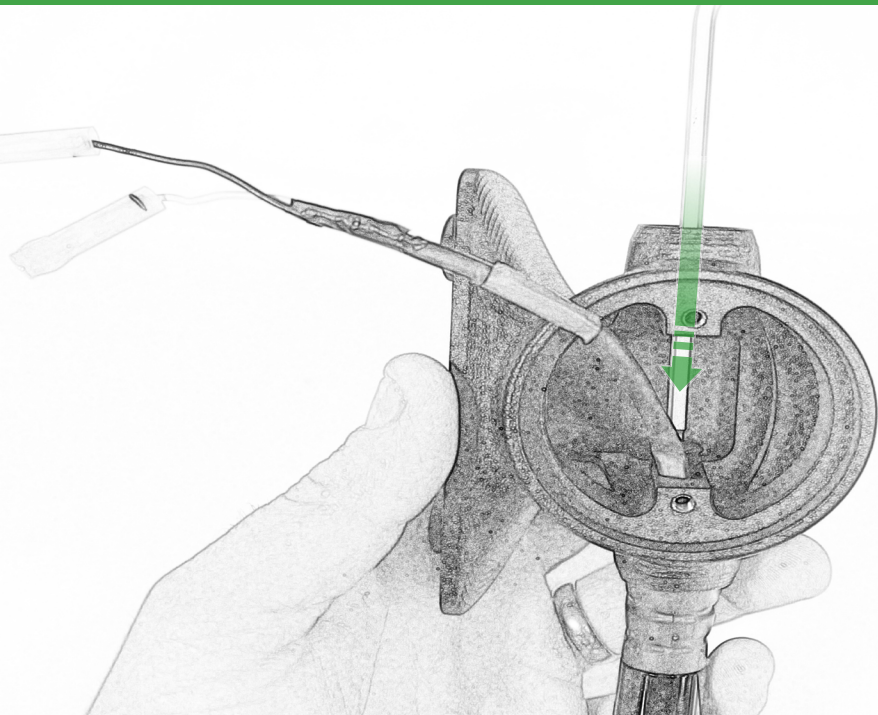

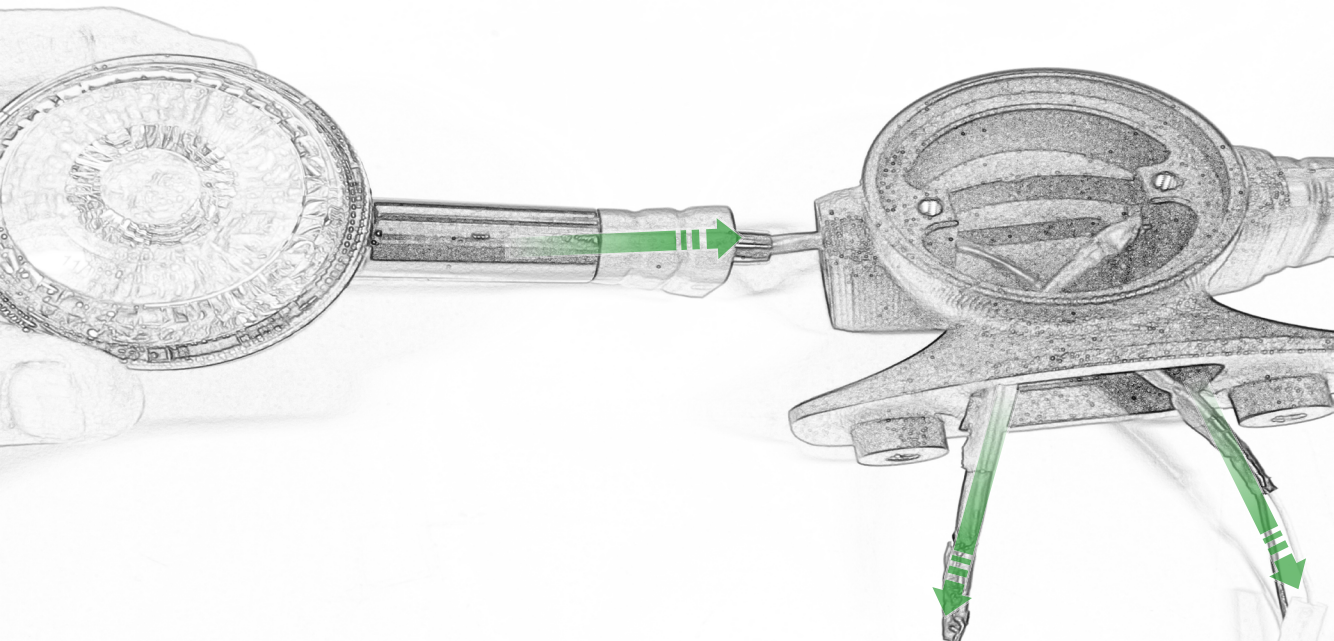

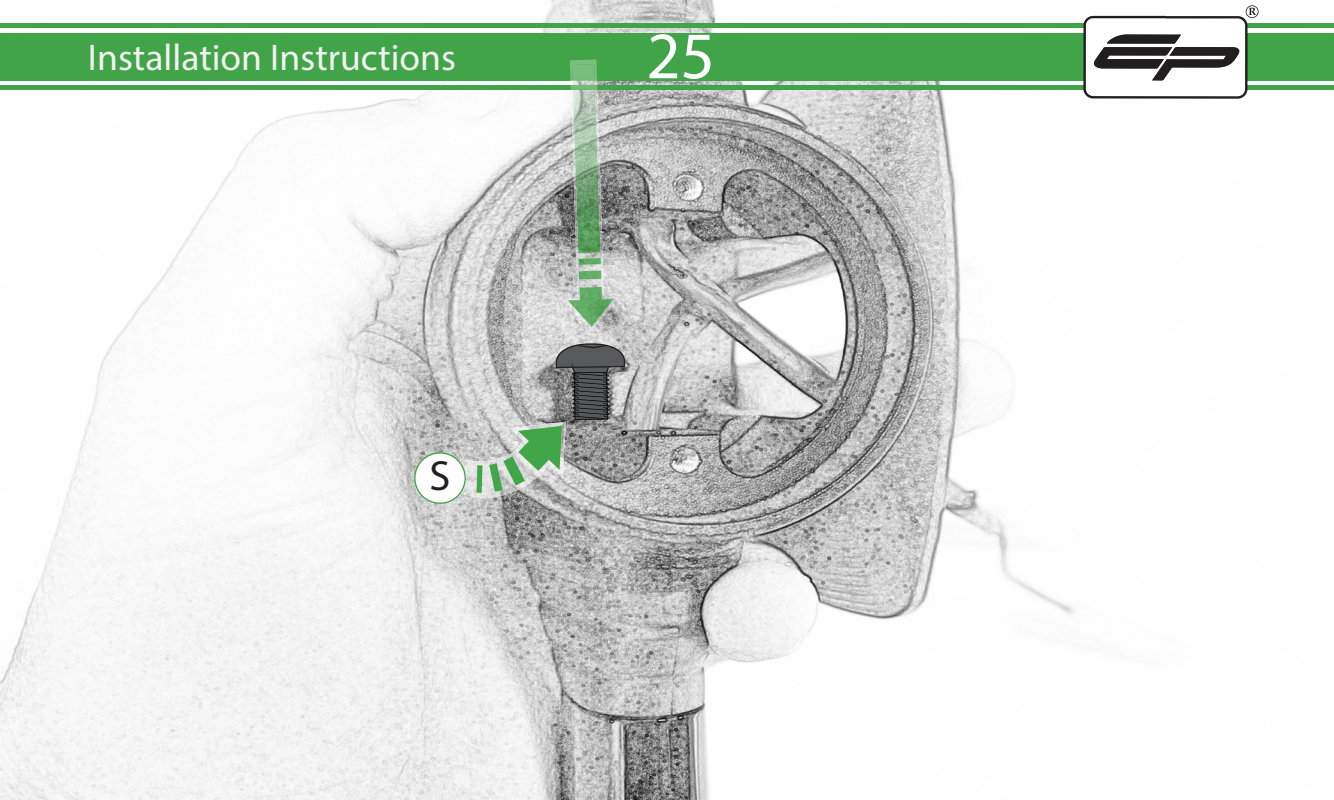

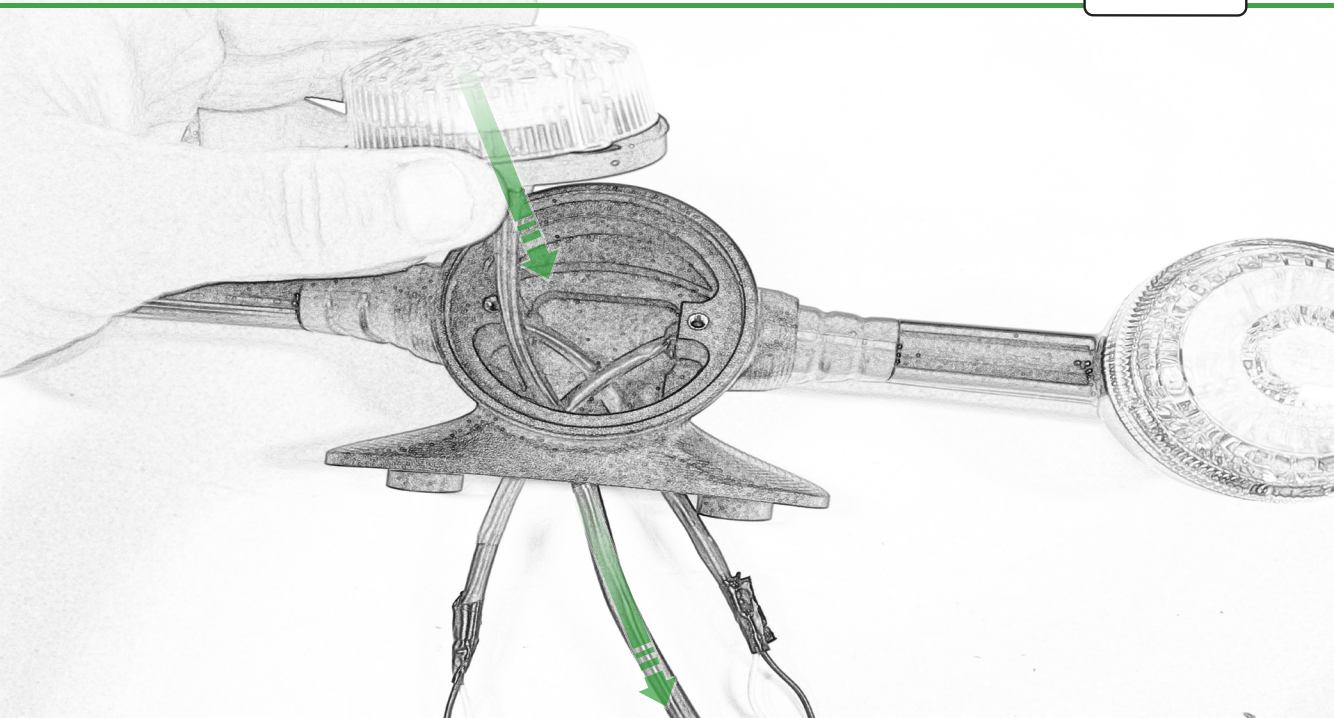

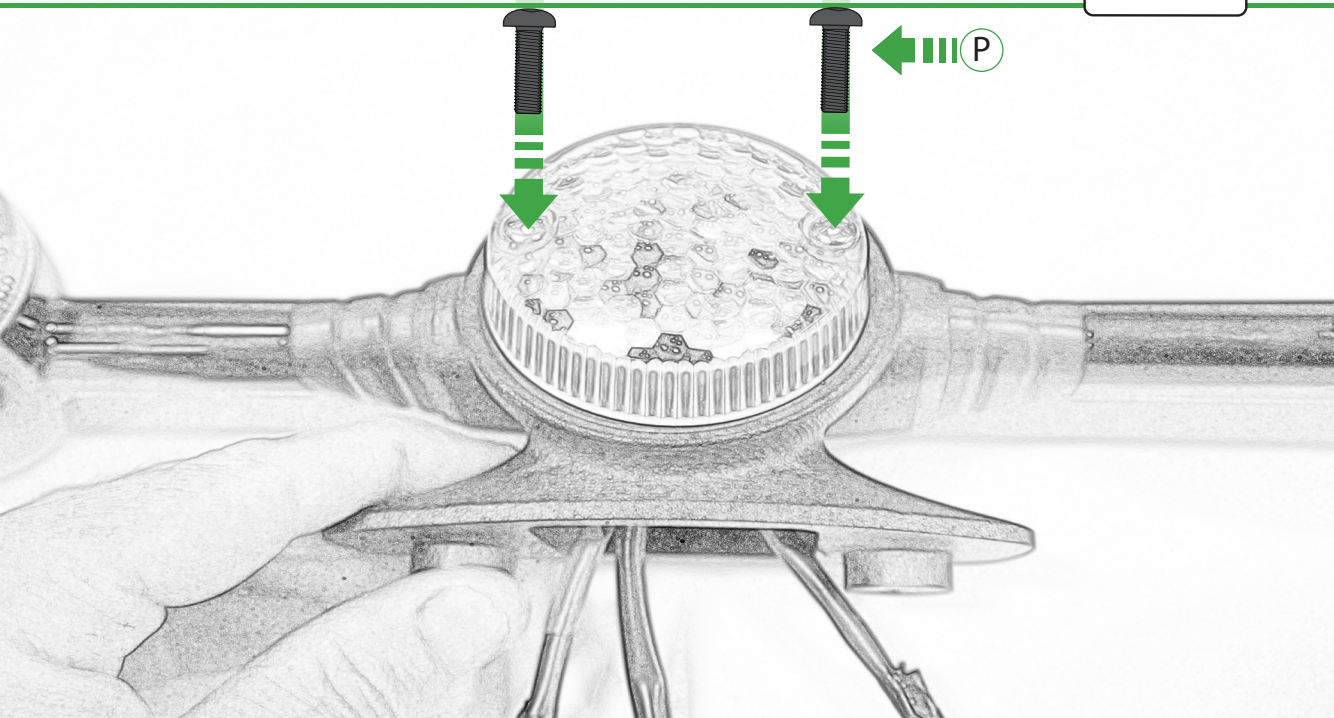

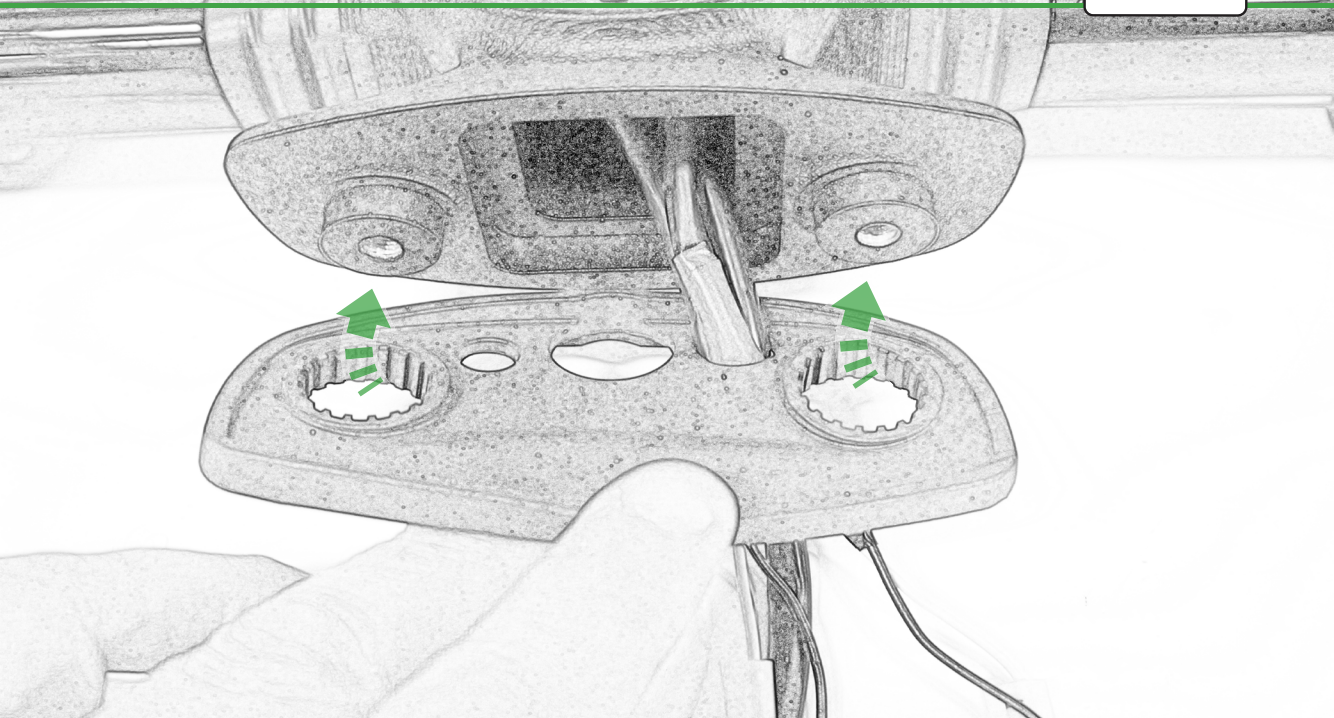

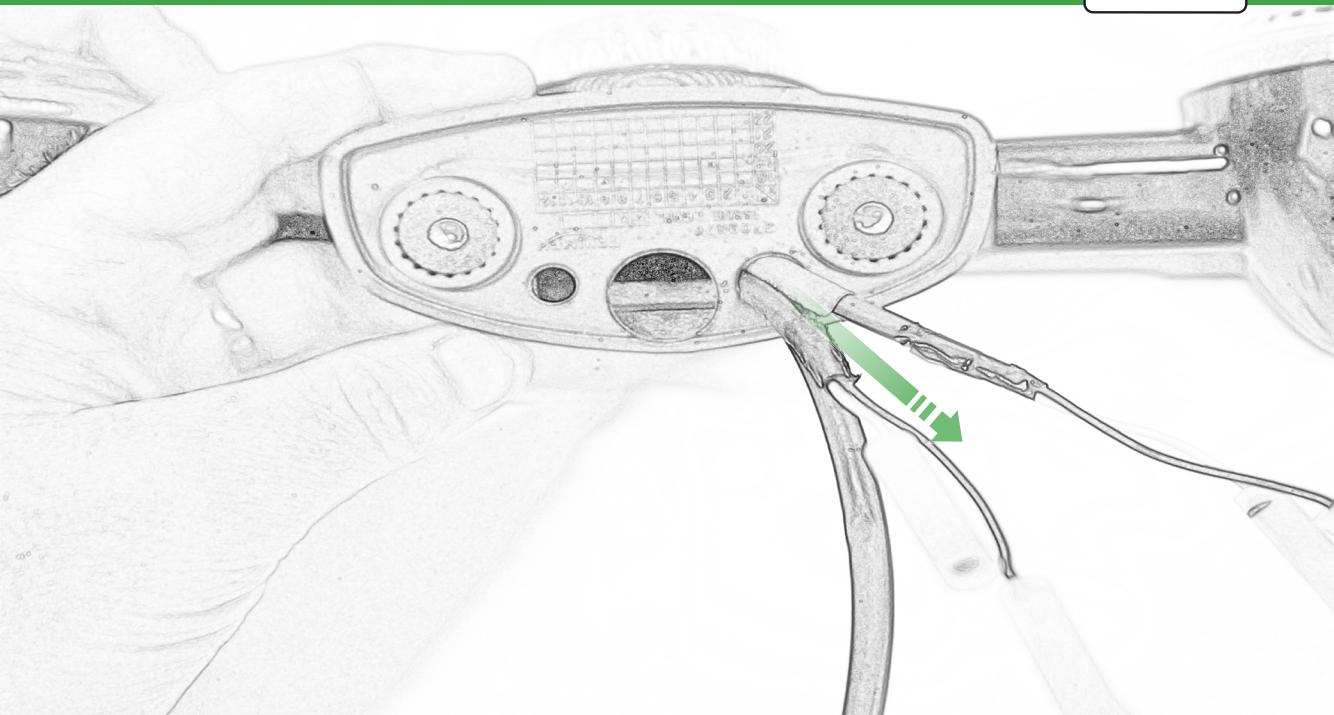

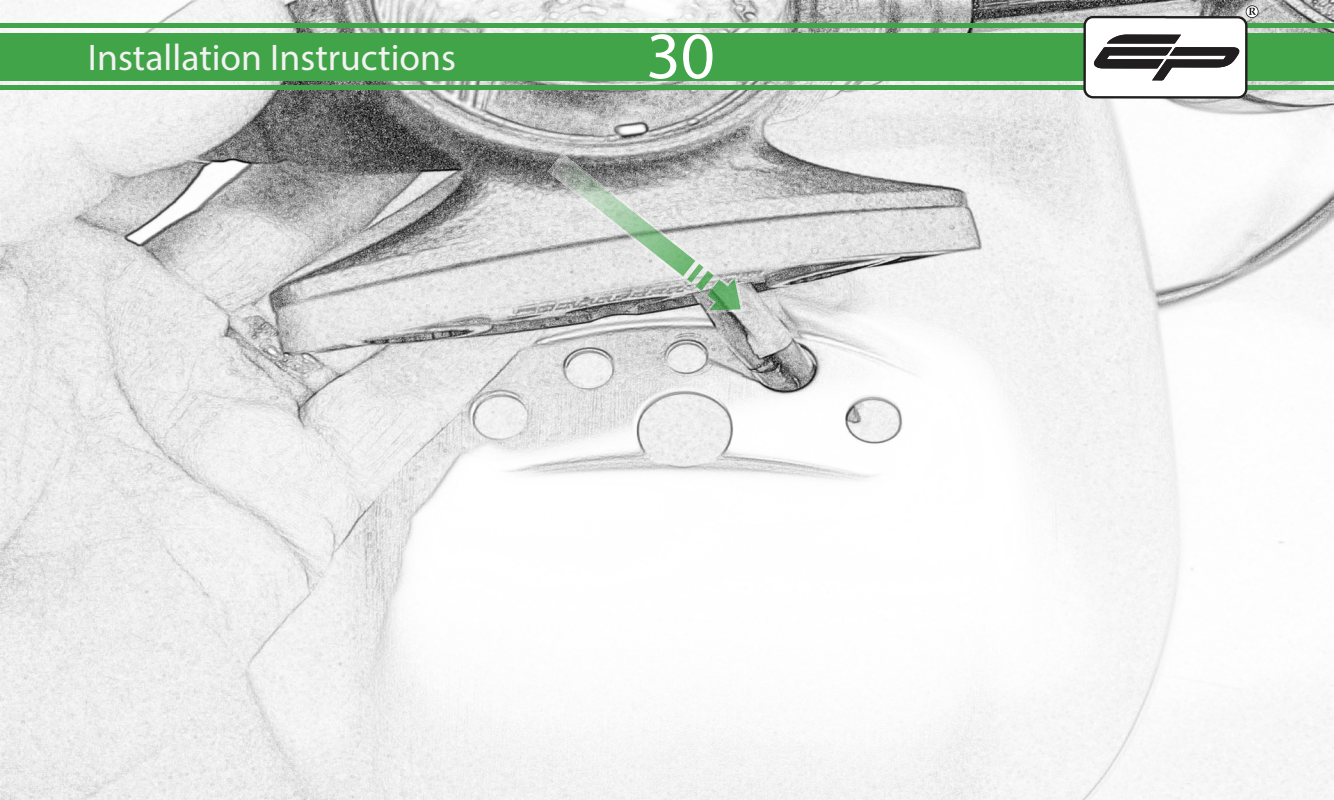



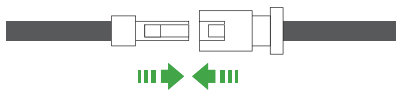

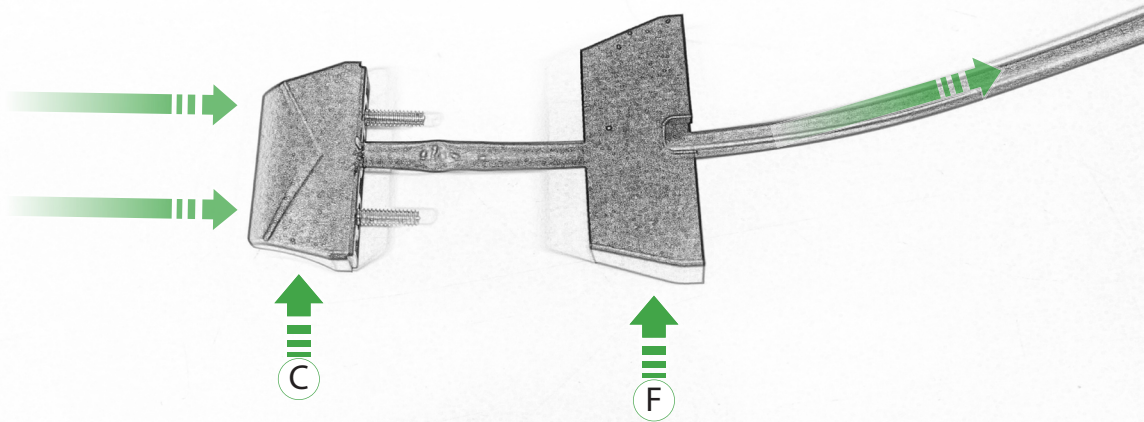

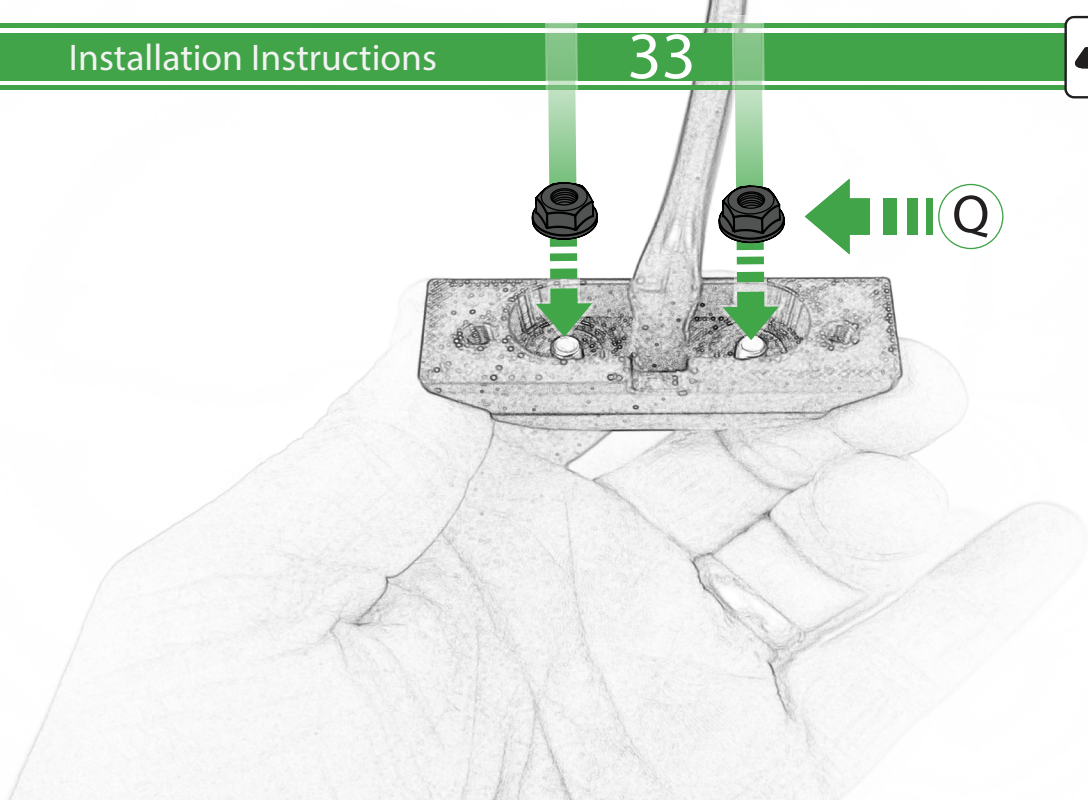

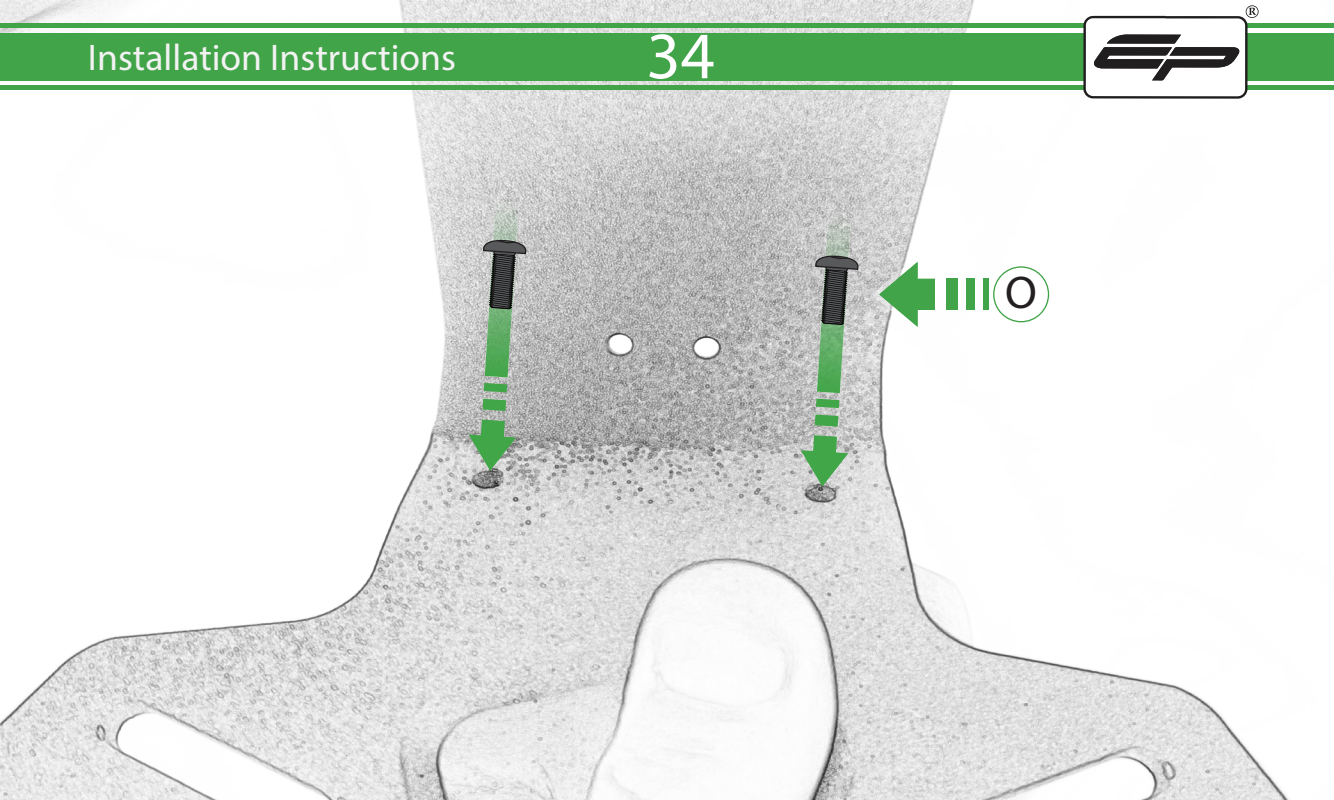

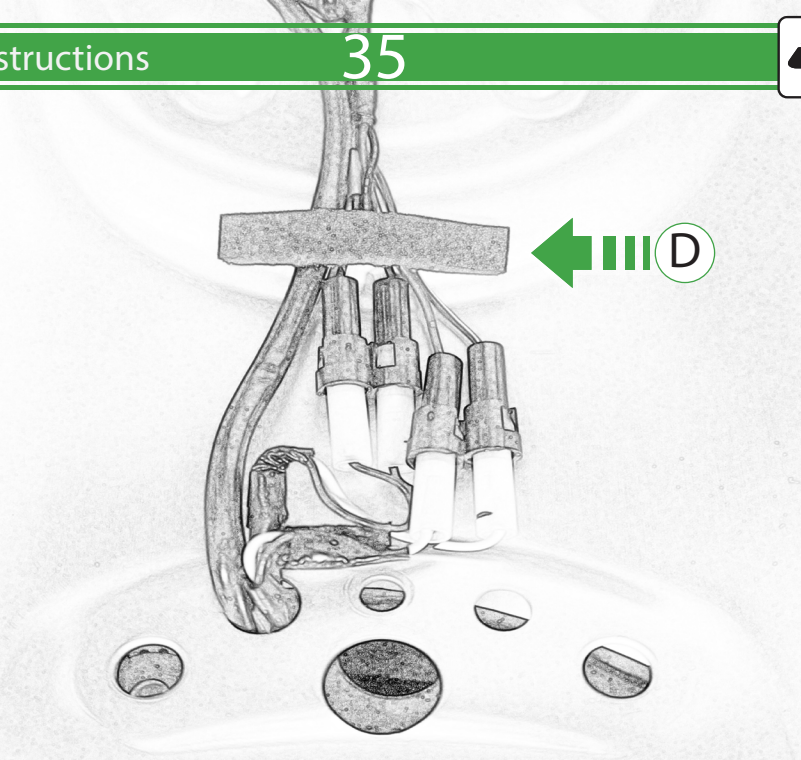

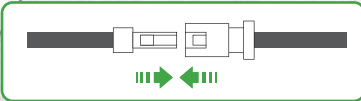
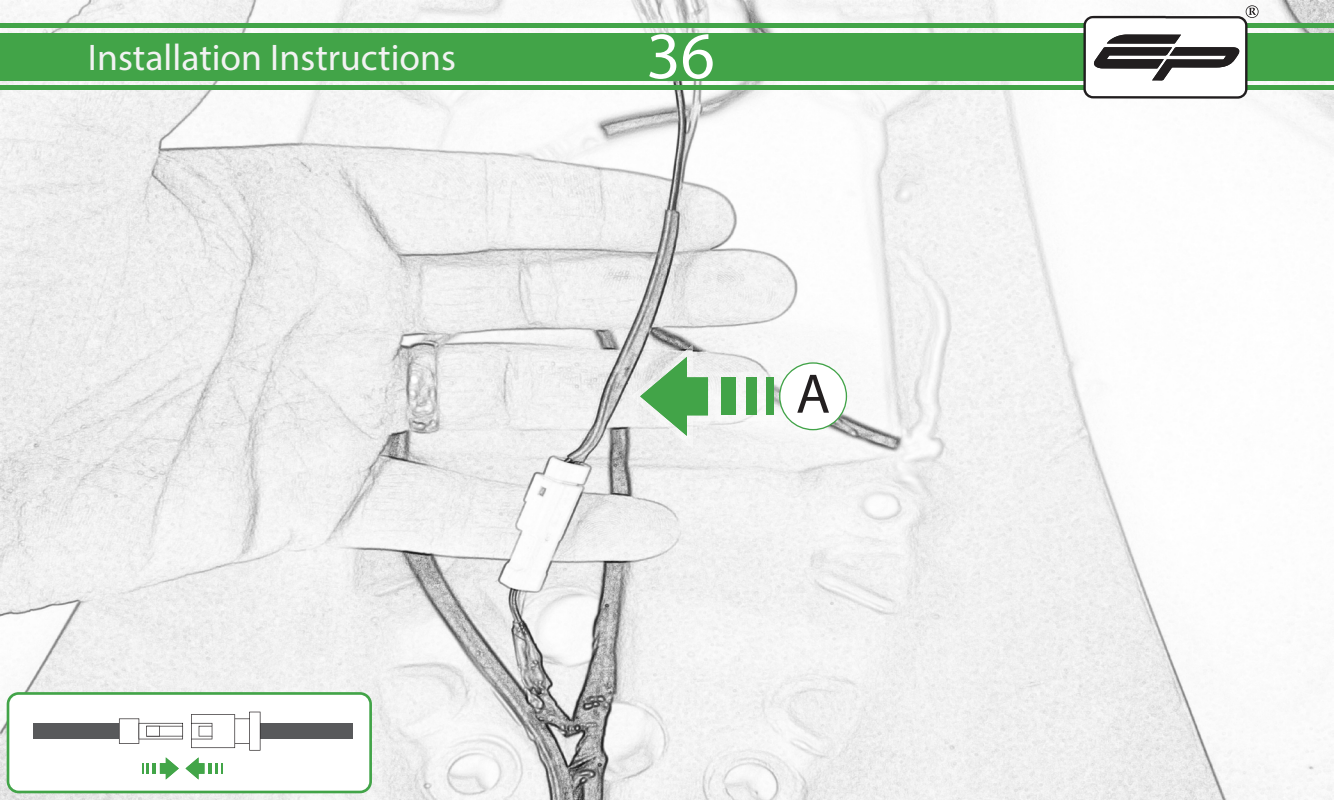

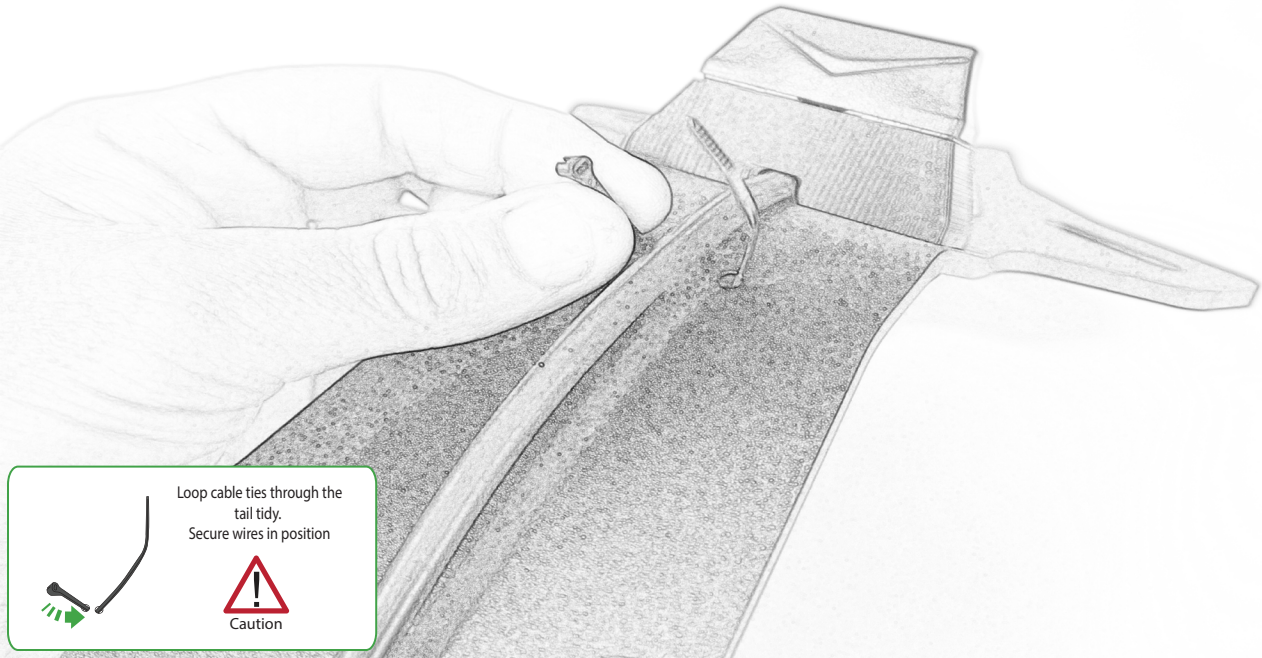

Loop cable ties through the tail tidy. Secure wires in position



Caution

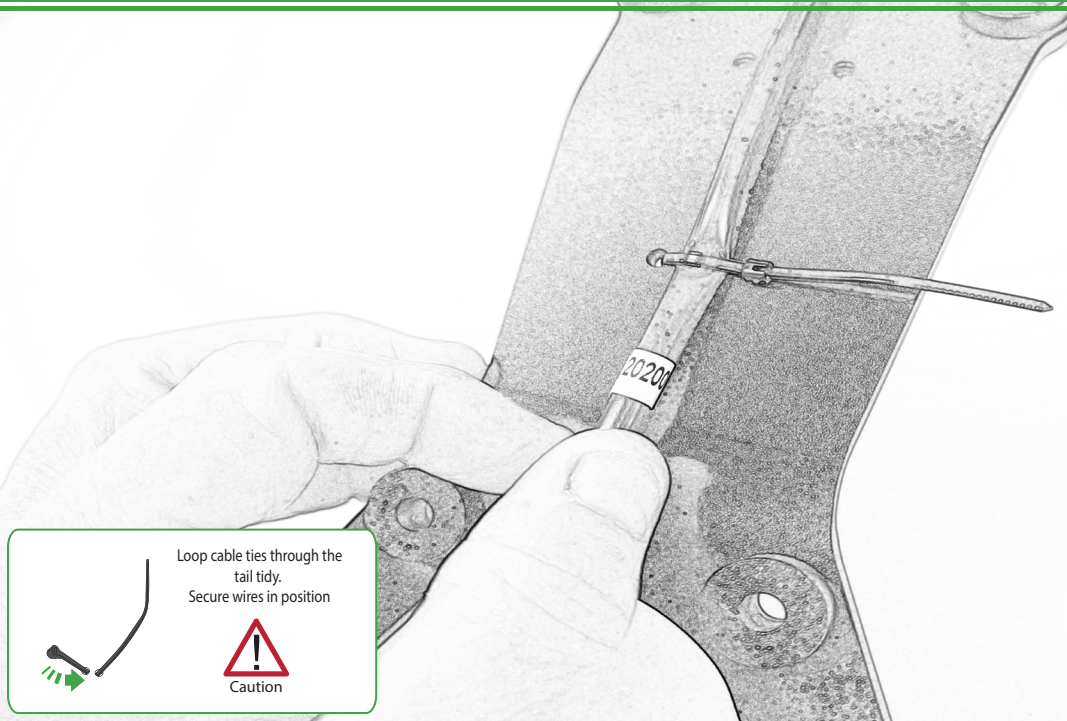

Loop cable ties through the tail tidy. Secure wires in position



Caution



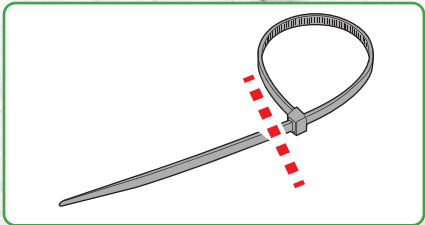
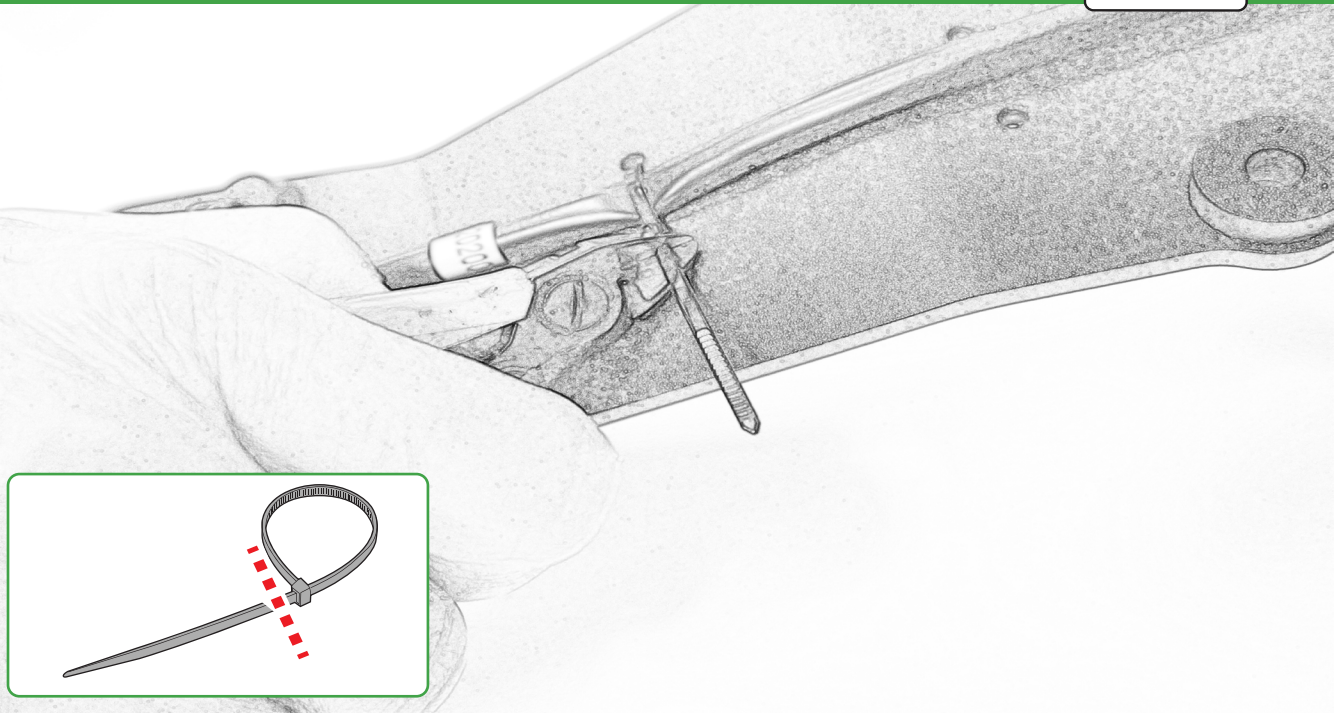

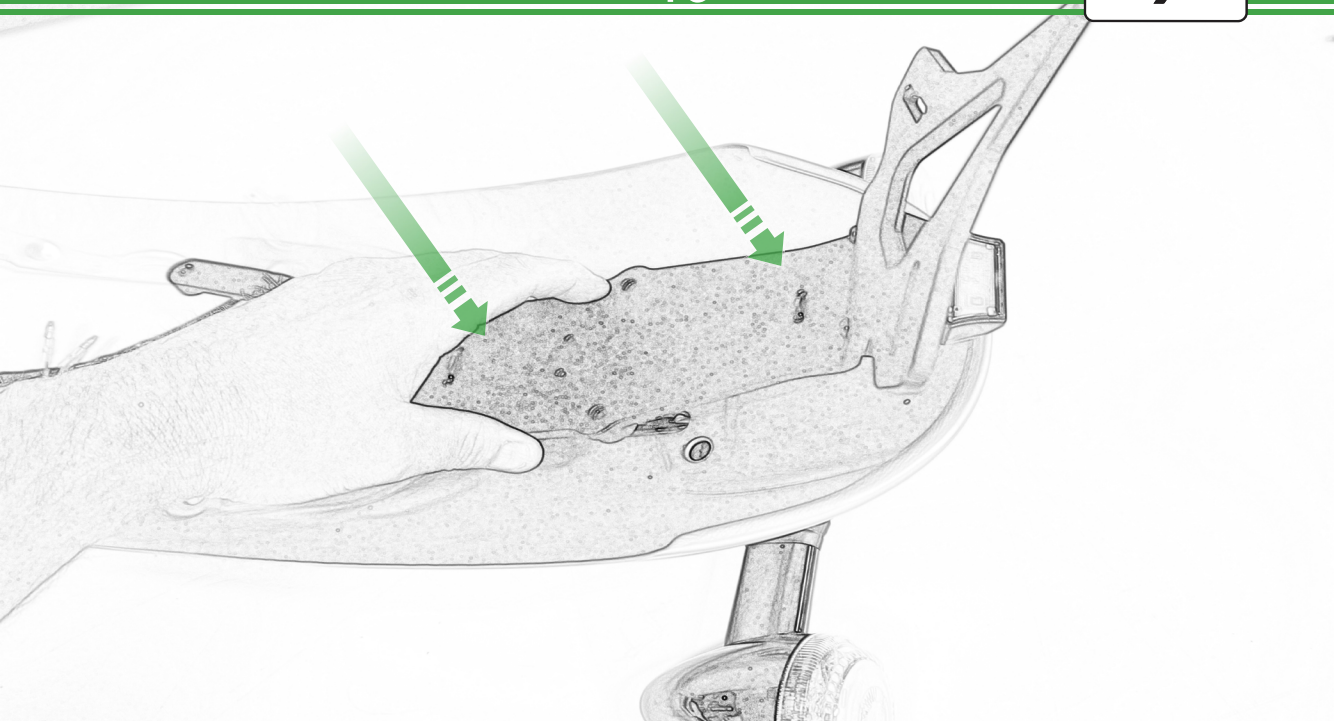



Caution

Run wires neatly down the channel in both parts ensuring they do not get trapped or squashed

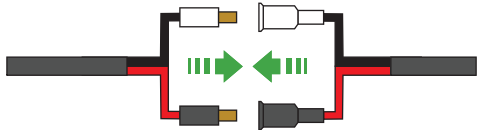
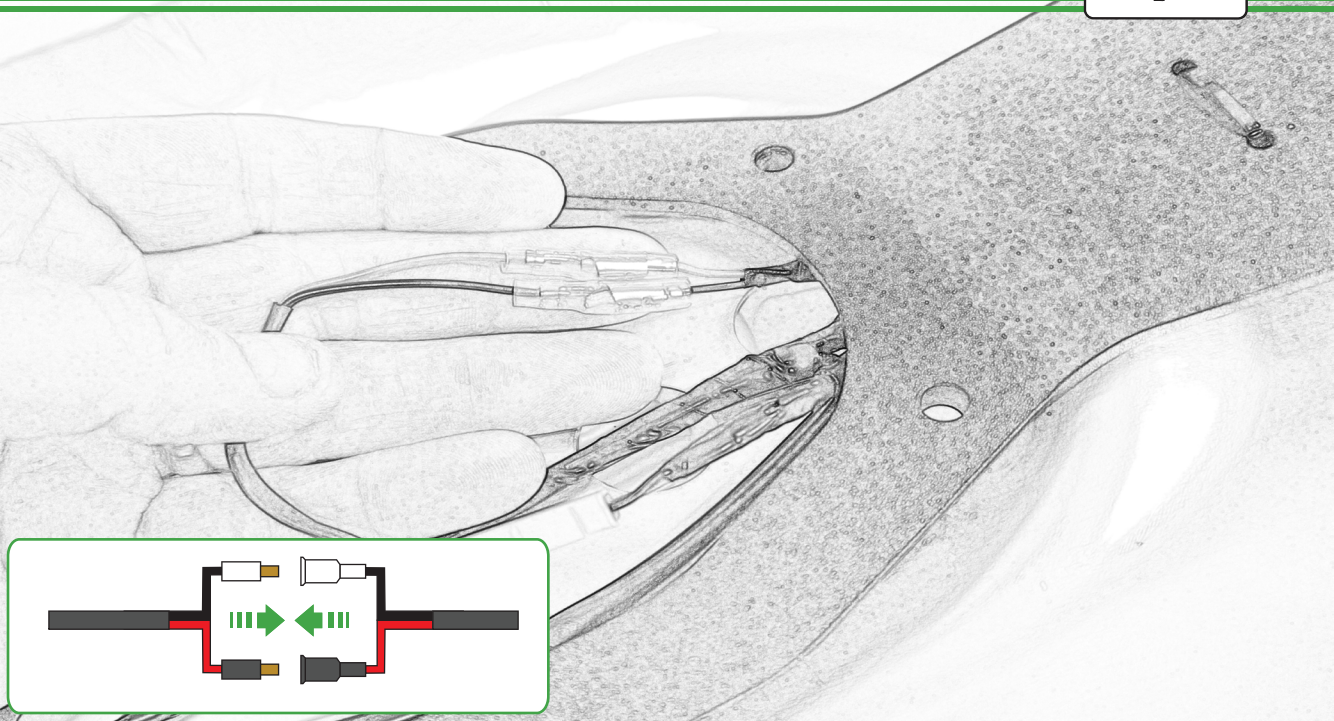

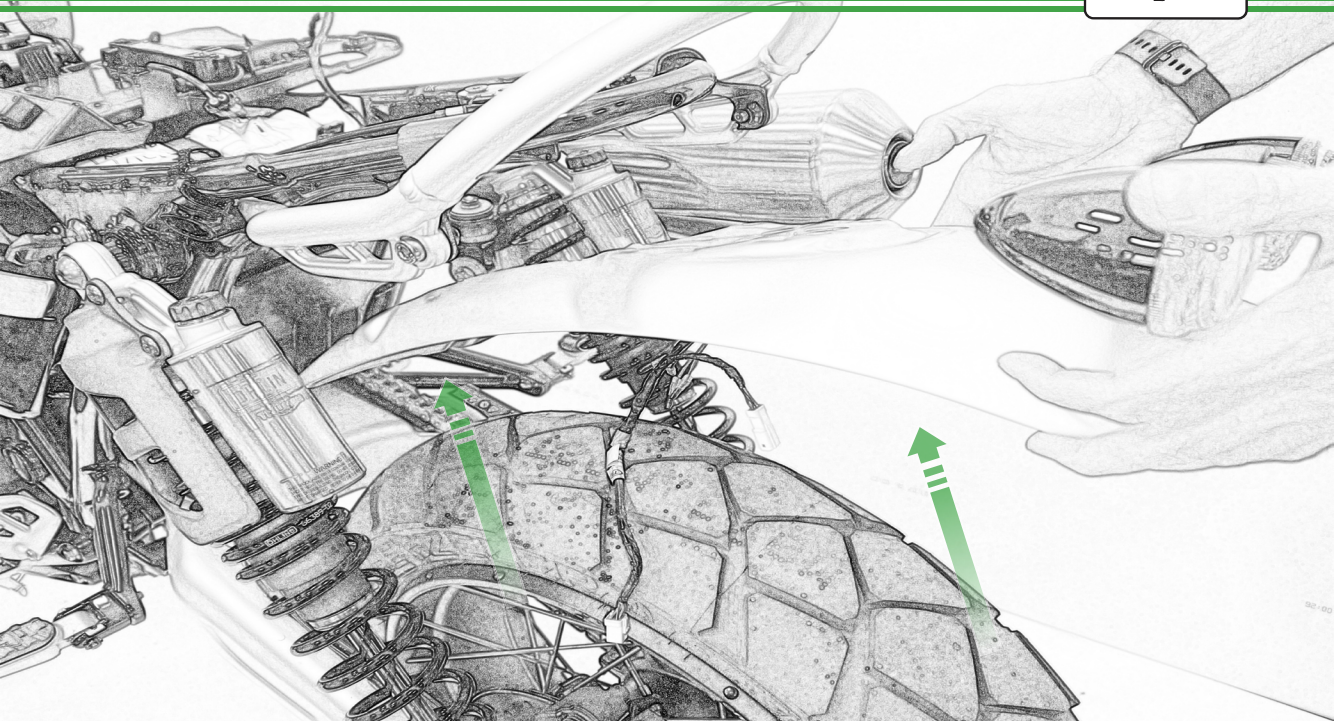

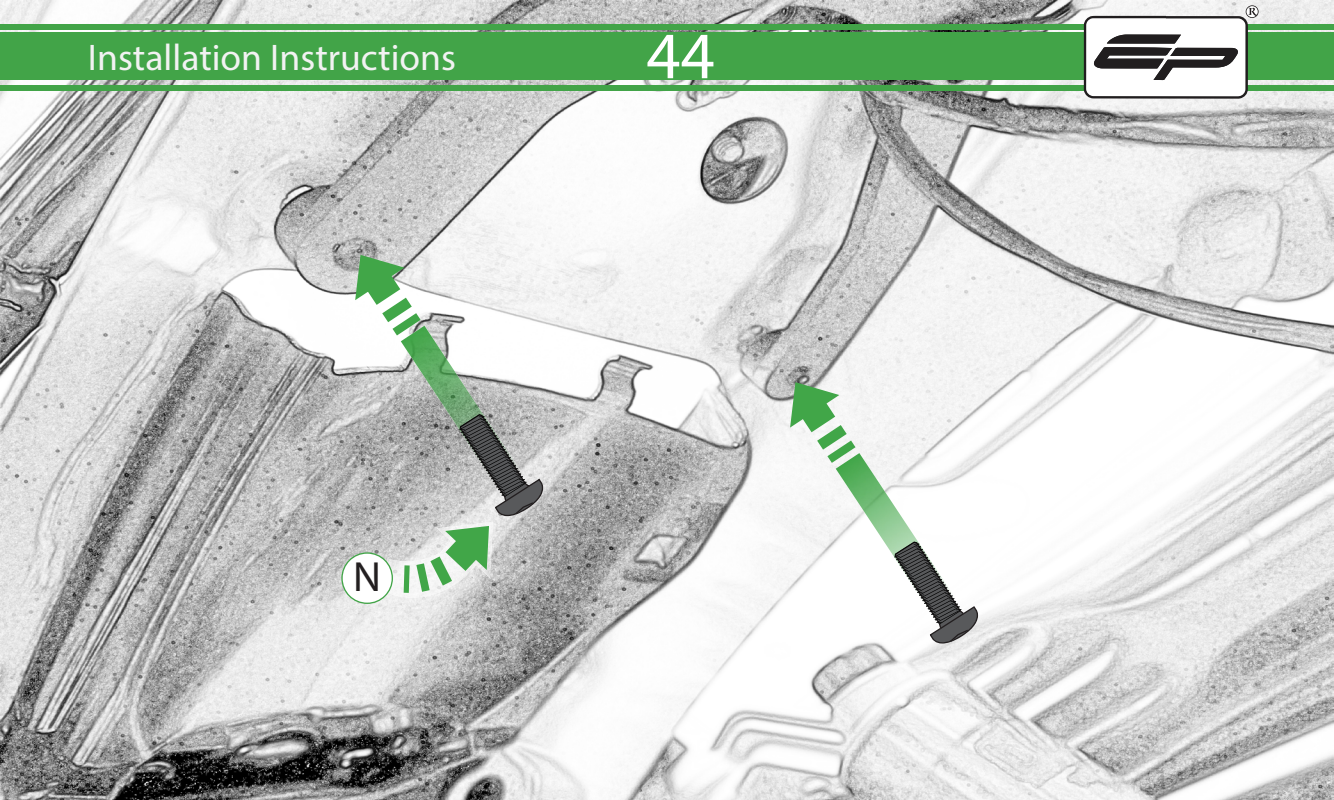

N

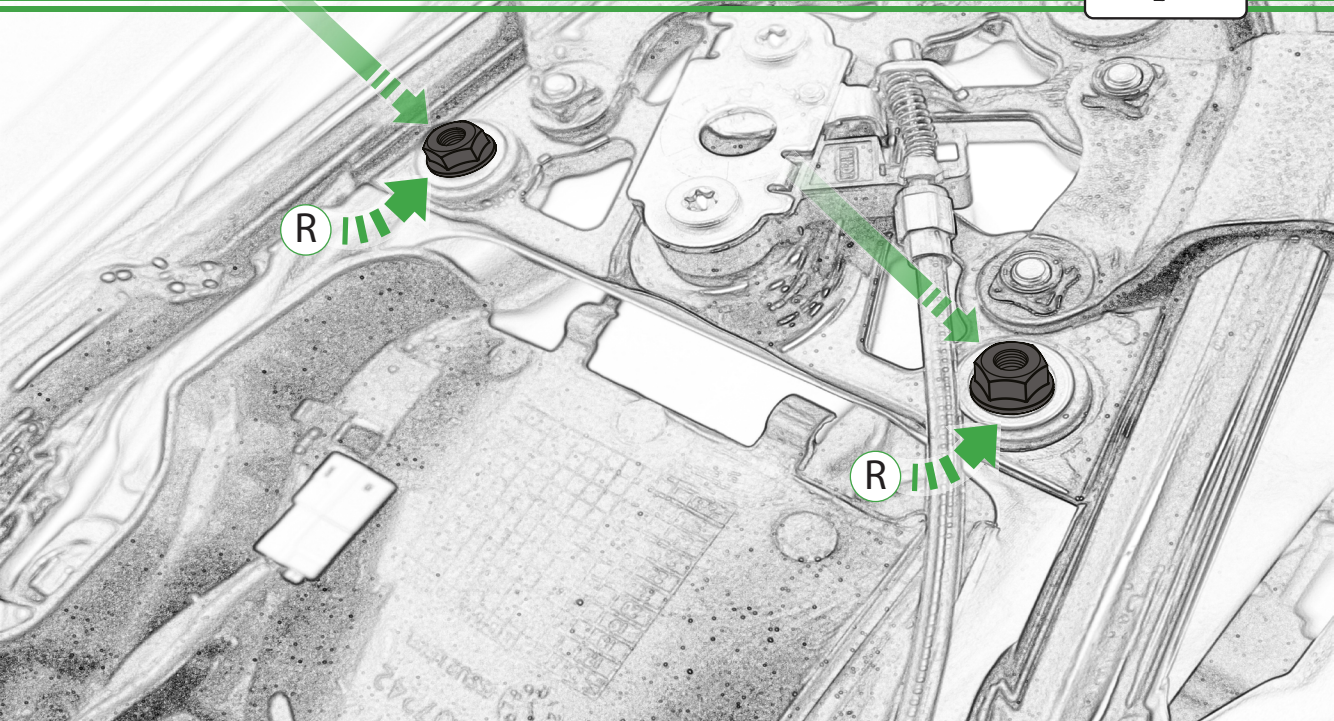





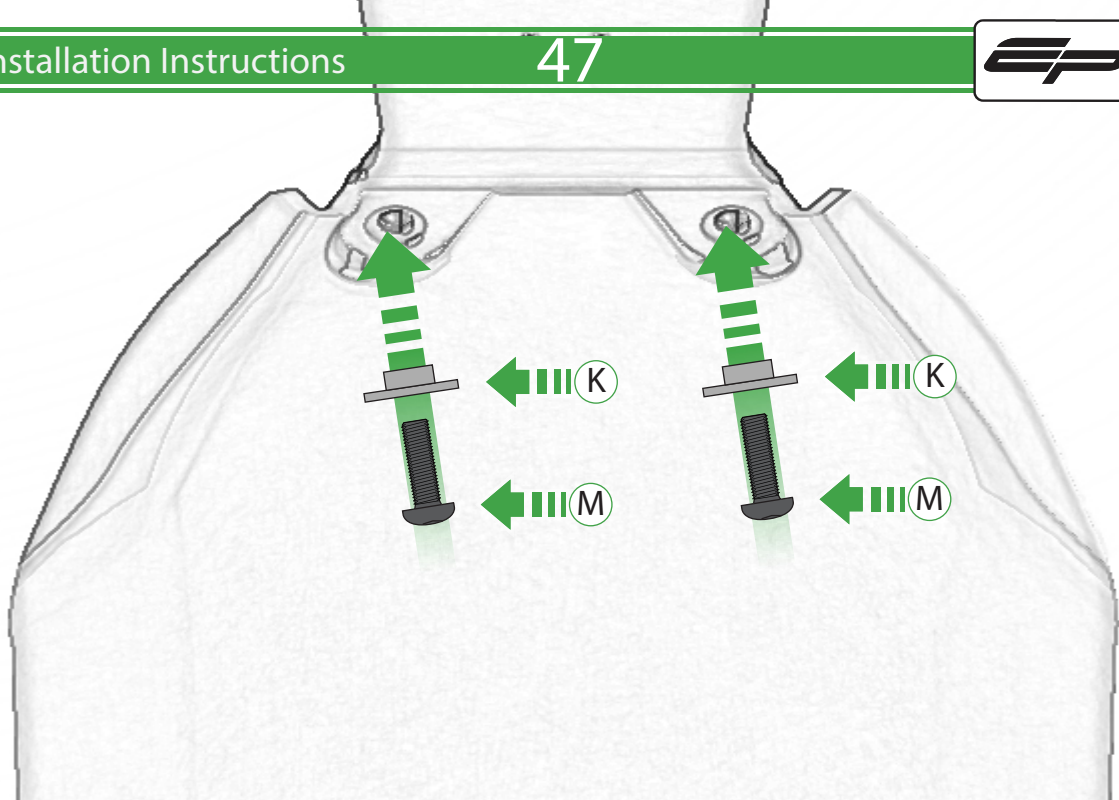

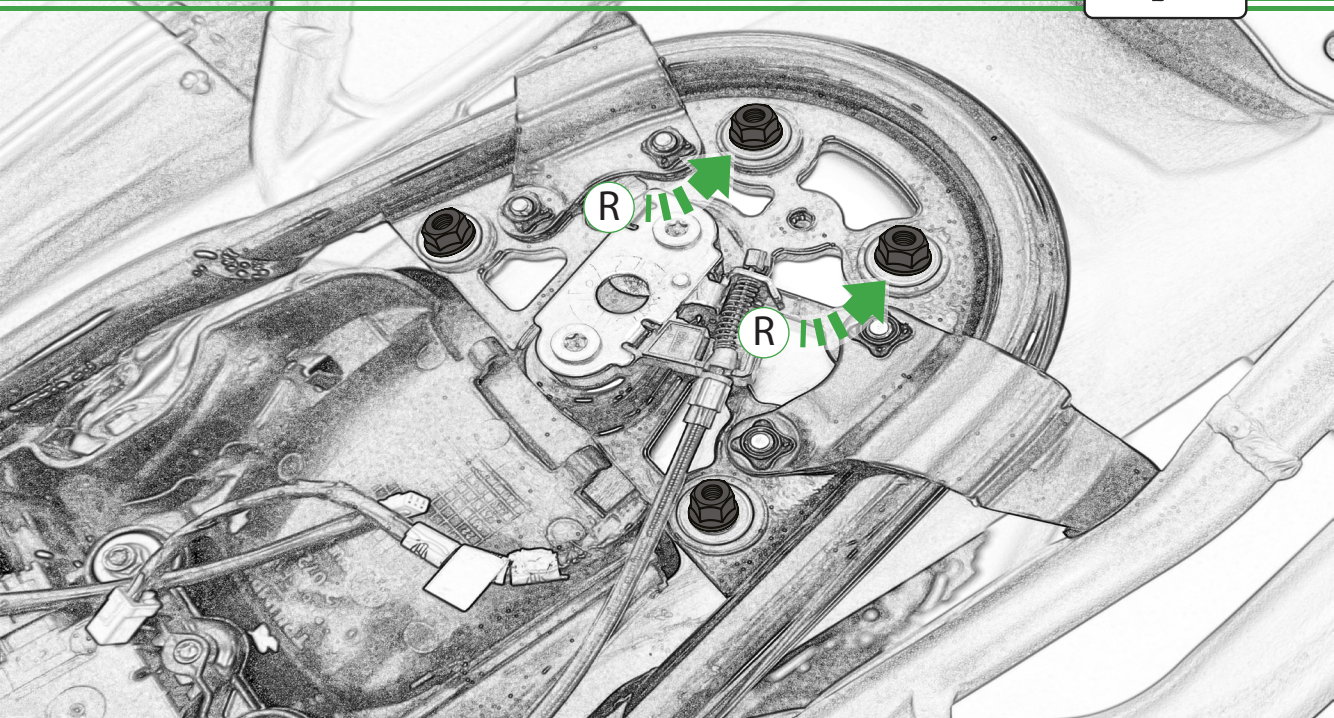

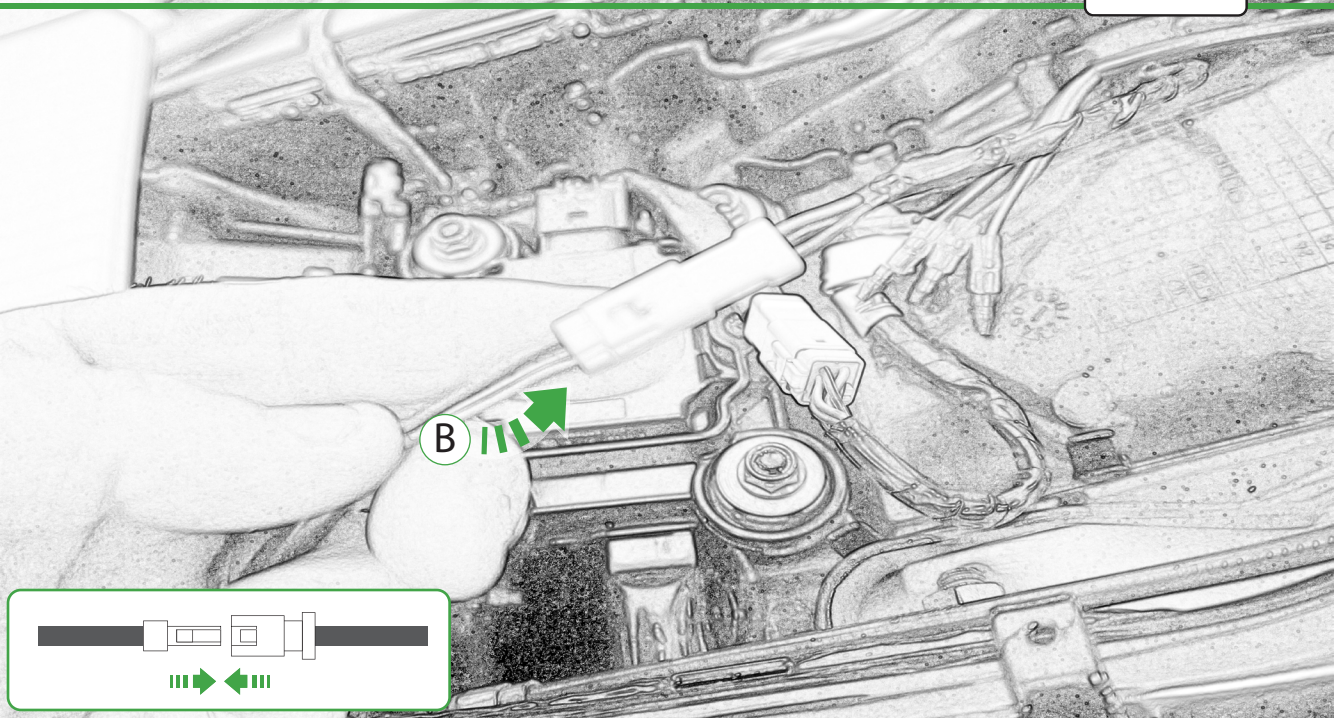

B

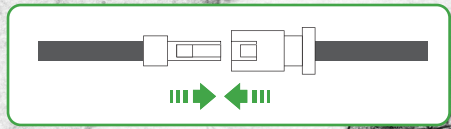

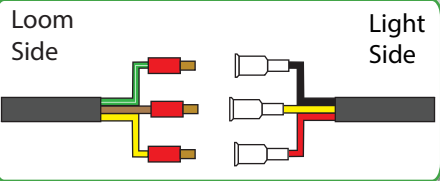
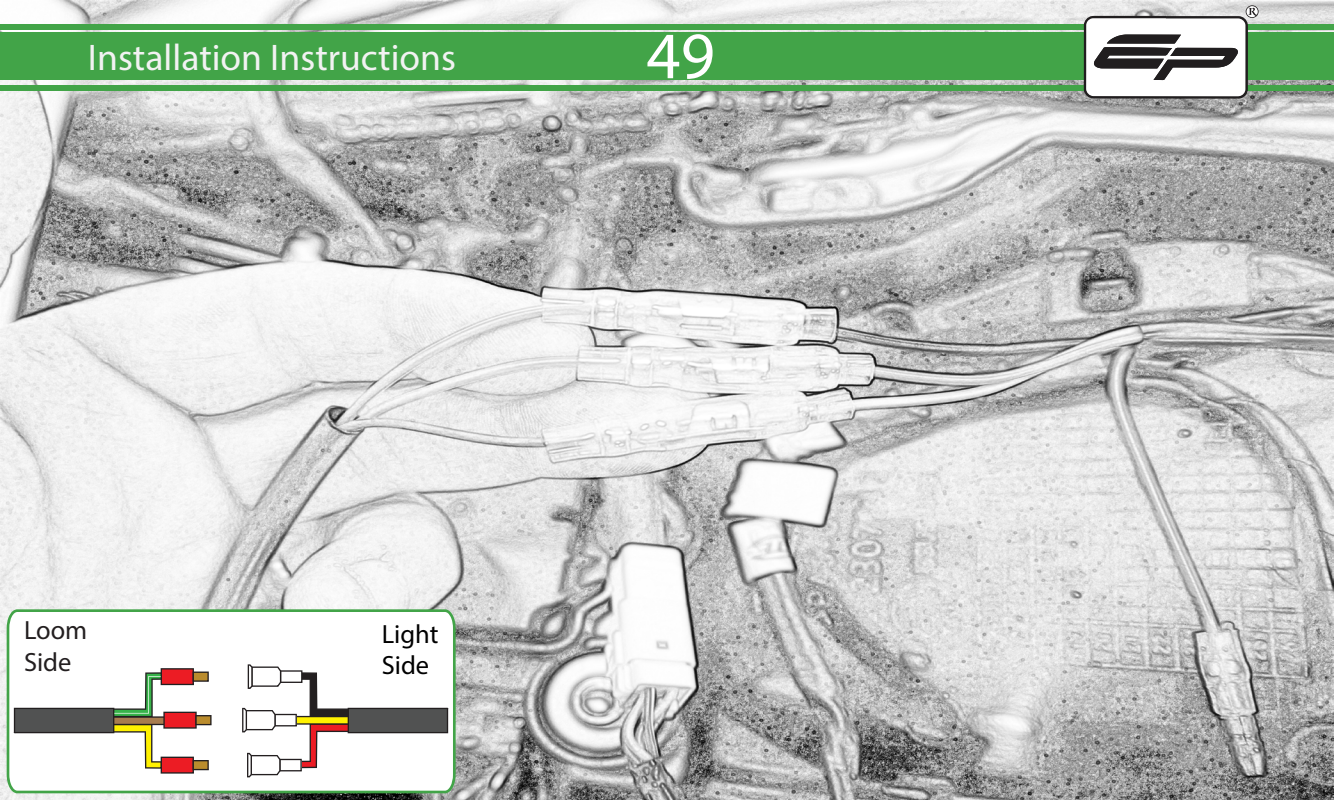

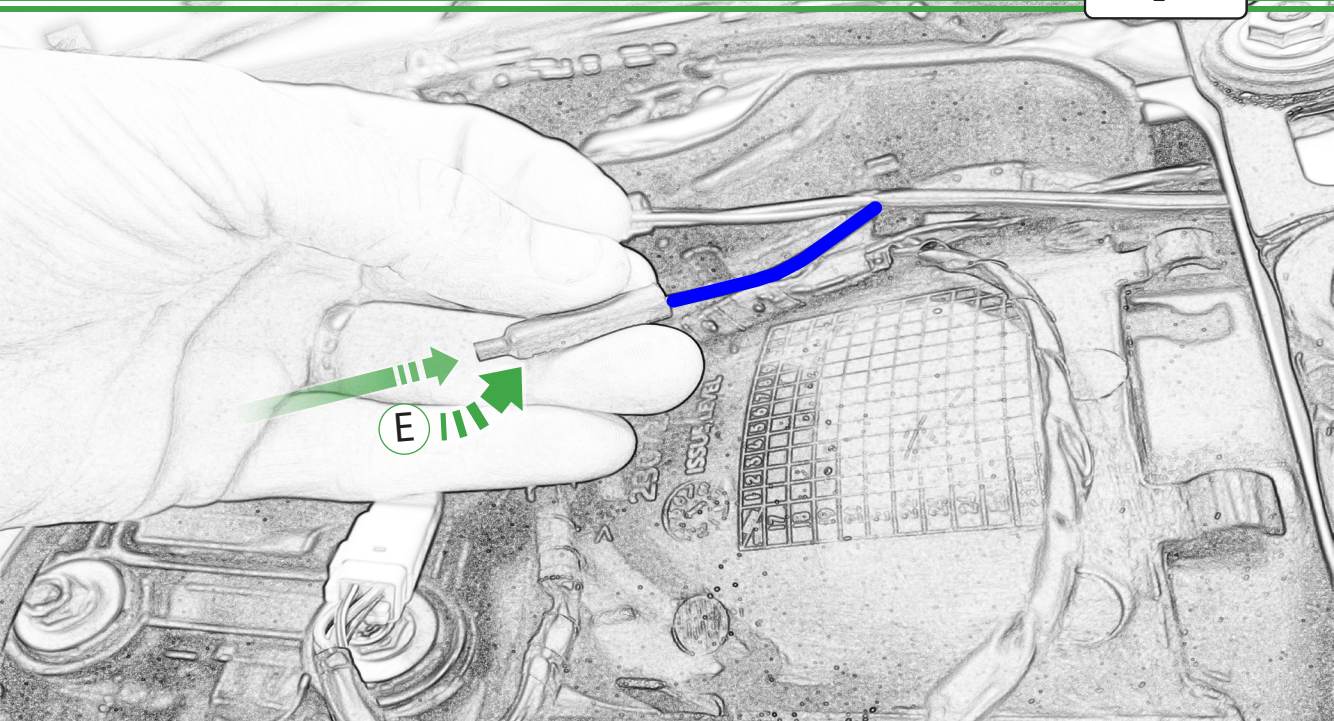

E

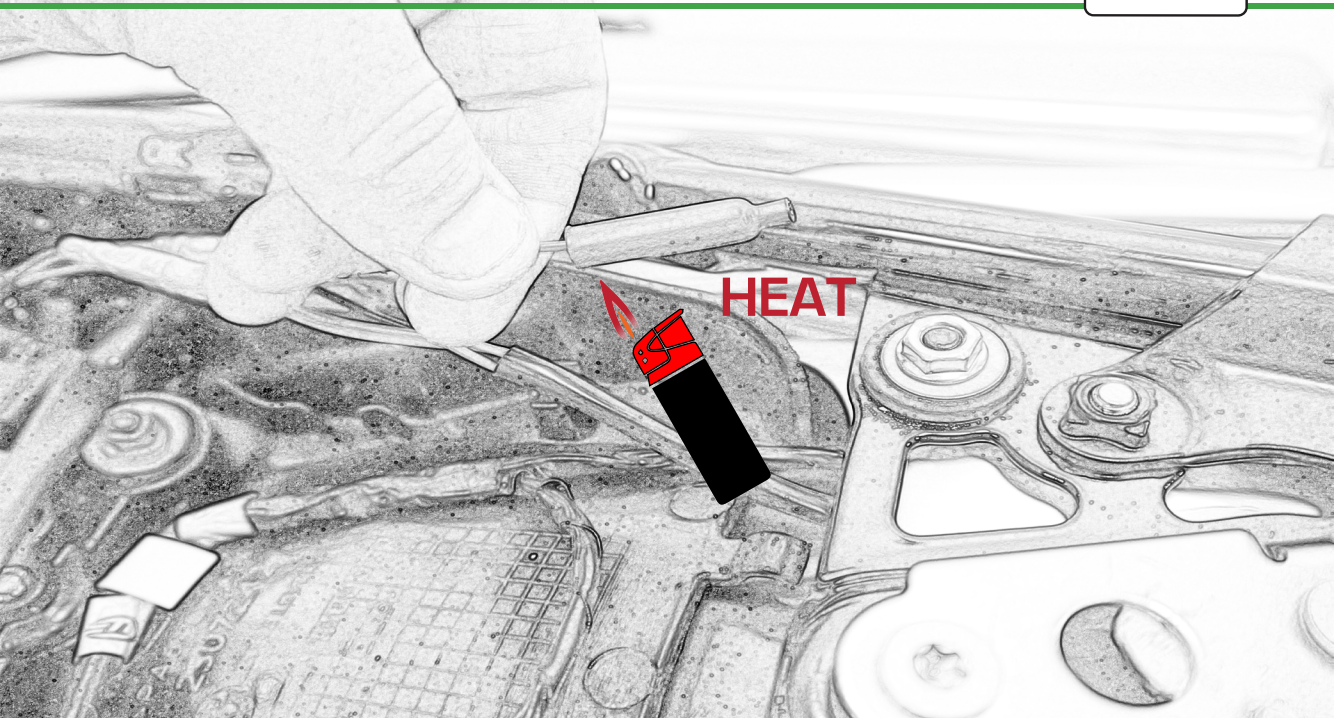

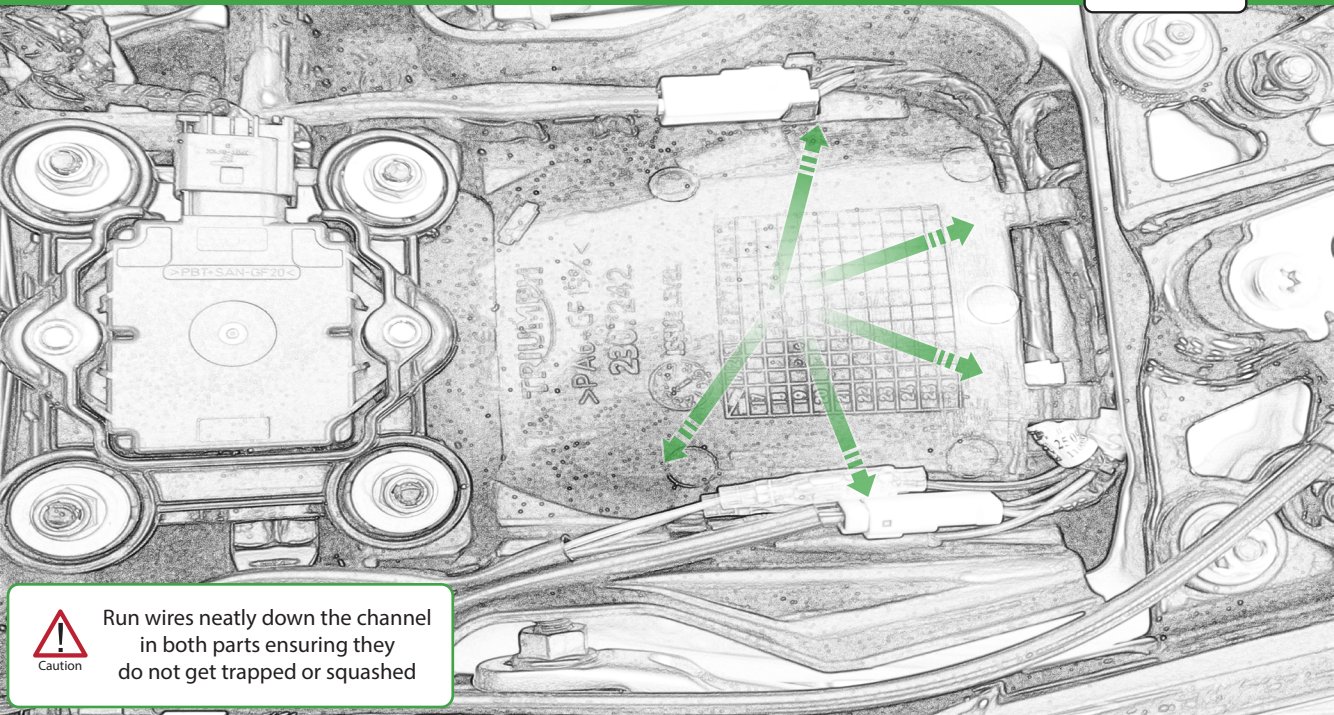

Caution

Run wires neatly down the channel in both parts ensuring they do not get trapped or squashed

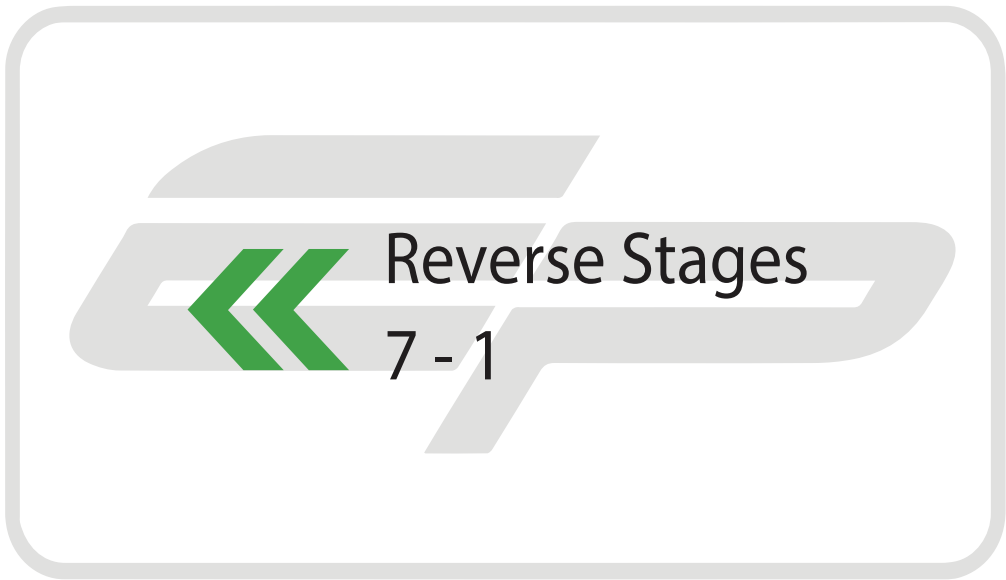





## ESSENTIAL CHECKS



After installation of your tail tidy ensure that the licence plate does not contact the rear tyre when suspension is fully compressed.

Ensure all electrics including indicators, tail light, brake light and licence plate light lights are working correctly before riding the motorcycle.

It is recommended that periodic inspections are made to ensure that all fixings are fully tightend.

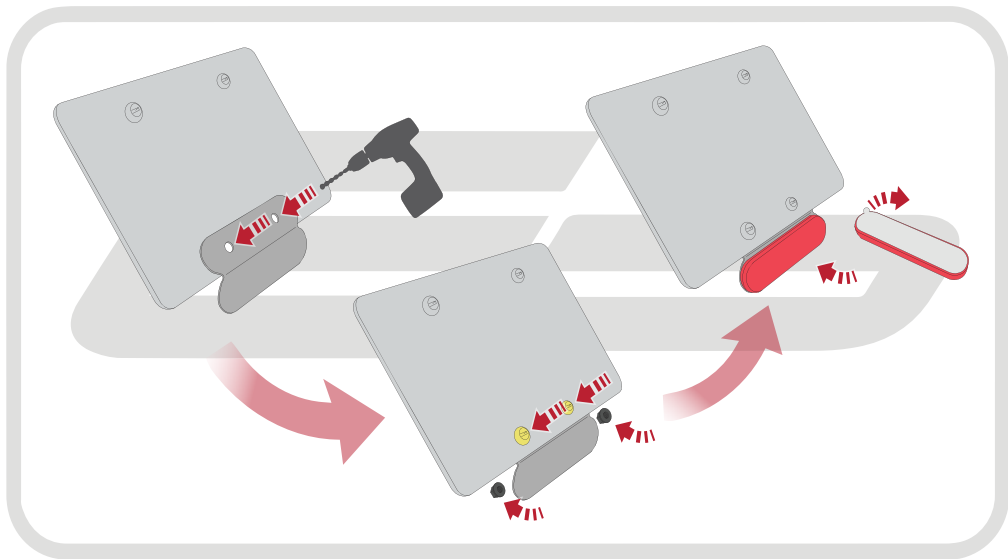

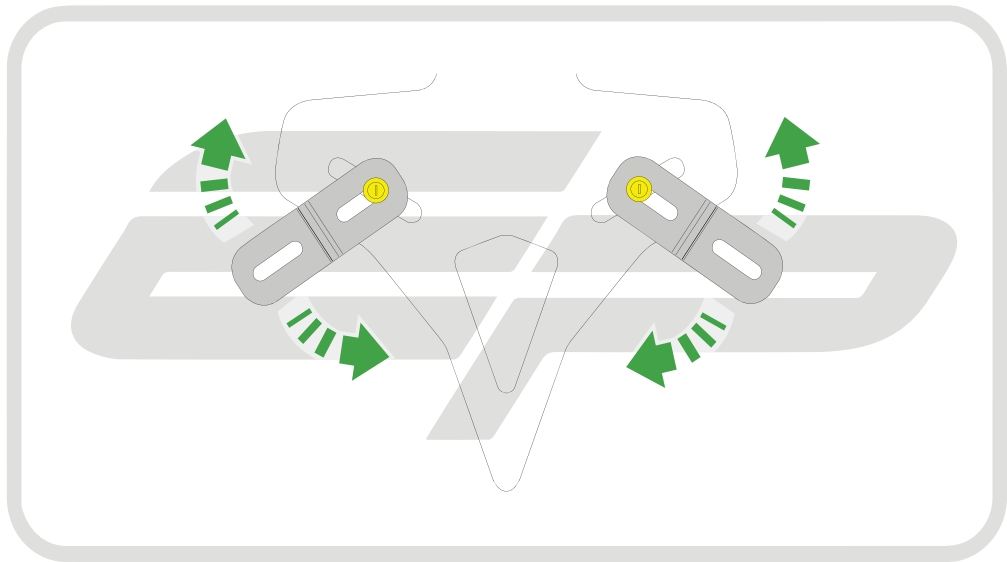



**EVOTECH**®  
P E R F O R M A N C E

[www.evotech-performance.com](http://www.evotech-performance.com)