



**EVOTECH**®  
P E R F O R M A N C E

[www.evotech-performance.com](http://www.evotech-performance.com)

Yamaha MT-09 Tail Tidy

Installation Instructions



## Kit Contents PRN015565

- (A) 1 x Loom Connector
- (B) 1 x Grommet
- (C) 2 x M5 x 16 Black Button Head Bolt
- (D) 2 x M5 x 12 Caphead Bolt
- (E) 2 x M4 x 8 Black Button Head Bolts
- (F) 2 x M5 x 12 Countersunk Screws
- (G) 2 x M5 x 12 Black Button Head Bolt
- (H) 2 x M5 x 8 Black Button Head Bolt
- (I) 2 x Indicator Plate
- (J) 2 x M4 Flange Nuts
- (K) 4 x M6 x 25 Black Button Head Bolt
- (L) 4 x Indicator Cups
- (M) 4 x M6 Flange Nut

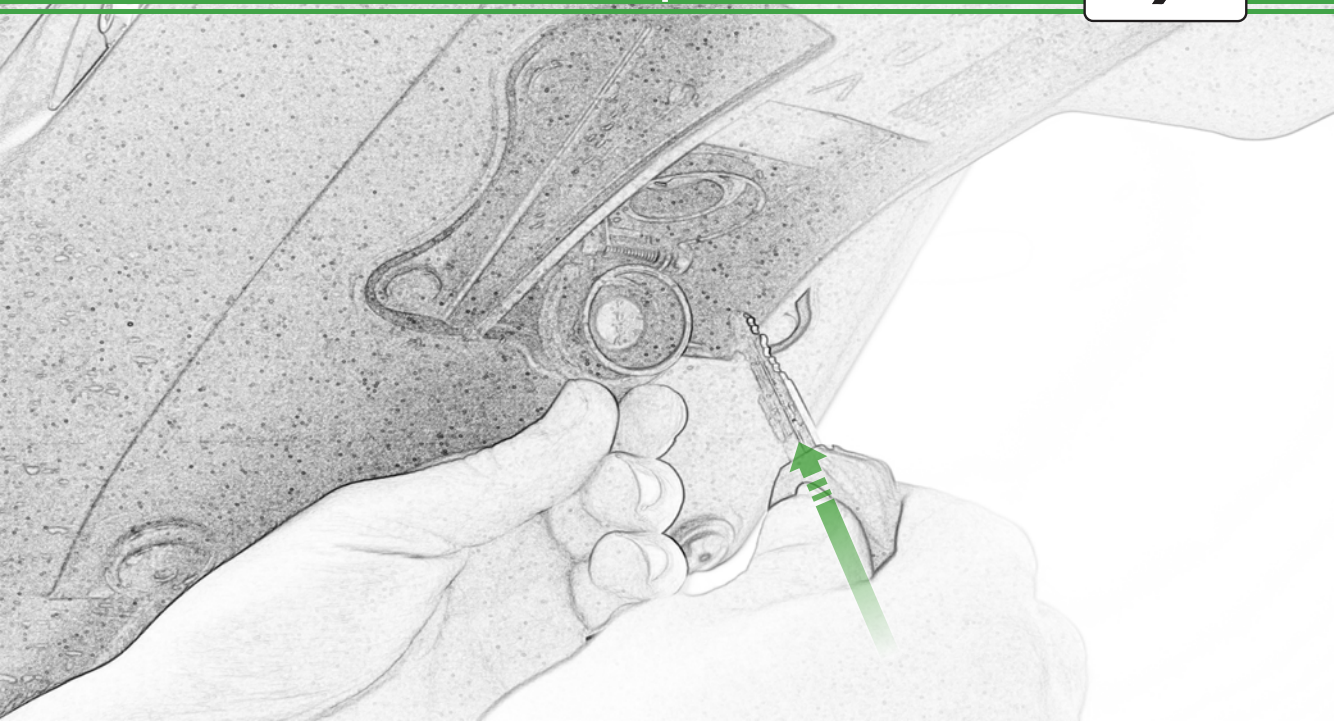

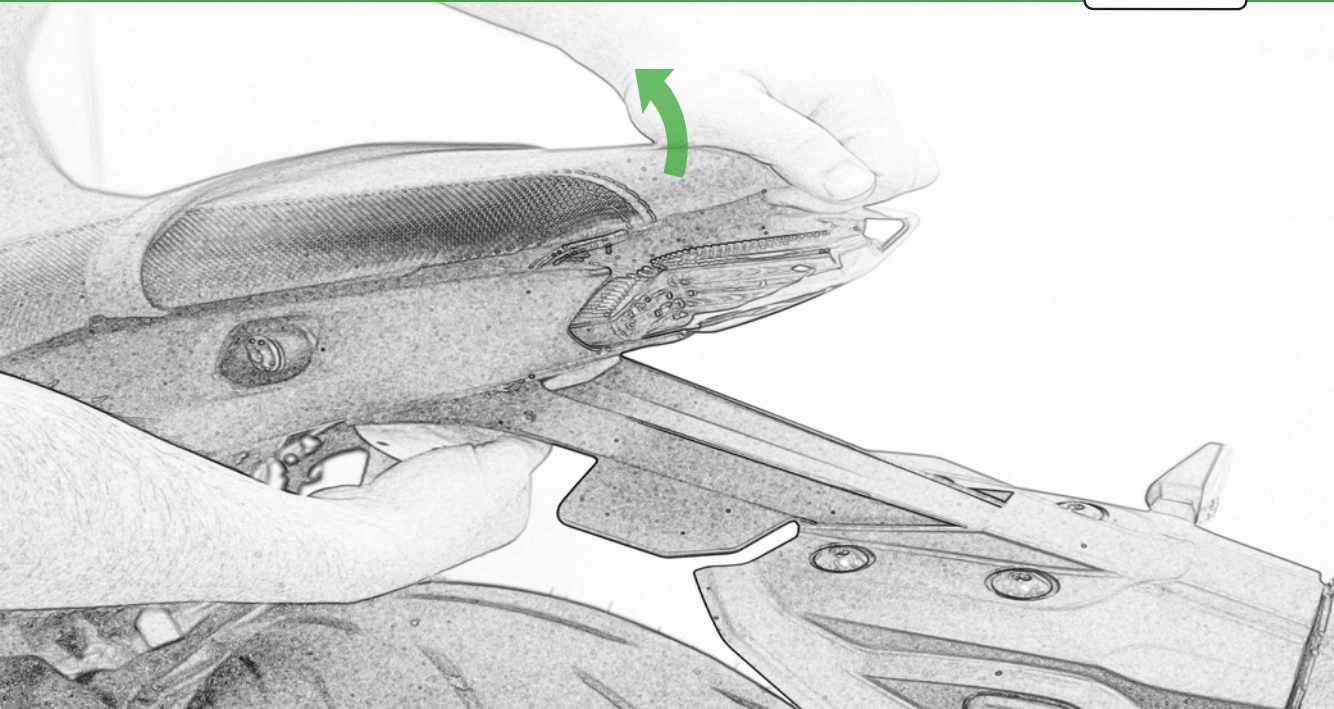

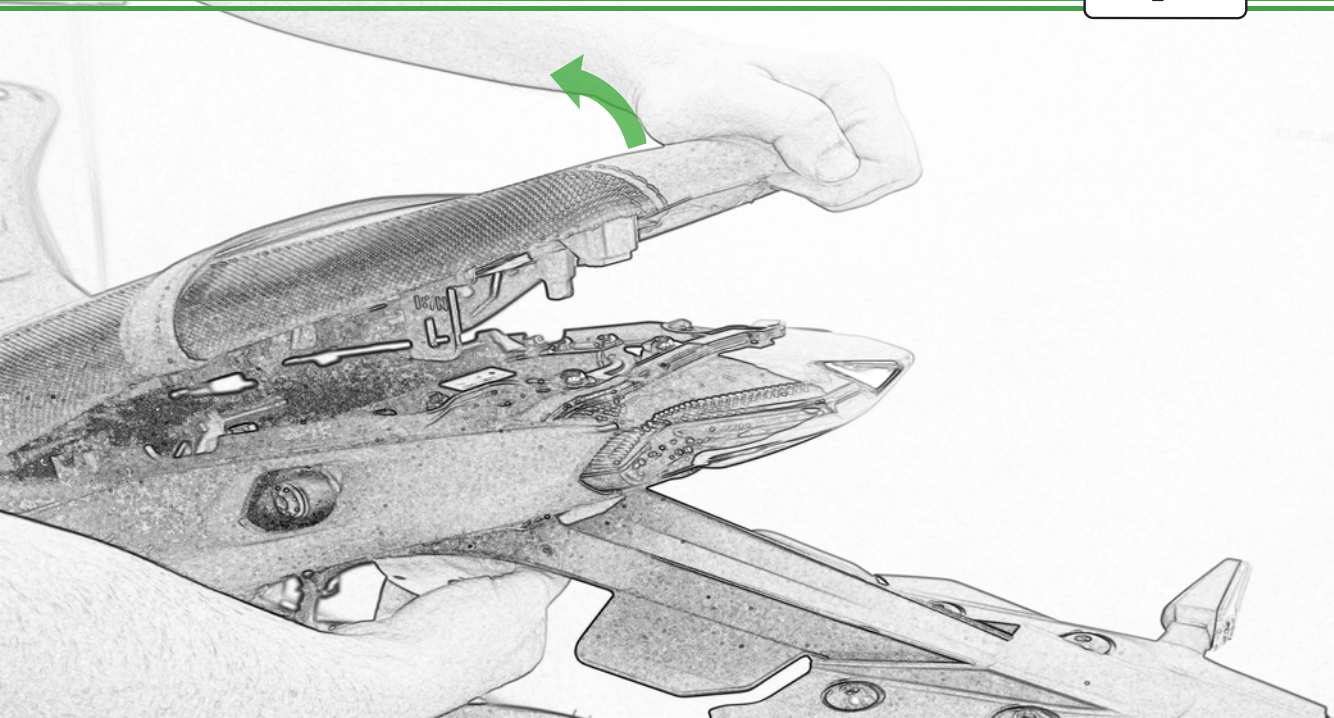

# Installation Instructions

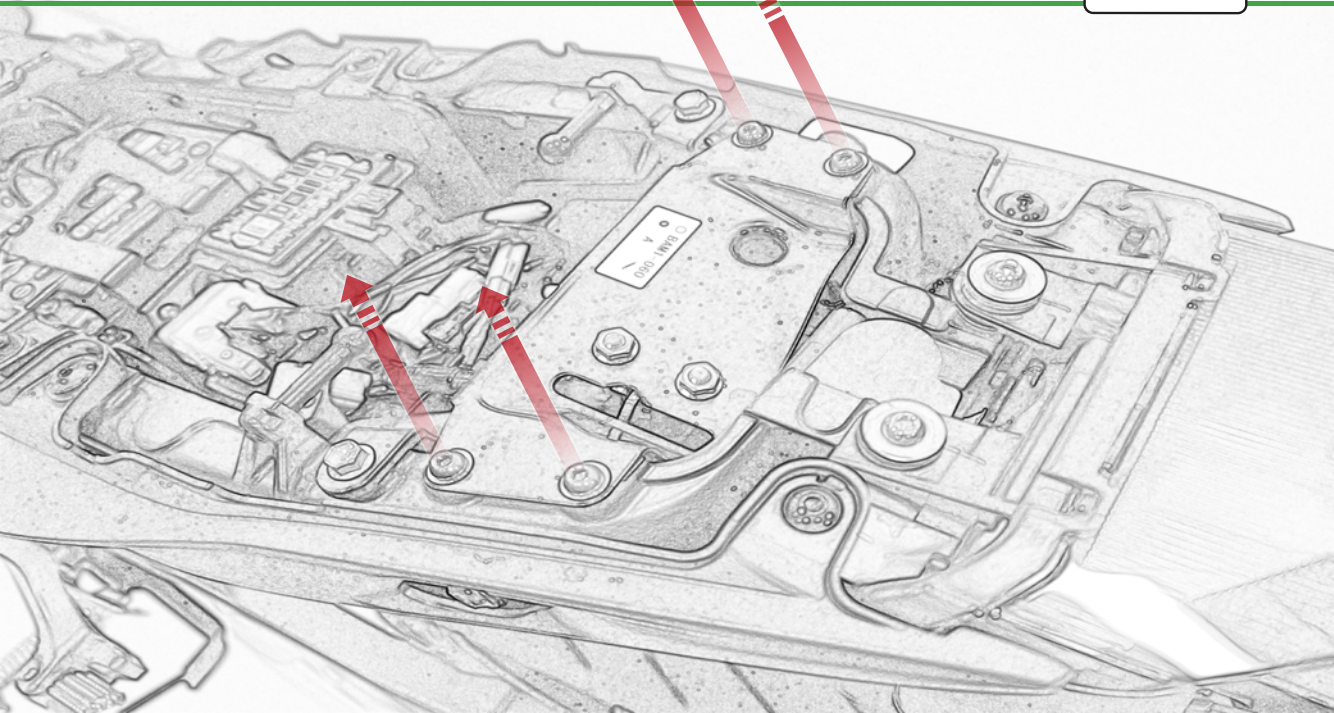

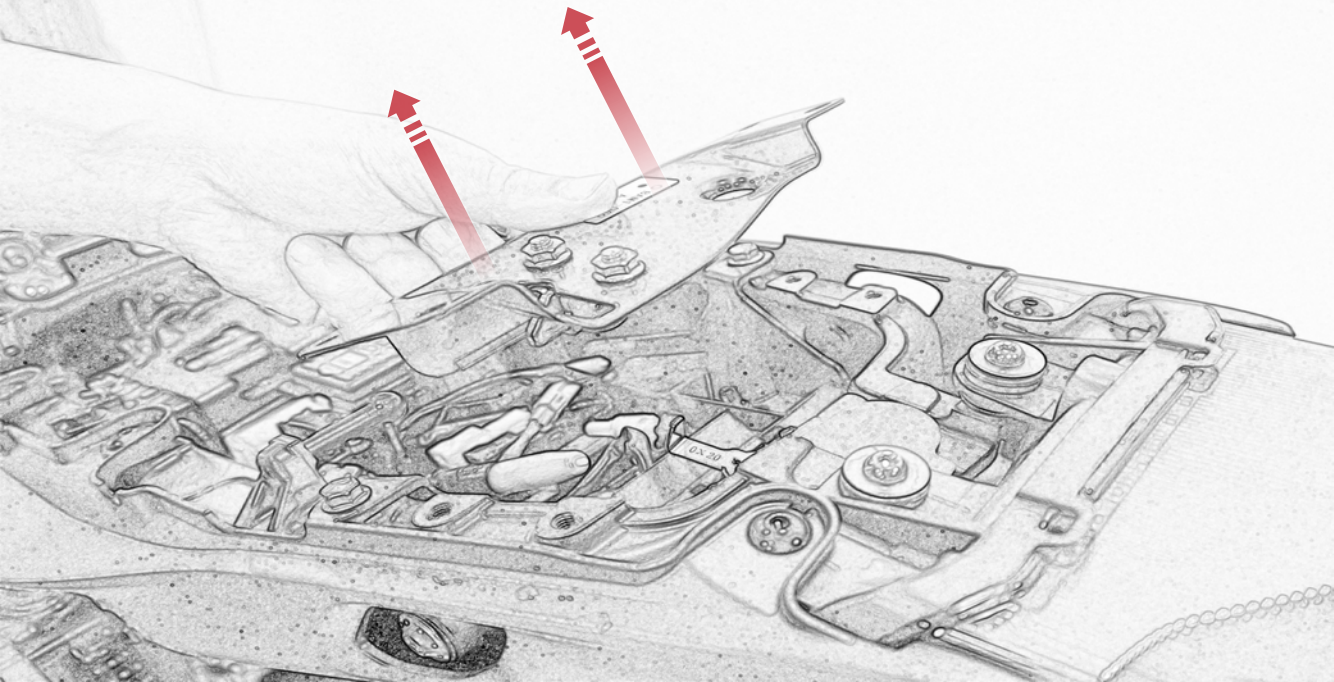

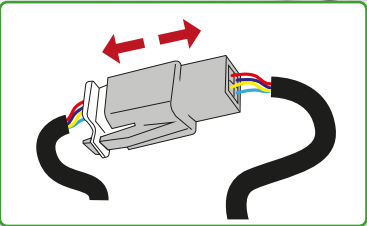
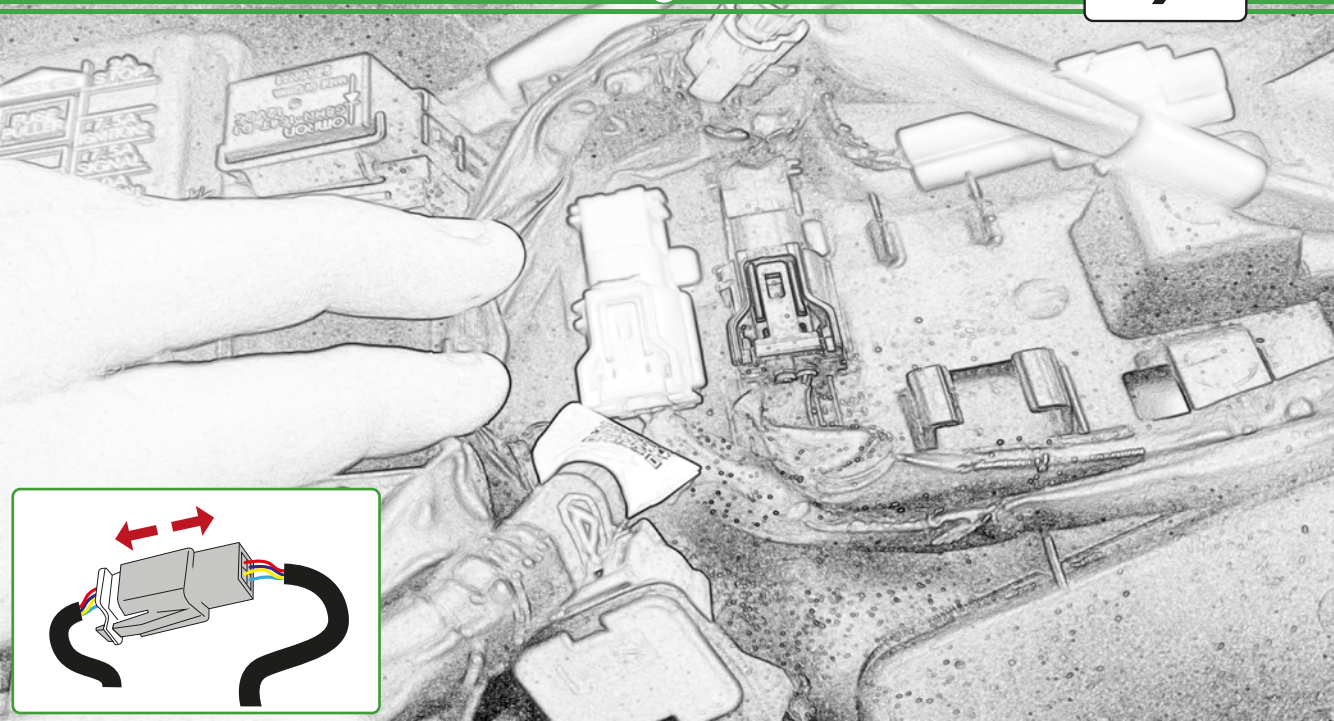



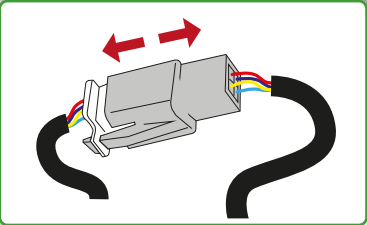





RELEASE



RE-SET



RE-FIT





**RELEASE**  
➡

**RE-SET**  
←

**RE-FIT**  
➡

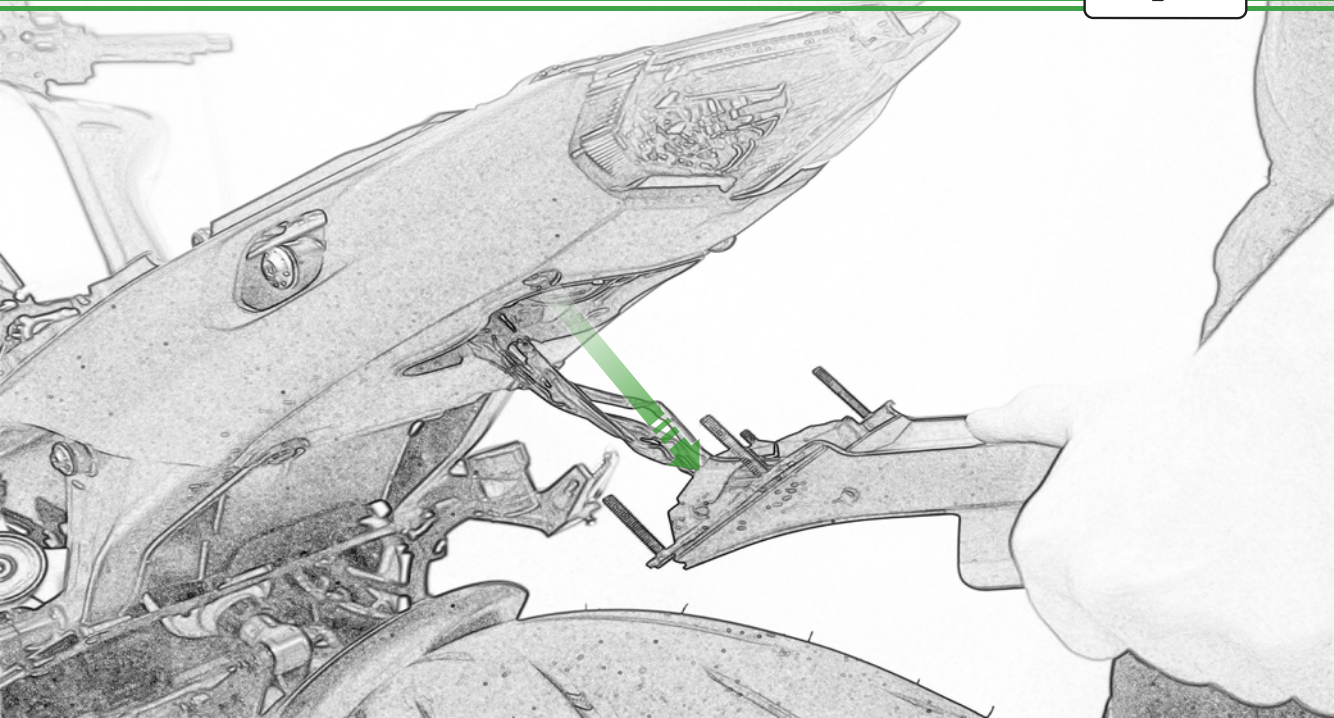

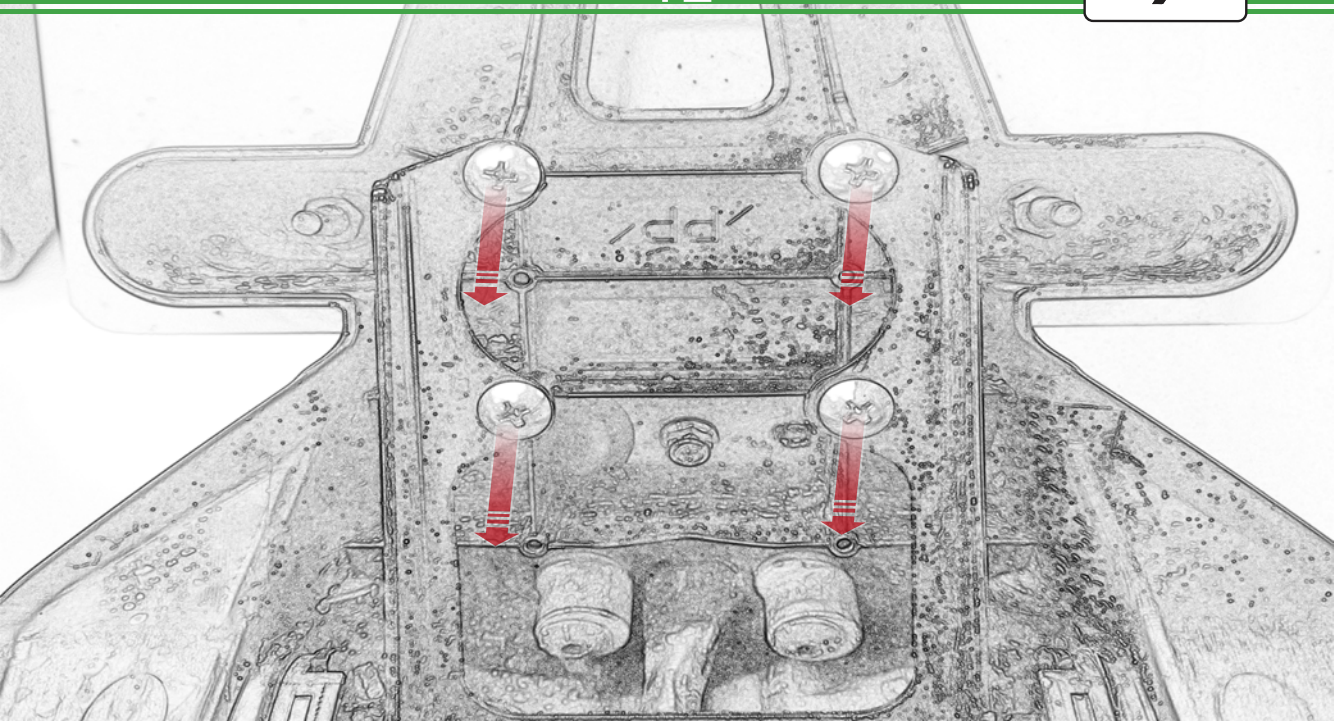

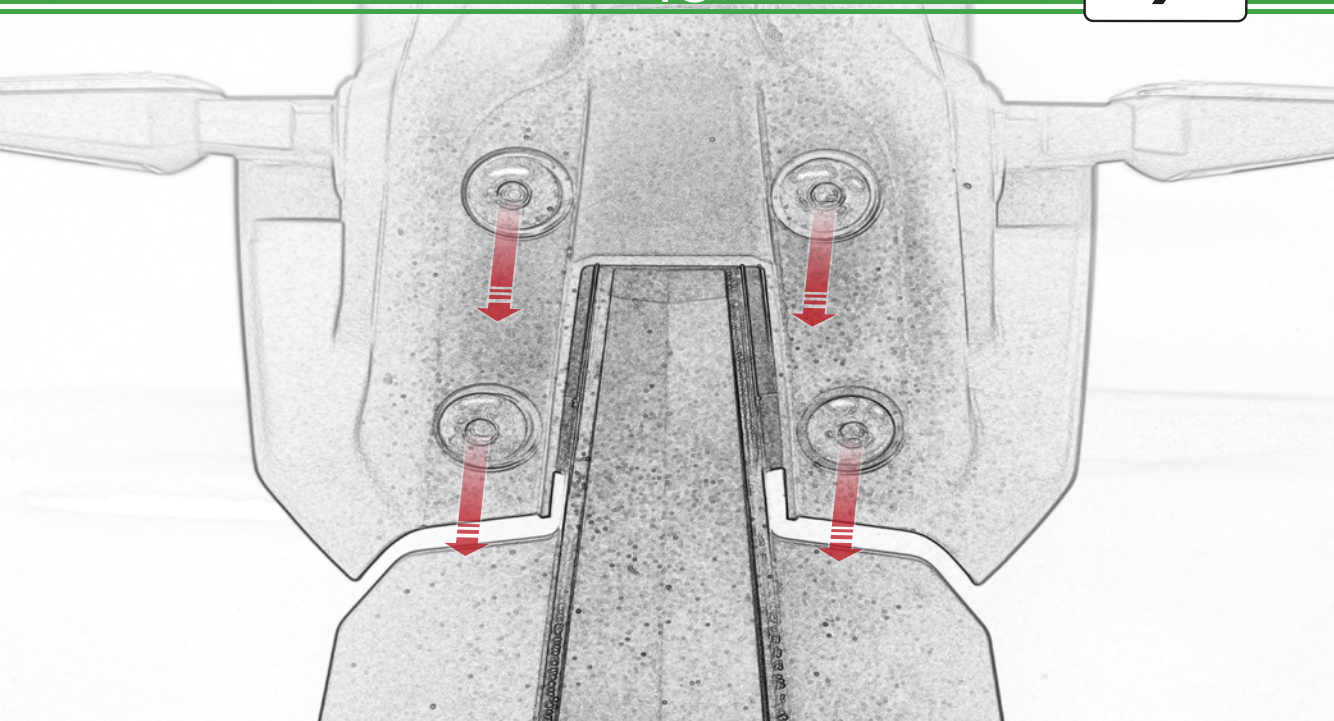

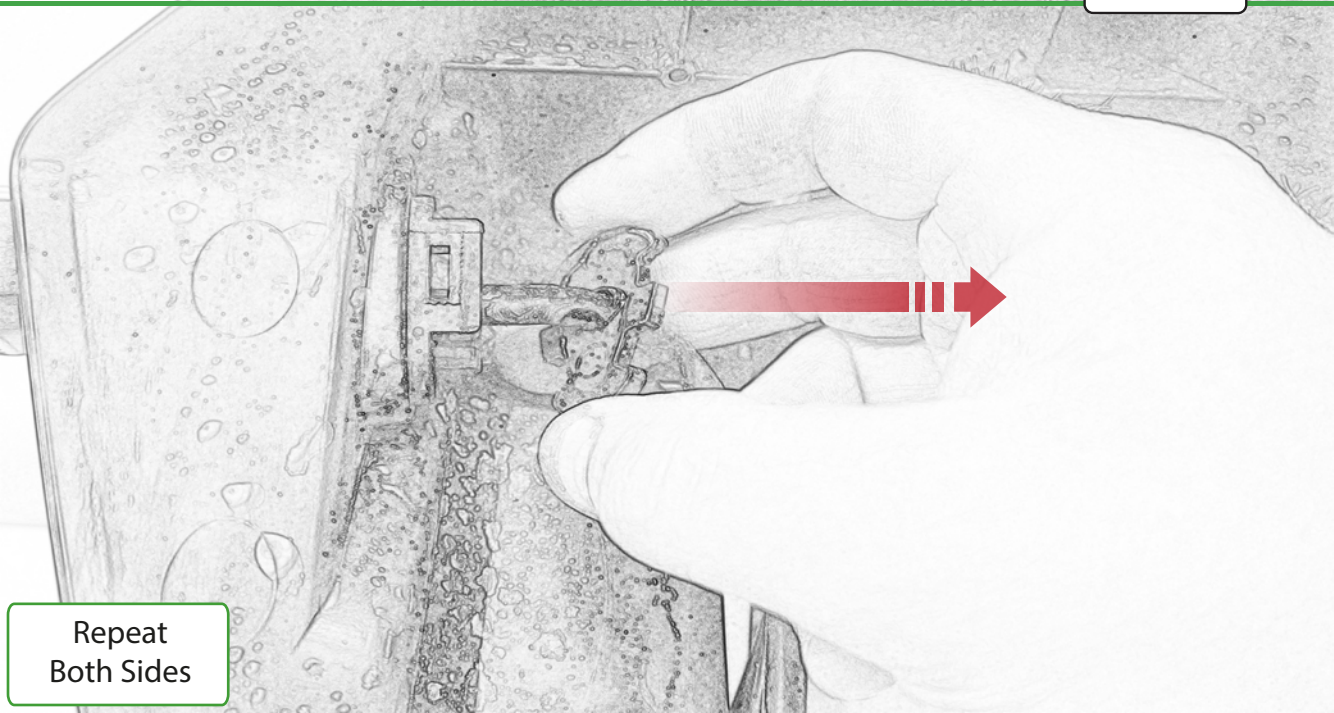

Repeat  
Both Sides



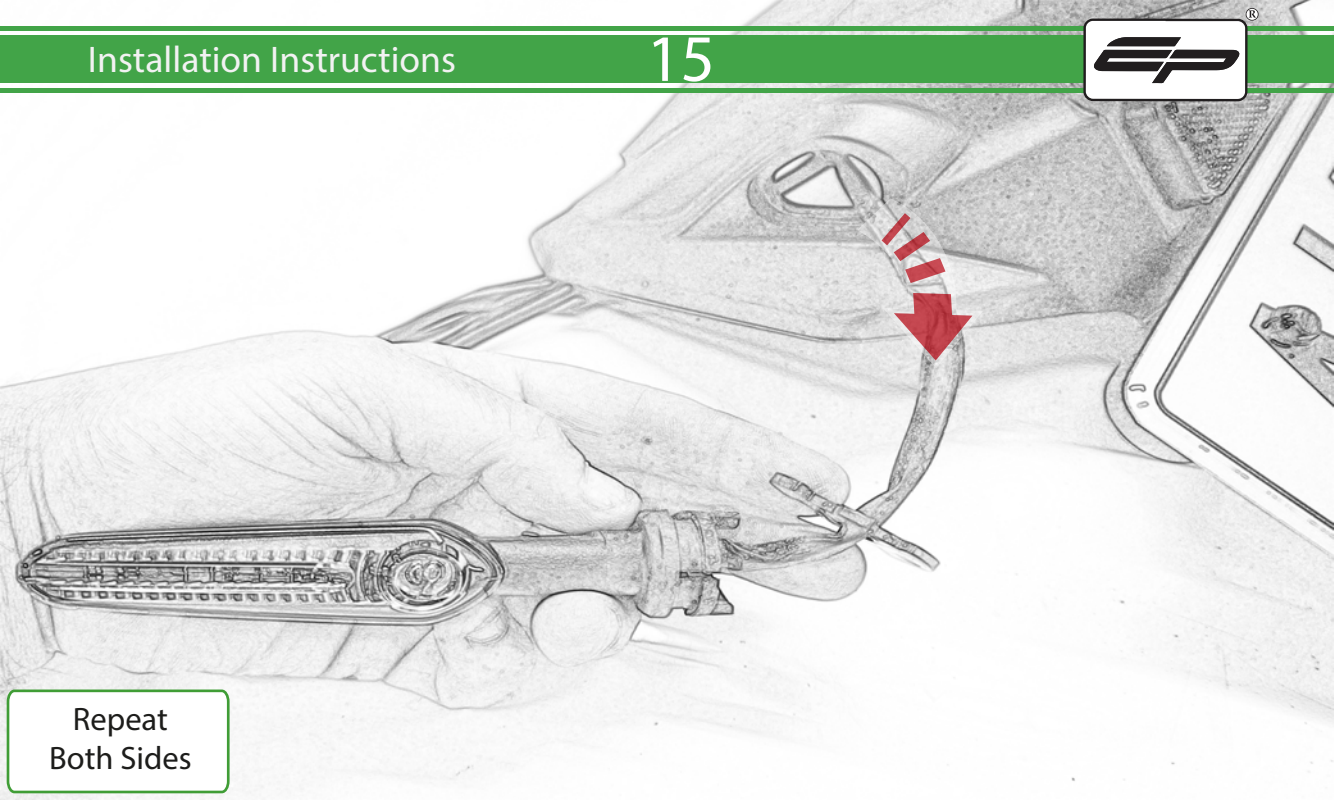

Repeat  
Both Sides

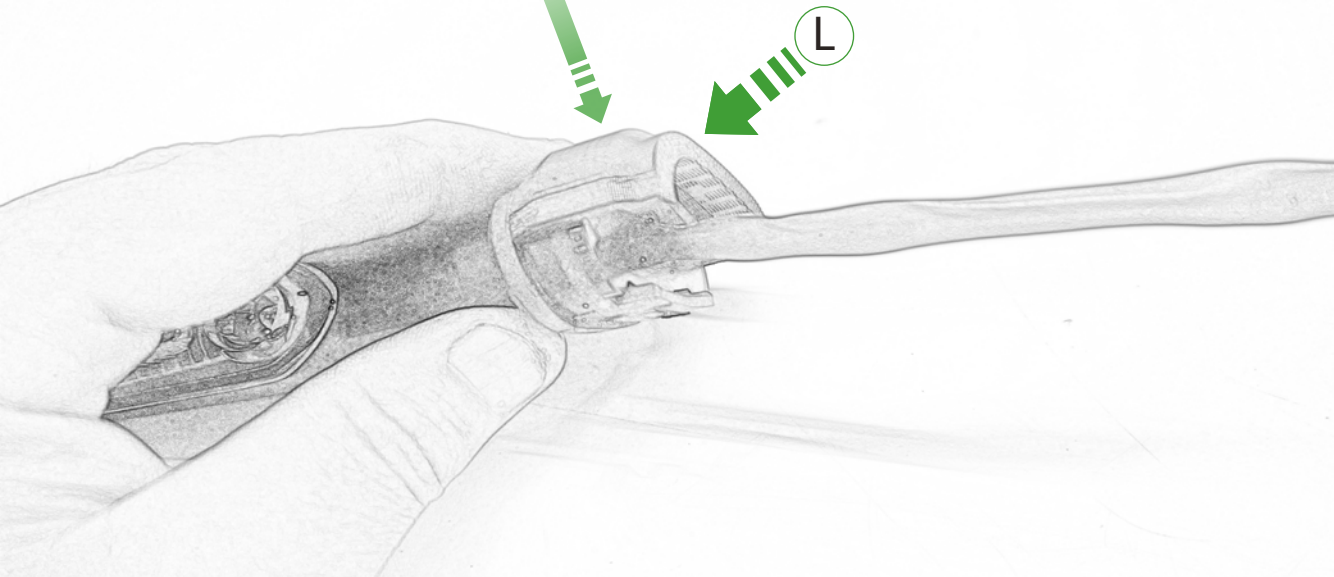

Repeat  
Both Sides

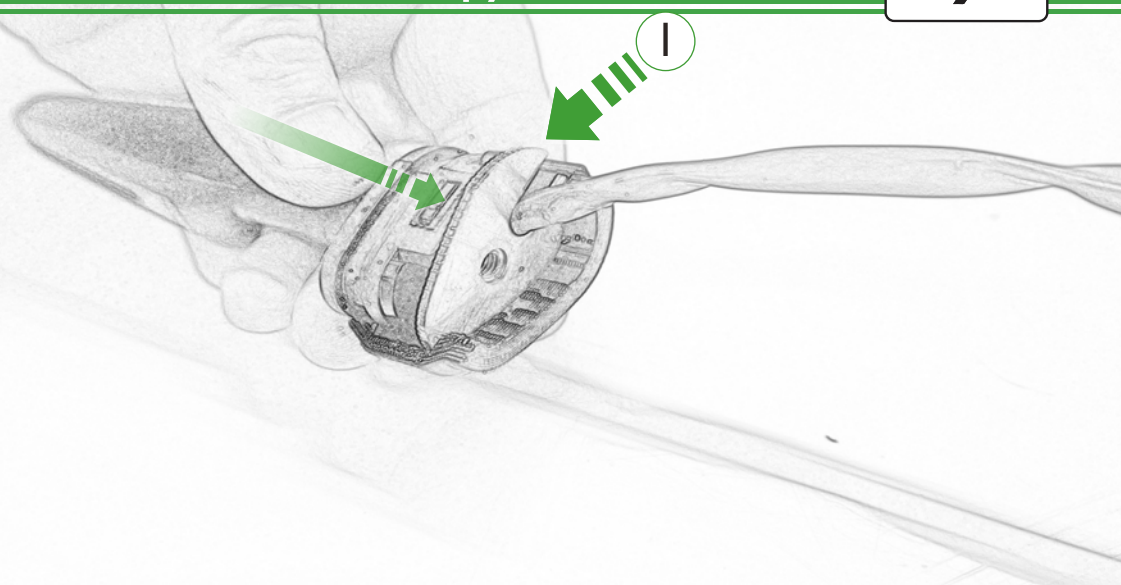

Repeat  
Both Sides



The inserted side of the plate  
**MUST** be facing the indicator.

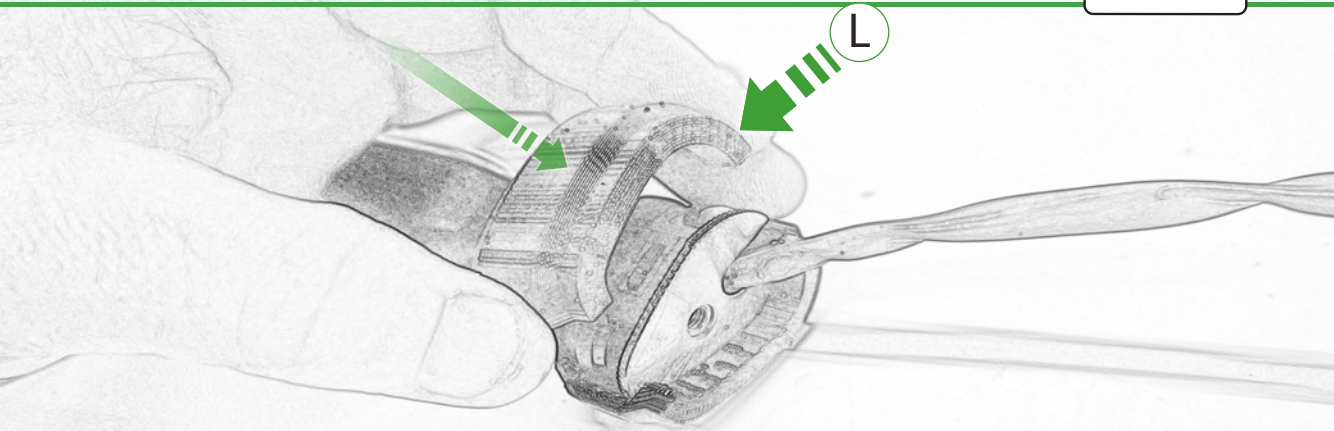

Repeat  
Both Sides

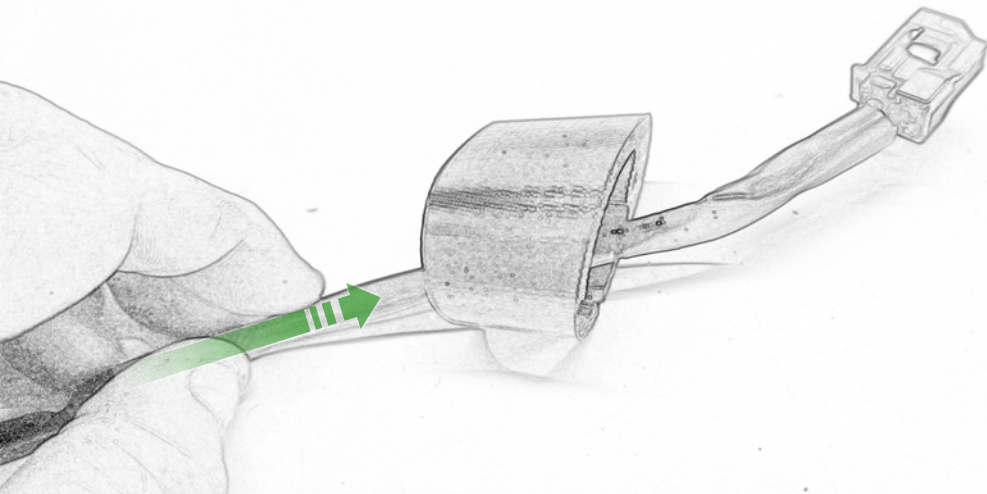

Repeat  
Both Sides

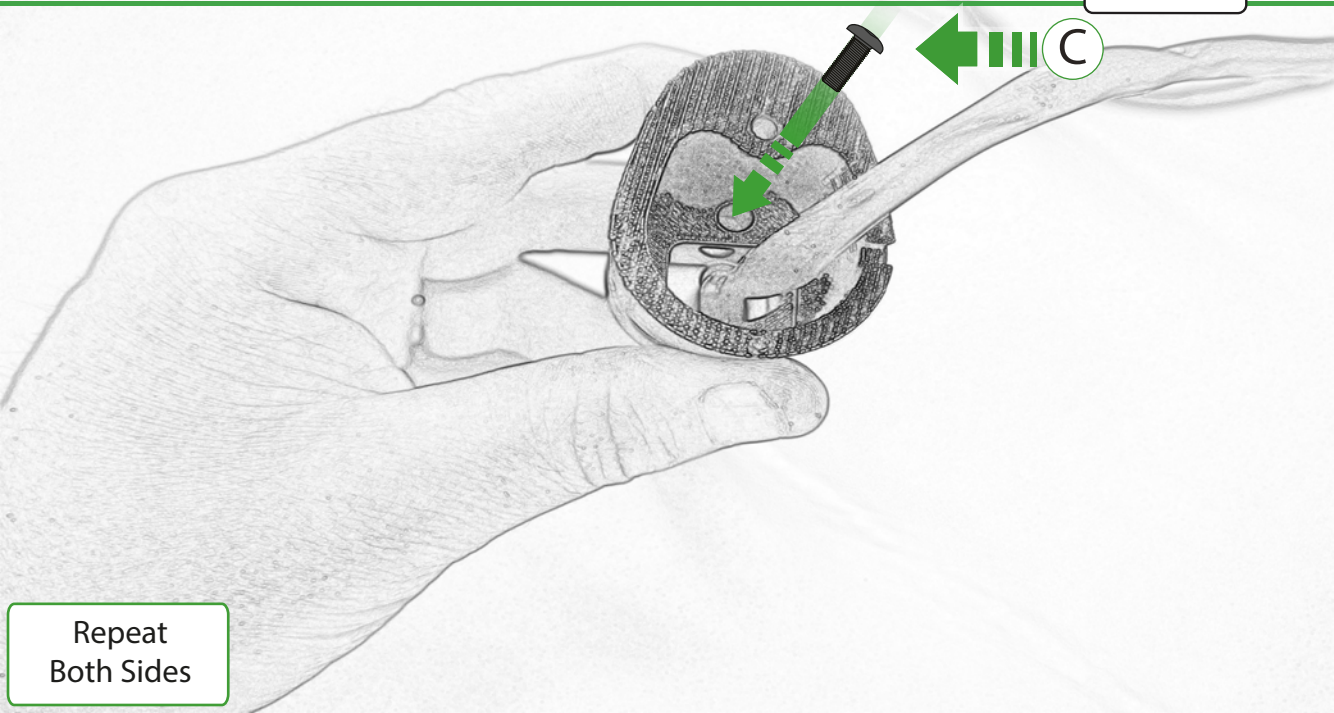

Repeat  
Both Sides

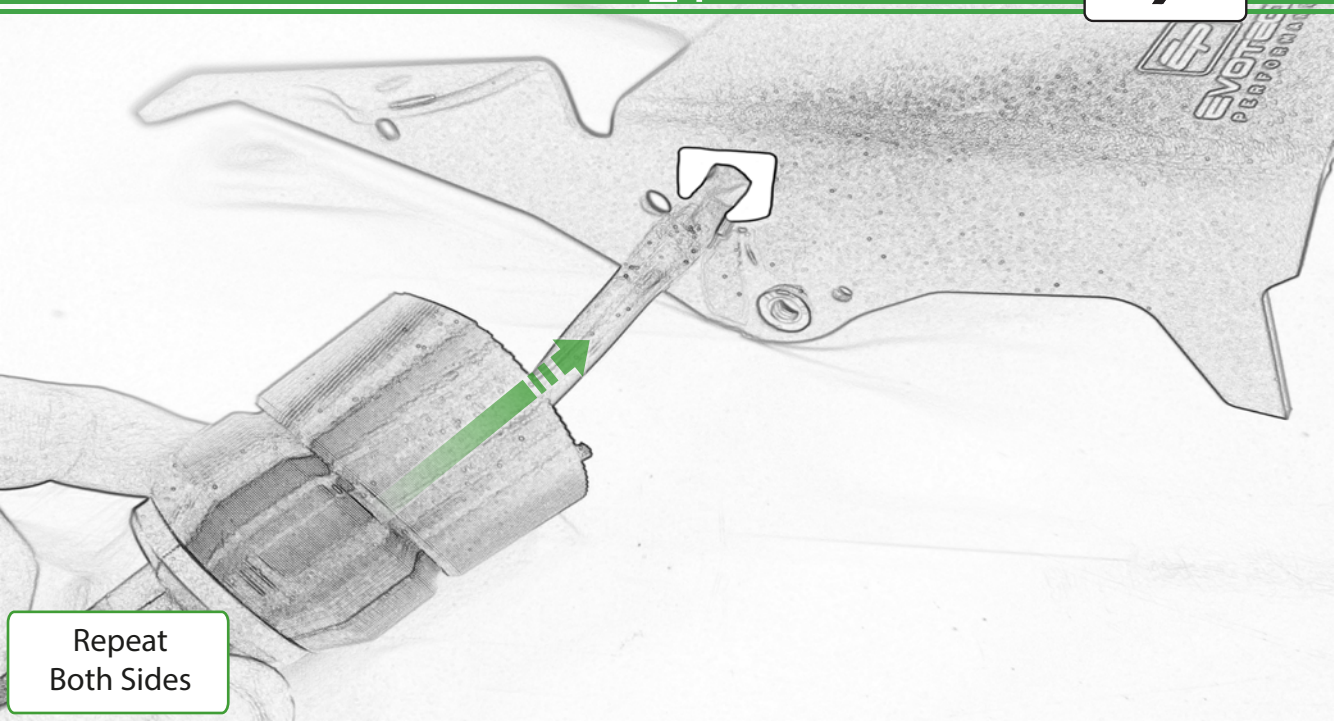

Repeat  
Both Sides

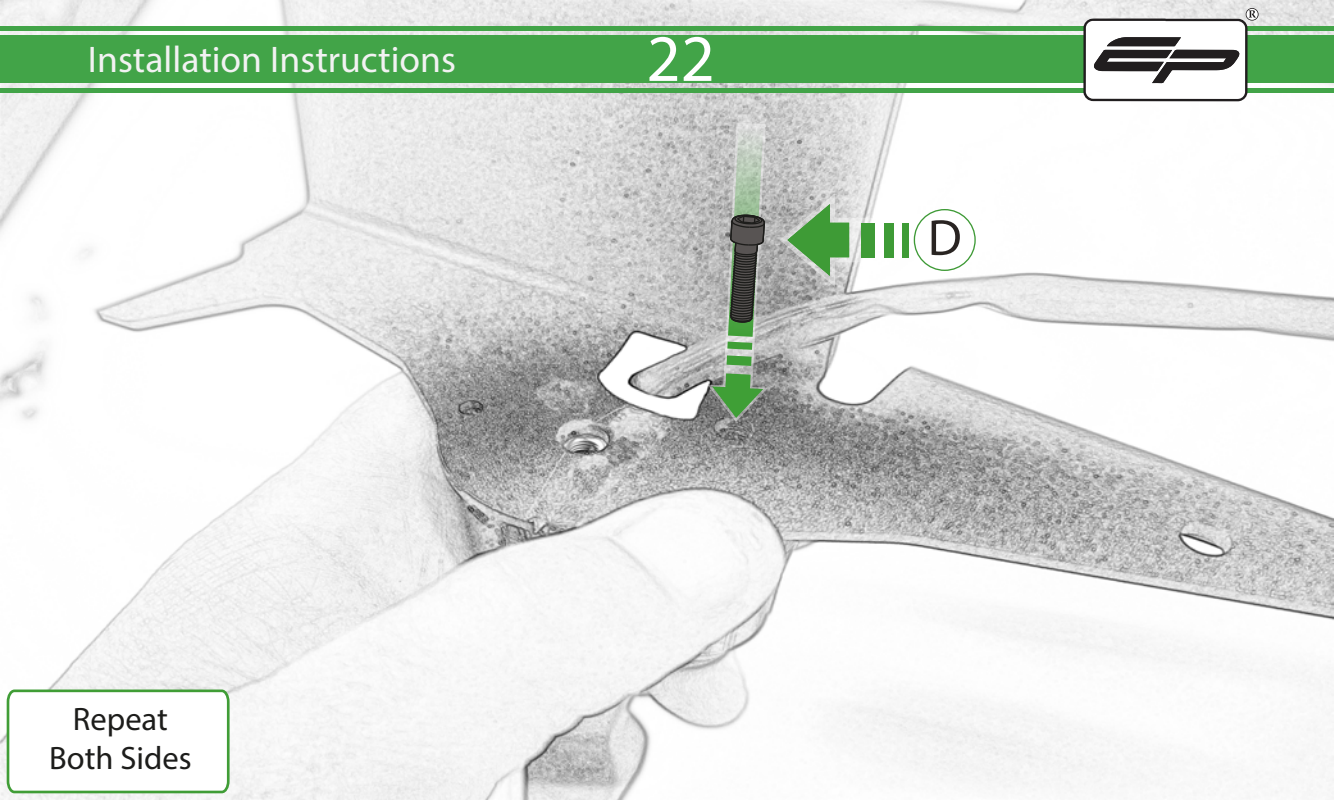

Repeat  
Both Sides



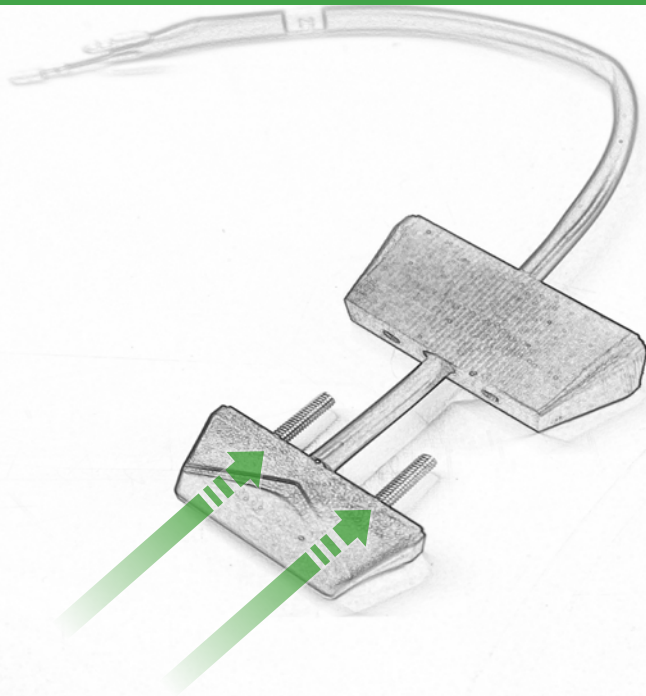







F

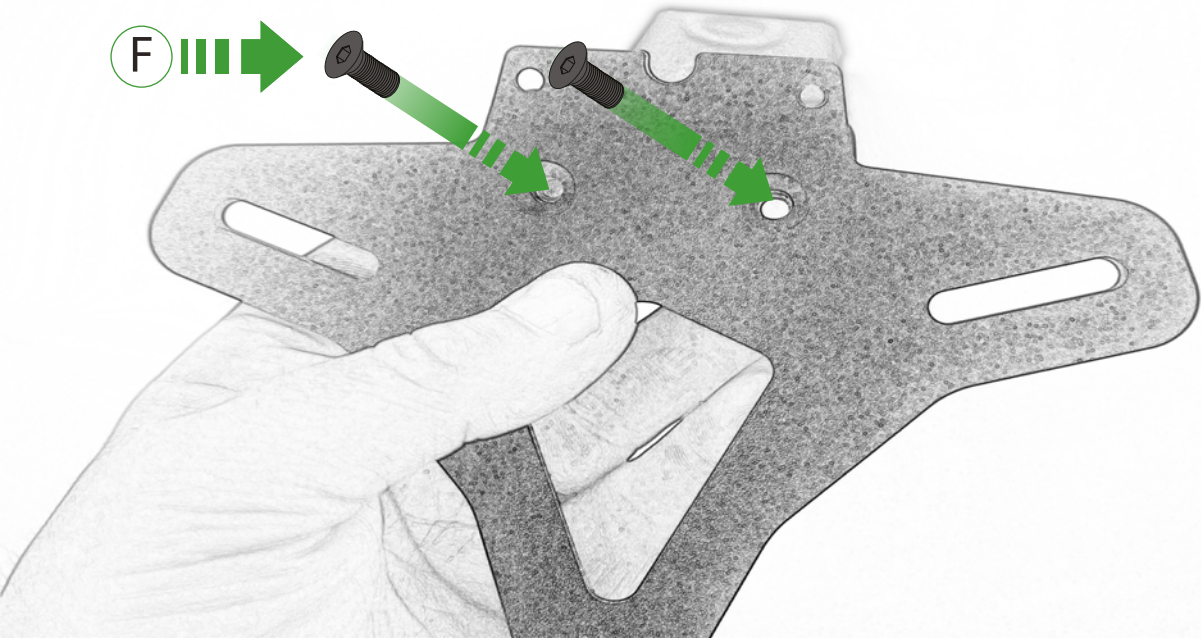

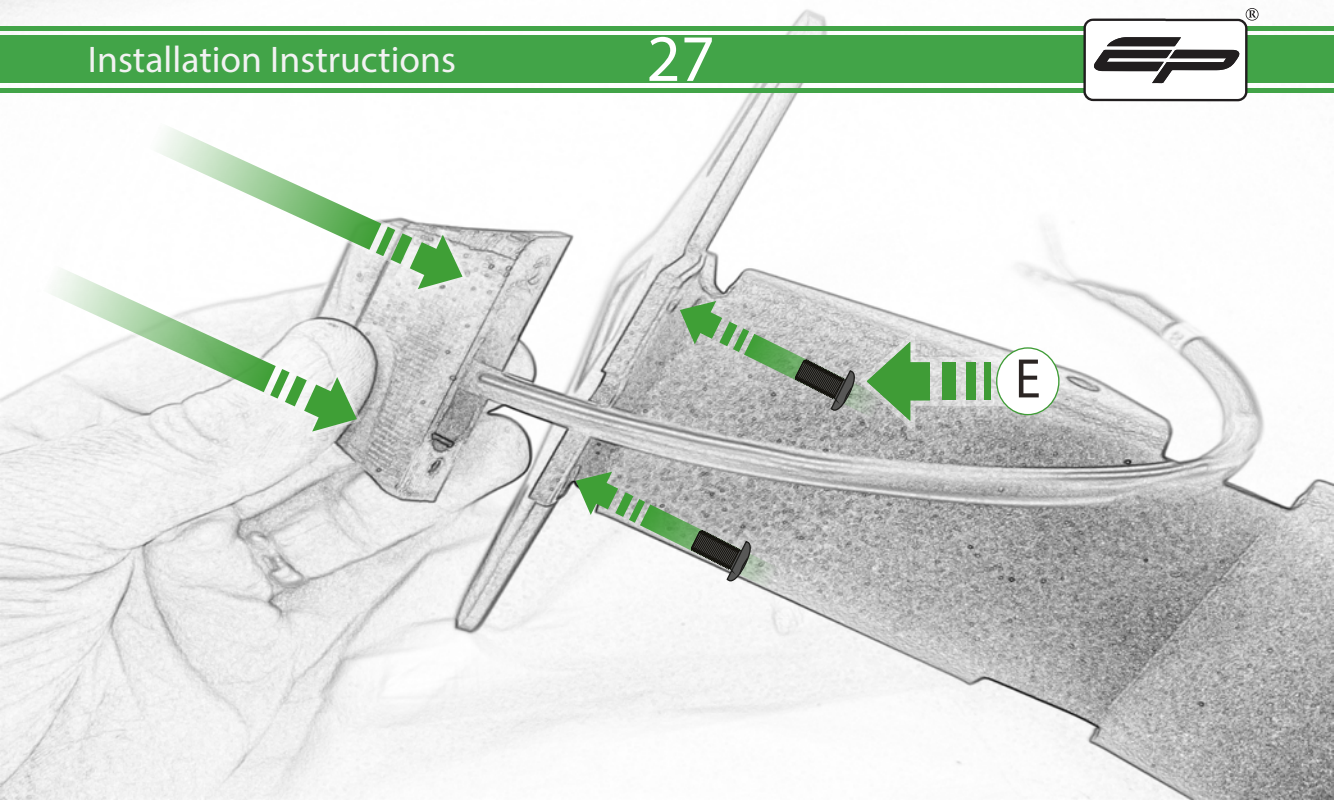

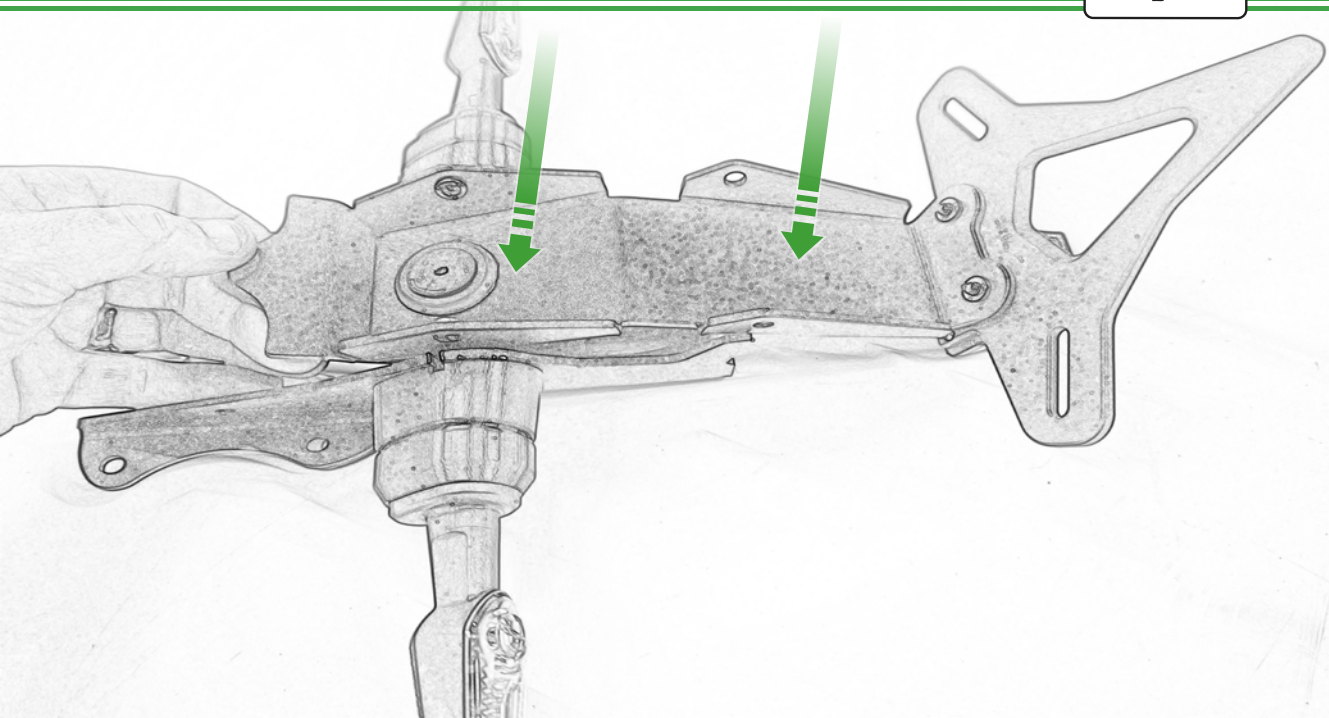

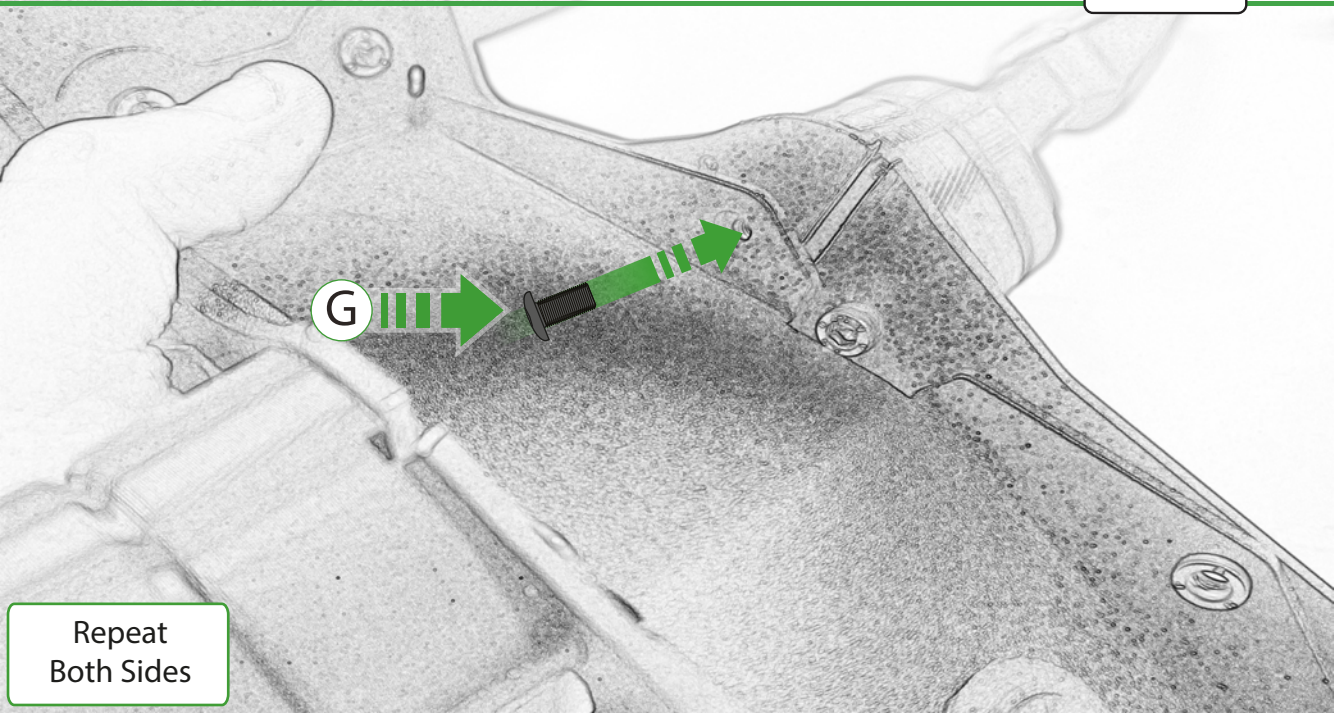

G

Repeat  
Both Sides

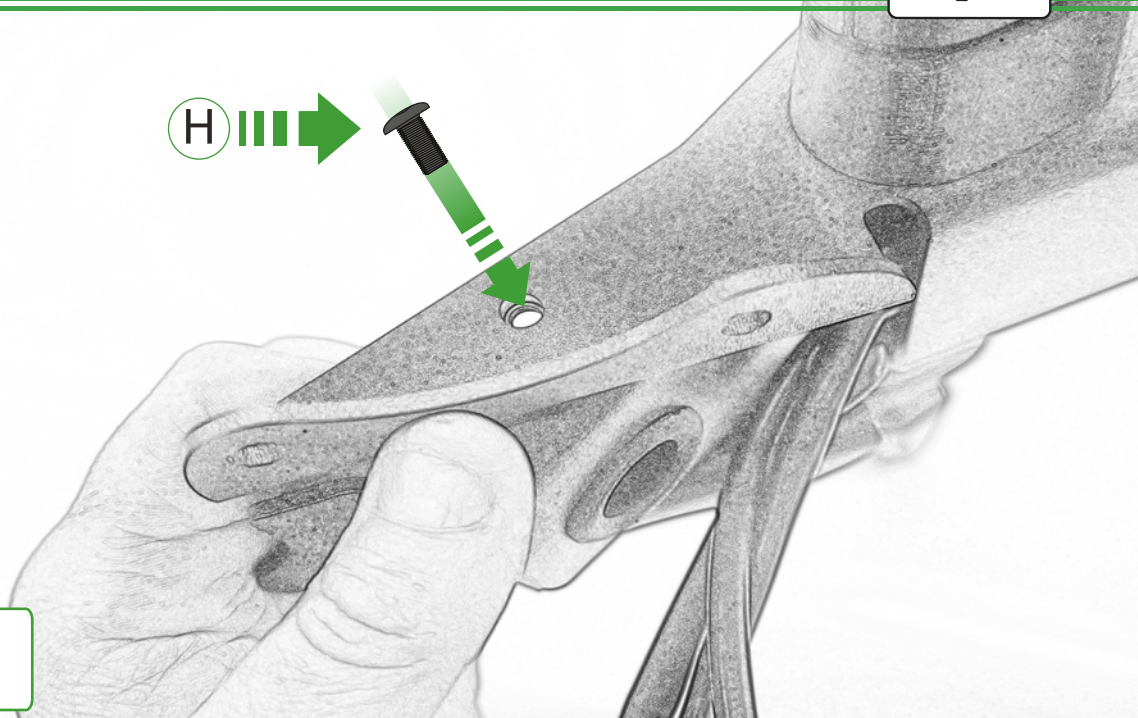

Repeat  
Both Sides



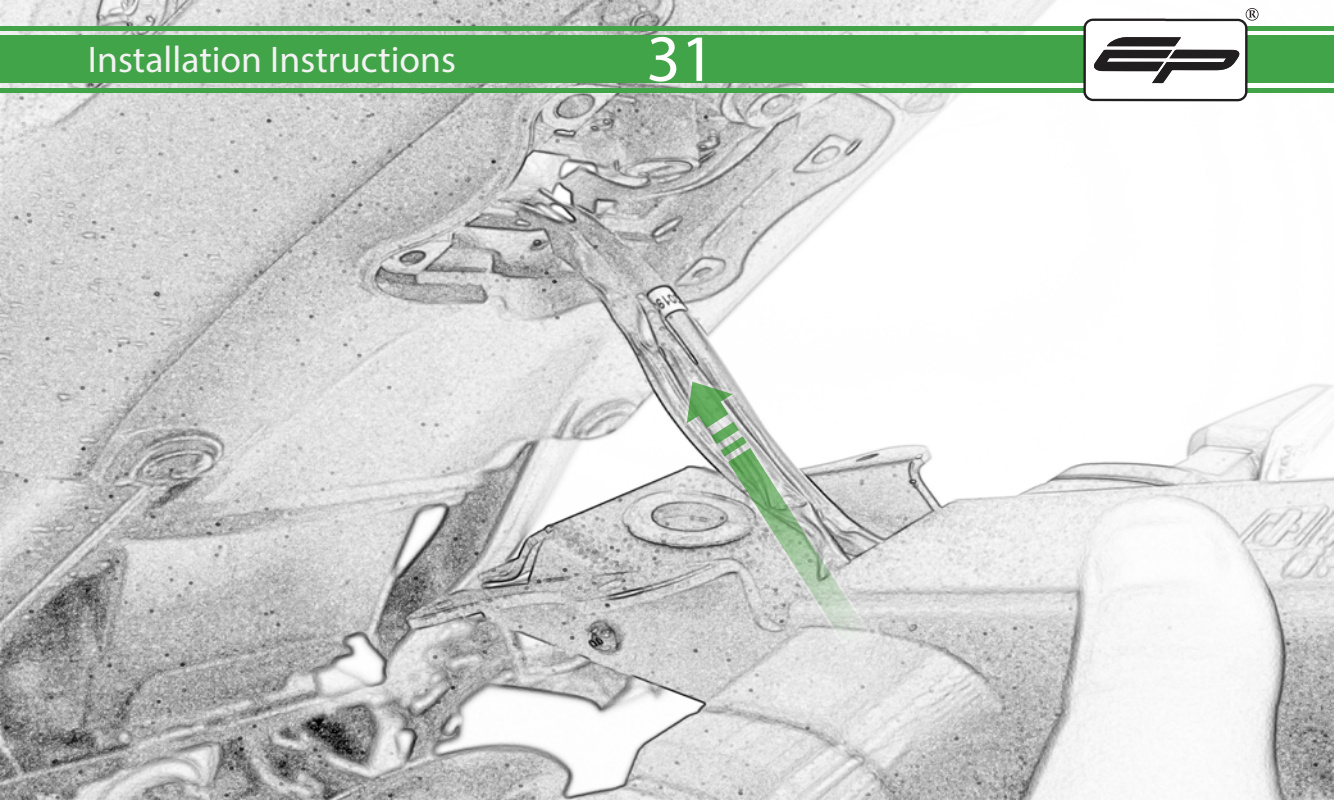

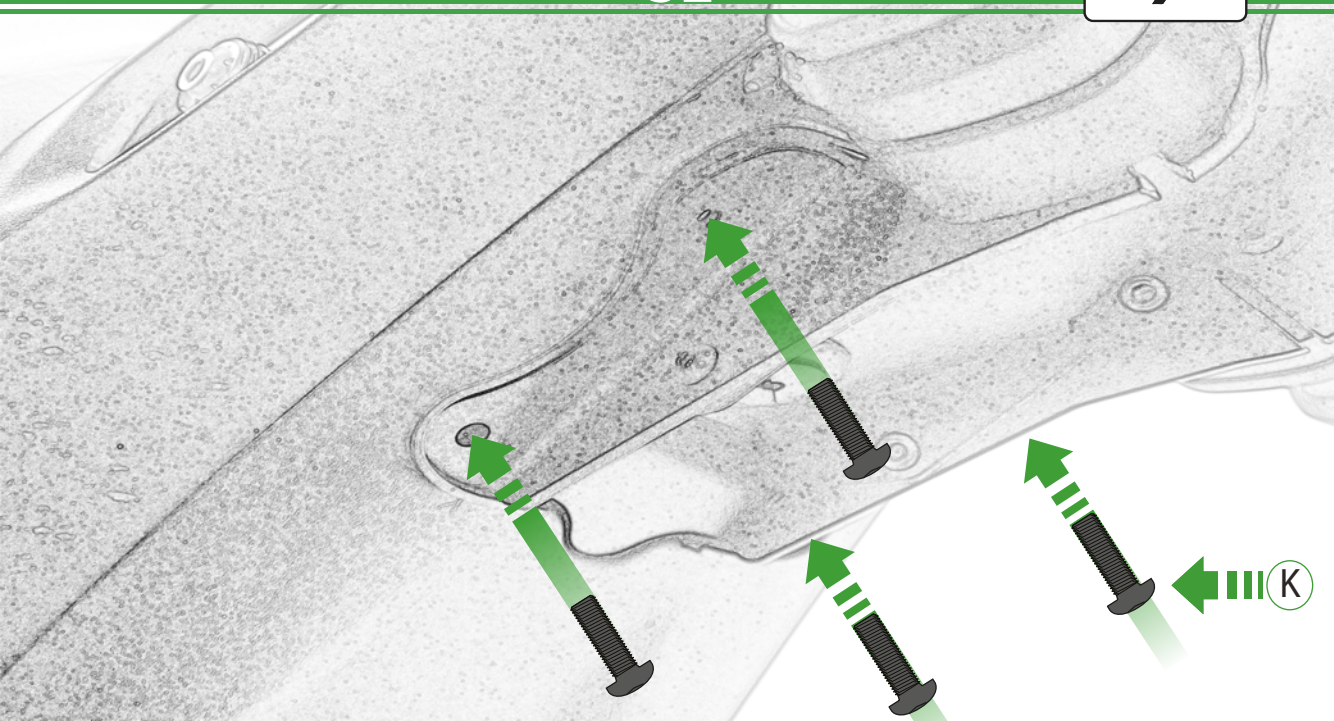

(K)

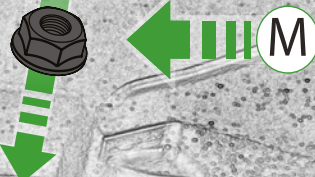
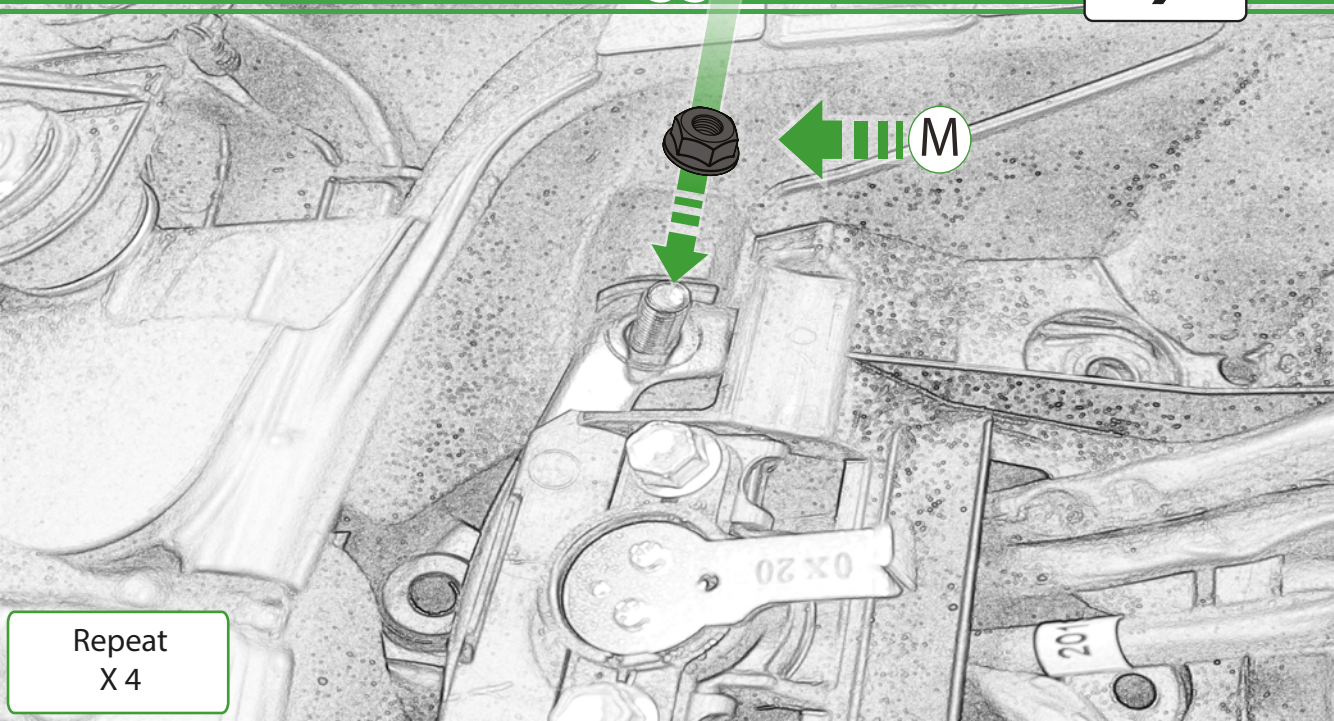

Repeat  
X 4

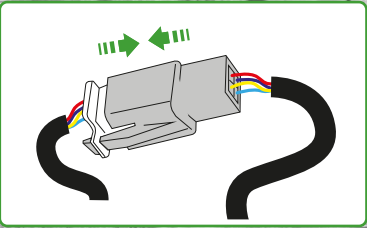

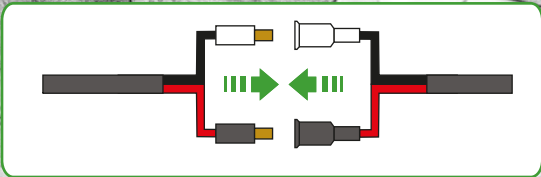
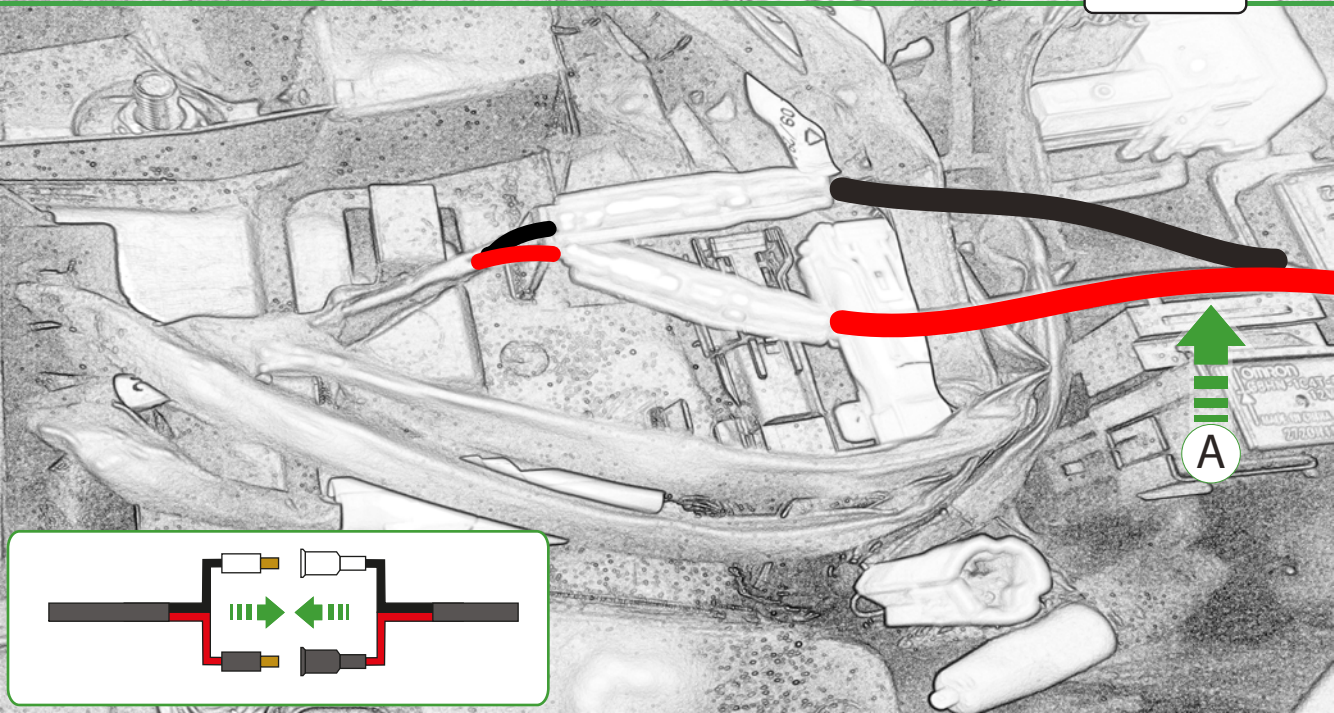

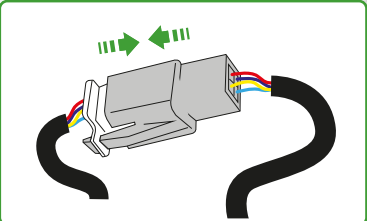
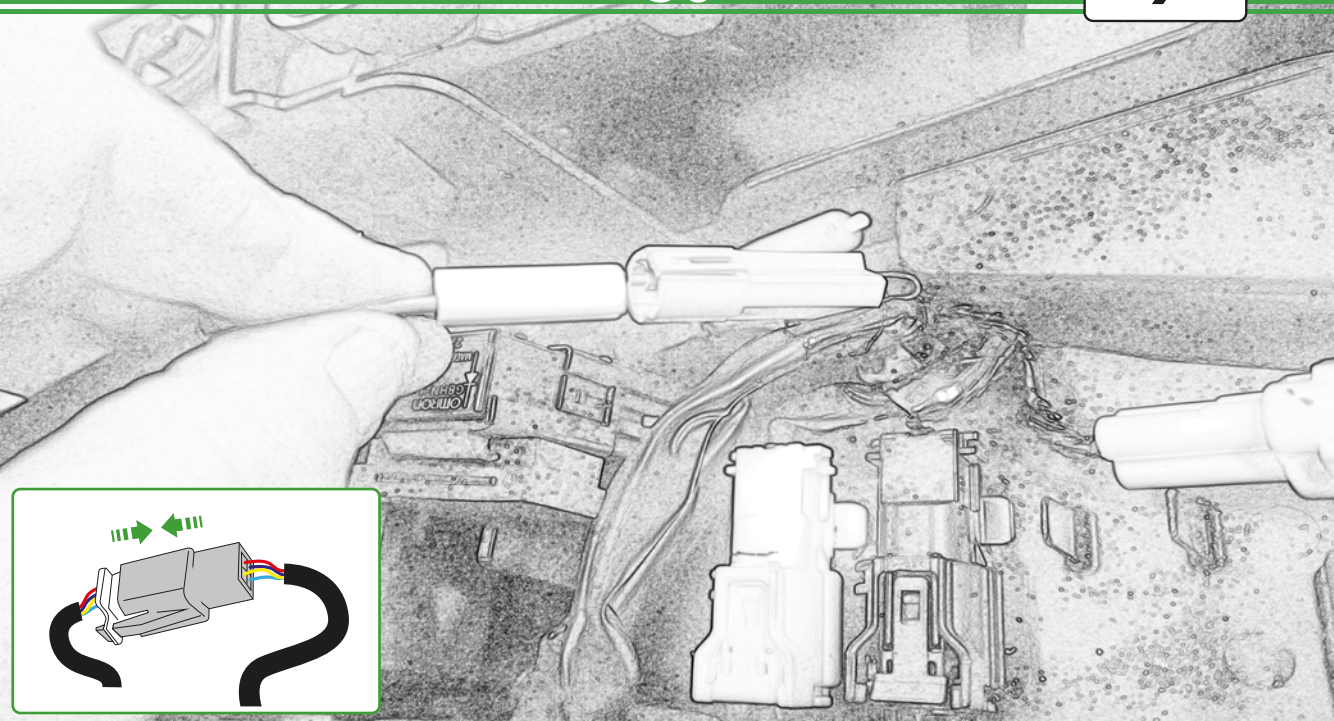

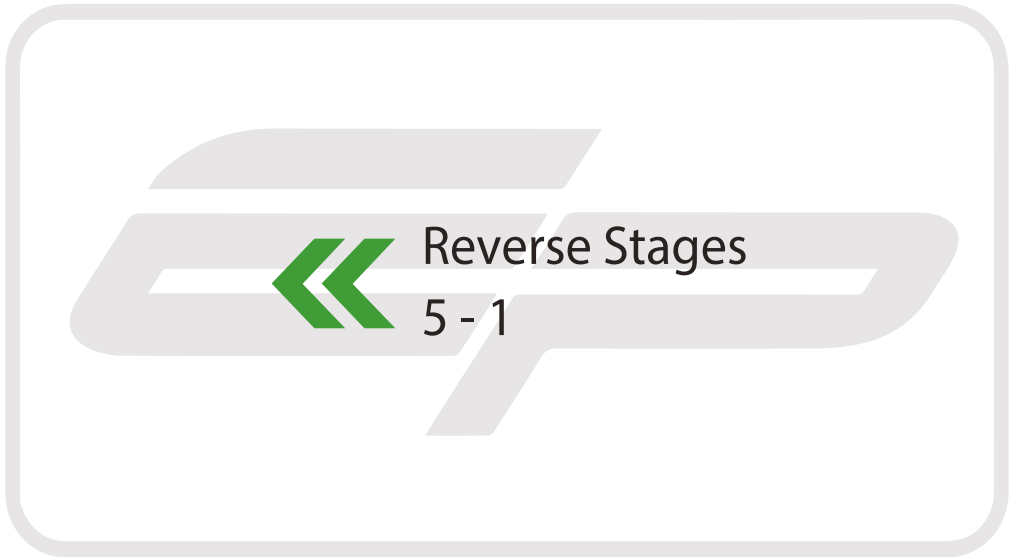

# Installation Instructions

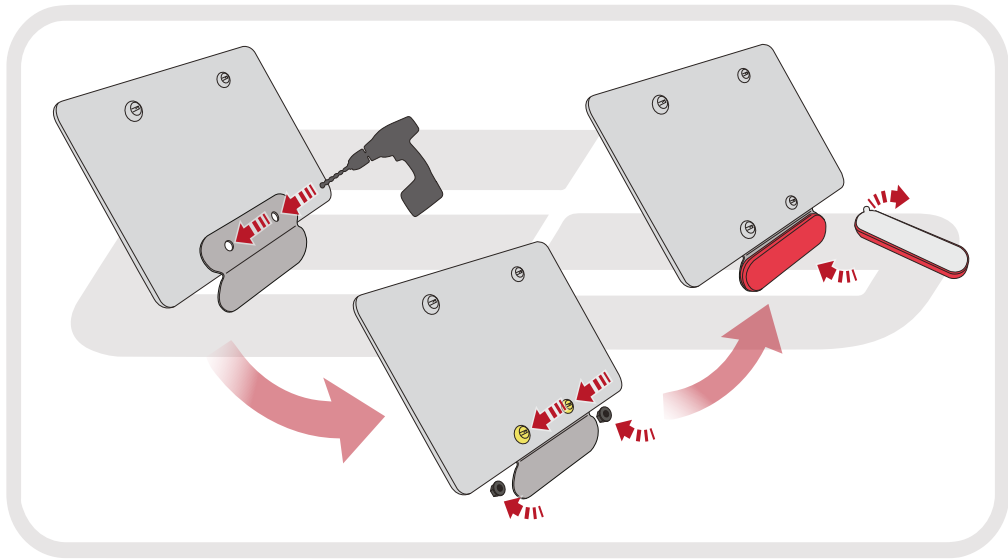

**EVOTECH**<sup>®</sup>  
P E R F O R M A N C E



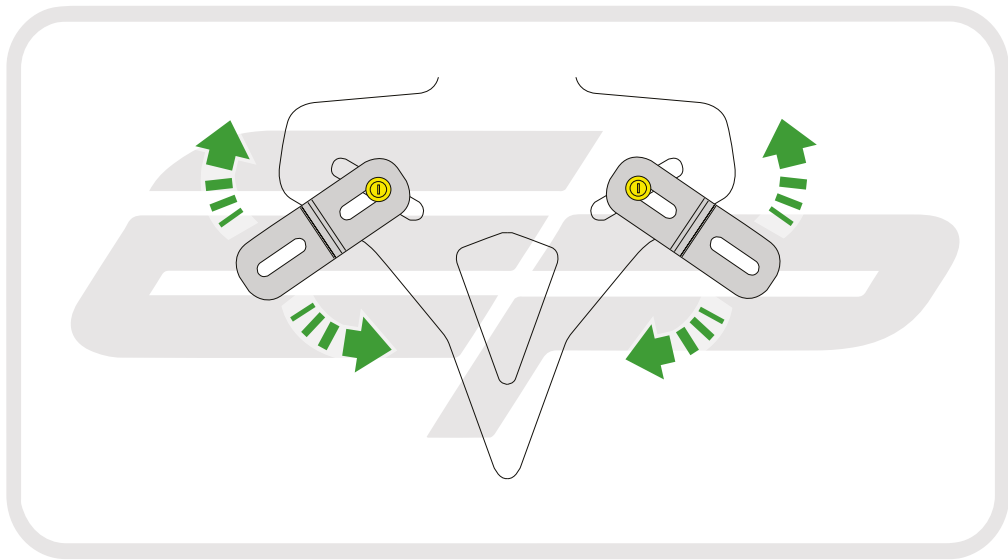



## ESSENTIAL CHECKS

After installation of your tail tidy ensure that the licence plate does not contact the rear tyre when suspension is fully compressed.

Ensure all electrics including indicators, tail light, brake light and licence plate light lights are working correctly before riding the motorcycle.

It is recommended that periodic inspections are made to ensure that all fixings are fully tightend.



**EVOTECH**®  
P E R F O R M A N C E

[www.evotech-performance.com](http://www.evotech-performance.com)