



**EVOTECH**®  
P E R F O R M A N C E

Triumph  
Crash Protection

Installation Instructions



## Kit Contents PRN014714-014731

- (A) 1 x L/H Inner Bracket
- (B) 1 x R/H Inner Bracket
- (C) 1 x M12 Cross Bar
- (D) 2 x Large Bobbin Head
- (E) 2 x Outer Bracket
- (F) 2 x Bobbin Spacer
- (G) 2 x Washer M12 BZP
- (H) 2 x M12 x 180 x 1.25 Caphead
- (I) 2 x M12 x 65 x 1.25 Caphead
- (J) 2 x Polyurathane Washer

## Installation Instructions

1



17mm Socket

Repeat  
Both Sides

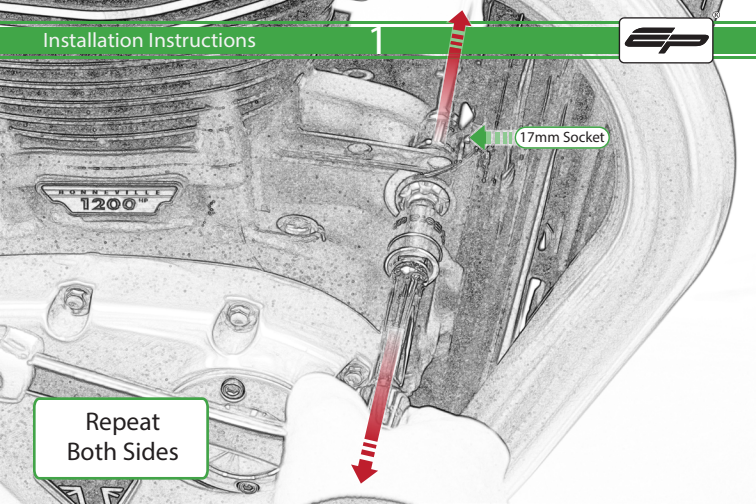

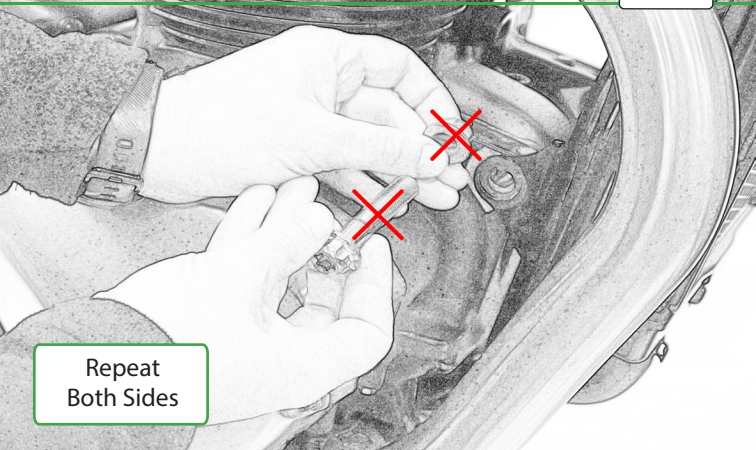

Repeat  
Both Sides

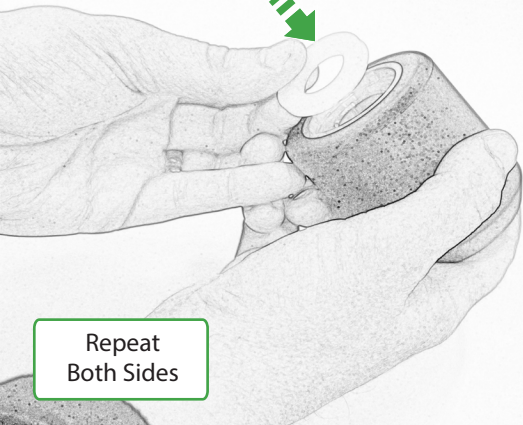

Repeat  
Both Sides

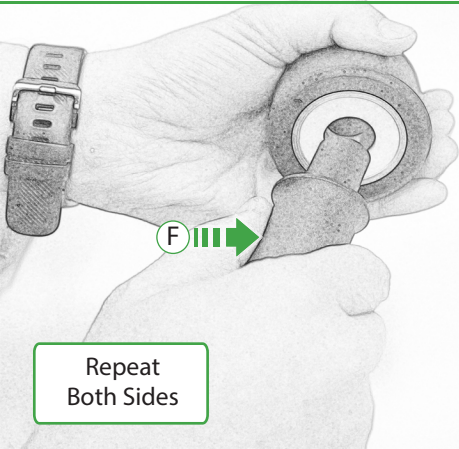

Repeat  
Both Sides

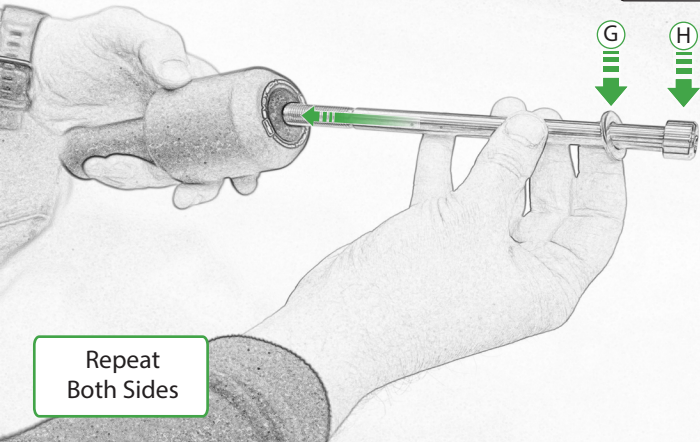

Repeat  
Both Sides

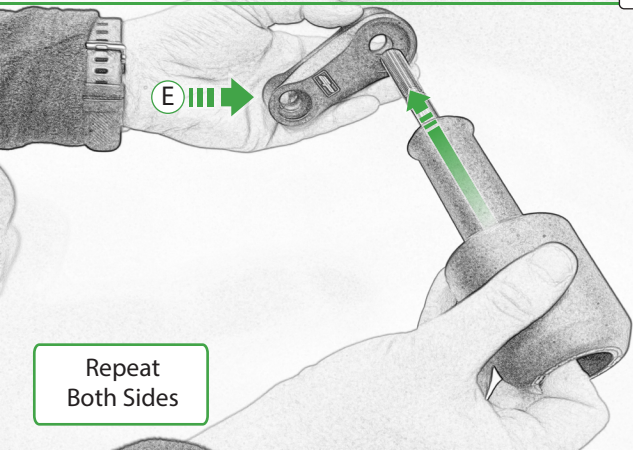

E IIII →

Repeat  
Both Sides



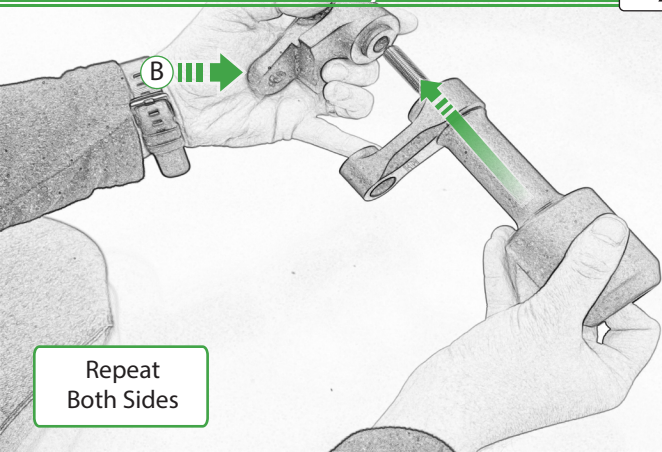

B

Repeat  
Both Sides

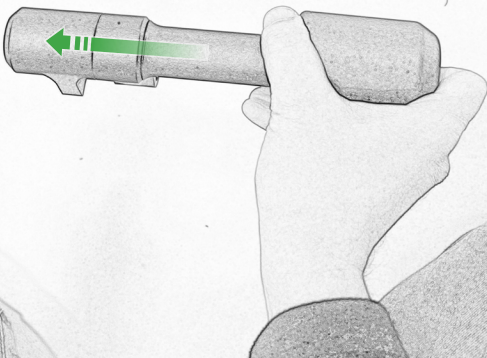
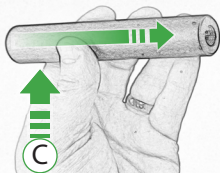

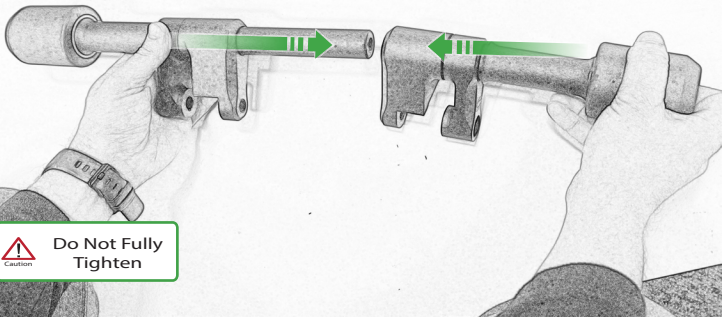

Caution

**Do Not Fully  
Tighten**

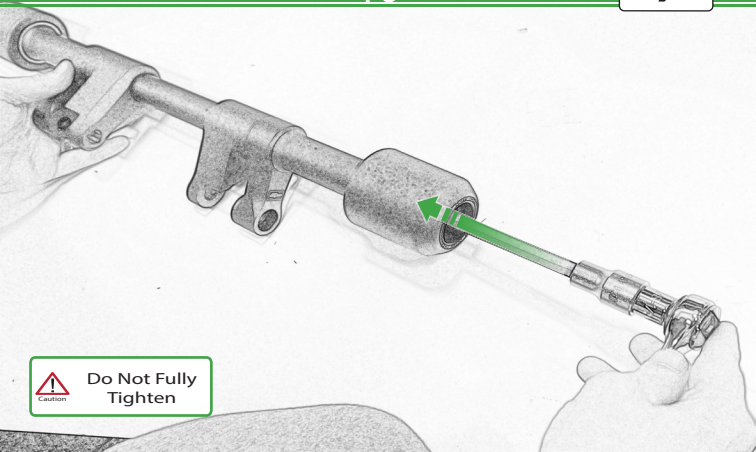

Caution

**Do Not Fully  
Tighten**

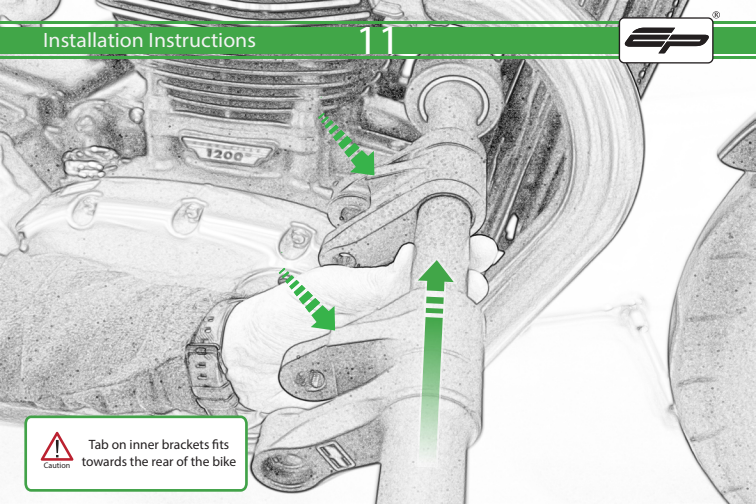

Caution

Tab on inner brackets fits towards the rear of the bike

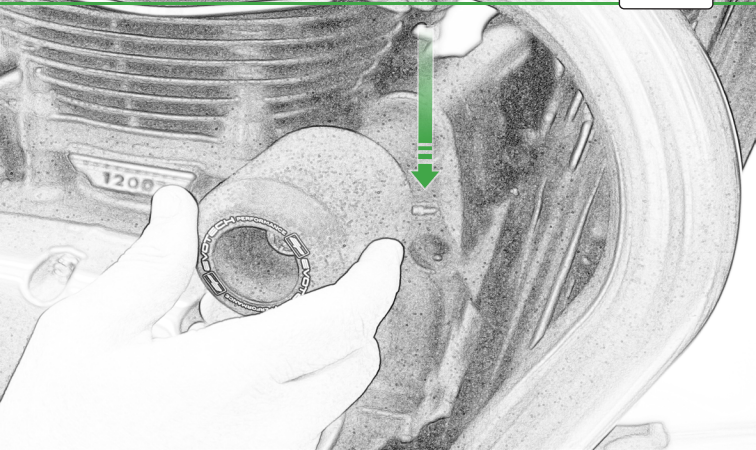



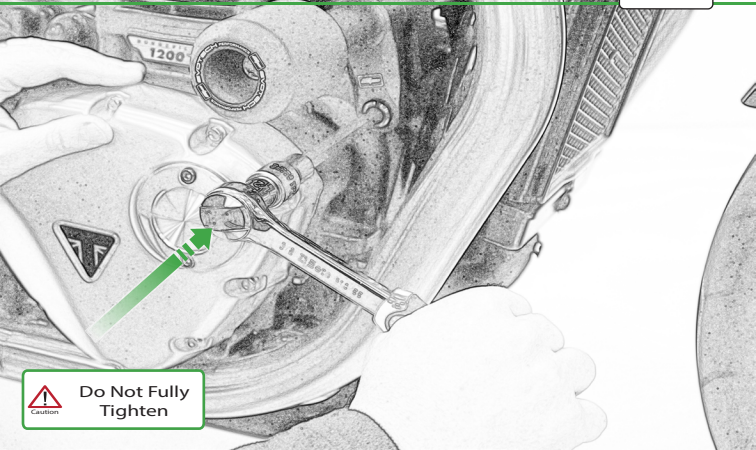

Caution

**Do Not Fully  
Tighten**



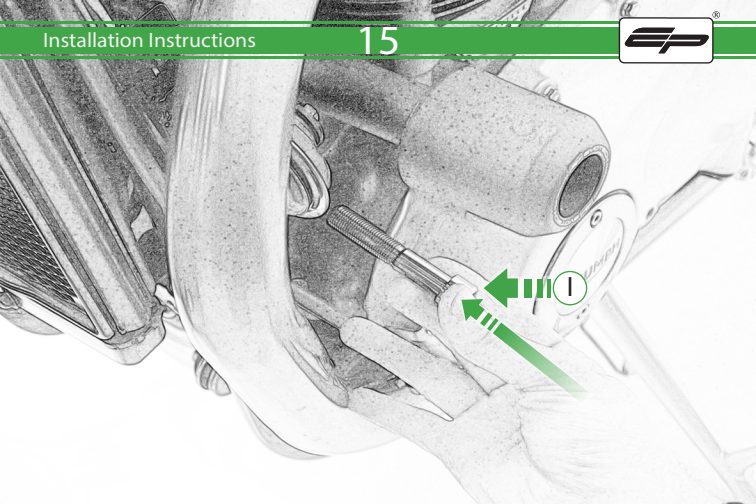

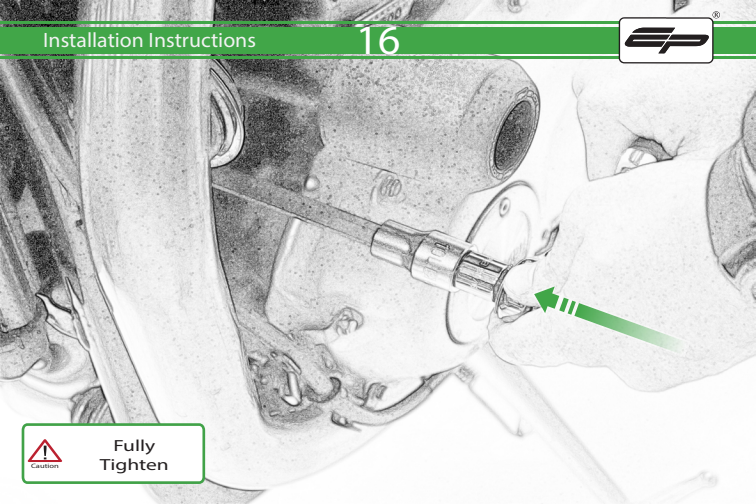

Caution

Fully  
Tighten

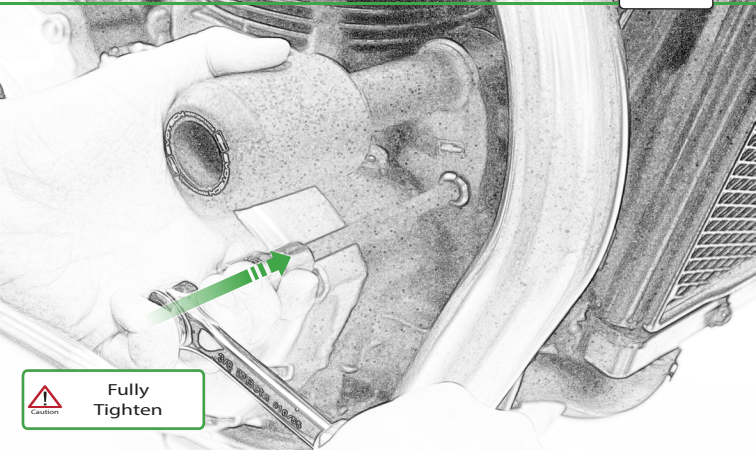

Caution

**Fully  
Tighten**

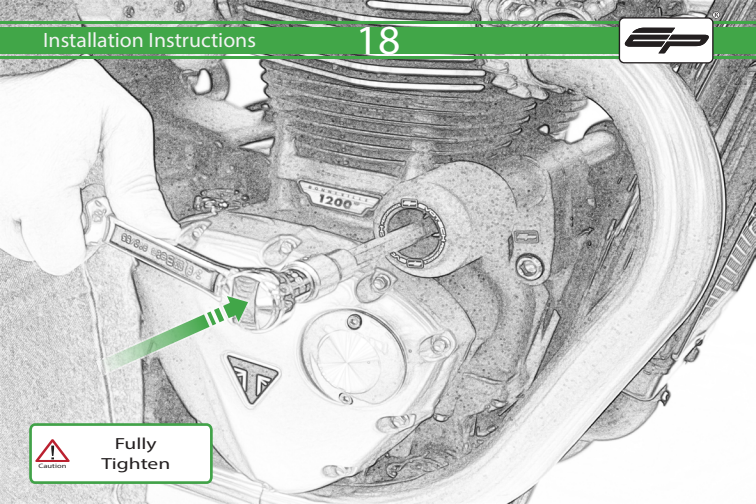

Caution

Fully  
Tighten

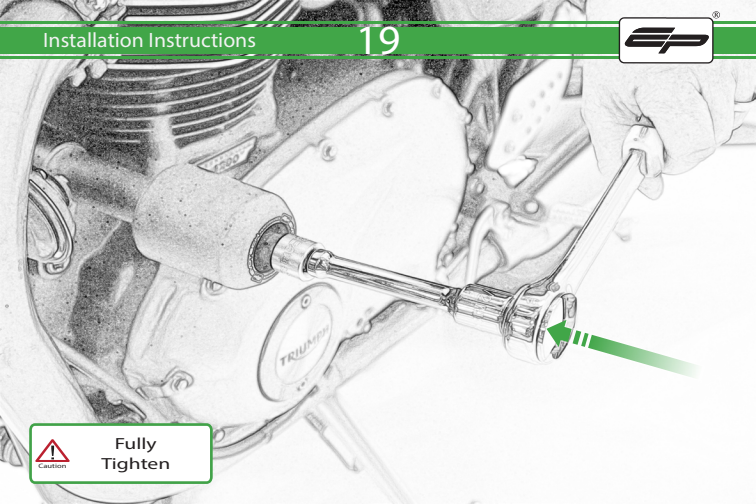

Caution

Fully  
Tighten



 **ESSENTIAL CHECKS** 

It is recommended that periodic inspections are made to ensure that all bolts are tightened to the specified torque settings.

Should the bike be involved in an accident a thorough inspection should be made and any components that have taken an impact, no matter how small, be replaced



**EVOTECH**®  
P E R F O R M A N C E

[www.evotech-performance.com](http://www.evotech-performance.com)