



EVOTECH®
P E R F O R M A N C E

Installation Instructions



SUZUKI GSX-S 1000 TAIL TIDY

Product Reference - 12754

Kit Contents

- | | |
|--|---|
| A 1 x Main Tail Tidy | G 2 x M5 - 10 Black Button Head Screws |
| B 1 x Licence Plate Light Bracket | H 2 x M3 - 12 Black Button Head Screws |
| C 1 x LED Light Unit | I 2 x Male Bullet Connectors |
| D 1 x Wiring Connector | J 4 x M6 - 12 Black Button Head Screws |
| E 1 x Reflector | K 5 x Cable Ties |
| F 1 x M5 - 16 Black Button Head Screw | |

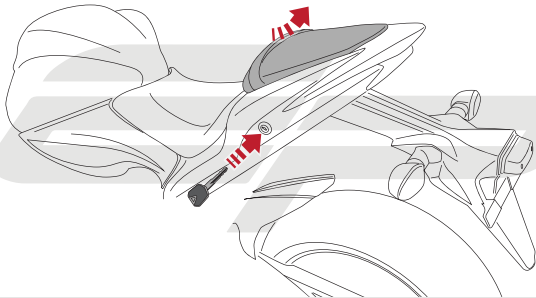

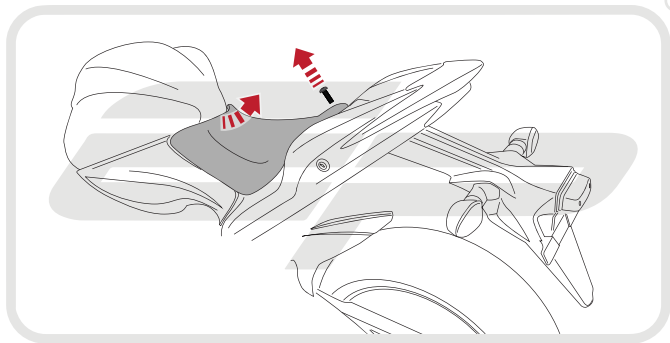

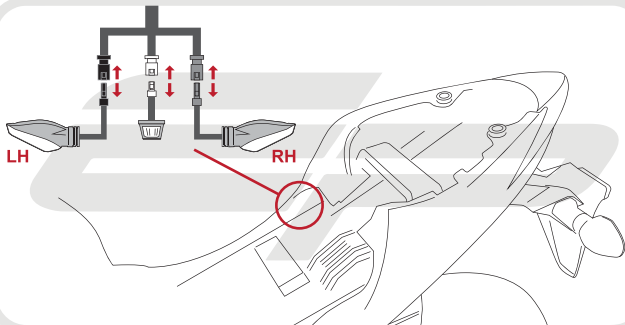

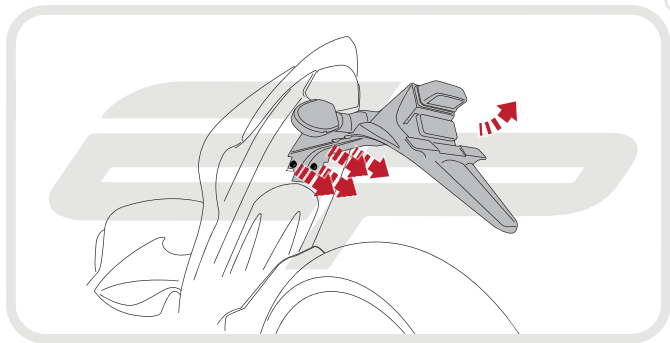

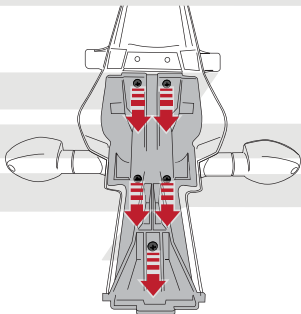

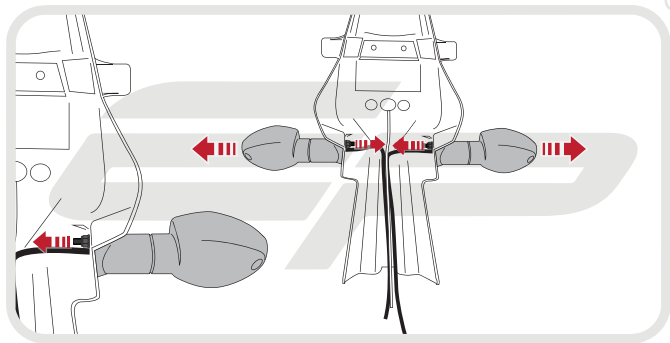

Ensure drain holes are facing down when installed

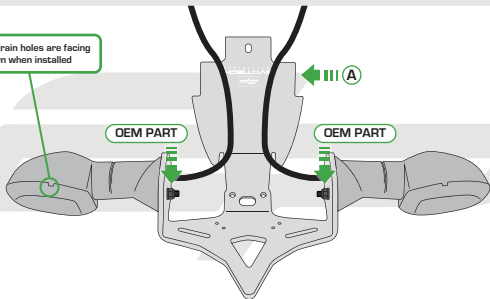

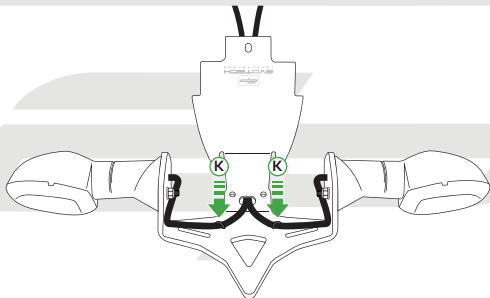

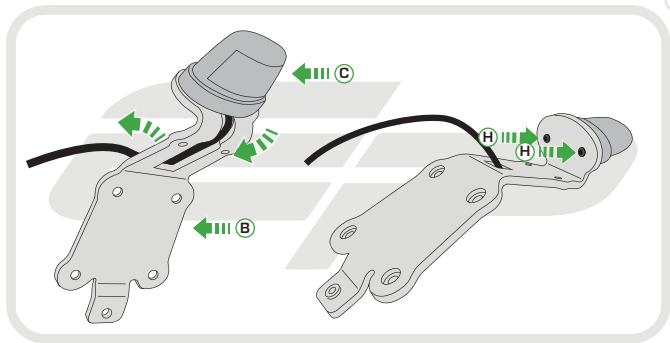

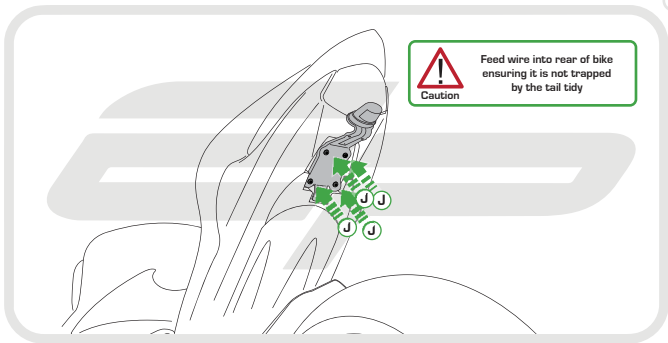

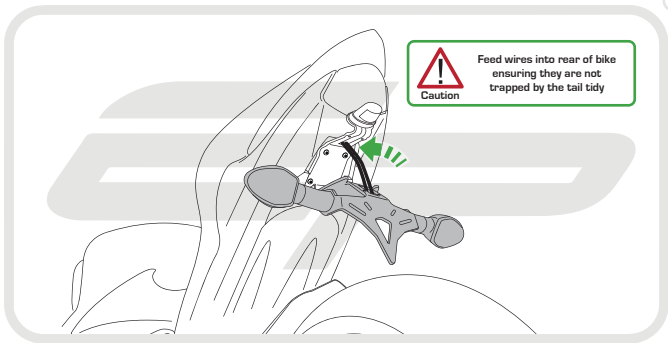

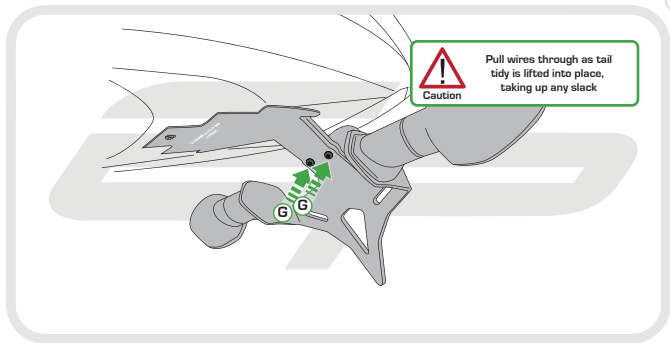

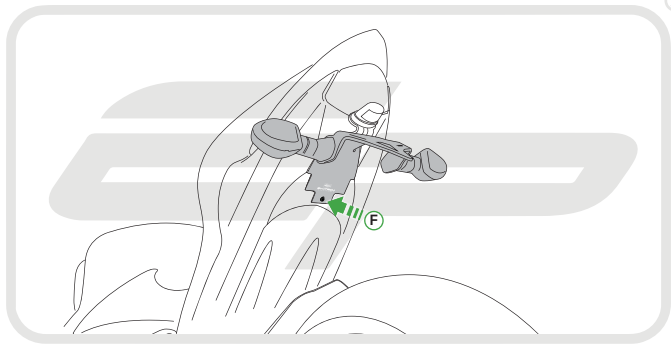

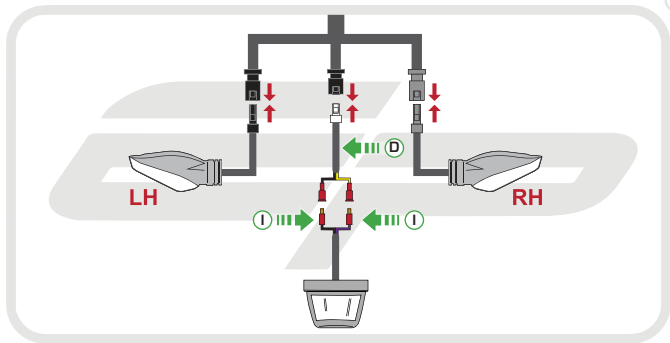



Reverse Stage

2,1



ESSENTIAL CHECKS



After installation of your tail tidy ensure that the licence plate does not contact the rear tyre when suspension is fully compressed.

Ensure all electrics including indicators, tail light, brake light and licence plate light lights are working correctly before riding the motorcycle.

It is recommended that periodic inspections are made to ensure that all fixings are fully tightend.



EVOTECH®
P E R F O R M A N C E

www.evotech-performance.com