



**Attention**  Special notes and cautionary measures which can prevent damage to the accessory or motorcycle.

**Note:**  Tips for facilitation of operation, control and adjustment, as well as maintenance work.

Check contents of this package against parts list. Report any missing parts to your dealer or ZTechnik directly. The following information is necessary: Bag Number and Date Stamp(s) on outside of Kit or Box and Place of Purchase.

Z2442, Z2443 and Z2444 Parts List				
Index	Part Number	Description	Qty.	Notes
1		Windshield, Hardcoated Lexan® polycarbonate	1	Not Pictured
2	37-370240-000	Bracket, Left	1	
3	37-370241-000	Bracket, Right	1	
<b>Bag#1067</b>				
4	51-514212-000	Hex Screw, M6 x 12 Stainless Steel	6	
5	34-346037-000	Cap, Black	6	
6	44-447304-000	Grommet	6	
7	51-515748-000	Hex Screw M8 x 1.25 x 45 Stainless Steel	4	
8	49-495256-000	Standoff	2	

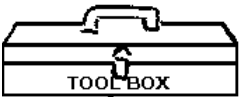
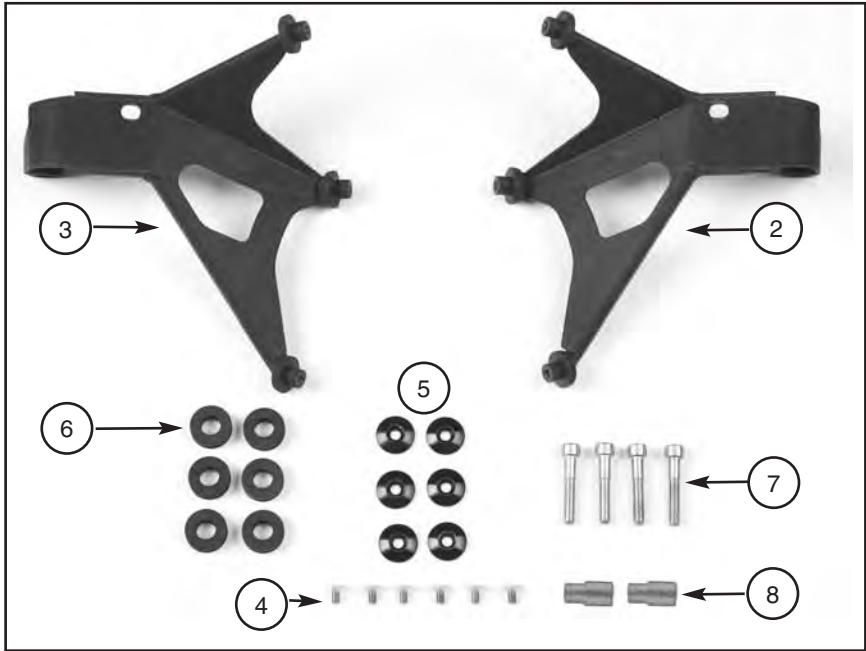

- TOOLS REQUIRED:**  
 Torx Wrench, T30 (Turn Signal Removal)  
 Torx Wrench, T40  
 Allen Wrench, 6mm  
 Allen Wrench, 4mm



## PREPARATION

 Right and left side of motorcycle is determined while sitting on the bike.

Position the motorcycle securely on its stand.  
Cover the front fender while you work.

### R12R MODELS WITH SMALL TURN SIGNALS

There is no need to remove turn signals. Turn signal housing will fit through bracket.

GO TO PAGE 3. FIGURE 1

### R12R MODELS WITH LARGE TURN SIGNALS, FIGURE 2

1. Remove headlight shroud. **Figure 3**

2. Disconnect Turnsignals. **Figure 4**

3. Remove turnsignal. (**T30 Torx Wrench**) **Figure 5**

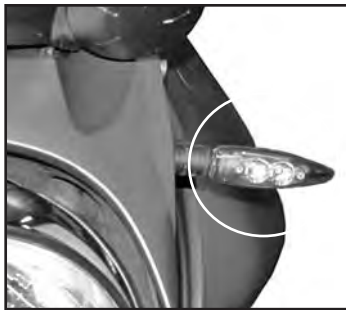

Figure 1, Small Turn Signals



Figure 2, Large Turn Signals



Figure 3



Figure 4



Figure 5

## INSTALLATION

 Remove and install the brackets to motorcycle one side at a time.

### 1. MOUNT POINT-A

Remove the Left side screw only, from the head light bracket located on the underside of the upper triple tree clamp. (T40 Torx Wrench) Figure 6.

**Retain the OEM compression spacer. It will be re-used.**

**Screw will not be re-used**

### 2. MOUNT POINT- B

Remove the Left side screw and compression spacer from the headlight bracket located on the outside of the upper triple tree clamp. **Screw and Compression Spacer will not be reused.** (T40 Torx Wrench) Figure 7.

### 3. INSTALL BRACKET

#### MOUNT POINT- A

Secure mount point A using original OEM Compression spacer and a 45mm Screw (7). (6mm Allen Wrench) Figure 8b

#### MOUNT POINT-B

Secure mount point B using supplied Standoff (8) and a 45mm Screw (7) (6mm Allen Wrench) Figure 8a and 8c

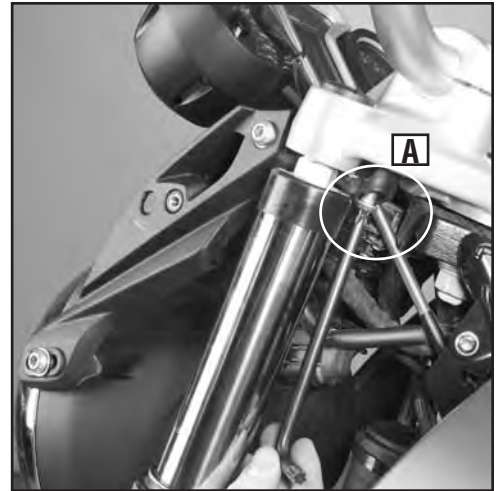

Figure 6

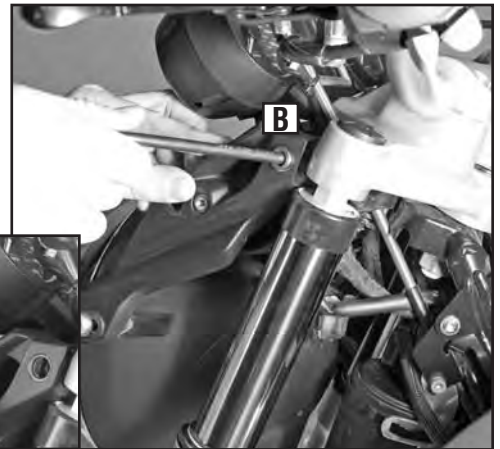

Figure 7

4. Tighten all fasteners securely. (6mm Allen Wrench)

5. Follow the same procedure for the Right side of motorcycle.

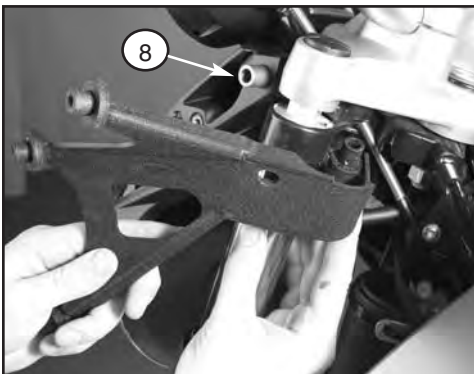

Figure 8a

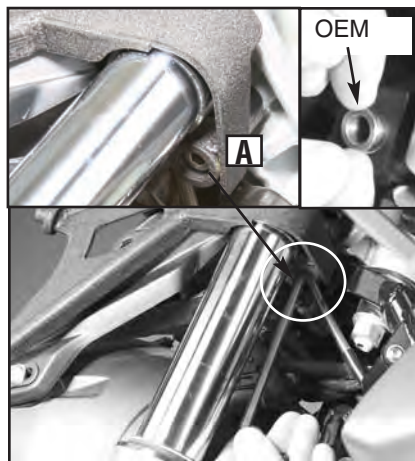

Figure 8b



Figure 8c

 **R12R MODELS WITH LARGE TURN SIGNALS**

Route turn signal through bracket and re-install turn signal. Check operation of turn signals. (T30 Torx Wrench) Figure 9

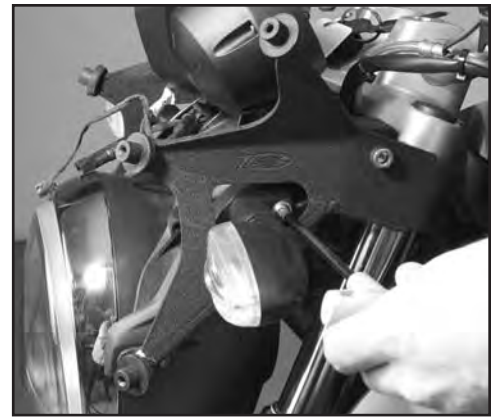

Figure 9, Large Turn Signals

Install shroud. Figure 10



Figure 10, Large Turn Signals

**6. INSTALL WINDSHIELD**

Insert grommets (6) into windshield. Figure 11

Flex shield, to align holes with the mount points.  
Figure 12

Install aluminum caps (5) using the M6 Screws (4)  
(6mm Allen Wrench) Figure 13

Tighten securely. (4mm Allen Wrench)



Figure 11

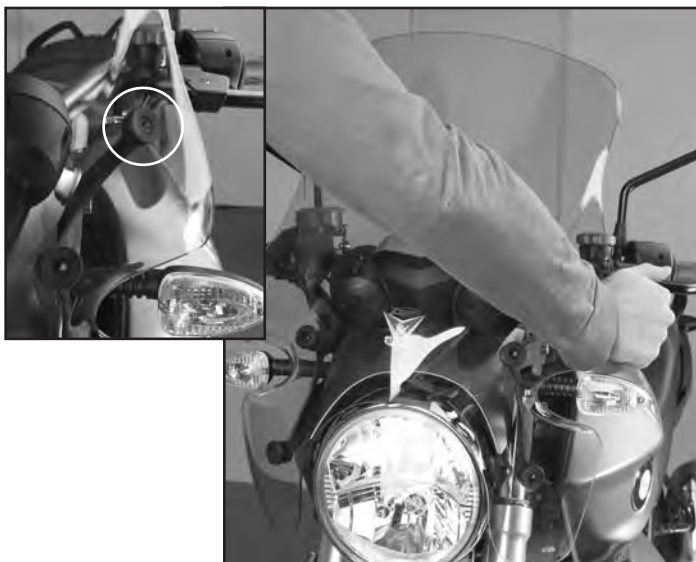

Figure 12



Figure 13



## MAINTENANCE

To clean the screen, wash with a clean soft cloth, plenty of warm water and if necessary, a non-abrasive soap such as dishwashing liquid. Flannel or soft chamois make good cleaning cloths. **Paint, glue residue or grease removal:** Moisten cotton with Naphtha or Turpentine followed by a wash as above. National Cycle Shield Wash™ makes a good daily cleaner and comes with a handy travel size bottle. N1401 Shield Wash is safe for helmet visors.

Do not clean polycarbonate in hot sun or high temperatures. Do not clean the screen with glass cleaners. Do not use rain protective products on the screen other than National Cycle brand Rain Zip®, Part No. N1410-01. Do not allow brake fluid, alcohol, or strong solvents to contact the screen.



Small Turn Signals

Large Turn Signals



N1401-01



N1410-01

## WARNING

Never ride your motorcycle with loose accessory mounting hardware. Check the hardware for tightness regularly.

Today's motorcycles are built with enough frame rigidity to withstand the moderate loads imposed on them by the foreseeable addition of an accessory(ies). If an accessory(ies) adversely affects your motorcycle's stability, immediately remove the accessory(ies). Do not ride a motorcycle that exhibits unsafe handling traits.

Have experienced service personnel correct any problem before riding with the accessory(ies) installed. For further questions concerning handling problems associated with an accessory(ies), contact your dealer, motorcycle manufacturer, or accessory manufacturer.

Sunlight reflected off the inside curvature of the windscreen can, at certain times of day, cause extreme heat buildup on the motorcycle's instruments and possibly even melt them. Exercise care in parking to avoid this. Park your motorcycle facing the sun or place an opaque object over this area.



### ZTechnik 3-Year Limited Warranty

Register your windshield on Line at: [www.ZTechnik.com](http://www.ZTechnik.com)

ZTechnik hereby warrants to the original registered owner of a ZTechnik polycarbonate windshield for a period of three years from the date of purchase against breakage. This limited warranty is expressly limited to the replacement of the polycarbonate windscreen. This limited warranty does not include scratches, coating failure, cosmetic wear and tear, replacement of hardware, or any consequential damages or expenses including labor cost of installation, removal and/or replacement, inconvenience, inbound freight expenses or damage to any other component of the motorcycle or any other accessories. Certain chemicals, generally known as acidic hydrocarbons, are known to cause polycarbonate damage and will not be covered under this limited warranty. Please refer to the cleaning instructions supplied with all ZTechnik windshields.

Visit [www.ZTechnik.com](http://www.ZTechnik.com) for further details or call or write ZTechnik / PO Box 158 / Maywood, IL 60153 / 708-3430400

ZTechnik PO Box Maywood, IL 60153-0158 USA

708-343-0400 / Fax: 708-343-0625 / [www.ZTechnik.com](http://www.ZTechnik.com) / e mail: [info@ZTechnik.com](mailto:info@ZTechnik.com)

©2011 National Cycle, Inc.

Page 5 of 5

10-118585-000 12/11