



EVOTECH®
P E R F O R M A N C E

Kawasaki Z650
SP Connect Sat Nav Mount

Installation Instructions



For SP Connect mirco stem mount alu Part number #53122
follow instructions 1 - 16

For SP Connect anti vibration module Part number #53135
follow instructions 17 - 30



Kit Contents

- Ⓐ 1 x M6 x 16 Countersunk Screw
- Ⓑ 1 x Pivot Plate
- Ⓒ 1 x SP Connect Plate
- Ⓓ 1 x Mounting Bracket
- Ⓔ 2 x Nord Washer
- Ⓕ 2 x M5 x 10mm Caphead Bolts
- Ⓖ 2 x M5 x 12mm Caphead Bolts

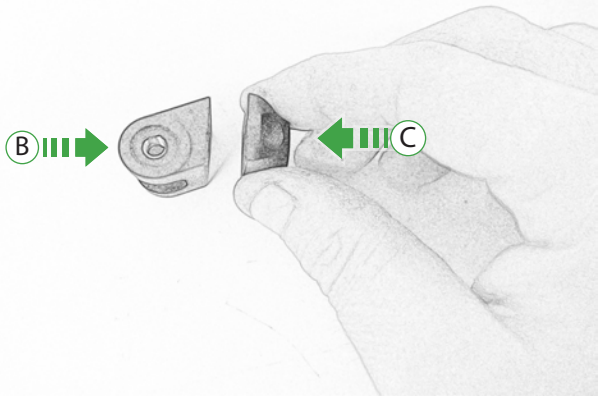

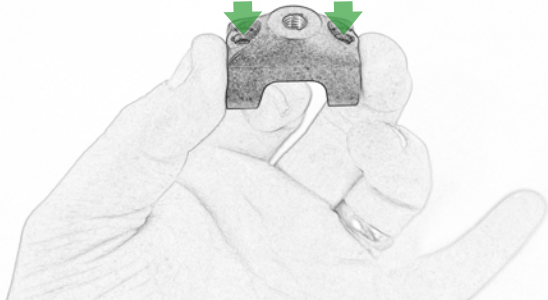

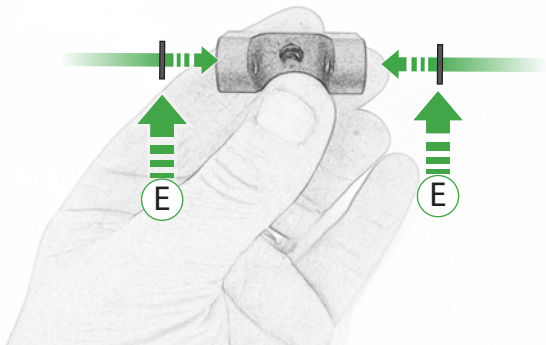

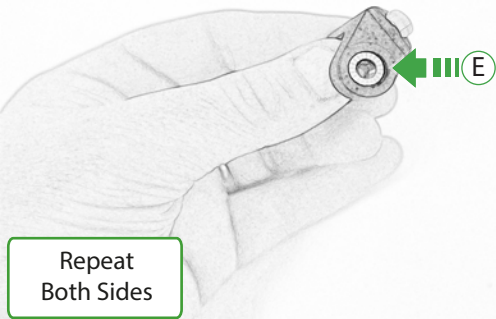

Repeat
Both Sides

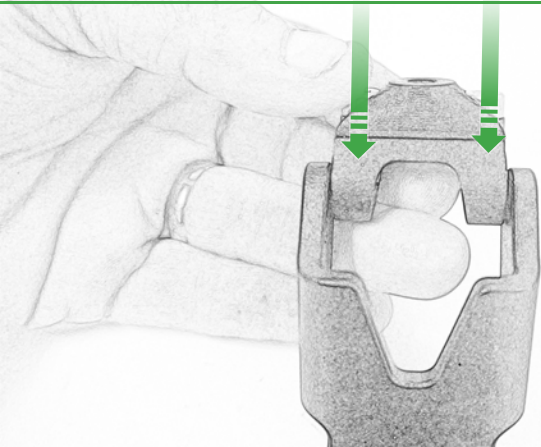

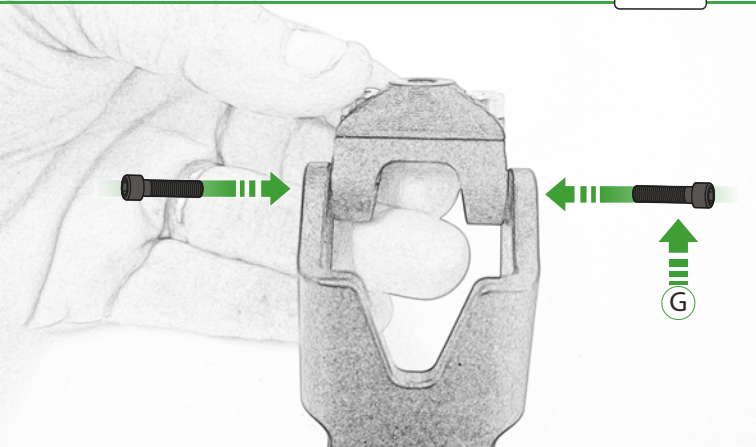



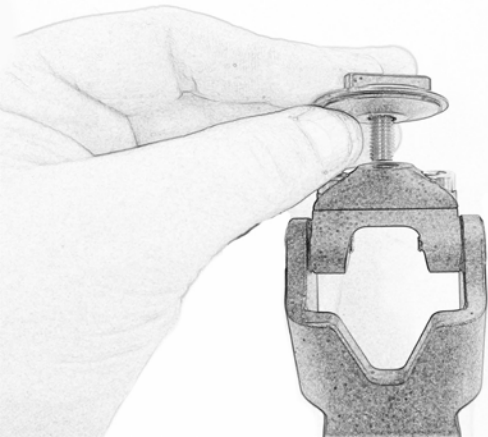

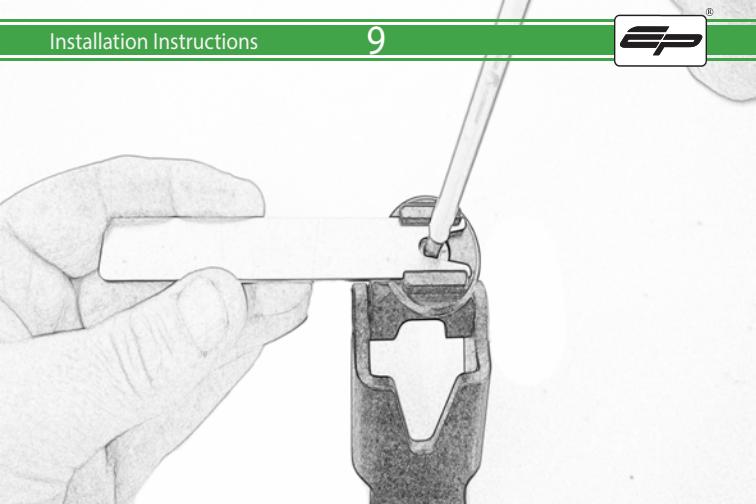

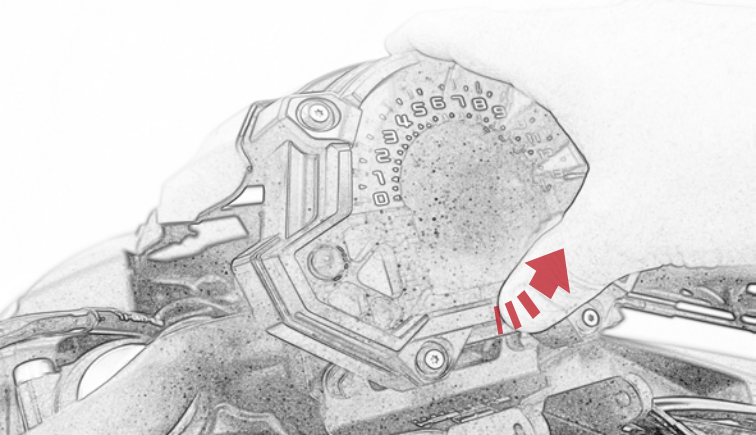

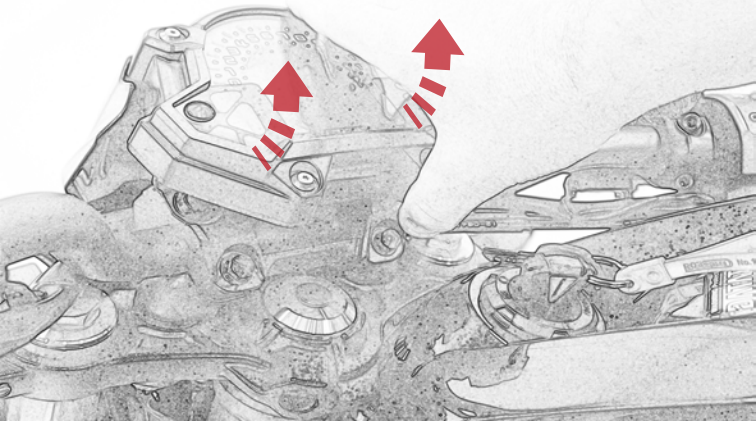

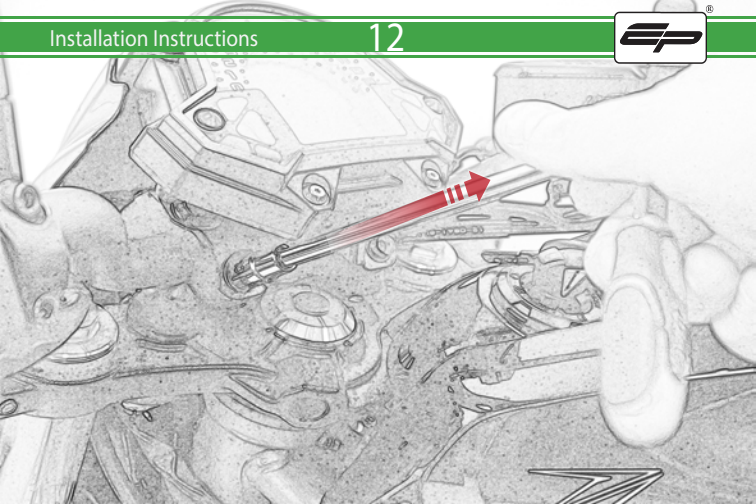

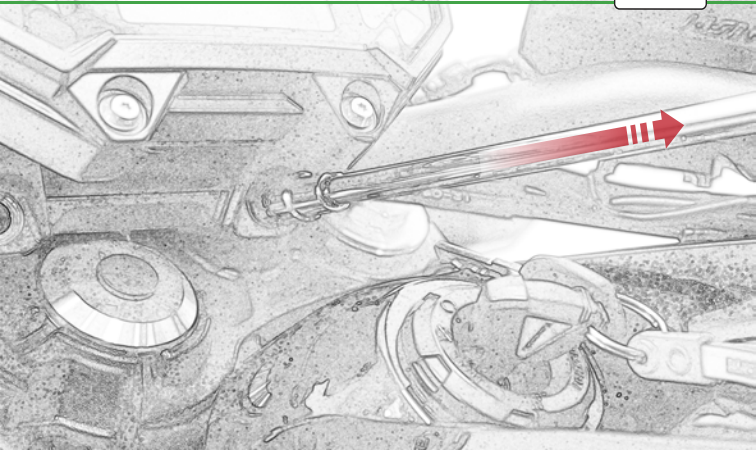

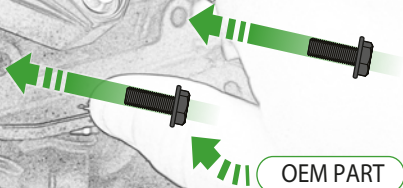
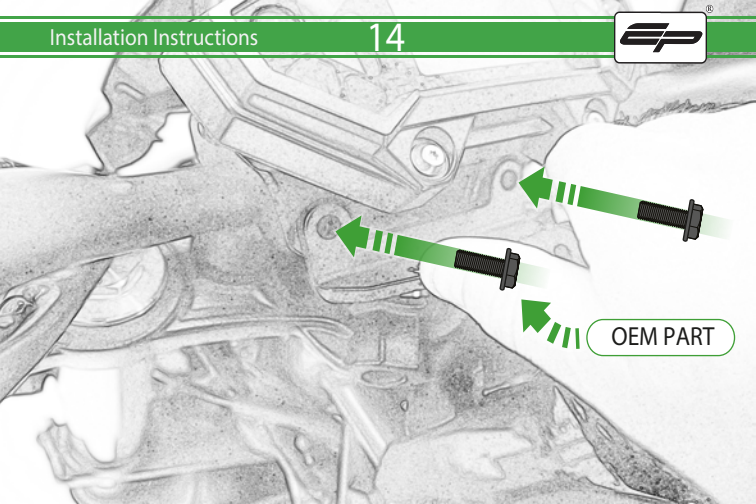

OEM PART

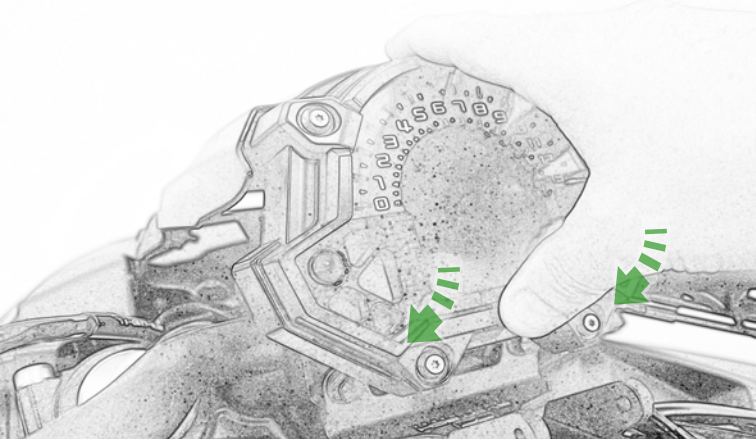



ESSENTIAL CHECKS



It is recommended that periodic inspections are made to ensure that all bolts are tightened to the specified torque settings.

Should the bike be involved in an accident a thorough inspection should be made and any components that have taken an impact, no matter how small, be replaced



Kit Contents

- (A) 1 x M6 x 16 Countersunk Screw
- (B) 1 x Pivot Plate
- (C) 1 x M5 Nyloc Nut
- (D) 1 x Mounting Bracket
- (E) 2 x Nord Washer
- (F) 2 x M5 x 10mm Caphead Bolts
- (G) 2 x M5 x 12mm Caphead Bolts

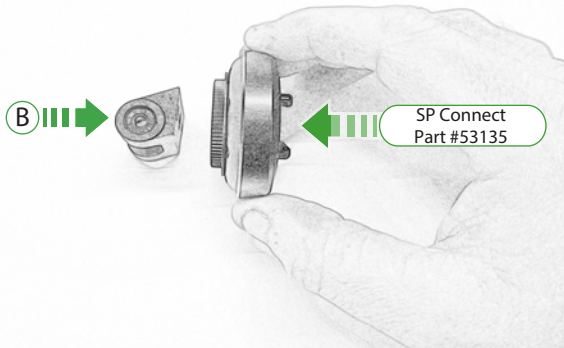



Supplied with
#53135

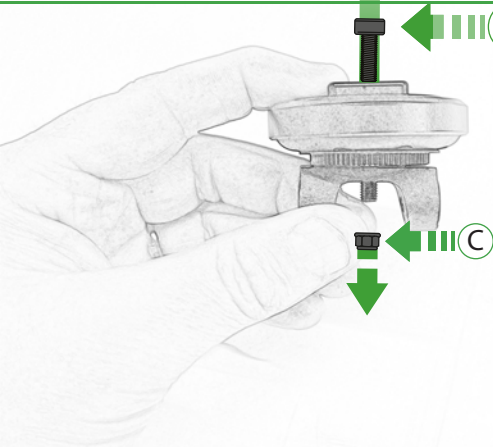

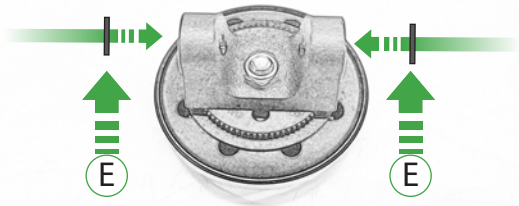

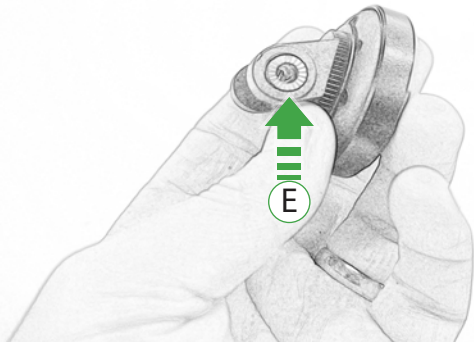

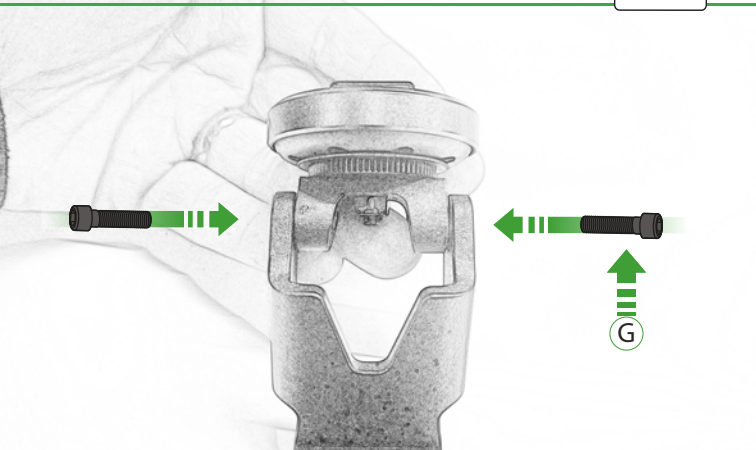

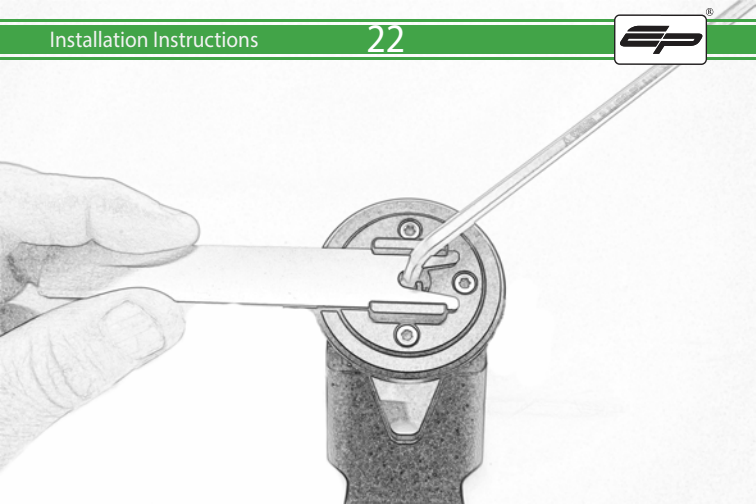

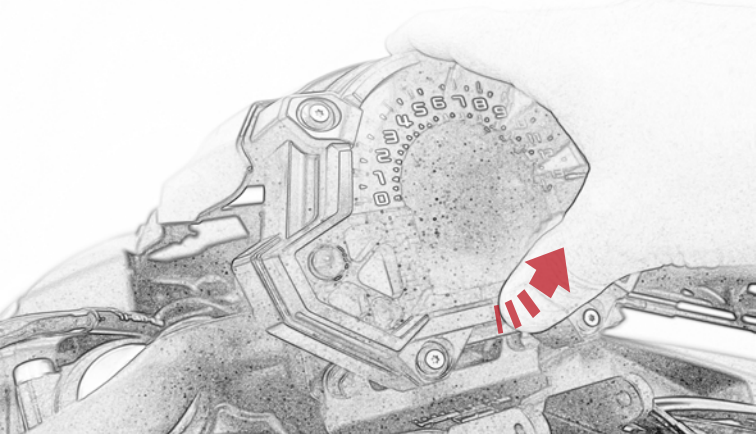

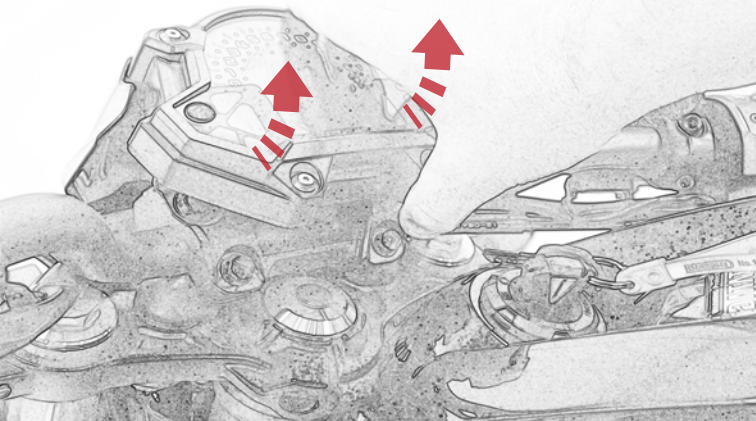

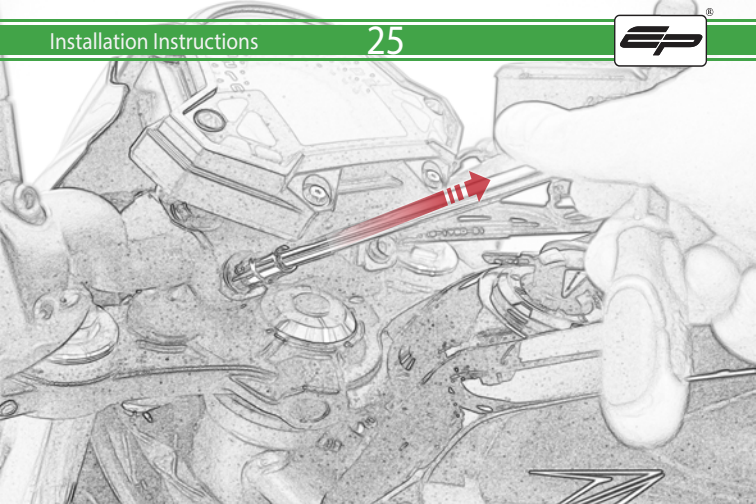

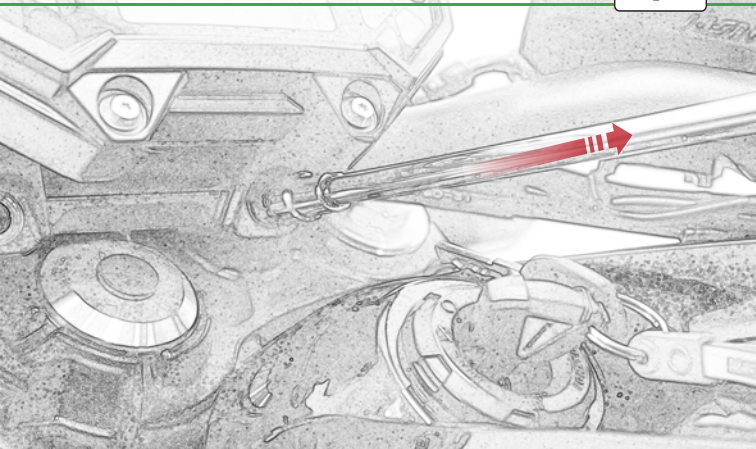

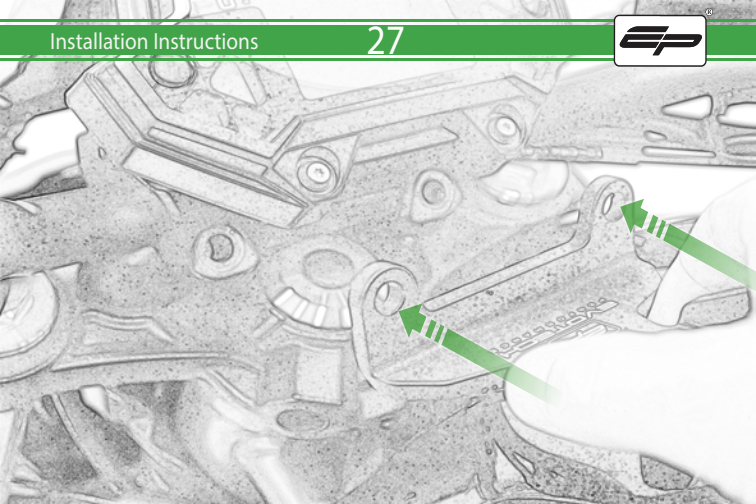

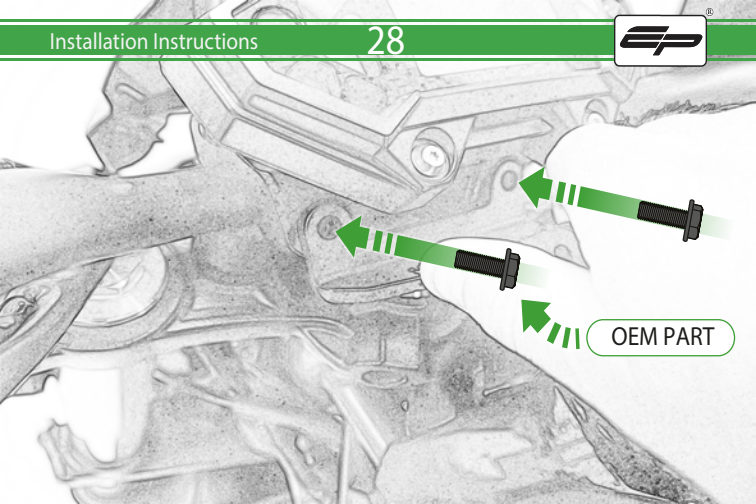

OEM PART

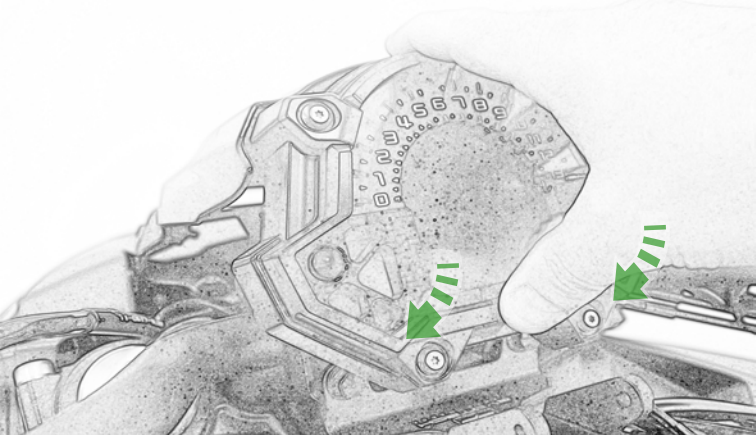



ESSENTIAL CHECKS



It is recommended that periodic inspections are made to ensure that all bolts are tightened to the specified torque settings.

Should the bike be involved in an accident a thorough inspection should be made and any components that have taken an impact, no matter how small, be replaced



EVOTECH®
P E R F O R M A N C E

www.evotech-performance.com