



EVOTECH®
P E R F O R M A N C E

Installation Instructions



KTM 1290 SUPERDUKE GT TAIL TIDY

Product Reference - 13248

Kit Contents

- | | |
|--|---|
| A 1 x Mounting Bracket | J 2 x Indicator Screws |
| B 1 x RH Arm | K 2 x Indicator Stems |
| C 1 x LH Arm | L 2 x M5 - 16 Cap Head Screws |
| D 1 x Licence Plate Bracket | M 2 x Indicator Extension Wires |
| E 1 x Neoprene Gasket | N 2 x Plastic Screws and Nuts |
| F 1 x M6 - 12 Countersink Screw | O 3 x M4 - 10 Button Head Screws |
| G 1 x M6 - 16 Trunion | P 4 x M6 - 16 Button Head Screws |
| H 1 x M5 - 12 Cap Head Screw | Q 5 x Cable Ties |
| I 1 x M5 Plastic Cap | |

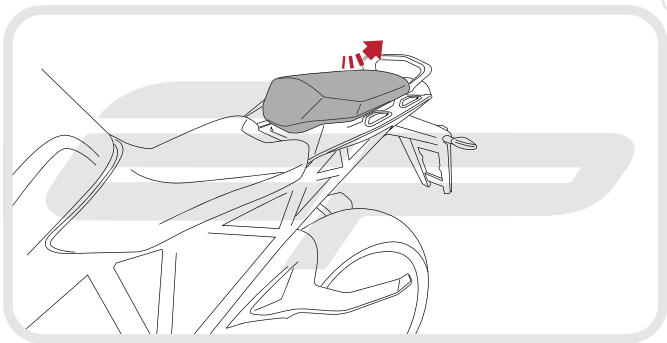

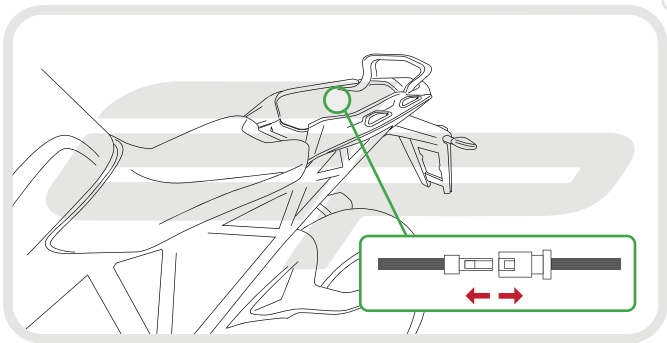

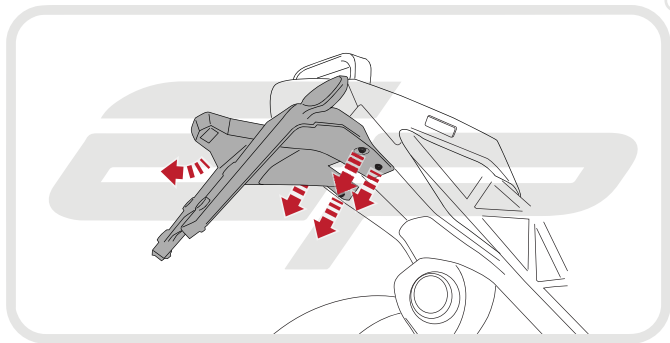

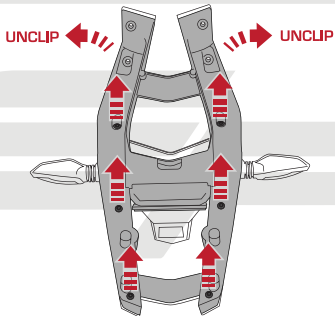

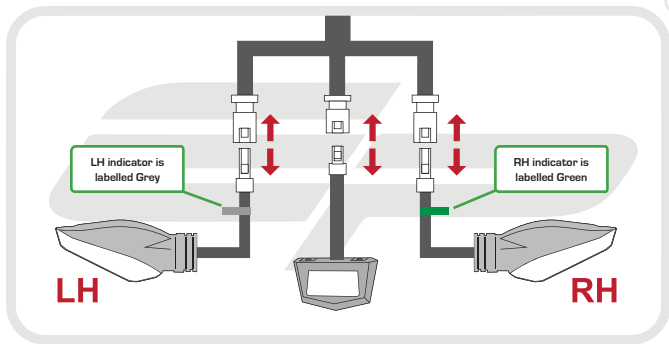

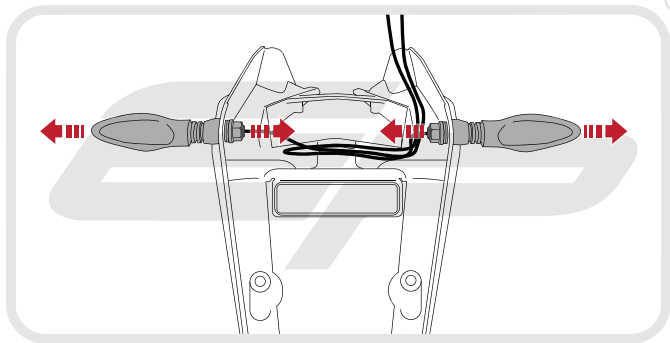

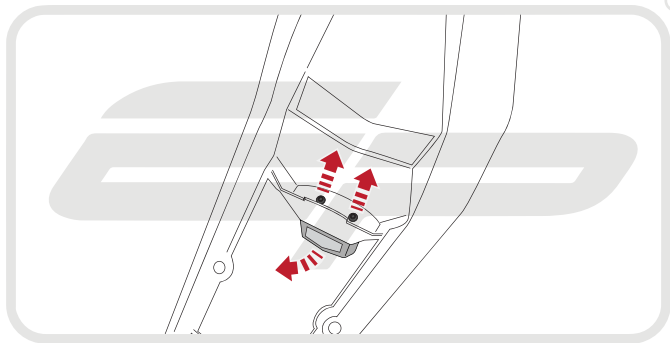

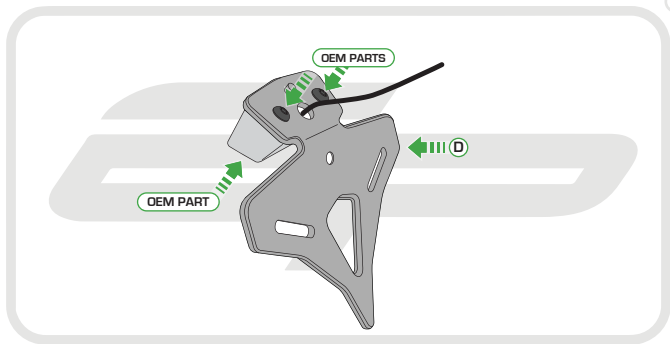

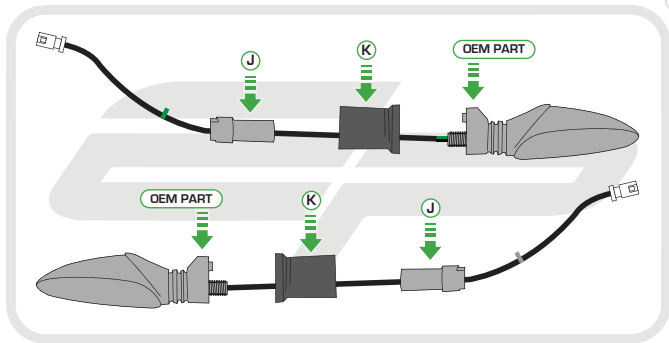

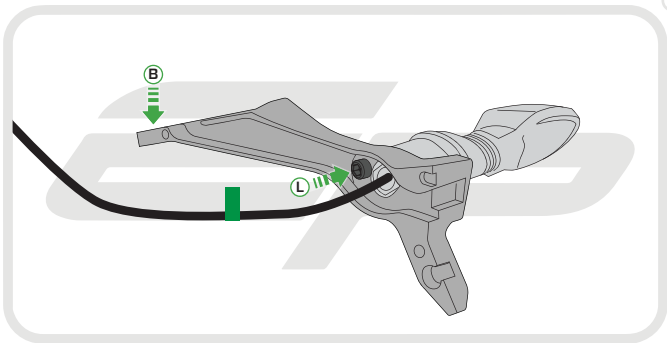

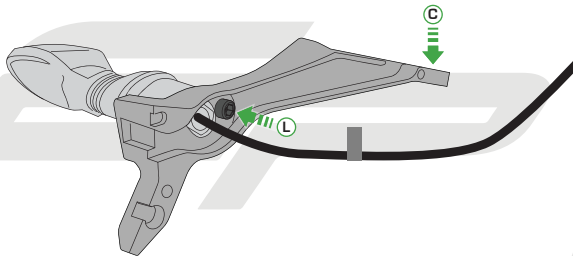



Caution

Ensure connectors are located
at the top of both arms

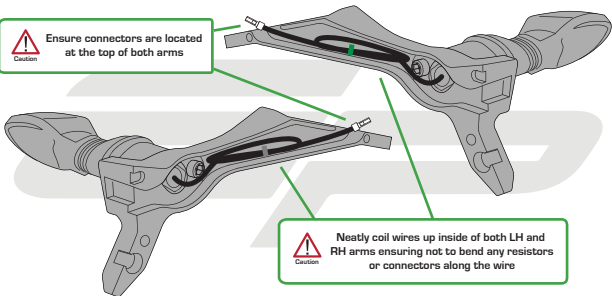

Caution

Neatly coil wires up inside of both LH and
RH arms ensuring not to bend any resistors
or connectors along the wire

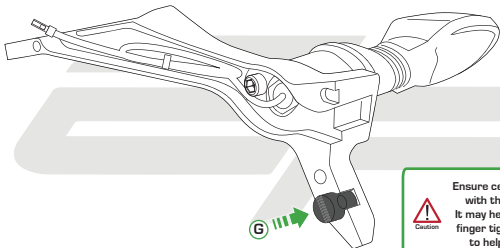



Caution

Locate pin in the rear of the licence plate holder into the slot in the RH arm

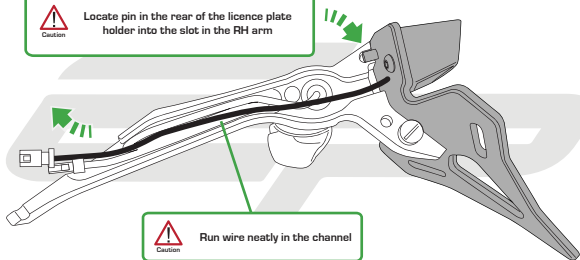

Caution

Run wire neatly in the channel



Caution

Bring LH and RH arms together
ensuring wires site in the channels
and do not get trapped

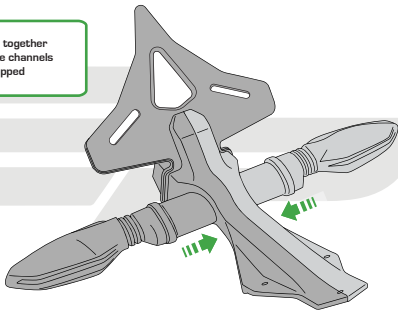

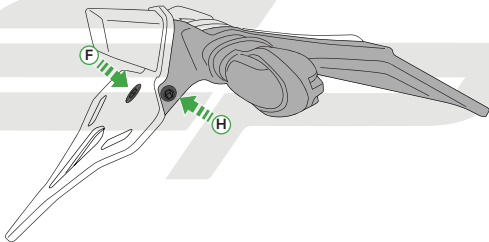

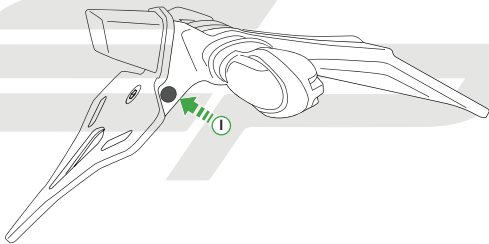

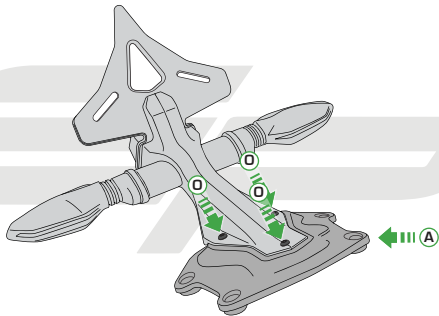

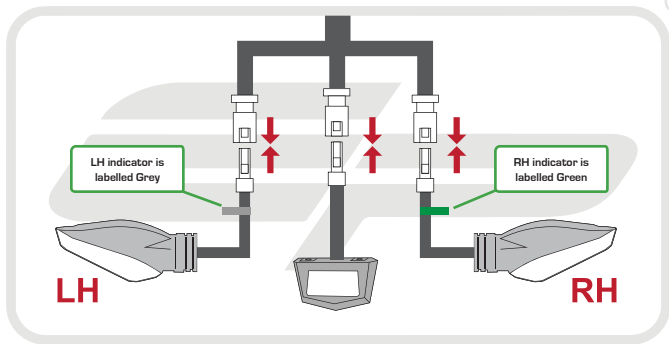

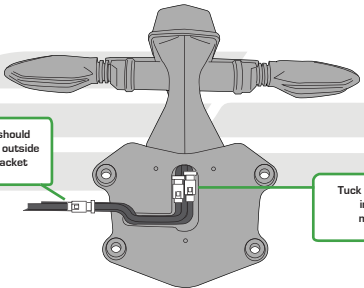

Licence plate light should be long enough to sit outside of the mounting bracket

Tuck indicator connectors in the slot on the mounting bracket

Carefully peel off yellow backing paper from neoprene gasket

Pull wires through hole in the gasket and firmly stick down

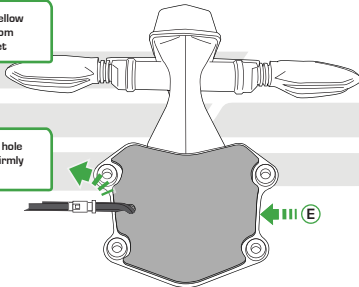

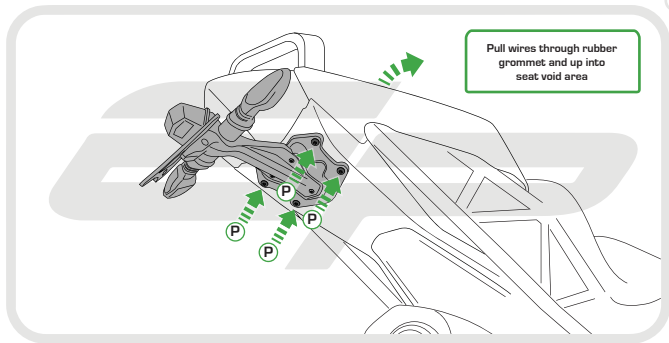



Reverse Stage

2,1

Reflector Bracket Installation

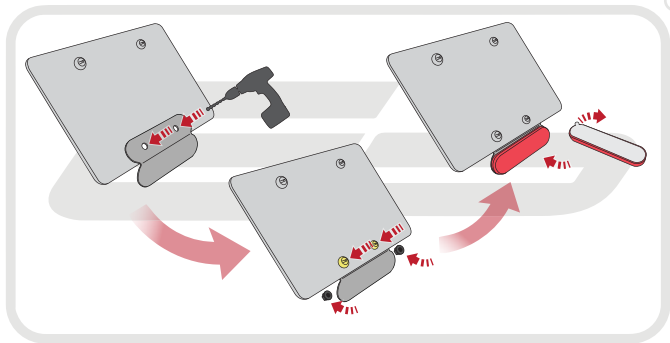

EVOTECH[®]
P E R F O R M A N C E



 **ESSENTIAL CHECKS** 

After installation of your tail tidy ensure that the licence plate does not contact the rear tyre when suspension is fully compressed.

Ensure all electrics including indicators, tail light, brake light and licence plate light lights are working correctly before riding the motorcycle.

It is recommended that periodic inspections are made to ensure that all fixings are fully tightend.



EVOTECH®
P E R F O R M A N C E

www.evotech-performance.com