



**EVOTECH**®  
P E R F O R M A N C E

[www.evotech-performance.com](http://www.evotech-performance.com)

Triumph Tiger 660 Sport  
Tail Tidy



- (A) 2 x Indicator Stems
- (B) 2 x M6 x 60 Caphead Bolt
- (C) 2 x M6 x 12mm Black Button Head Bolt
- (D) 2 x M6 x 16mm Caphead Bolt
- (E) 4 x M4 x 5mm Black Button Head Bolt

EVOTECH<sup>®</sup>  
P E R F O R M A N C E





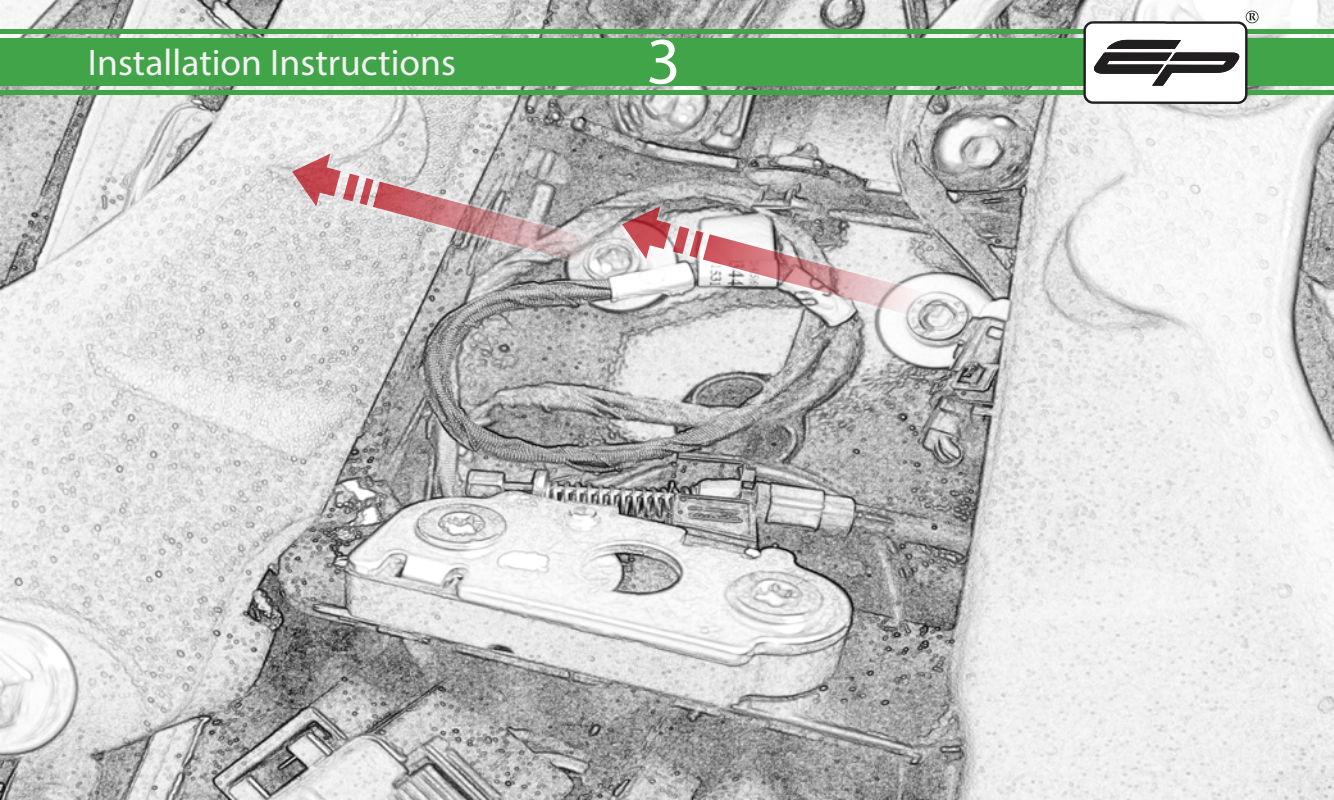

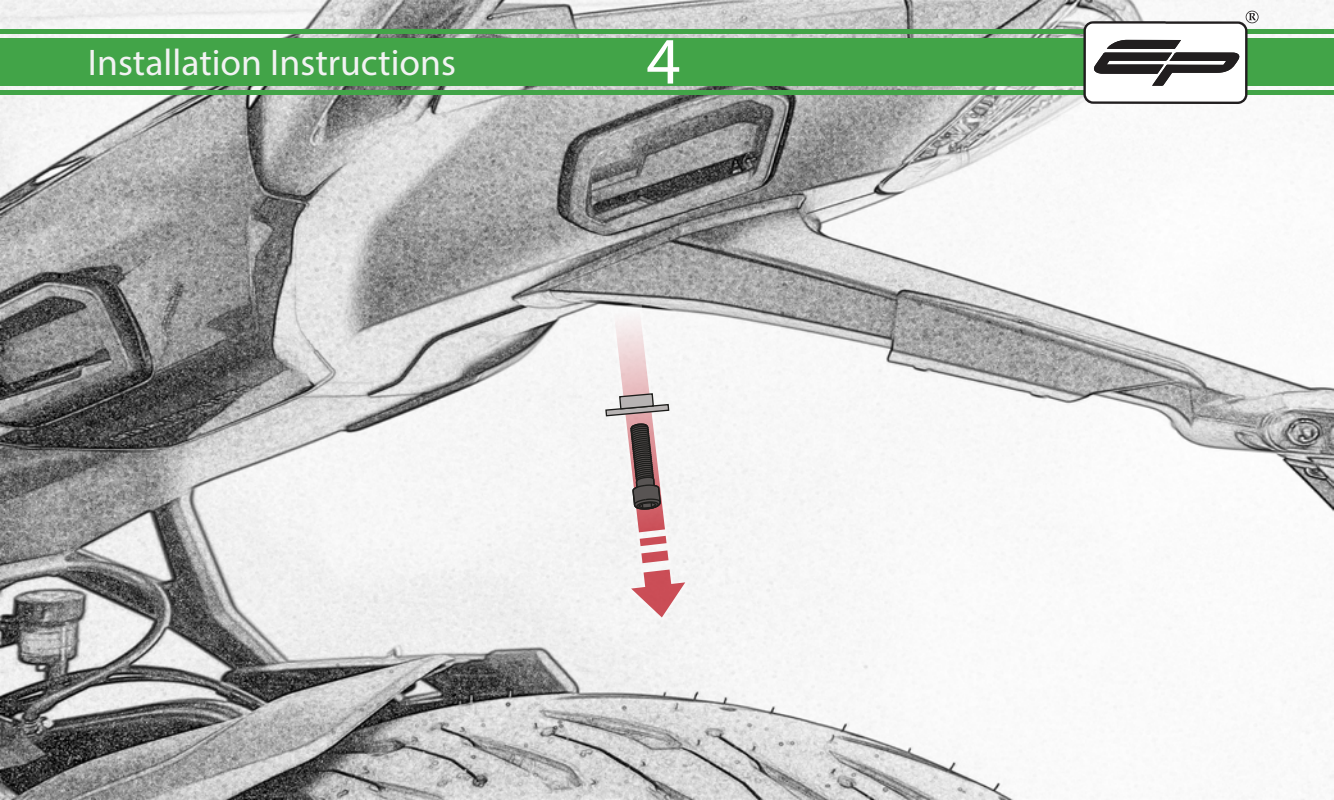

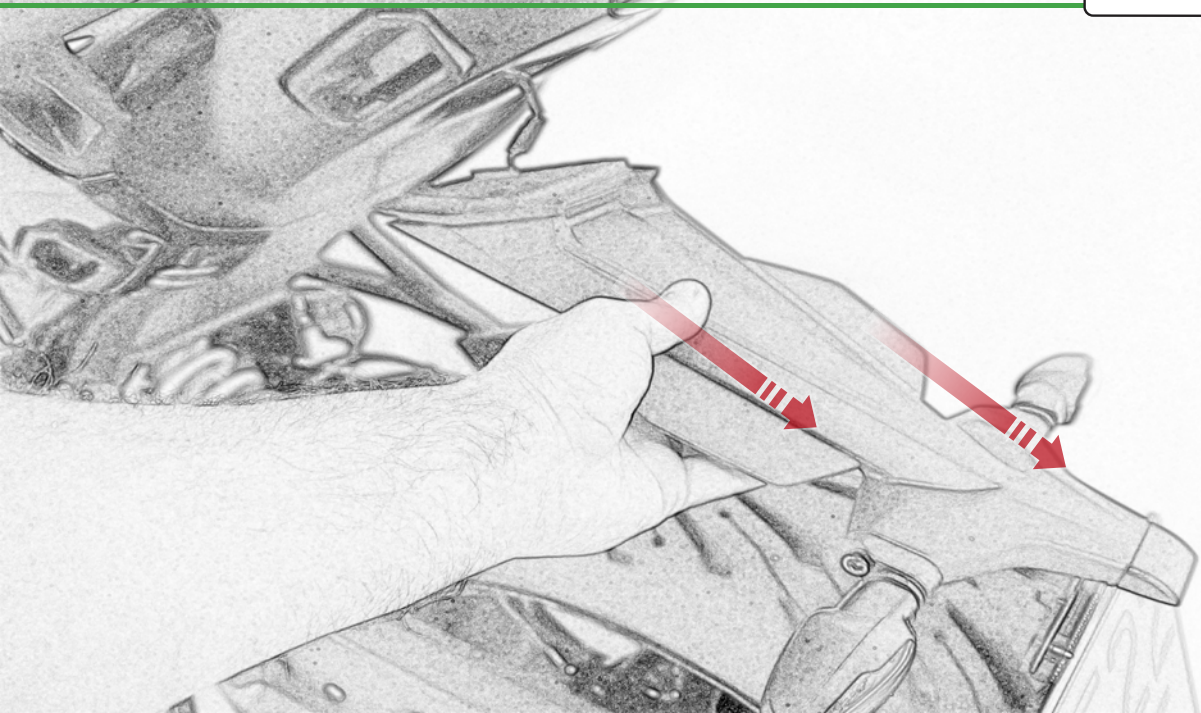

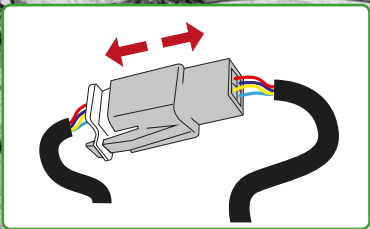
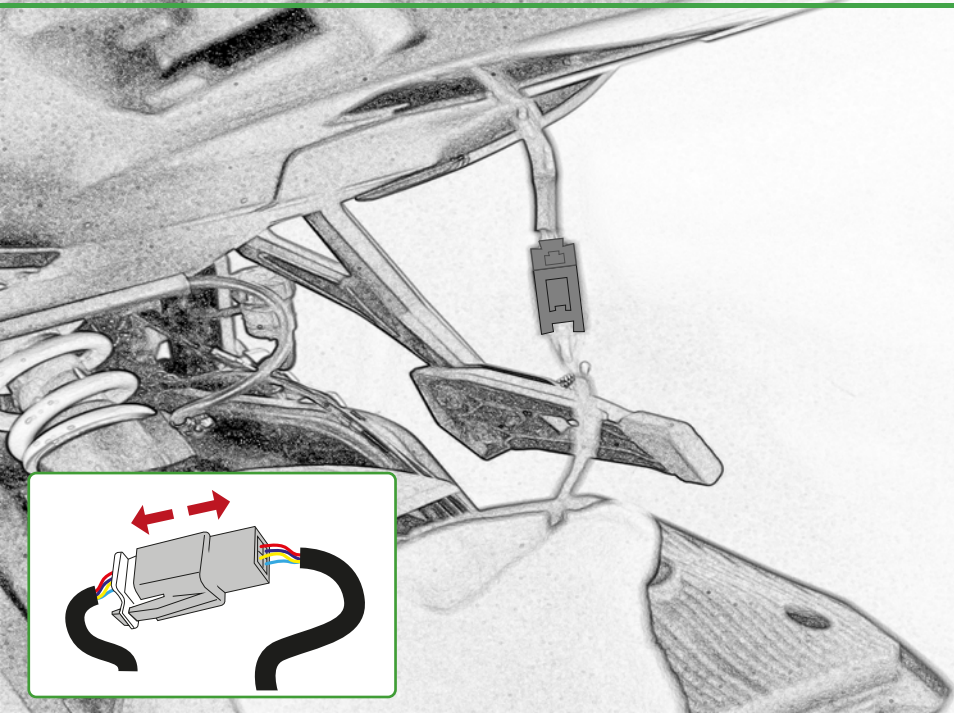



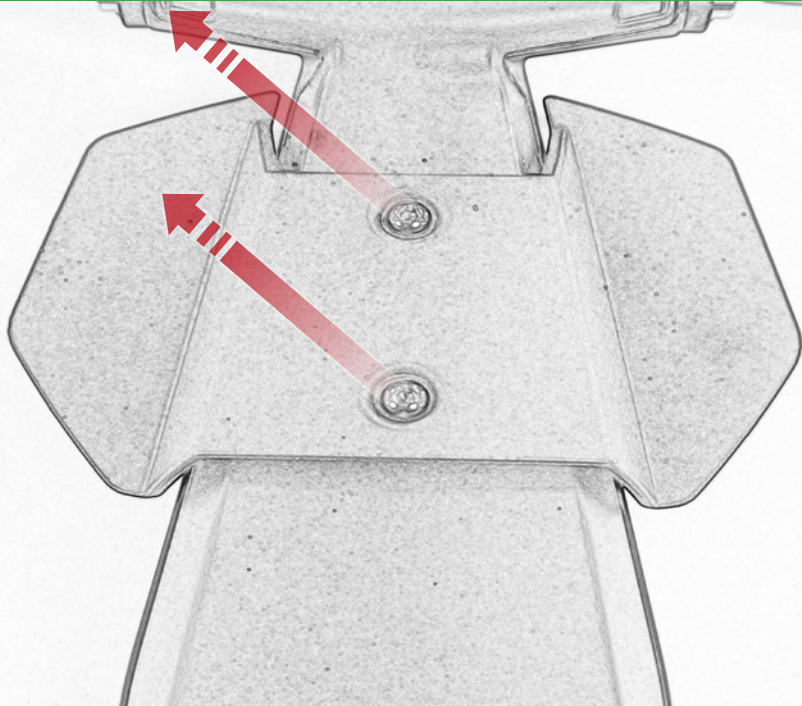

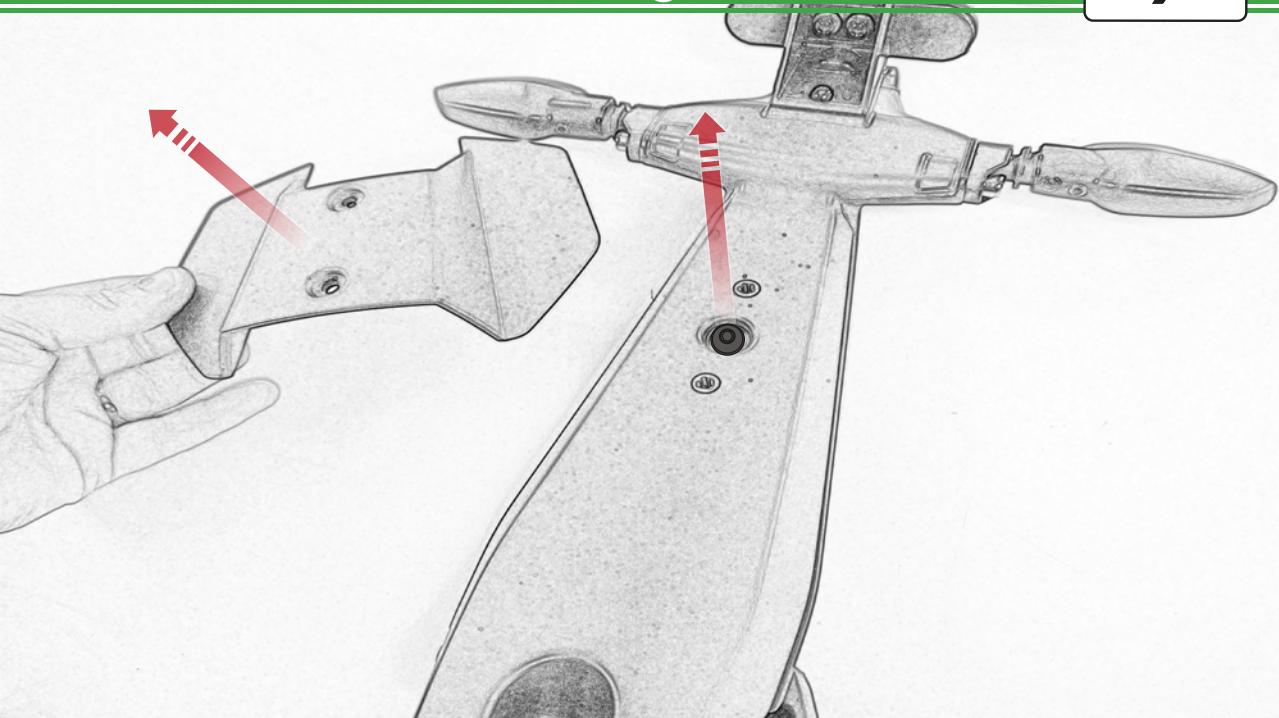

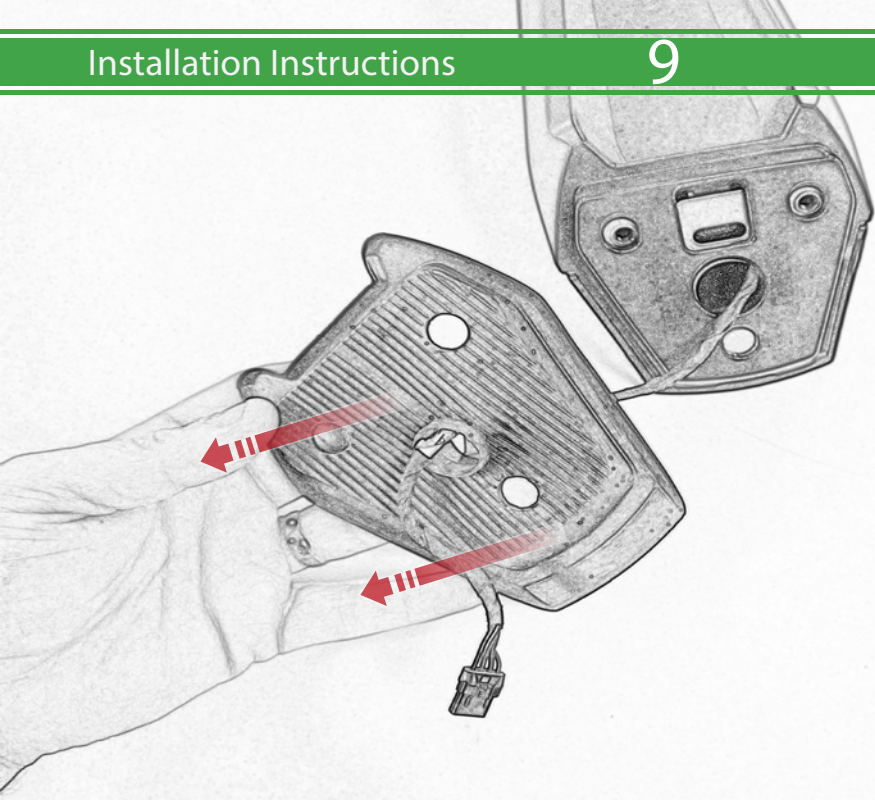

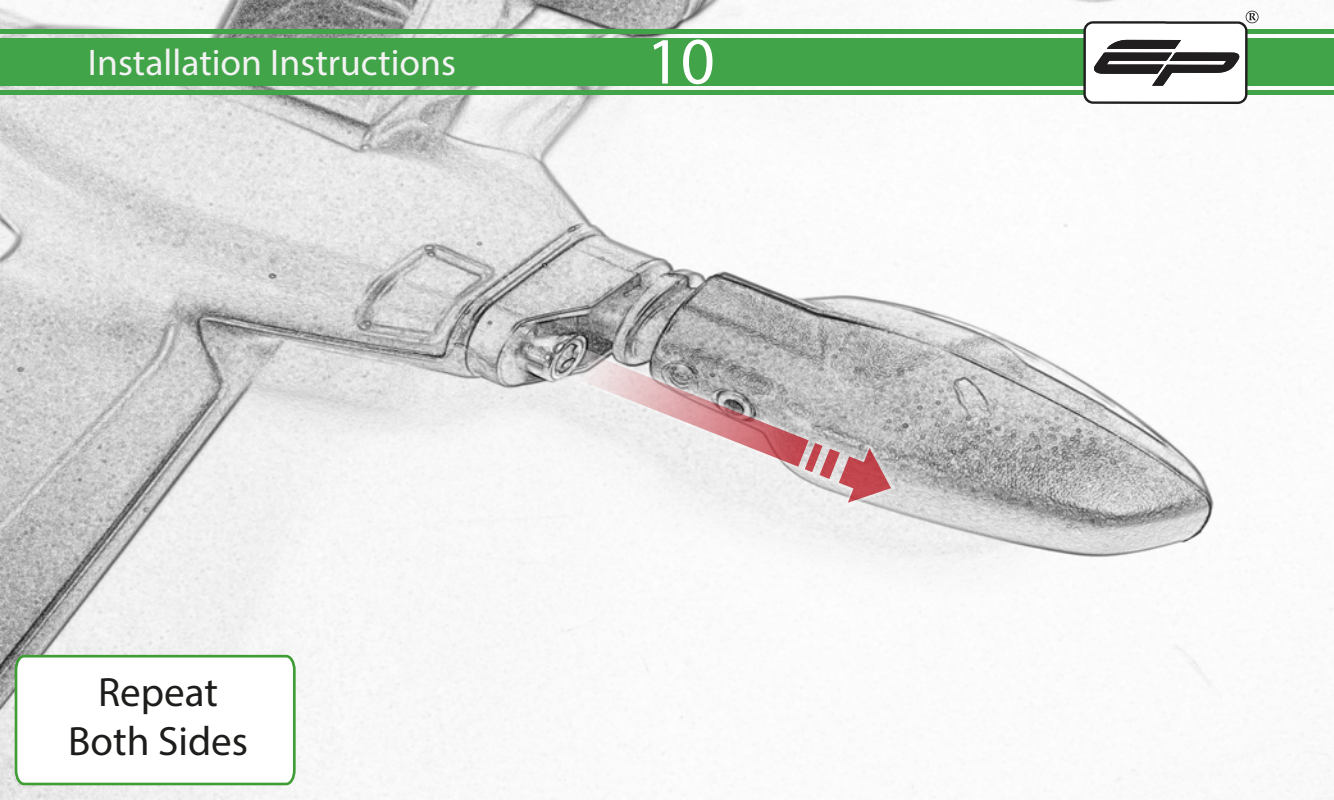

Repeat  
Both Sides

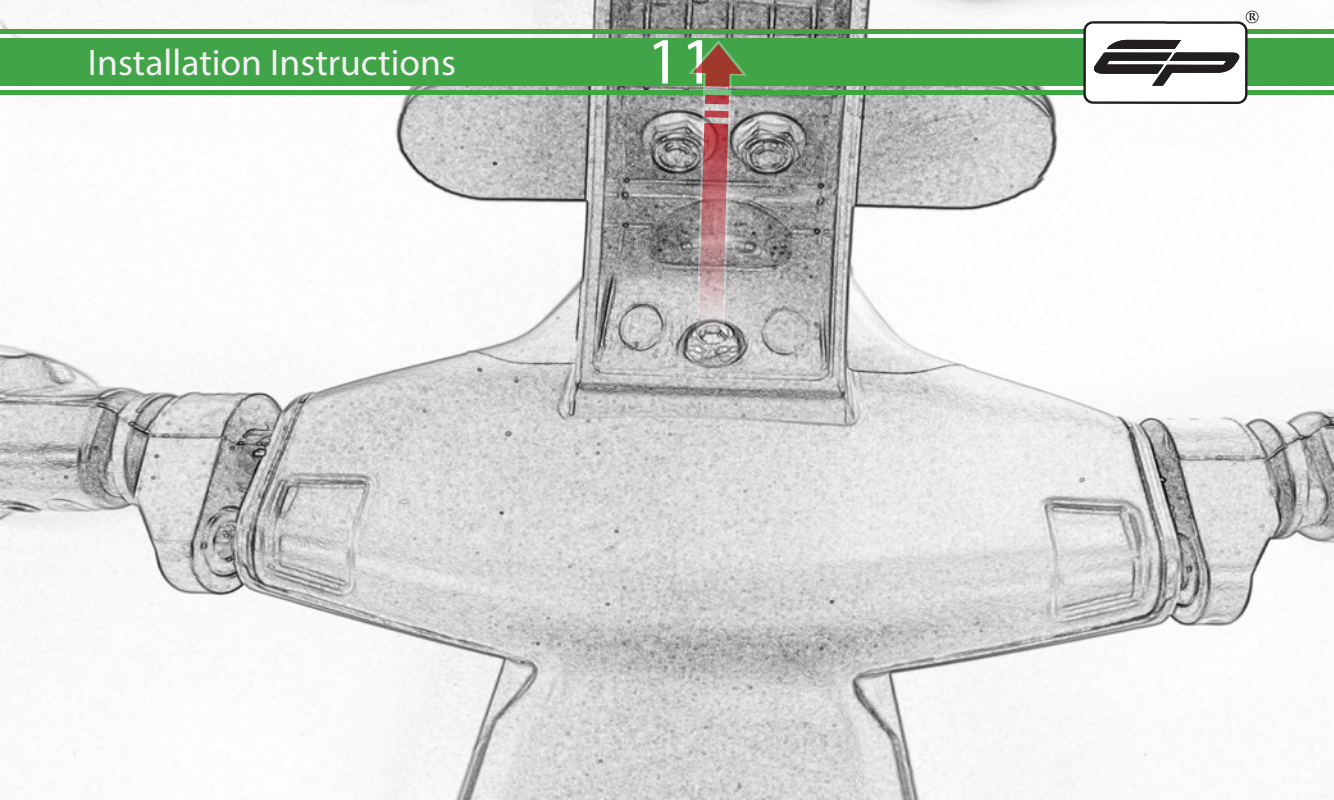

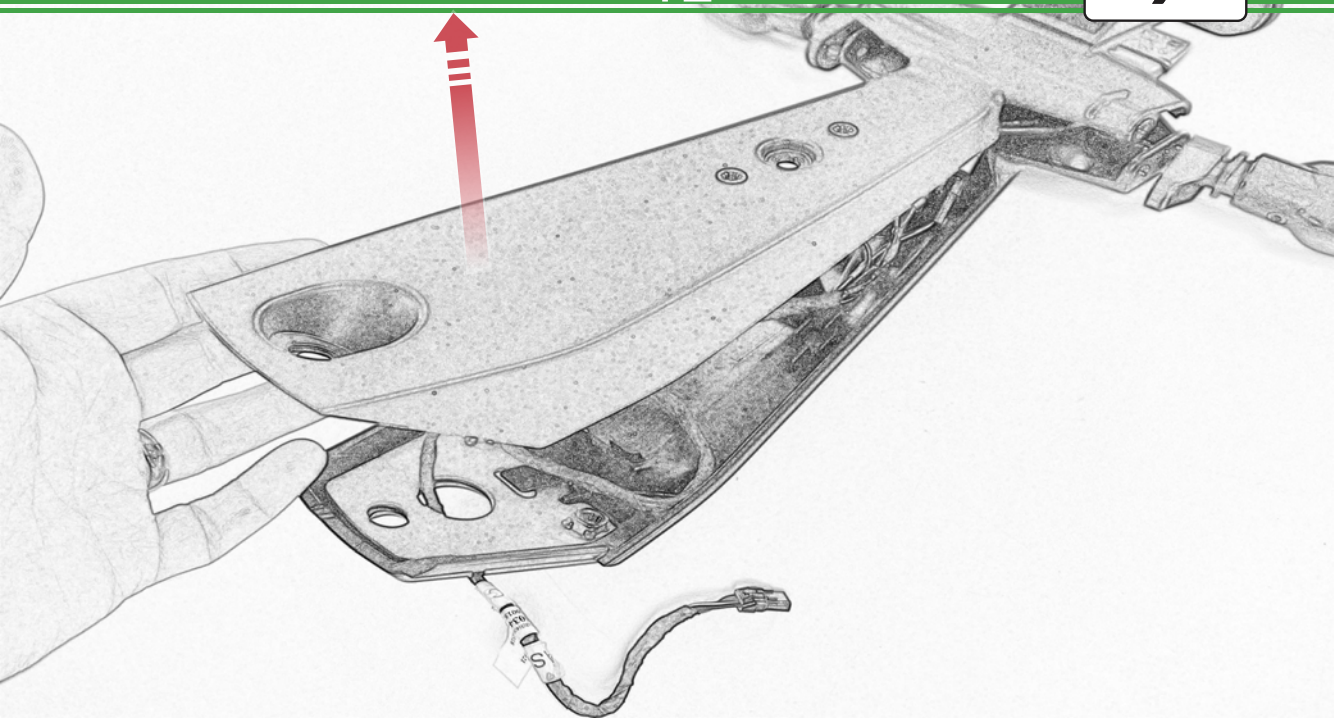

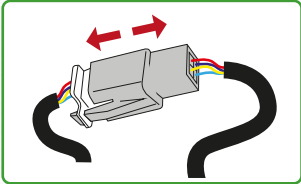
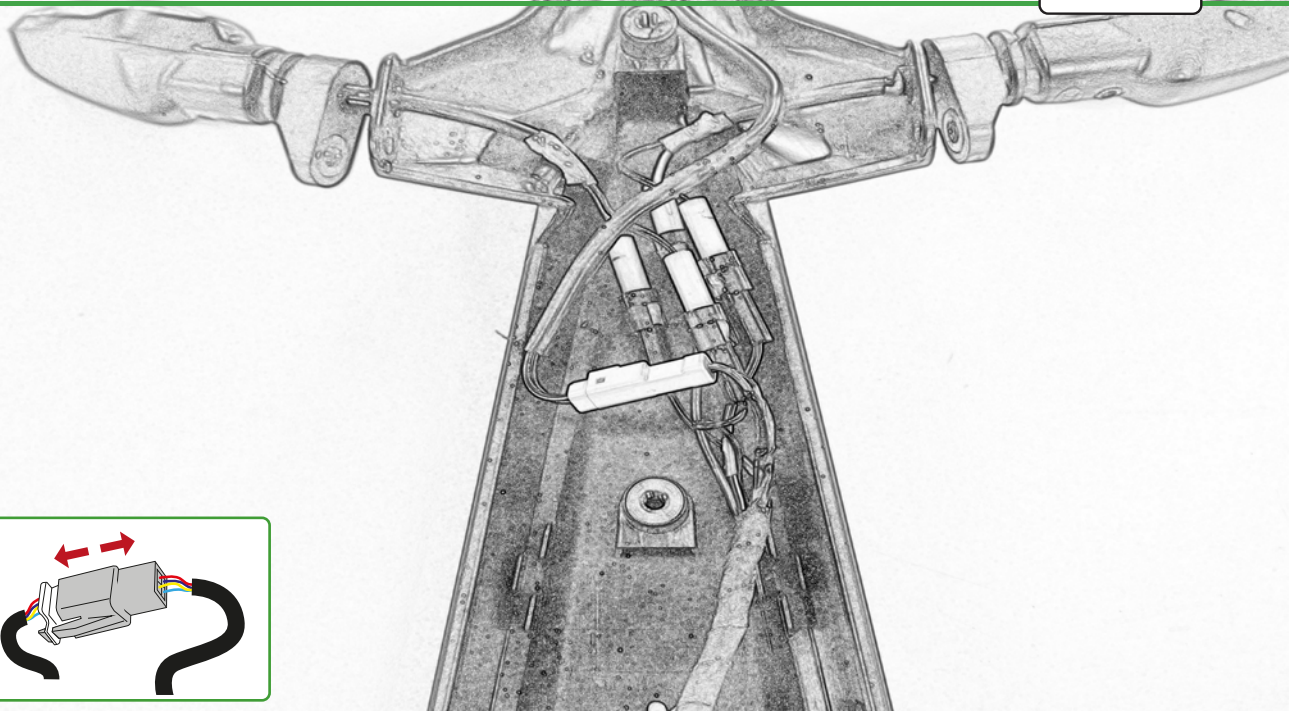

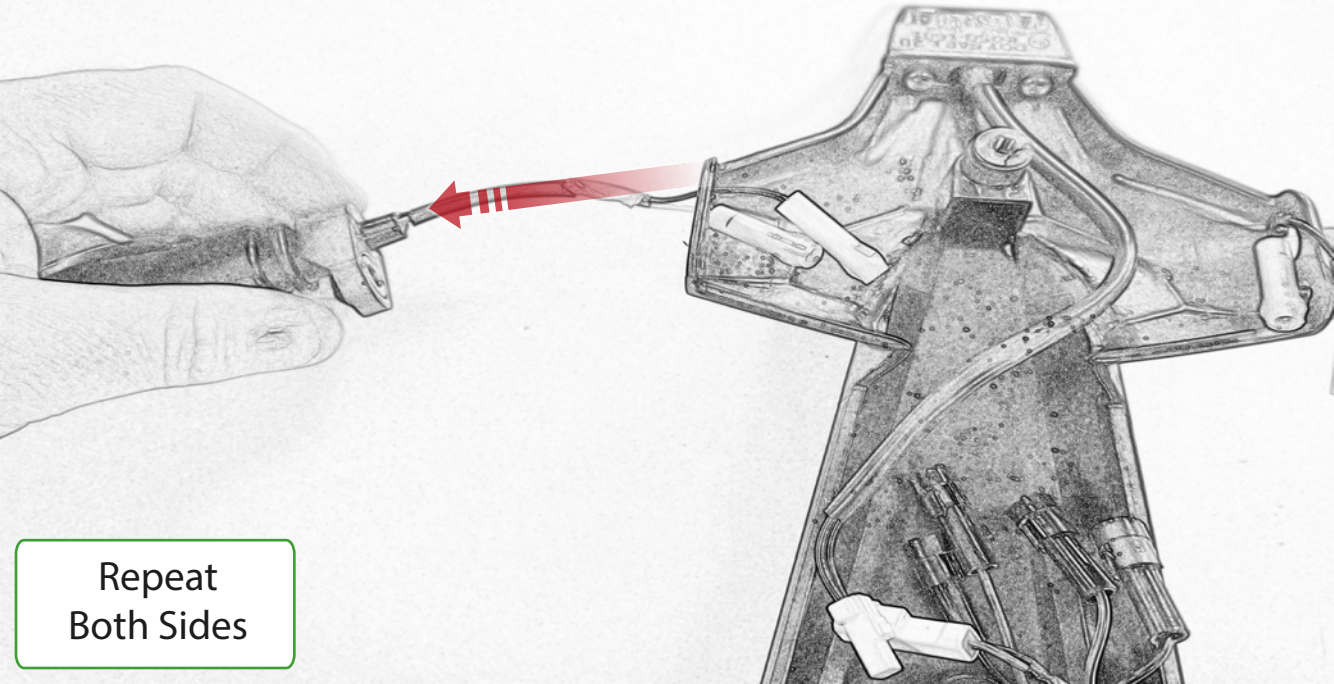

Repeat  
Both Sides



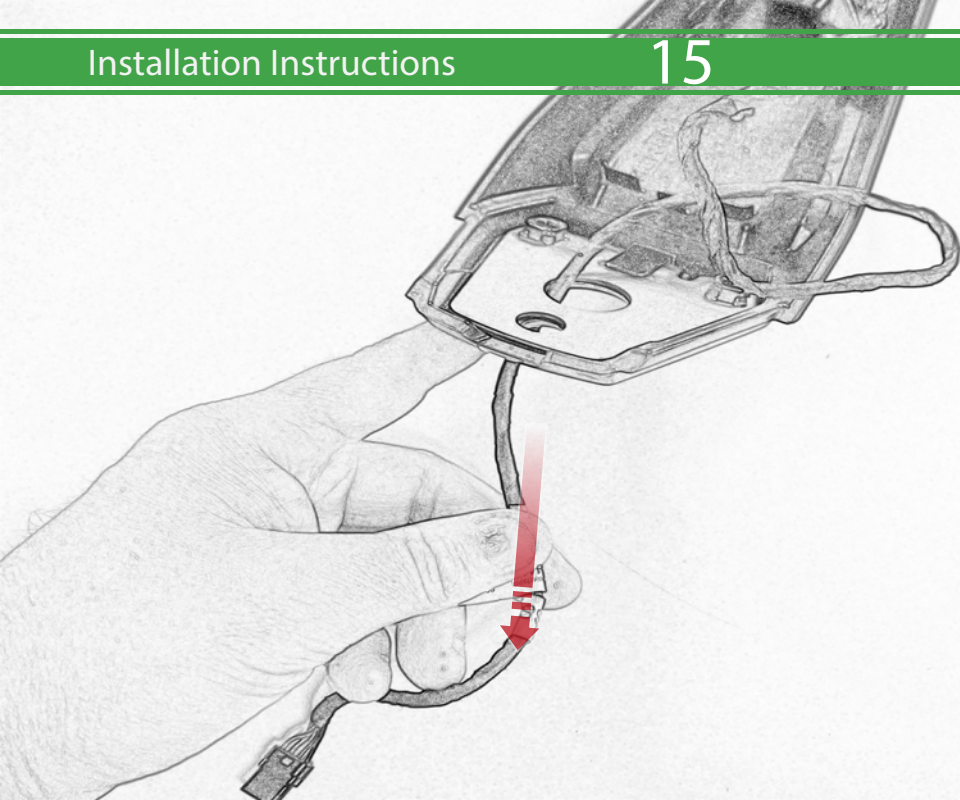

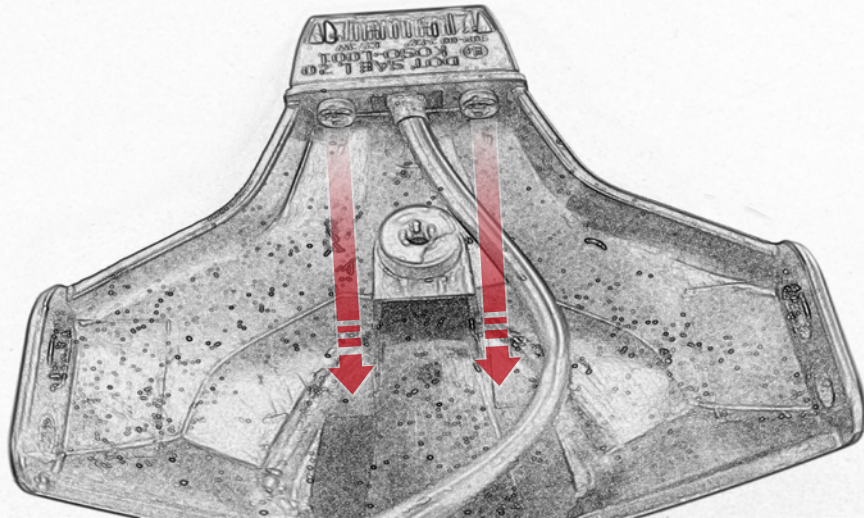

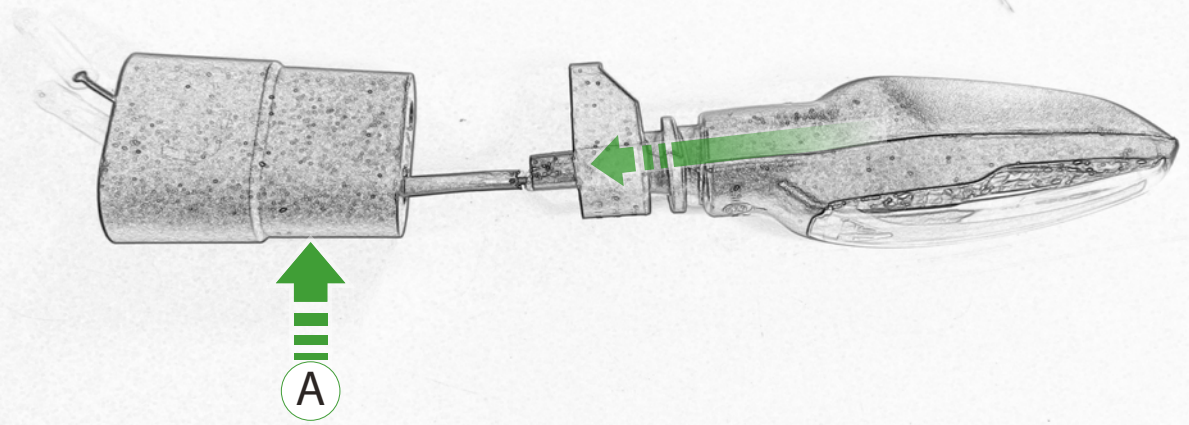

Repeat  
Both Sides

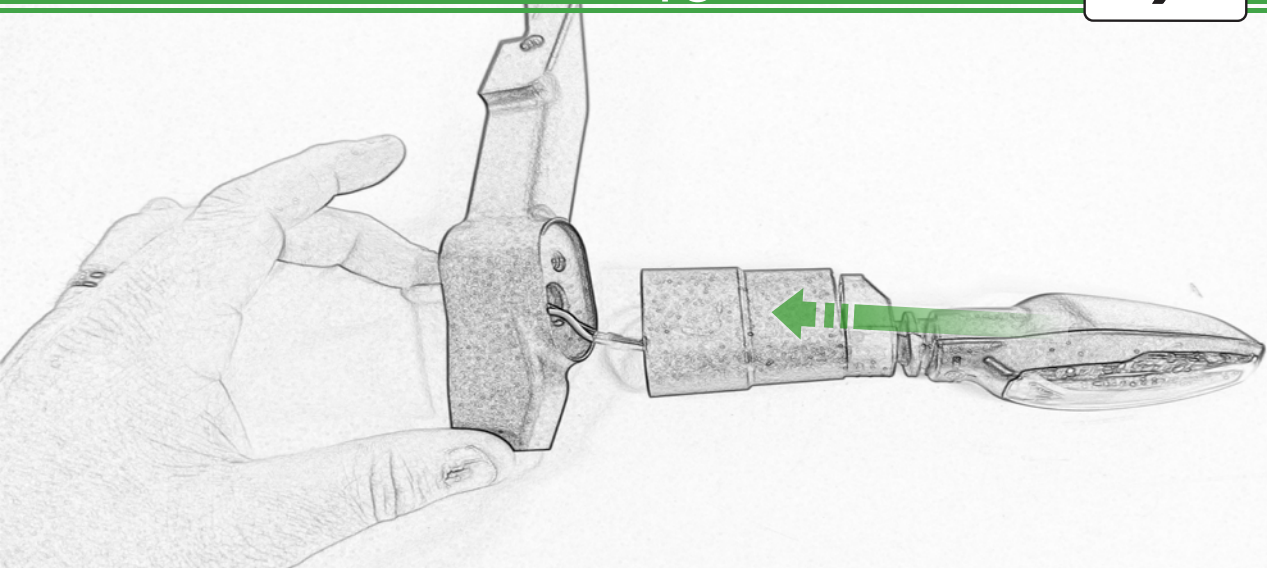

Repeat  
Both Sides

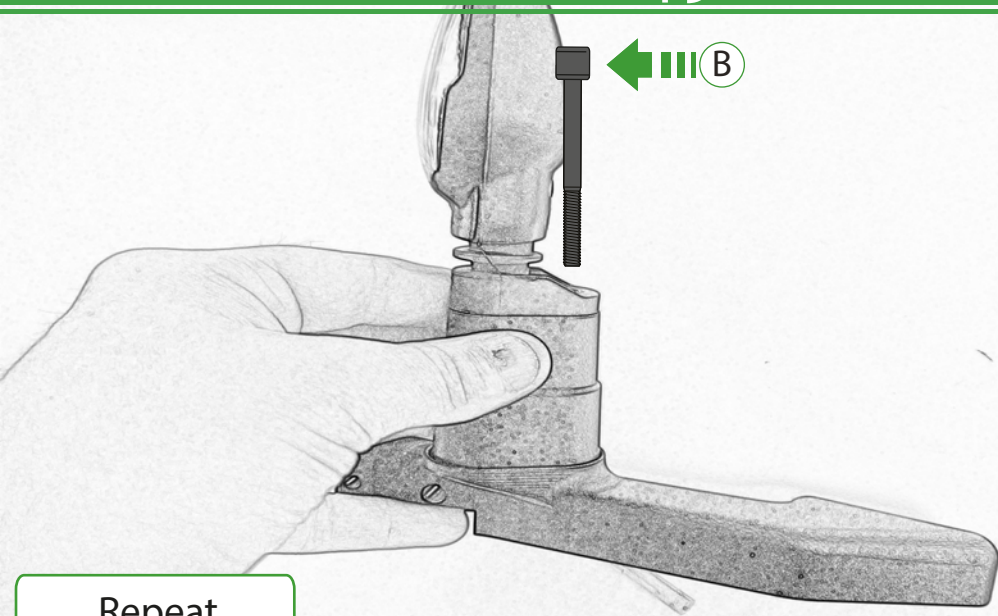

Repeat  
Both Sides

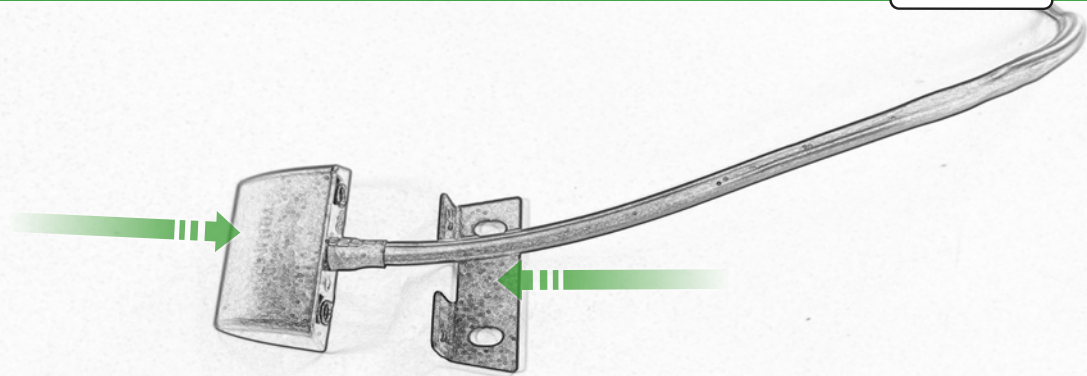

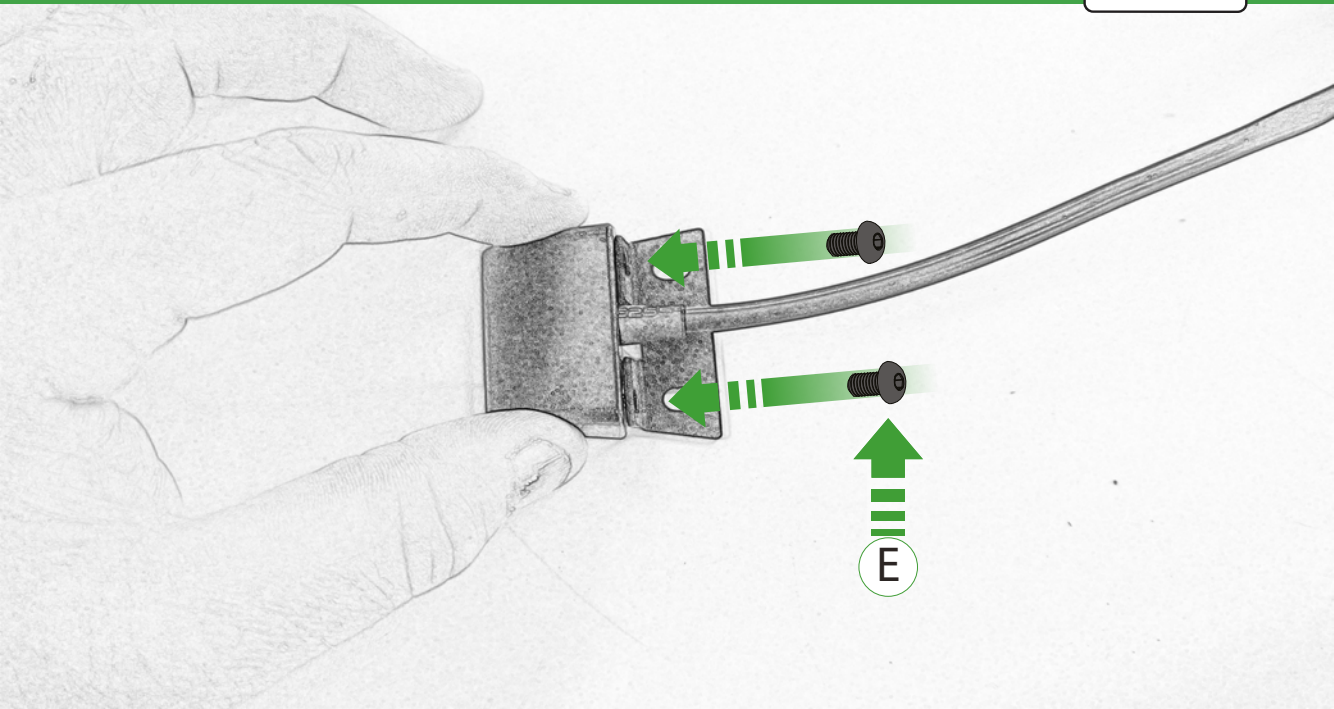

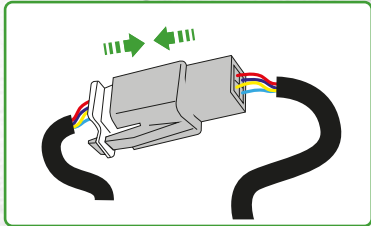
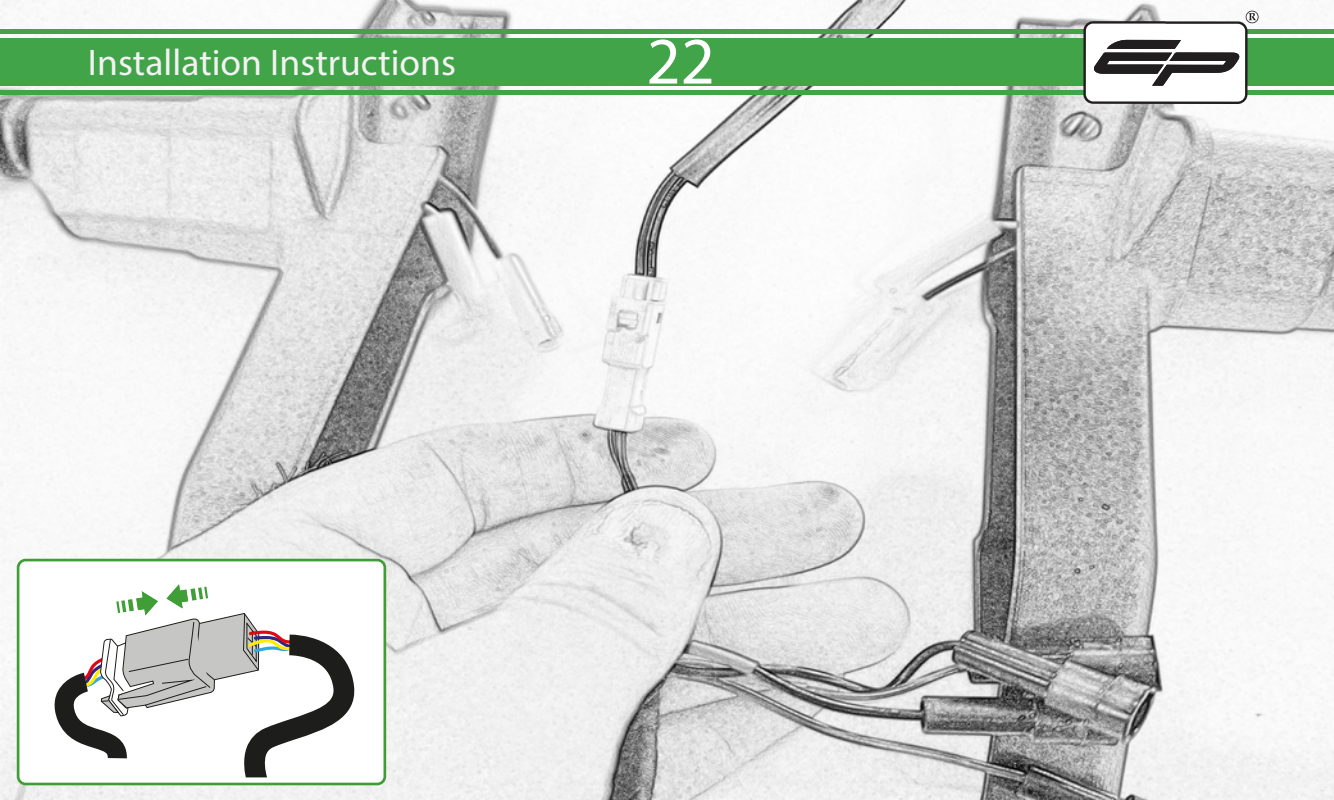



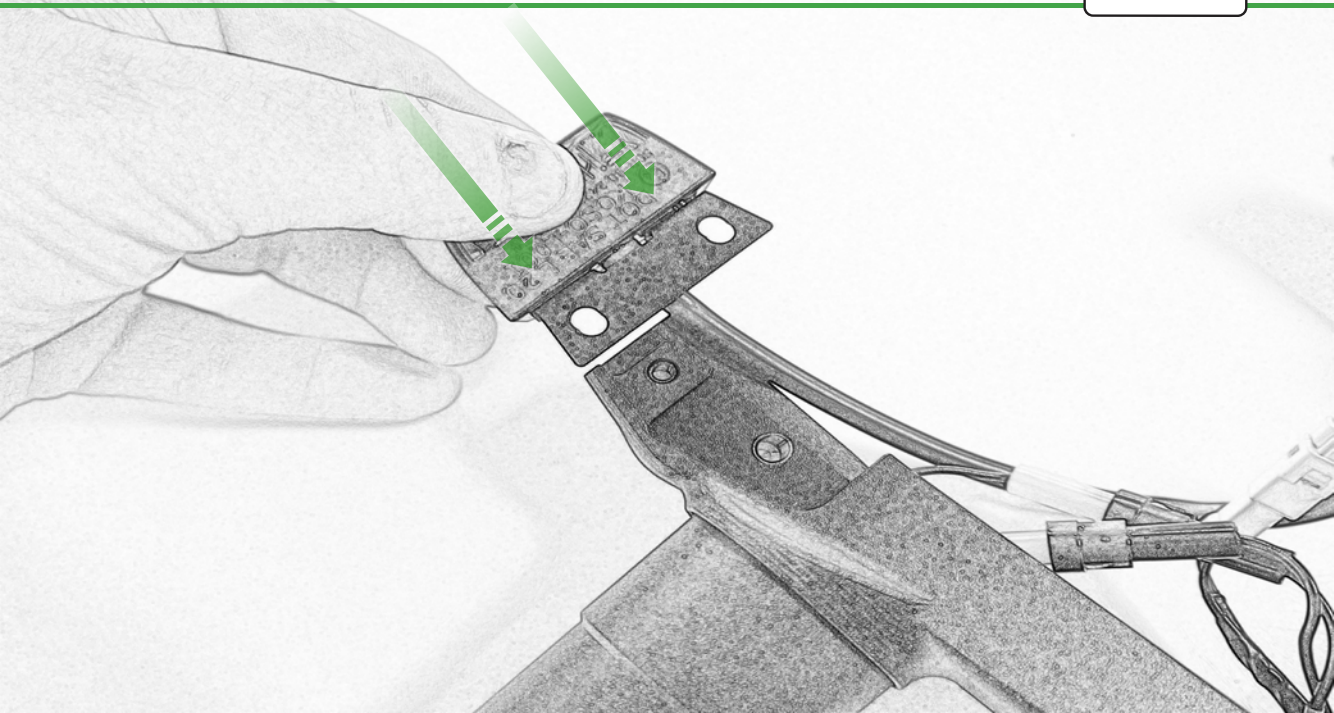

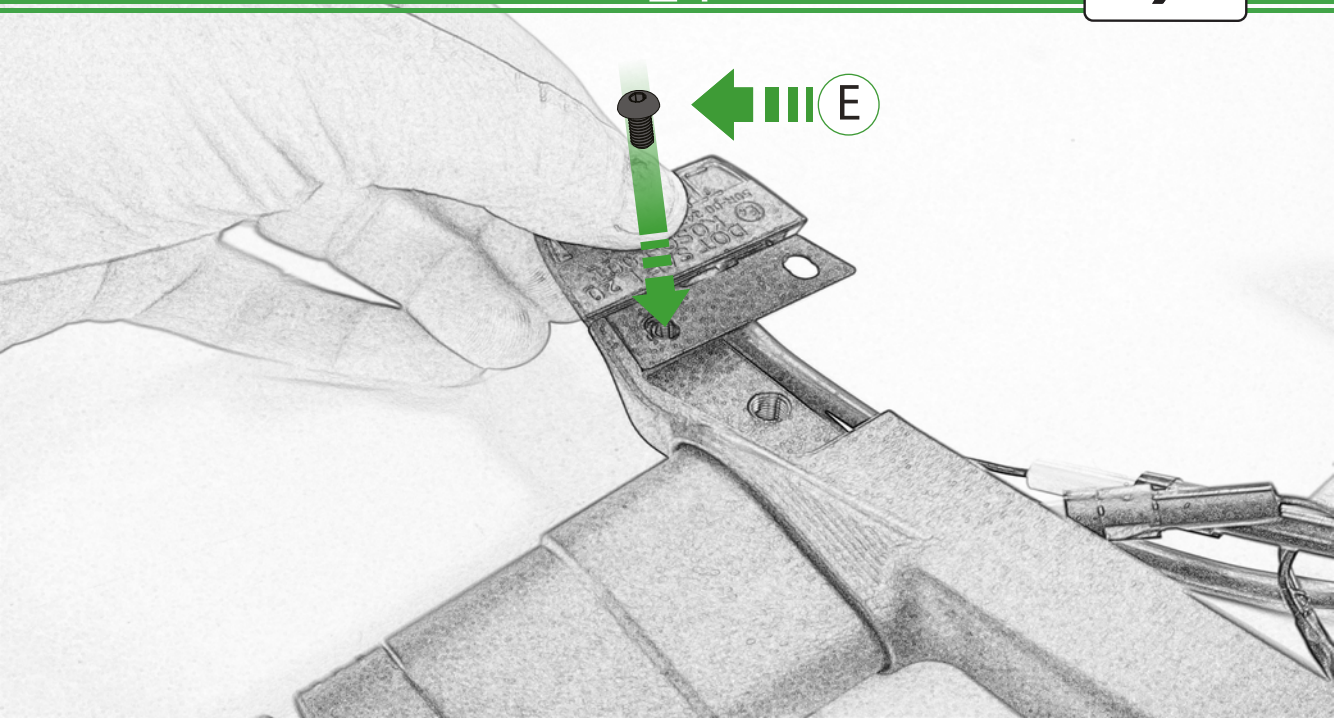

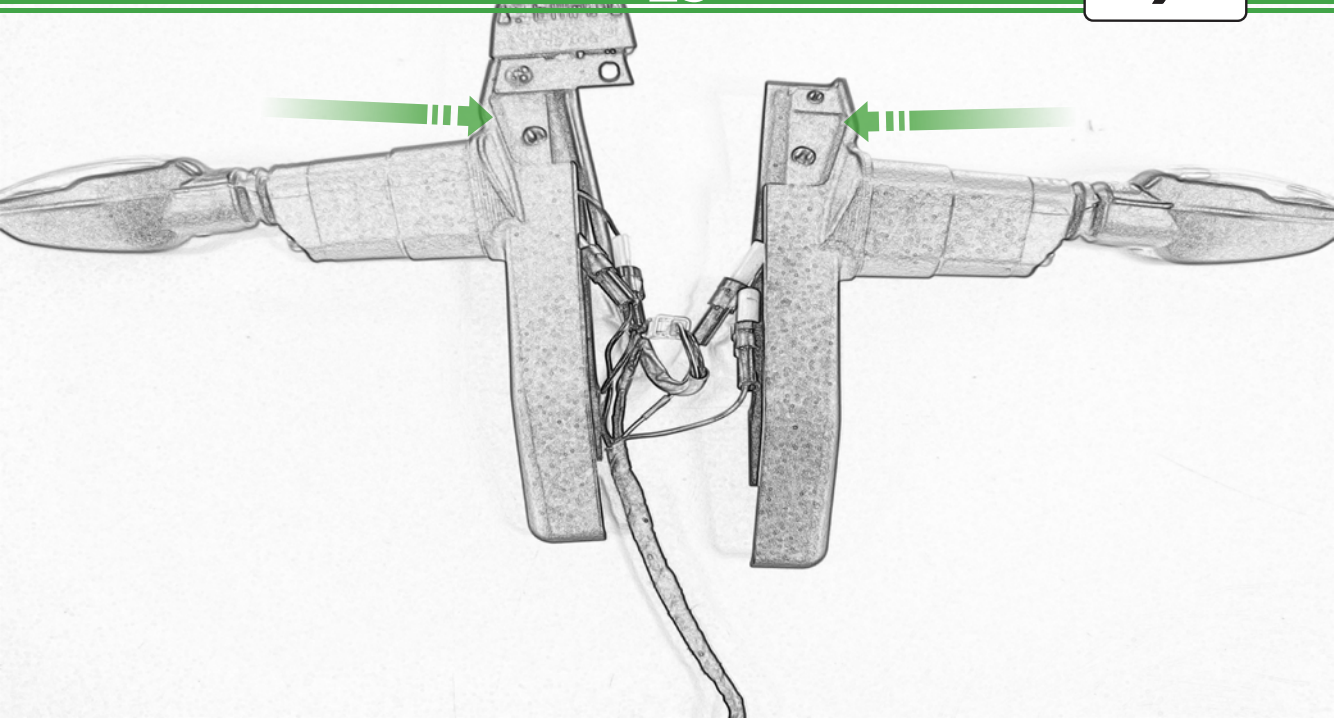

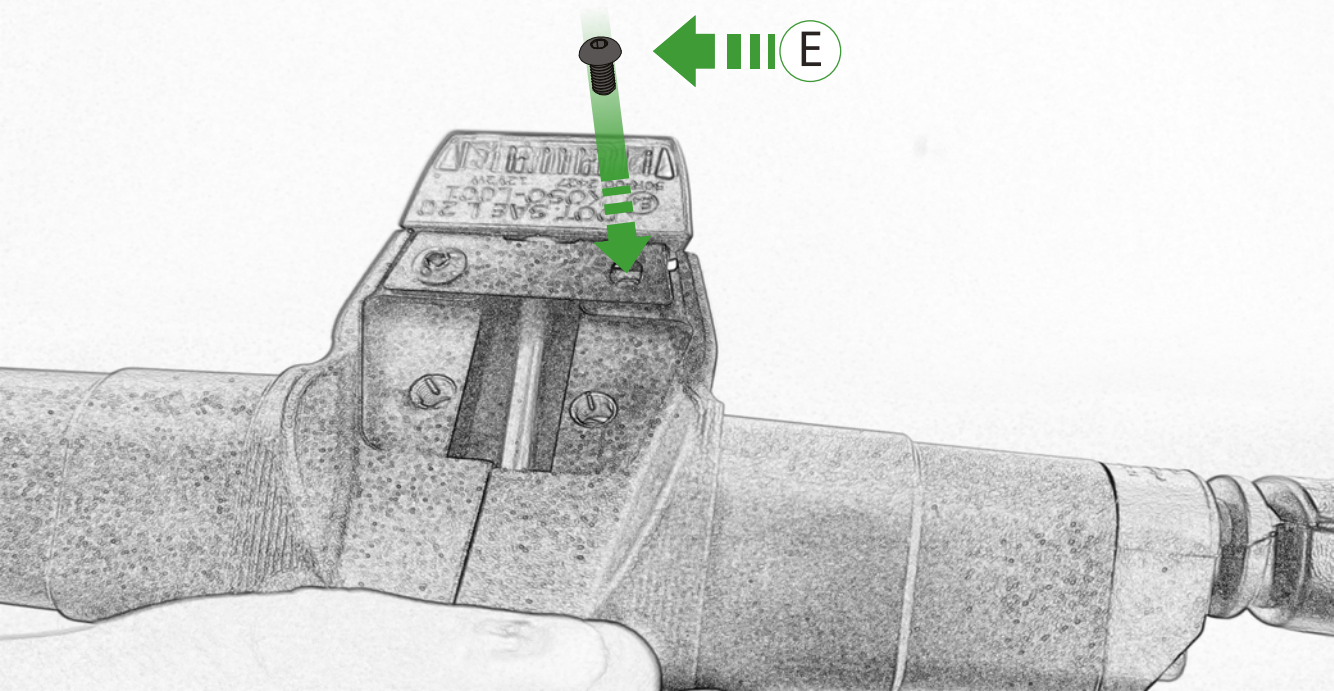

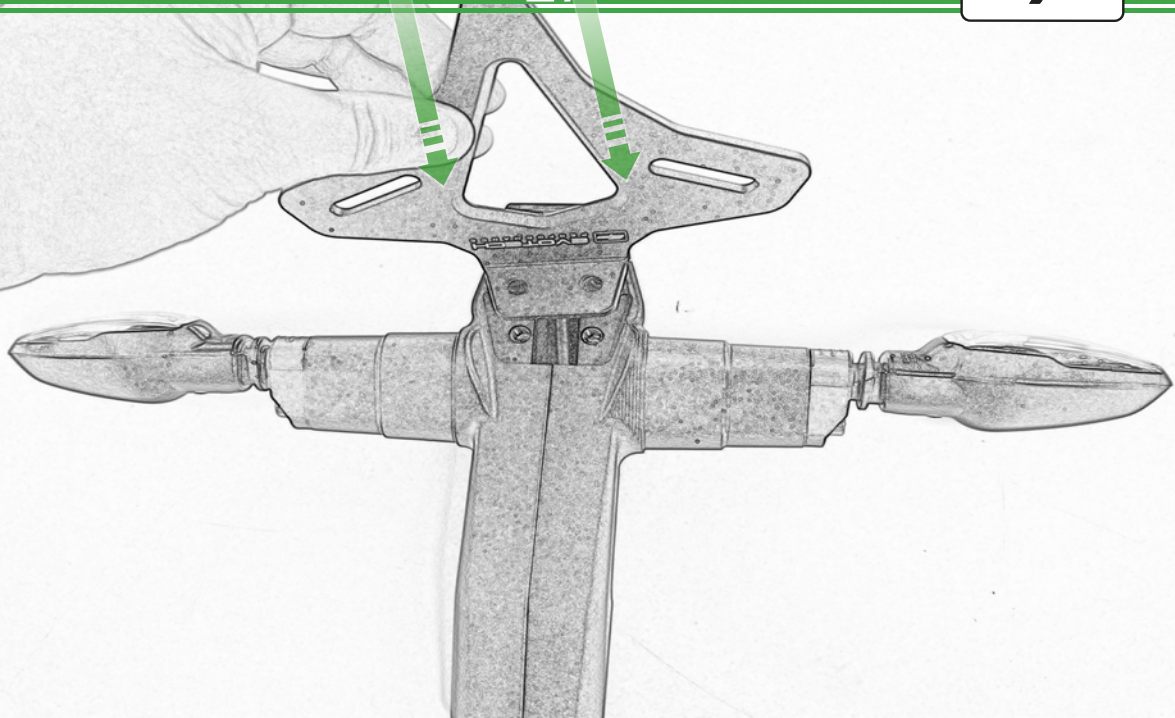

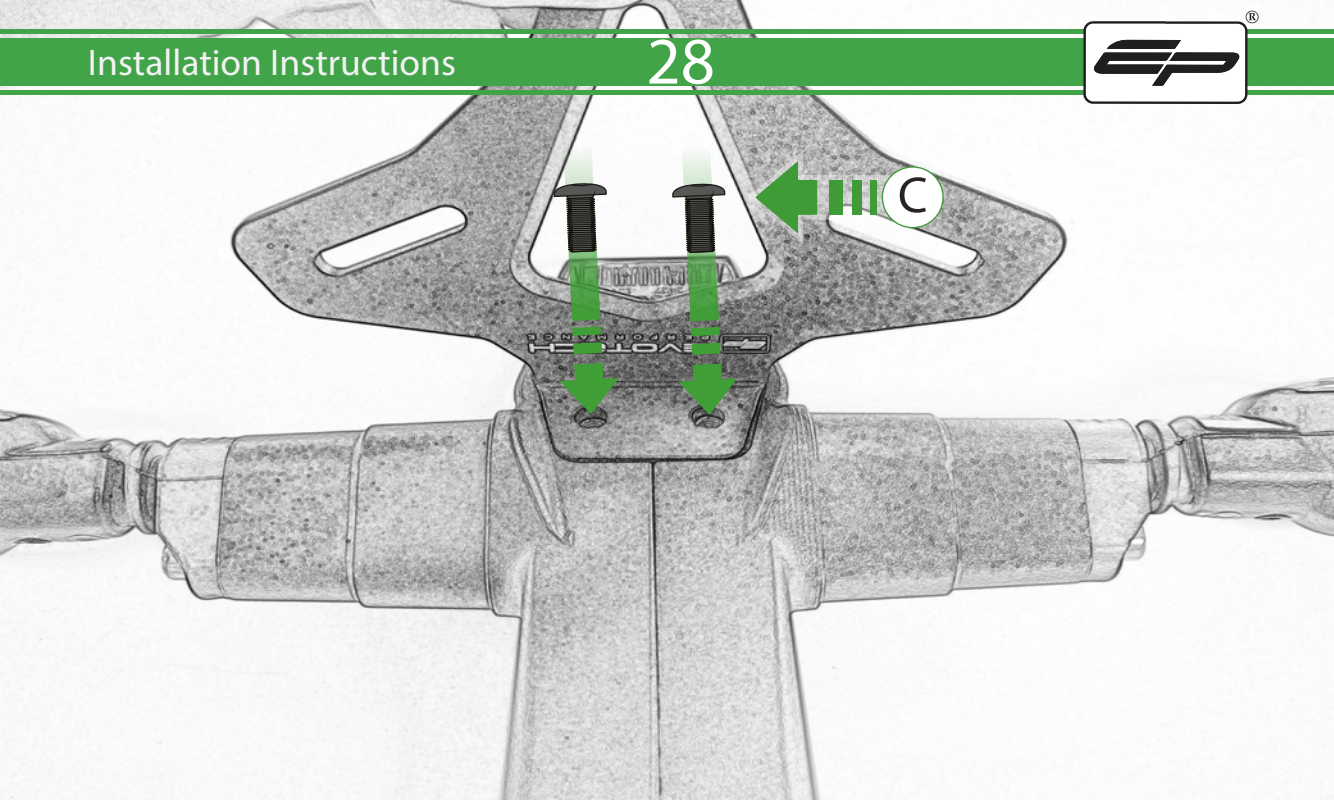

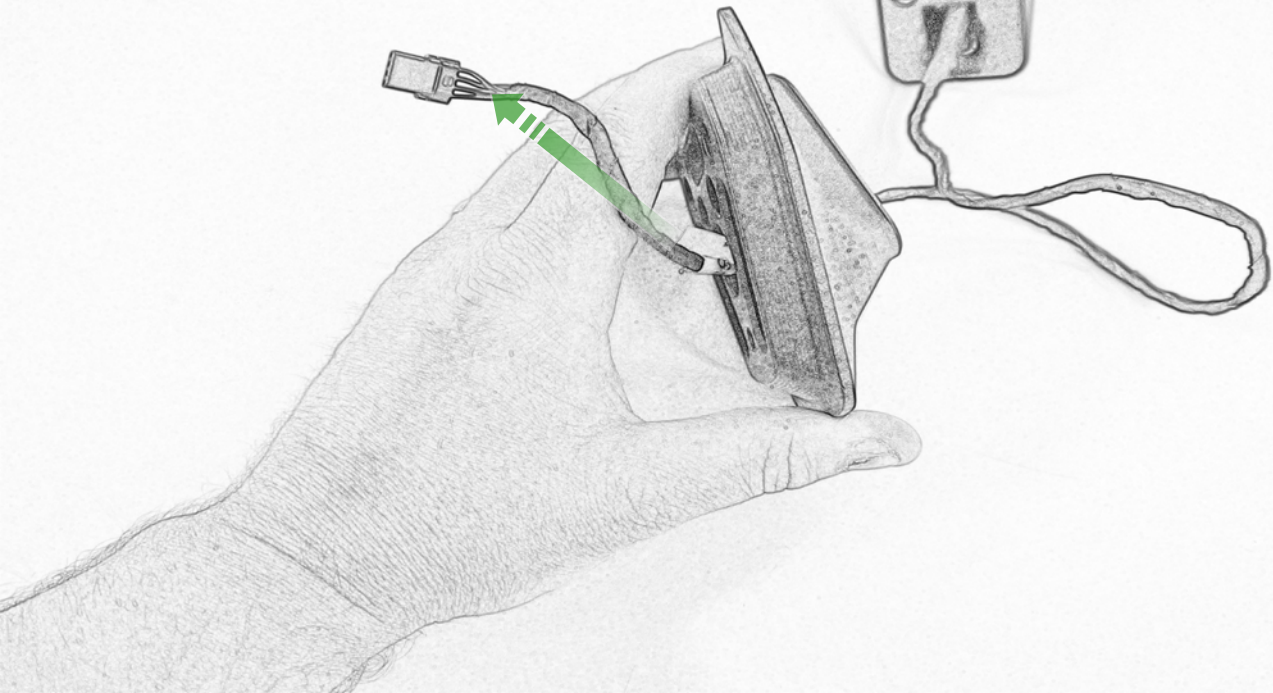

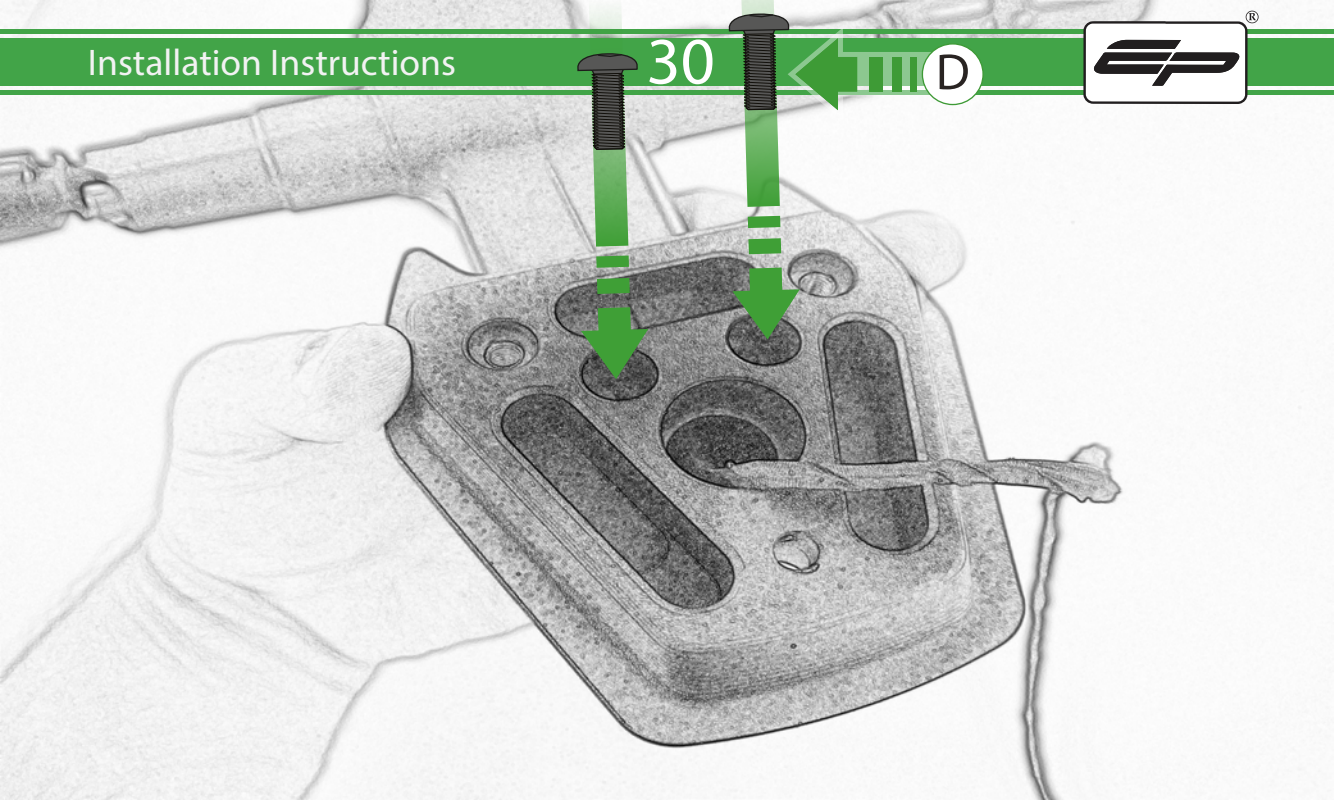



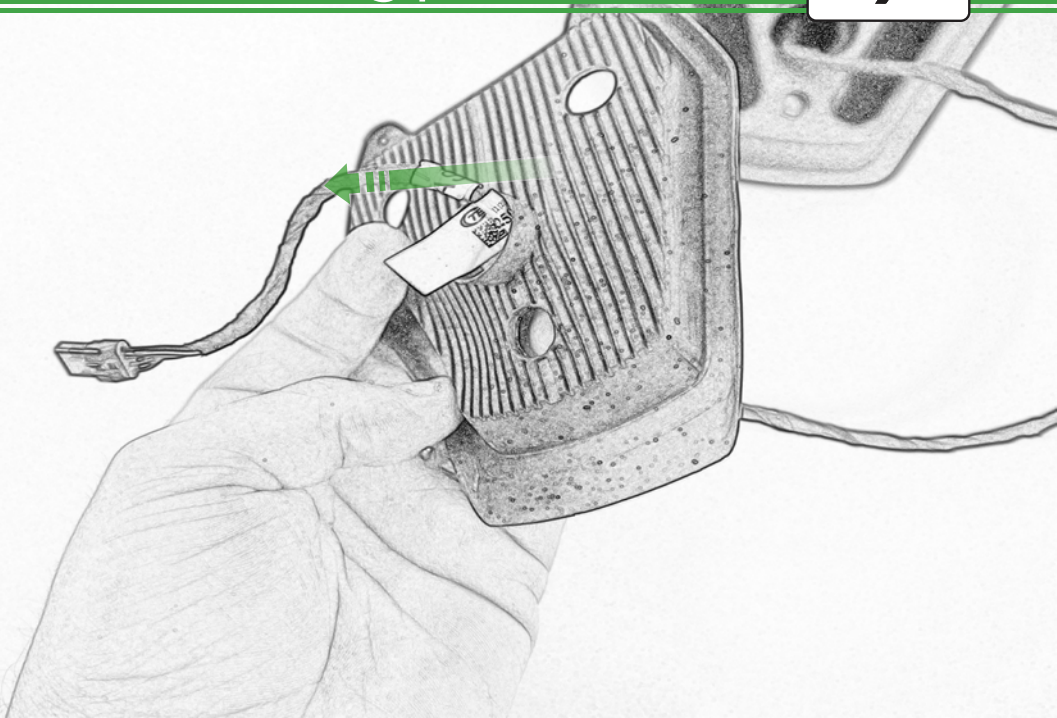

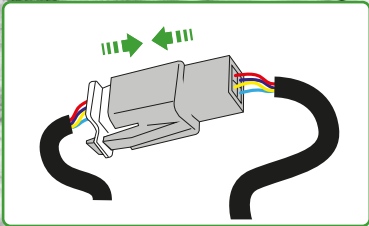
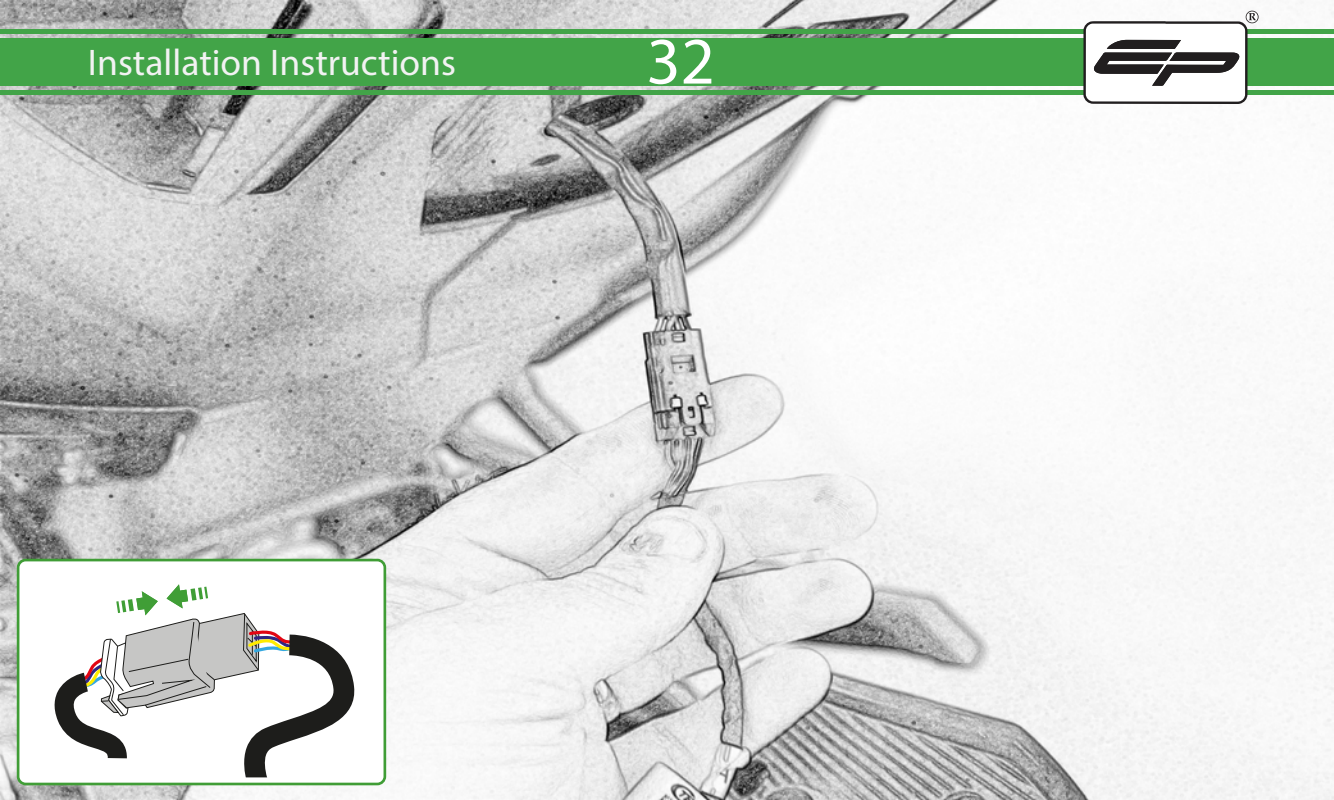

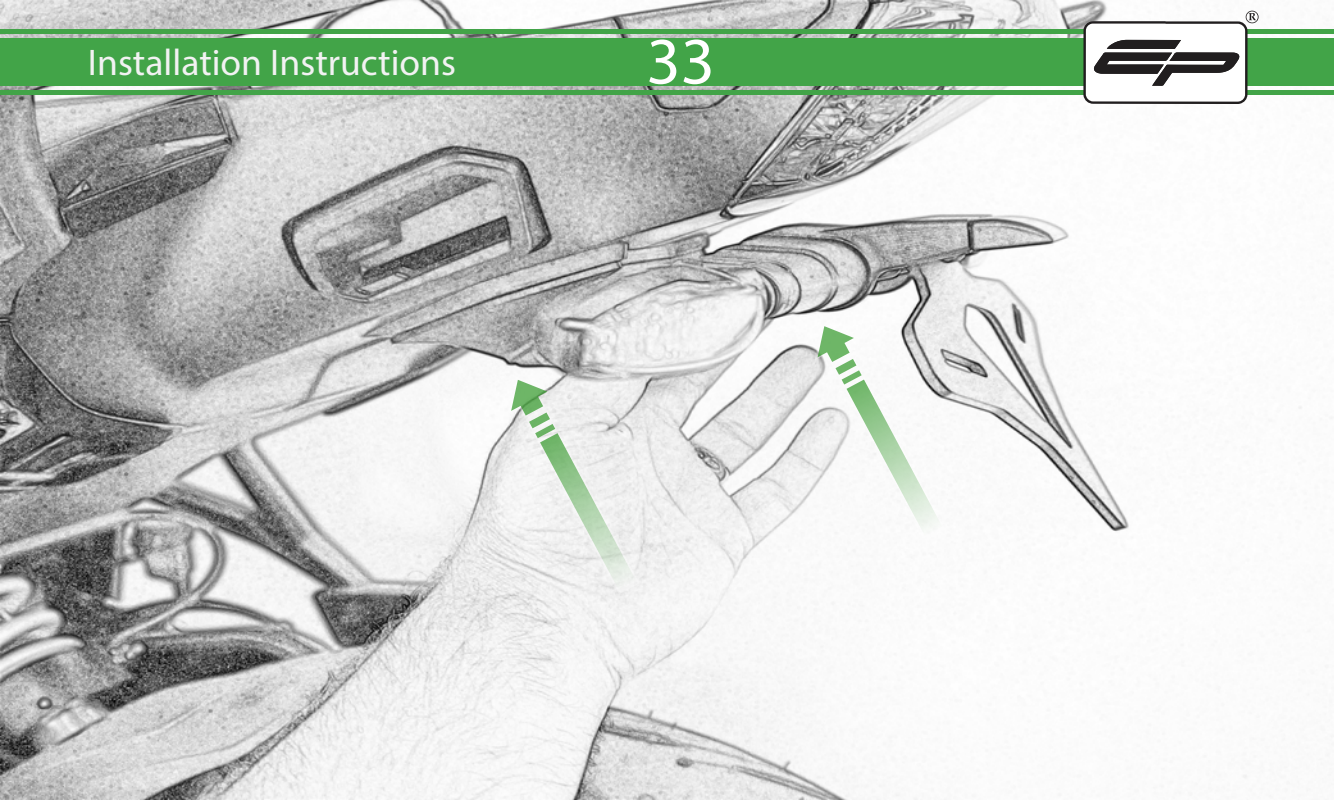

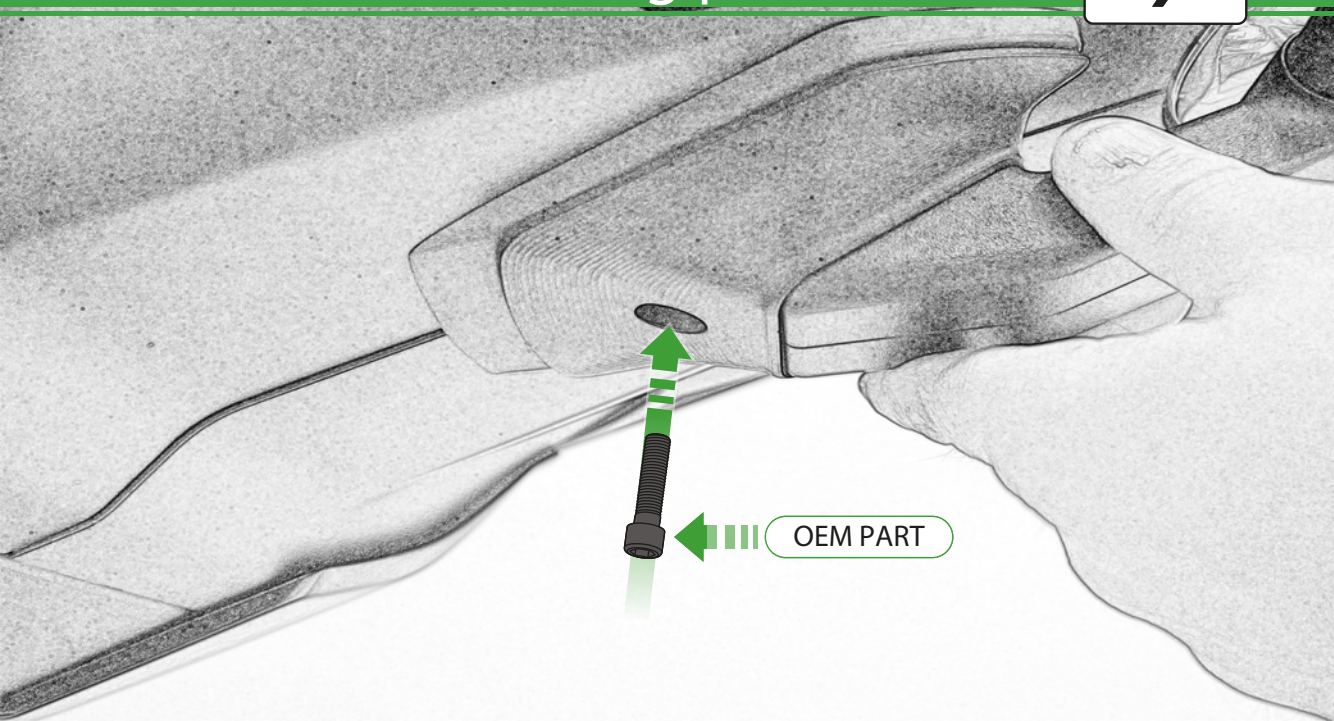

OEM PART



OEM PART

OEM PART

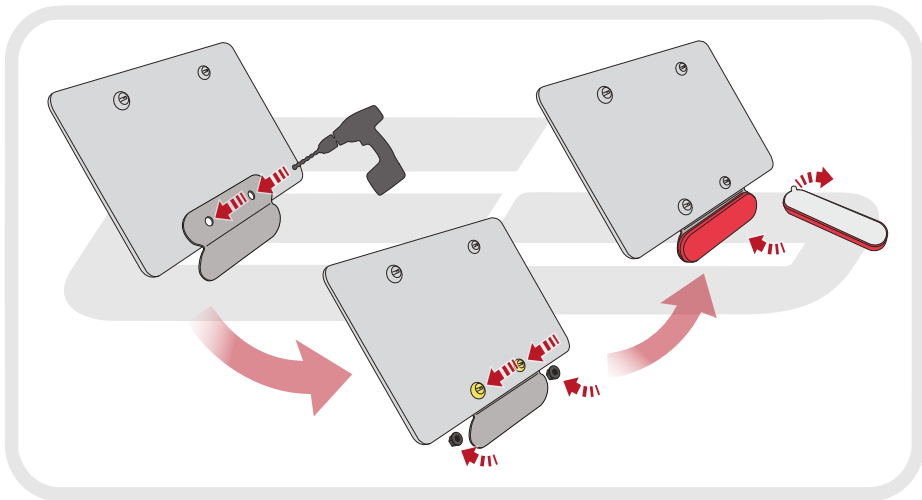

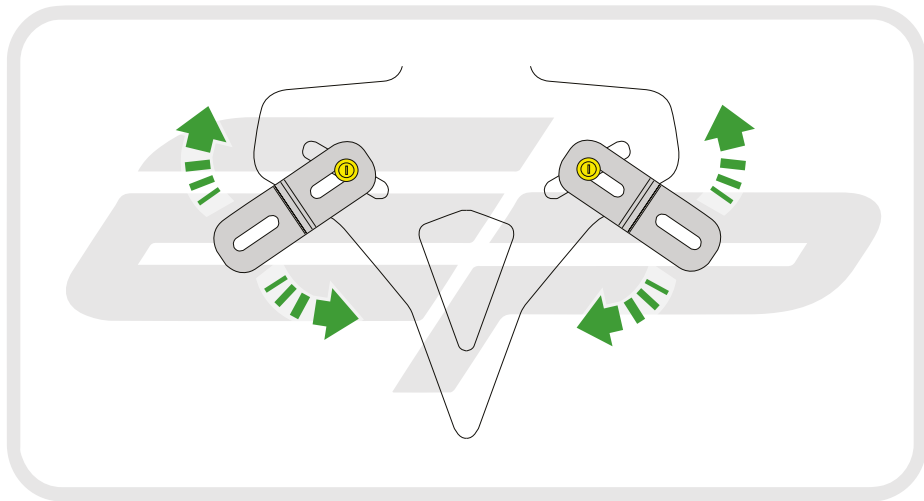



## ESSENTIAL CHECKS



After installation of your tail tidy ensure that the licence plate does not contact the rear tyre when suspension is fully compressed.

Ensure all electrics including indicators, tail light, brake light and licence plate light lights are working correctly before riding the motorcycle.

It is recommended that periodic inspections are made to ensure that all fixings are fully tightend.





**EVOTECH**®  
P E R F O R M A N C E

[www.evotech-performance.com](http://www.evotech-performance.com)