



EVOTECH®
P E R F O R M A N C E

www.evotech-performance.com

DesertX Tail Tidy
Installation instructions



Kit Contents

- Ⓐ 2 x M4 x 12mm Black Button Head Bolts
- Ⓑ 2 x Cable Ties
- Ⓒ 2 x Spacers

EVOTECH®
P E R F O R M A N C E

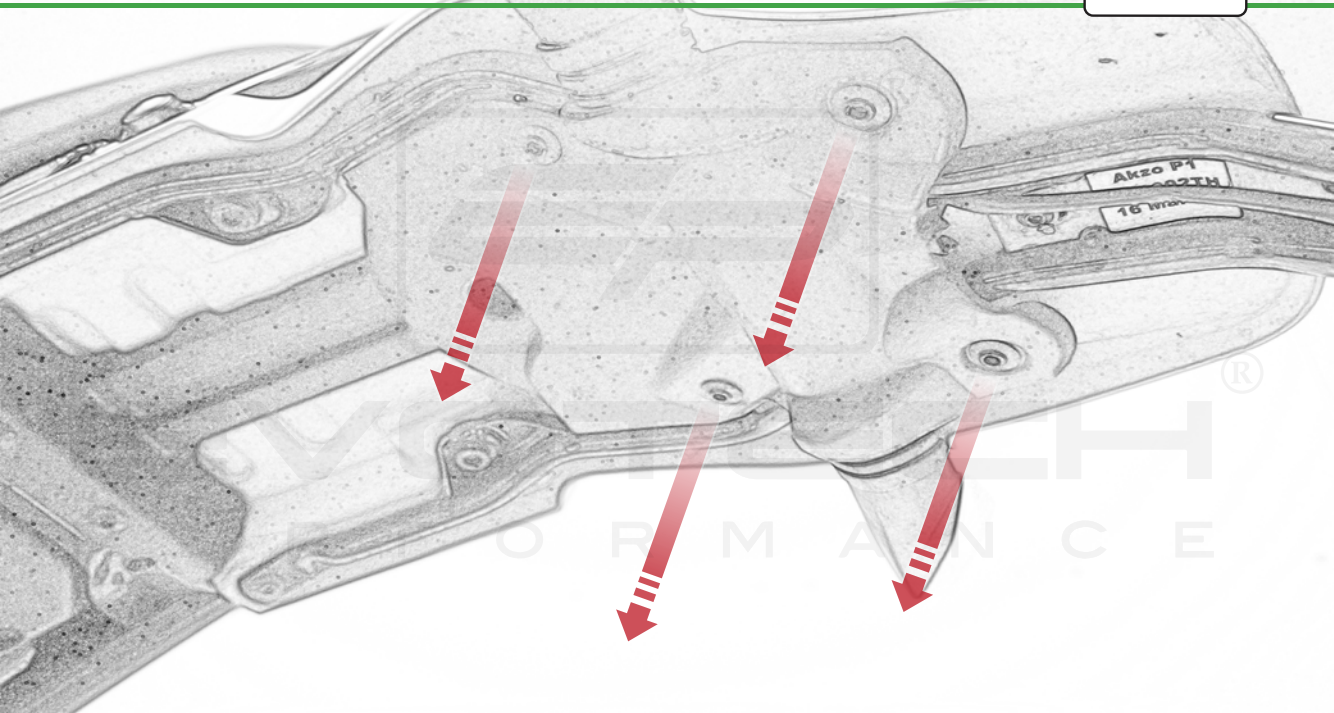

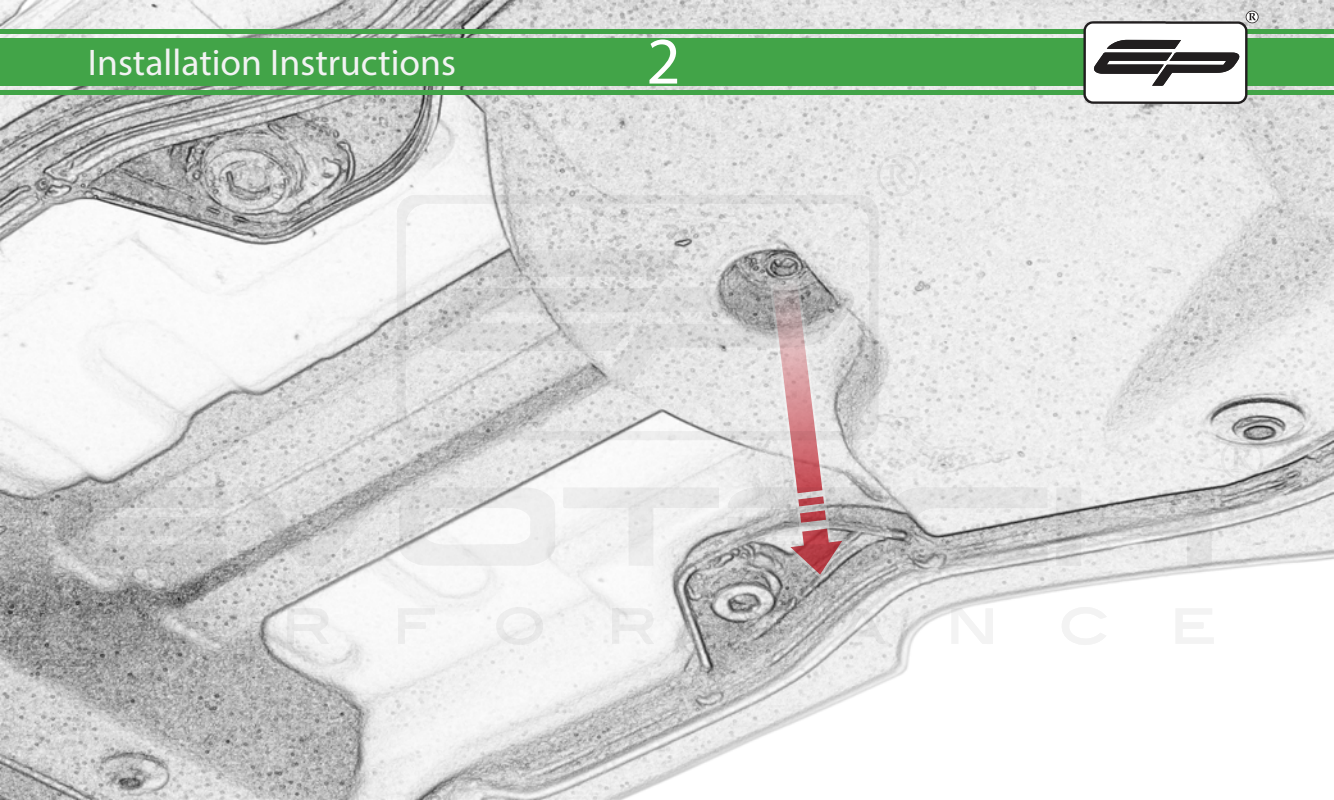



01 9100621621
M3500
DSX 2500R NGWS GB - SW STD
ZDM1X0CAAPR000158

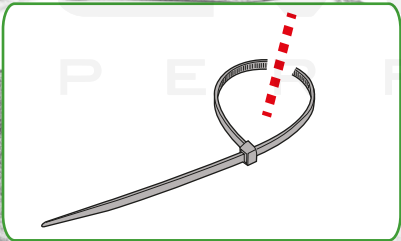
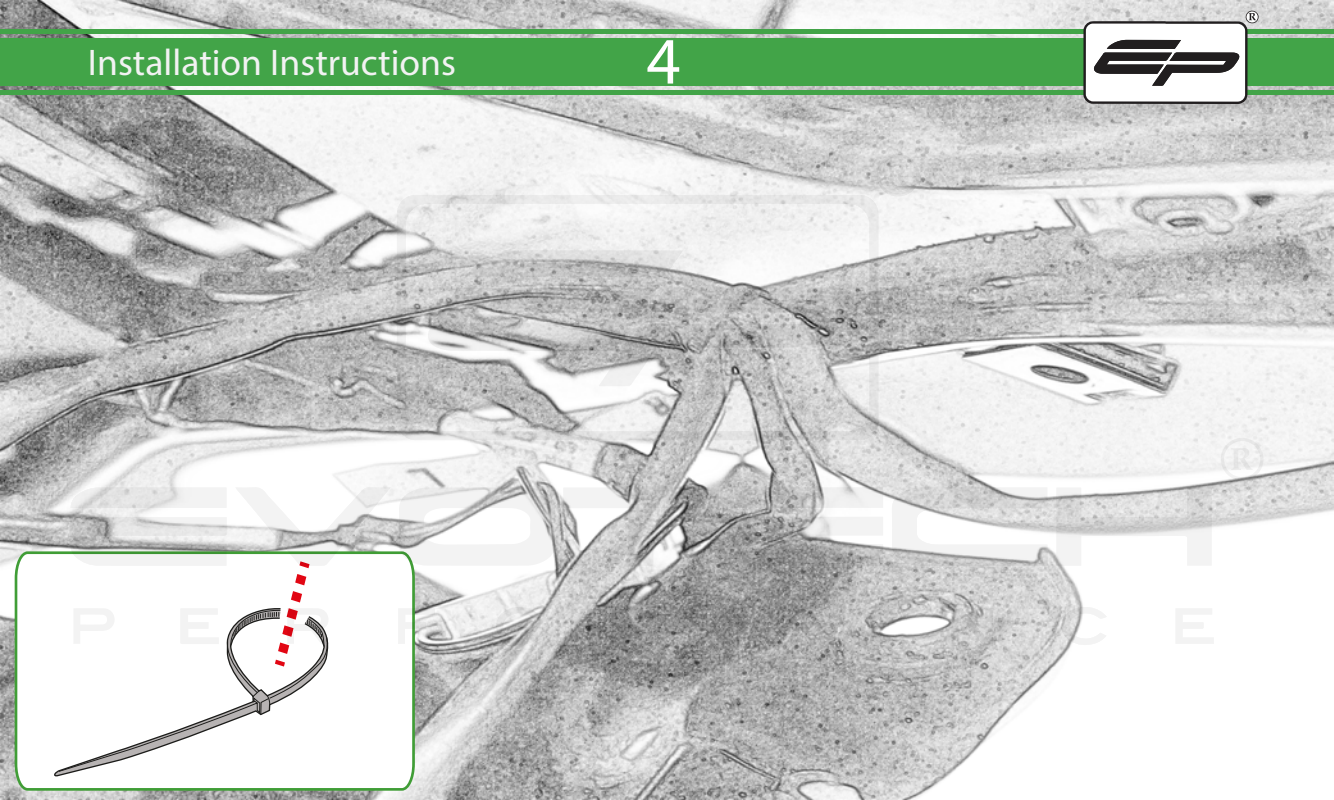

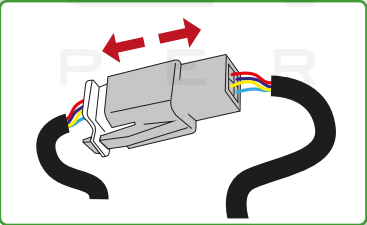



WM9302TH
16 Mar 22

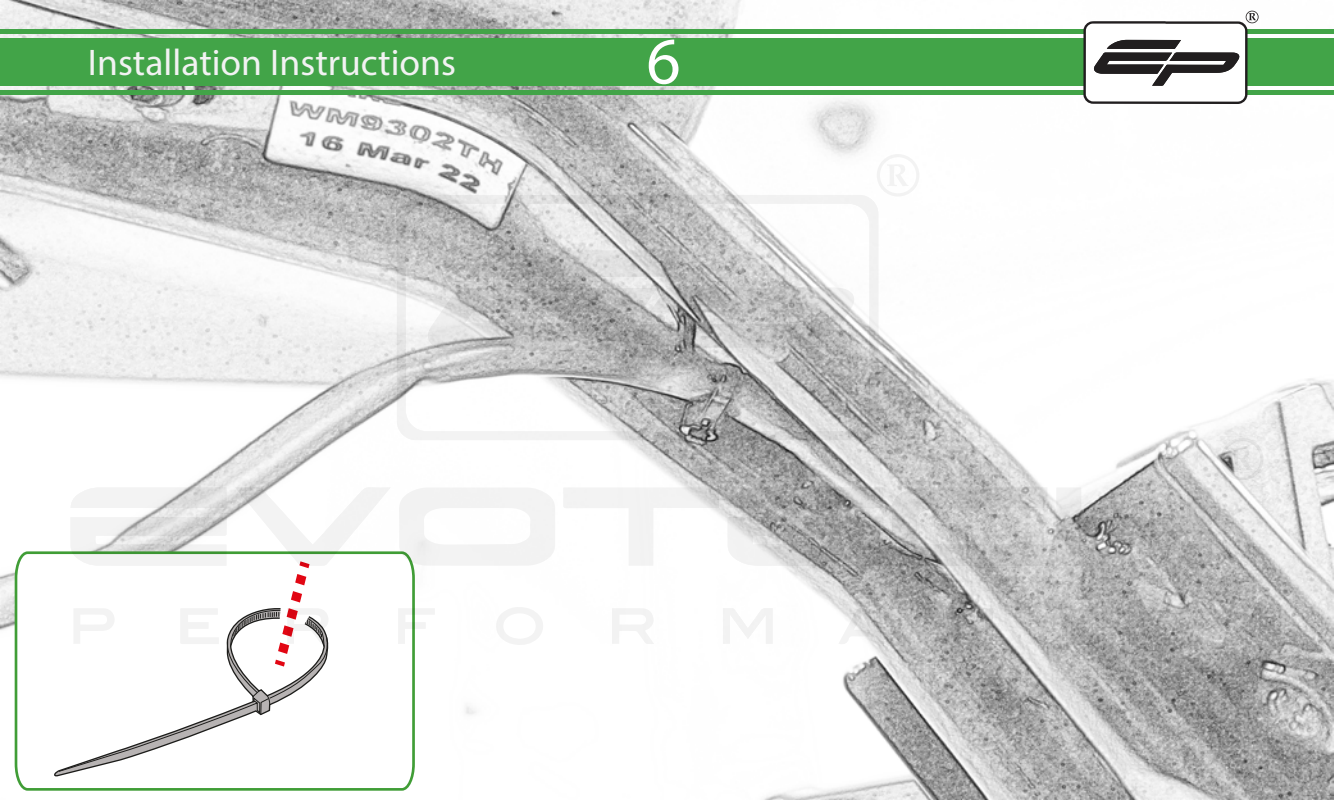
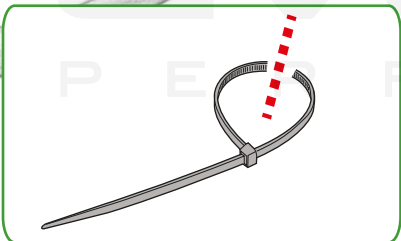

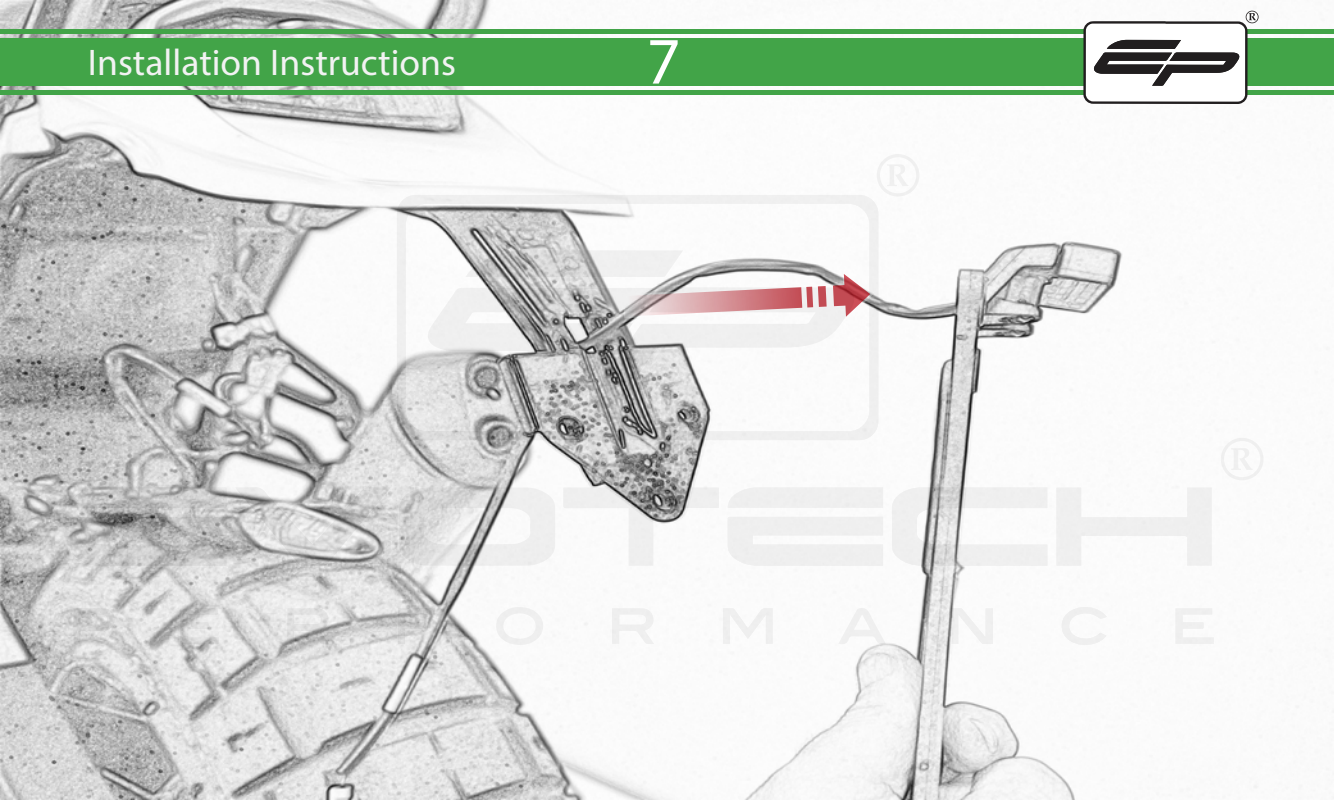

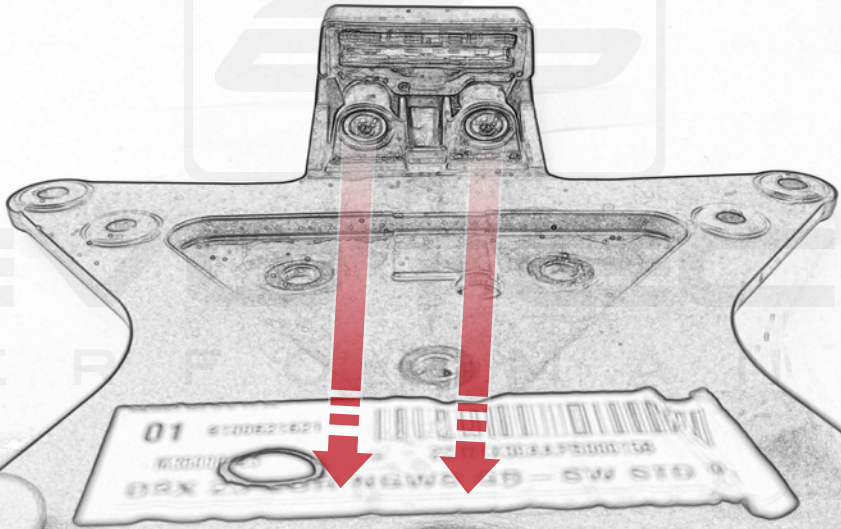

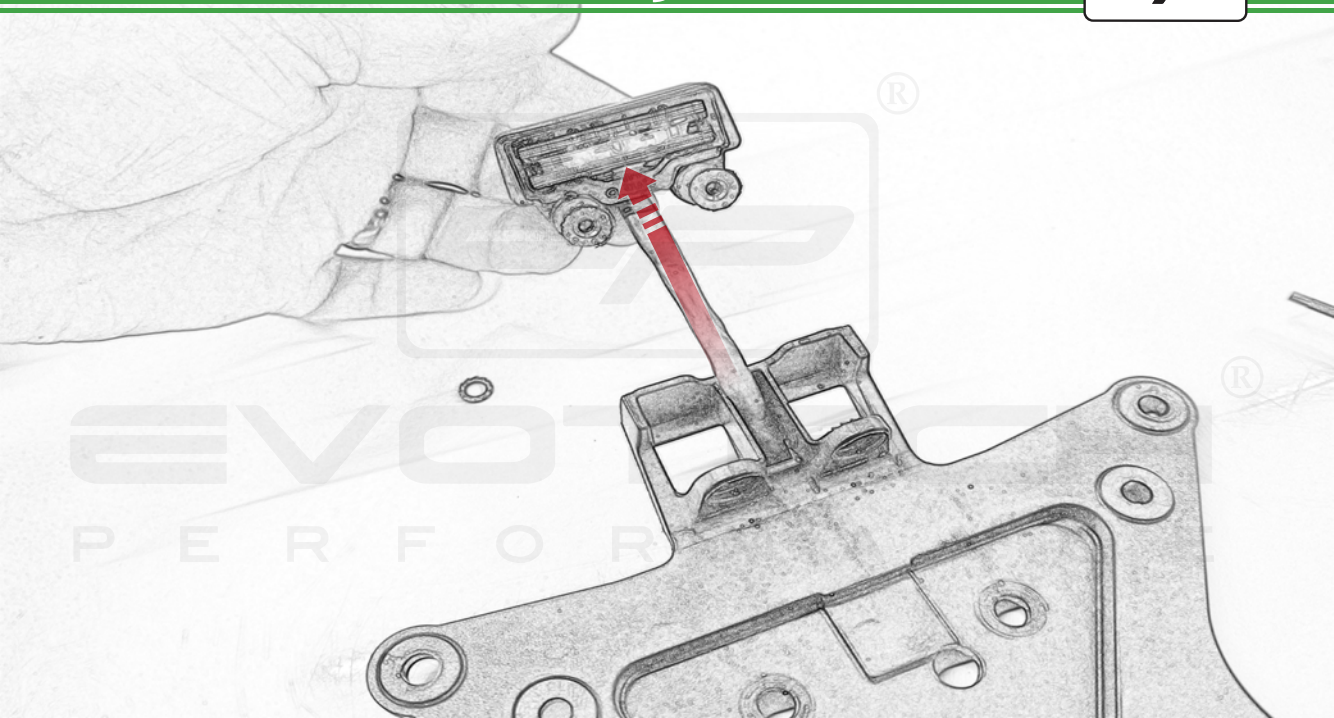

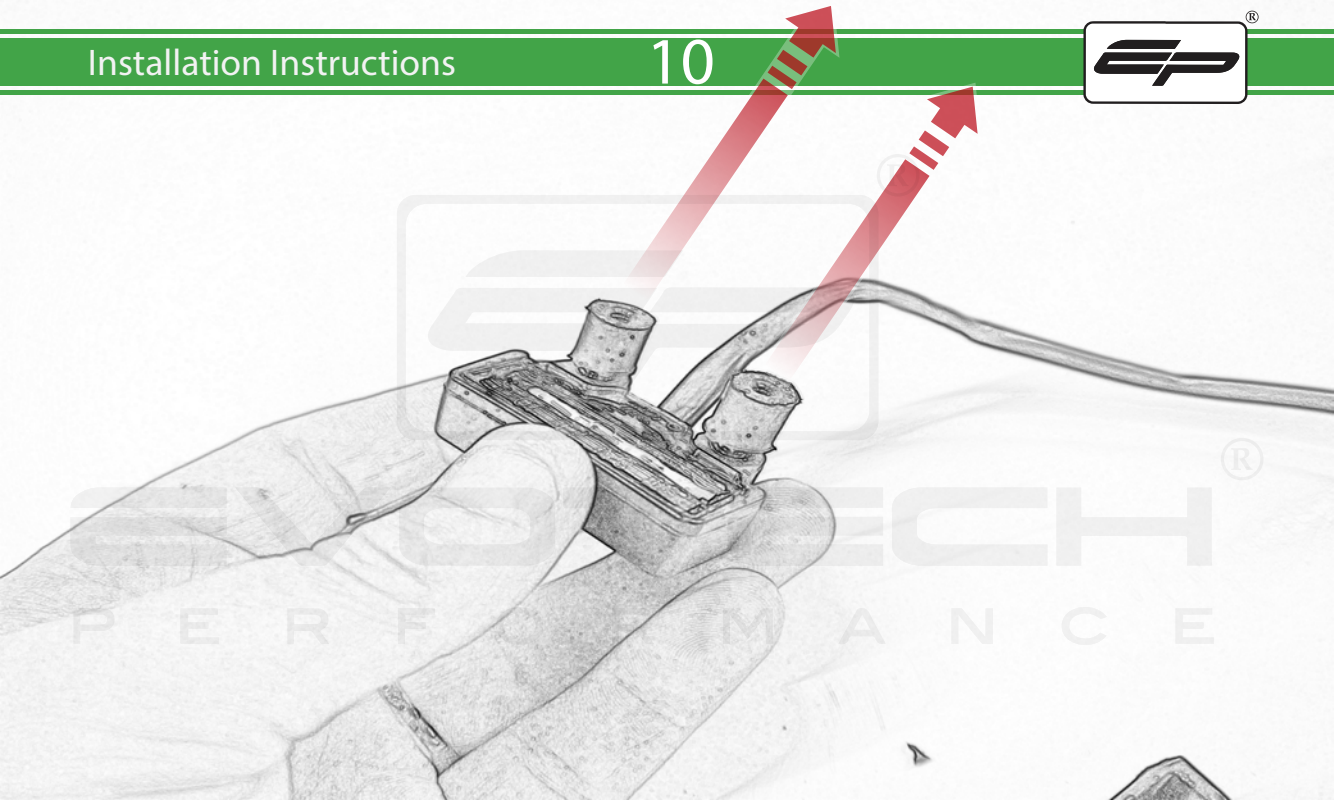

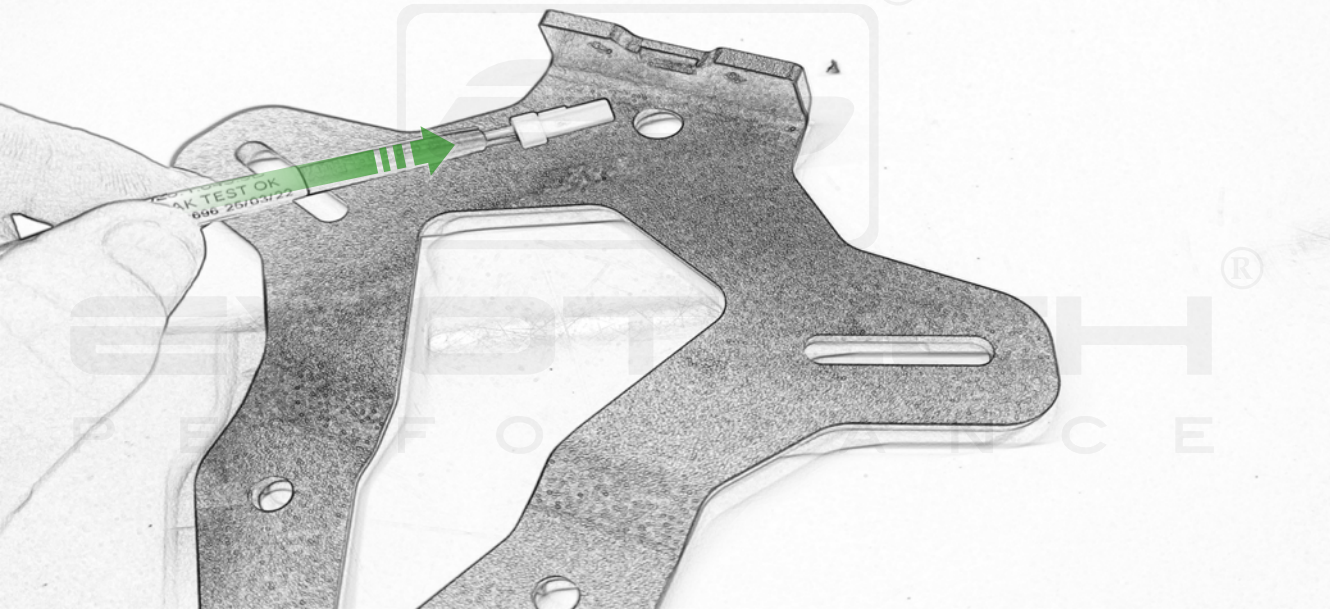

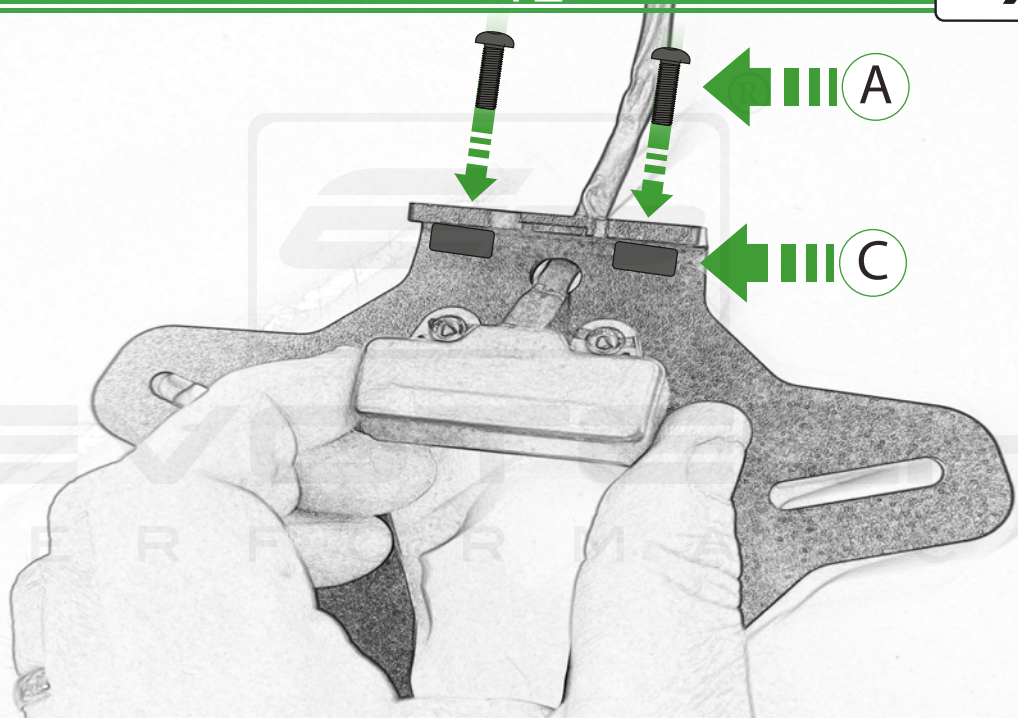



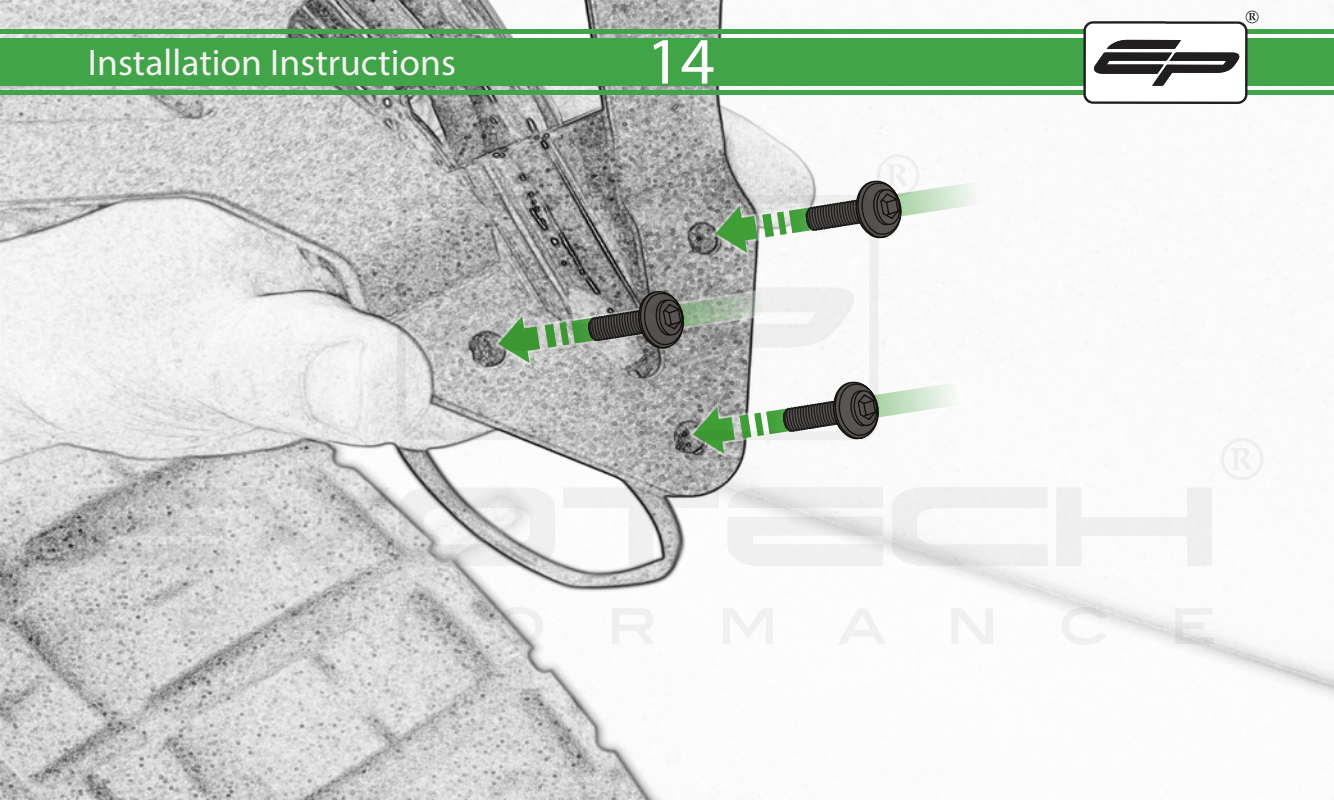

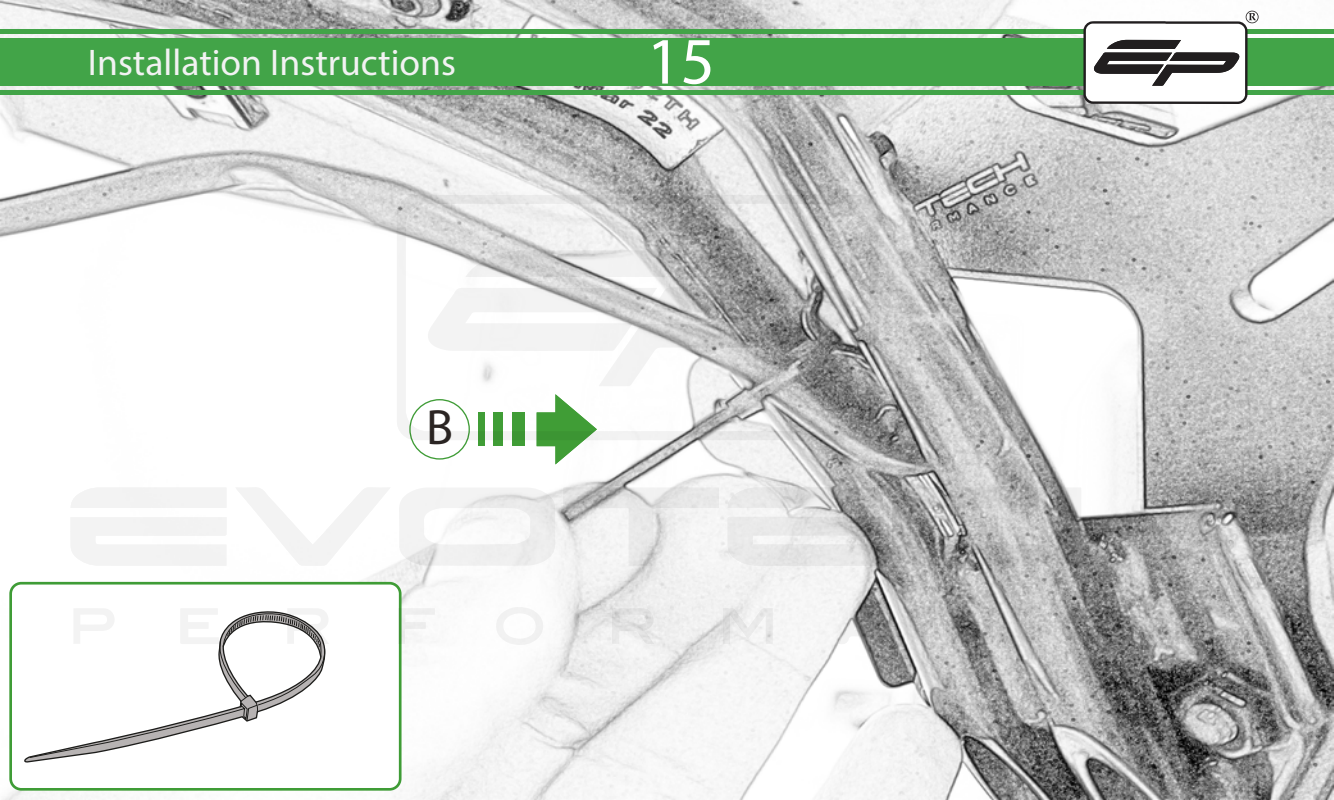
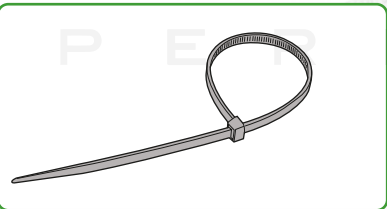



EVOTECH[®]
P E R F O R M A N C E

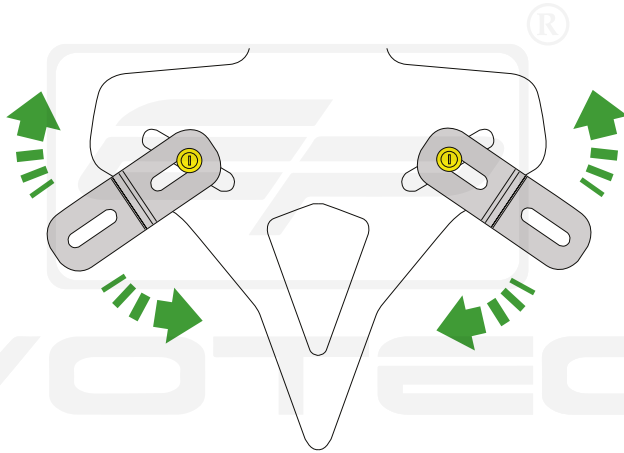

EVOTECH[®]
PERFORMANCE

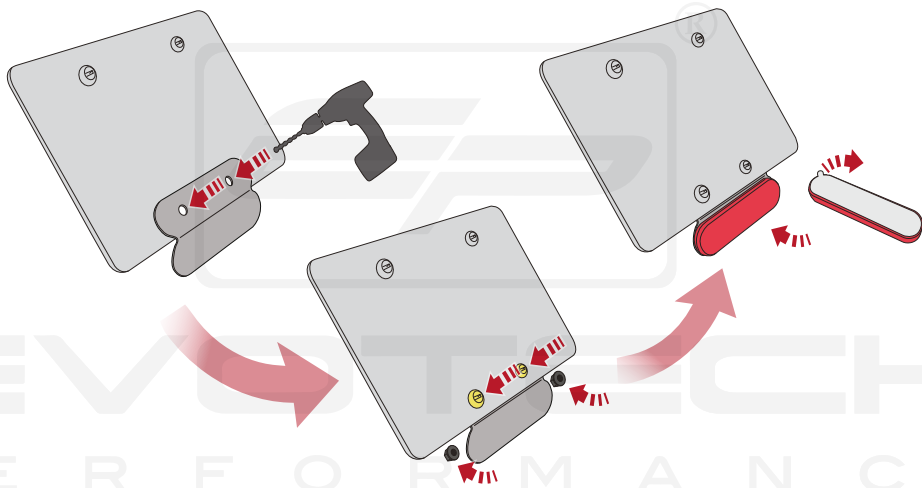



ESSENTIAL CHECKS

After installation of your tail tidy ensure that the licence plate does not contact the rear tyre when suspension is fully compressed.

Ensure all electrics including indicators, tail light, brake light and licence plate light lights are working correctly before riding the motorcycle.

It is recommended that periodic inspections are made to ensure that all fixings are fully tightend.



EVOTECH®
P E R F O R M A N C E

www.evotech-performance.com