



**Ducati Multistrada 1260
Main Frame Crash Protection**

Installation Instructions



Kit Contents PRN013903

- A** 1 x L/H Stem
- B** 1 x R/H Stem
- C** 1 x M12 Shaft
- D** 2 x Bobbin Heads
- E** 2 x Polyurethane Washers
- F** 2 x M12 Nuts
- G** 2 x M12 Washers

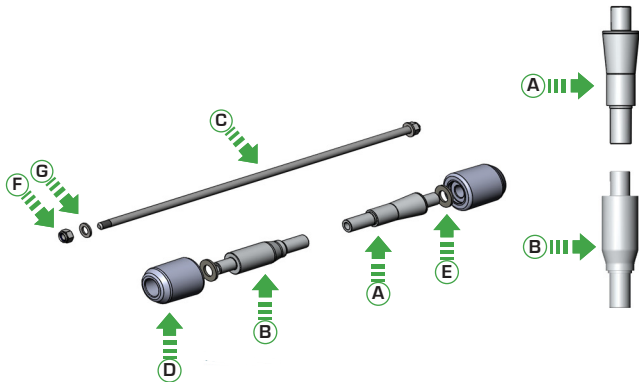

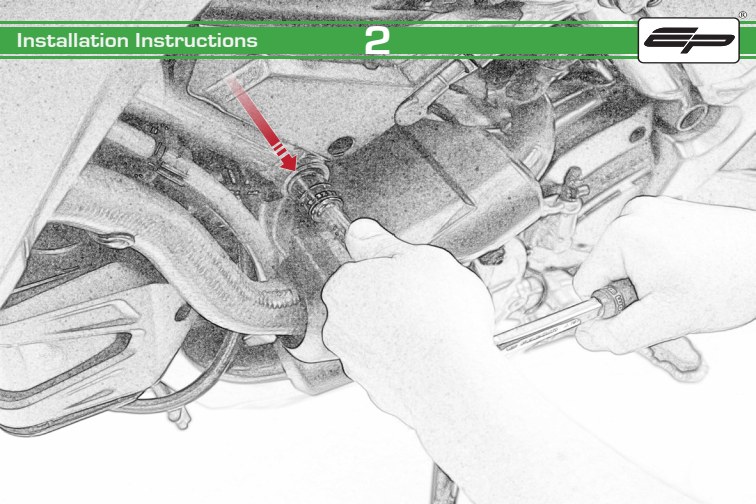

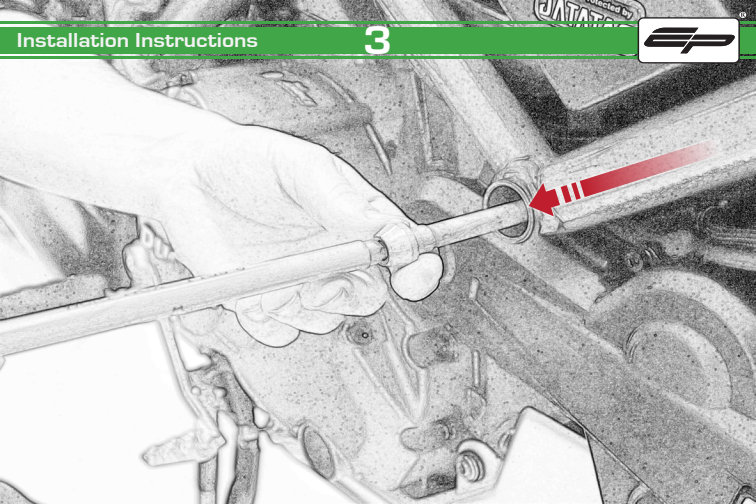

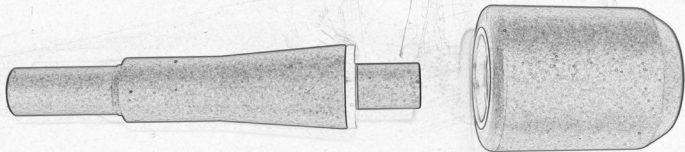

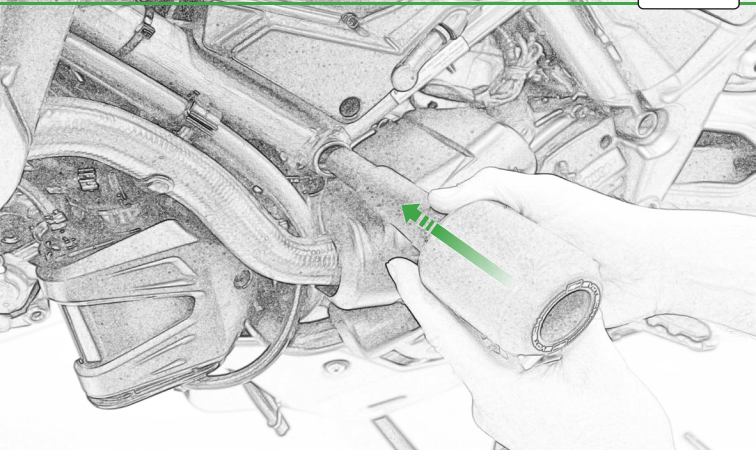

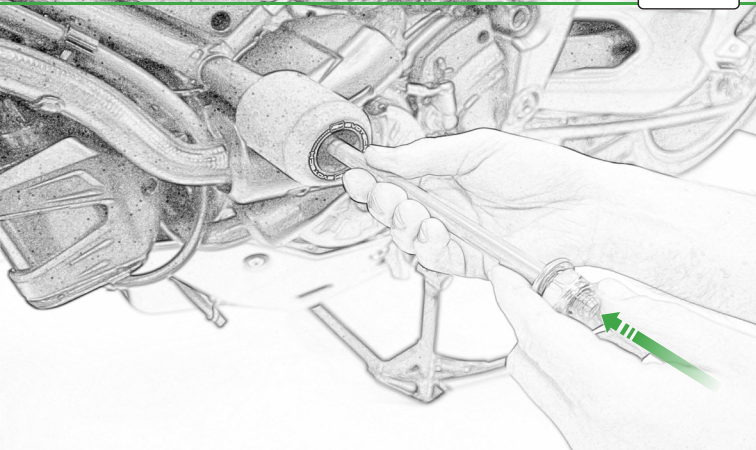

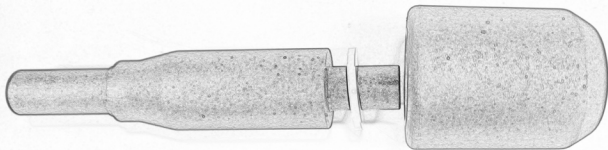

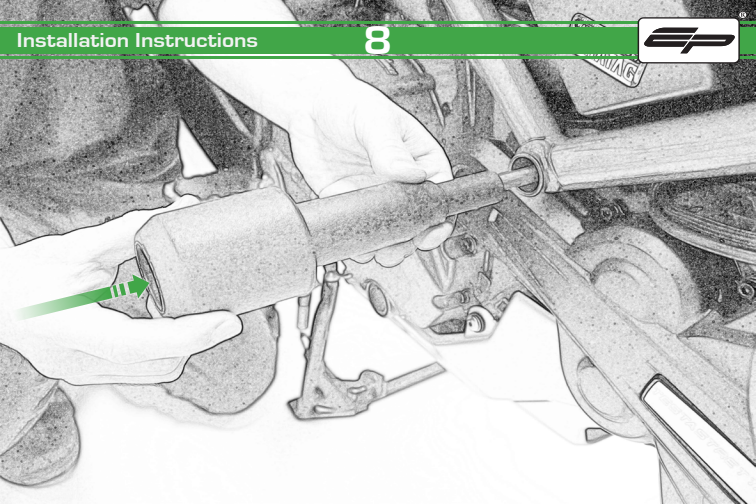



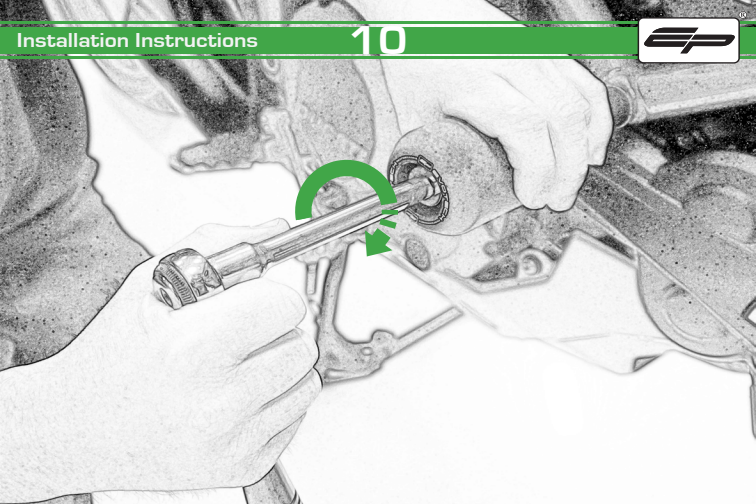



ESSENTIAL CHECKS

It is recommended that periodic inspections are made to ensure that all bolts are tightened to the specified torque settings.

Should the bike be involved in an accident a thorough inspection should be made and any components that have taken an impact, no matter how small, be replaced



EVOTECH®
P E R F O R M A N C E

www.evotech-performance.com