



EVOTECH®
P E R F O R M A N C E

www.evotech-performance.com

Aprilia Tuono 660 Crash Protection

Installation Instructions



Kit Contents PRN015476

- (A) 1 x R/H Bobbin Bracket
- (B) 1 x R/H Bobbin Spacer (Short)
- (C) 1 x R/H Wire Bracket
- (D) 1 x M6 x 25 Caphead
- (E) 1 x M12 x 100 Caphead
- (F) 1 x L/H Bobbin Bracket
- (G) 1 x L/H Bobbin Spacer (Long)
- (H) 1 x L/H Frame Shim
- (I) 1 x M10 x 40 Caphead
- (J) 1 x M12 x 110 Caphead
- (K) 2 x M10 x 35 Caphead
- (L) 2 x Bobbin Head
- (M) 2 x Poly Washer
- (N) 2 x M12 Washer

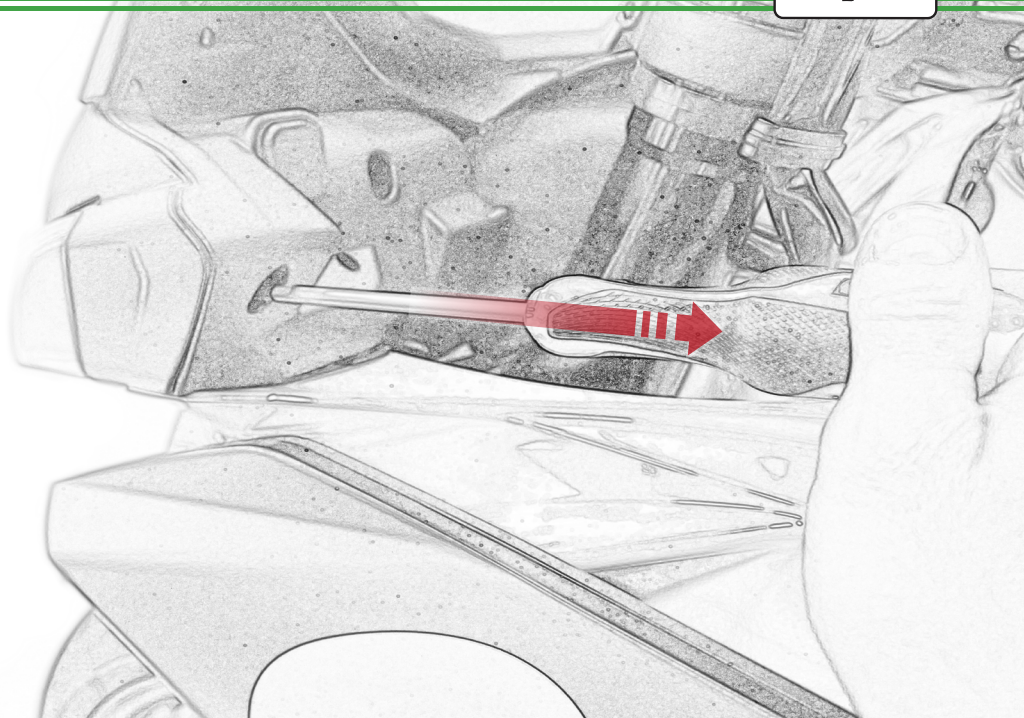

Repeat
Both Sides

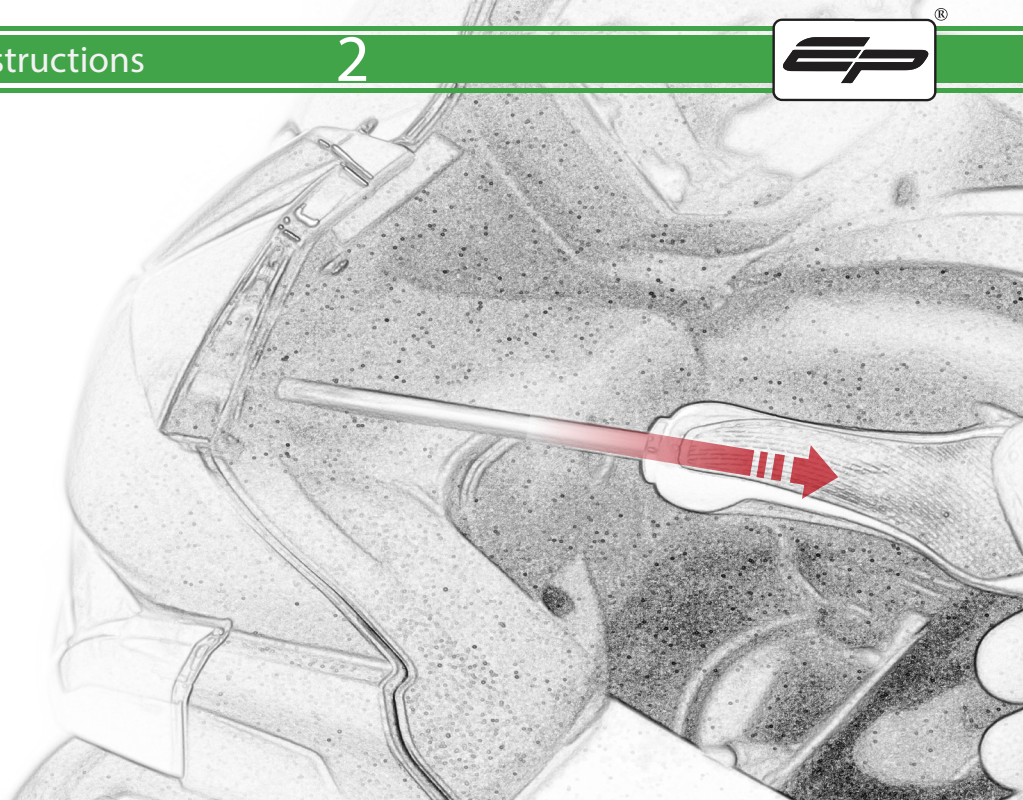

Repeat
Both Sides

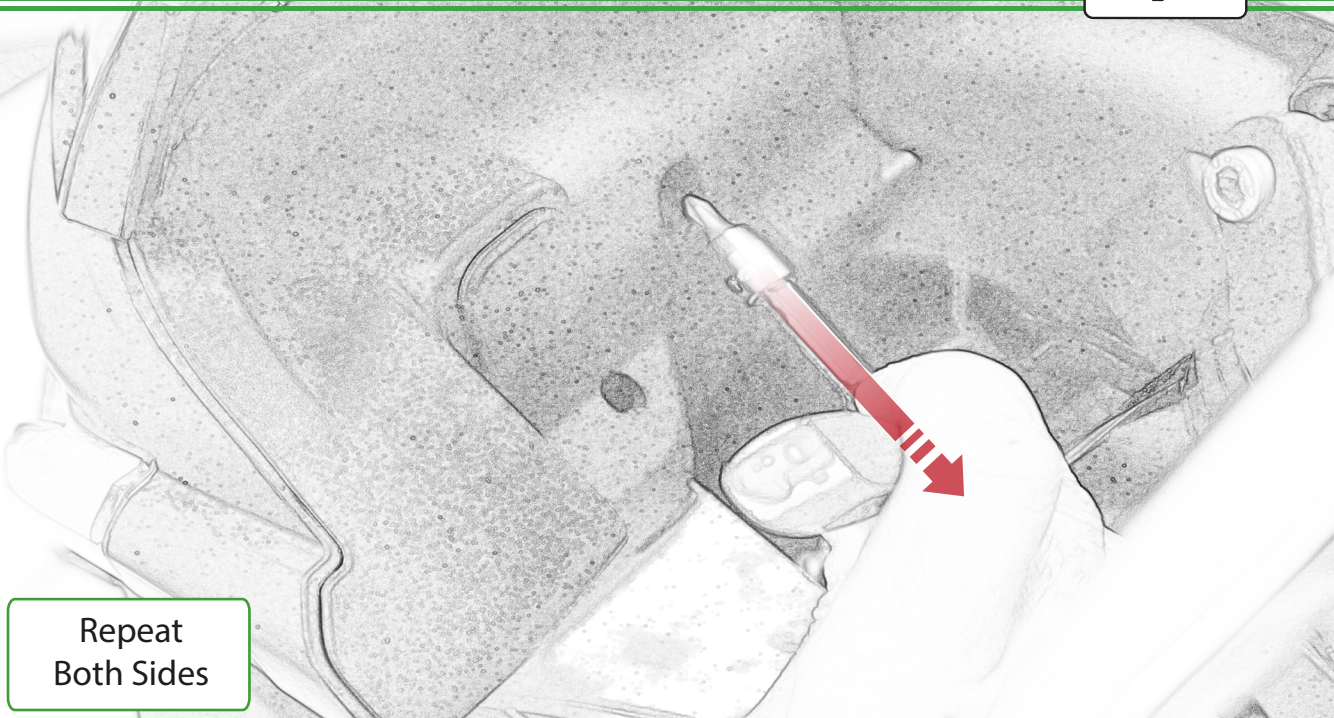

Repeat
Both Sides



4

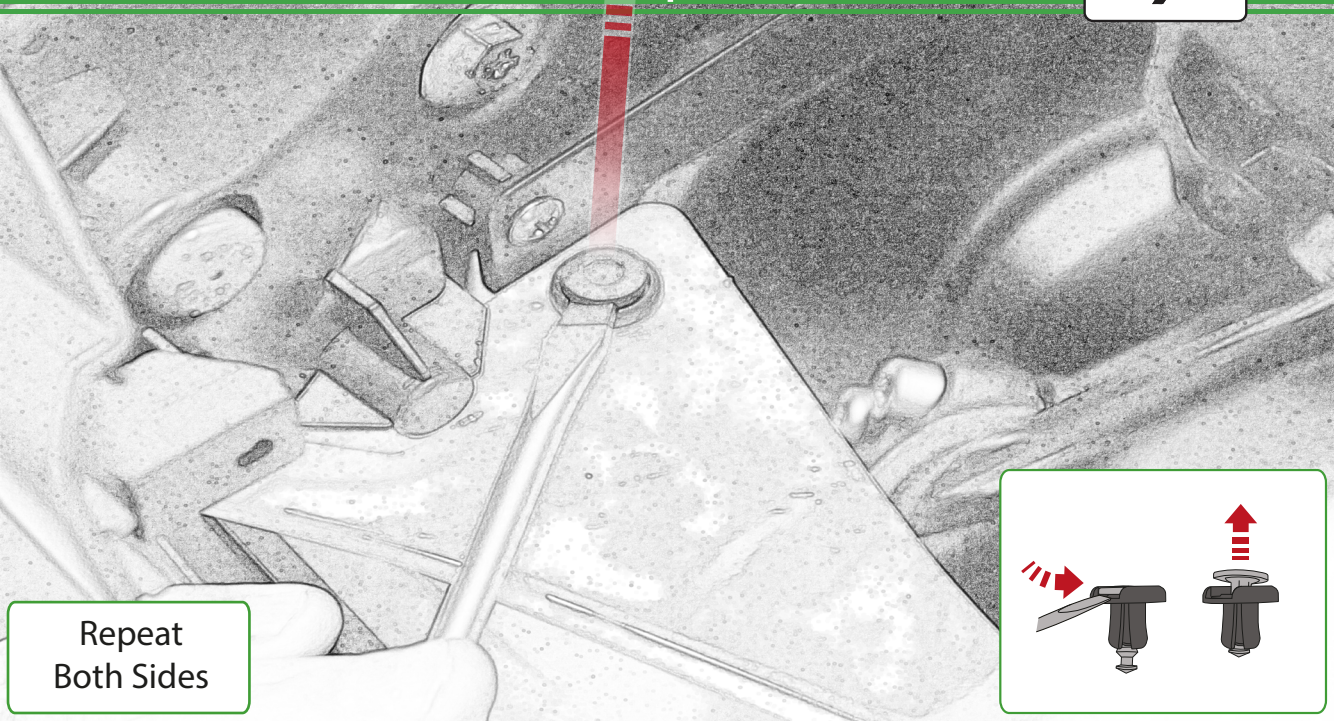

Repeat
Both Sides

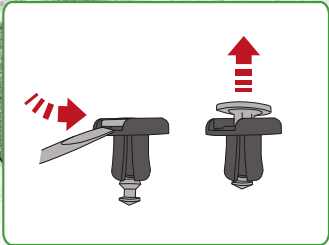

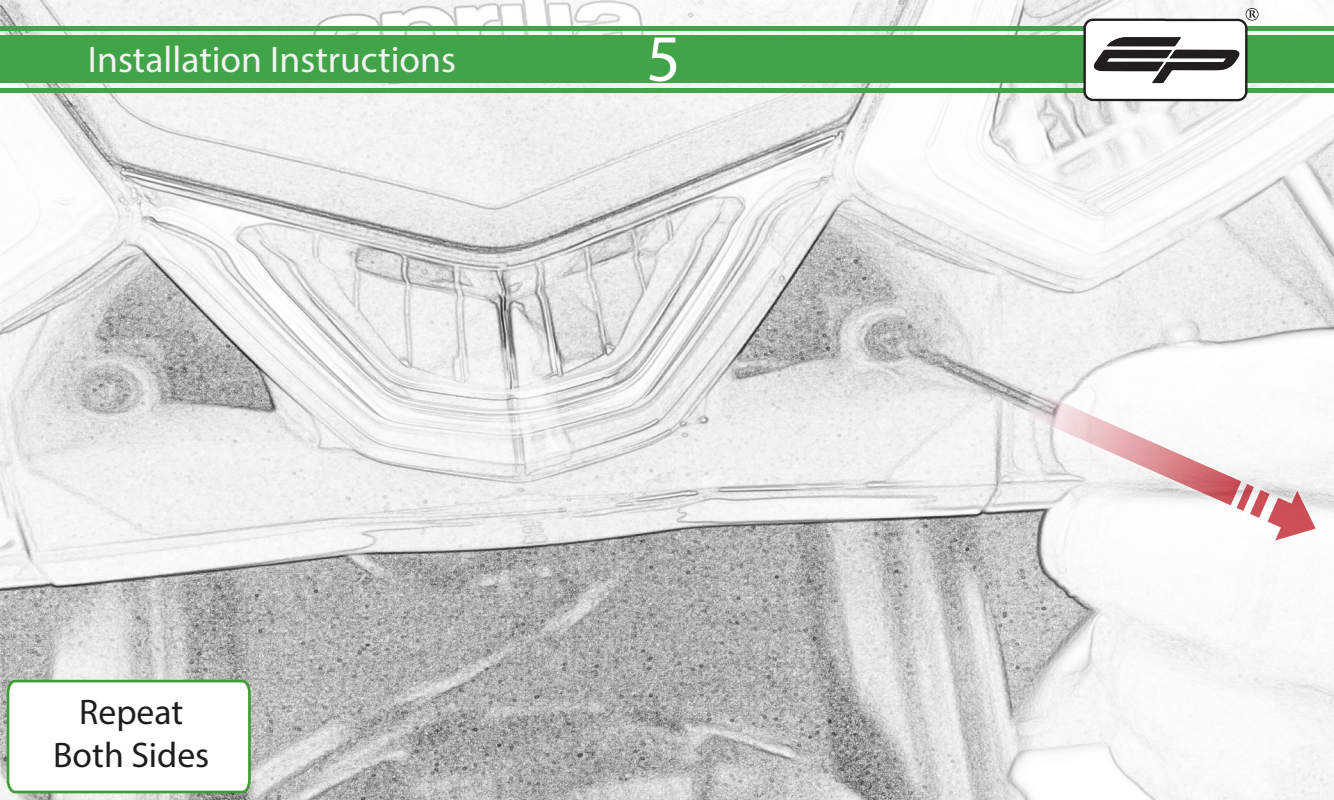

Repeat
Both Sides



6

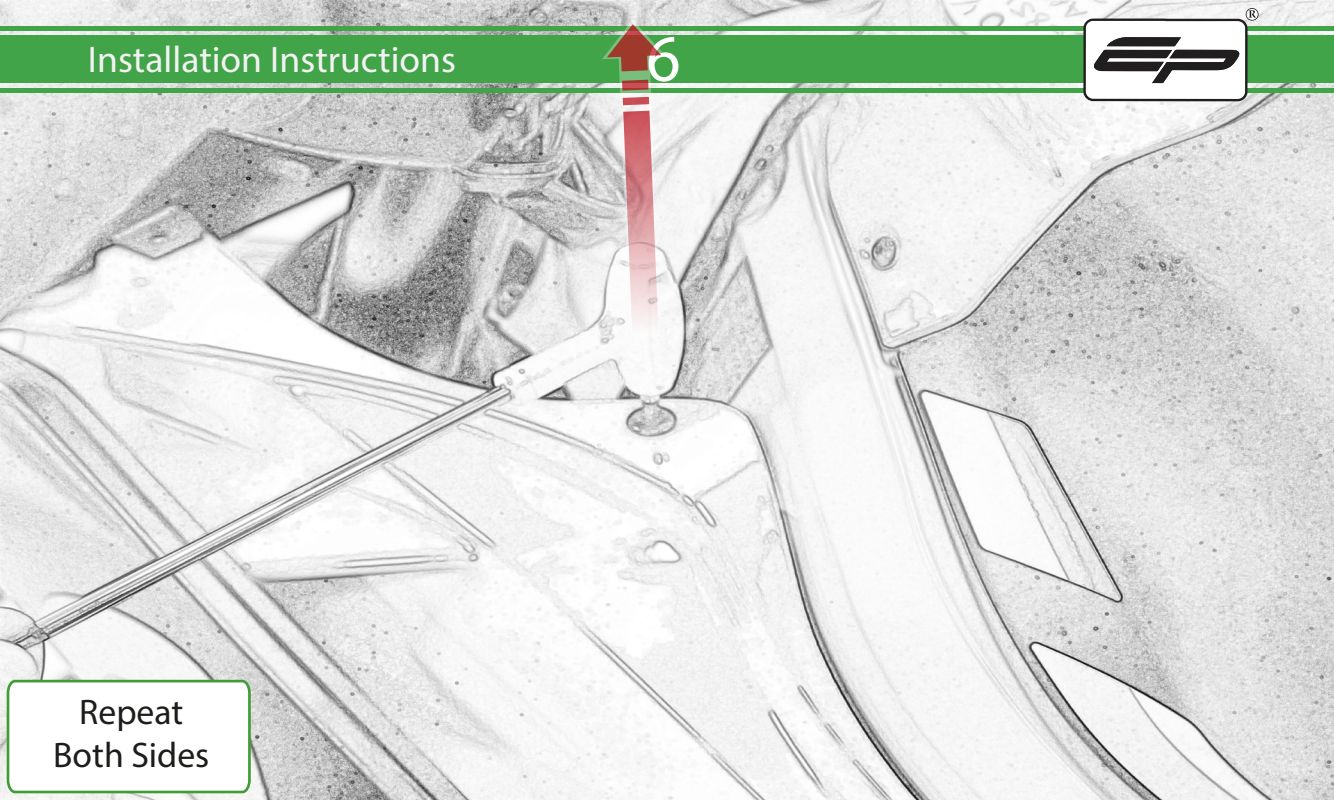

Repeat
Both Sides

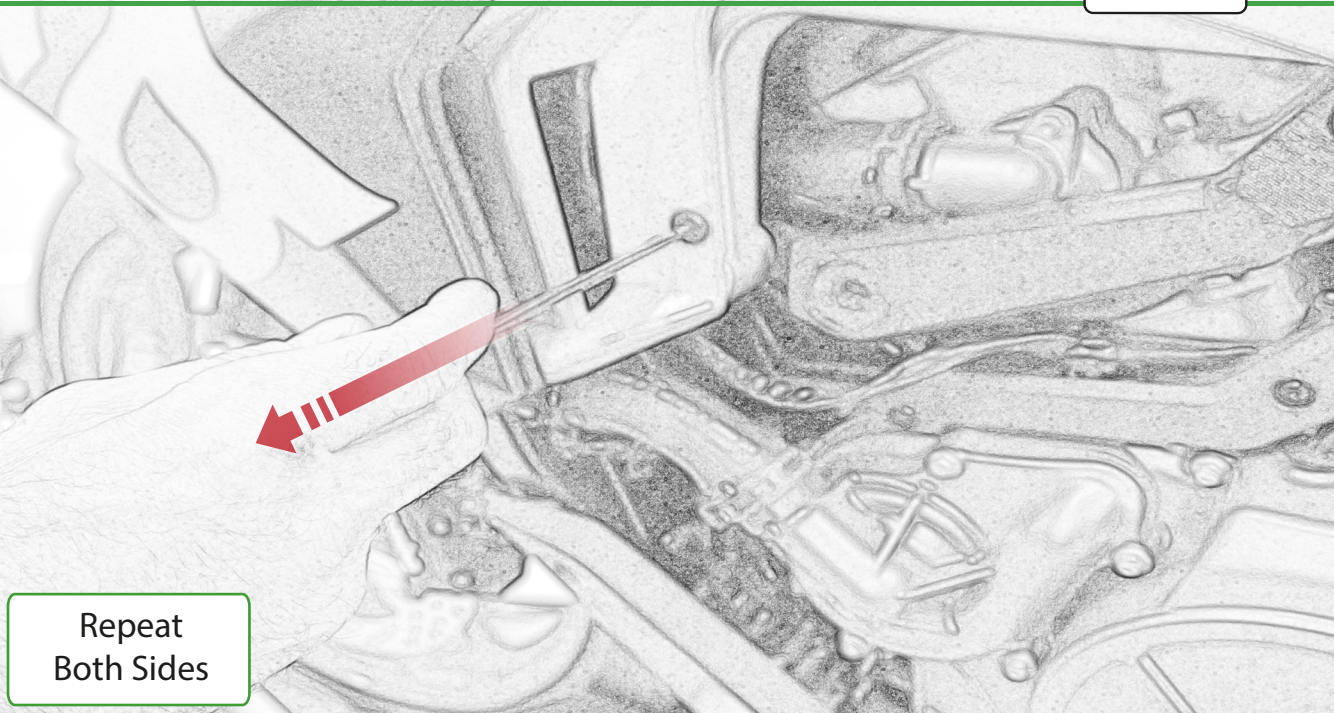

Repeat
Both Sides



Repeat
Both Sides

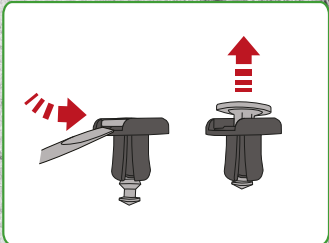

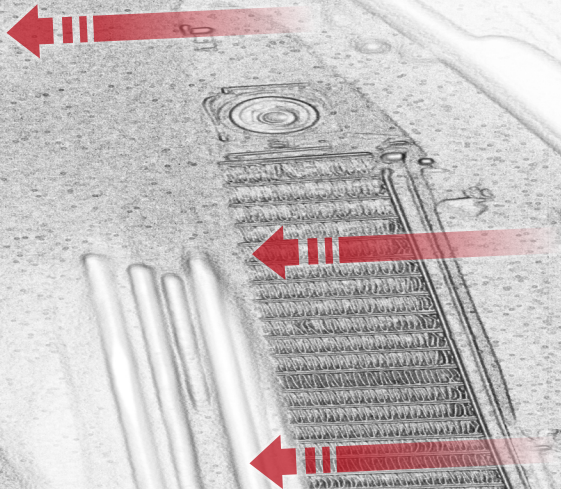

Repeat
Both Sides

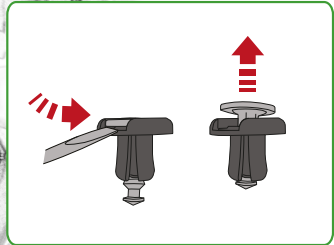

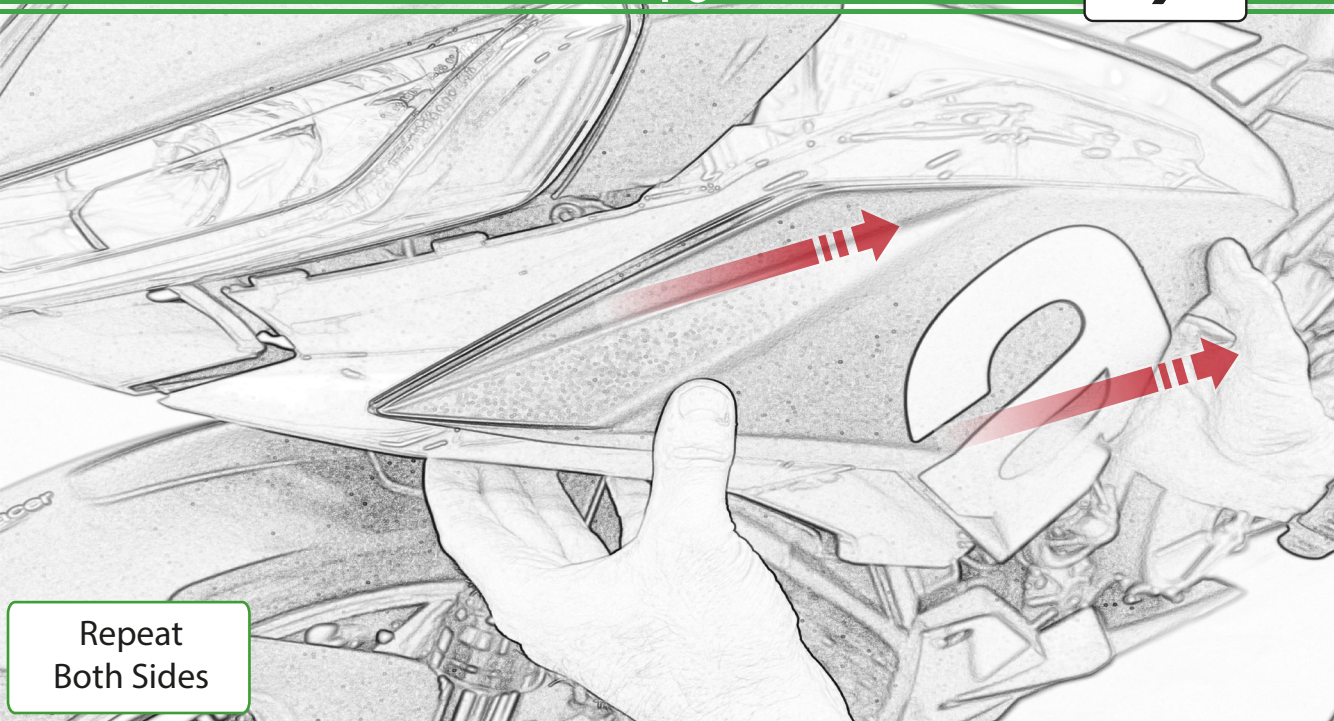

Repeat
Both Sides

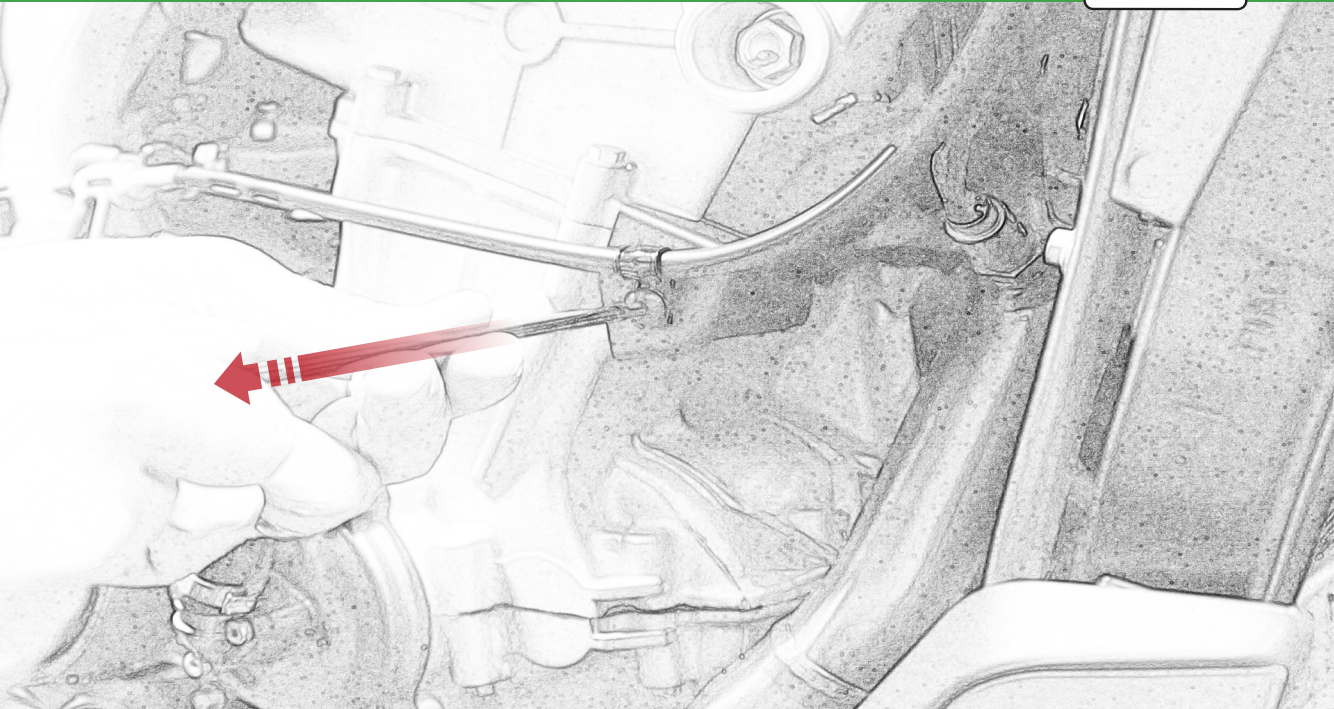

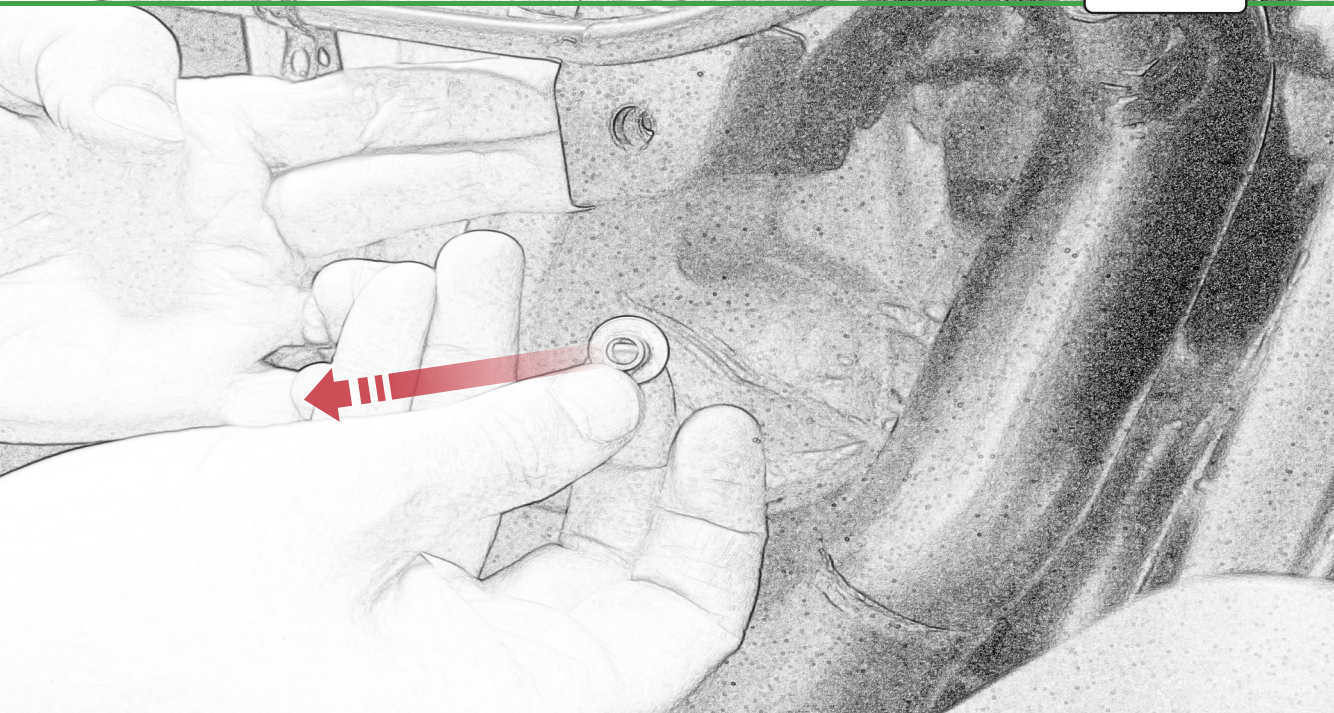

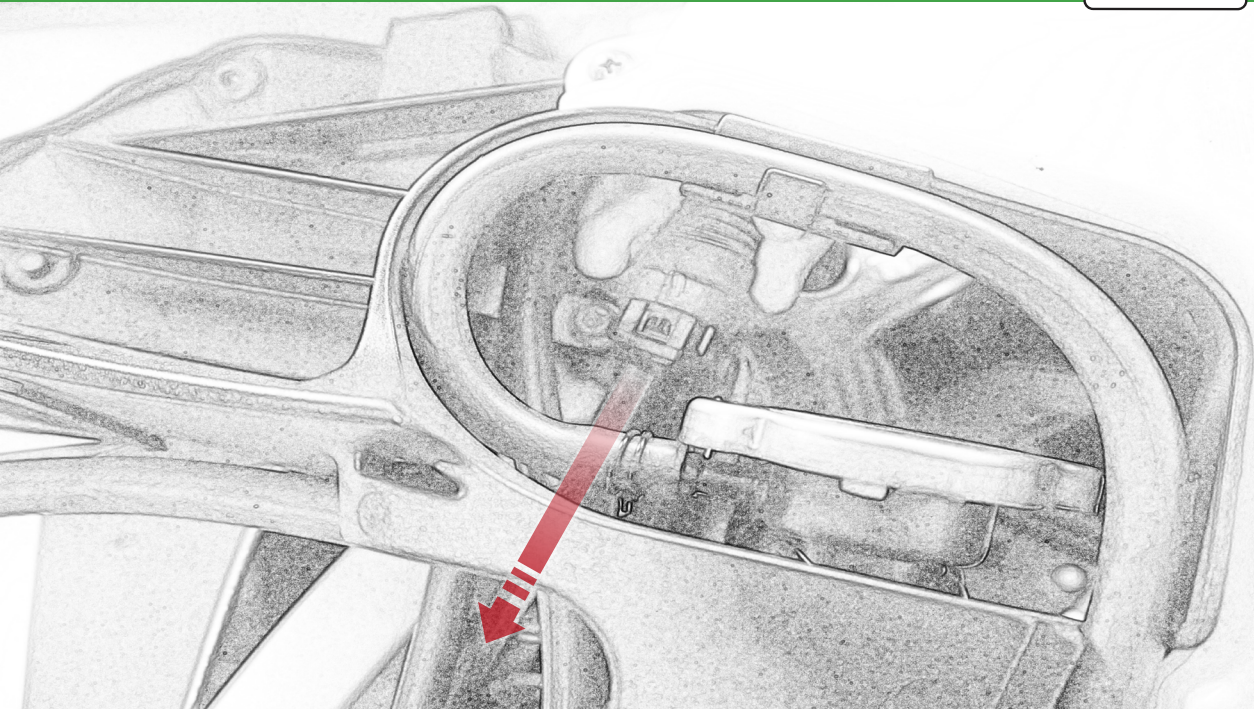

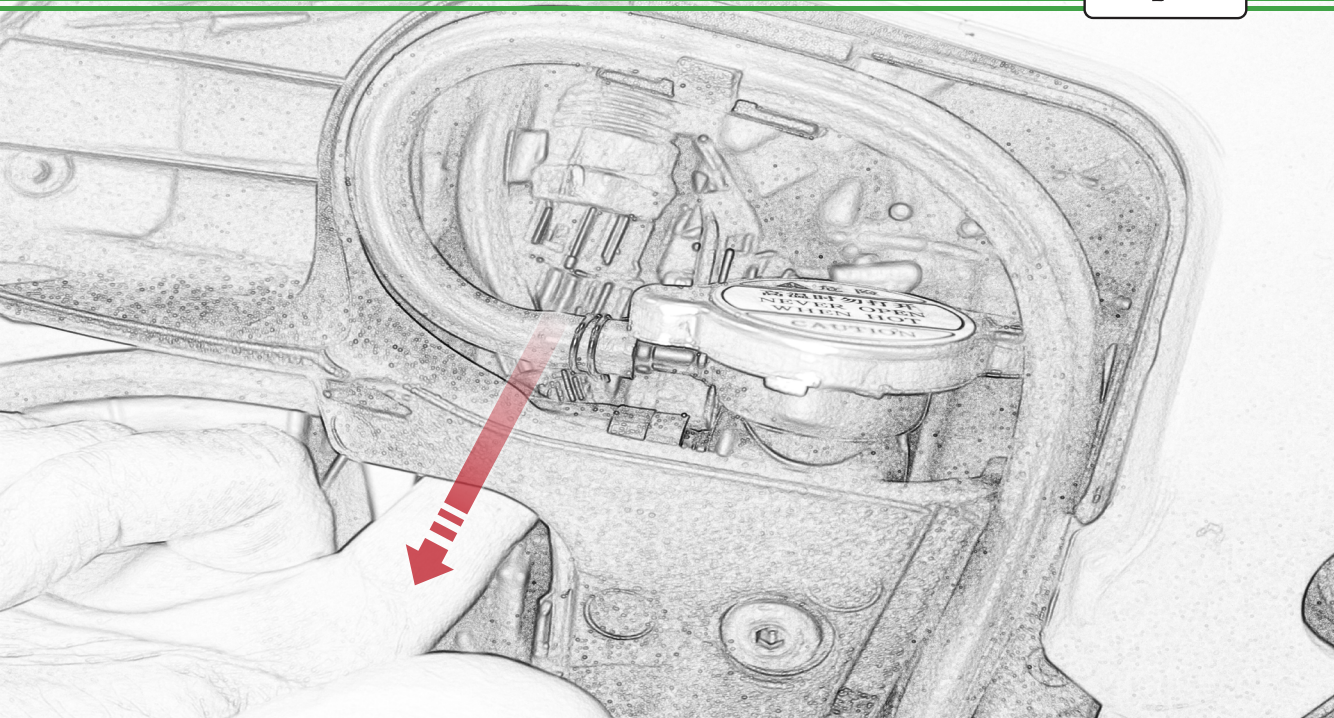

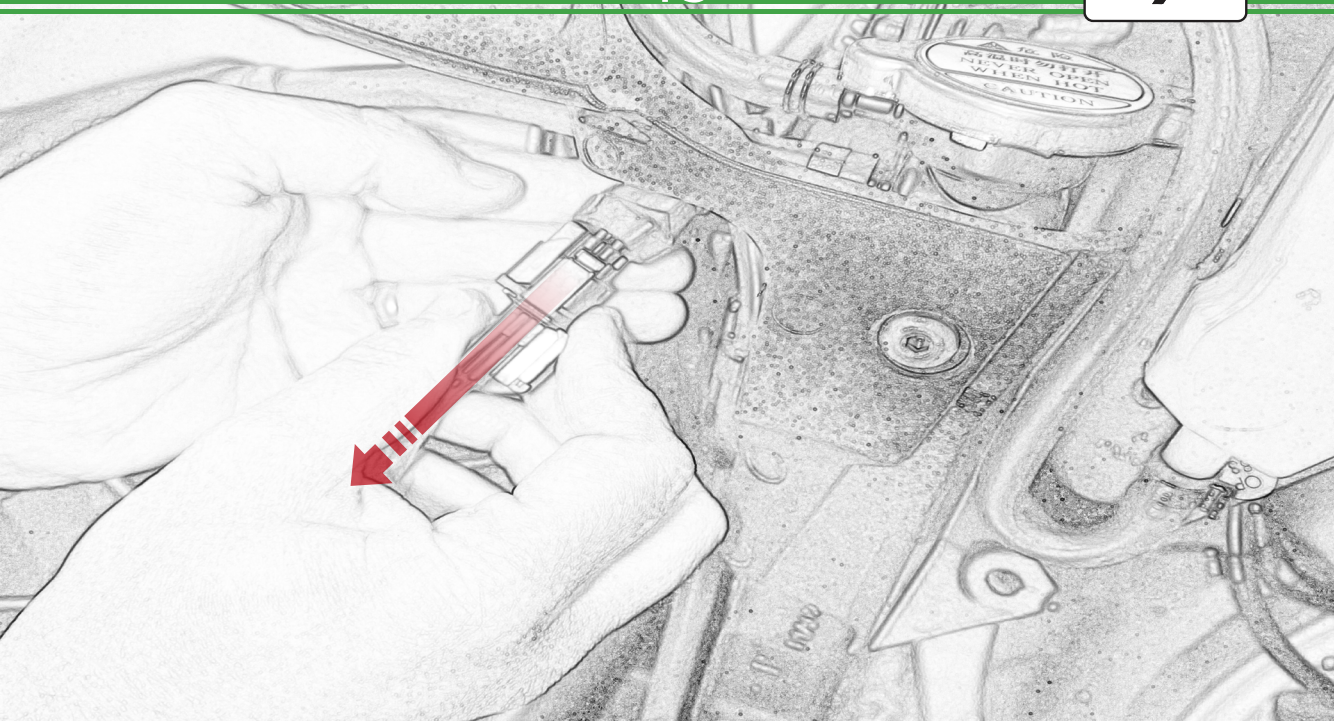

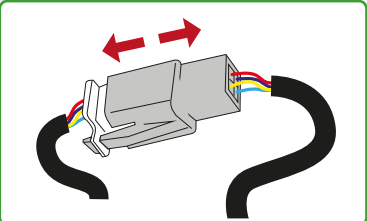
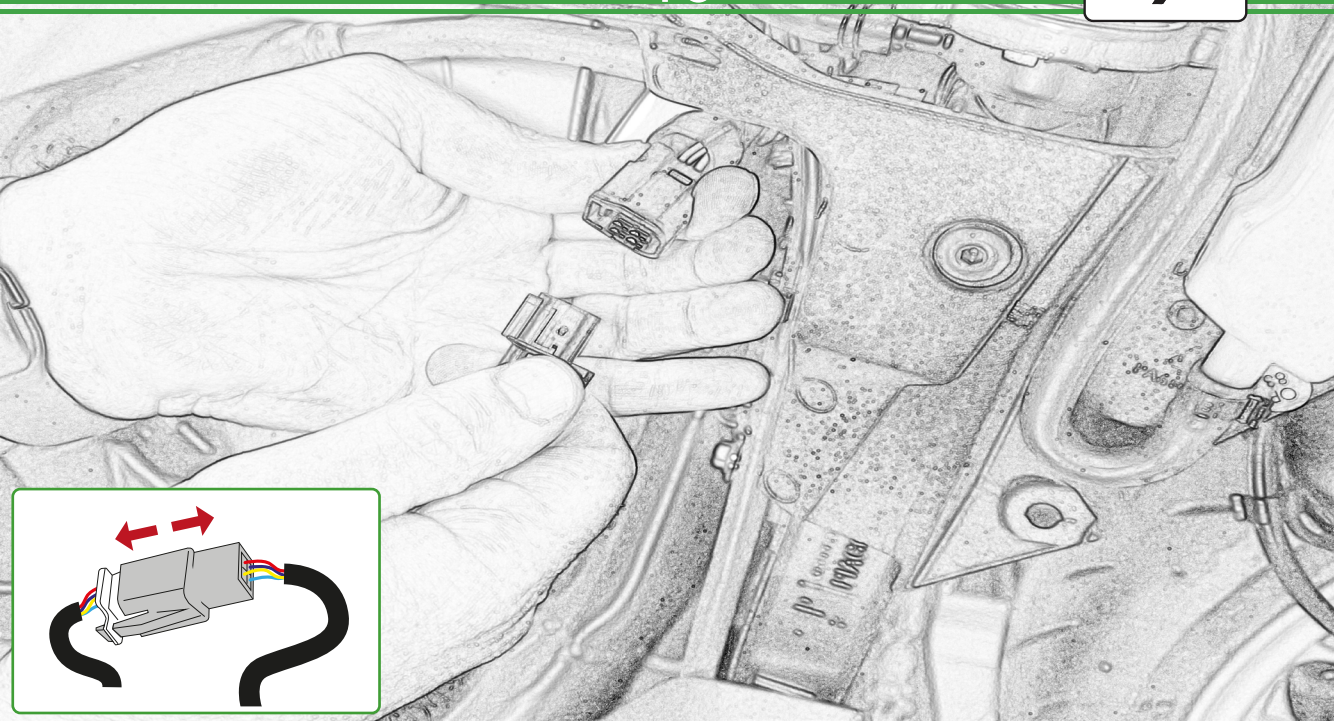

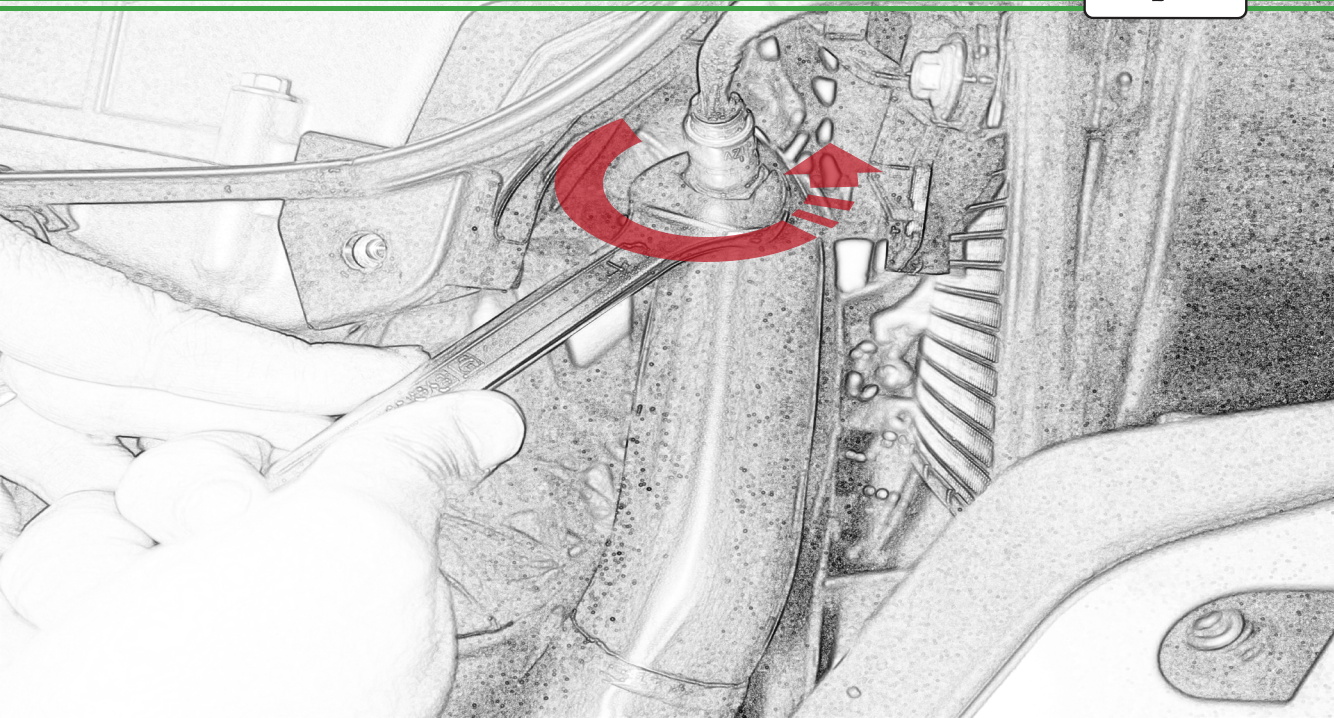

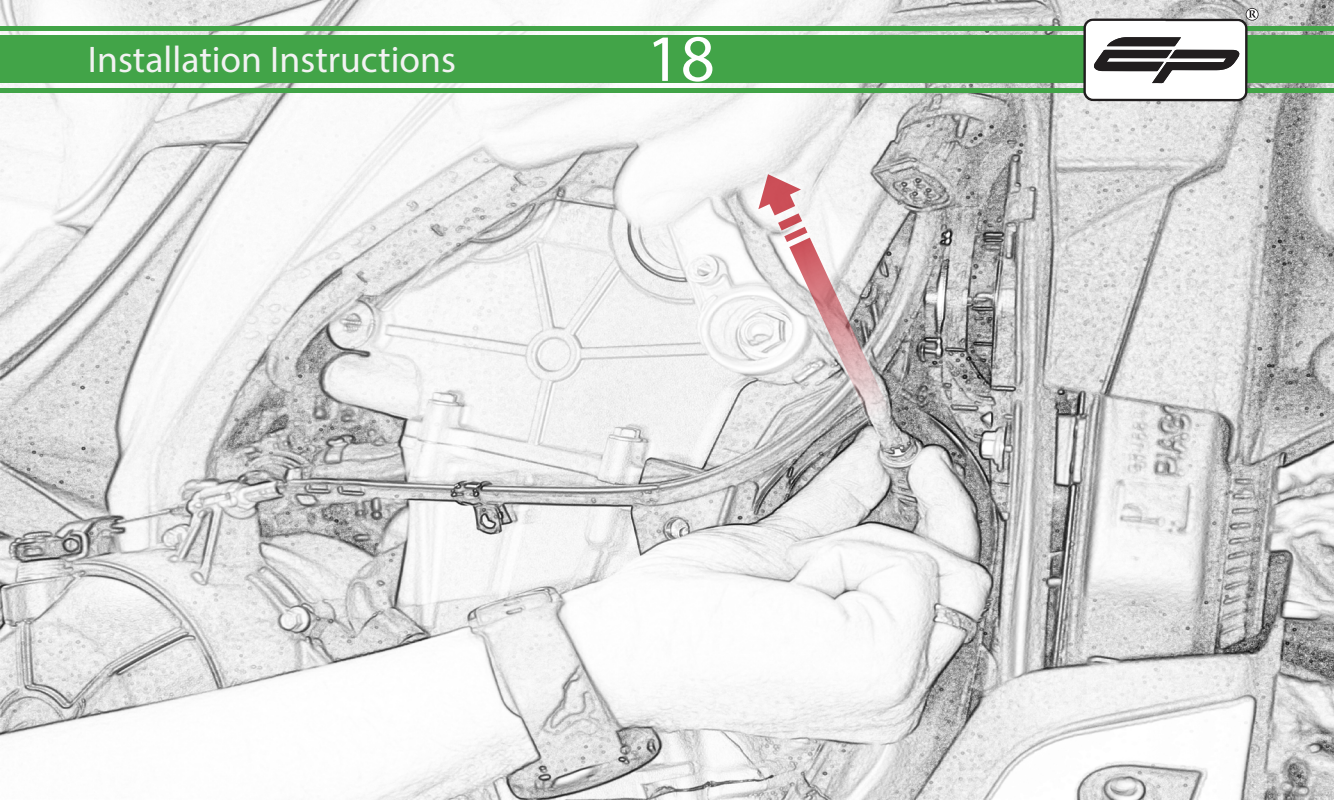



Remove Wire
From Bracket



Caution

Remove
Connector

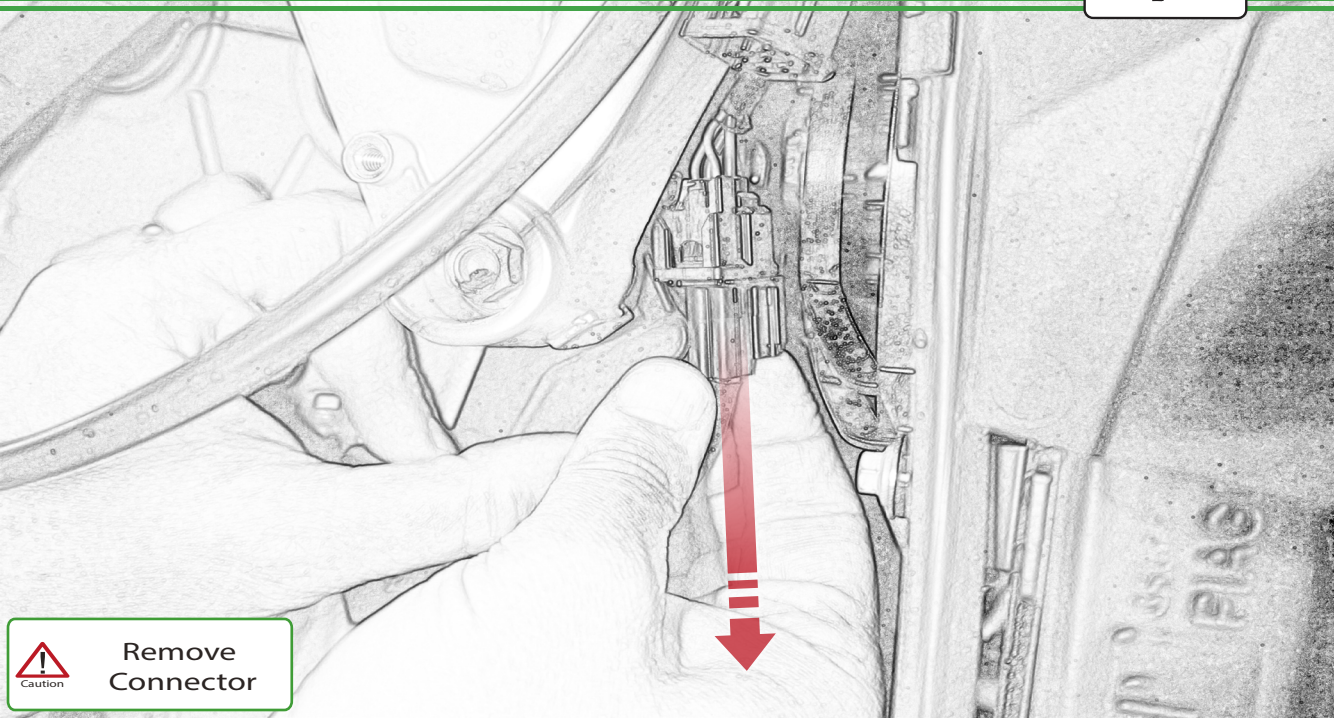

Caution

Remove
Connector

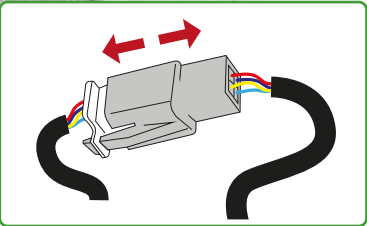

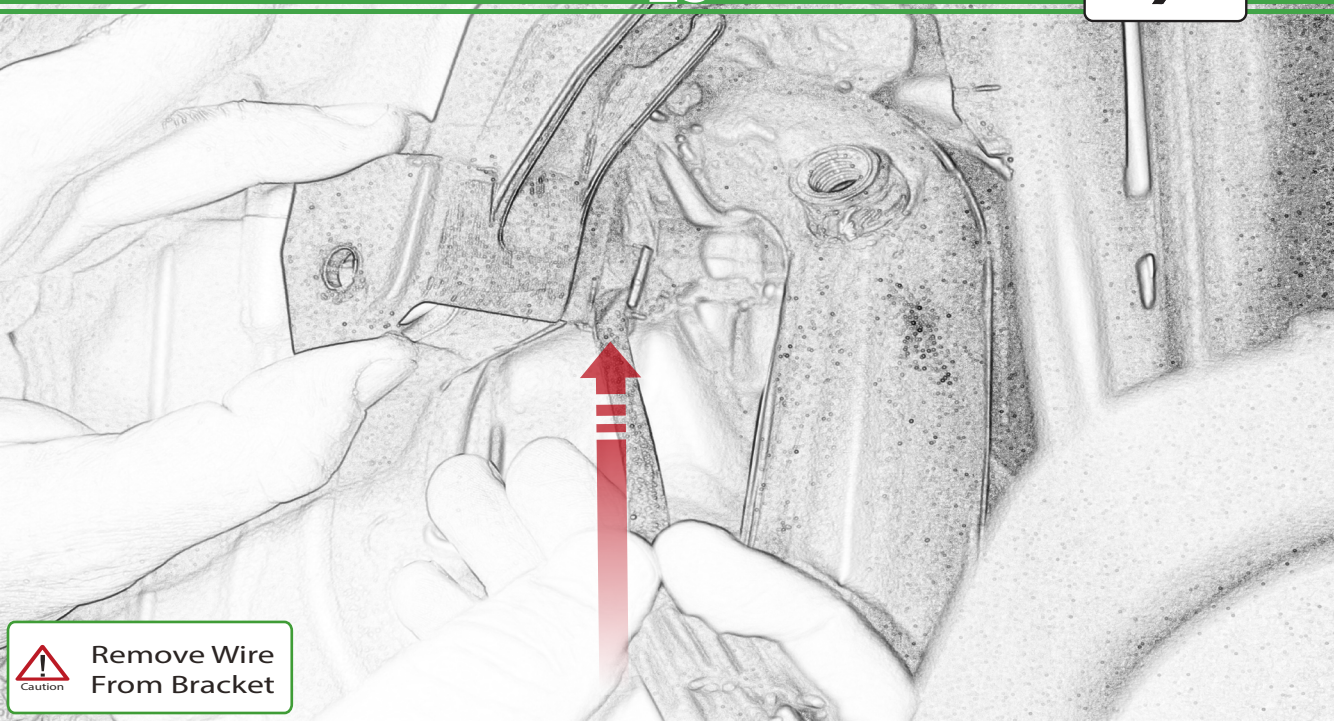

Remove Wire
From Bracket

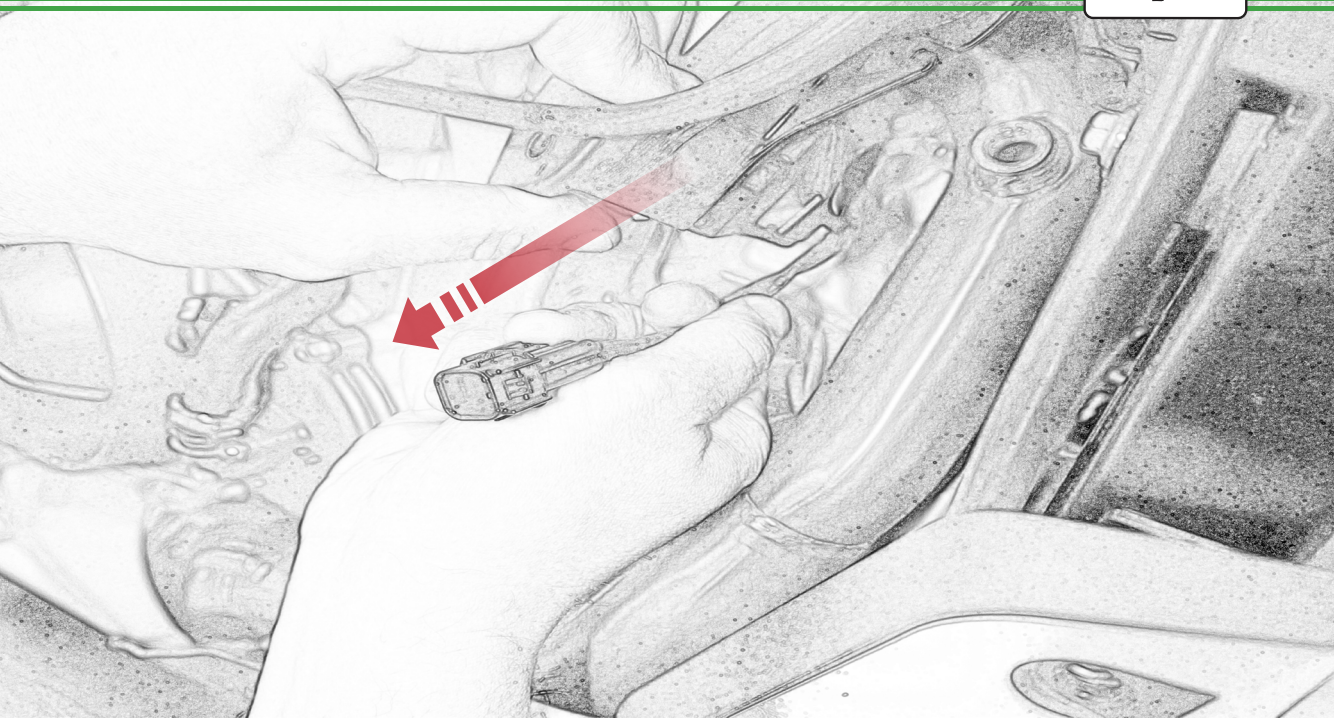

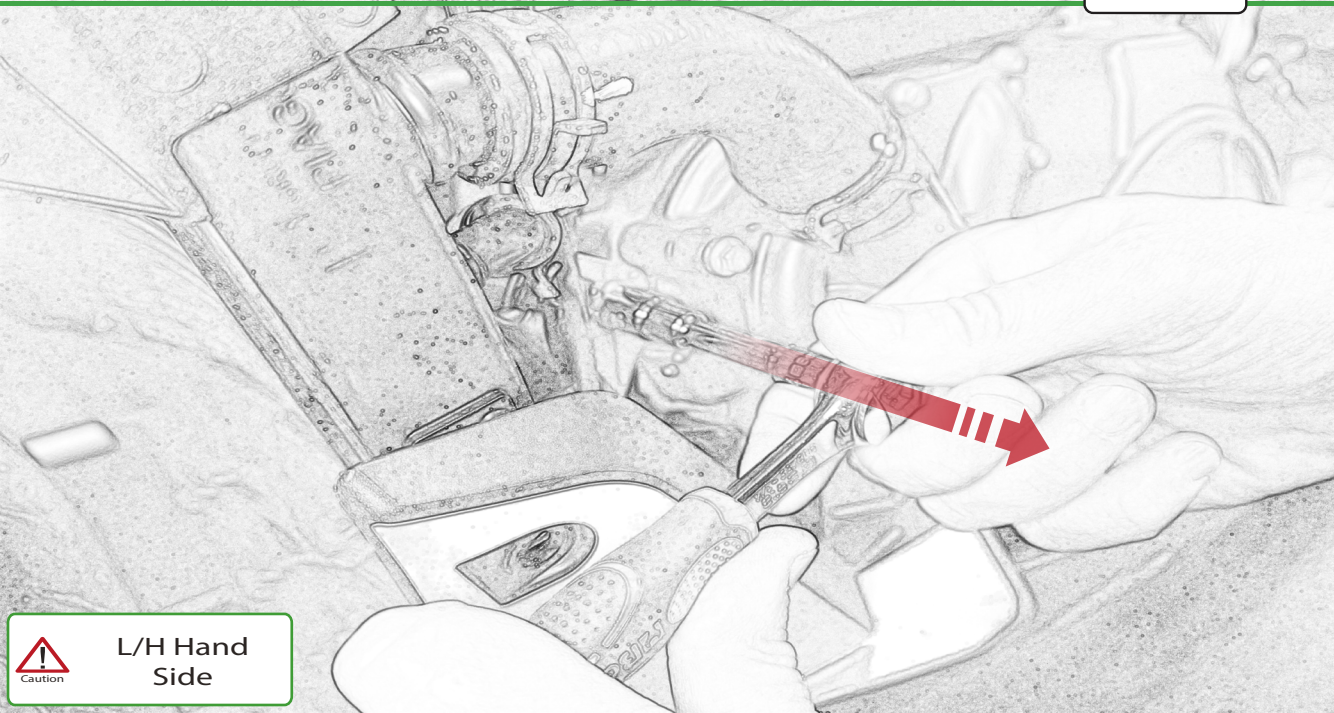

L/H Hand
Side



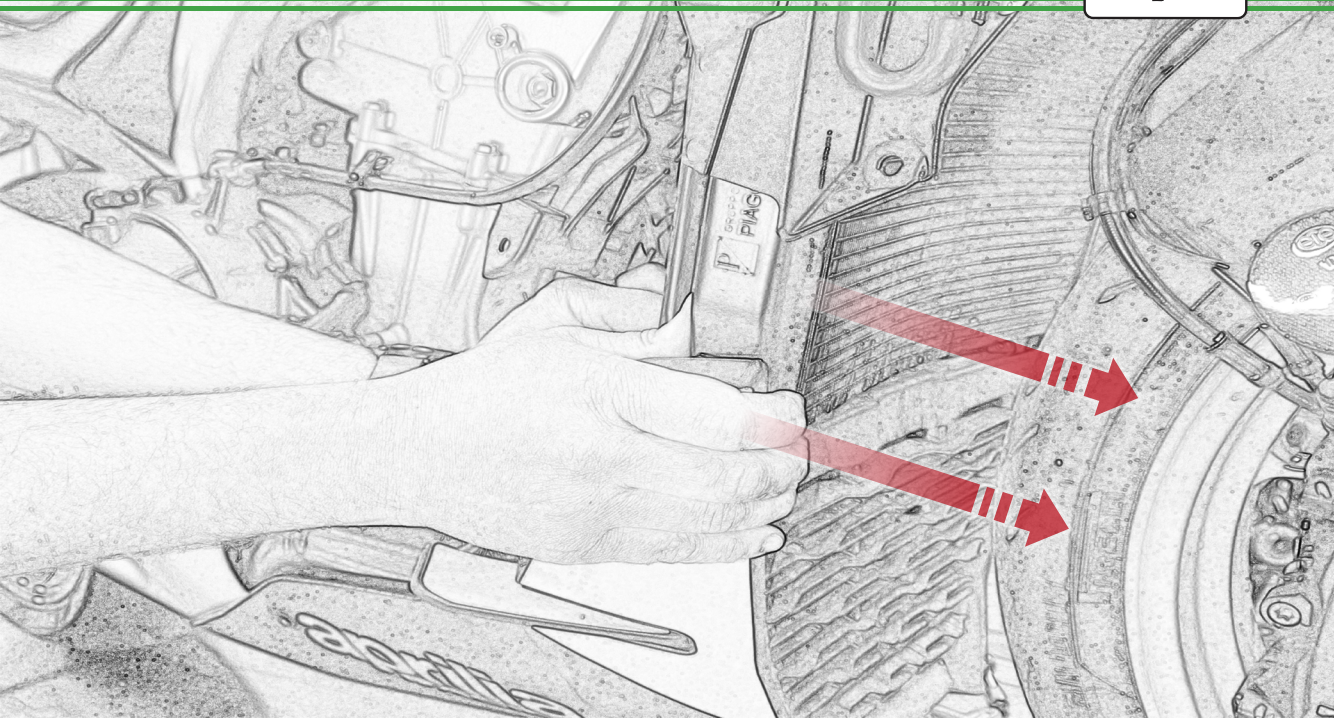

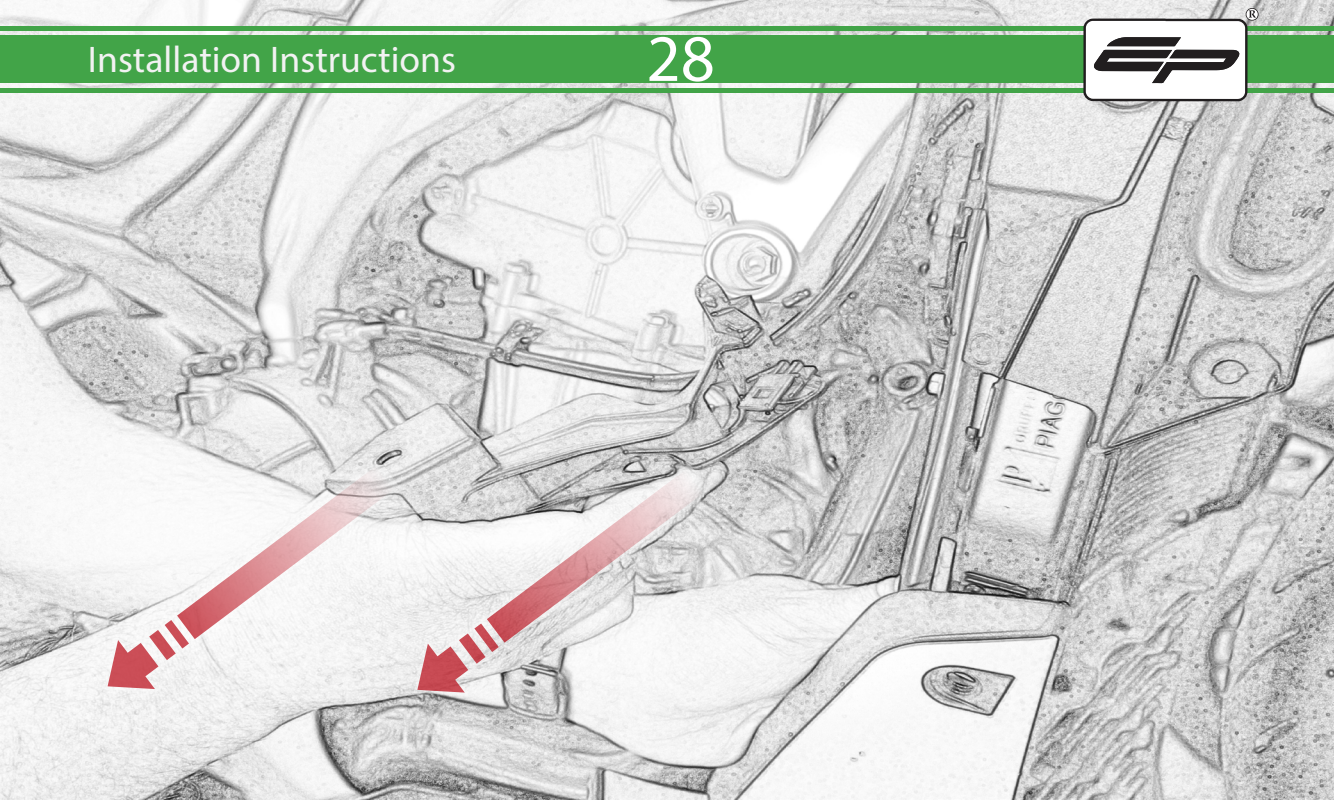

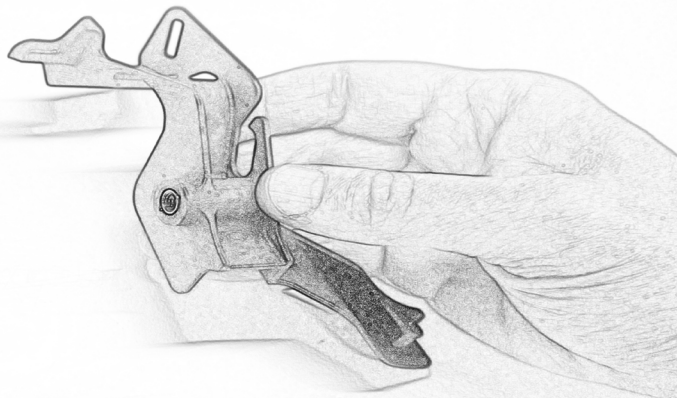
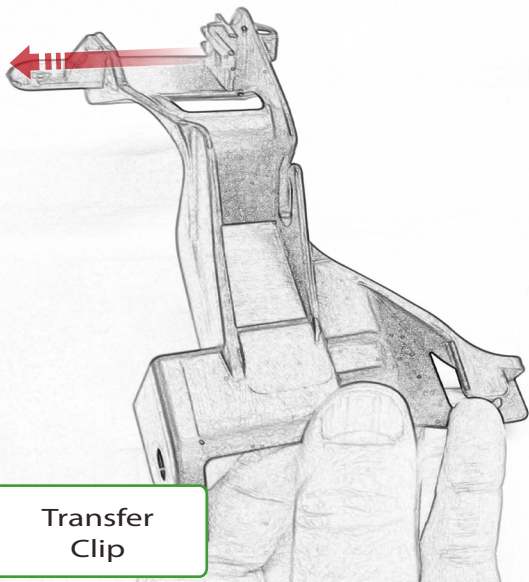

Caution

Transfer
Clip

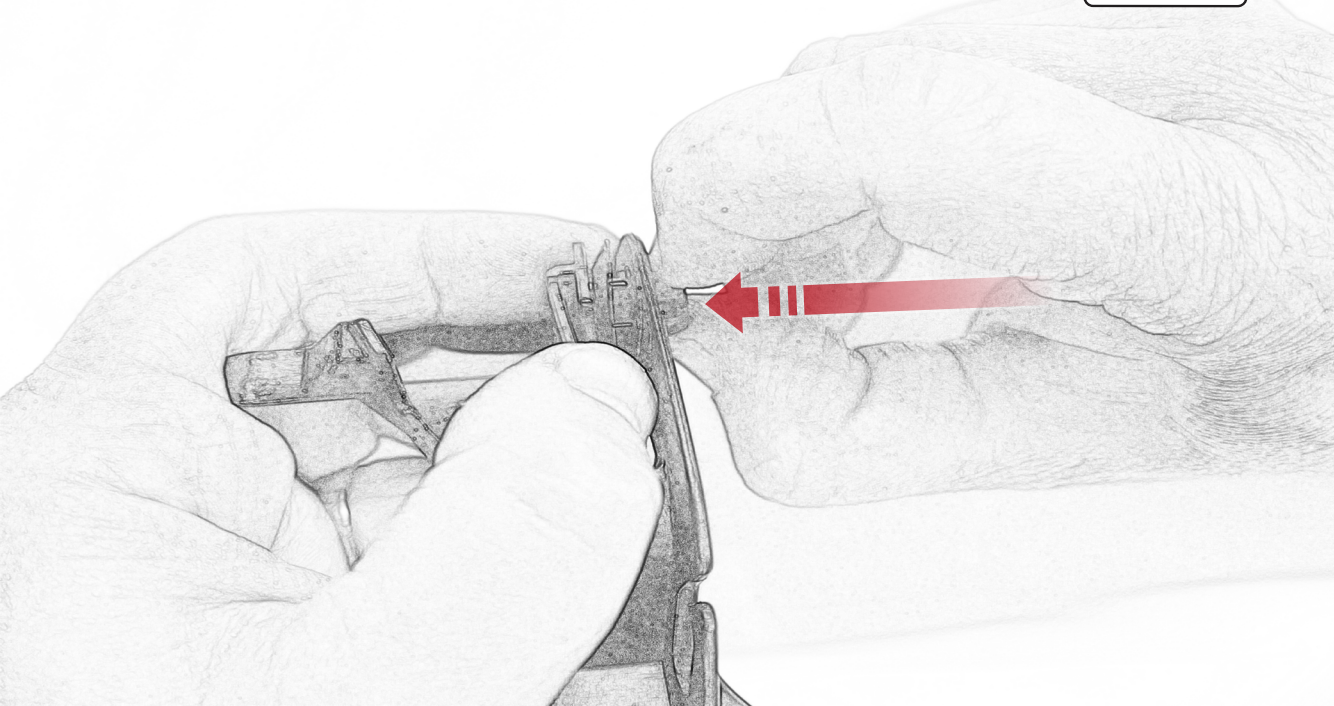

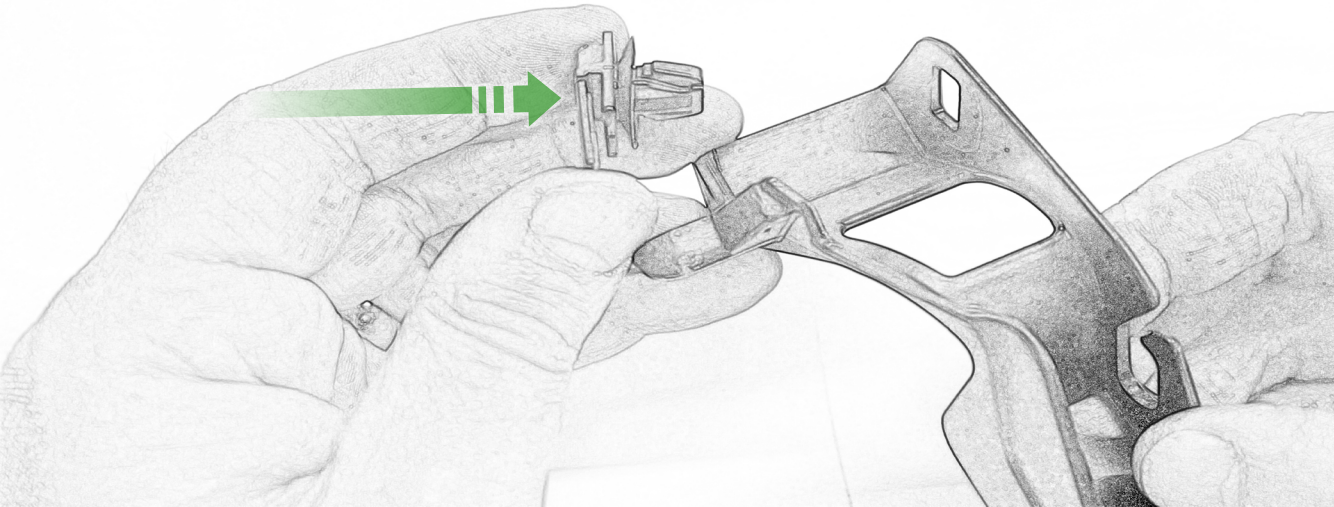

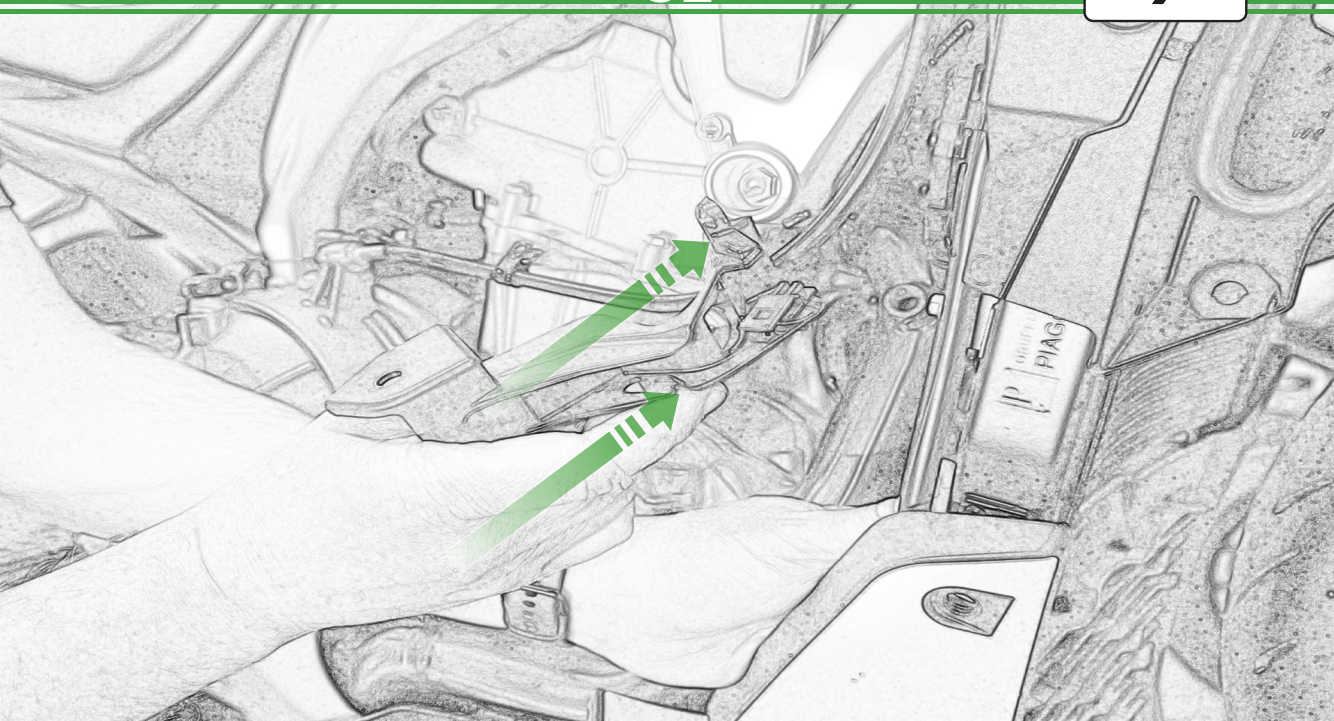

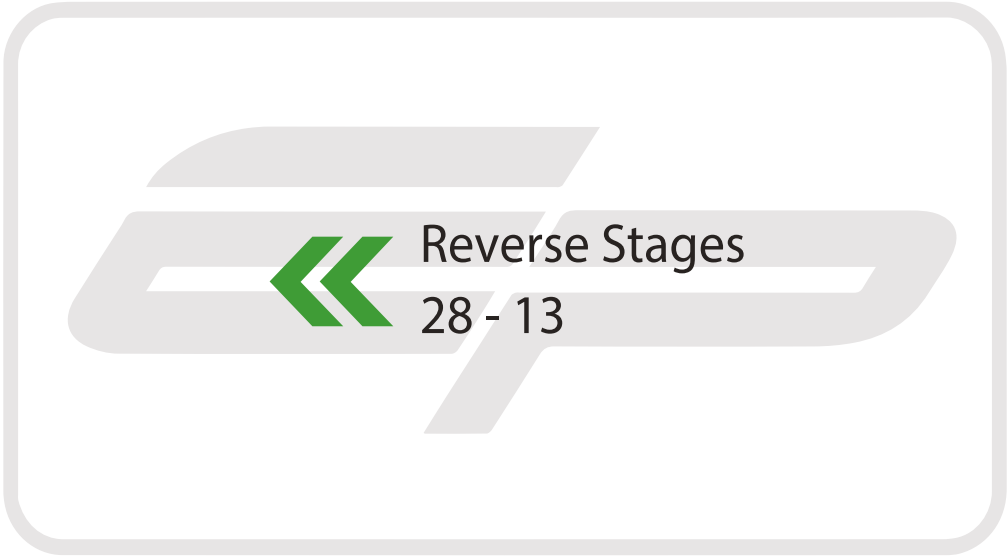

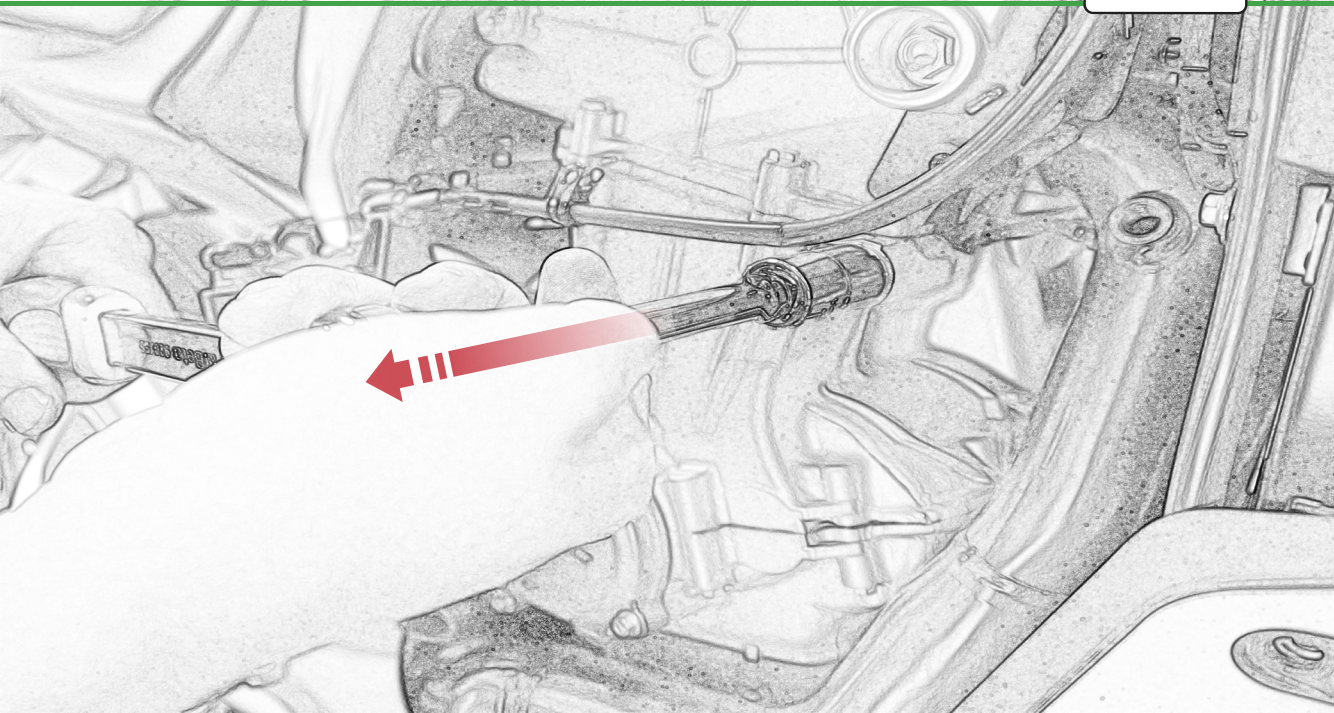

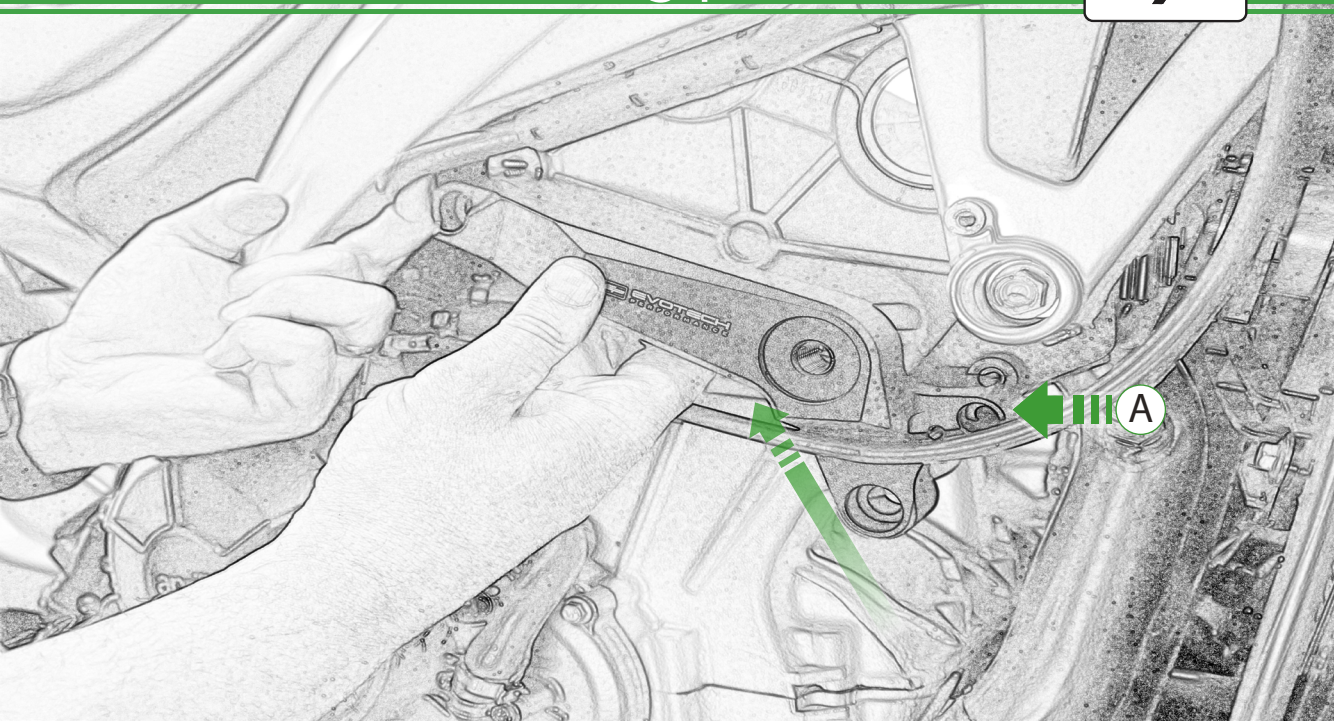

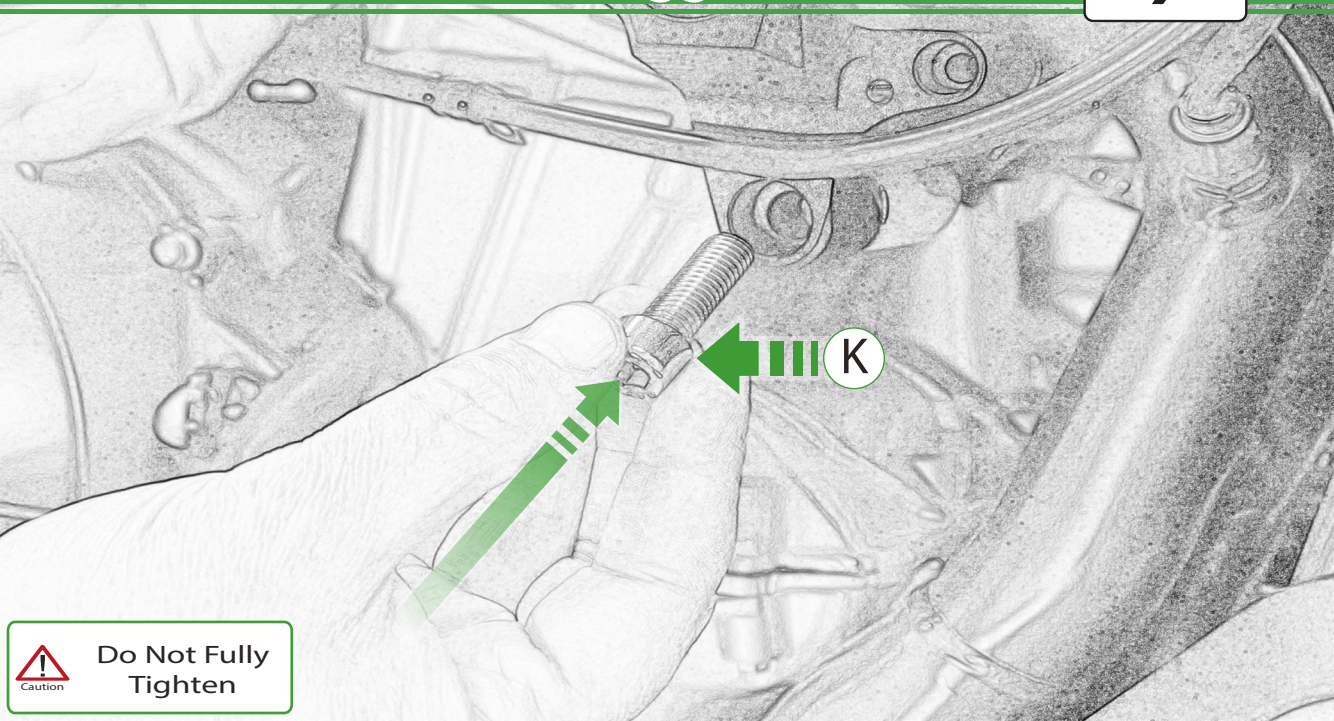

Do Not Fully Tighten

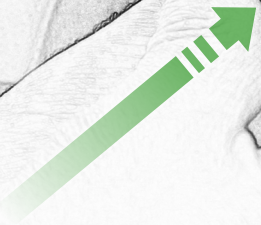
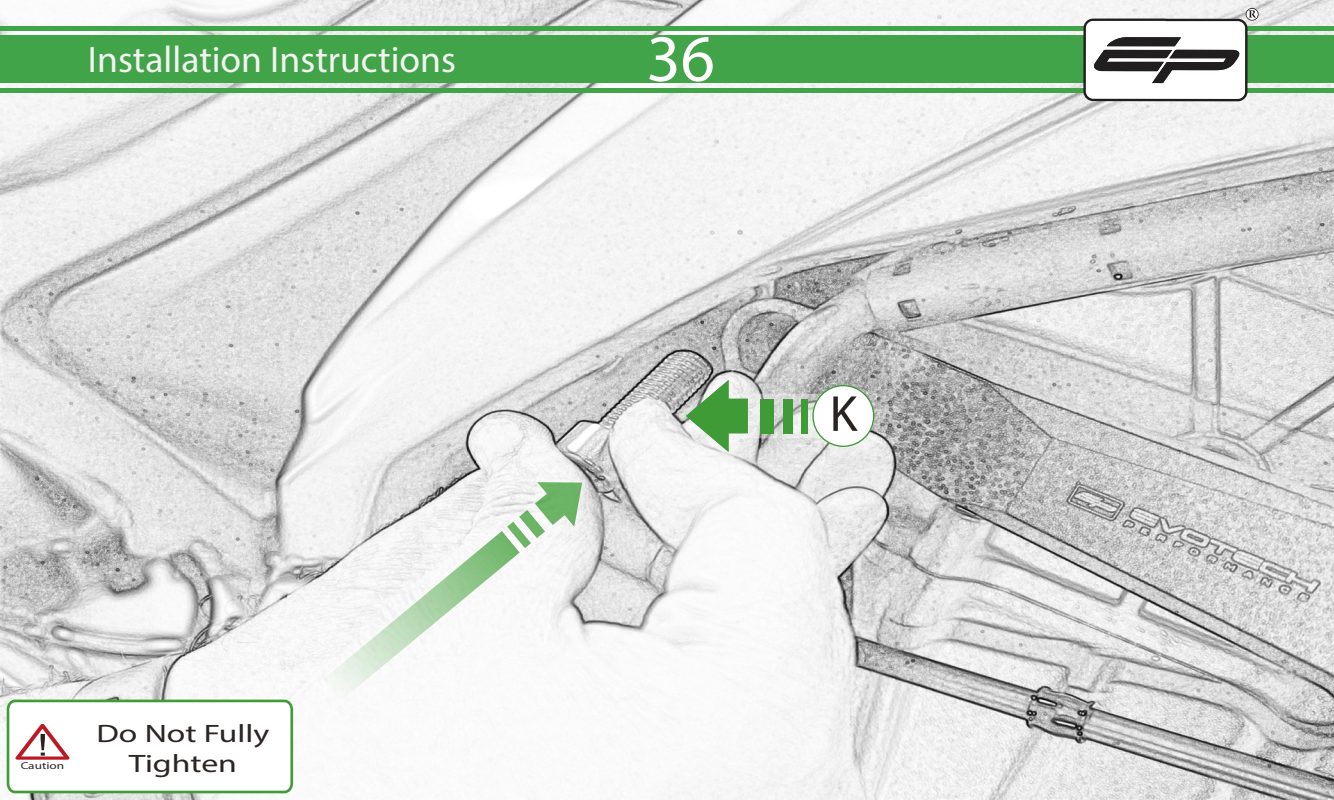

Do Not Fully Tighten

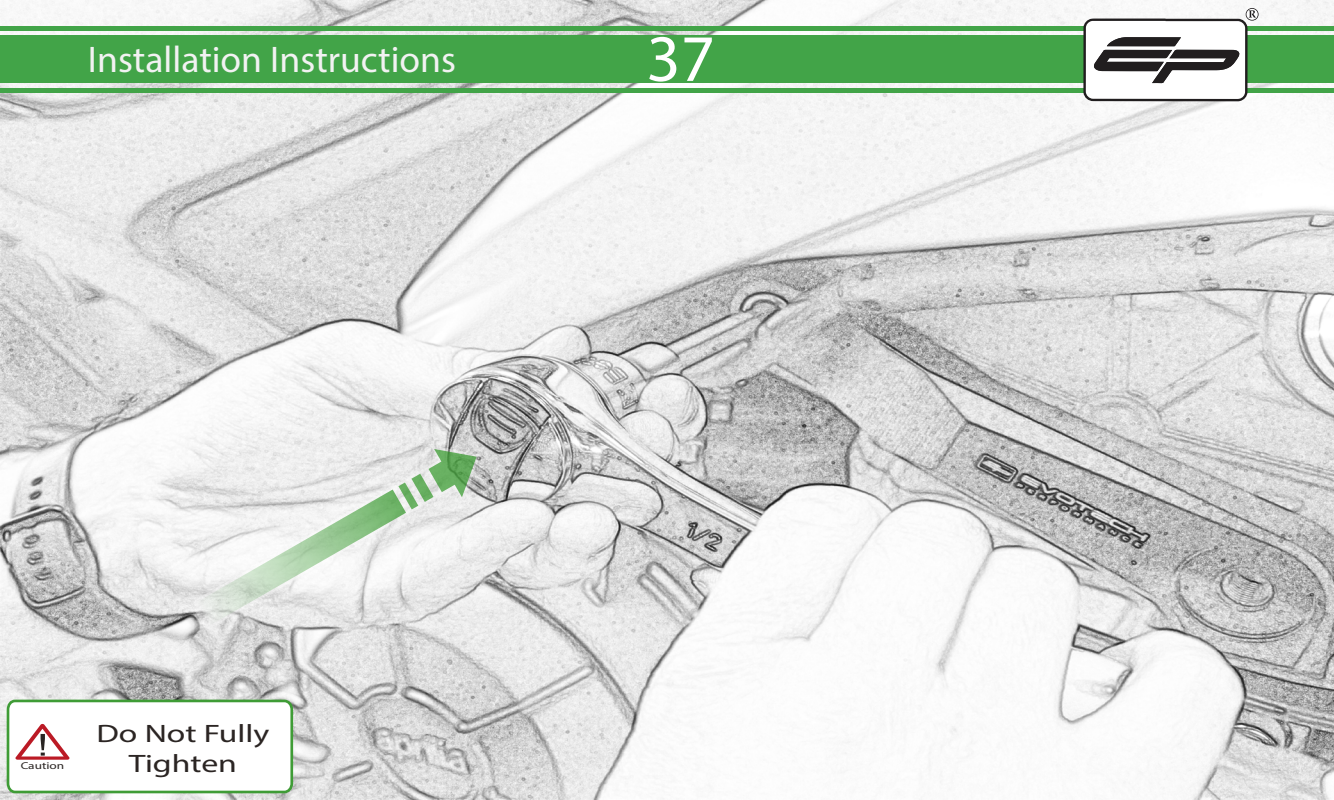

Do Not Fully
Tighten

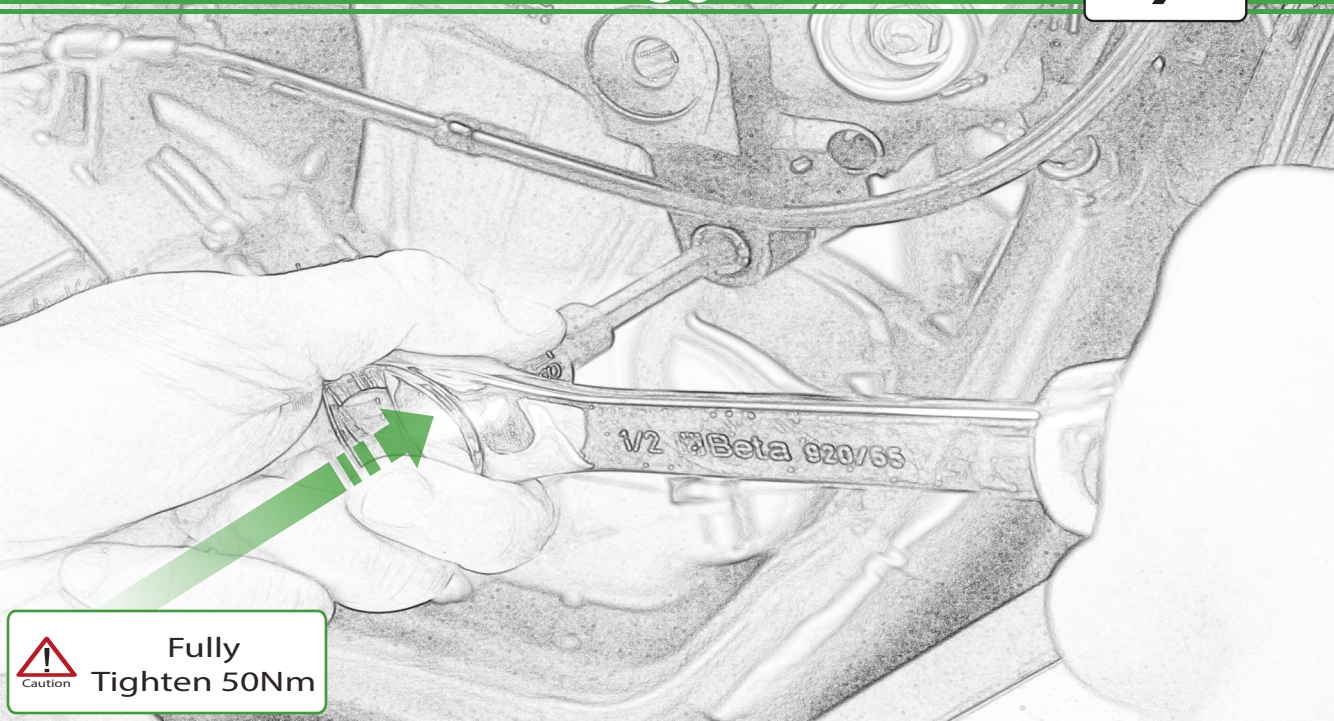

Caution

Fully
Tighten 50Nm

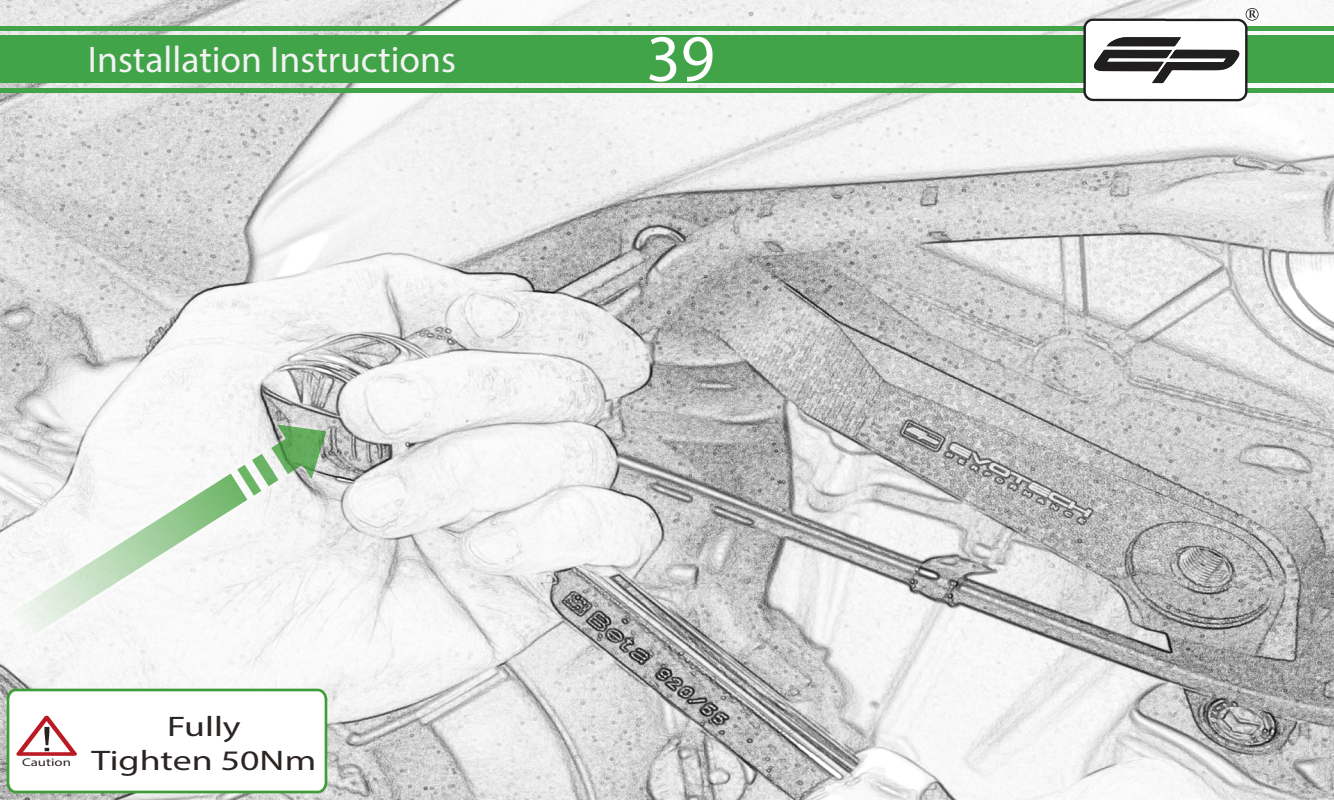

Caution

Fully
Tighten 50Nm

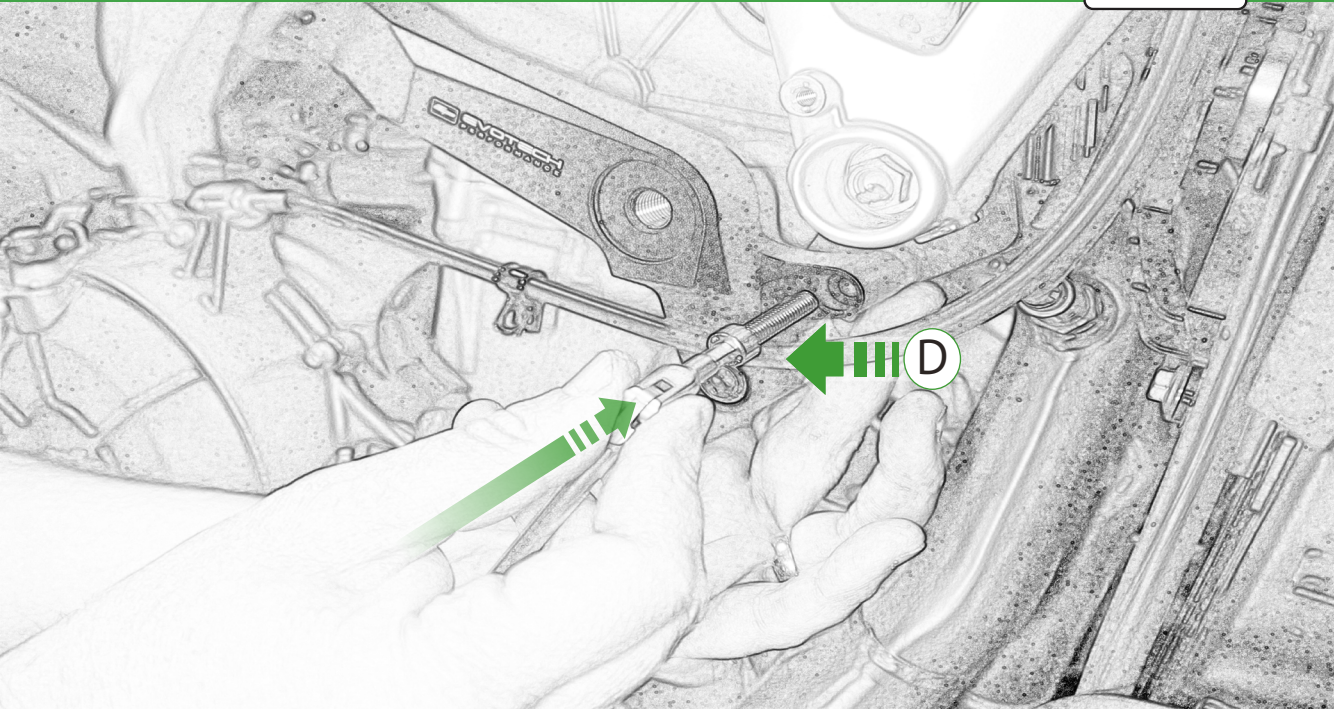

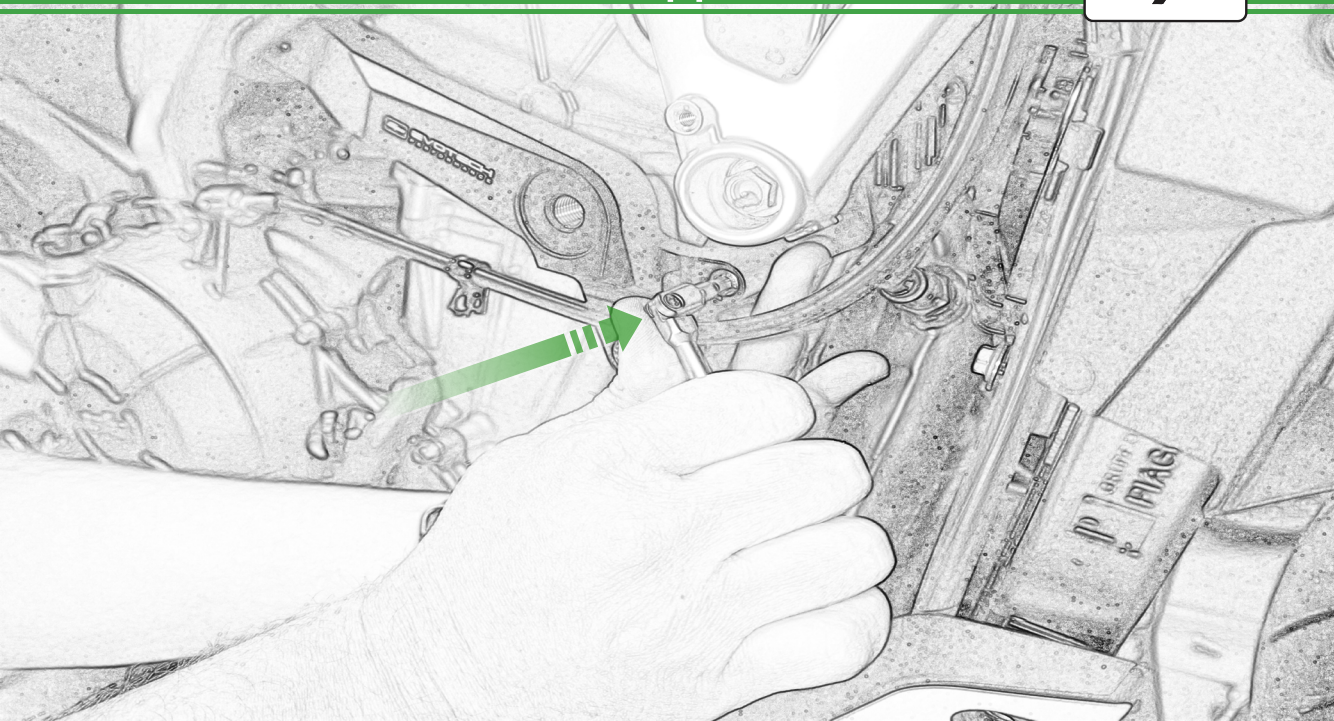





OEM PART

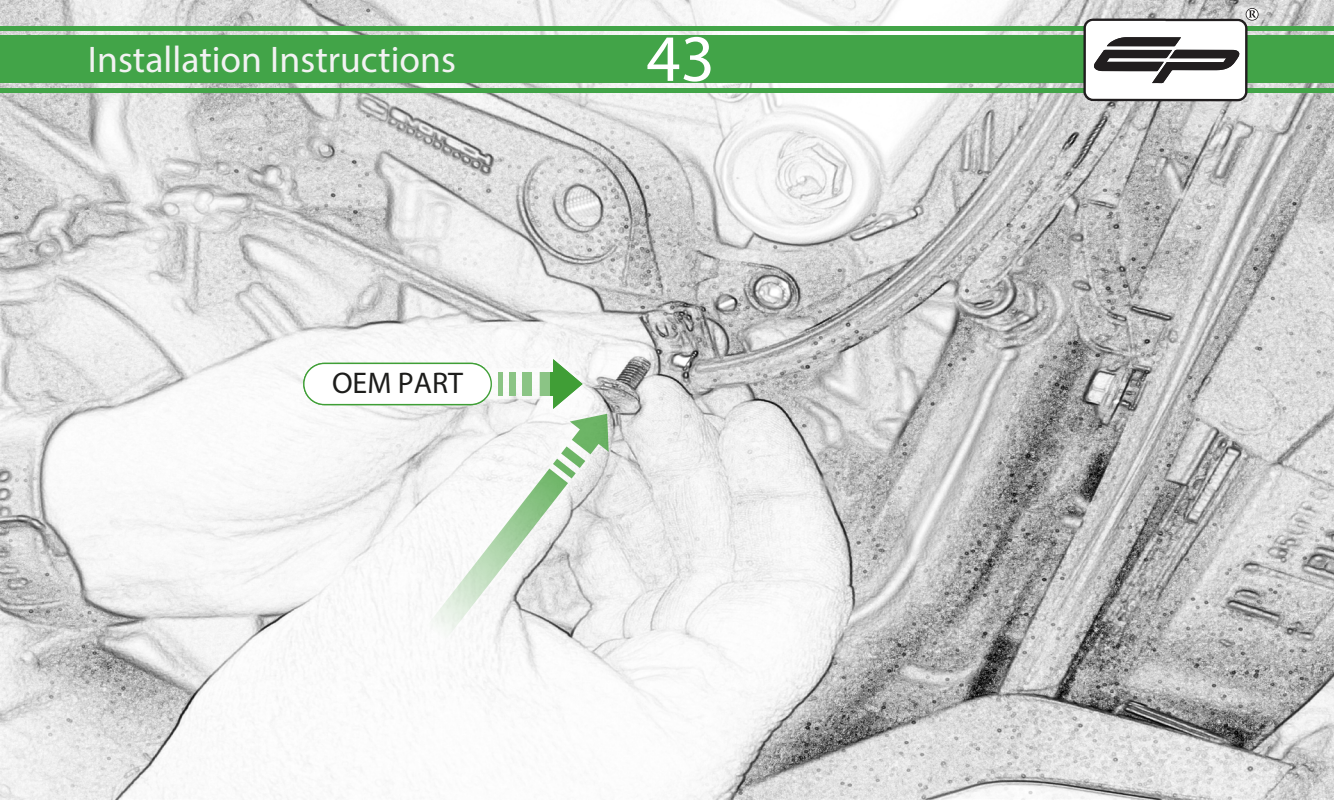
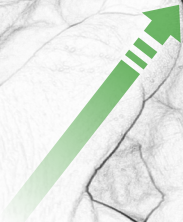

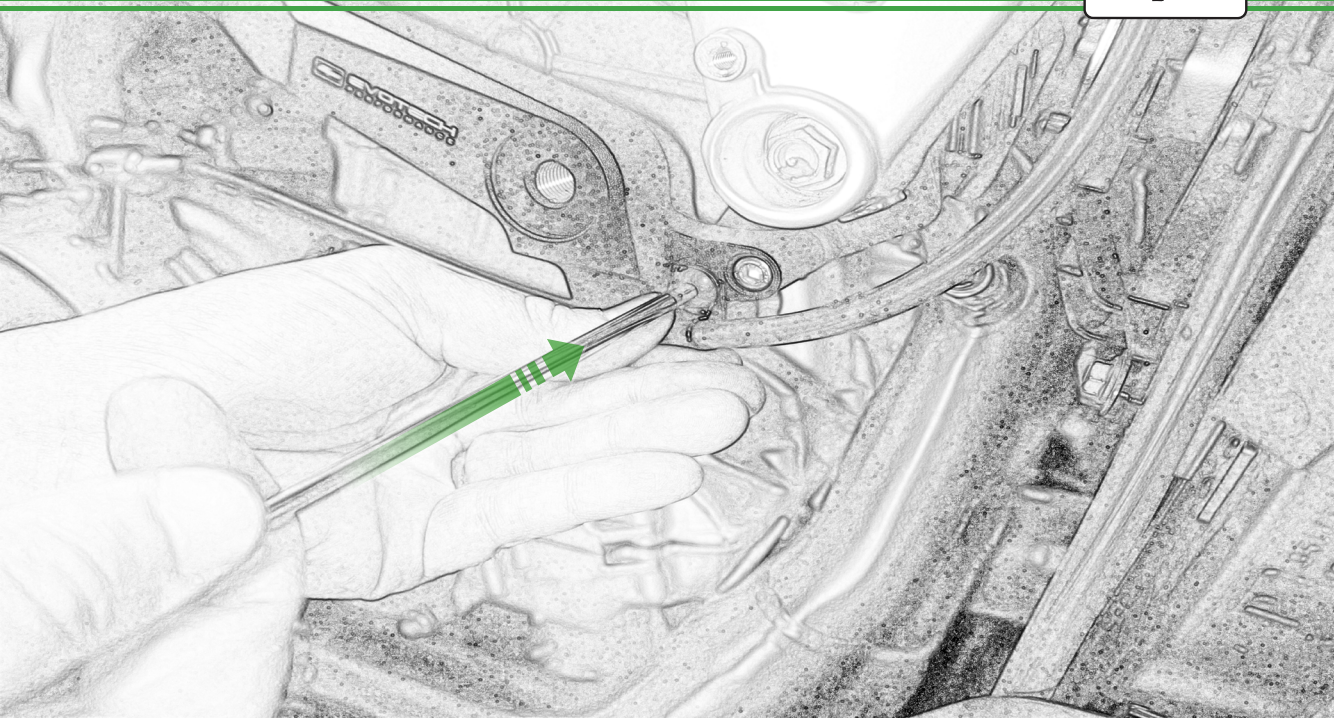

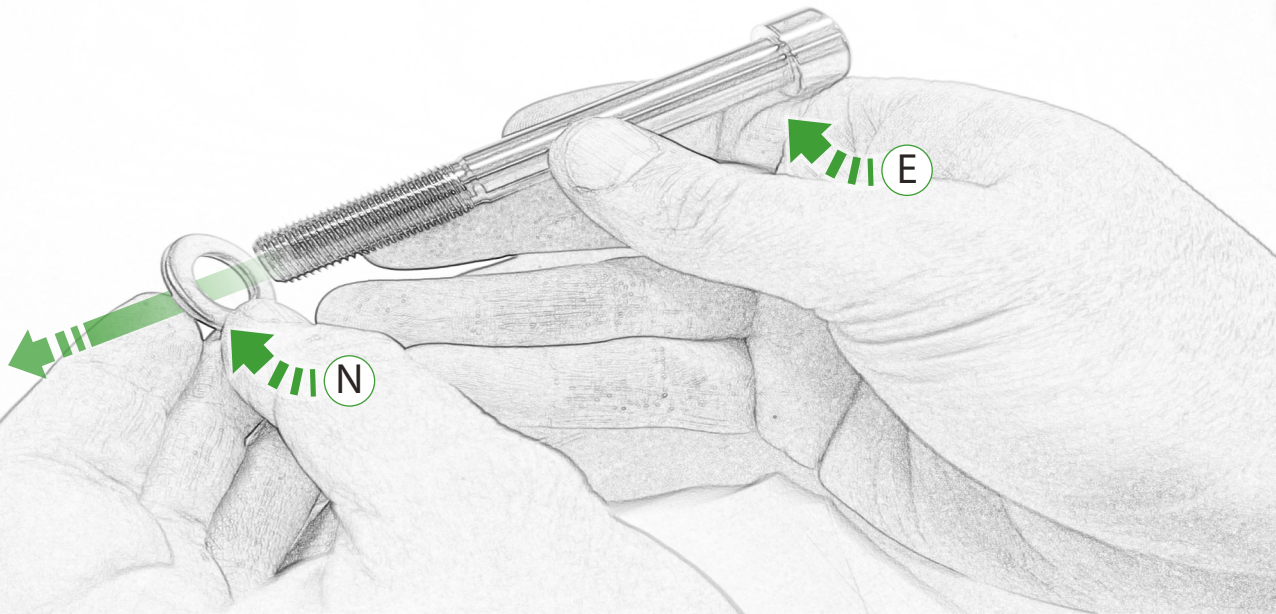

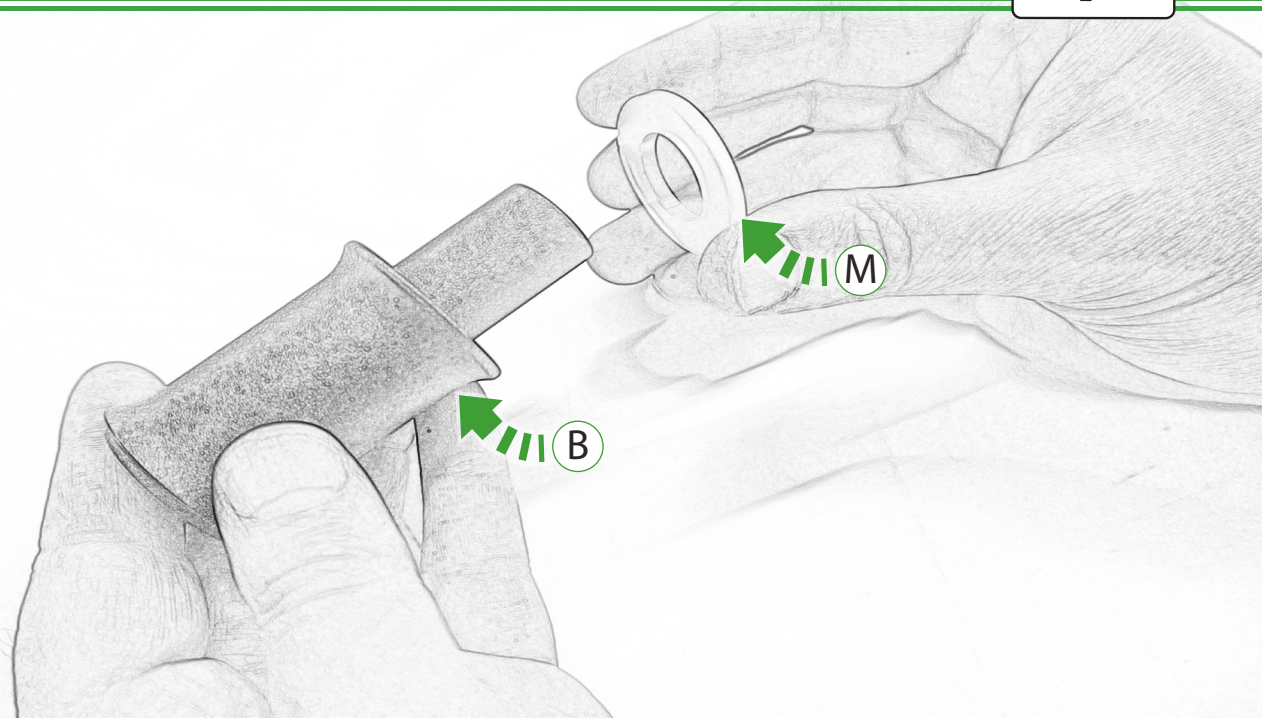

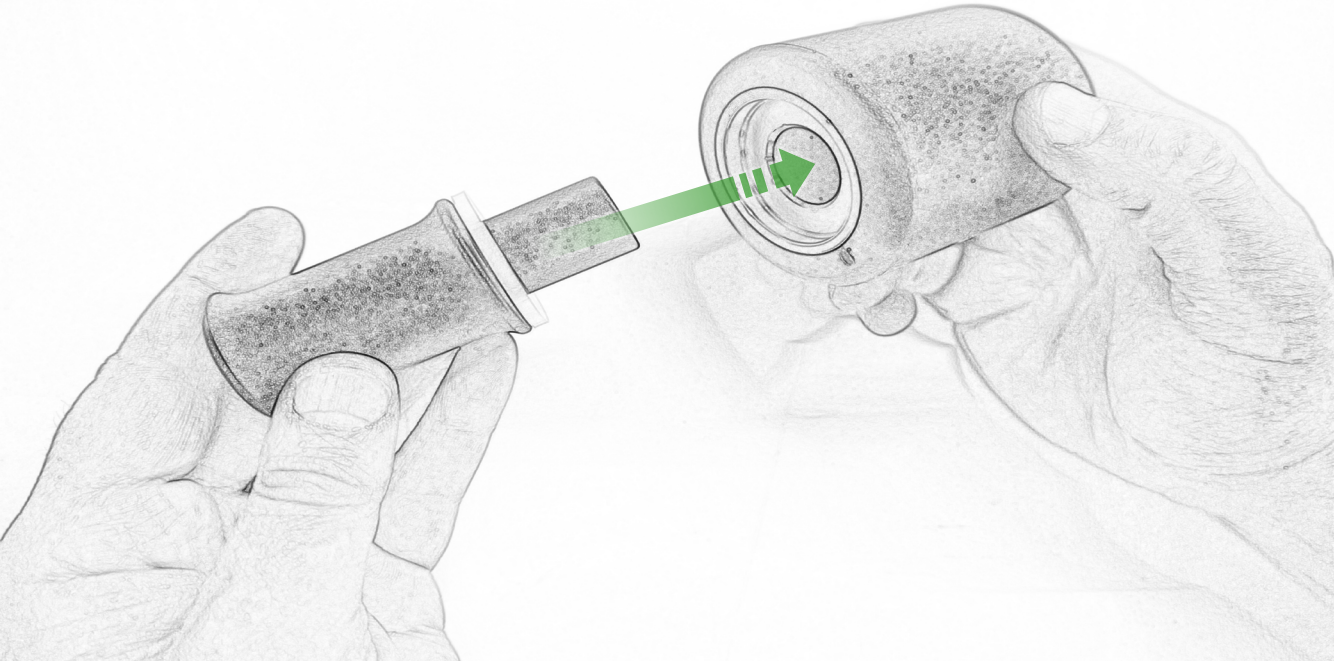

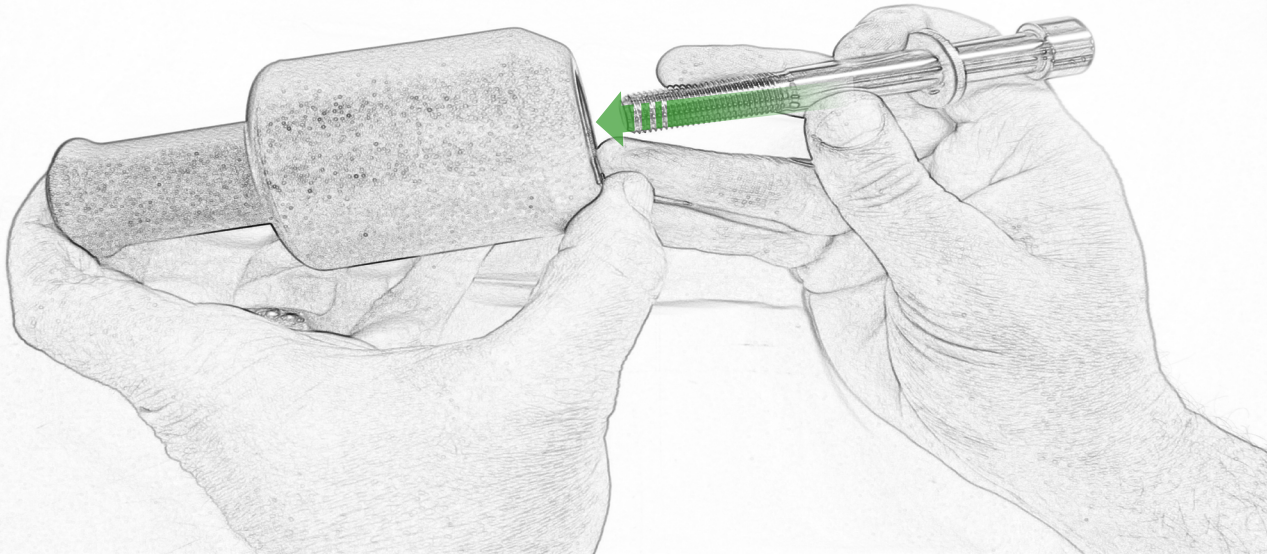

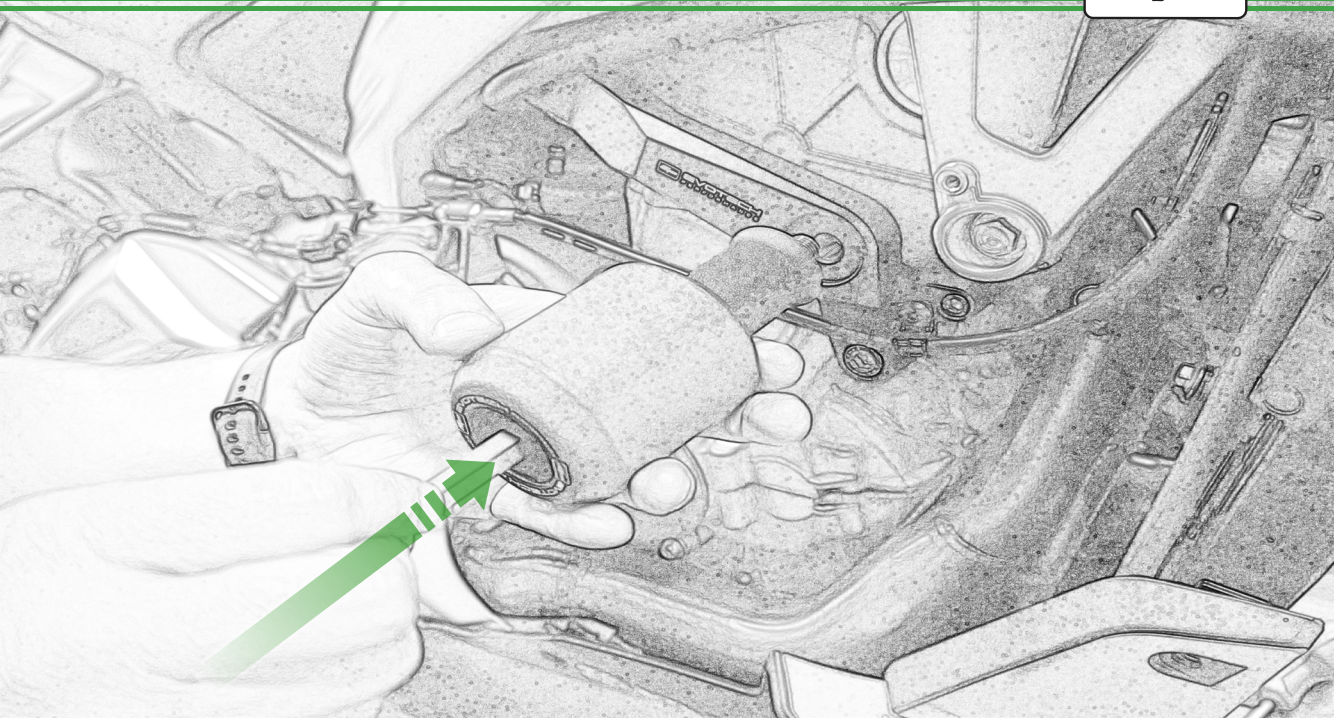



Caution

Fully
Tighten 40Nm

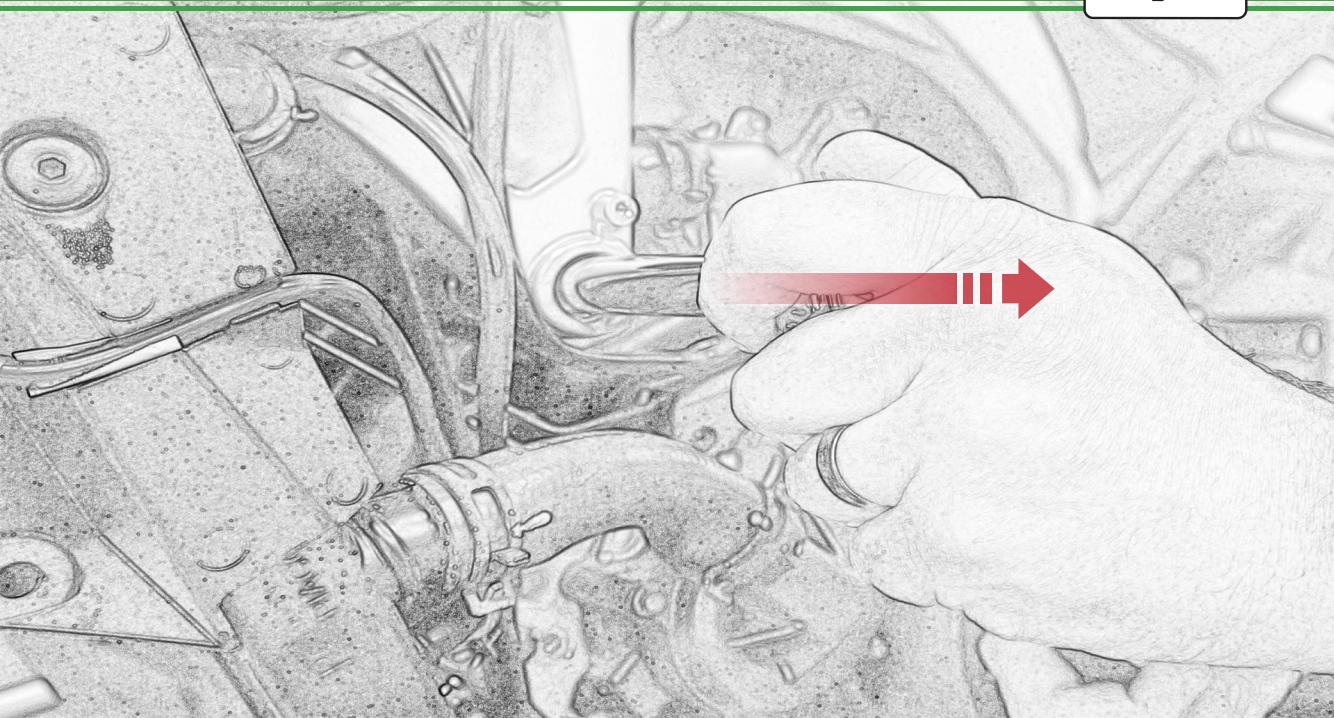



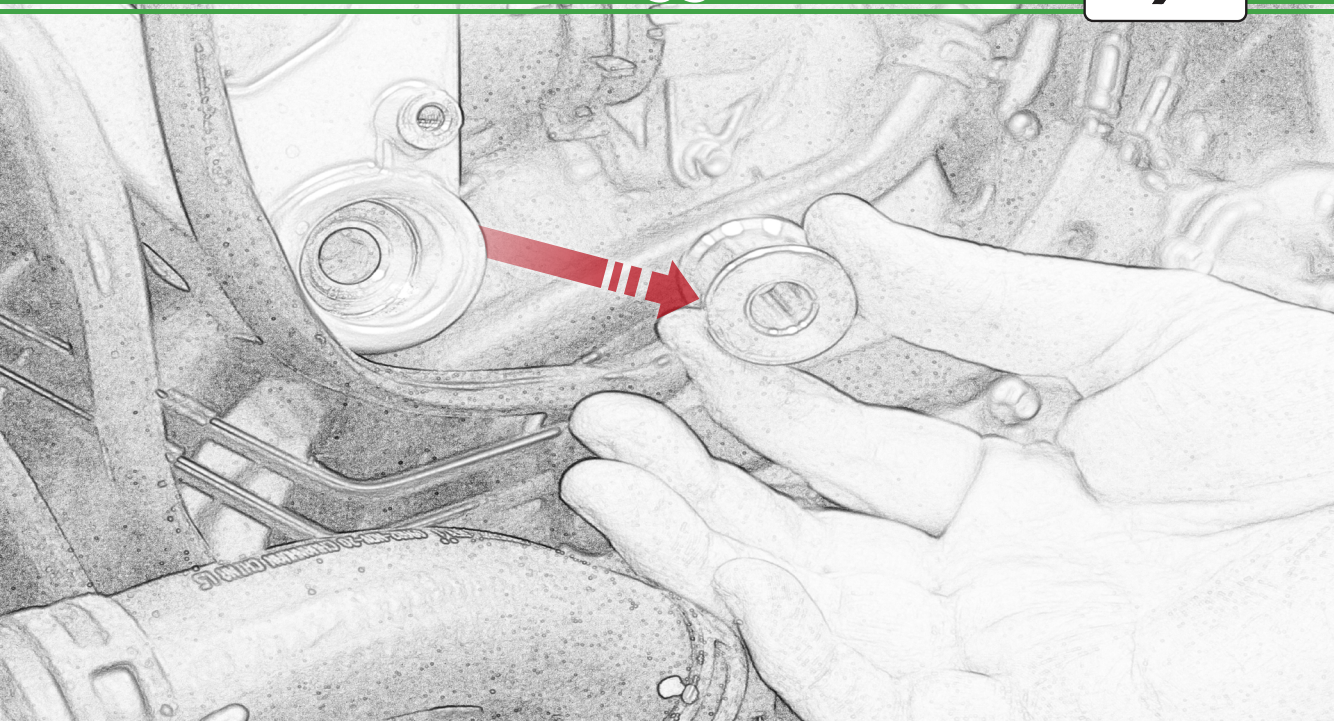

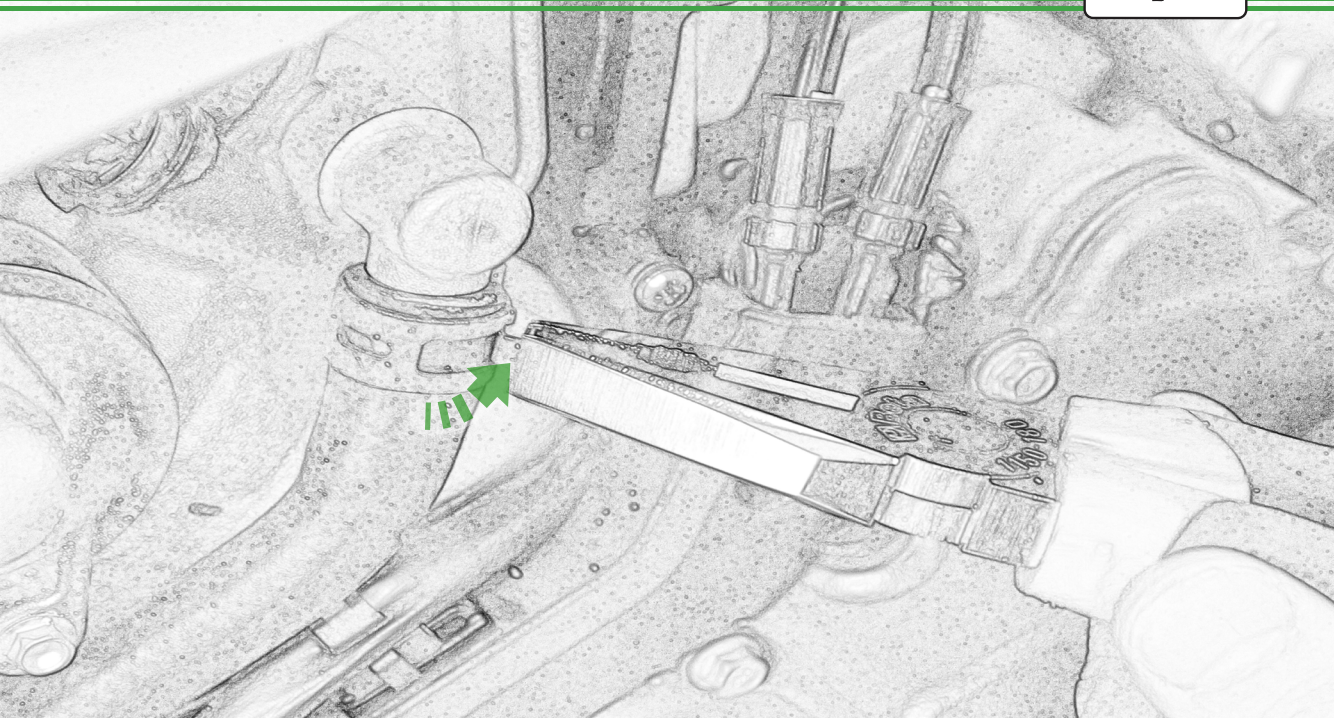

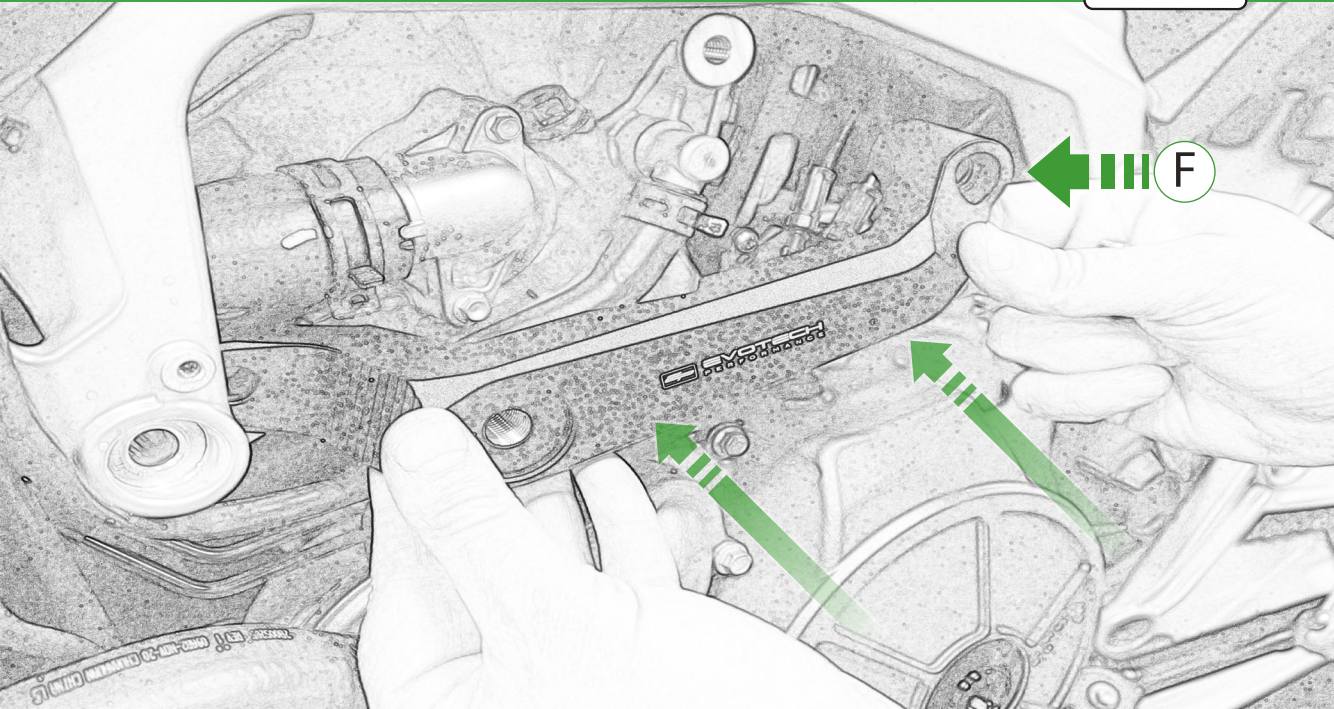

F

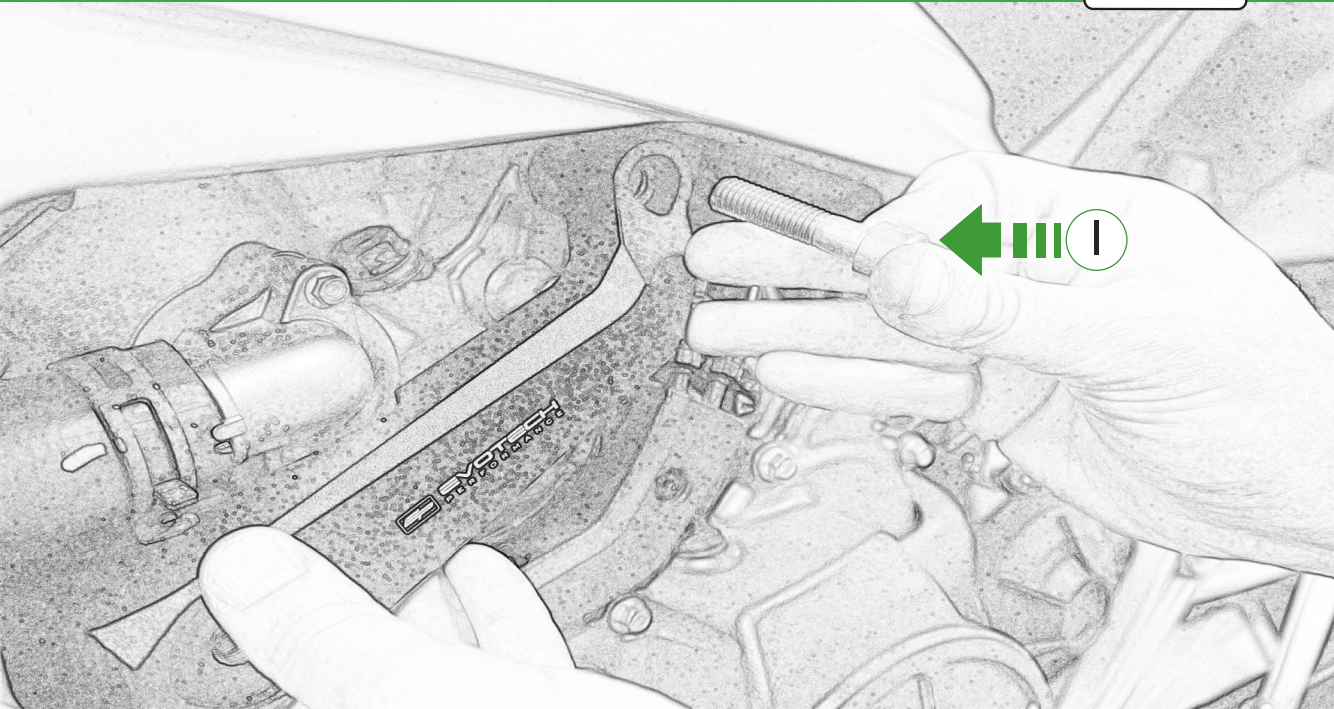

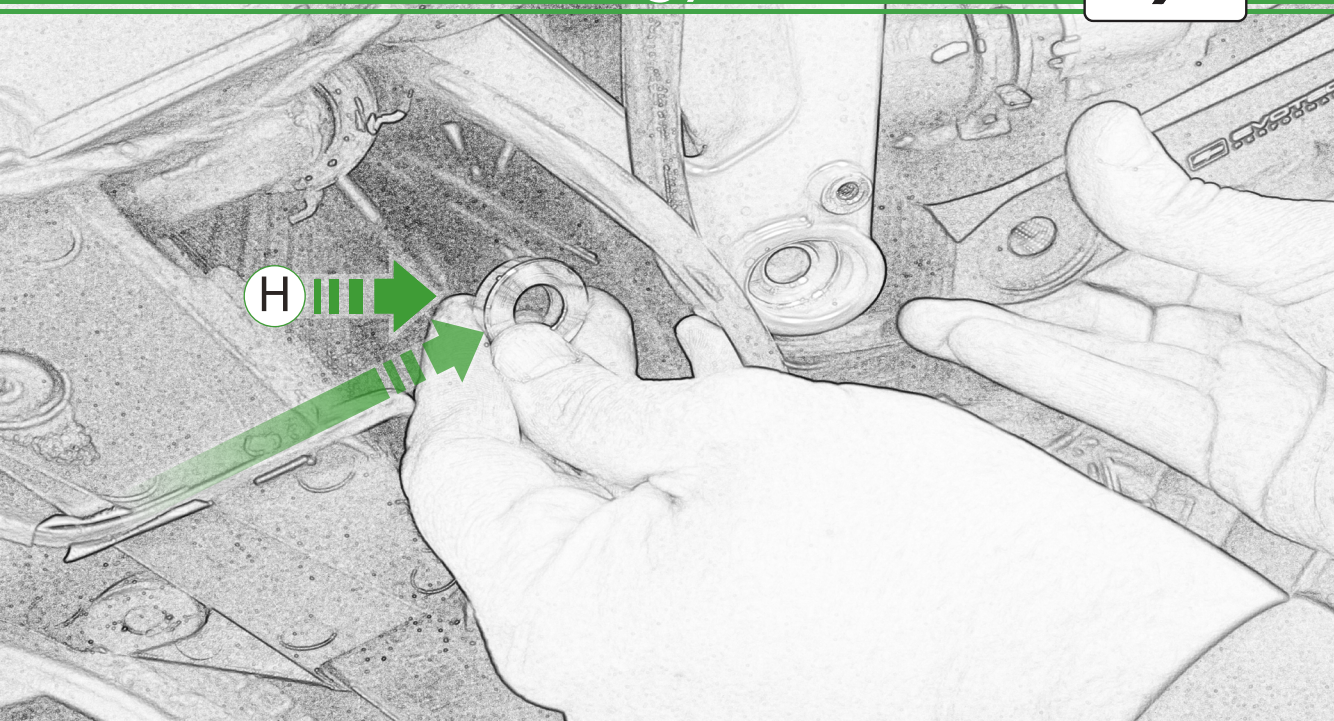

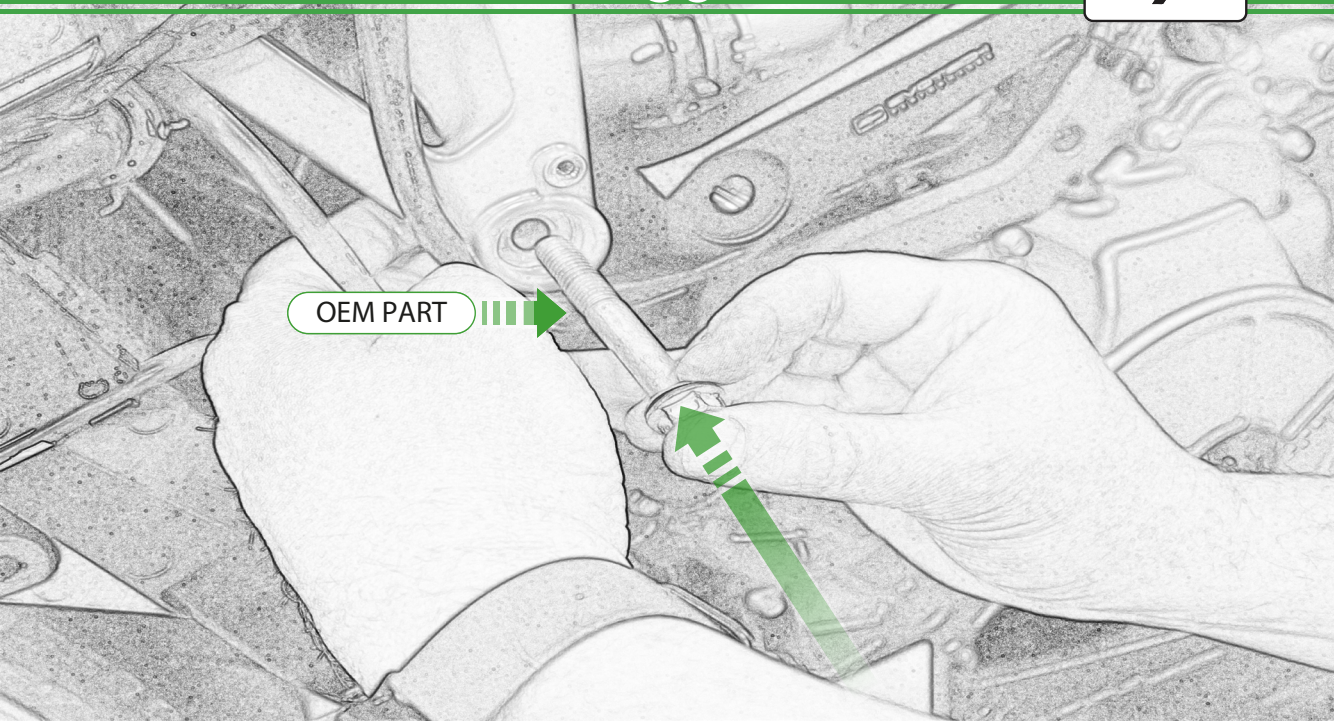

OEM PART





OEM PART

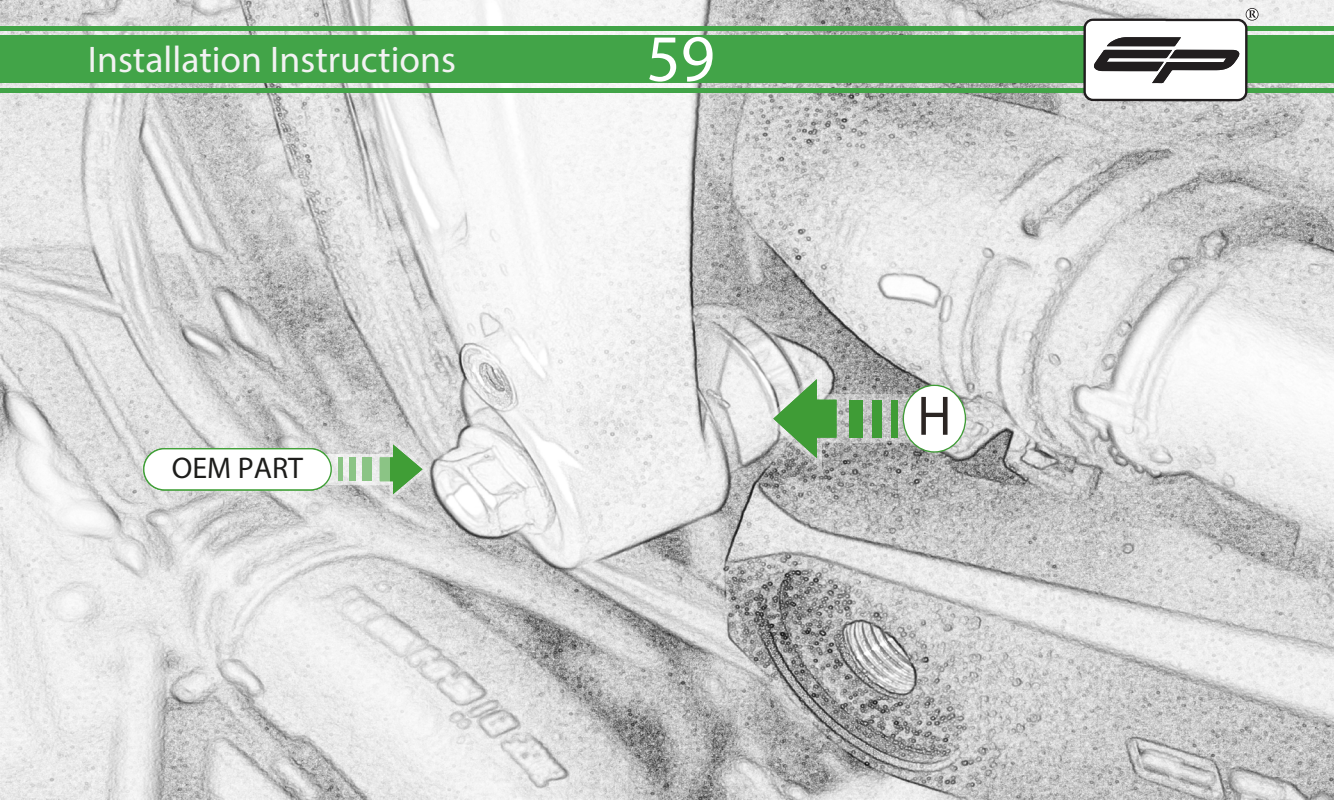

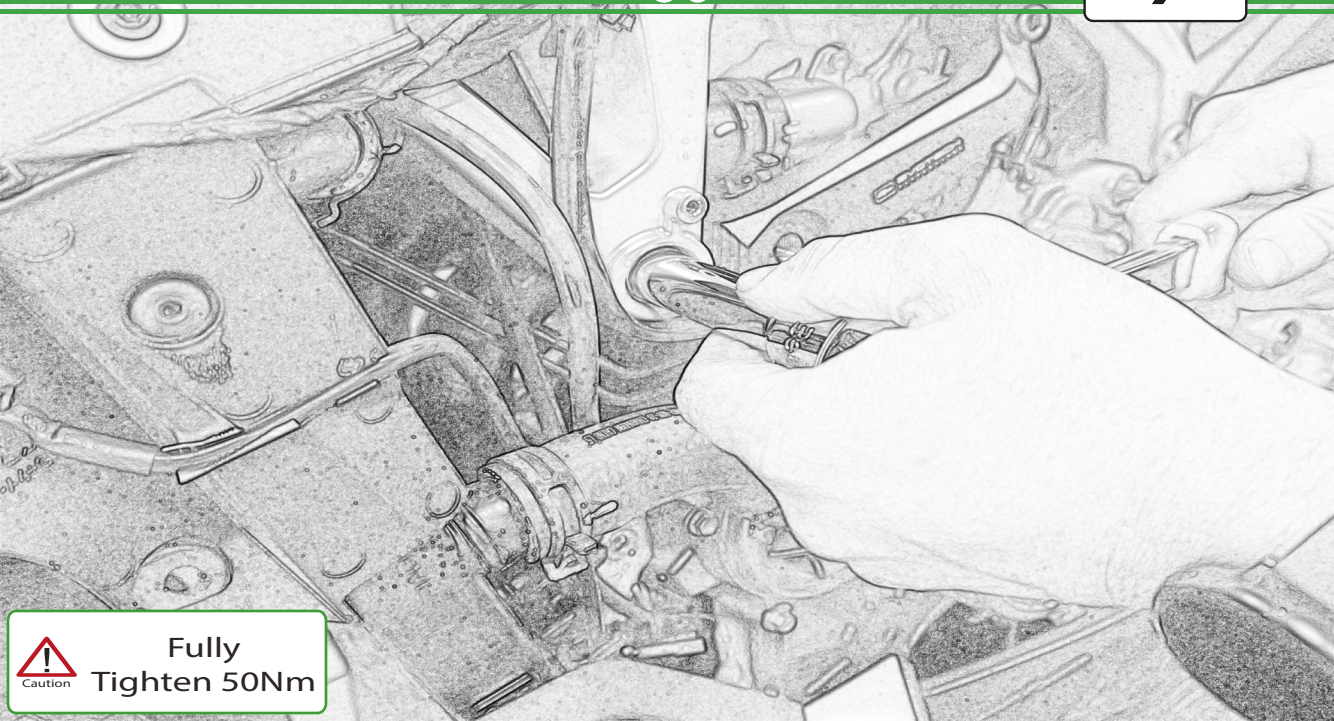

Fully
Tighten 50Nm

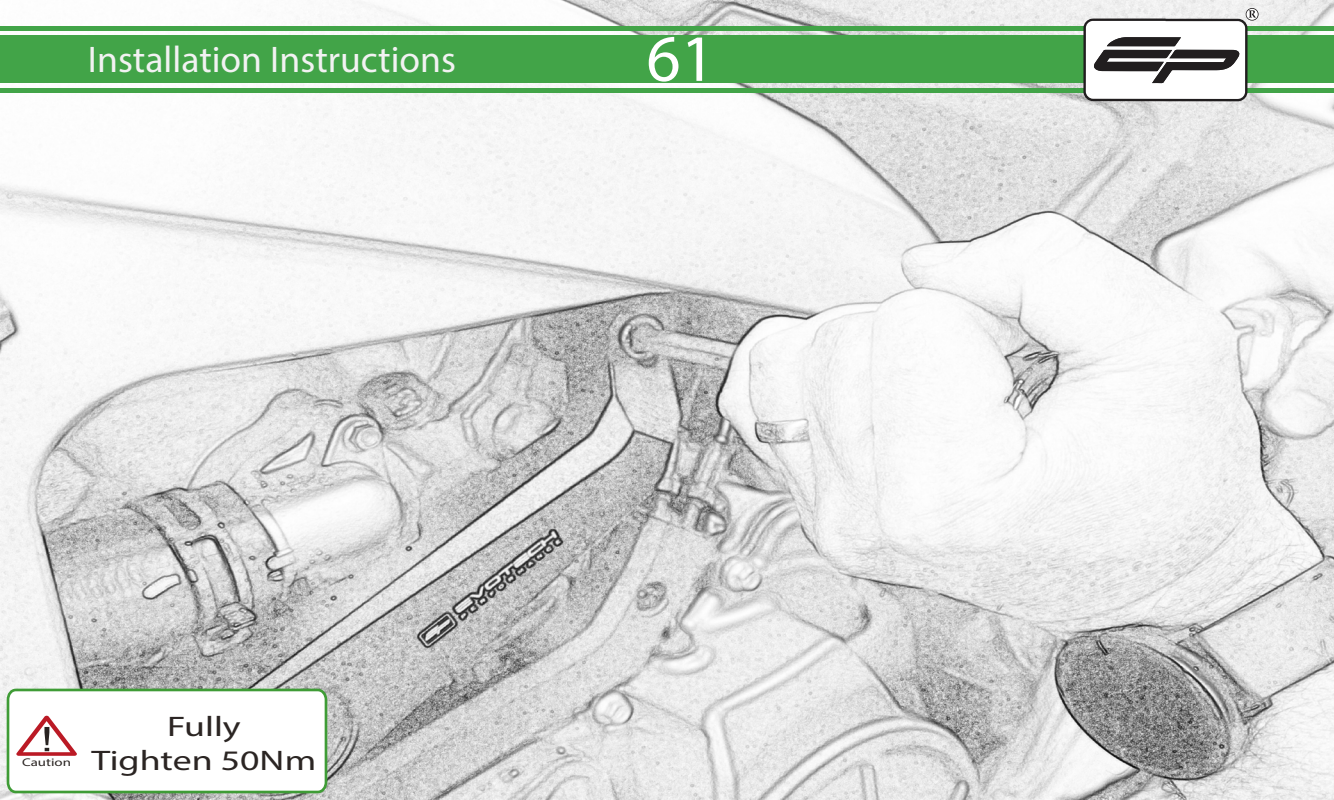

Caution

Fully
Tighten 50Nm

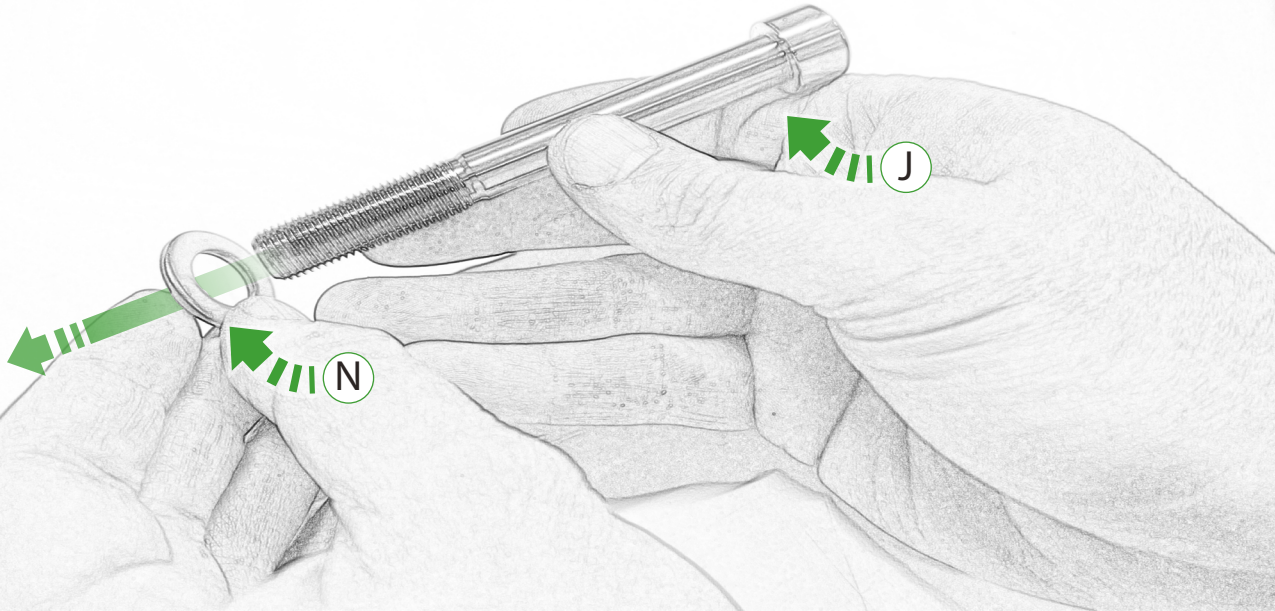

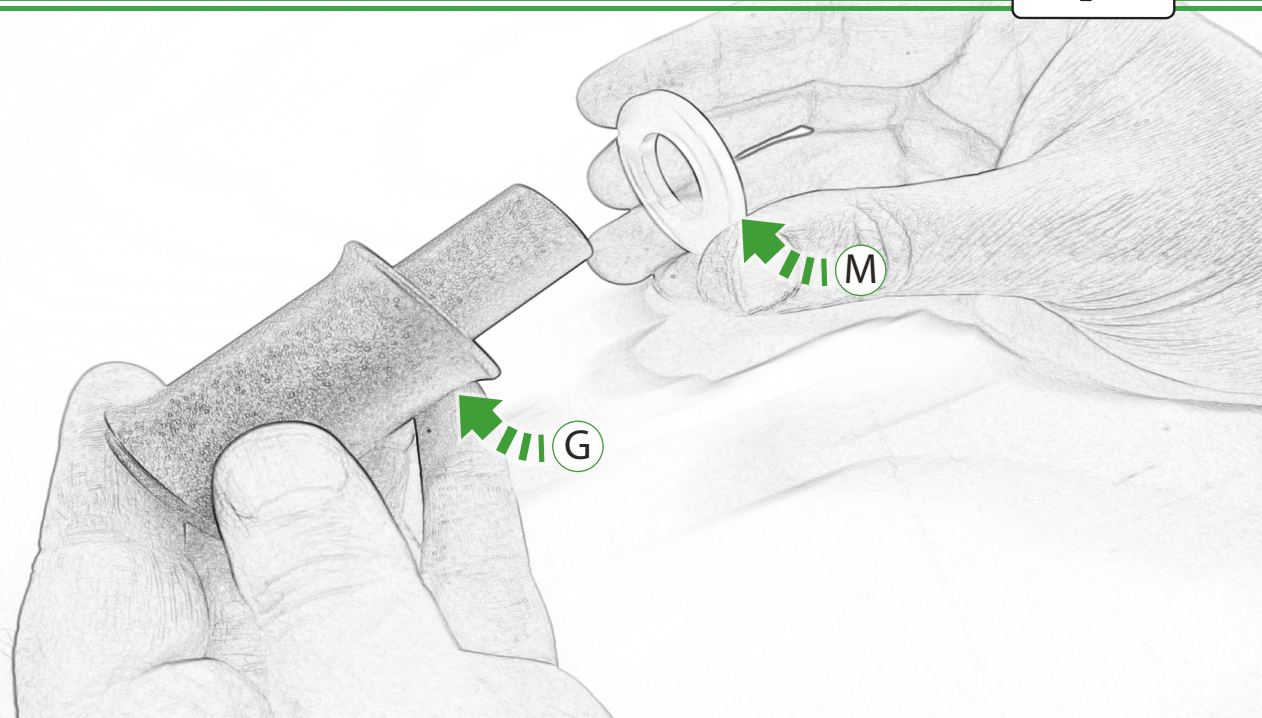

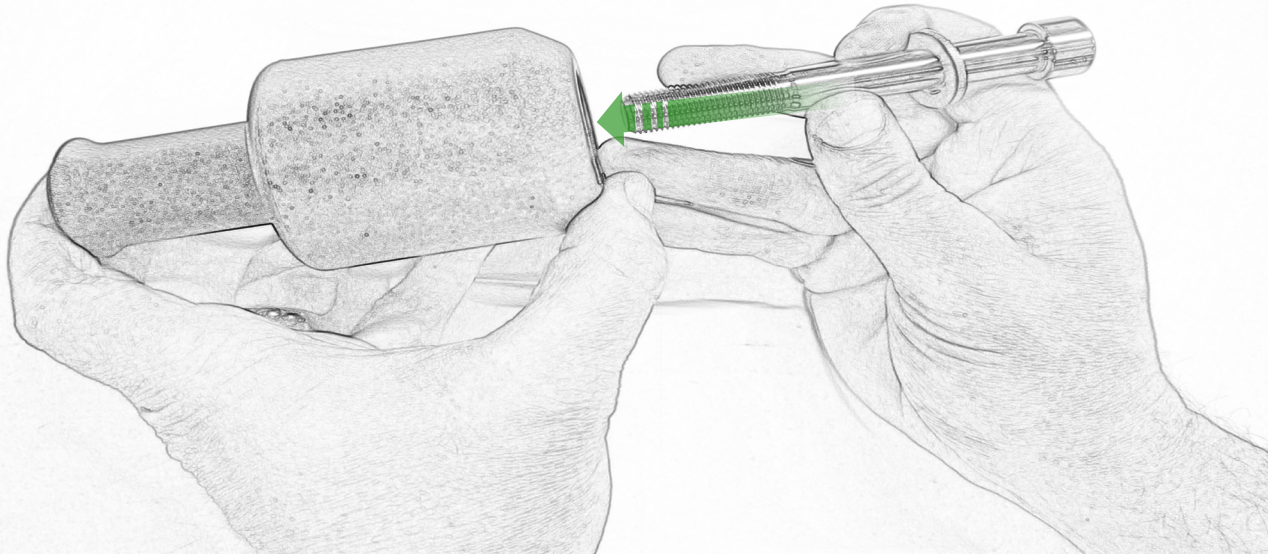

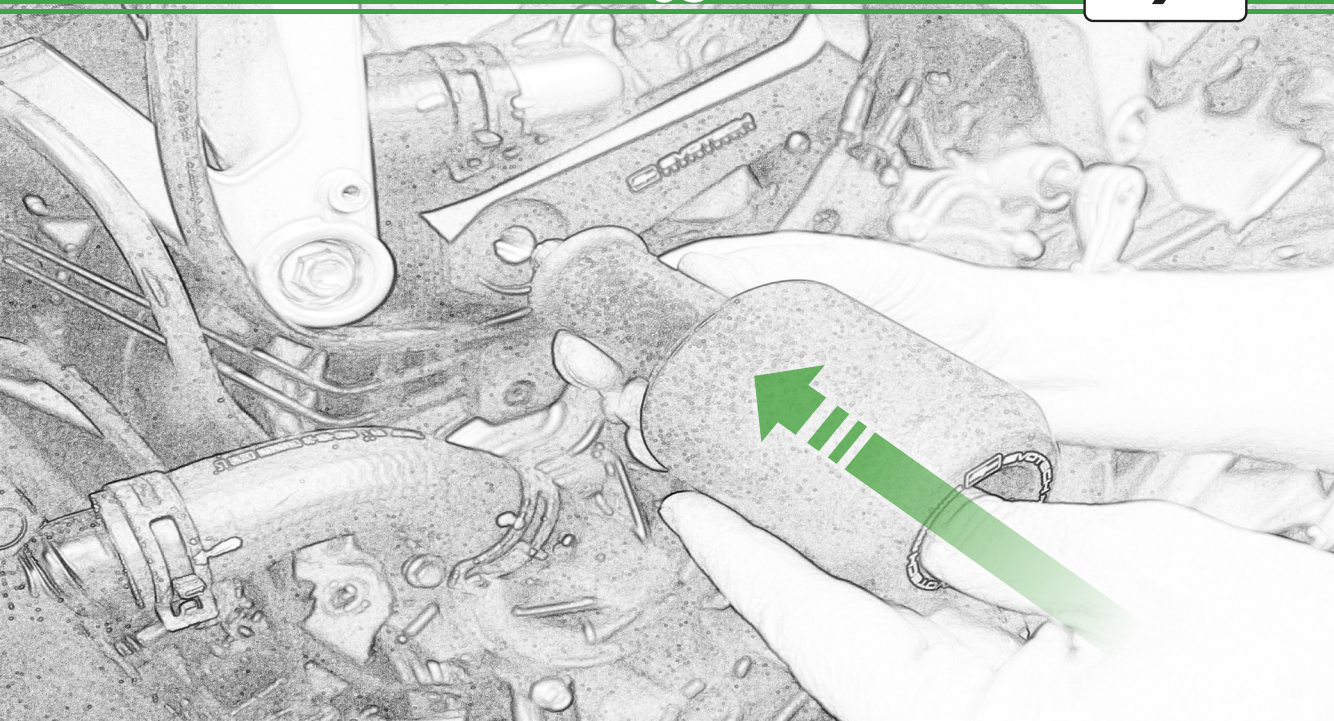

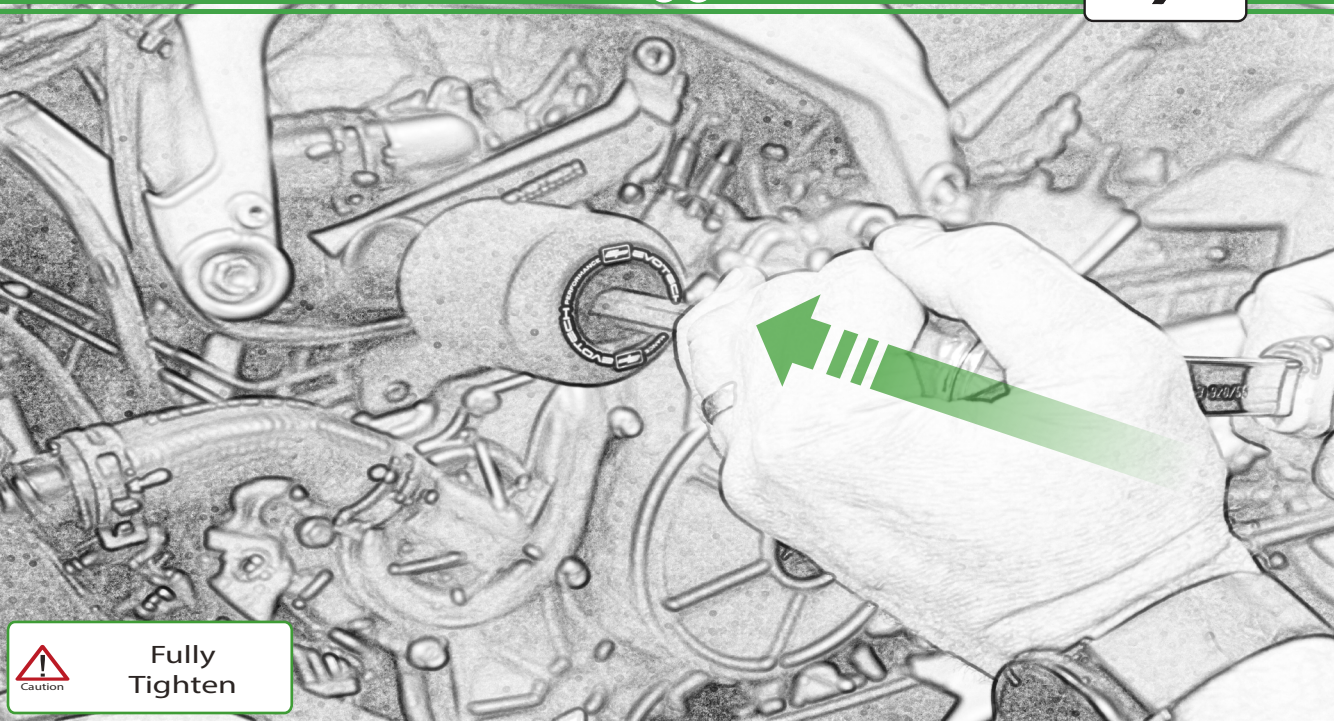

Fully
Tighten

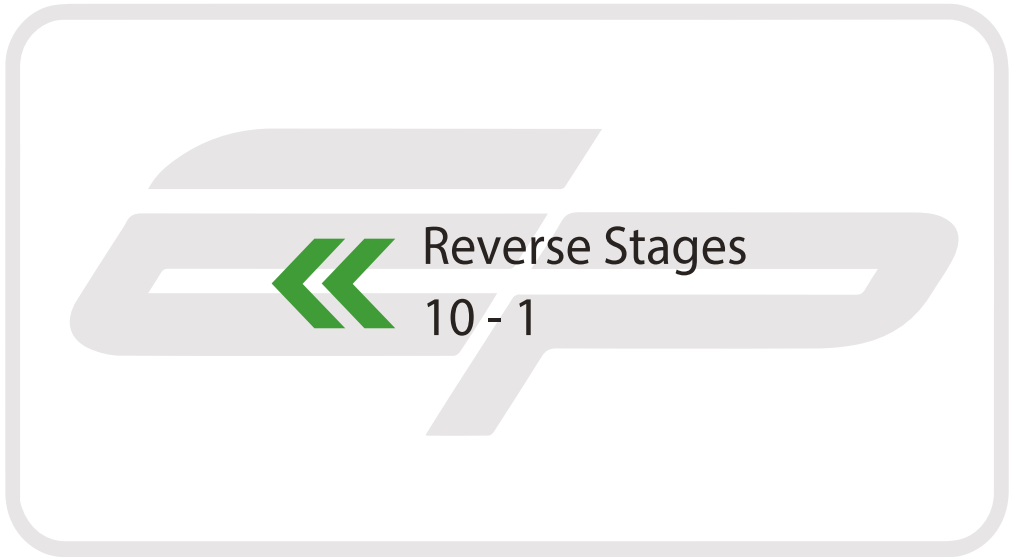



ESSENTIAL CHECKS

It is recommended that periodic inspections are made to ensure that all bolts are tightened to the specified torque settings.

Should the bike be involved in an accident a thorough inspection should be made and any components that have taken an impact, no matter how small, be replaced



EVOTECH[®]
P E R F O R M A N C E

www.evotech-performance.com