



EVOTECH®
P E R F O R M A N C E

Suzuki GSXR1000

Crash protection

Installation Instructions



Product No: PRN013581

Kit Contents

- | | |
|---|---|
| A 1 x L/H Bracket | I 1 x M10 x 55 x 1.25 Caphead Bolt |
| B 1 x R/H Bracket | J 2 x M6 x 45 Caphead Bolts |
| C 1 x Bobbin Spacer (Shortest) | K 2 x M12 x 75 x 1.25 Caphead Bolt |
| D 1 x Bobbin Spacer (Longest) | L 2 x M10 Washers |
| E 1 x Neoprene (Large) | M 2 x M12 Washers |
| F 1 x Neoprene (Medium) | N 2 x Polyurathane Washers |
| G 1 x Neoprene (Small) | O 2 x Bobbin Heads |
| H 1 x M10 x 60 x 1.25 Caphead Bolt | |

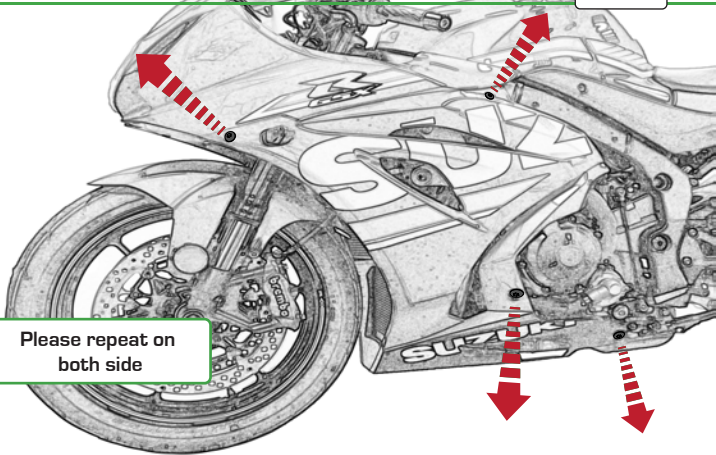

Please repeat on both side

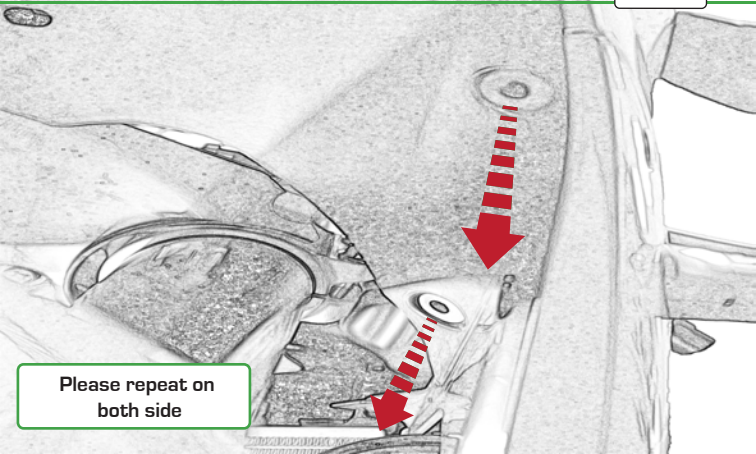

Please repeat on
both side

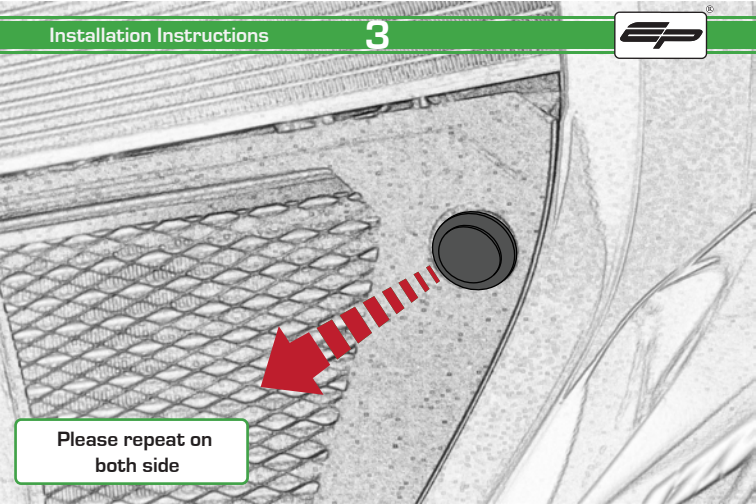

Please repeat on
both side

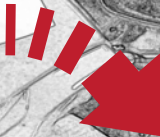
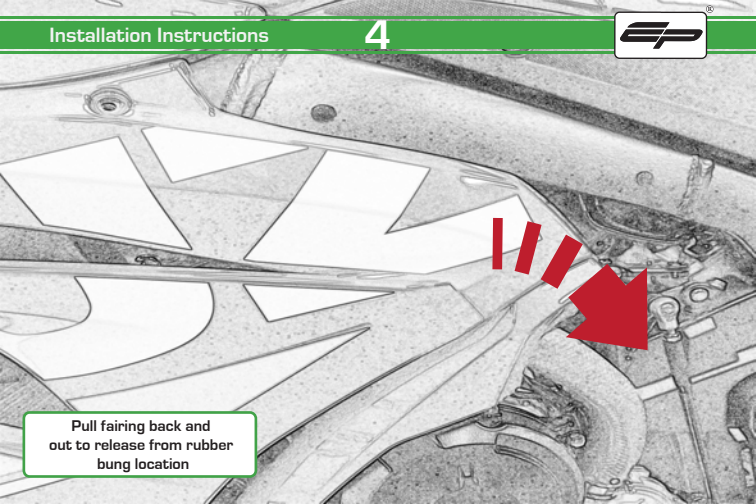

Pull fairing back and out to release from rubber bung location

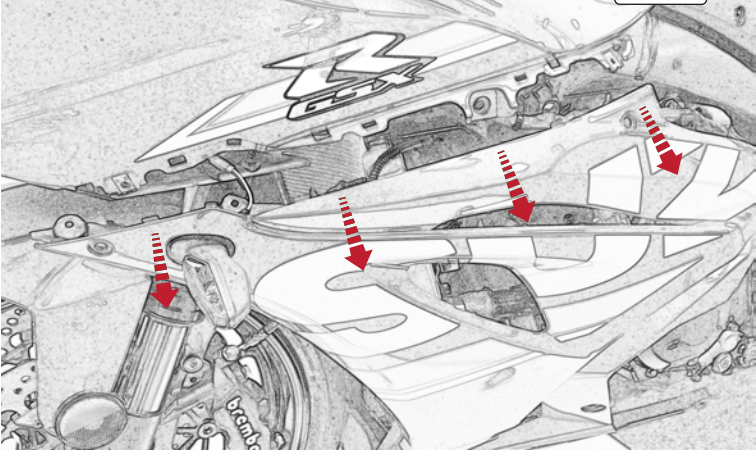

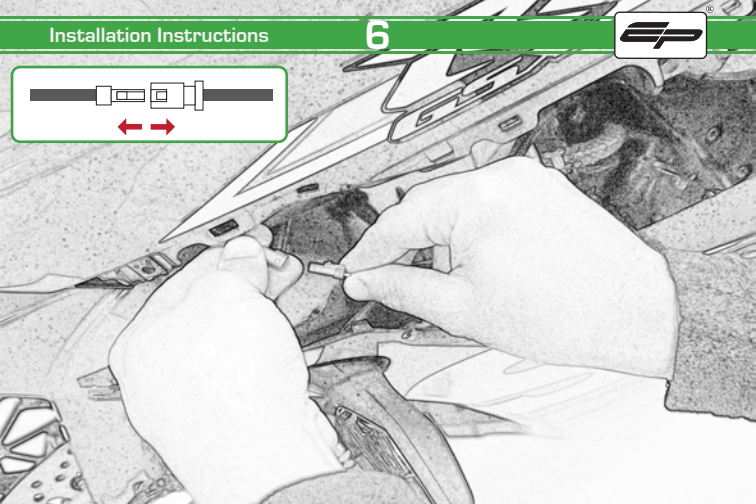
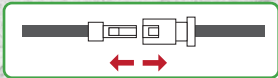

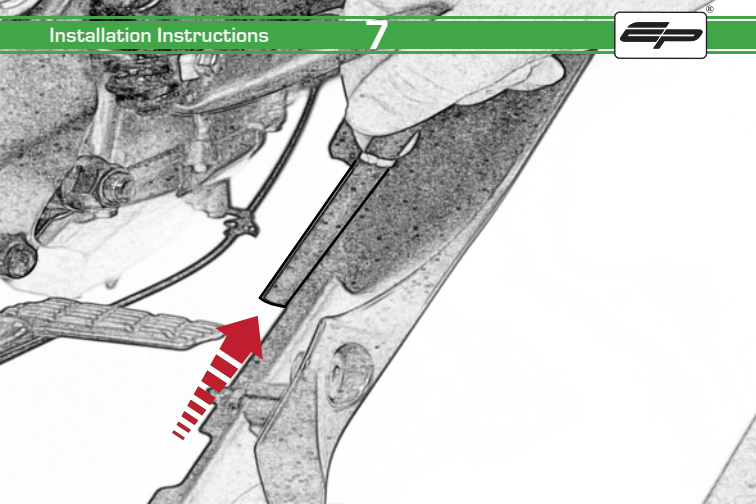

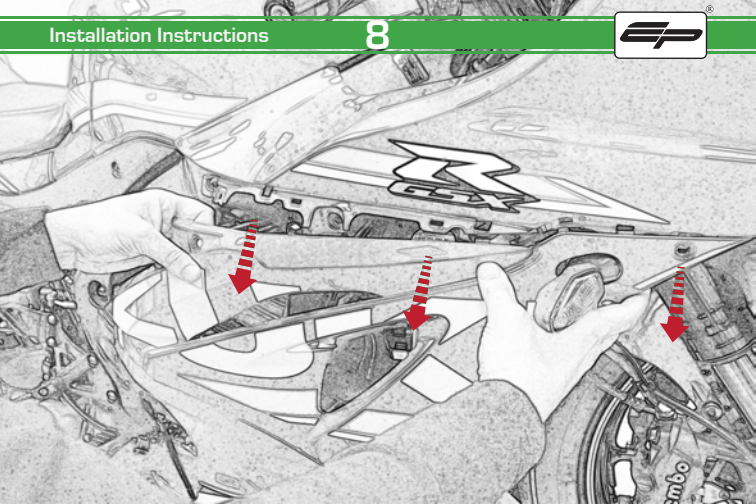

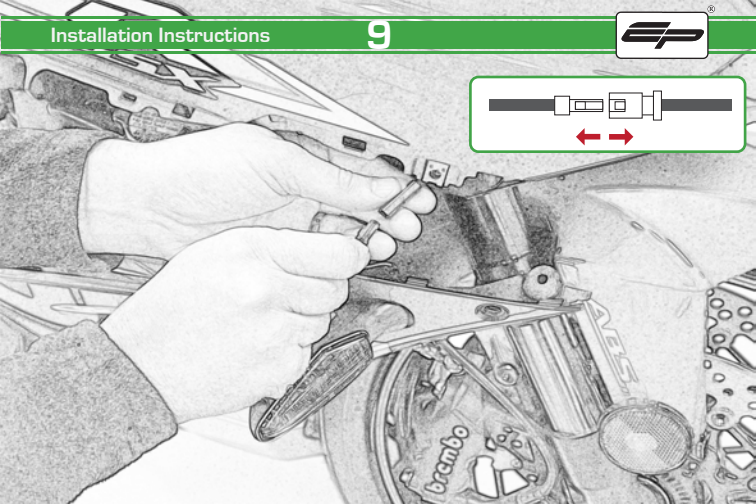
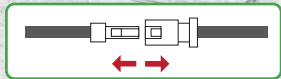



Caution

Lay a towel or cloth on the ground to stop any damage to the fairing

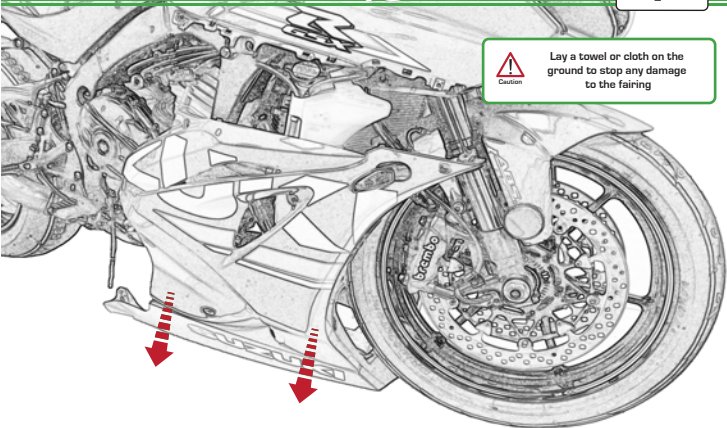



Caution

Remove fairing by rotating
the complete panel underneath
the bike

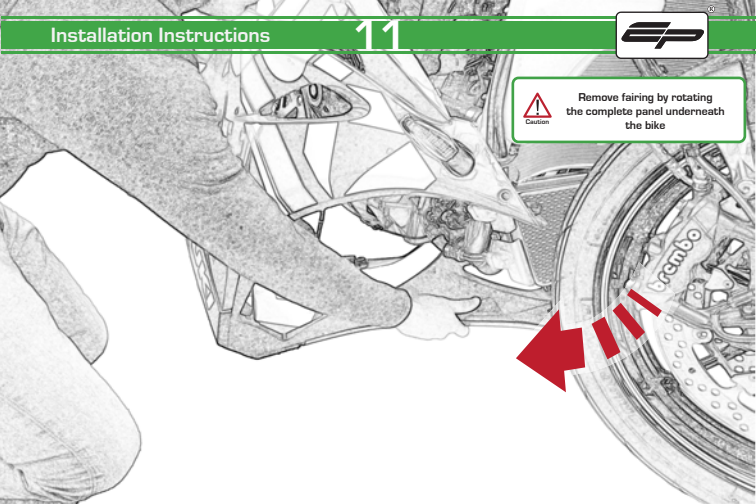

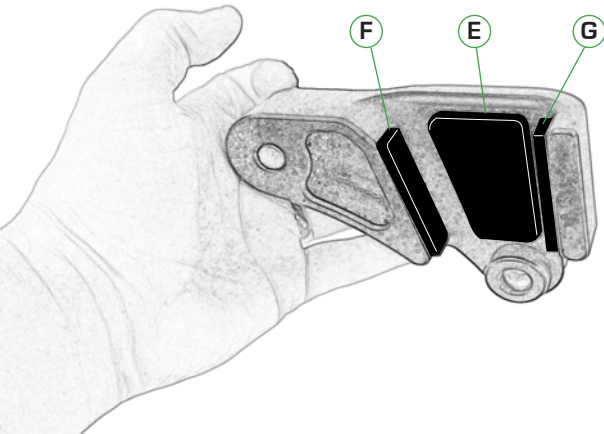

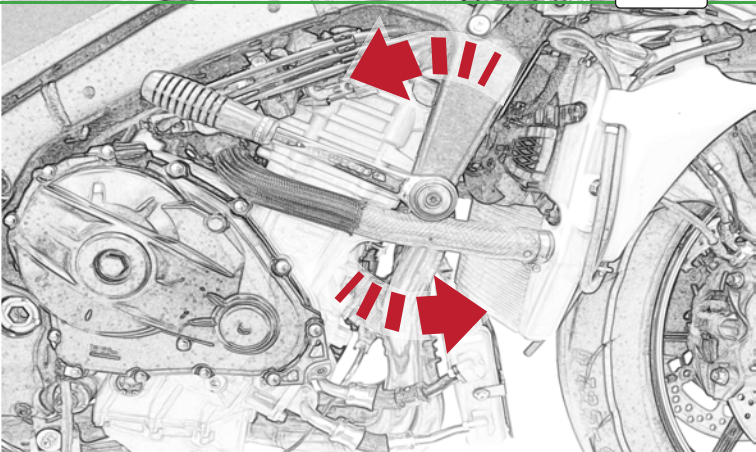

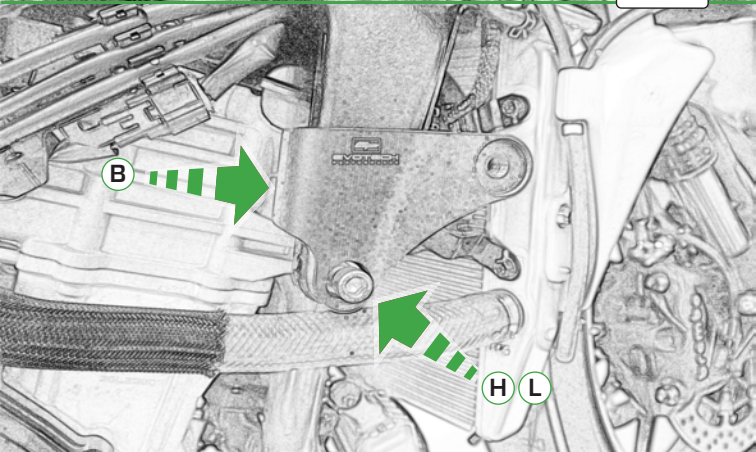

B

H

L

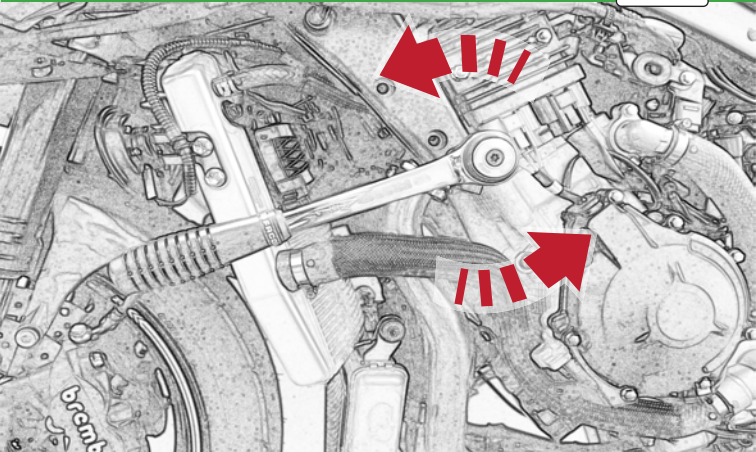

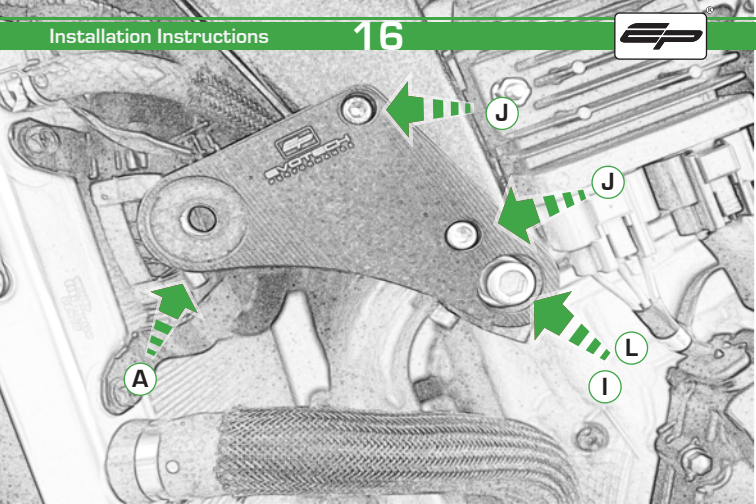



Install fairing by rotating
the complete panel underneath
the bike

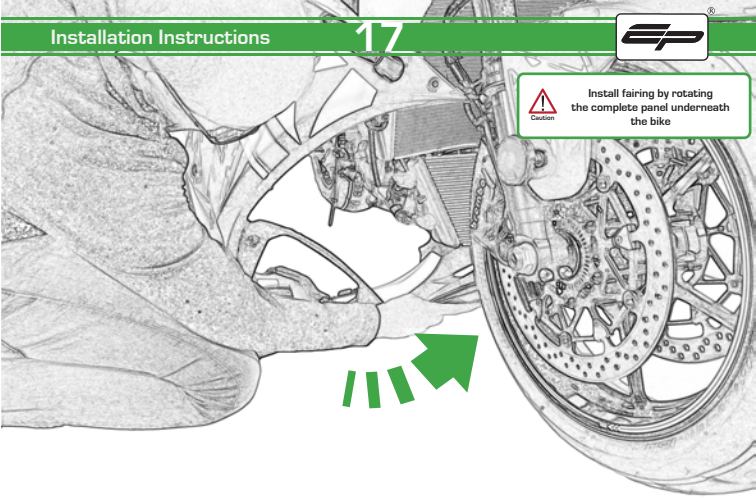

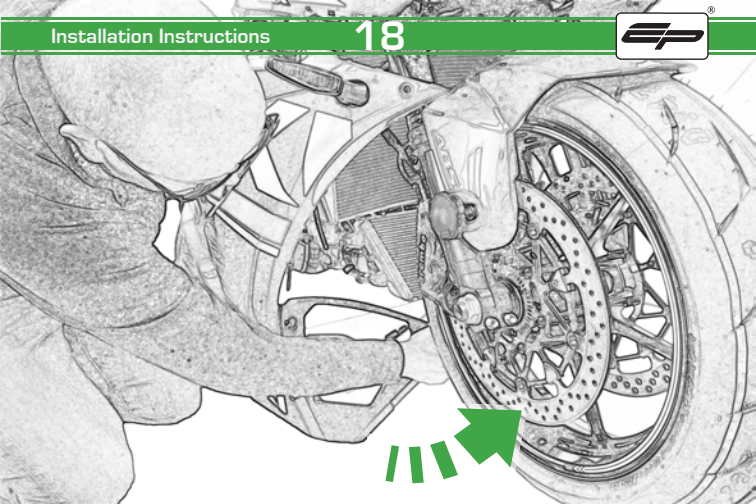



Reverse Stages

9 - 1

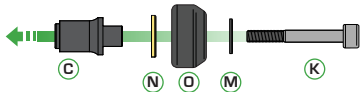
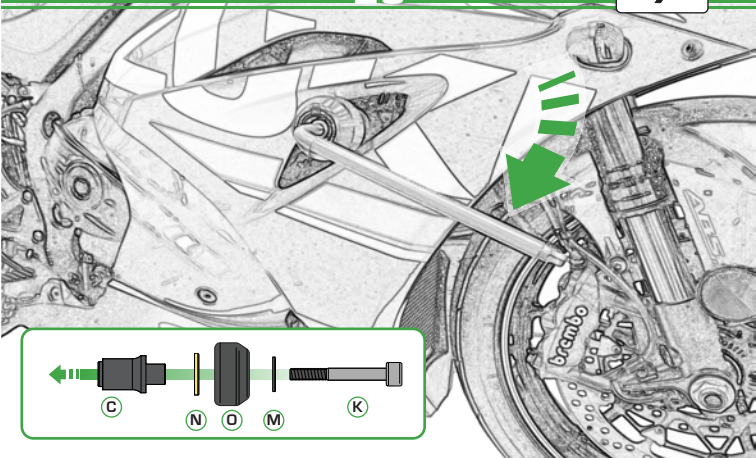

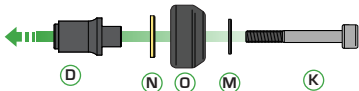
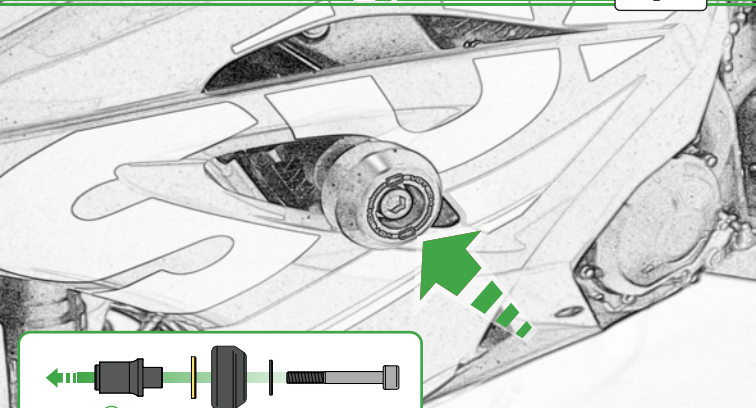



ESSENTIAL CHECKS



It is recommended that periodic inspections are made to ensure that all bolts are tightened to the specified torque settings.

Should the bike be involved in an accident a thorough inspection should be made and any components that have taken an impact, no matter how small, be replaced