



EVOTECH®
P E R F O R M A N C E

Installation Instructions

**KTM RC 125, 200, 390 2014
TOE GUARD**

Product Reference - 12140

Kit Contents

- A** 1 x Toe Guard
- B** 1 x Mounting Bracket
- C** 1 x Rear Bracket
- D** 1 x Neoprene Pad
- E** 1 x M10 - 25 x 1.25 Pro Bolt
- F** 2 x M6 x 12 Black Button Head Screw

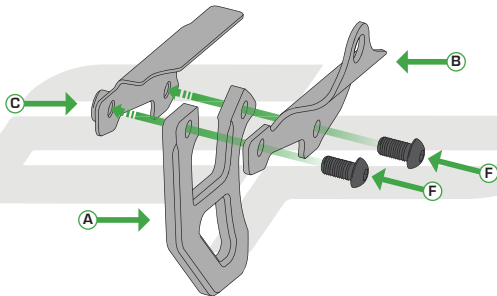

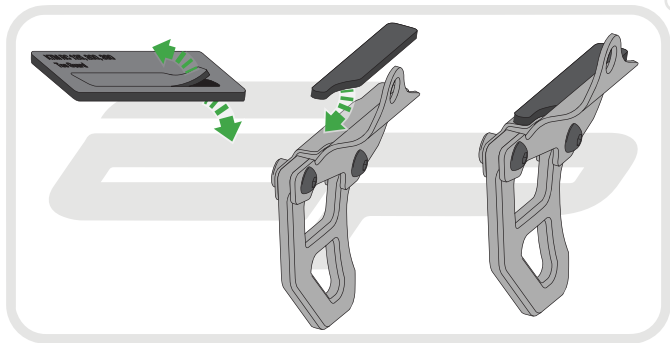



Caution

Ensure Toe Guard is
firmly located underneath
the swingarm

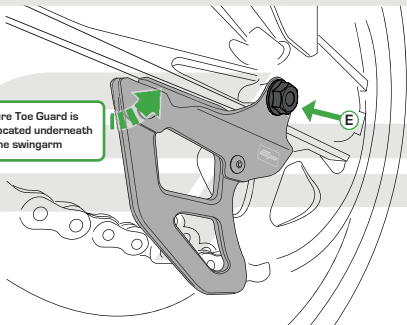

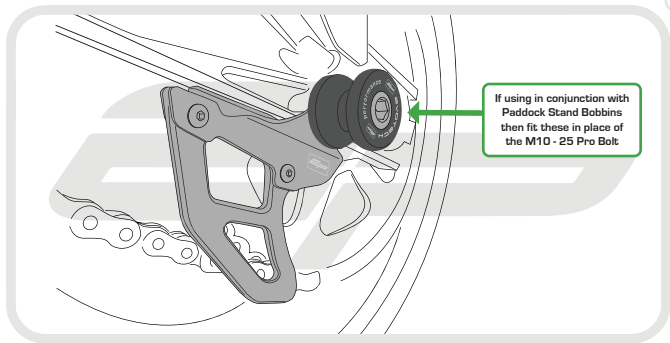

If using in conjunction with Paddock Stand Bobbins then fit these in place of the M10 - 25 Pro Bolt



EVOTECH®
P E R F O R M A N C E

www.evotech-performance.com