

EVOTECH®
P E R F O R M A N C E

www.evotech-performance.com

Suzuki V-Strom 1050

SP Connect Sat Nav Mount Instruction



For SP Connect mirco stem mount alu Part number #53122
follow instructions 1 - 16

For SP Connect anti vibration module Part number #53135
follow instructions 17 - 31



Kit Contents PRN014677-015140

- (A) 1 x Upper Mounting Body
- (B) 1 x Lower Mounting Body
- (C) 1 x Mounting Plate
- (D) 1 x SP Connect Mounting Plate
- (E) 1 x M5 Nyloc Nut
- (F) 2 x M4 x 30mm Caphead Bolts
- (G) 2 x O-ring
- (H) 2 x Spacer
- (I) 2 x M5 x 10mm Caphead Bolts



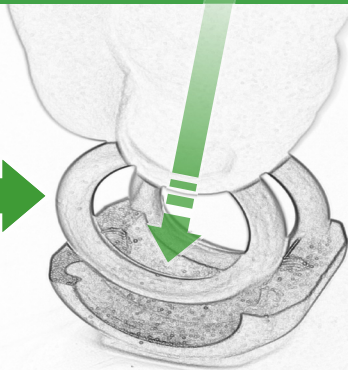

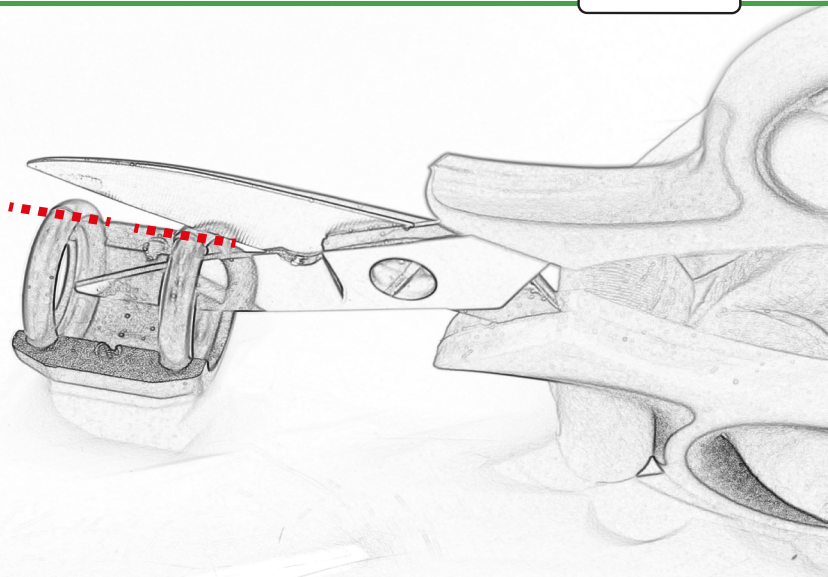

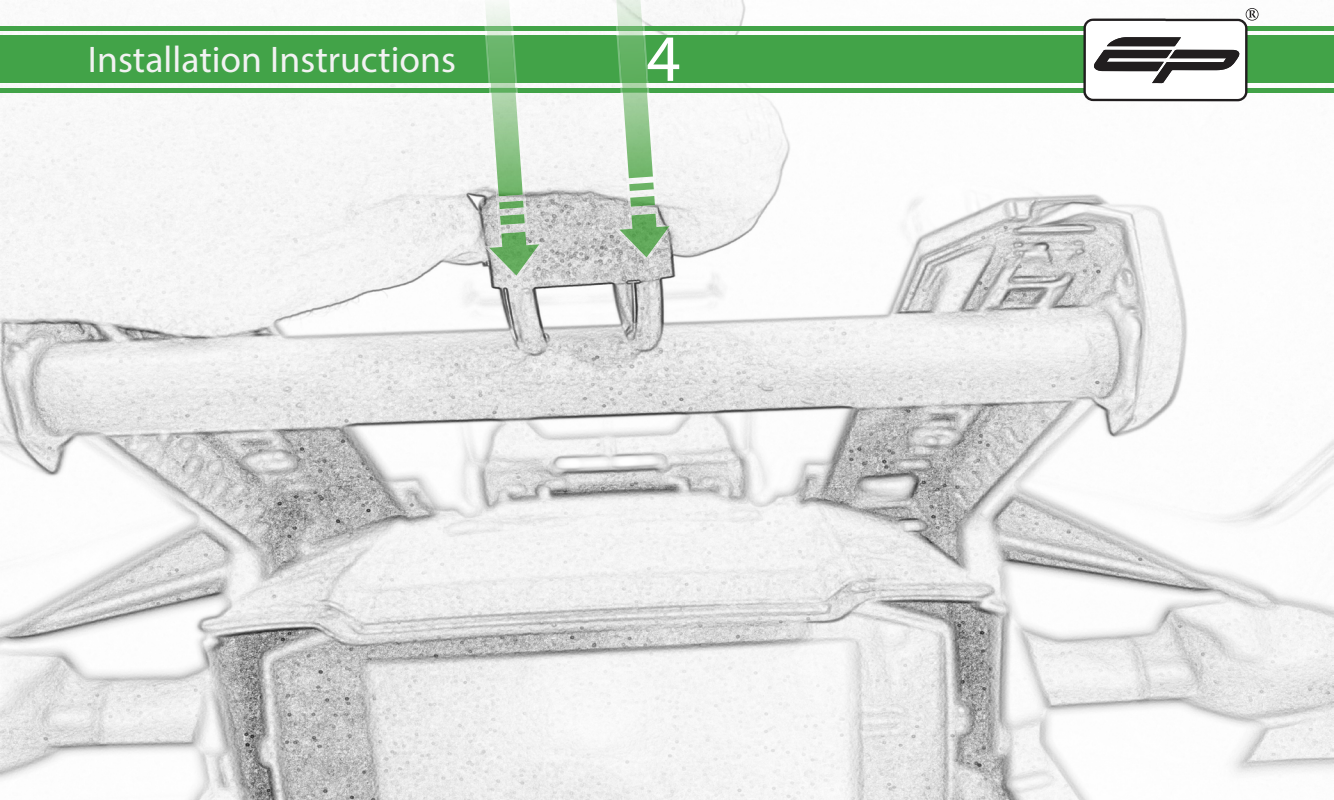

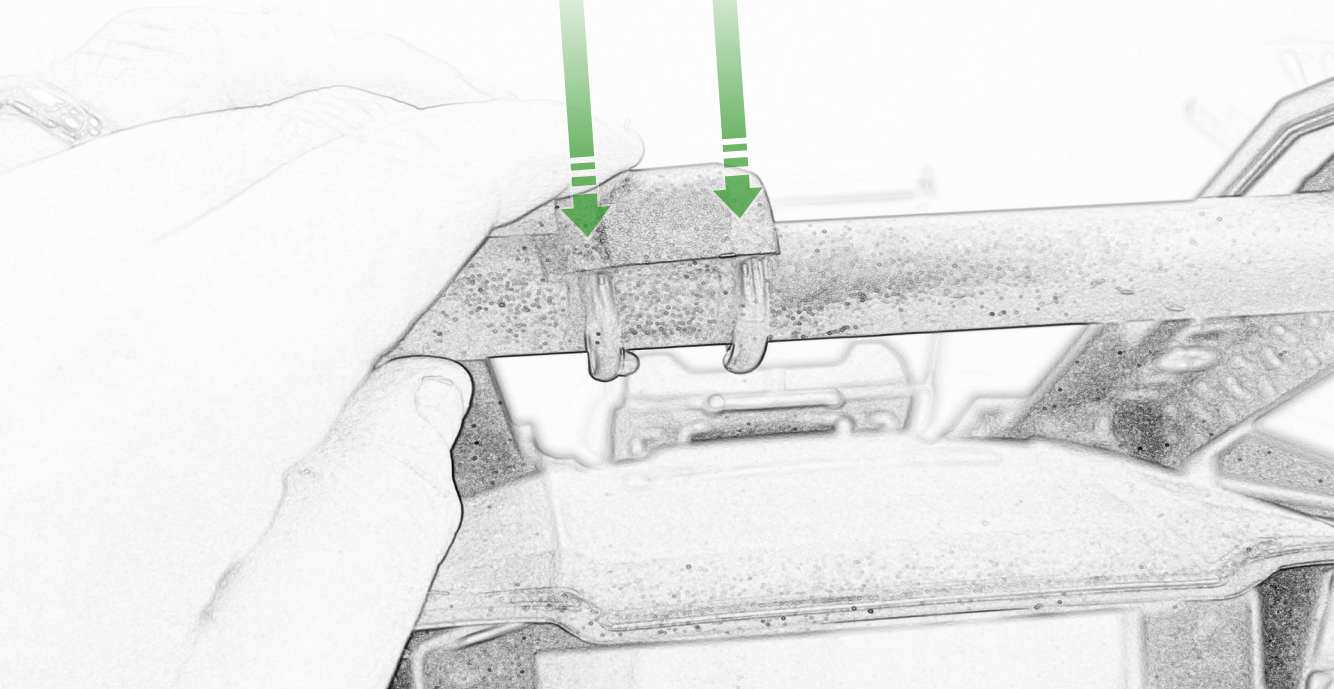



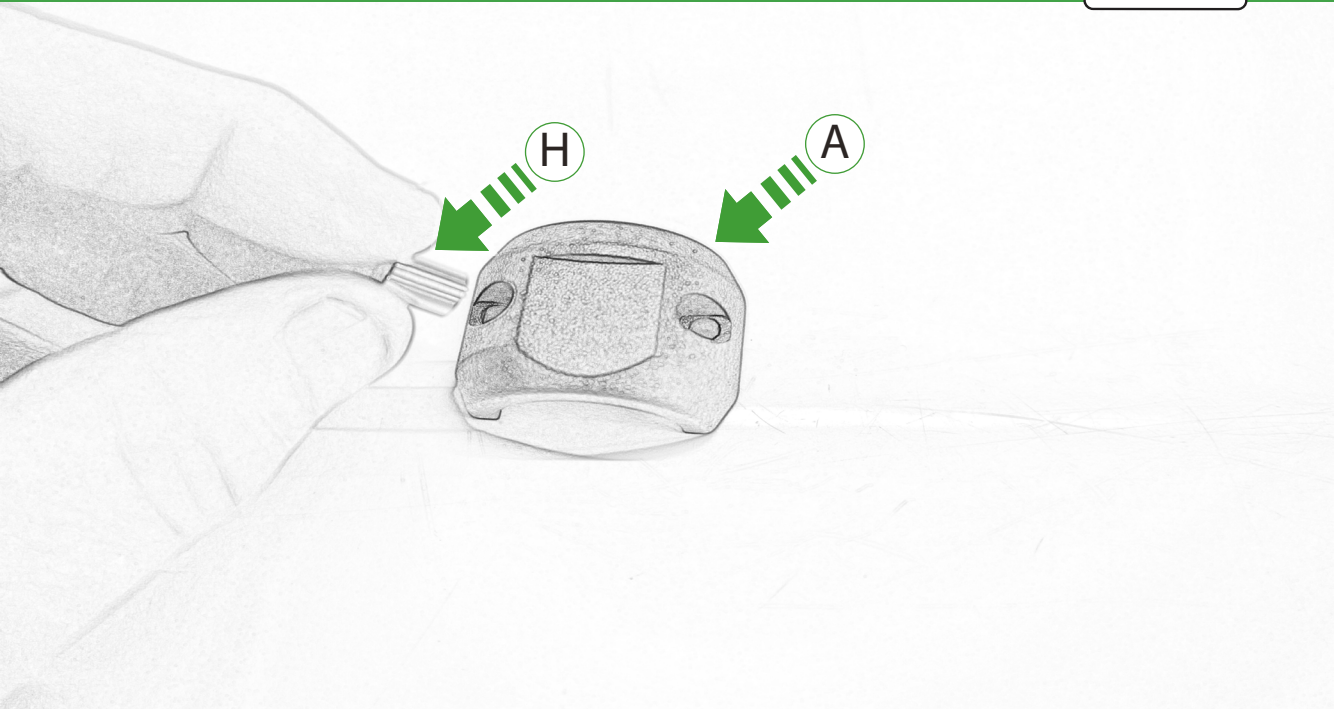

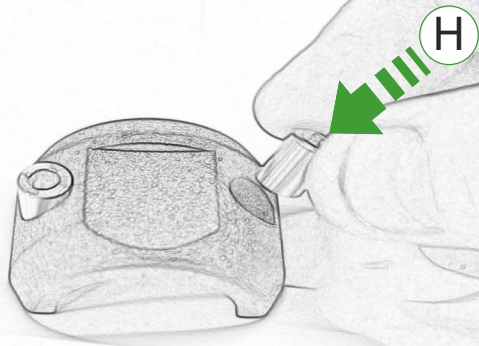

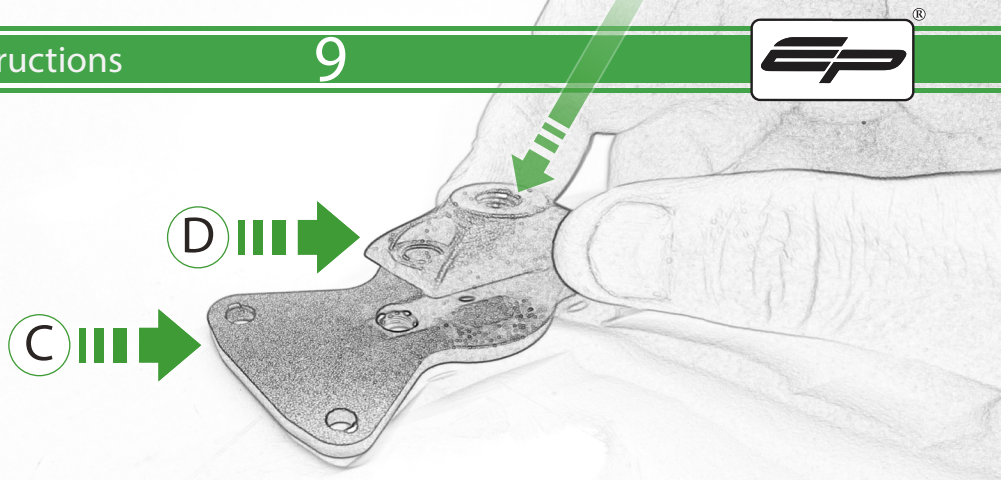



10

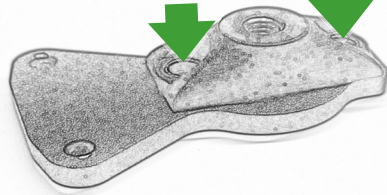

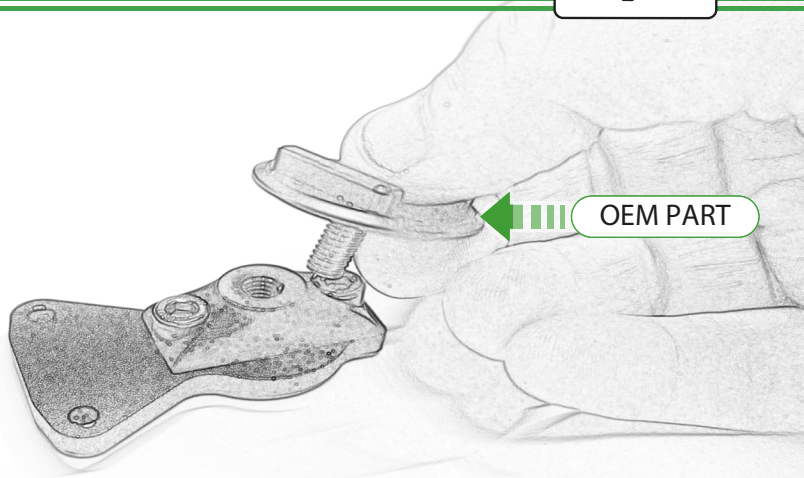

OEM PART

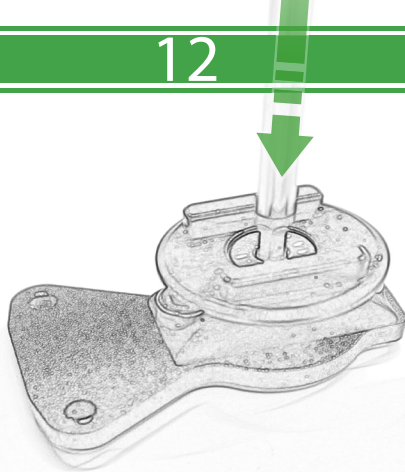

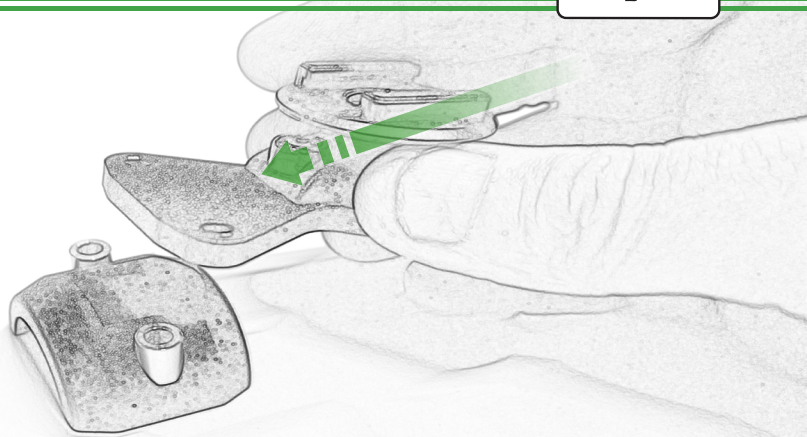

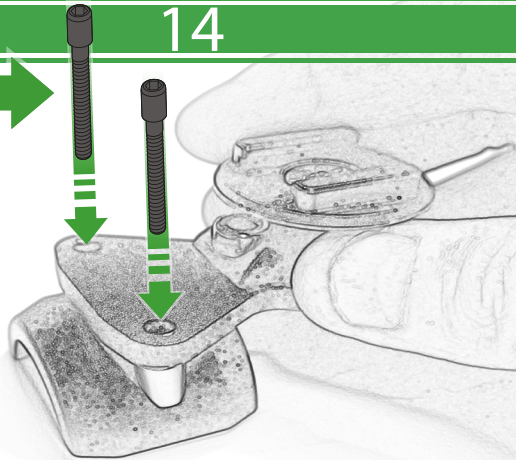

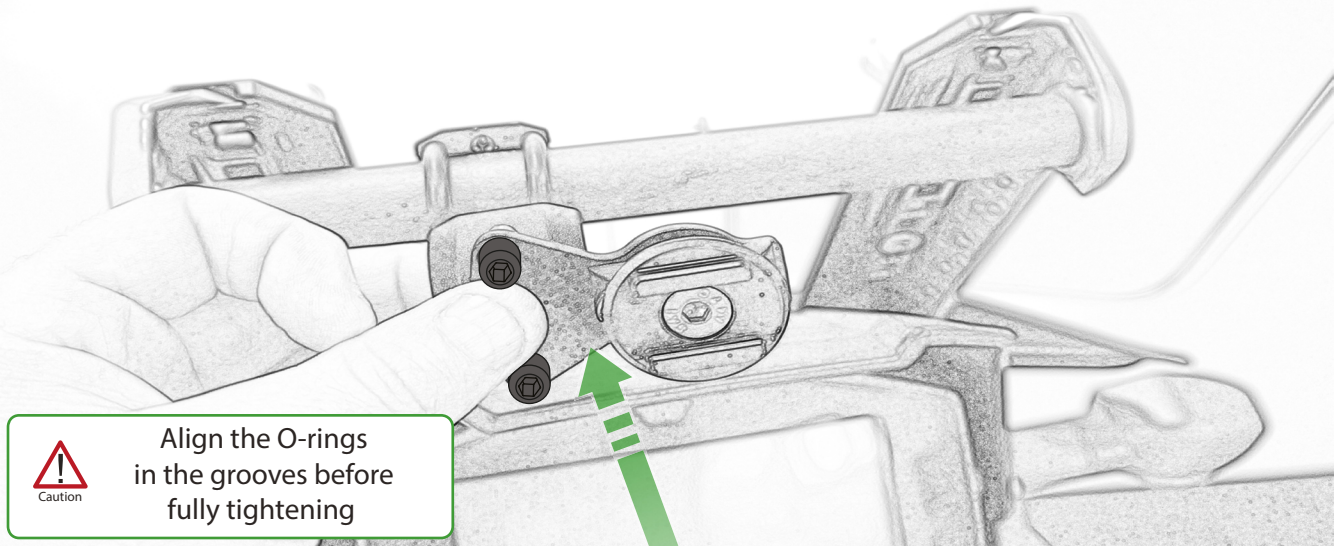

Caution

Align the O-rings
in the grooves before
fully tightening

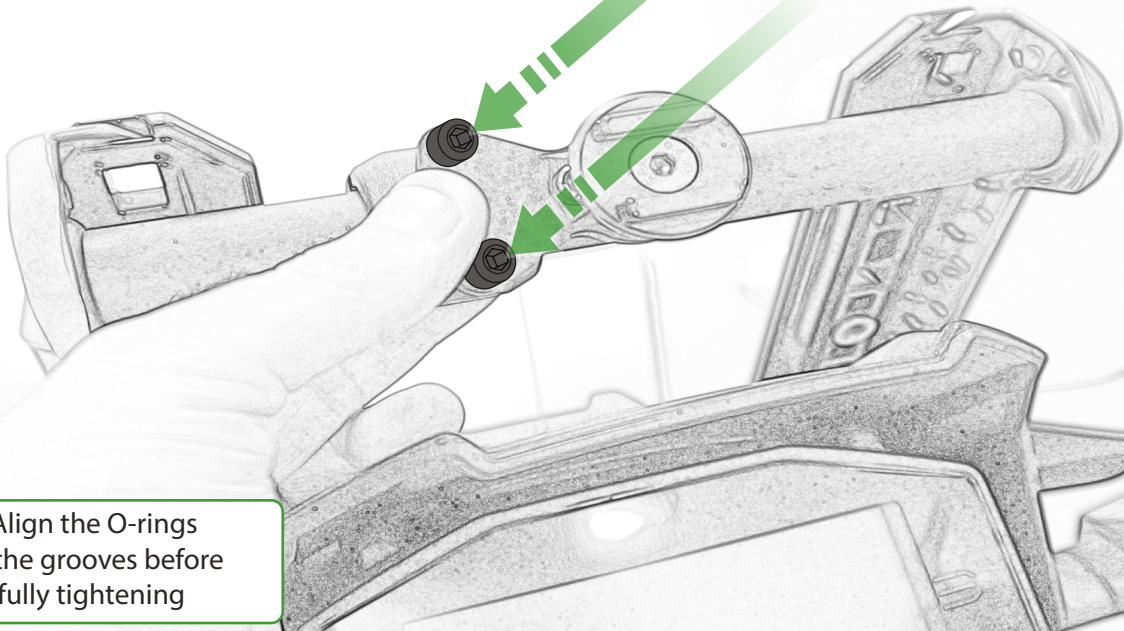

Caution

Align the O-rings
in the grooves before
fully tightening



Kit Contents PRN014677-015140

- (A) 1 x Upper Mounting Body
- (B) 1 x Lower Mounting Body
- (C) 1 x Mounting Plate
- (D) 1 x SP Connect Mounting Plate
- (E) 1 x M5 Nyloc Nut
- (F) 2 x M4 x 30mm Caphead Bolts
- (G) 2 x O-ring
- (H) 2 x Spacer
- (I) 2 x M5 x 10mm Caphead Bolts





G

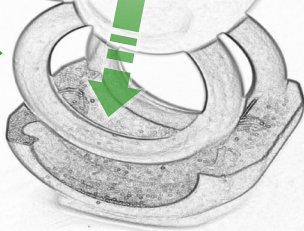

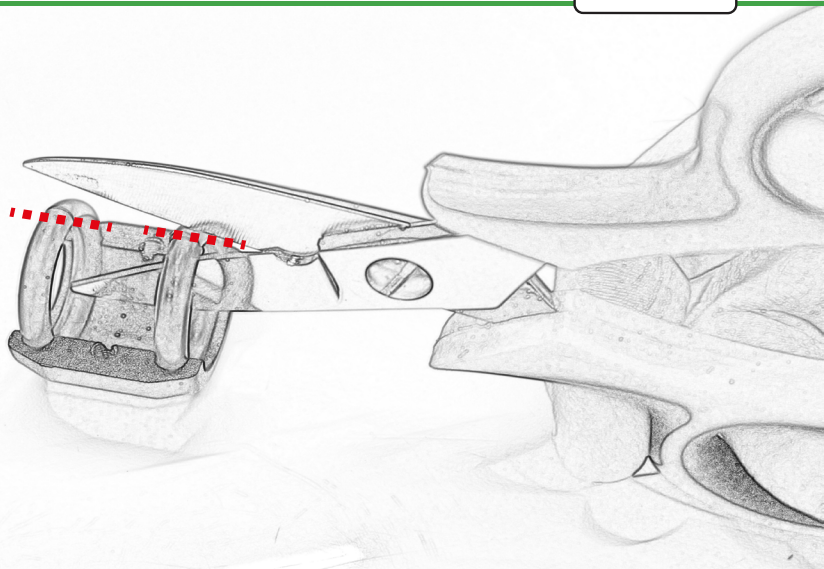

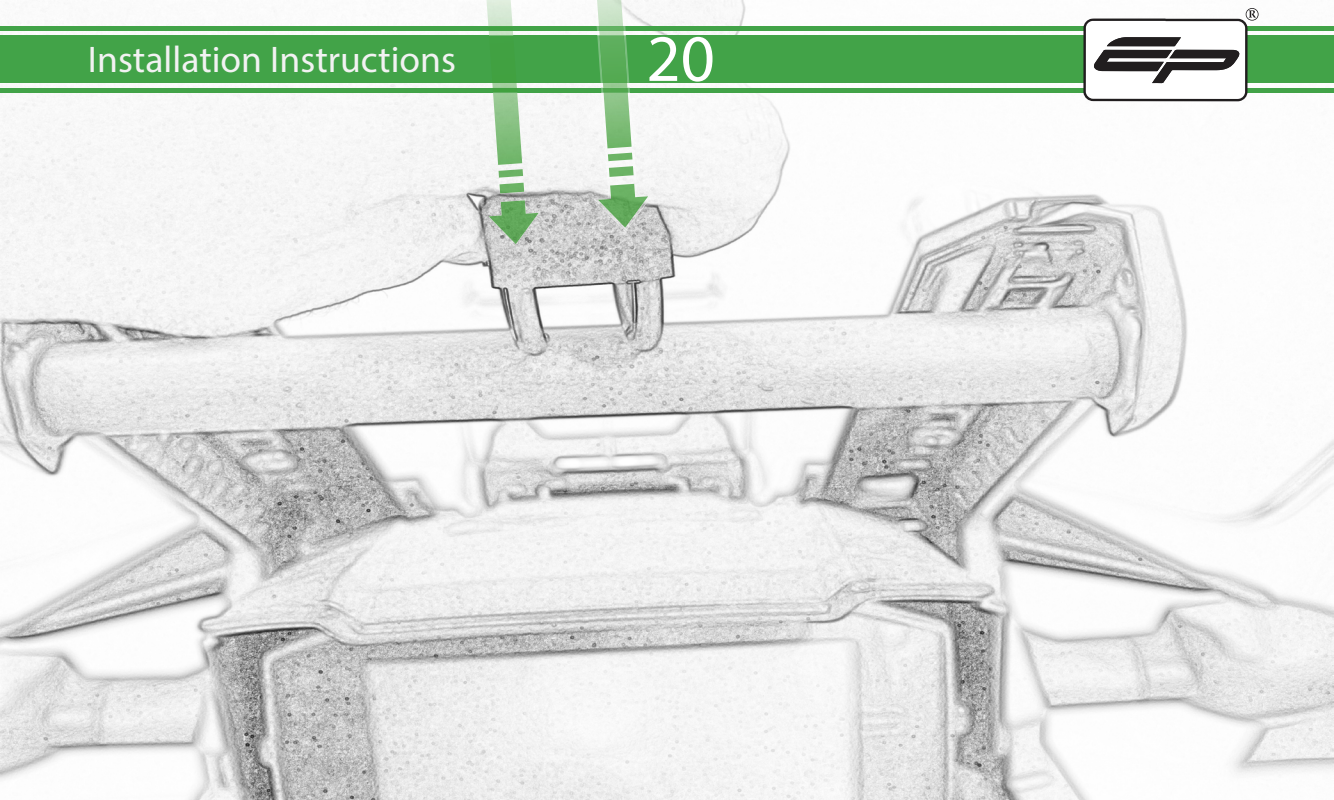

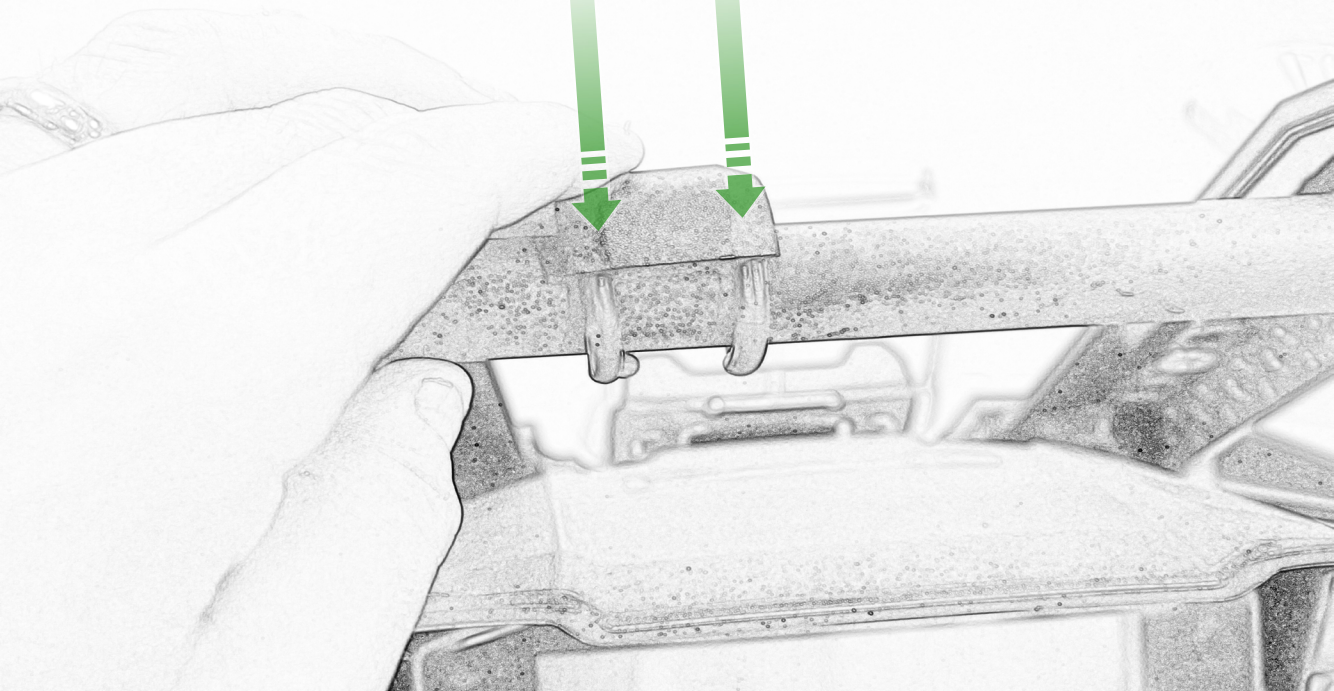

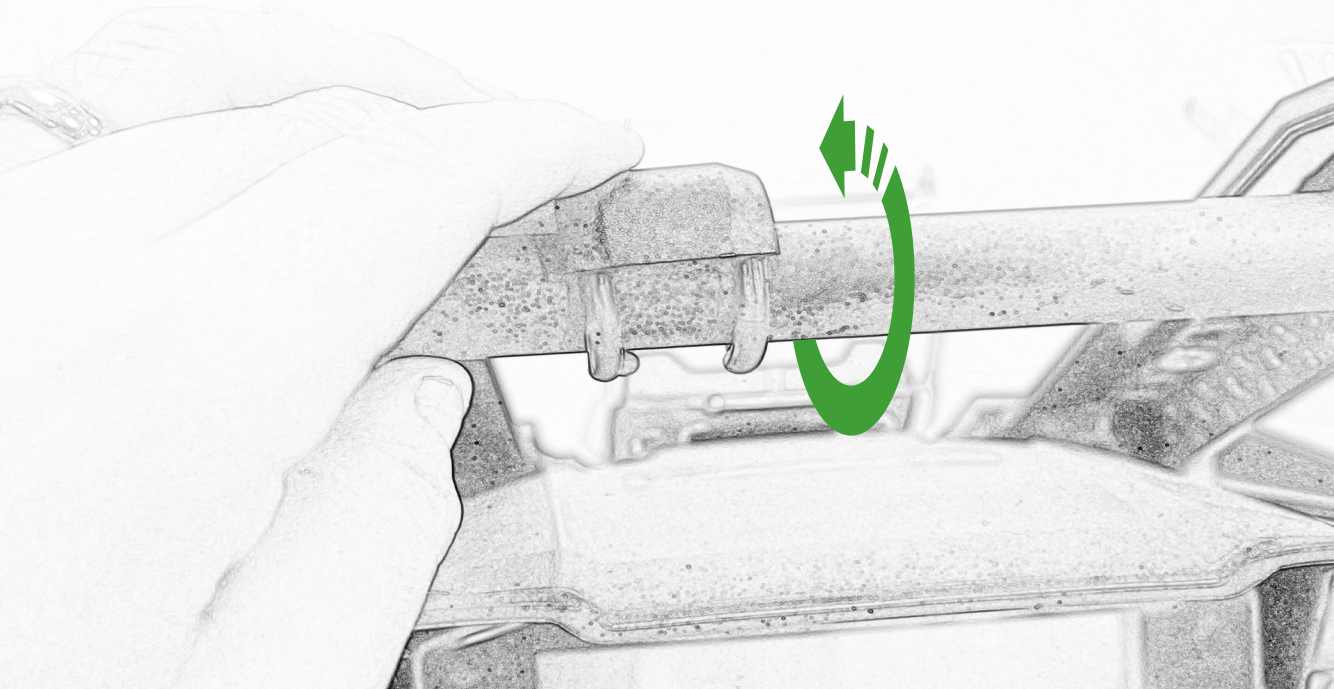

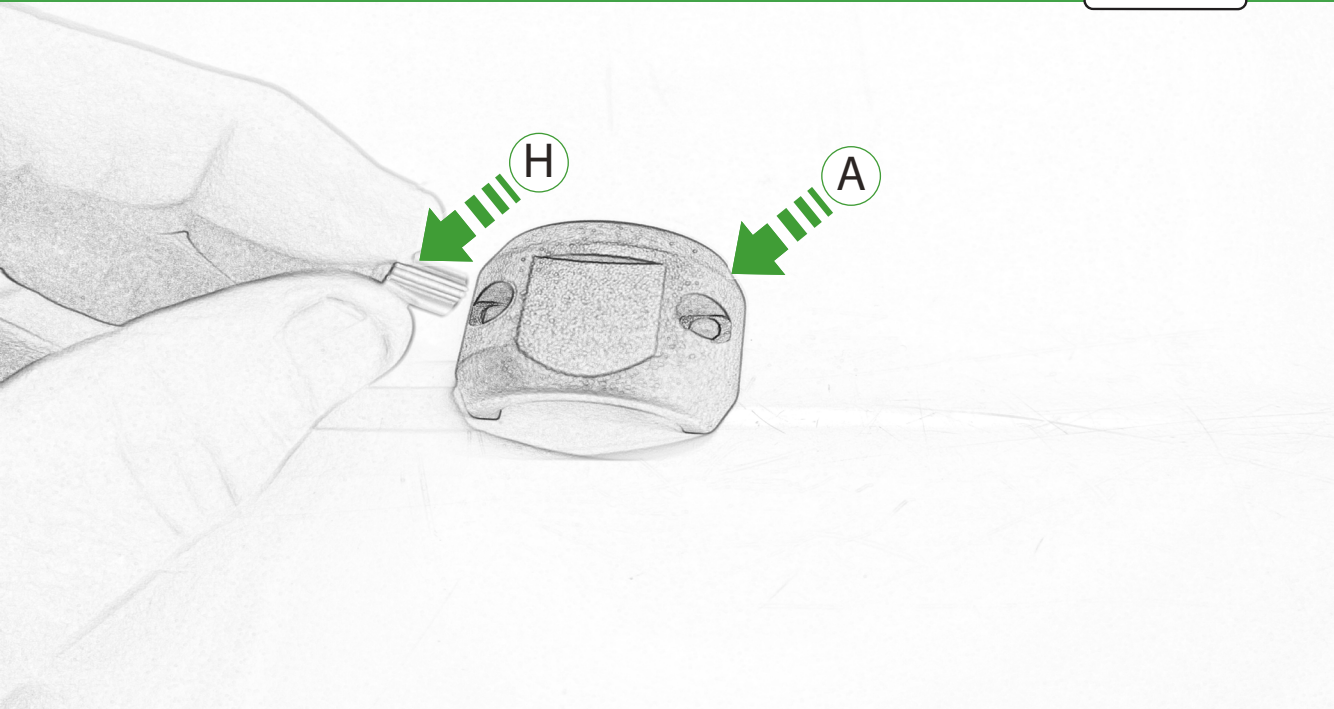

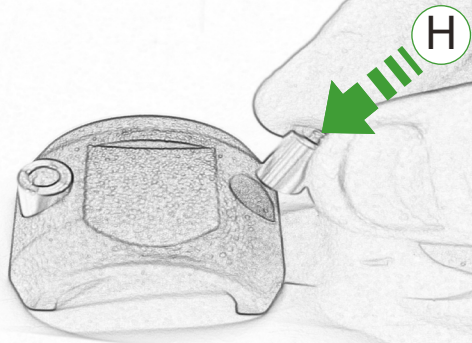

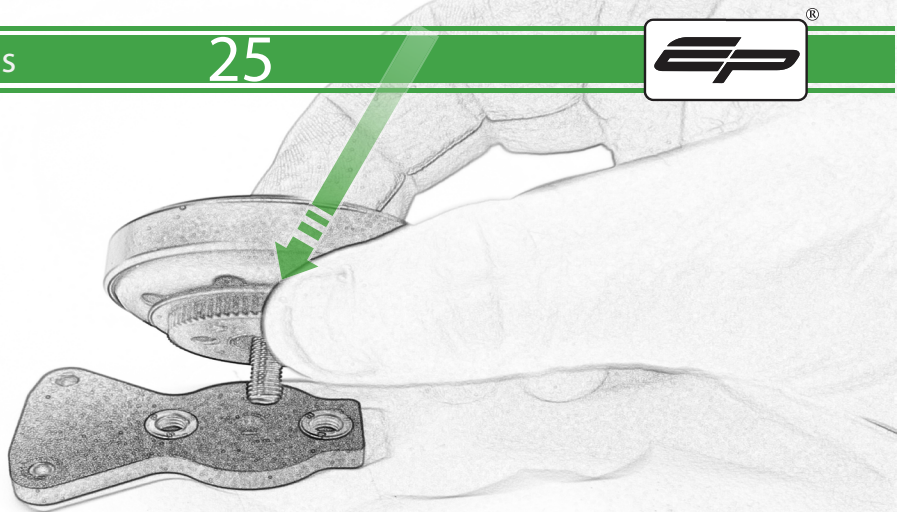

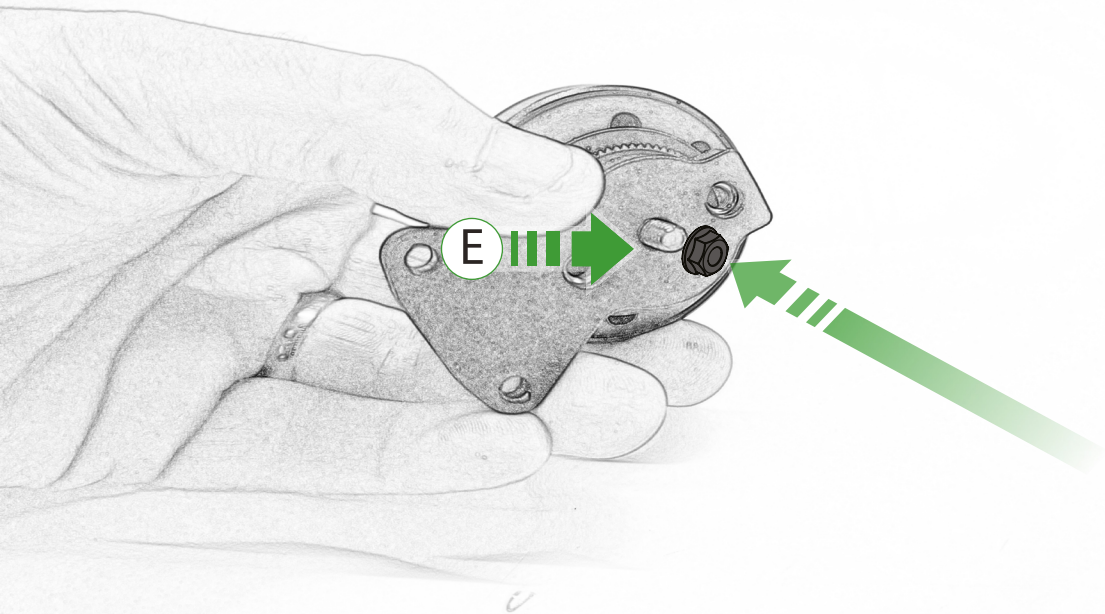

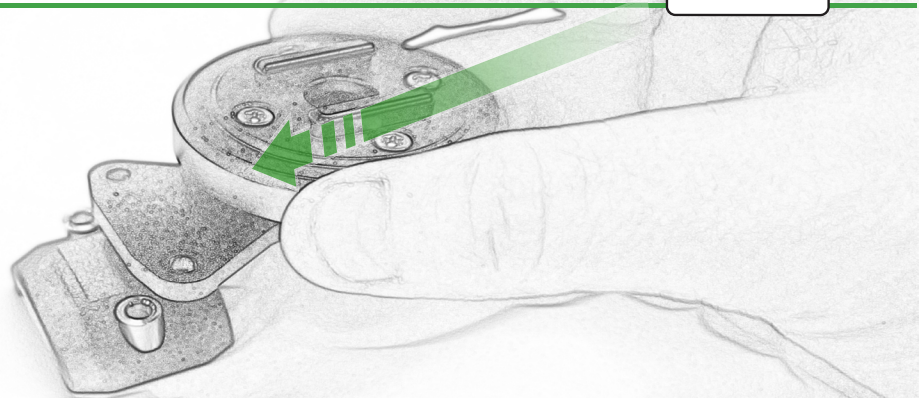



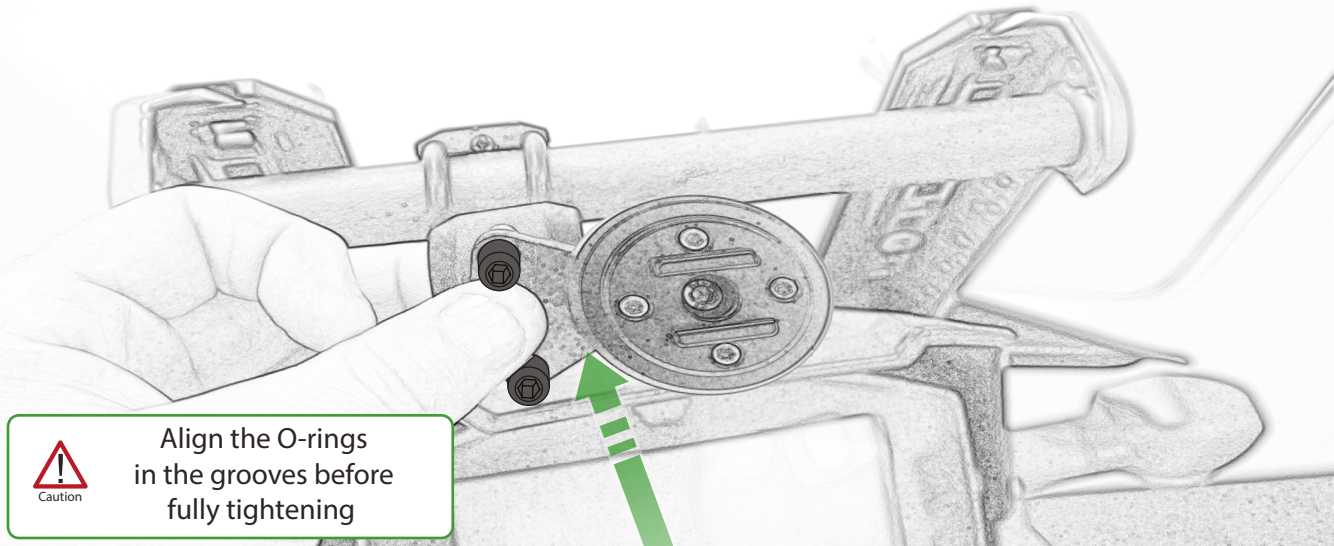

Caution

Align the O-rings
in the grooves before
fully tightening

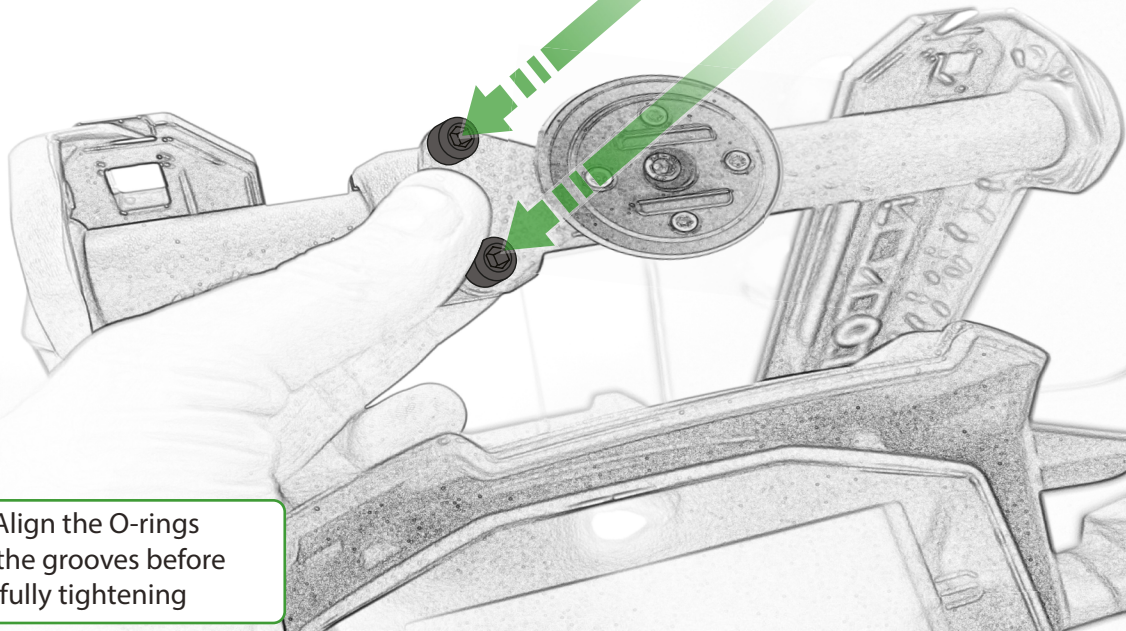

Caution

Align the O-rings
in the grooves before
fully tightening

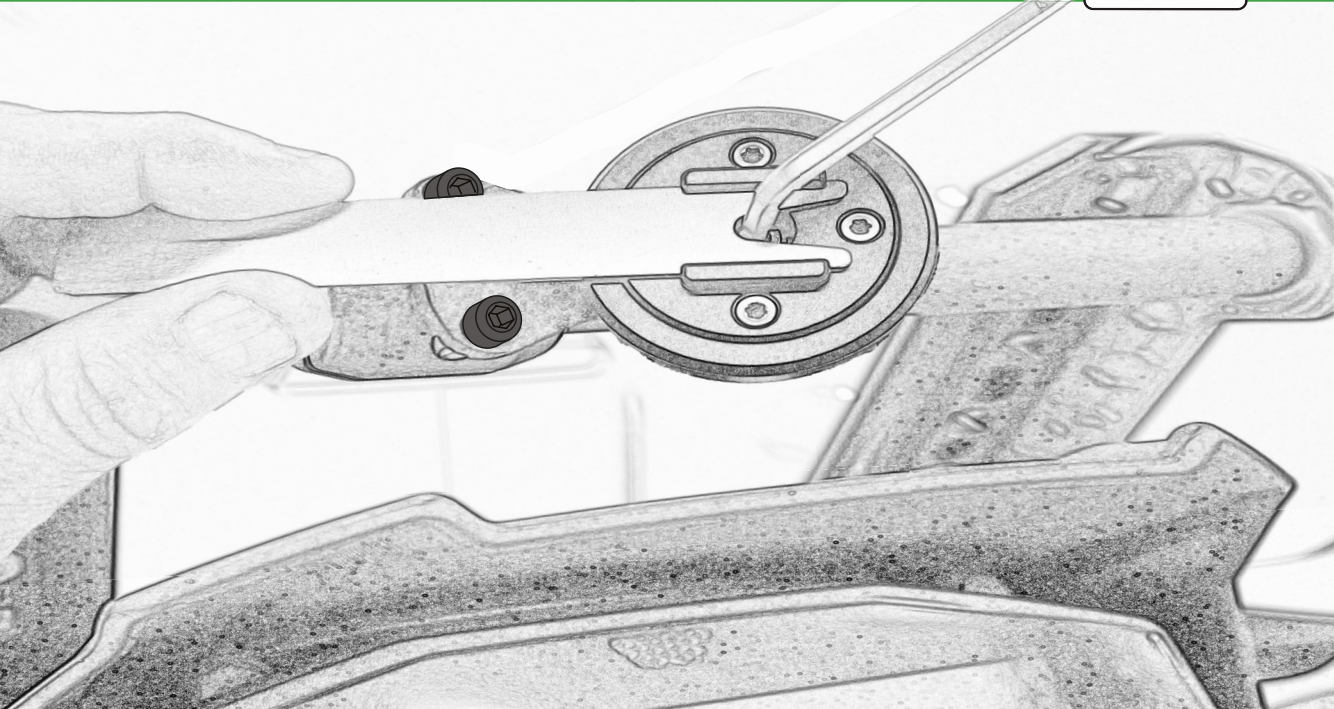



ESSENTIAL CHECKS

It is recommended that periodic inspections are made to ensure that all bolts are tightened to the specified torque settings.

Should the bike be involved in an accident a thorough inspection should be made and any components that have taken an impact, no matter how small, be replaced



EVOTECH®
P E R F O R M A N C E

www.evotech-performance.com