



EVOTECH®
P E R F O R M A N C E

www.evotech-performance.com

BMW S 1000 RR

Action Camera Mount Instructions



- (A) 1 x Rubber Bung
- (B) 1 x Mounting Bracket
- (C) 1 x Action Camera Mount
- (D) 1 x M5 Washer
- (E) 1 x M5 x 20 Caphead
- (F) 2 x M5 x 16 Black Button Head Bolts
- (G) 4 x M5 x 12 Black Button Head Bolts

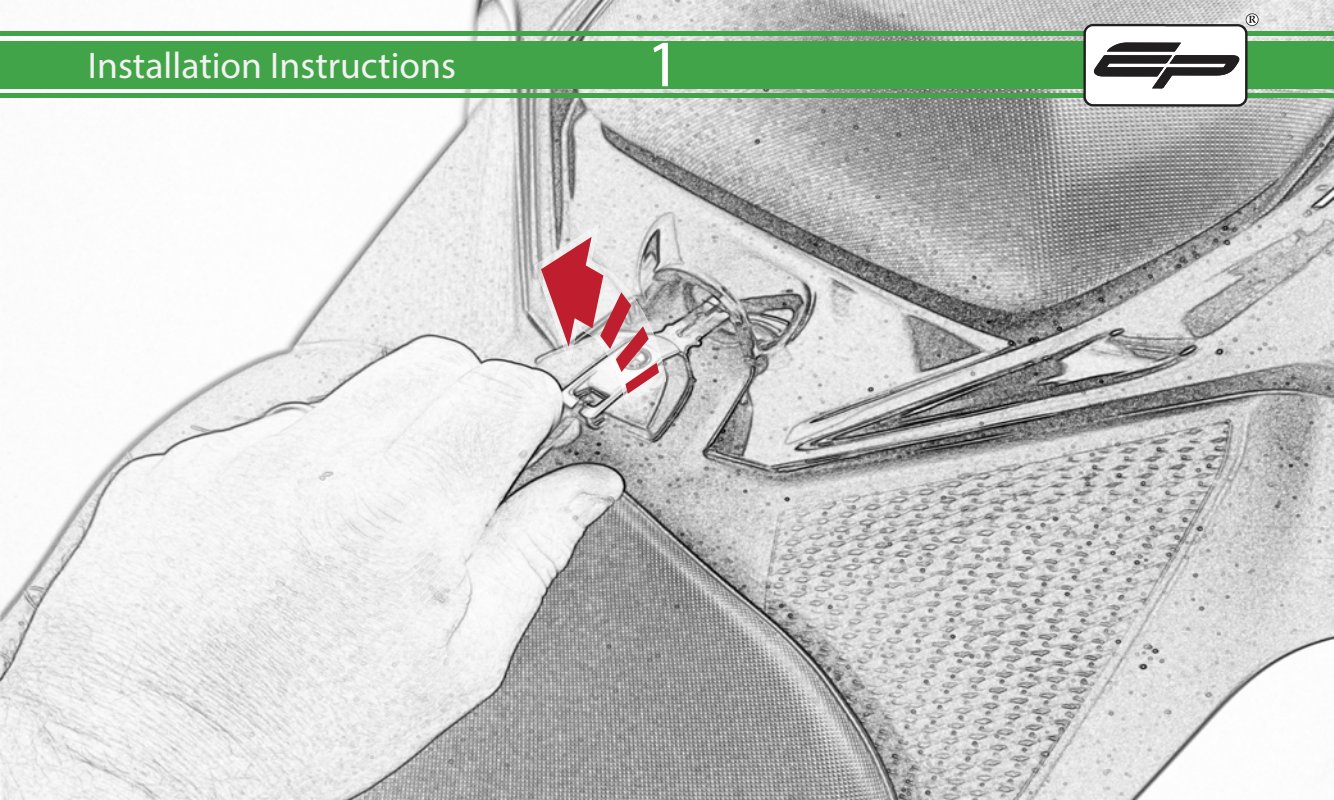

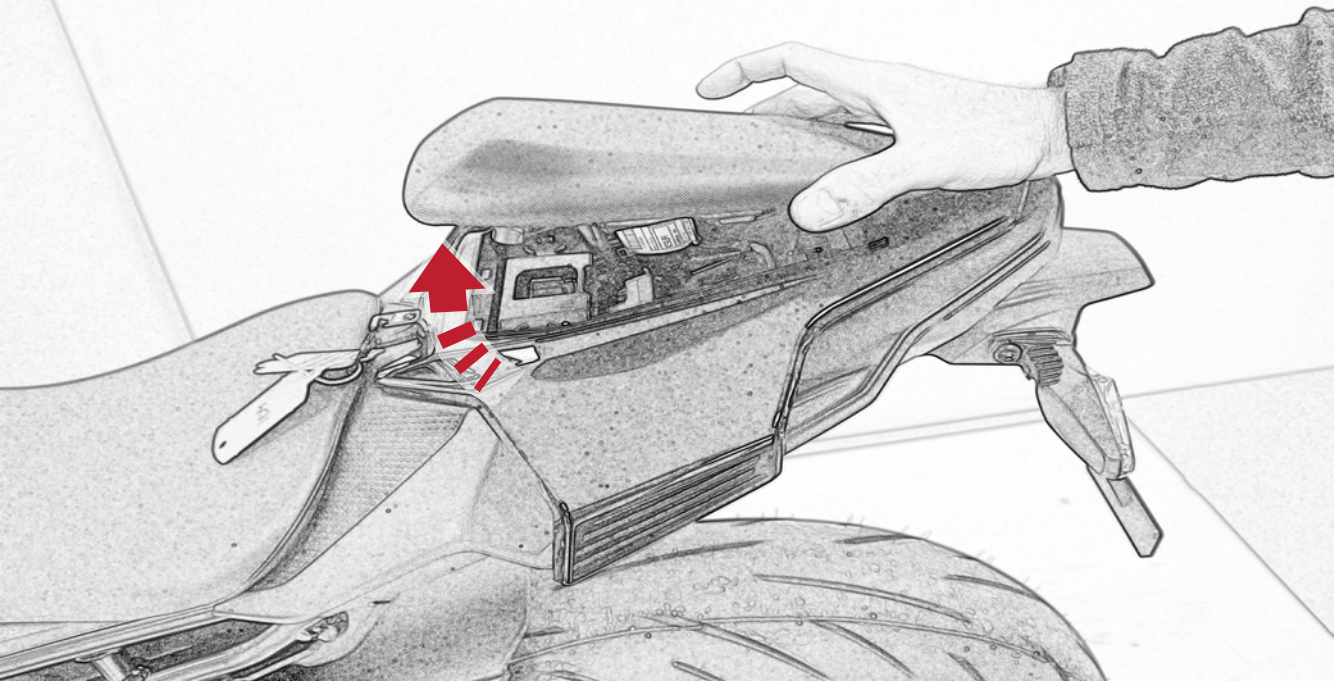

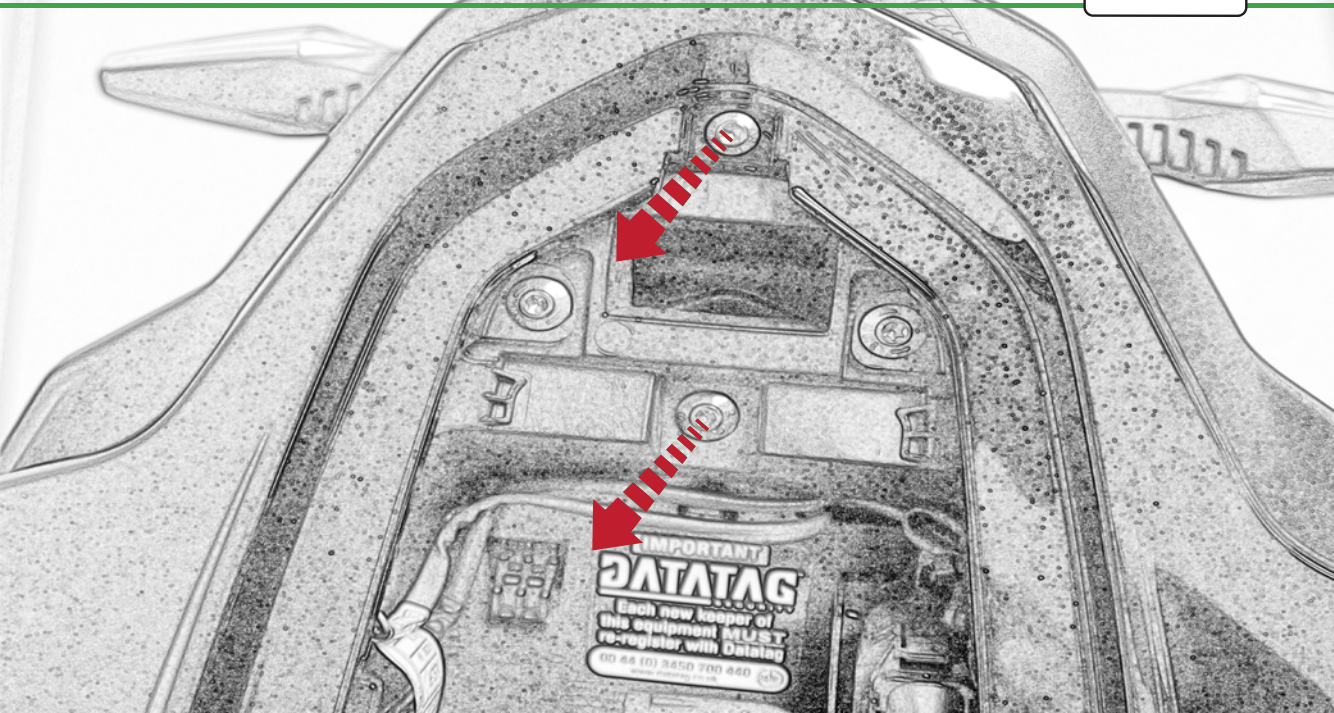

IMPORTANT!
DATATAG
Each new keeper of
this equipment **MUST**
re-register with Datatag
00 44 (0) 3450 700 850 

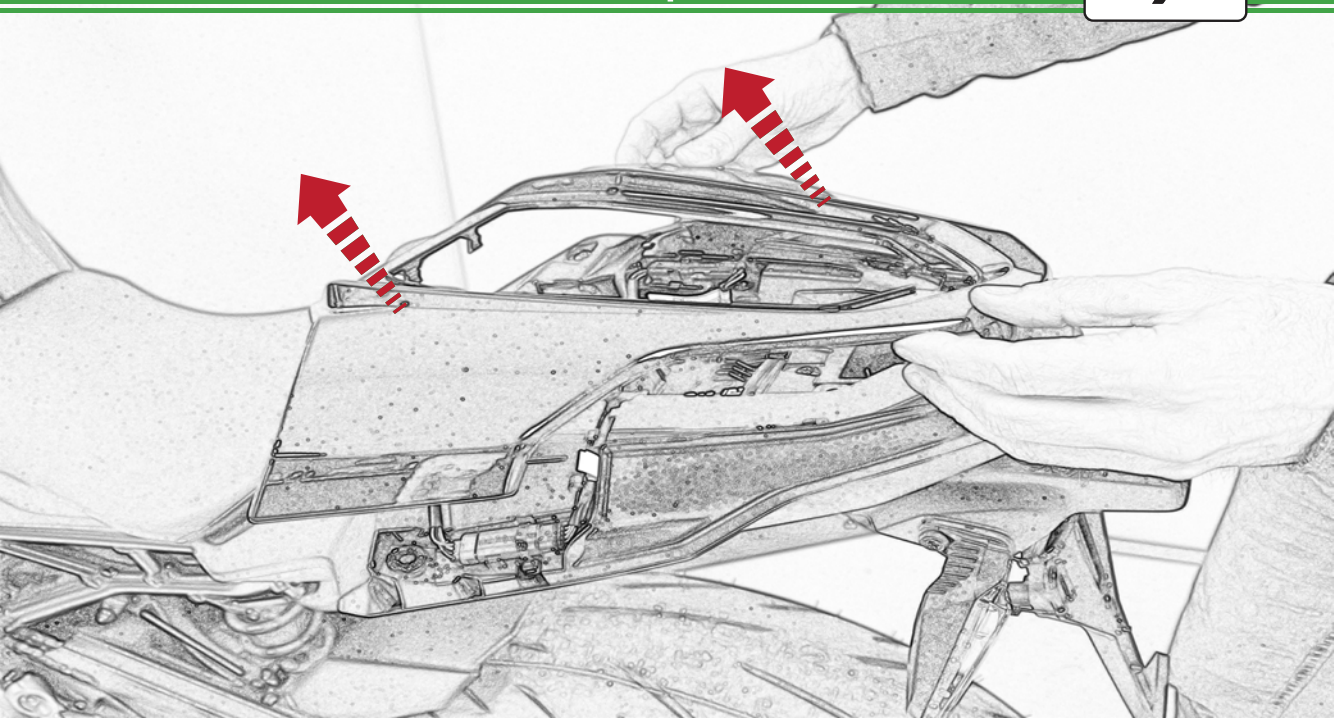

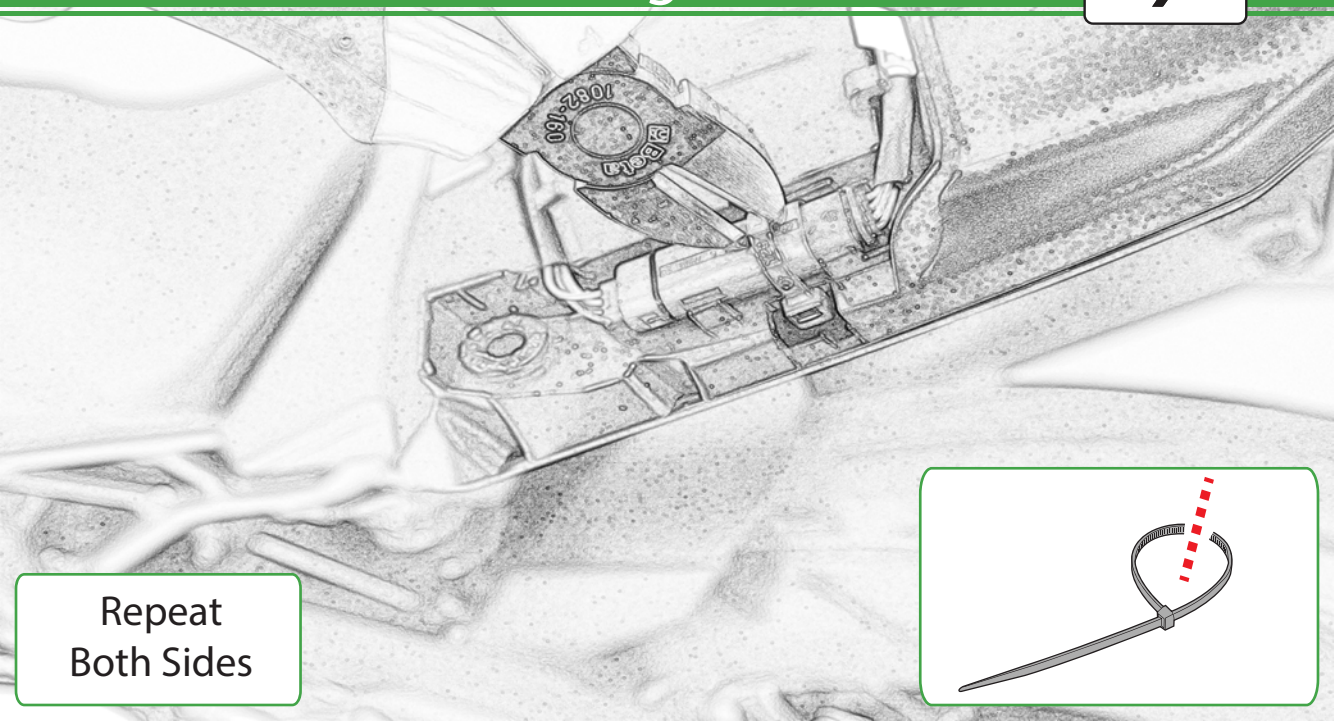

Repeat
Both Sides

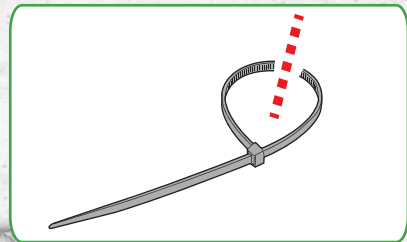

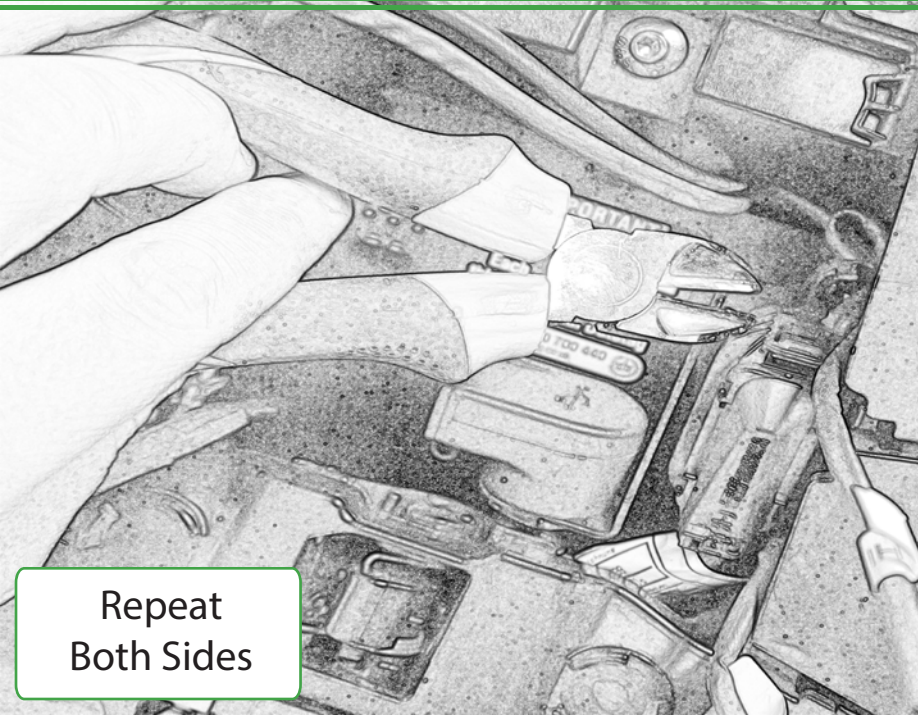

Repeat
Both Sides

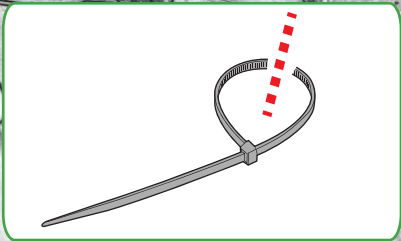

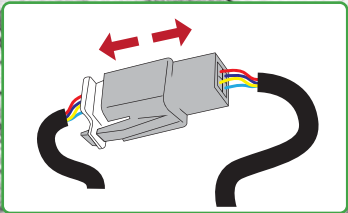
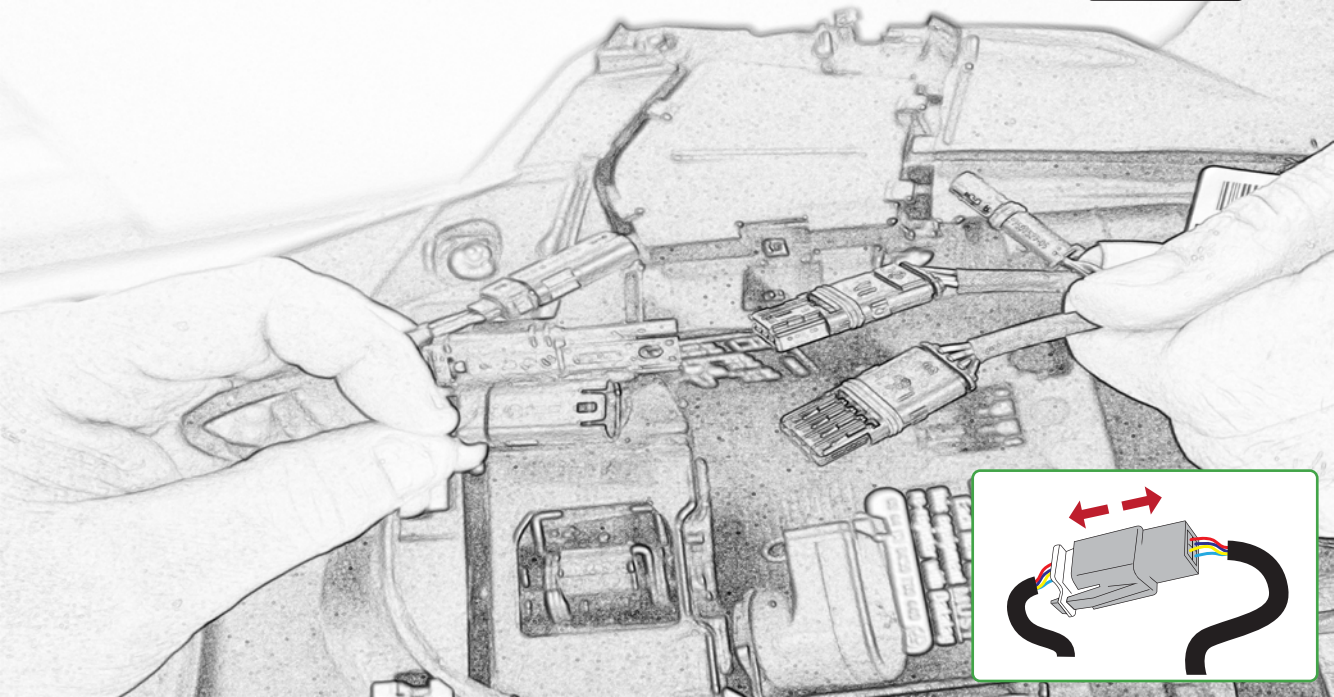

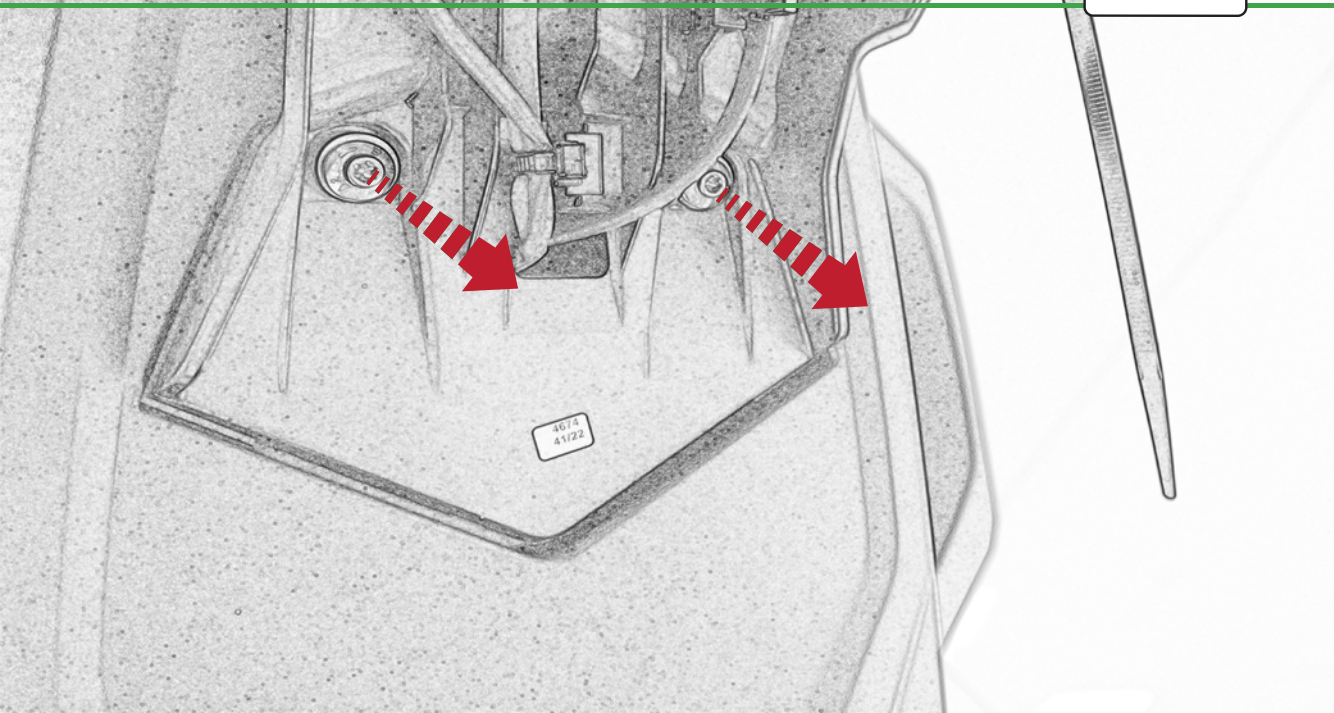

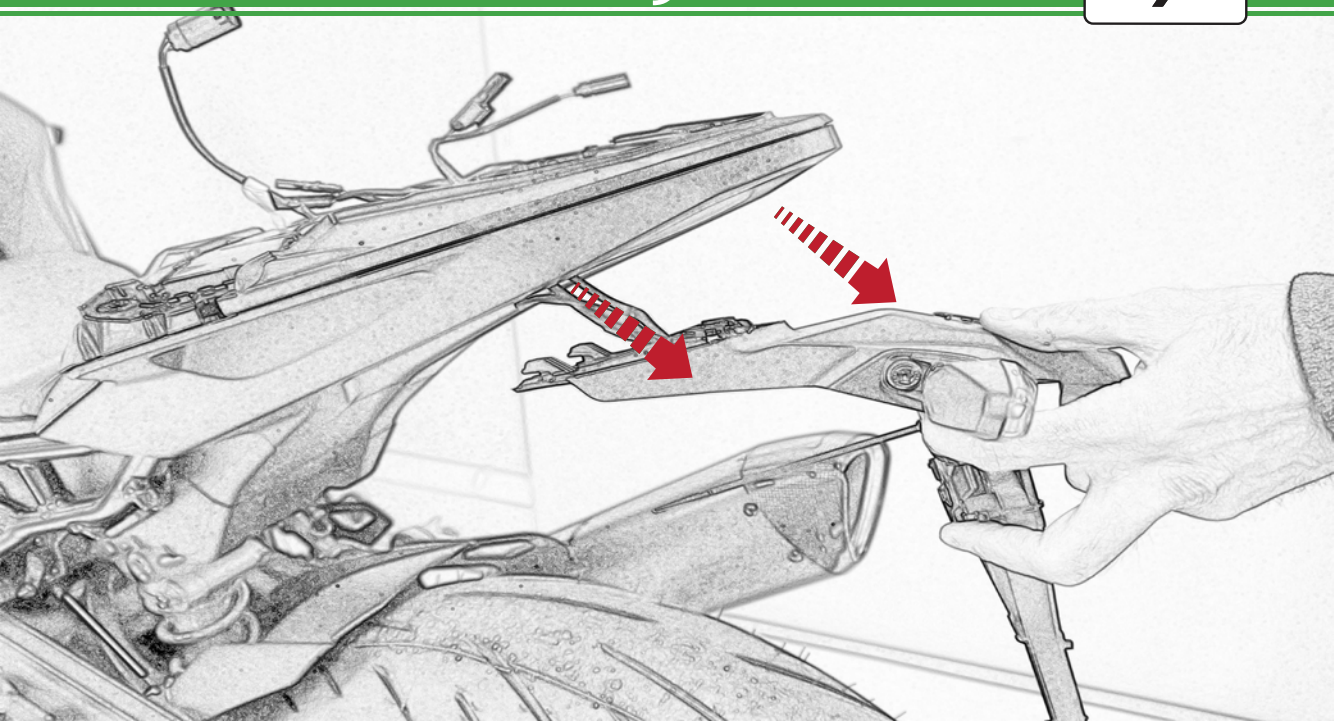

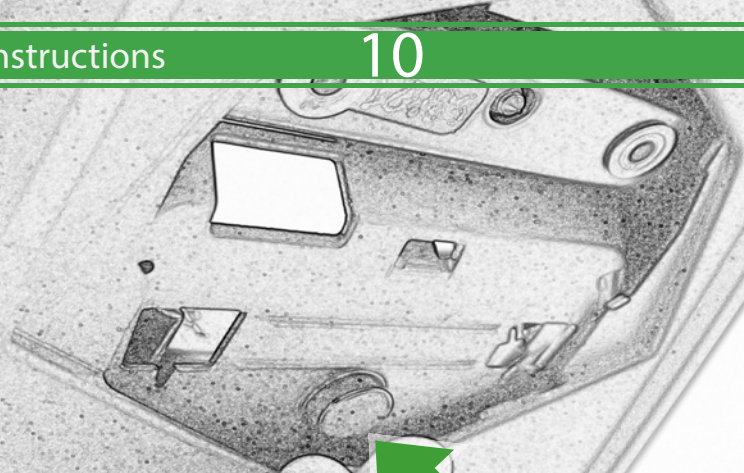

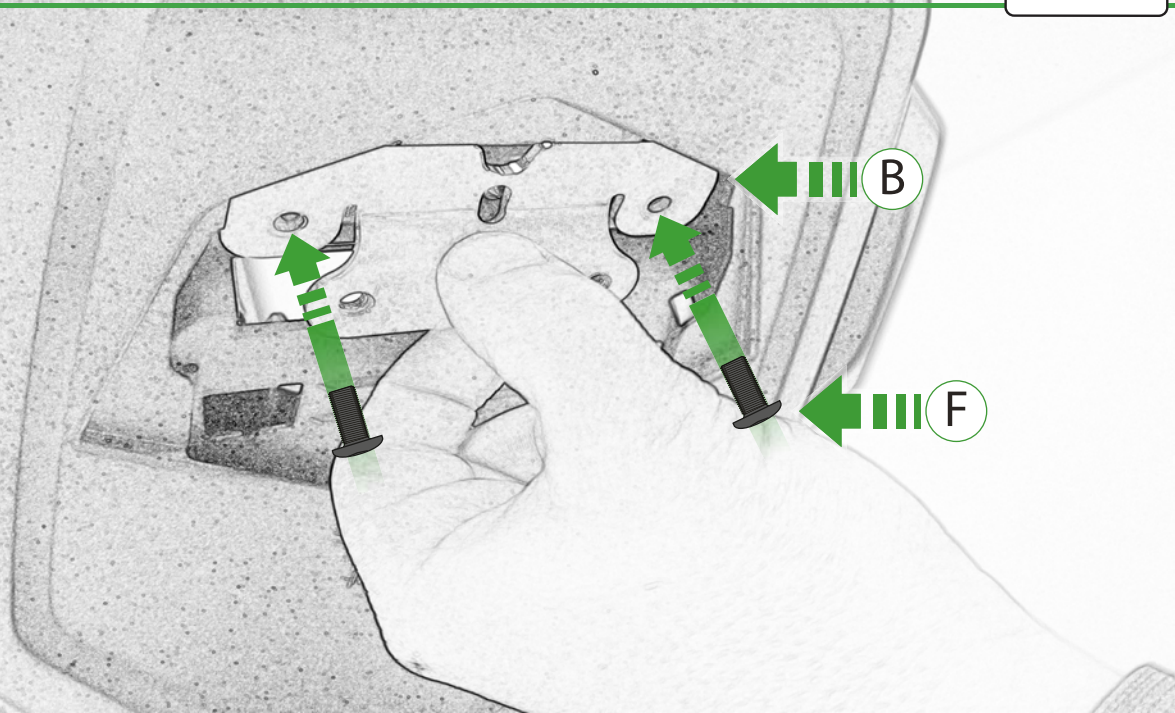

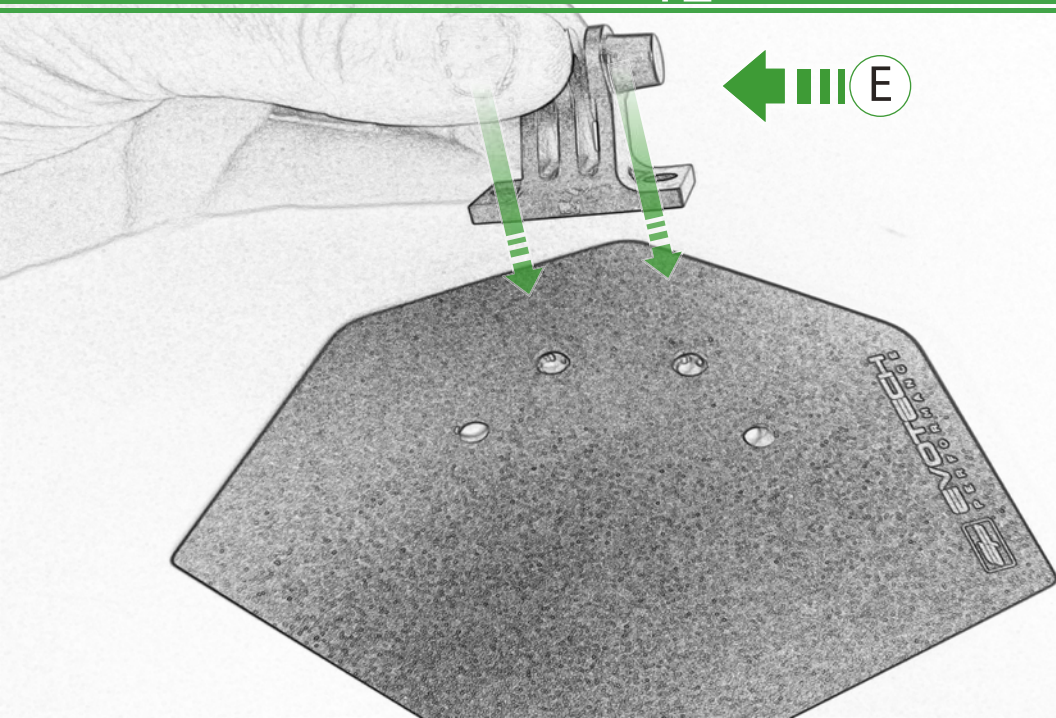

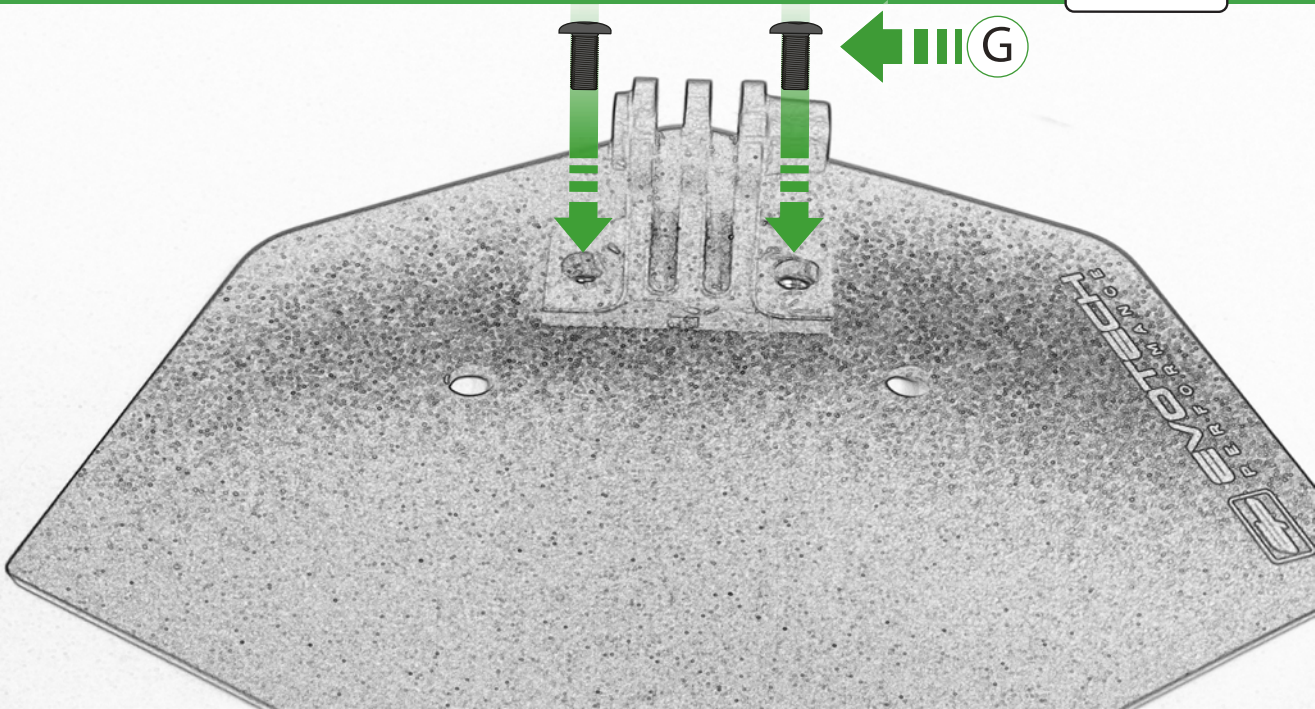

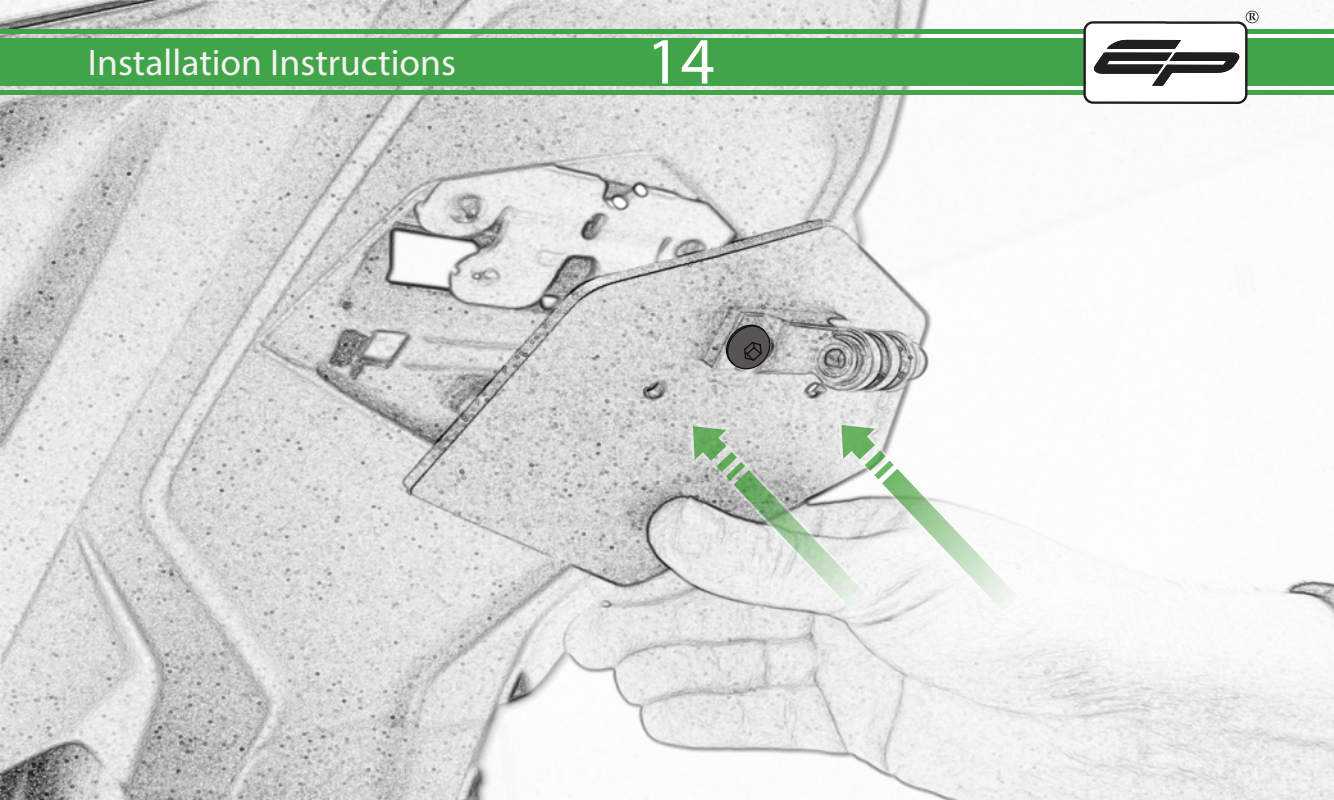

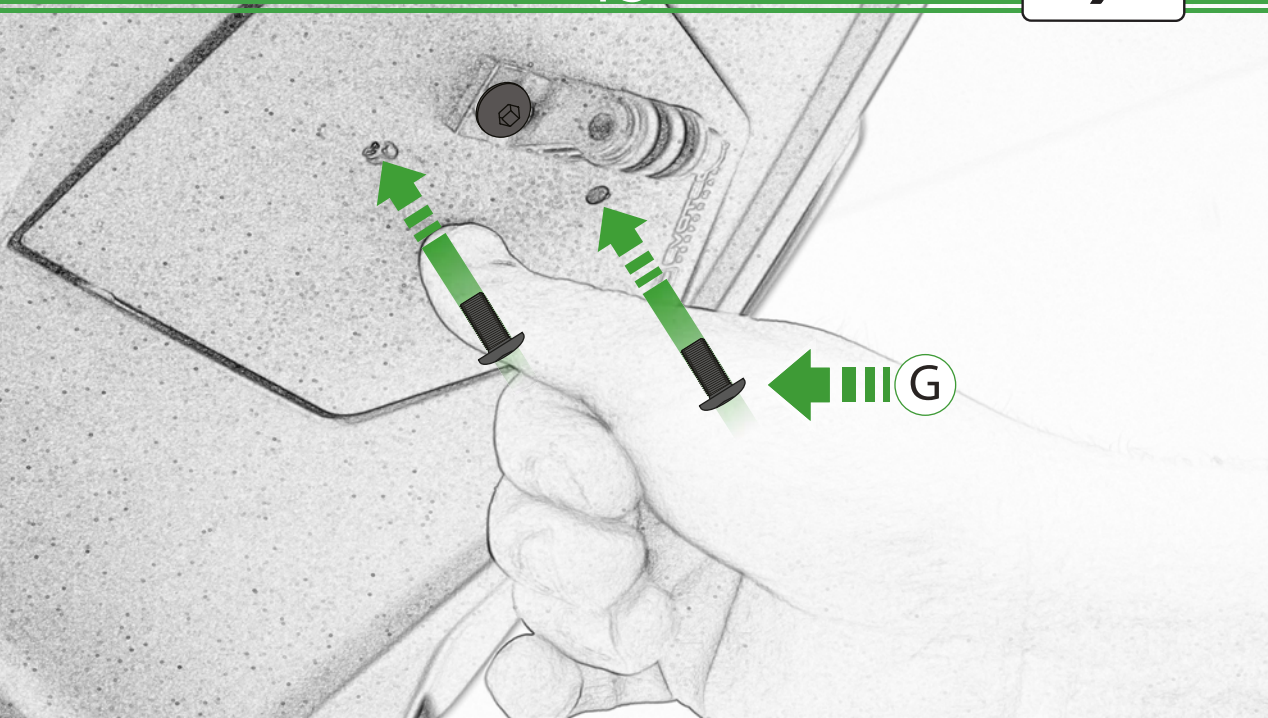

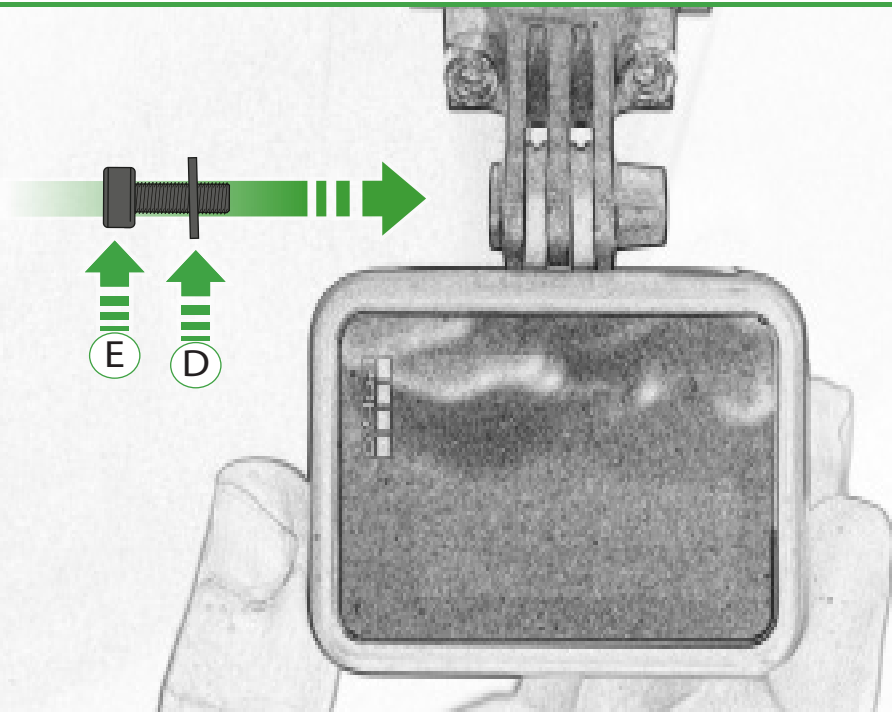



 **ESSENTIAL CHECKS** 

It is recommended that periodic inspections are made to ensure that all bolts are tightened to the specified torque settings.

Should the bike be involved in an accident a thorough inspection should be made and any components that have taken an impact, no matter how small, be replaced



EVOTECH®
P E R F O R M A N C E

www.evotech-performance.com