



EVOTECH®
P E R F O R M A N C E

www.evotech-performance.com

Triumph Street Triple
Tail Tidy



Kit Contents

- Ⓐ 1 x Retro Light
- Ⓑ 1 x Con 12
- Ⓒ 2 x M4 Nut
- Ⓓ 2 x M6 x 60mm Black Button Head
- Ⓔ 3 x M5 x 12mm Black Button Head
- Ⓕ 3 x M6 x 16mm CapHead
- Ⓖ 4 x M6 x 20mm CapHead

EVOTECH[®]

P E R F O R M A N C E



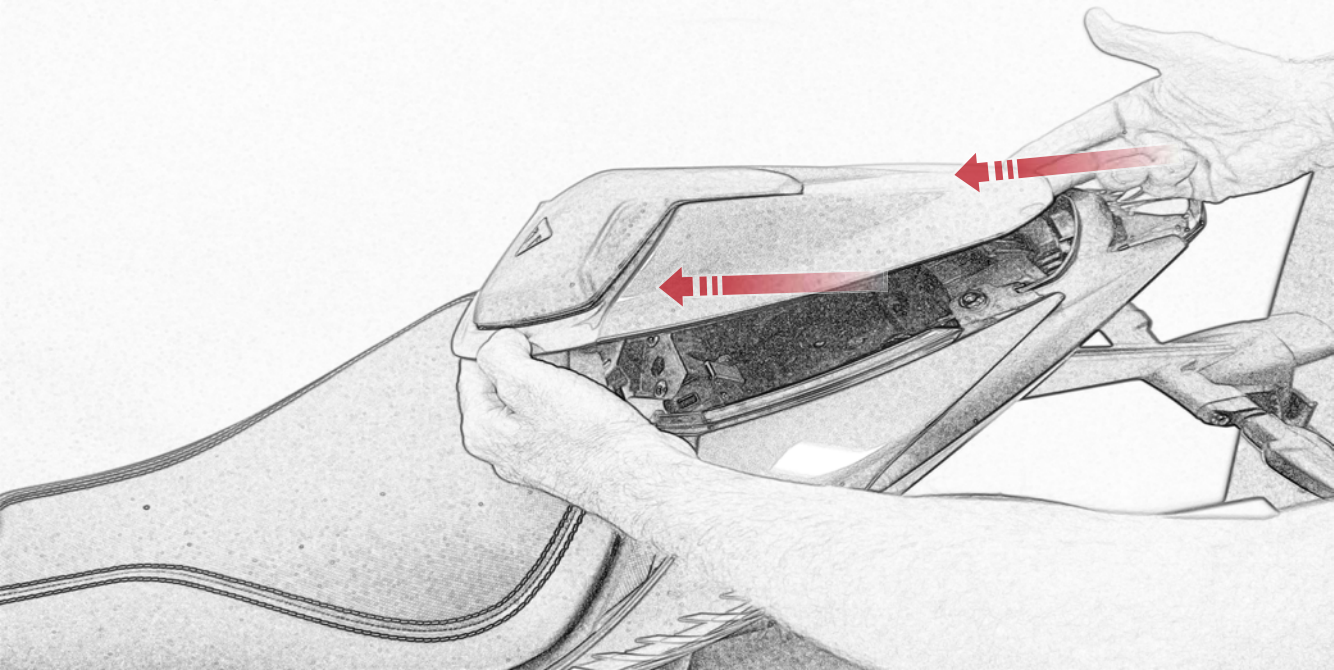

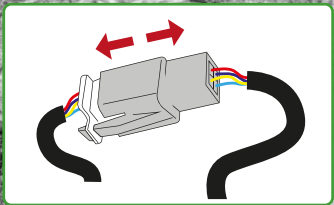
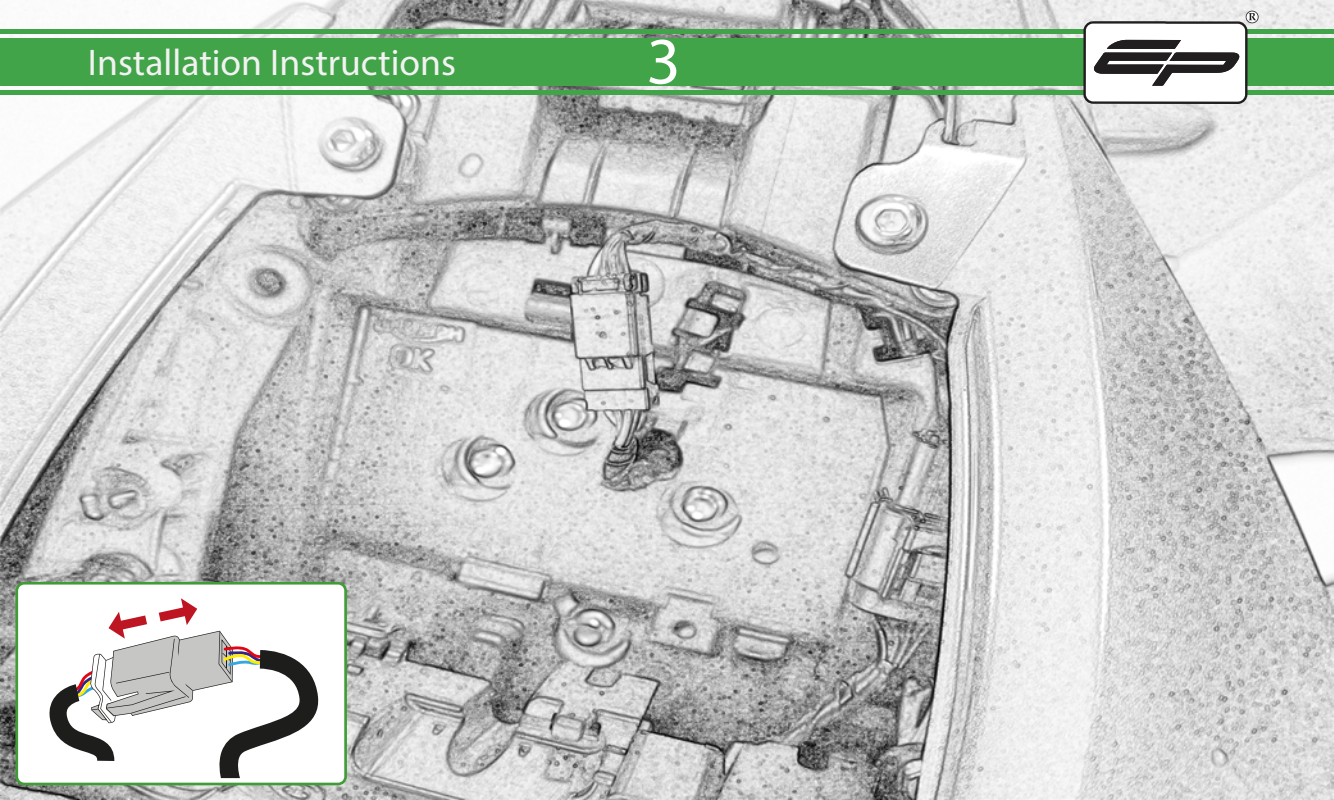

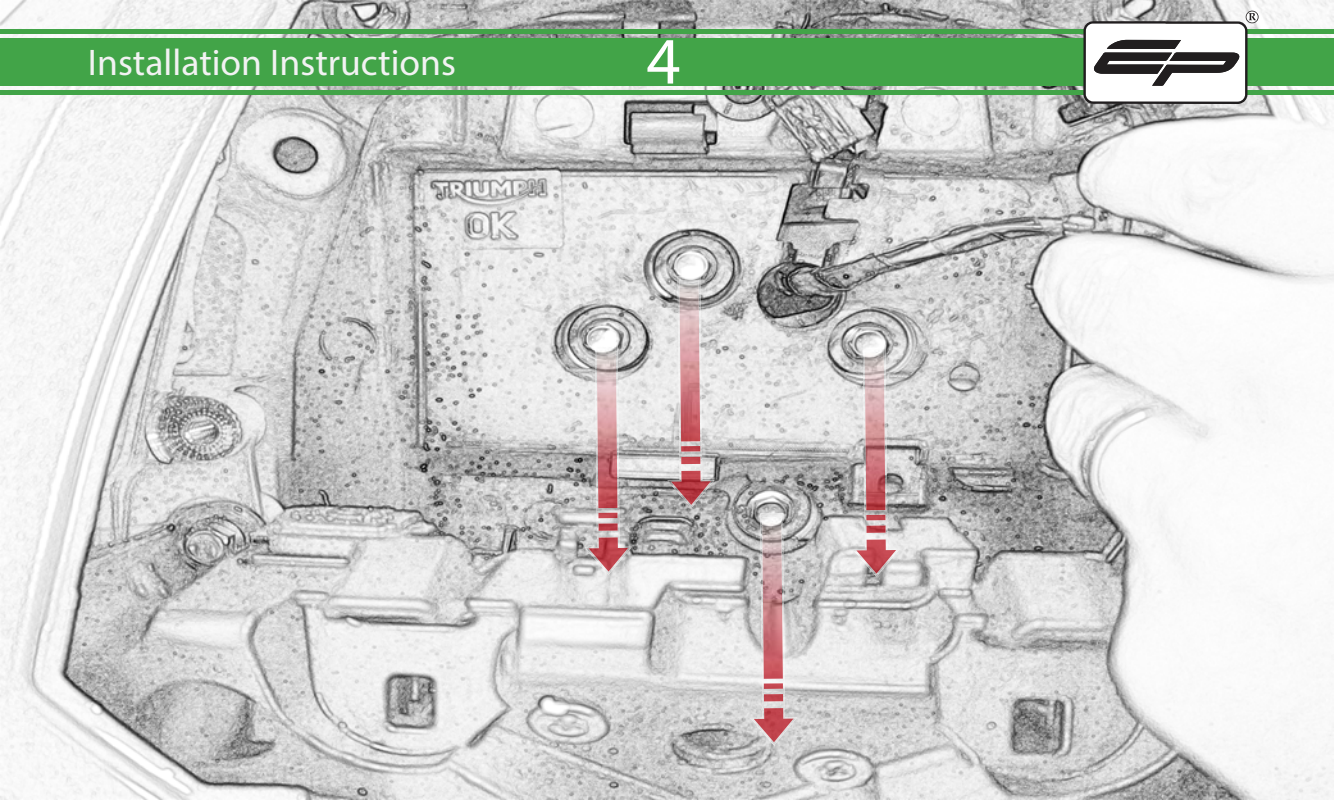

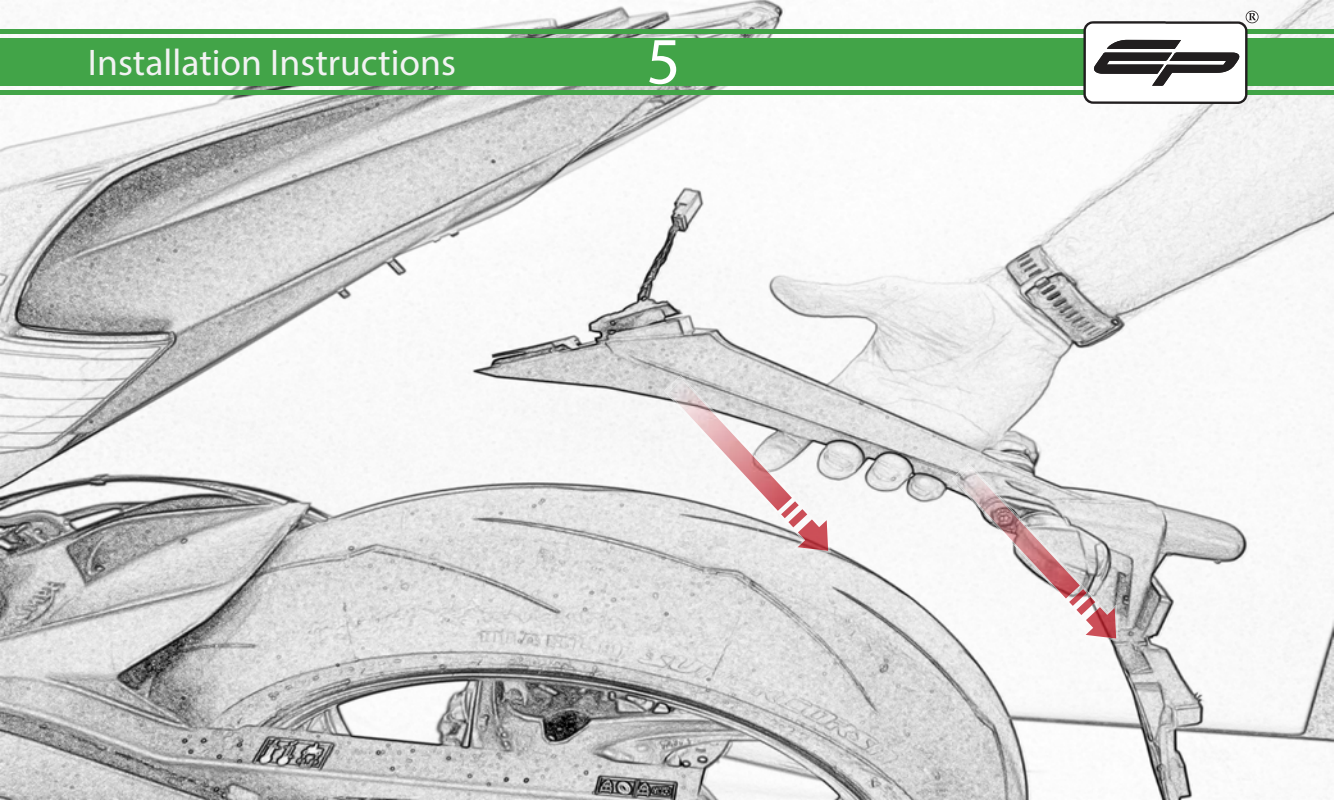

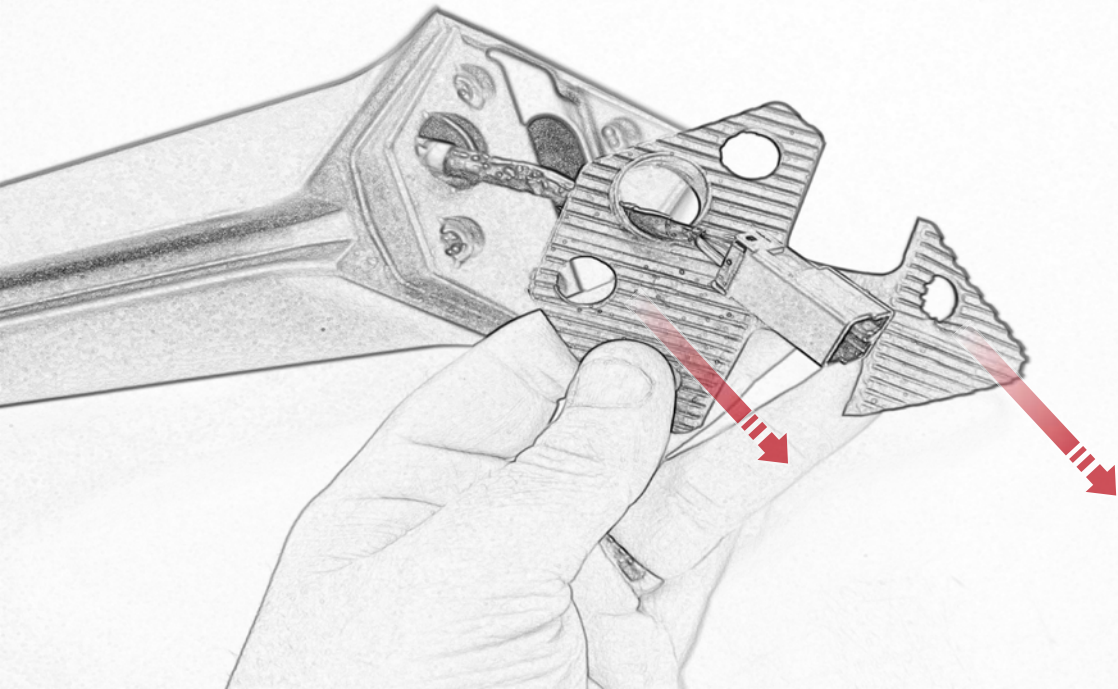

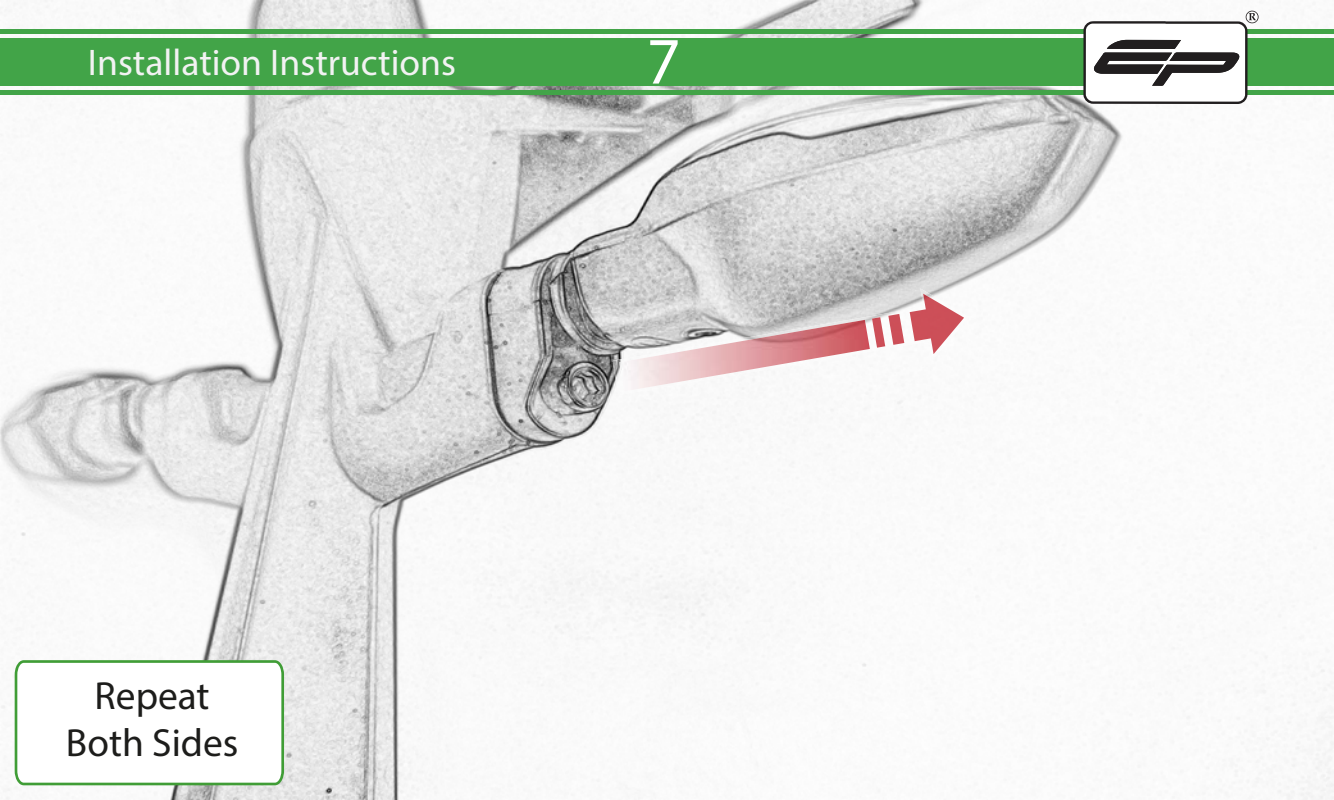

Repeat
Both Sides

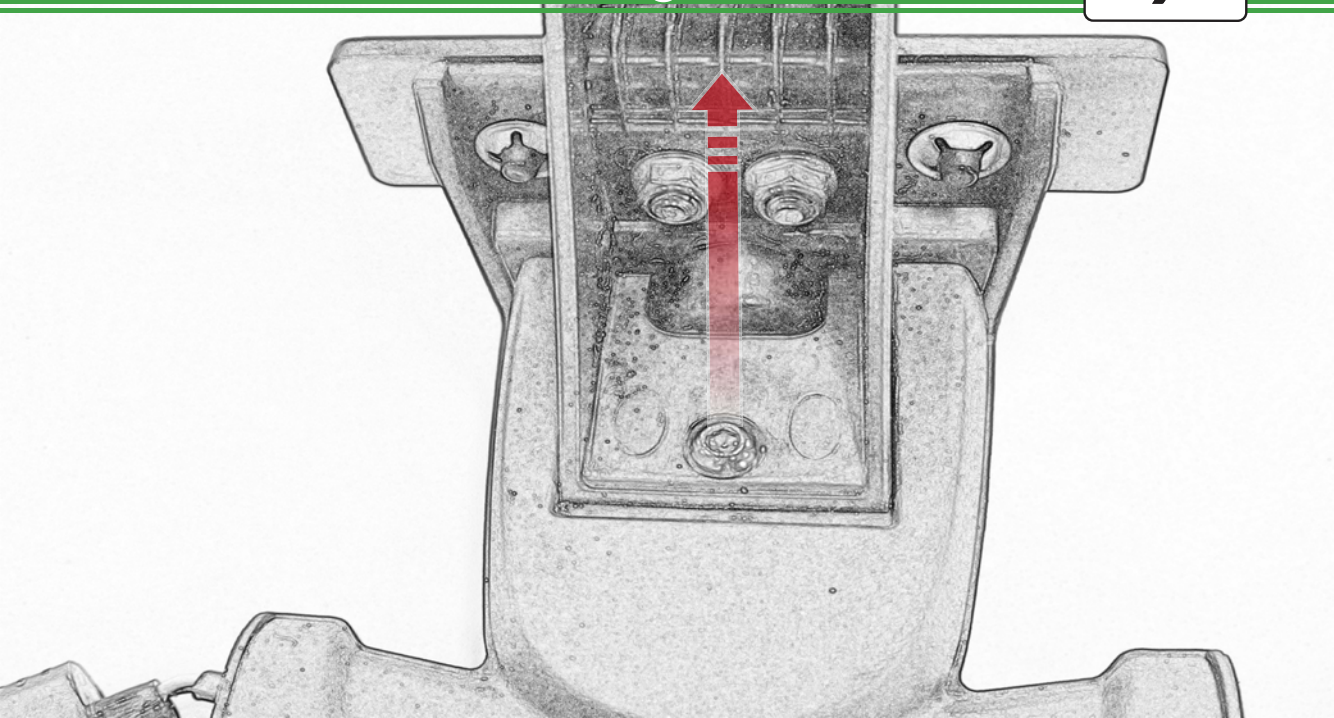

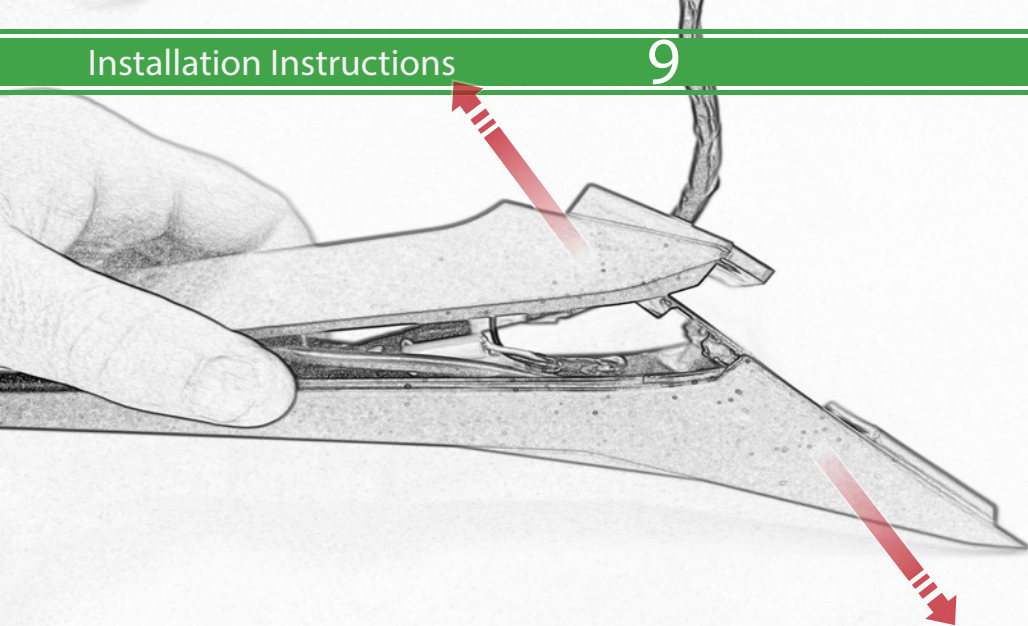

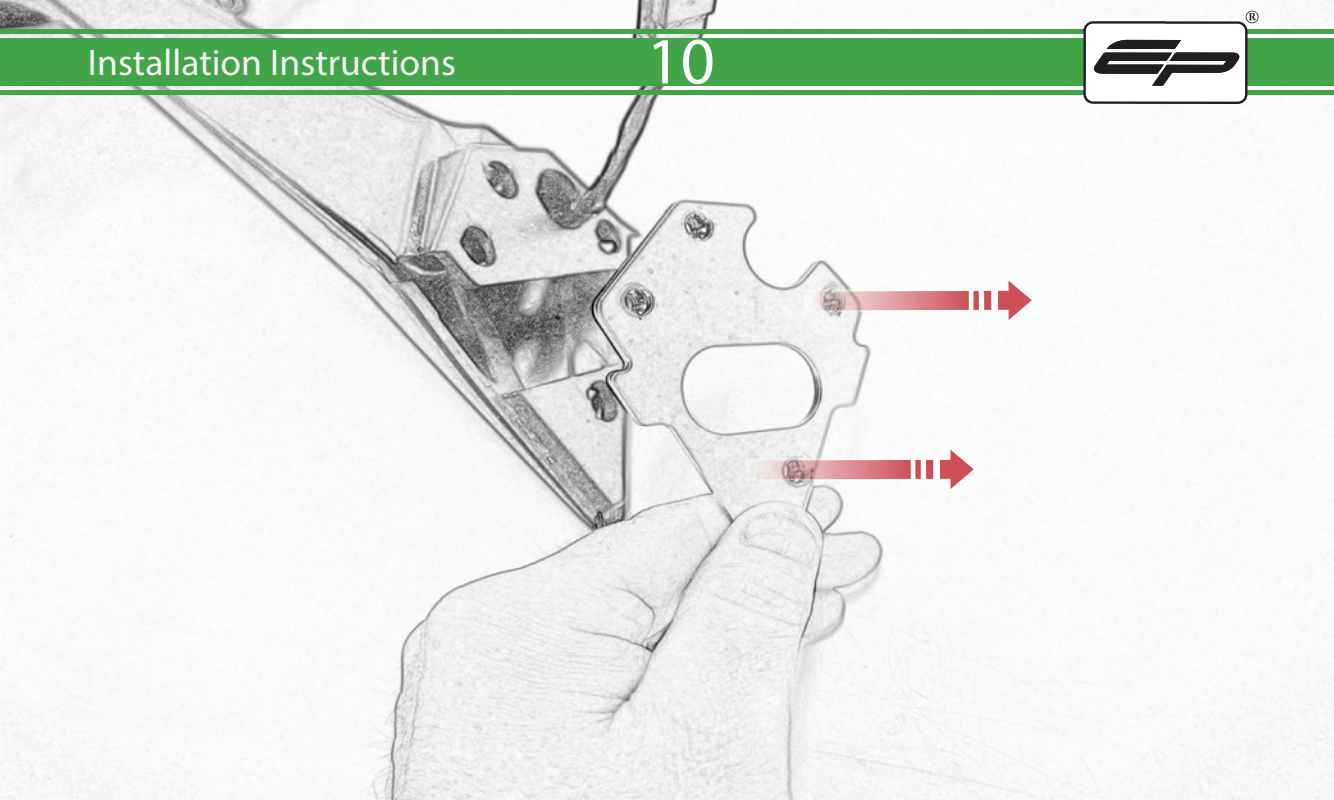

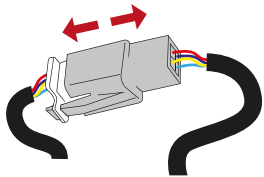
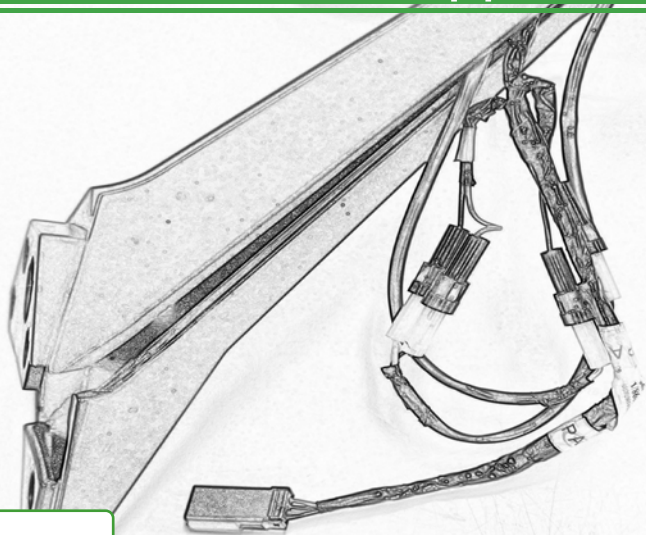

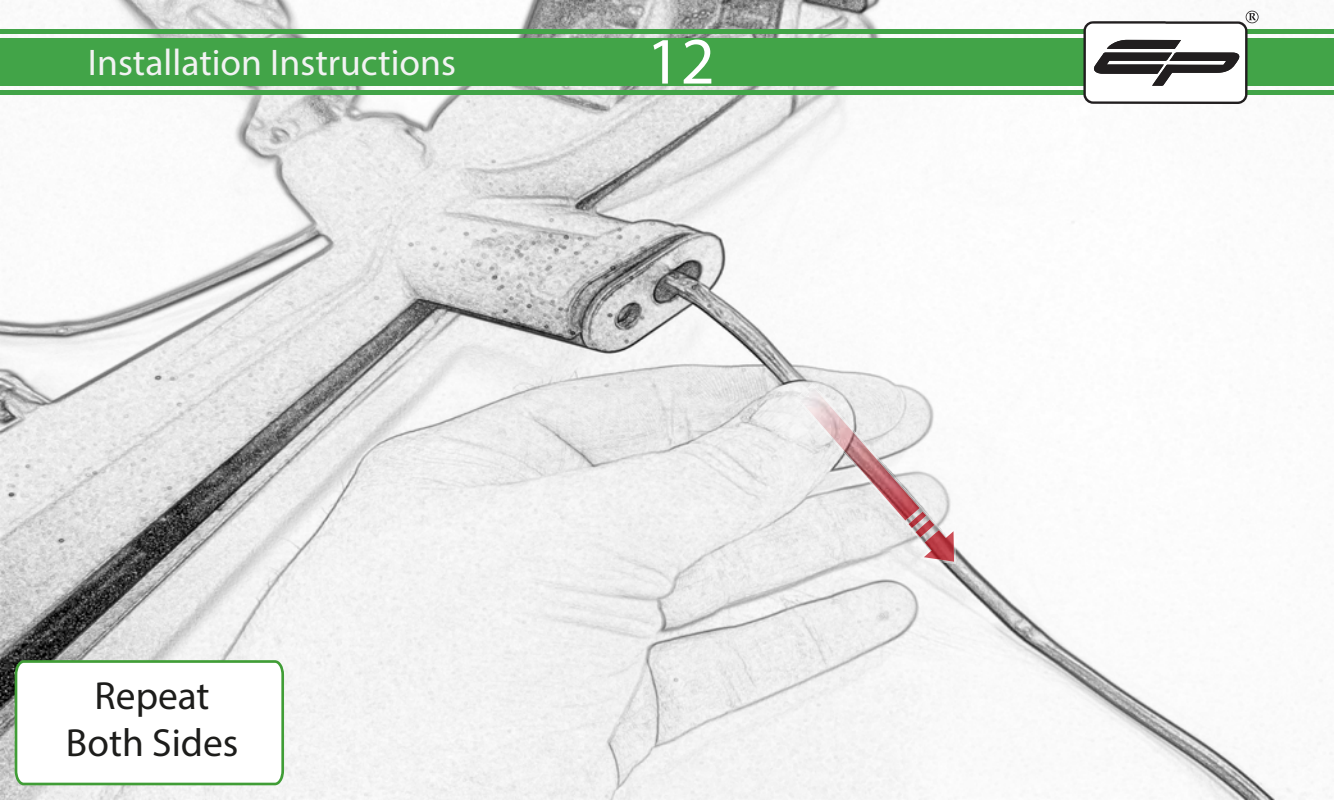

Repeat
Both Sides

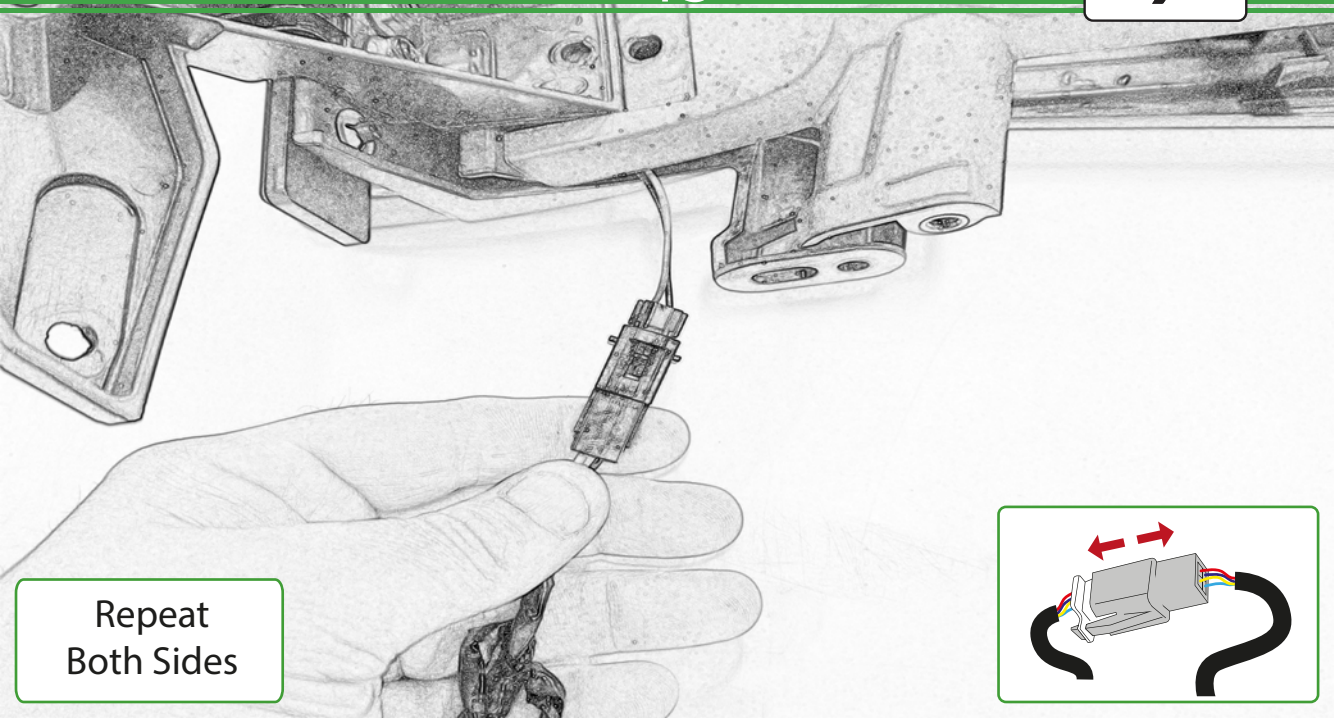

Repeat
Both Sides

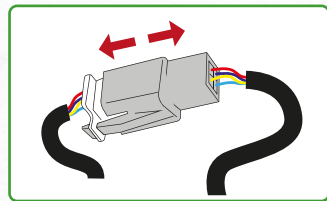

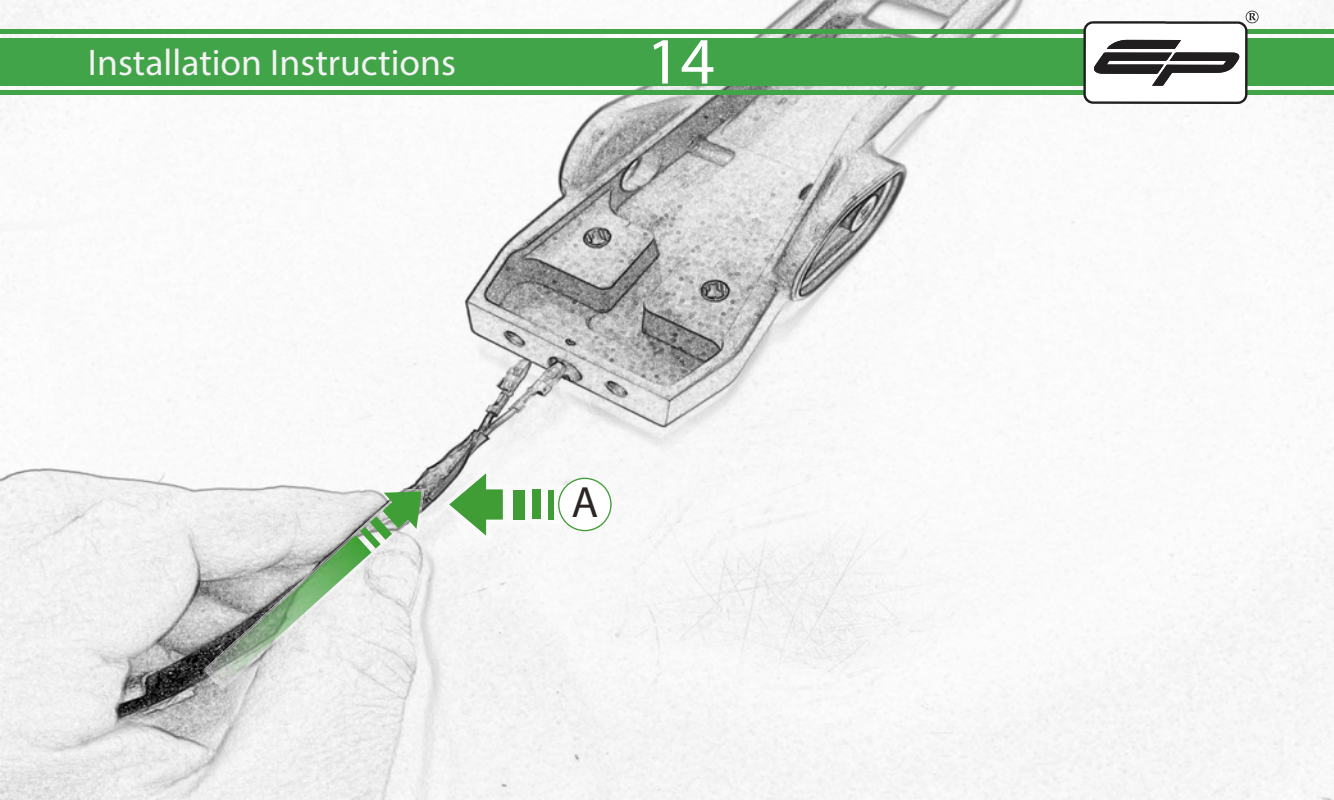

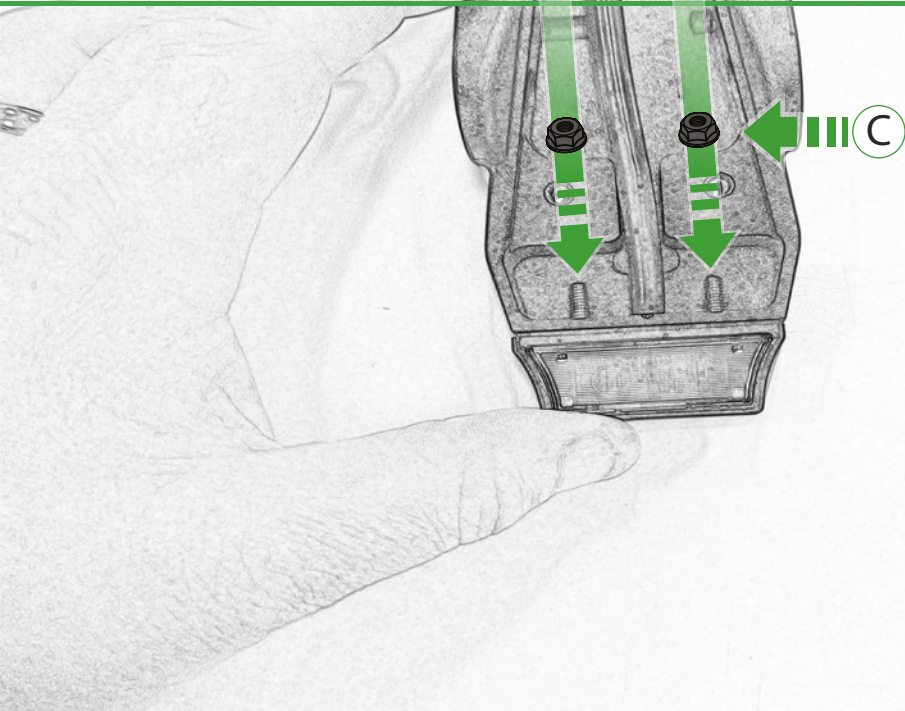

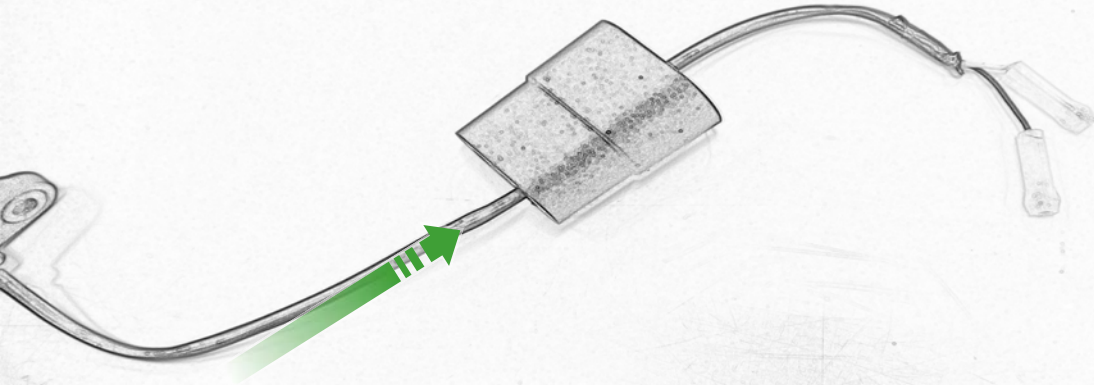

Repeat
Both Sides

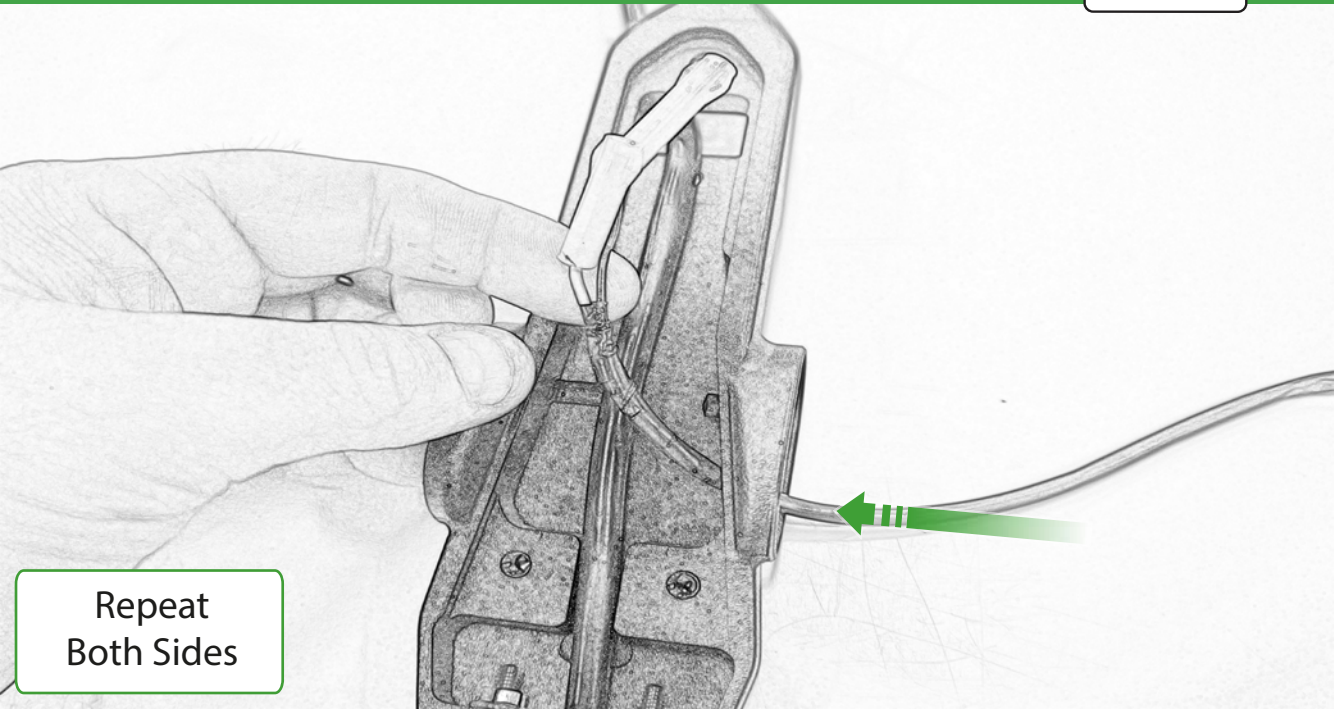

Repeat
Both Sides

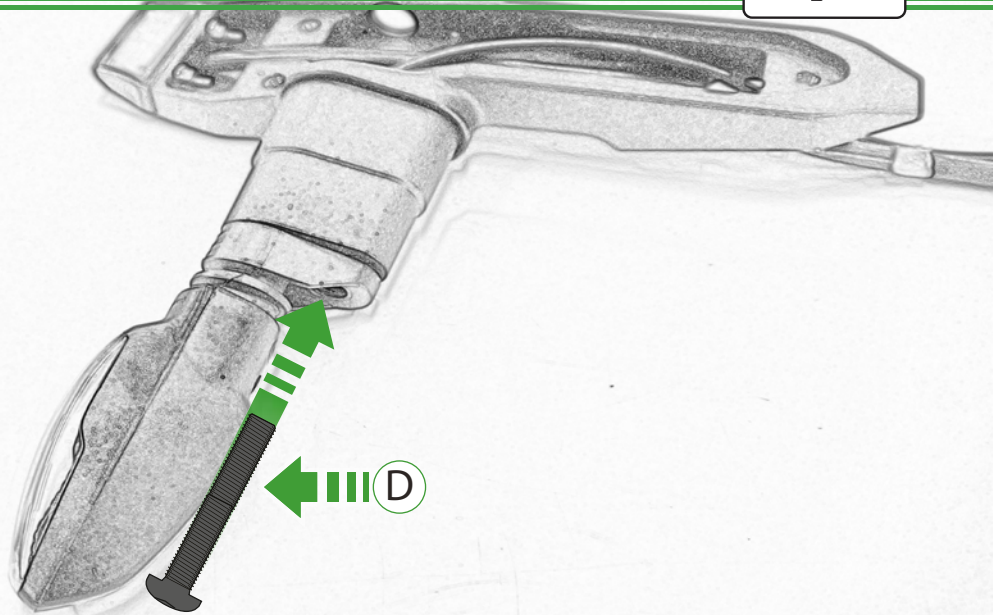

Repeat
Both Sides

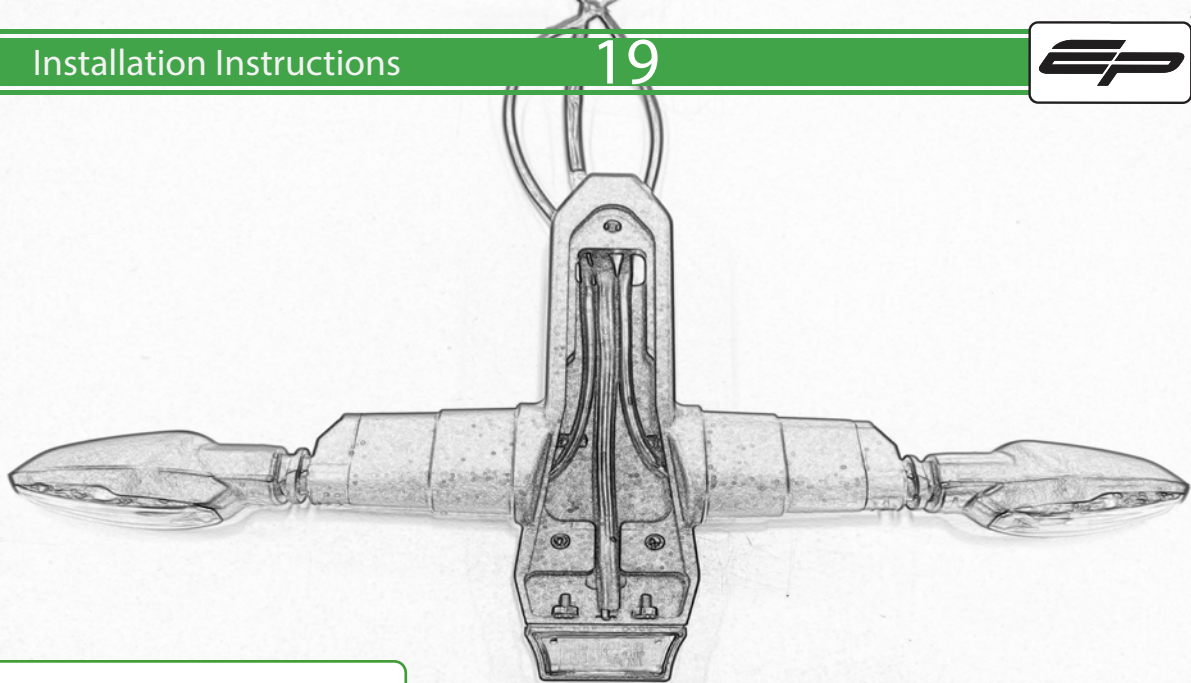

Run wires neatly down the channel in both parts ensuring they do not get trapped or squashed

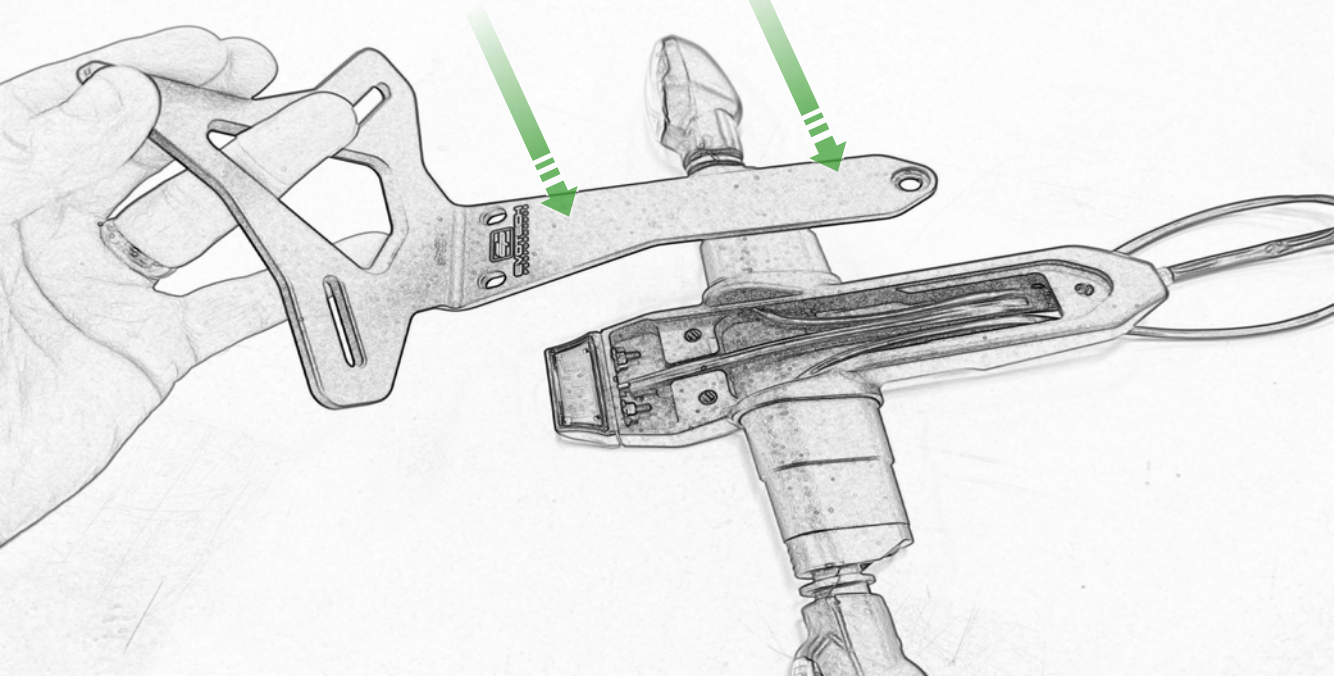

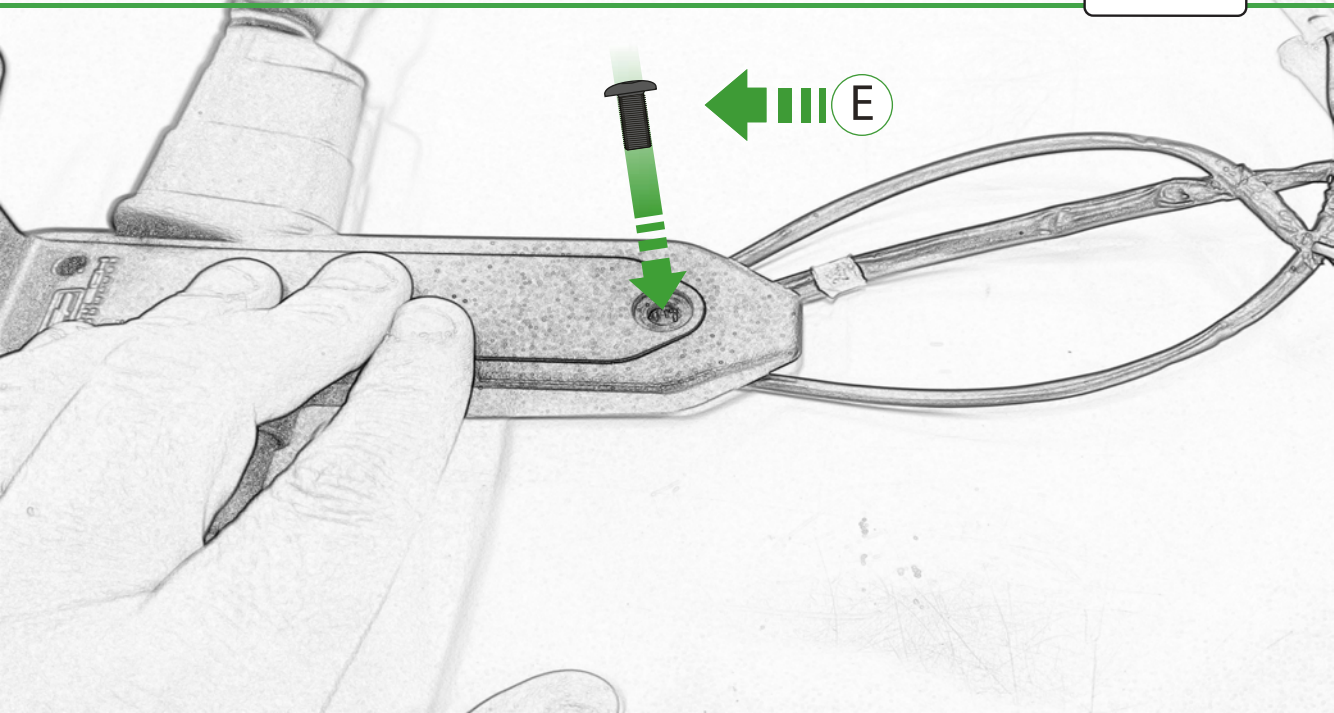

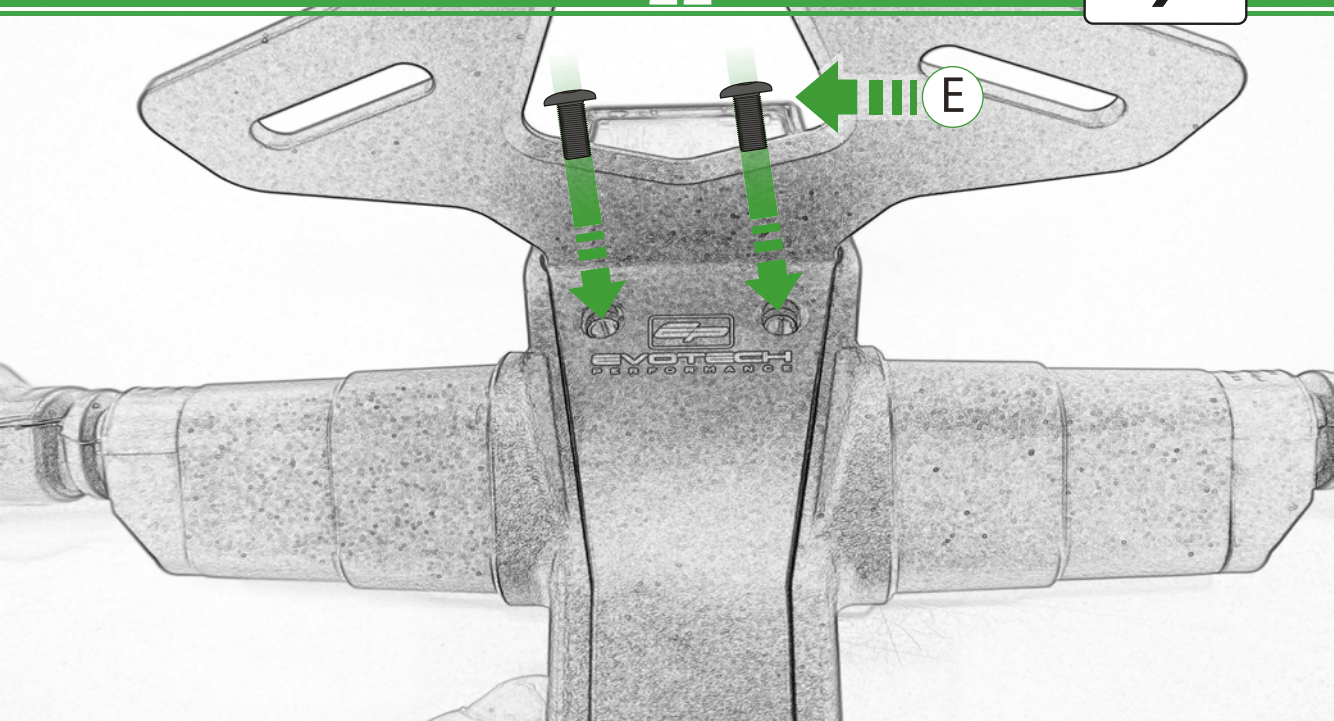

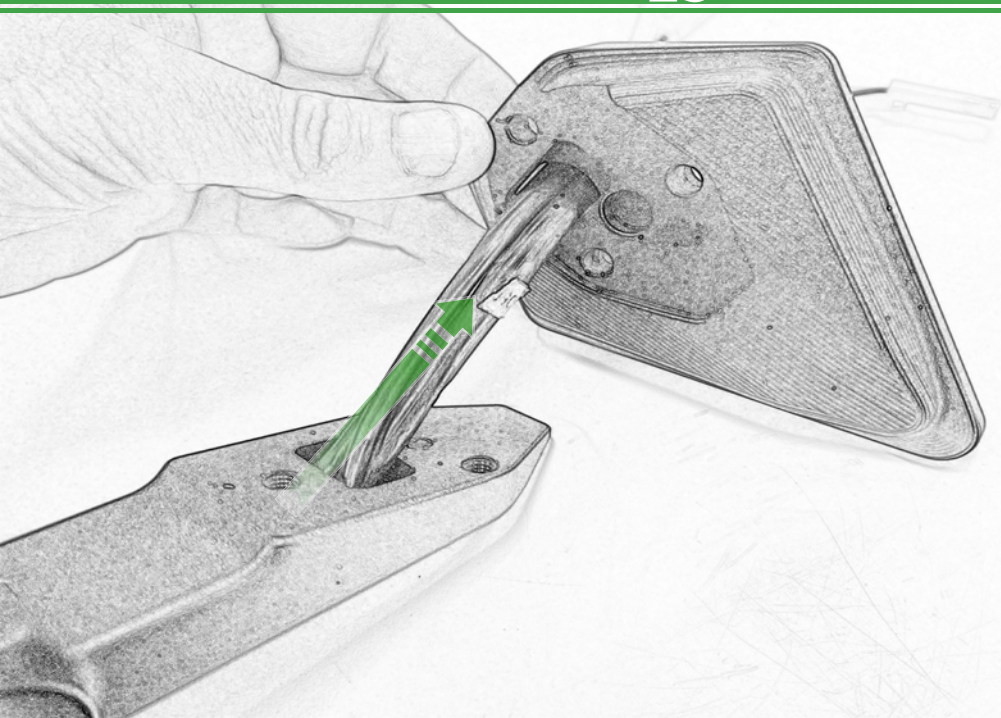

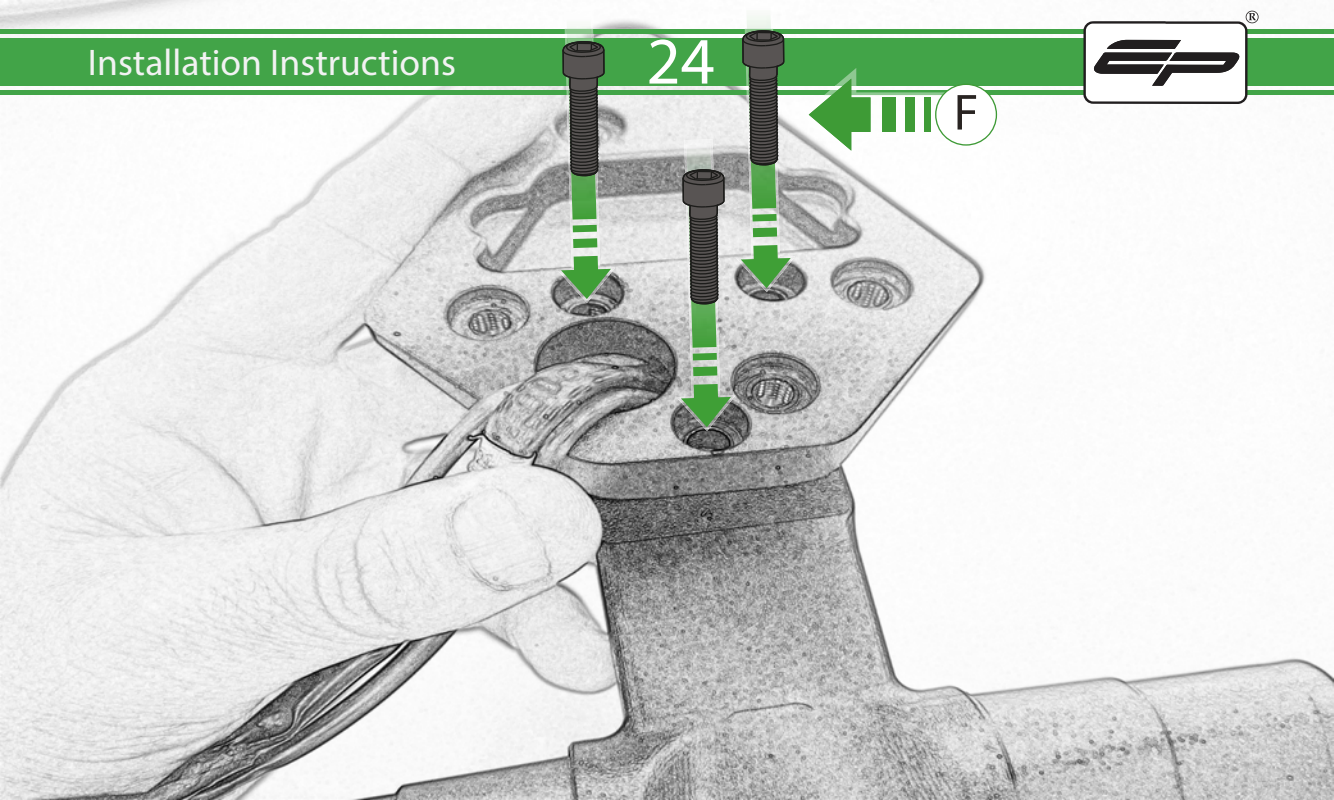

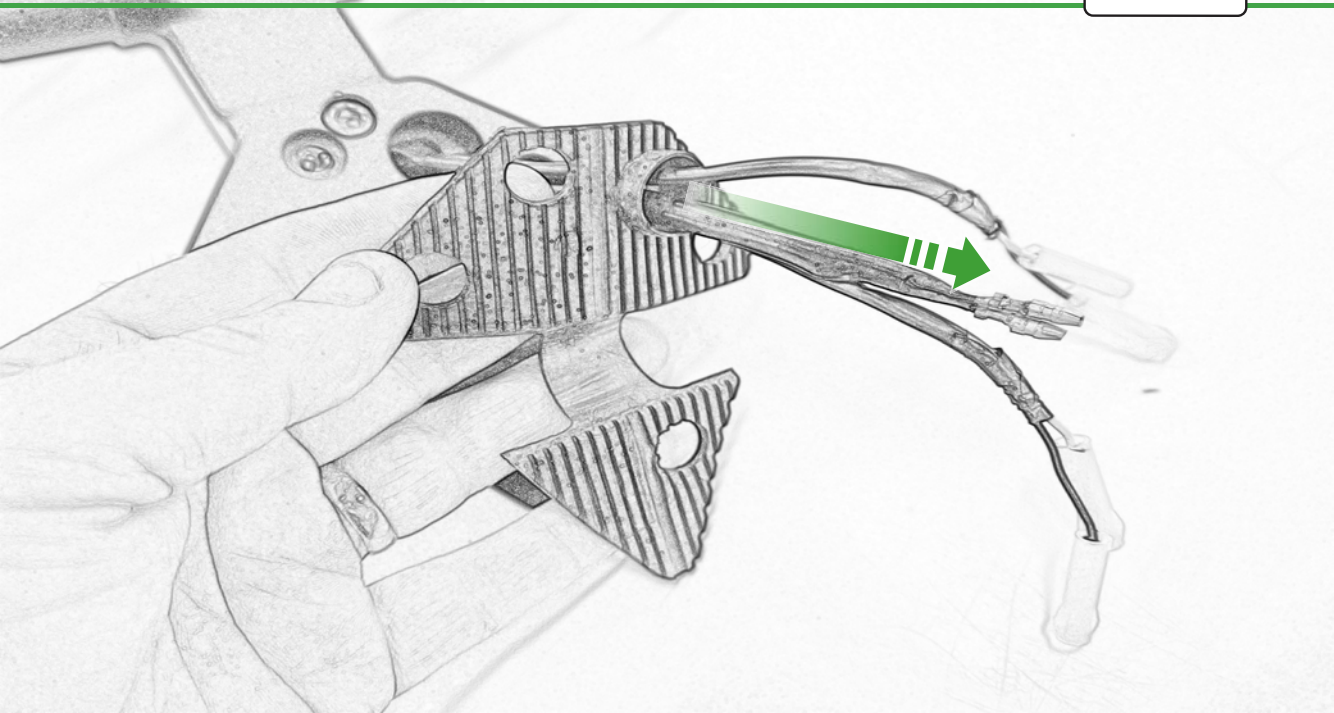

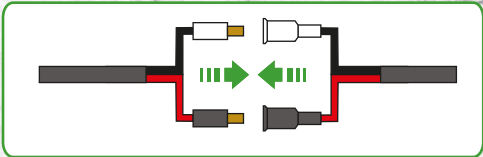
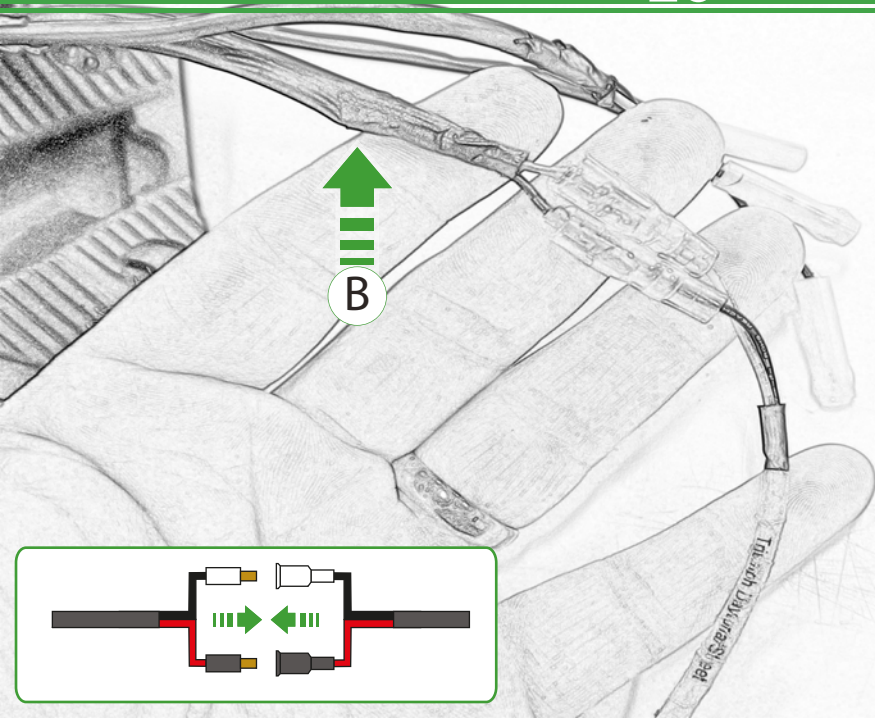

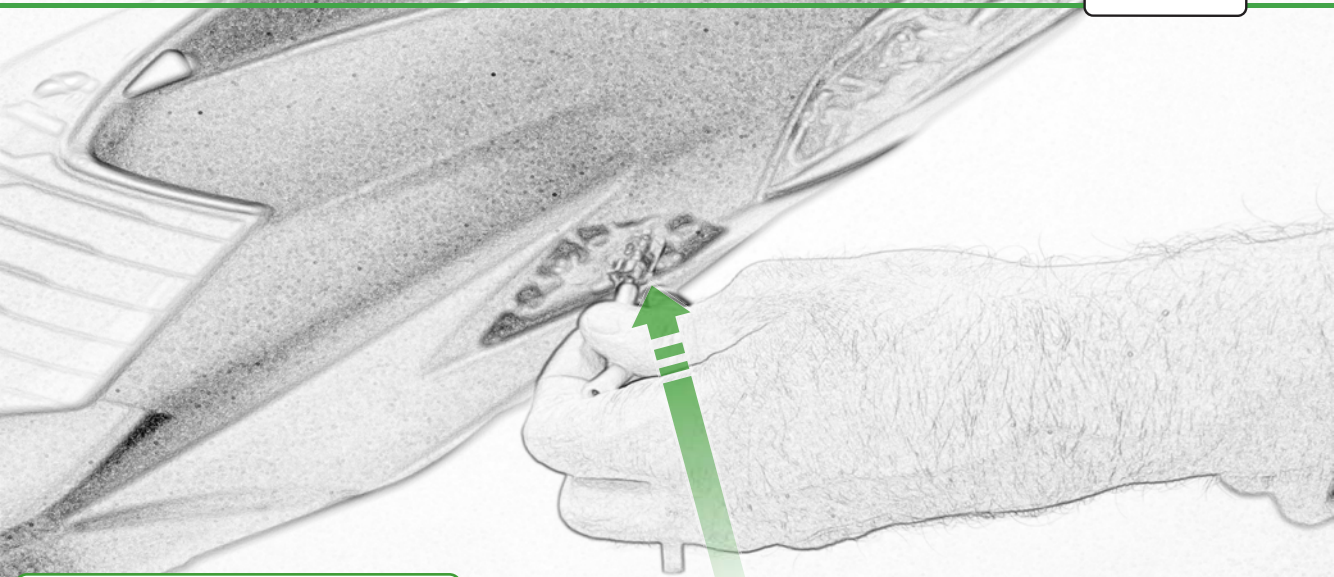

Caution

Feed loom in underseat area ensuring they do not get trapped or squashed

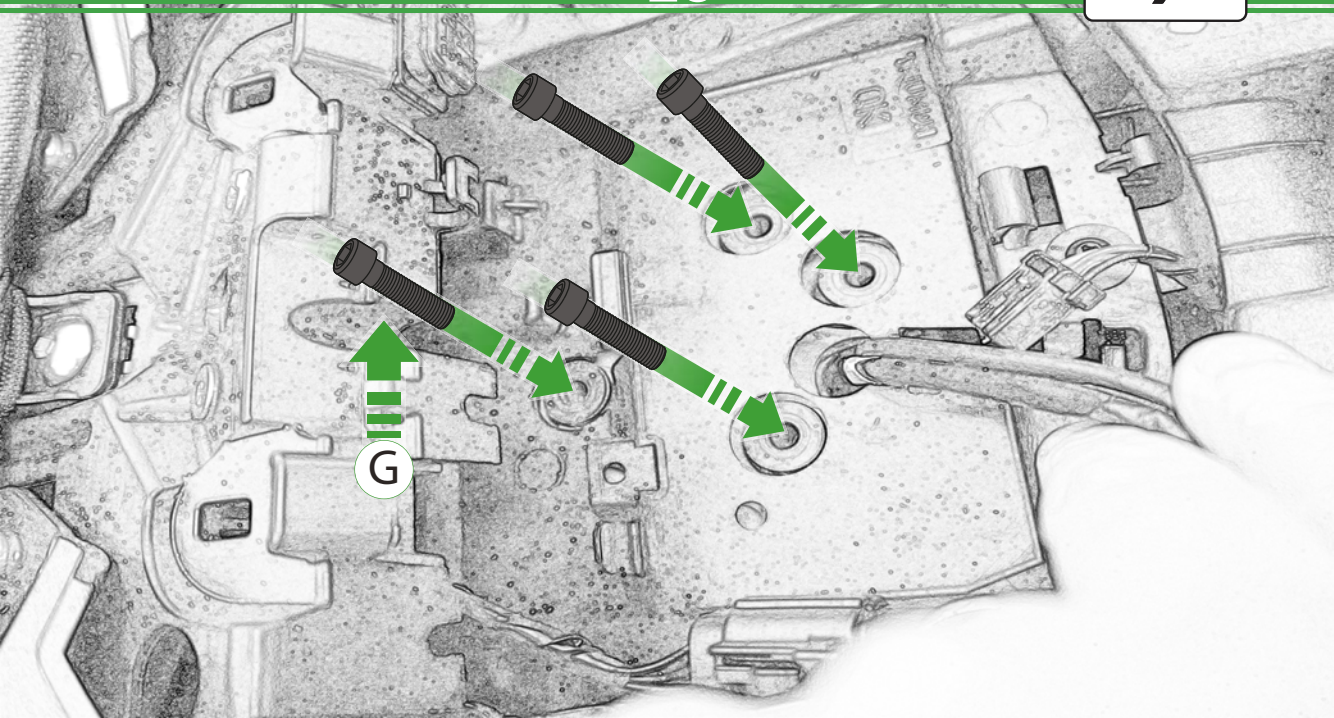

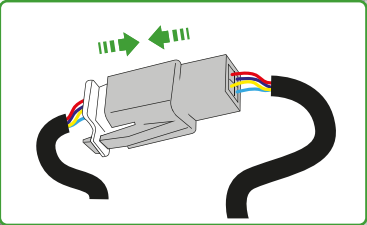
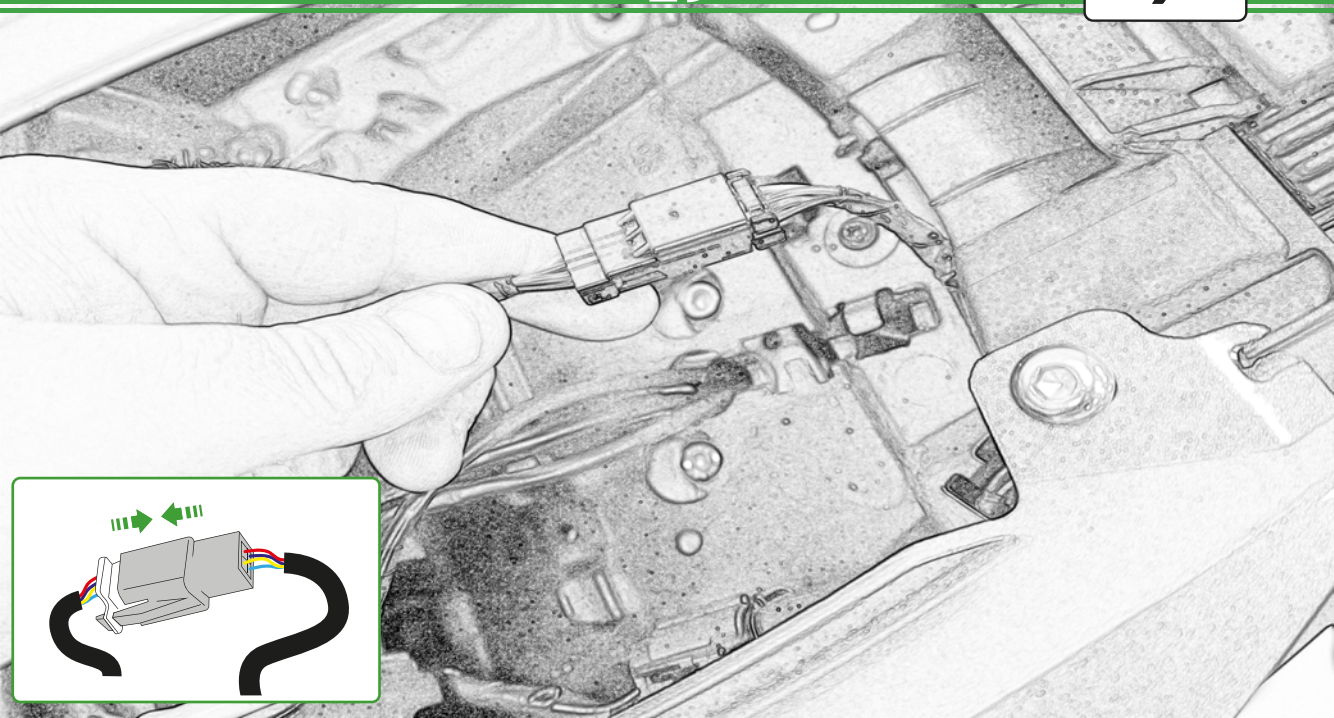

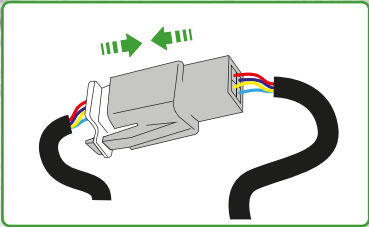
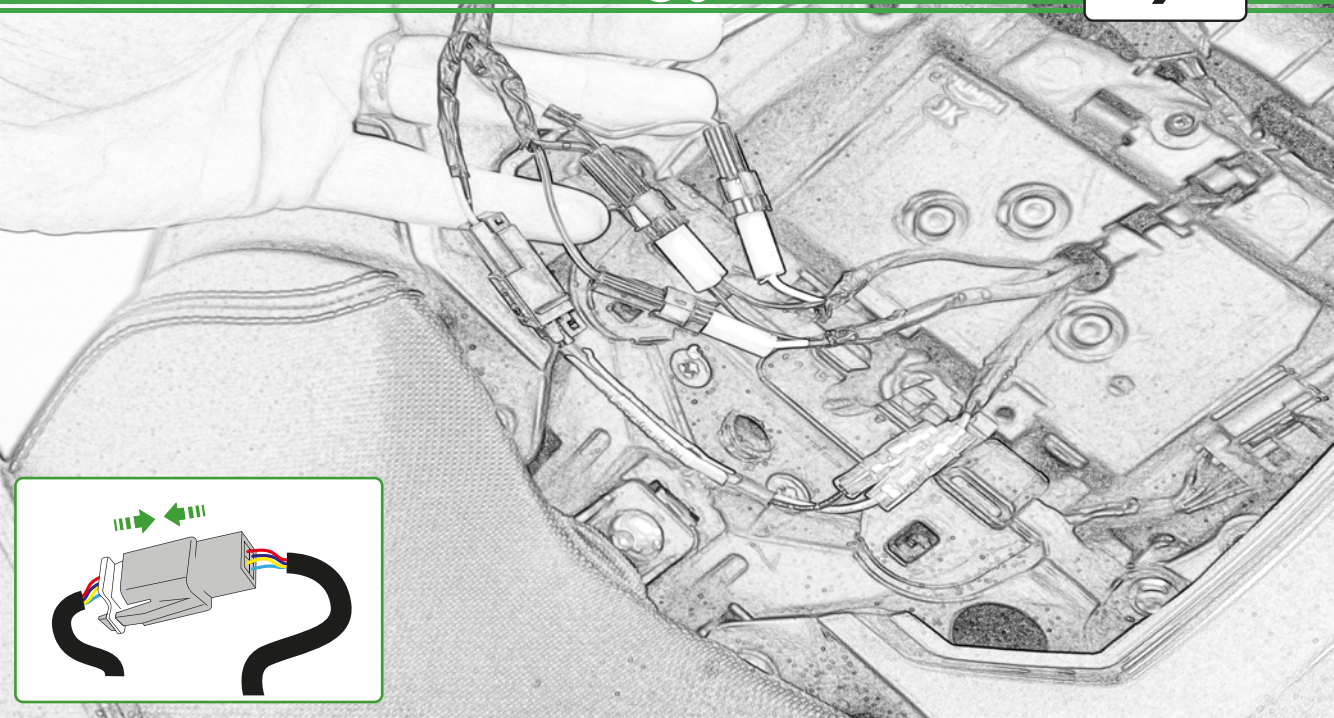

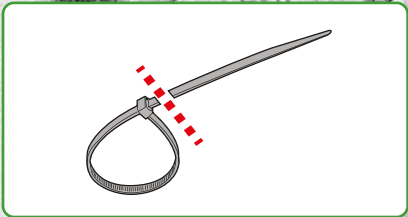
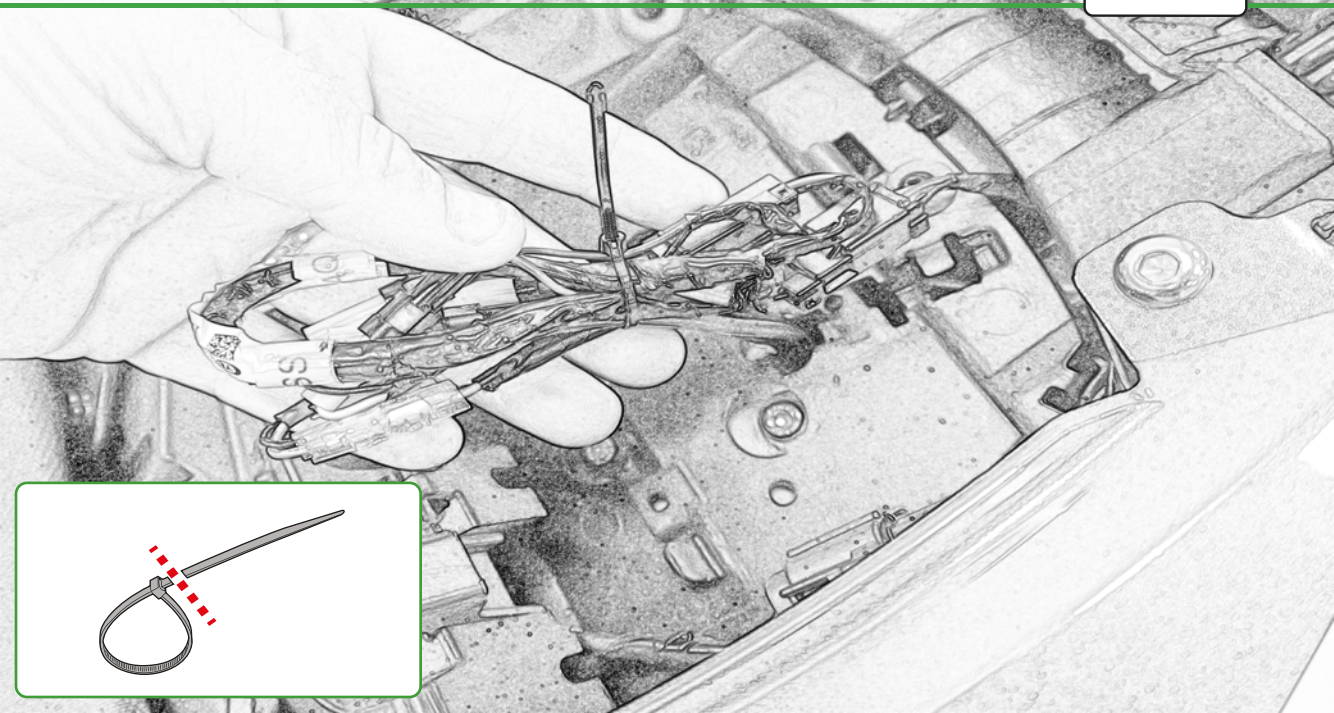



 Reverse Stages
2 - 1

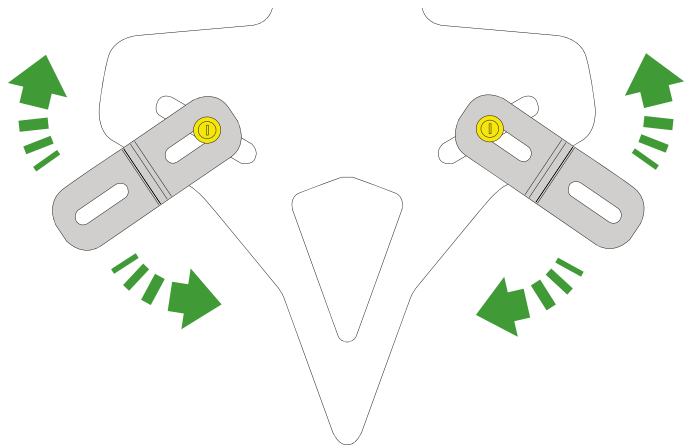

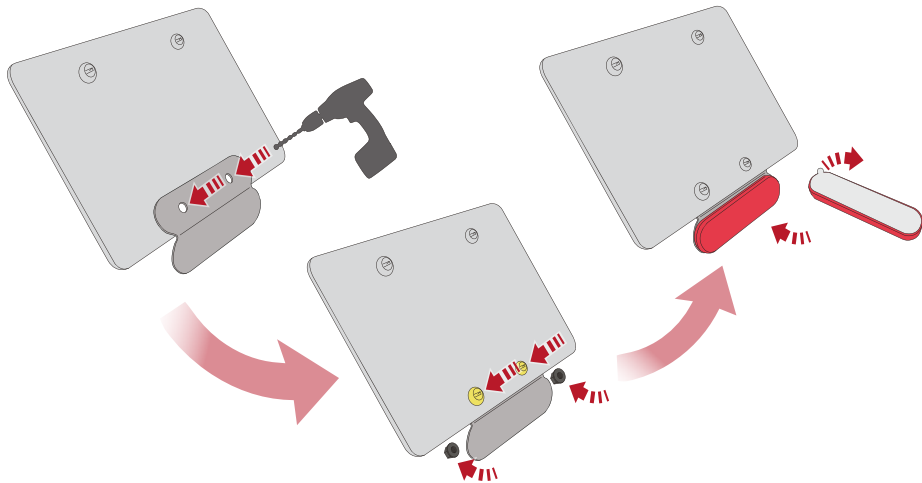



 **ESSENTIAL CHECKS** 

After installation of your tail tidy ensure that the licence plate does not contact the rear tyre when suspension is fully compressed.

Ensure all electrics including indicators, tail light, brake light and licence plate light lights are working correctly before riding the motorcycle.

It is recommended that periodic inspections are made to ensure that all fixings are fully tightend.

