

THIS SHEET INCLUDES FITTING INSTRUCTIONS FOR THE FOLLOWING PARTS:

Secondary Alternator Cover Part No. EC-GSXR600-K6-1-GBR / Secondary Clutch Cover Part No. EC-GSXR600-K6-2-GBR /
 Secondary Starter Cover Part No. EC-GSXR600-K6-2-1-GBR
 Bullet Frame Race Slider Set **K6-K10** - RACE - Part No. FS-GSXR600-K6-R / Bullet Frame Race Slider Set **L1-L6** - RACE - Part No. FS-GSXR600-K11-R
 Paddock Stand / Bobbin Set Part No. BA12-8-GBR-SET / Lower Chain Guard Part No. CGA10-GBR / Lower Chain Guard Part No. CGA08-GBR



SECONDARY ALTERNATOR COVER PART NO. EC-GSXR600-K6-1-GBR

- 1 Remove the Fairing.
- 2 Remove 4 off existing bolts on the stock aluminium Alternator cover, corresponding to the STOCK Secondary Engine Alternator Cover. Shown as bolt positions 1,2,3 & 4.
- 3 Place the Secondary Engine Alternator cover over the stock aluminium alternator cover. Loosely screw down all Bolt using the supplied M6 x 55mm Hex Head Flange replacement bolts.
- 4 Tighten all 4 bolts to a torque of 10 N/m as per manufacturer's recommendations.
DO NOT OVERTIGHTEN
- 5 Refit the fairing.

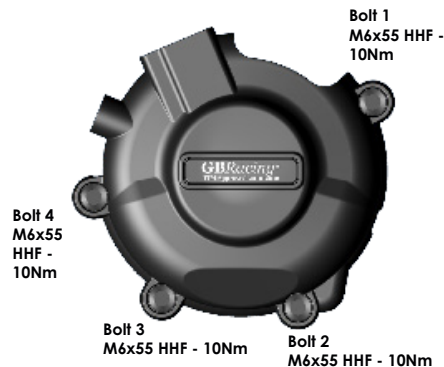
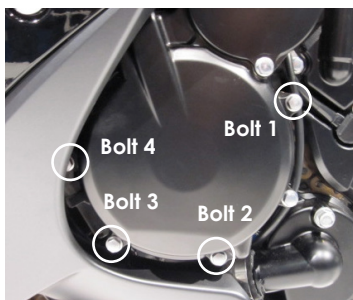

SECONDARY CLUTCH COVER PART NO. EC-GSXR600-K6-2-GBR

- 1 Remove 4 off existing bolts on the stock aluminium Clutch cover, corresponding to the Secondary Engine Clutch Cover. Shown as bolt positions 1,2,3 & 4.
- 2 Place the Secondary Engine Clutch cover over the stock aluminium clutch cover. Loosely screw down all Bolts using the supplied M6 x 35mm Hex Head Flange replacement bolts.
- 3 Tighten all 4 bolts to a torque of 10 N/m as per manufacturer's recommendations.
DO NOT OVERTIGHTEN

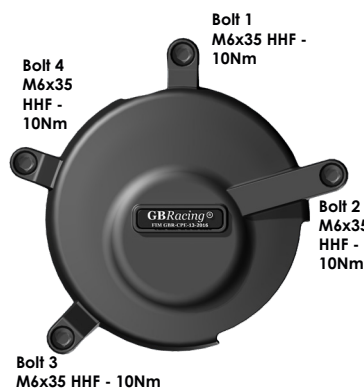
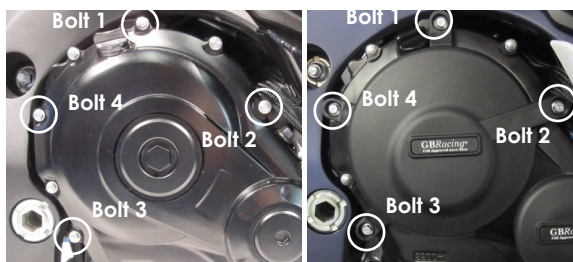

SECONDARY STARTER COVER PART NO. EC-GSXR600-K6-2-1-GBR

- 1 Remove 3 off existing bolts on the stock aluminium Starter cover, corresponding to the Secondary Engine Starter Cover. Shown as bolt positions 1,2 & 3.
Note: Retain the 1 Rubber Washer found at Bolt Position 1.
- 2 Assemble 1 of the supplied M6x35mm Hex Head Flanged Bolts through the Secondary Engine Starter Cover at Bolt Position 1.
Place the retained rubber washer over the threaded end of this bolt.
- 3 Place the Secondary Engine Starter Cover over the stock aluminium starter cover. Loosely screw down Bolt 1, then the remaining Bolts as supplied M6 x 35mm Hex Head Flange bolts.
- 4 Tighten all 4 bolts to a torque of 10 N/m as per manufacturer's recommendations. DO NOT OVERTIGHTEN

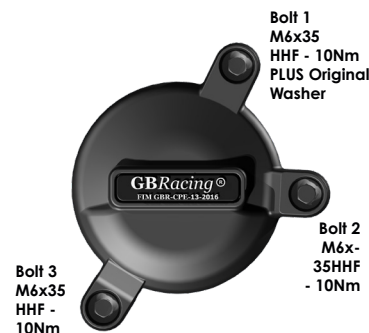

LOWER CHAIN GUARD - PART NO. CGA10-GBR

- 1 Assemble 2 bolts and washers through the lower chain guard into the Black Anodised aluminium mounting block CGA10-2.
- 2 Position the assembly underneath the swing arm, closing the gap to the rear sprocket.
Note : There should be a 5mm minimum gap from the bike chain to the lower chain guard.
- 3 Mark off the chosen hole positions.
- 4 Drill & Tap the marked holes , M6 - (Drill 5mm Dia. for tapping)
- 5 Disassemble the Black Anodised block from the assembly, and mount the block to the underside of the swing arm using the remaining 2 bolts and washers.
- 6 Re-assemble the lower chain guard to the fixed bracket.



LOWER CHAIN GUARD - PART NO. CGA08-GBR

- 1 Position the Lower Chain Guard on to the underside of the swing arm & mark off the hole centres.
Note: There should be a 5mm minimum gap from the bike chain to the Lower Chain Guard. On some models there may be an overhang on the swing arm. It may help to reverse the Lower Chain Guard in order to ease marking the hole centres.
- 2 Drill & Tap 2 off marked holes M6 - (Drill 5mm Dia. for tapping)
- 3 Assemble 2 off M6 washers onto 2 off M6 x 20mm Bolts.
- 4 Line up the Moulded Chain Guard to the Swing Arm & assemble the bolts & washers. Tighten to 10Nm approx.

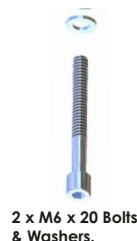

BULLET FRAME SLIDER - LEFT HAND SIDE - RACE - K6-L0
PART NO. FS-GSXR600-K6-LHS-R

NOTE: FAIRING REQUIRES MODIFICATION

- 1 Remove fairing from bike.
- 2 Extend upper engine mount bolt as seen in picture 1.
- 3 Replace fairing and mark bolt position on inside of fairing.
- 4 Remove fairing from bike and drill clearance hole of 22mm as seen in picture 2.
- 5 Remove upper engine mount bolt.
- 6 Replace fairing as seen in picture 3.
- 7 Assemble bolt through the aluminium bush into correct position.
- 8 Tighten to 25NM torque.
- 9 Slide bullet moulding onto aluminium bush.
- 10 Screw M6 bolt into front of bullet moulding hand tight.

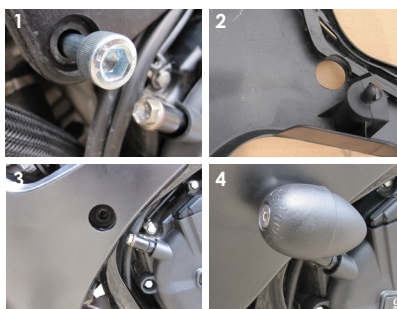

BULLET FRAME SLIDER - RIGHT RIGHT SIDE - RACE - K6-L0
PART NO. FS-GSXR600-K6-RHS-R

- 1 Remove upper engine mounting bolt, located through the fairing opening.
- 2 Assemble bolt through the aluminium bush into correct position.
- 3 Tighten to 25NM torque.
- 4 Slide bullet moulding onto aluminium bush.
- 5 Screw M6 bolt into front of bullet moulding hand tight.

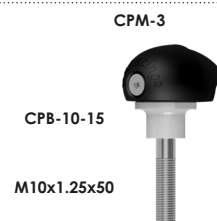

BULLET FRAME SLIDER SET - RACE - L1-L9
PART NO. FS-GSXR600-K11-R

NOTE: ON L2 MODEL THE RIGHT HAND SIDE REQUIRES FAIRING MODIFICATION

- 1 Remove fairing from bike.
- 2 Extend upper engine mount bolt as seen in picture 1.
- 3 Replace fairing and mark bolt position on inside of fairing.
- 4 Remove fairing from bike and drill clearance hole of 22mm as seen in picture 2.
- 5 Remove upper engine mount bolt.
- 6 Replace fairing as seen in picture 3.
- 7 Assemble bolt through the aluminium bush into correct position.
- 8 Tighten to 25NM torque.
- 9 Slide bullet moulding onto aluminium bush.
- 10 Screw M6 bolt into front of bullet moulding hand tight.

LEFT HAND SIDE:



RIGHT HAND SIDE:

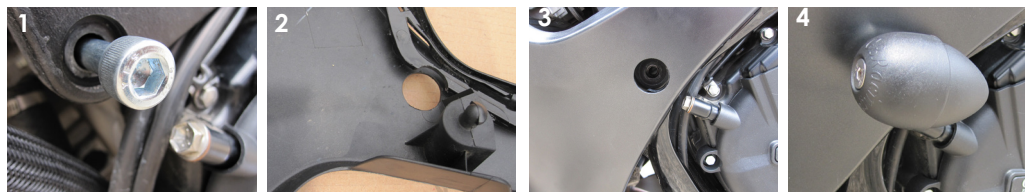

PADDOCK STAND / BOBBIN SET
PART NO. BA12-8-GBR-SET

- 1 Assemble M8 x 40mm Bolt through the moulded bobbin.
- 2 Tighten bolts to swing arm boss, 8 Nm.
 DO NOT OVERTIGHTEN



1 x Moulded Paddock Stand / Bobbin

SETS & BUNDLES

Protection Bundle: CP-GSXR600-K6-CS-GBR

EC-GSXR600-K6-1-GBR, EC-GSXR600-2-1-GBR, EC-GSXR600-K6-2-GBR, BA12-8-GBR-SET, CGA10-GBR

Engine Cover Set: EC-GSXR600-K6-SET-GBR

EC-GSXR600-K6-1-GBR, EC-GSXR600-2-1-GBR, EC-GSXR600-K6-2-GBR

Frame Slider Set K6-K10: FS-GSXR600-K6-R:

FS-GSXR600-K6-LHS-R, FS-GSXR600-K6-RHS-R

Frame Slider Set L1-L6: FS-GSXR600-K11-R (Parts only available as a SET)