



**EVOTECH**®  
P E R F O R M A N C E

## Installation Instructions

## DUCATI MONSTER 1200 and 821 - 2014 ONWARDS CRASH PROTECTION

**Product Reference - 11676**

### Kit Contents

- |   |  |
|---|--|
| <b>A</b> 1 x RH Arm                         | <b>H</b> 2 x Bobbin Heads                    |
| <b>B</b> 1 x RH Front Frame Spacer (25mm)   | <b>I</b> 2 x Bobbin Spacers                  |
| <b>C</b> 1 x RH Rear Frame Spacer (59mm)    | <b>J</b> 2 x M12 - 110 x 1.25 Cap Head Bolts |
| <b>D</b> 1 x LH Arm                         | <b>K</b> 2 x Impact Absorbing Washers        |
| <b>E</b> 1 x LH Front Frame Spacer (61mm)   | <b>L</b> 2 x M12 Washers                     |
| <b>F</b> 1 x LH Rear Frame Spacer (52mm)    | <b>M</b> 3 x M12 - 130 x 1.25 Cap Head Bolts |
| <b>G</b> 1 x M12 - 100 x 1.25 Cap Head Bolt |  |

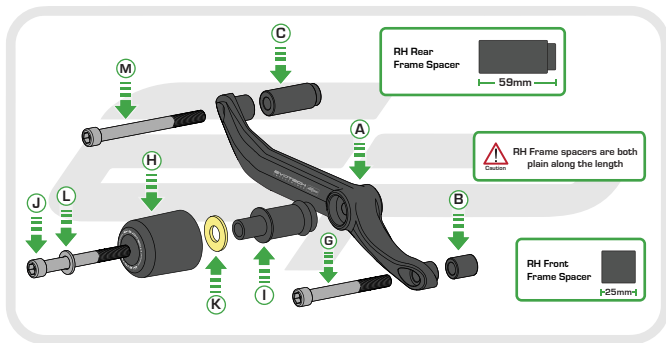

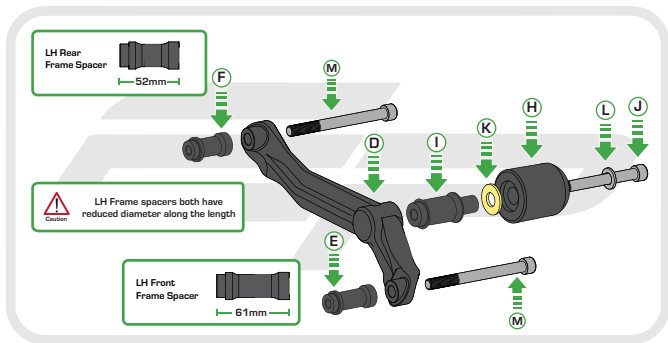

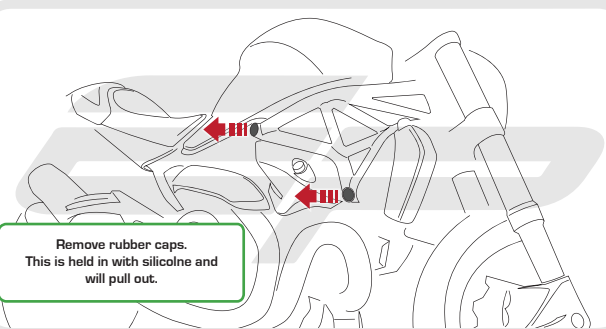

A line drawing of a car's front end, focusing on the headlights and grille area. Two red arrows point to black circular rubber caps on the front of the headlights. A green-bordered text box is overlaid on the bottom left of the diagram.

**Remove rubber caps.**  
This is held in with silicone and  
will pull out.



Only remove one engine bolt  
from one side at a time

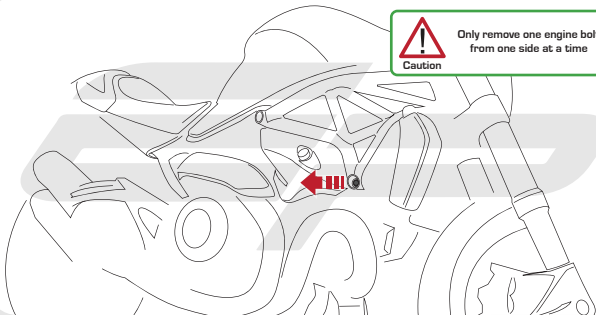



Caution

DO NOT fully tighten at this stage.  
the bracket needs to be able  
to pivot into place

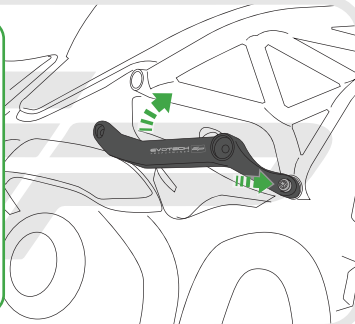
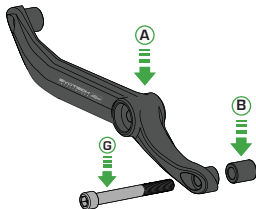



Only remove one engine bolt  
from one side at a time

**EVOTECH**<sup>®</sup>  
P E R F O R M A N C E





Caution

Pivot bracket up into place  
and insert spacers and bolt

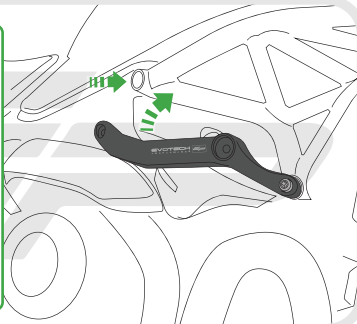
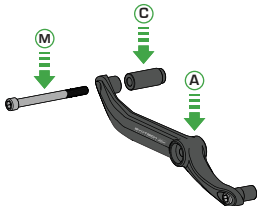

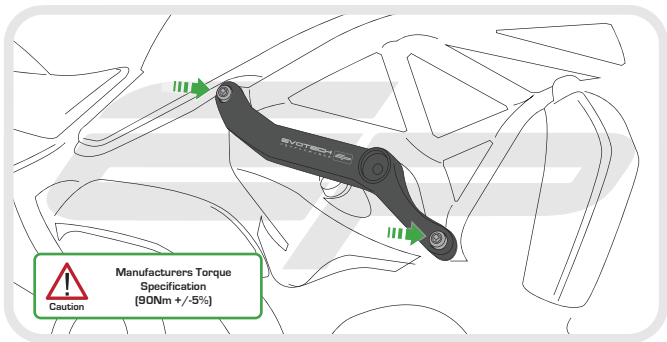

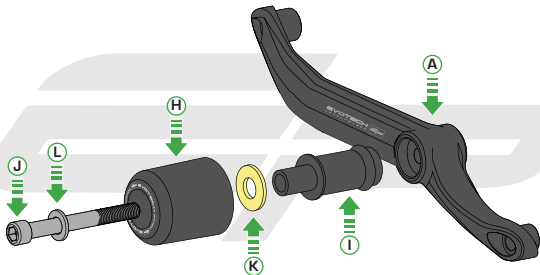



**Remove rubber caps.**  
This is held in with silicone and  
will pull out.

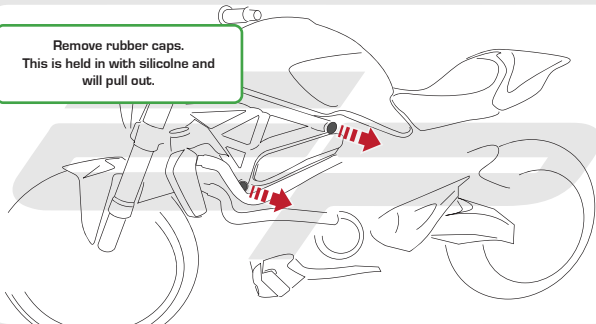



Caution

Only remove one engine bolt  
from one side at a time

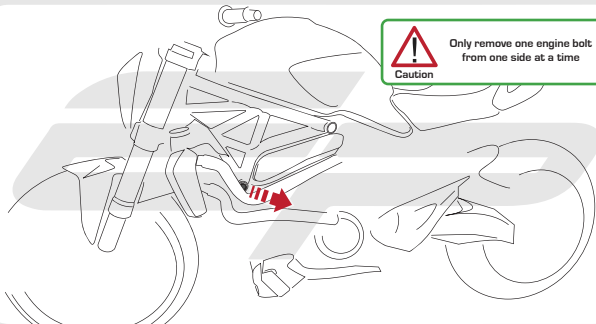

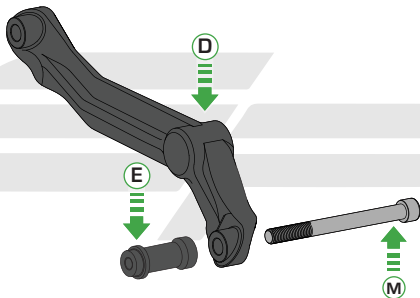

**EVOTECH**<sup>®</sup>  
P E R F O R M A N C E

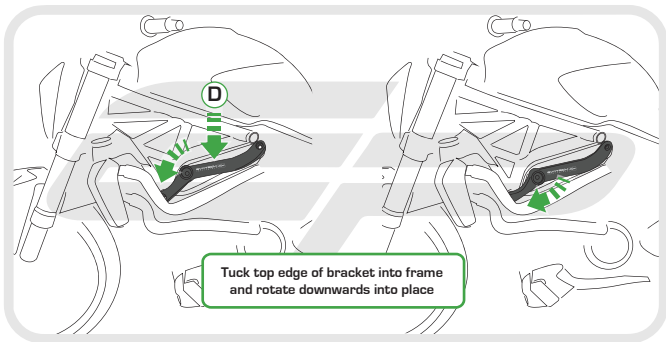



Caution

DO NOT fully tighten at this stage.  
the bracket needs to be able  
to pivot into place



M



Caution

Carefully pull radiator hose down  
enough to get the bolt in



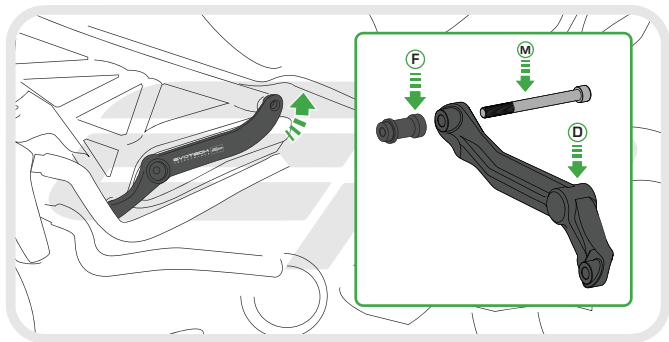



Manufacturers Torque  
Specification  
(90Nm +/-5%)

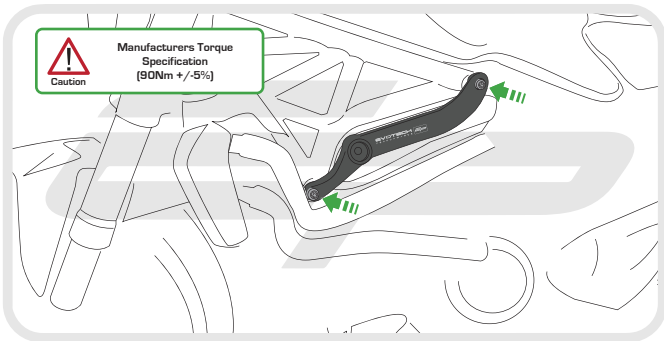

**EVOTECH**<sup>®</sup>  
P E R F O R M A N C E

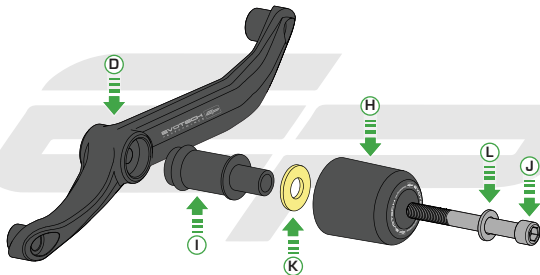



### ESSENTIAL CHECKS



It is recommended that periodic inspections are made to ensure that all bolts are tightened to the specified torque settings.

Should the bike be involved in an accident a thorough inspection should be made and any components that have taken an impact, no matter how small, be replaced



**EVOTECH**®  
P E R F O R M A N C E

[www.evotech-performance.com](http://www.evotech-performance.com)