

Thank you for purchasing a National Cycle product. Read these instructions carefully and thoroughly before beginning work. Dealers, if installing this windshield for a customer, please give them this manual upon completion. It contains information needed to properly maintain and use this product.

Description:	VStream+® Windscreen	Model:	2019-Current Honda® CB500F
Part Number:	N20073/N20074/N20075	Installation Time:	20 min. Difficulty Level: Easy

**PACKAGE CONTENTS**

ITEM	PART NO.	DESCRIPTION	QTY.
A		VStream+ Windscreen	1
B	37-374504-000	Mount Bracket, Left	1
C	37-374505-000	Mount Bracket, Right	1

**BAG#1130**

D	44-447304-000	Grommet	4
E	34-346037-000	Cap, Aluminum, Black	4
F	51-514212-000	Screw, Flat, M6x12	4
G	51-515749-000	Screw, Hex, M8x1.25	4
H	49-490317-000	Washer, Flat	4

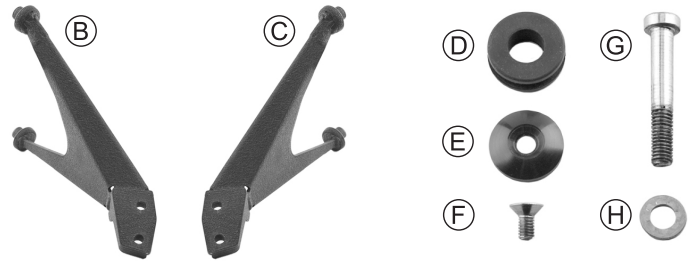

**TOOLS REQUIRED**

4mm, 5mm, 6mm Hex Wrenches      Torque Wrench  
5mm Hex Socket                      Medium Strength Thread Lock (Loctite® 243)



**ATTENTION:** Special notes and cautionary measures which can prevent damage to the accessory or vehicle.



**NOTE:** Tips for facilitation of operation, control and adjustment, as well as maintenance work.

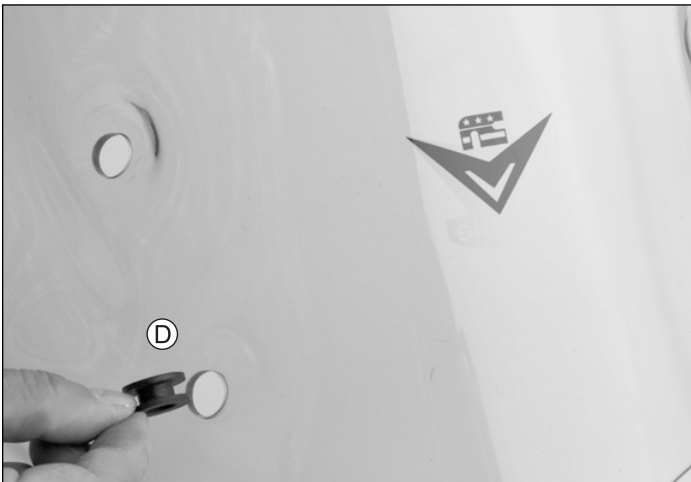

Figure 1

**PREPARATION**

Place motorcycle securely on its sidestand.

**INSTALLATION**

**Figure 1**

Install one Grommet (D) into each of the four holes on the windscreen.



Cover your motorcycle's gas tank with a blanket or tarp to prevent possible scratches during installation.

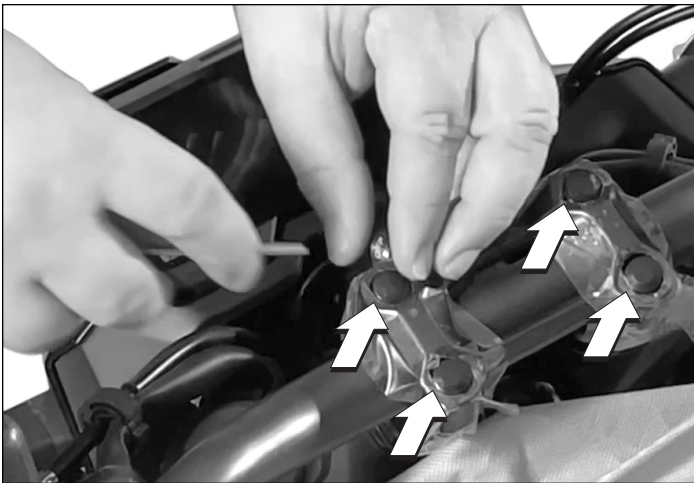

Figure 2

## INSTALLATION; CONT'D

### Figure 2

Starting on the left side, remove the stock rubber mounting bolt covers with a Small Screwdriver.



Work on one side of the bar clamp at a time to prevent handlebars from rotating out of position.



Stock hardware will not be re-used.

### Figure 3

Use a 6mm Hex Wrench to remove the stock bolts from the left handlebar clamp.

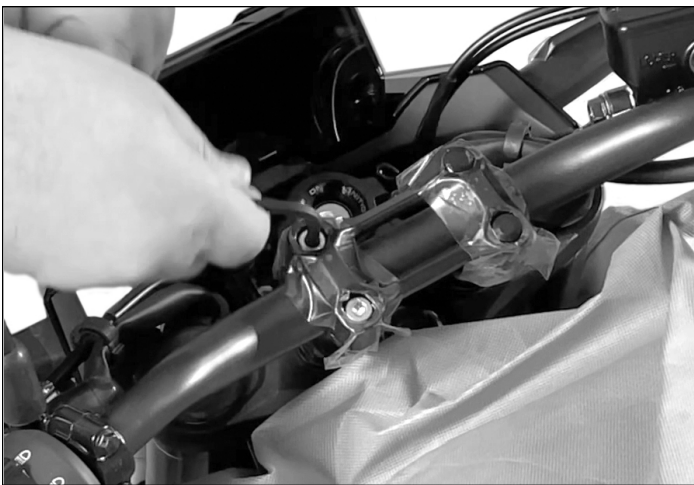

Figure 3

### Figure 4

Apply a small amount of thread locker on two M8 Screws (G).

Use two Flat Washers (H) and two M8 Screw (G) to install the Left Mount Bracket (B) onto left side handlebar clamp with a 5mm Hex Wrench.

### Figure 5

Remove the stock handlebar clamp bolts from the RIGHT side.

Apply a small amount of thread locker on the remaining two M8 Screws (G).

Use the remaining two Flat Washers (H) and M8 Screws (G) to install Right Mount Bracket (C) onto right side handlebar clamp with a 5mm Hex Wrench.

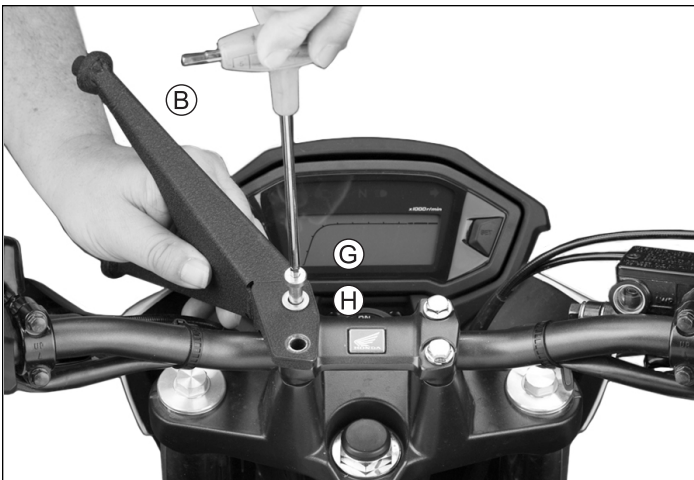

Figure 4

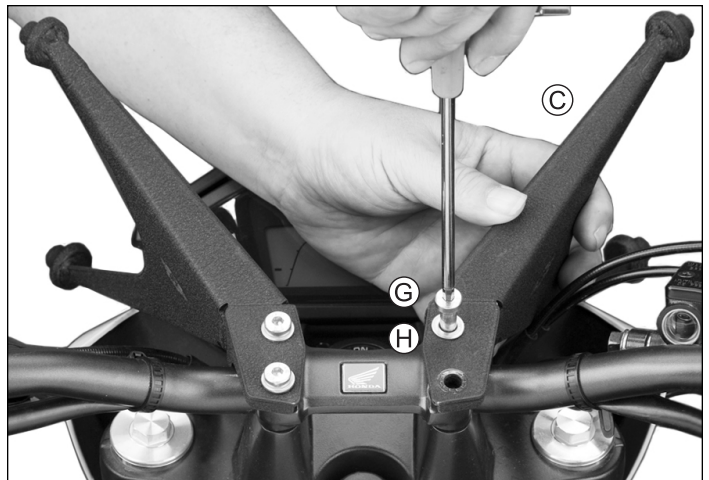

Figure 5

## INSTALLATION; CONT'D

### Figure 6

Torque the four M8 Screws (G) to 18 ft-lbs (24 Nm) with a Torque Wrench and a 5mm Allen Key Socket.

### Figure 7

Position the VStream+ Windscreen (A) onto the end studs of the Left and Right Mount Brackets. Press firmly until the studs are flush with the outside surface of the Grommets (D).

### Figure 8-9

Use an M6 Flat Screw (F) and Aluminum Cap (E) to attach windscreen to the Mount Brackets with a 4mm Hex Wrench. Repeat procedure at all four holes. Tighten Screws firmly.

***Your VStream+® Windscreen installation is now complete.  
Enjoy the ride!***



Figure 6

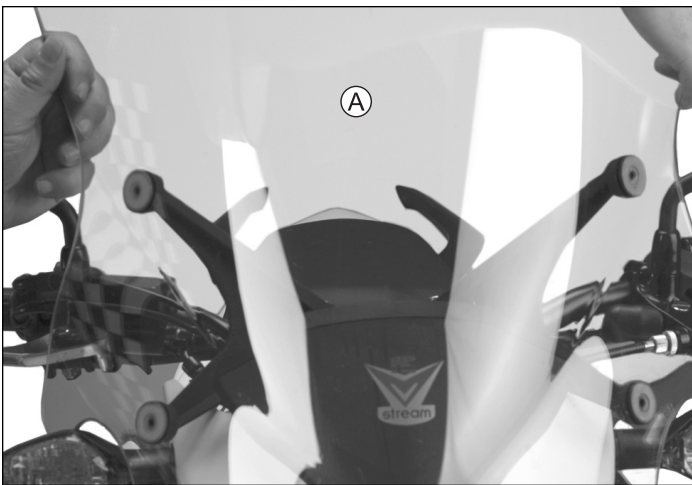

Figure 7

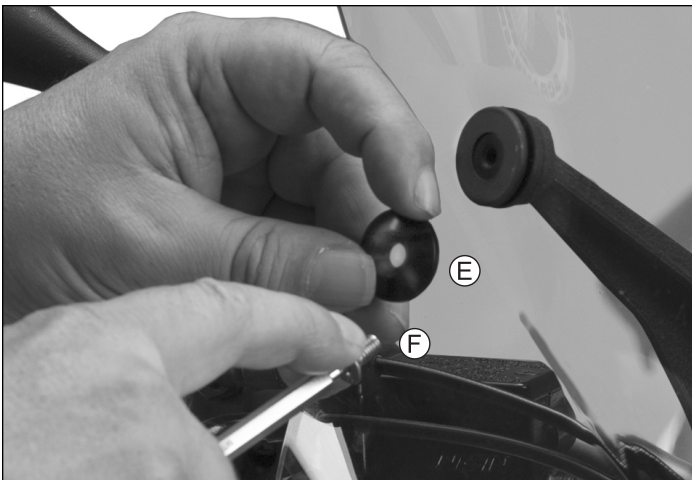

Figure 8



Figure 9



## CLEANING AND MAINTENANCE

To clean the screen, wash with a clean soft cloth and plenty of warm water and, if necessary, a non-abrasive soap such as dishwashing liquid. Flannel or soft chamois make good cleaning cloths. Paint, glue residue or grease removal: Moisten cotton wad with naphtha or turpentine followed by a wash as above.

National Cycle Shield Wash™ (N1401-01) makes a good daily cleaner and comes with a handy travel-size bottle. Shield Wash is safe for all windshields and helmet visors

*Do not clean polycarbonate in hot sun or high temperatures. Do not clean the screen with household glass cleaners. Do not allow brake fluid, alcohol, or strong solvents to contact the screen.*

## RAIN REPELLENT

Do not use rain protective products made for glass. We recommend National Cycle's RainZip® (N1410-01) to keep your windscreen clear in rainy weather.



Register Your Windshield Online at [www.nationalcycle.com](http://www.nationalcycle.com)

### National Cycle 3-Year Limited Warranty

National Cycle hereby warrants to the original registered owner of a National Cycle polycarbonate windshield for a period of three years from the date of purchase against breakage. This limited warranty is expressly limited to the replacement of the polycarbonate windscreen. This limited warranty does not include scratches, coating failure, cosmetic wear and tear, replacement of hardware, or any consequential damages or expenses including labor cost of installation, removal and/or replacement, inconvenience, inbound freight expenses or damage to any other component of the motorcycle or any other accessories. Certain chemicals, generally known as acidic hydrocarbons, are known to cause polycarbonate damage and will not be covered under this limited warranty. Please refer to the cleaning instructions supplied with all National Cycle windshields.

Visit [www.nationalcycle.com](http://www.nationalcycle.com) for further details, or call 708-343-0400 or e-mail [info@nationalcycle.com](mailto:info@nationalcycle.com).

## WARNING

Never ride your motorcycle with loose accessory mounting hardware. Check the hardware for tightness regularly.

Today's motorcycles are built with enough frame rigidity to withstand the moderate loads imposed on them by the foreseeable addition of an accessory(ies). If an accessory(ies) adversely affects your motorcycle's stability, immediately remove the accessory(ies). Do not ride a motorcycle that exhibits unsafe handling traits.

Have experienced service personnel correct any problem before riding with the accessory(ies) installed. For further questions concerning handling problems associated with an accessory(ies), contact your dealer, motorcycle manufacturer, or accessory manufacturer.

*Sunlight reflected off the inside curvature of the windscreen can, at certain times of day, cause extreme heat buildup on the motorcycle's instruments and possibly even melt them. Exercise care in parking to avoid this. Park your motorcycle facing the sun or place an opaque object over this area.*