



EVOTECH®
P E R F O R M A N C E

www.evotech-performance.com

Ducati Streetfighter V4 / Panigale V4
Blanking Plate / Camera Mount Instructions



- Ⓐ 1 x M5 x 8 Button Head Bolt
- Ⓑ 1 x Support Plate
- Ⓒ 1 x M5 x 20 Caphead (Camera Mount Only)
- Ⓓ 2 x M5 x 16 Button Head Bolt
- Ⓔ 2 x M5 x 10 Caphead (Camera Mount Only)
- Ⓕ 2 x Plastic Cap (Blanking Plate Only)

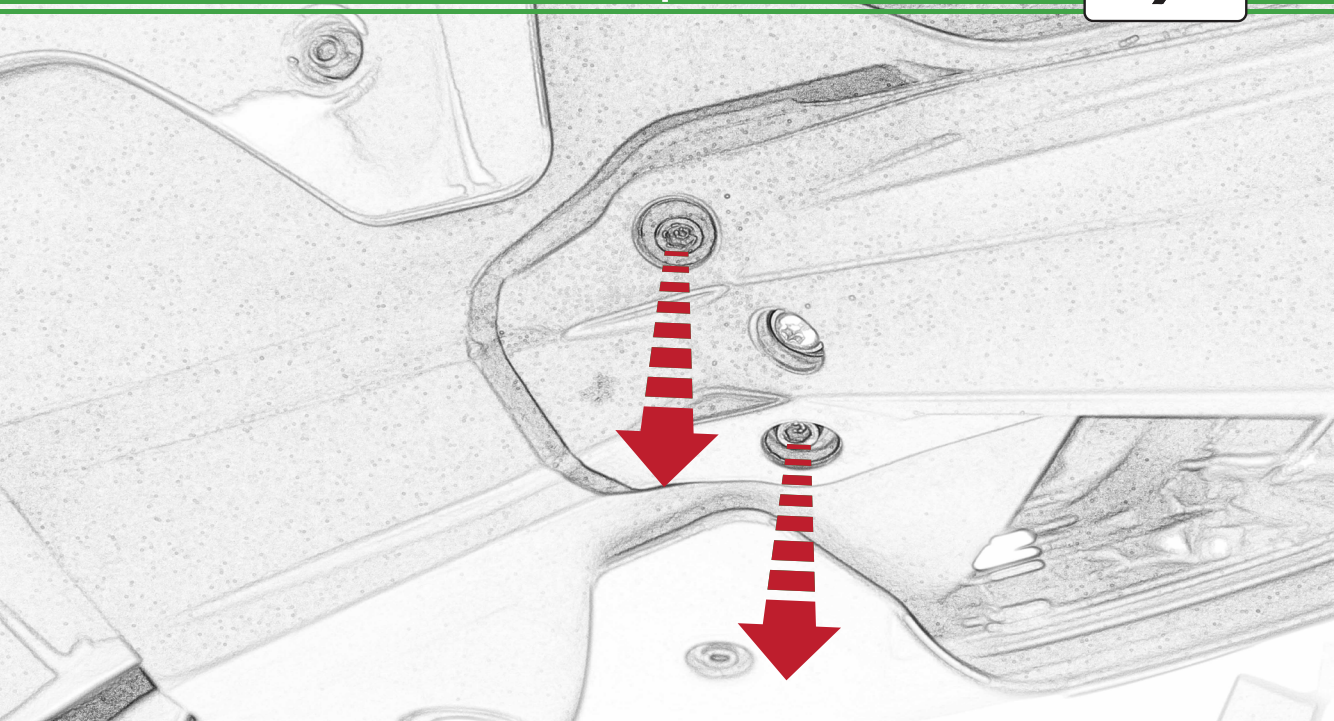

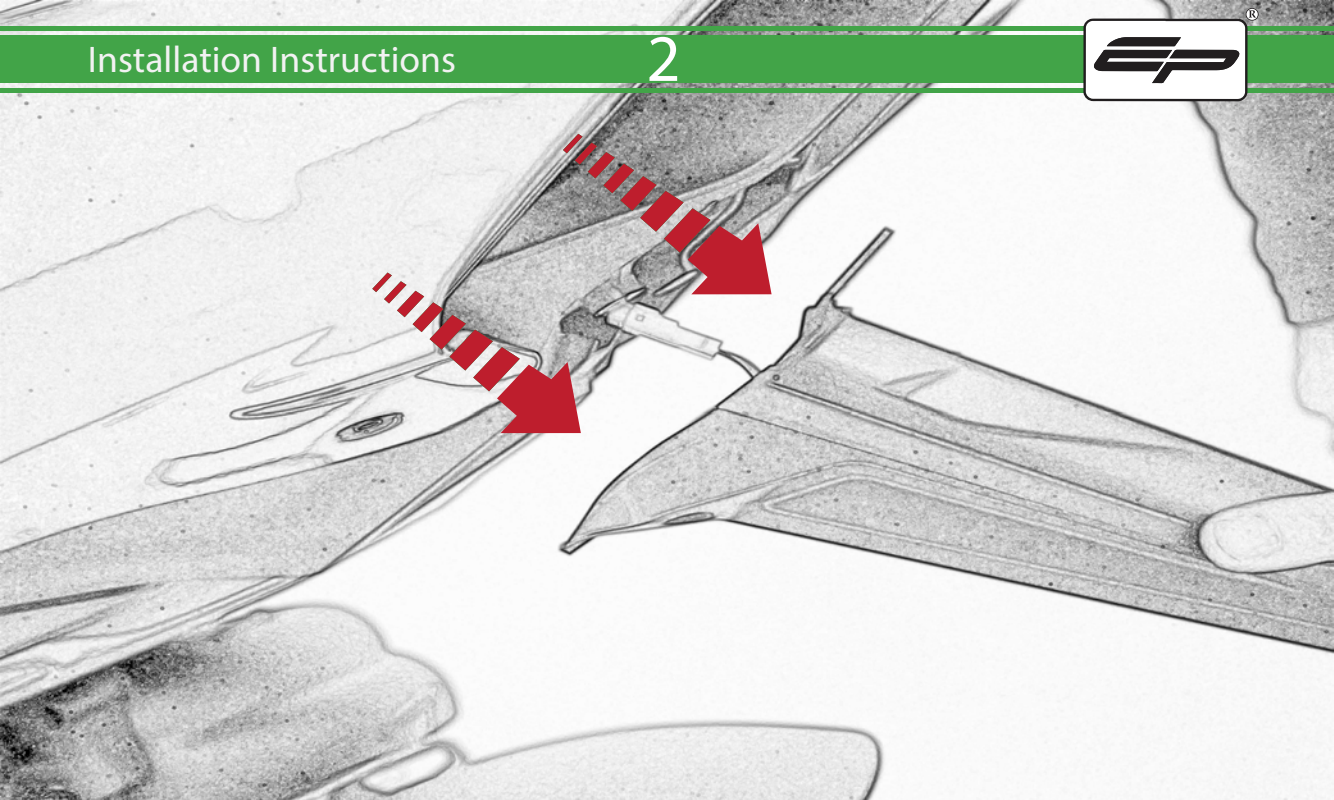

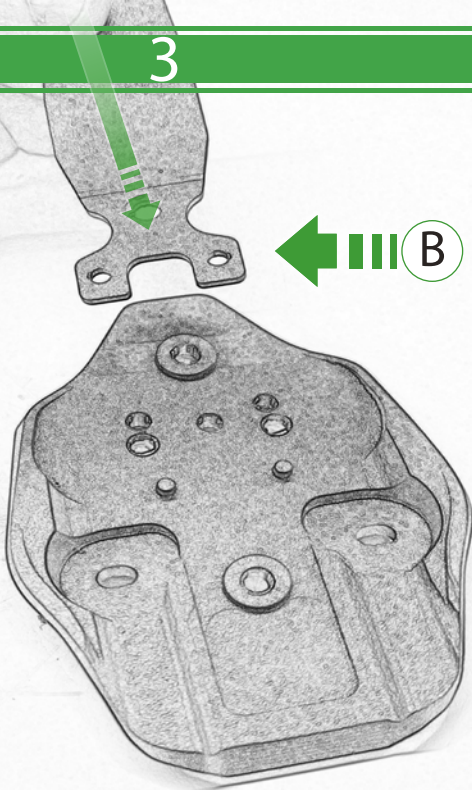

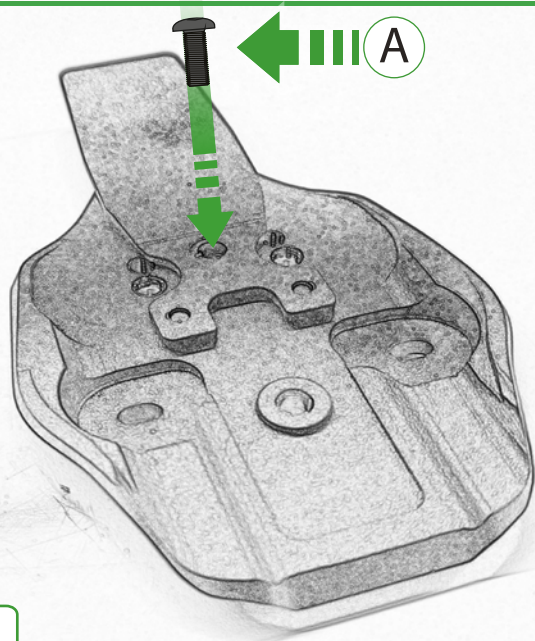

Caution

For Blanking Plate
Move to Stage 9

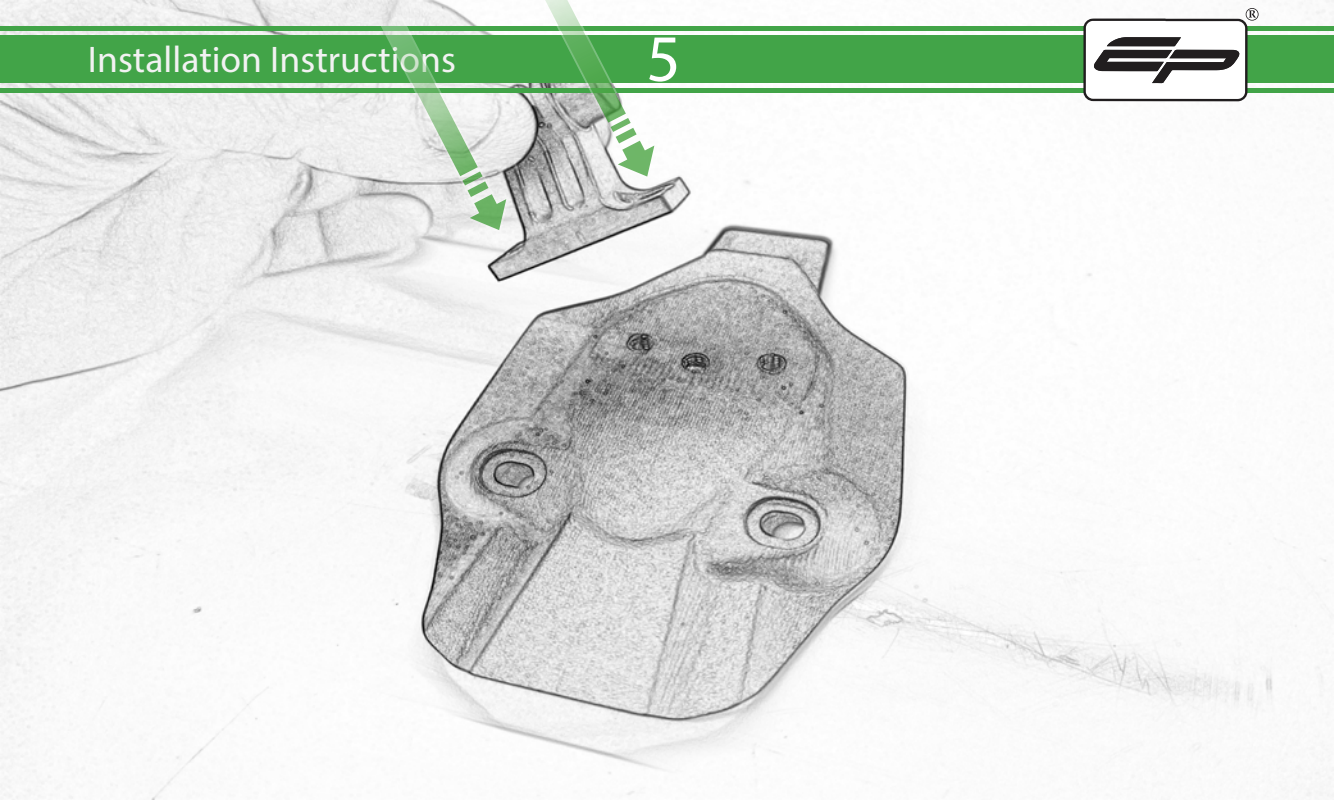



6

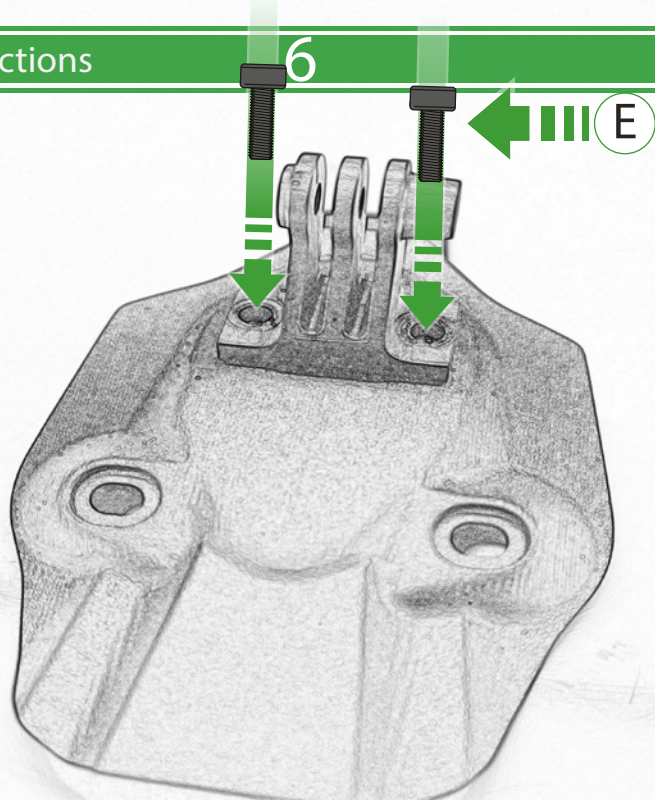

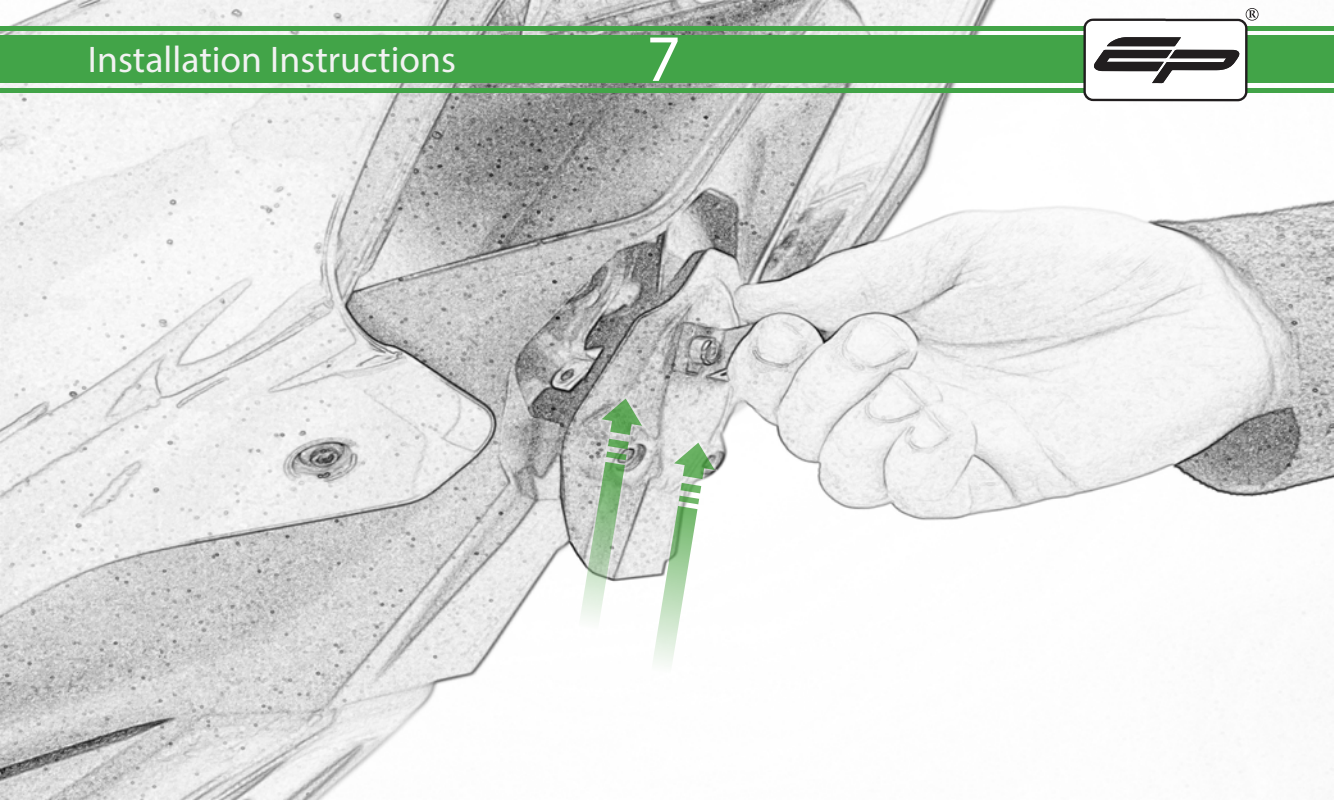

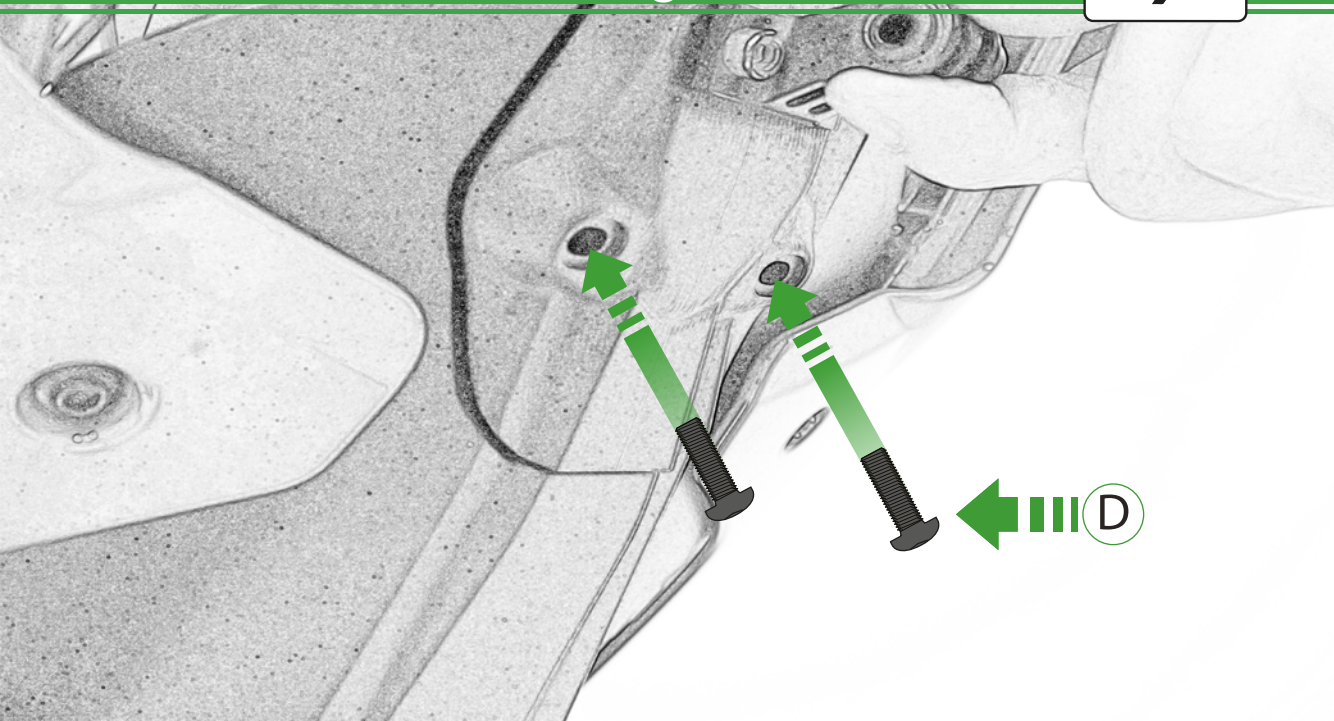

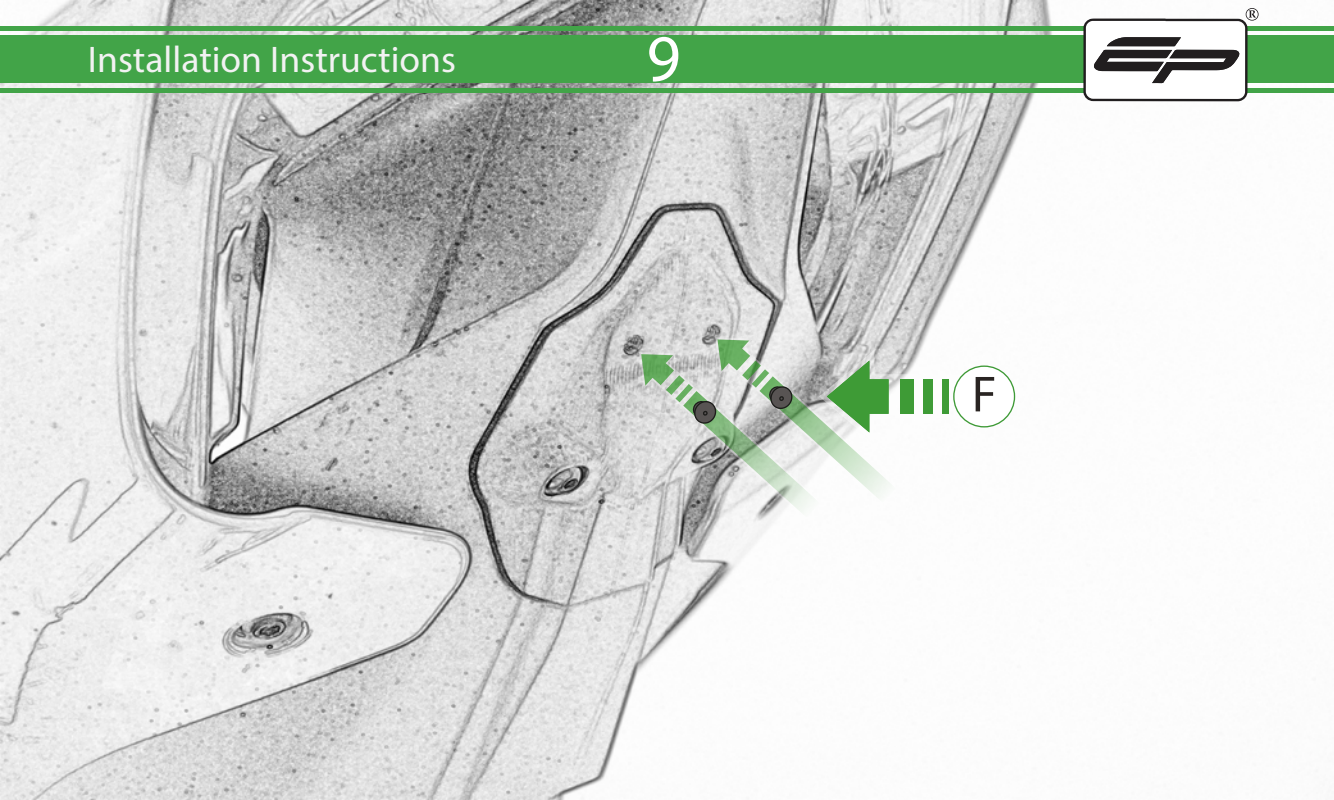



ESSENTIAL CHECKS

It is recommended that periodic inspections are made to ensure that all bolts are tightened to the specified torque settings.

Should the bike be involved in an accident a thorough inspection should be made and any components that have taken an impact, no matter how small, be replaced

P E R F O R M A N C E



EVOTECH®
P E R F O R M A N C E

www.evotech-performance.com