

YAMAHA NMAX 125 '21-

MOUNTING INSTRUCTIONS

REF 20737

V-TECH TOURING



ID.	PIEZA/PART	DESCRIPCIÓN	DESCRIPTION	QTY.	REF.:
1		Cúpula TOURING	TOURING screen	1	20737H/W/FM3
2		Silentblock Ø17xØ10 Ø1x10	Ø17xØ10 Ø1x10 silentblock	4	AROPASACABLES--
3		Casquillo con valona Ø15xØ9x7,5	Ø15xØ9x7,5 bush with flange	4	CASQUI-1A---324
4		Tornillo allen M5x30 Ø11 ISO 7380	M5x30 Ø11 ISO 7380 allen screw	4	TORNI-I7380-767
5		Tapon tornillo M5 ISO 7380	M5 ISO 7380 screw cap	4	TAPON-----85
6		Casquillo Ø14 x Ø8 x 3,5	Ø14 x Ø8 x 3,5 arrowhead	2	CASQUI-----182

YAMAHA NMAX 125 '21-

INSTRUCCIONES DE MONTAJE - MOUNTING INSTRUCTIONS - MONTAGEANLEITUNG

1

**DISASSEMBLY
DESMONTAJE**

A Tornillería original
Original screws

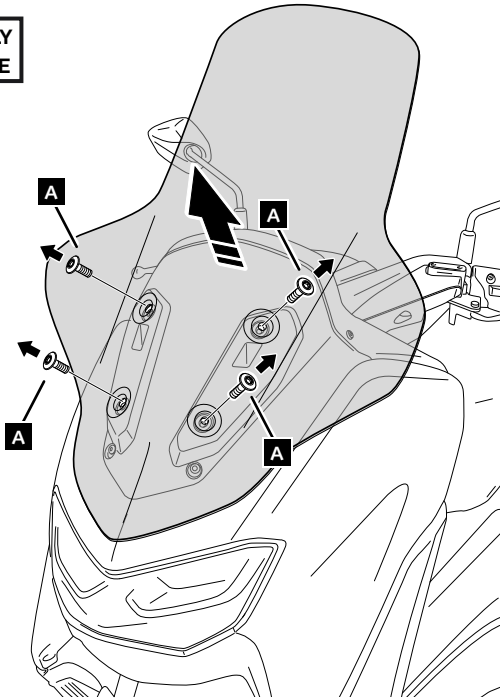

2

**ASSEMBLY
MONTAJE**

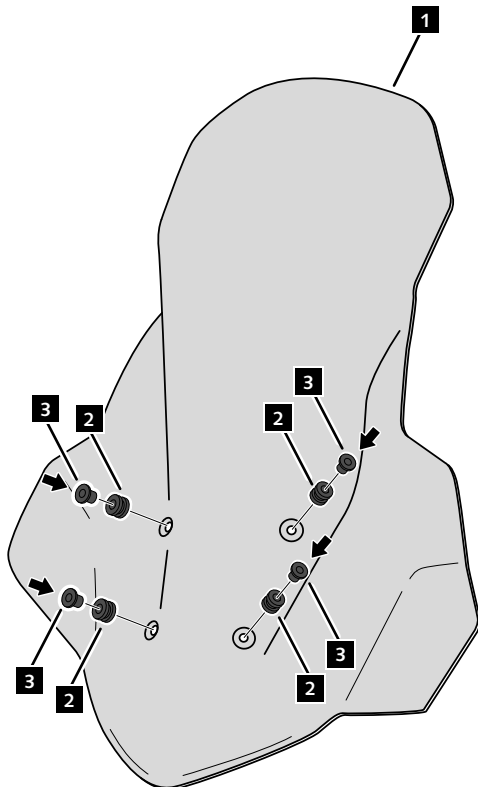

**NO APRETAR
DO NOT TIGHTEN**

3

**ASSEMBLY
MONTAJE**

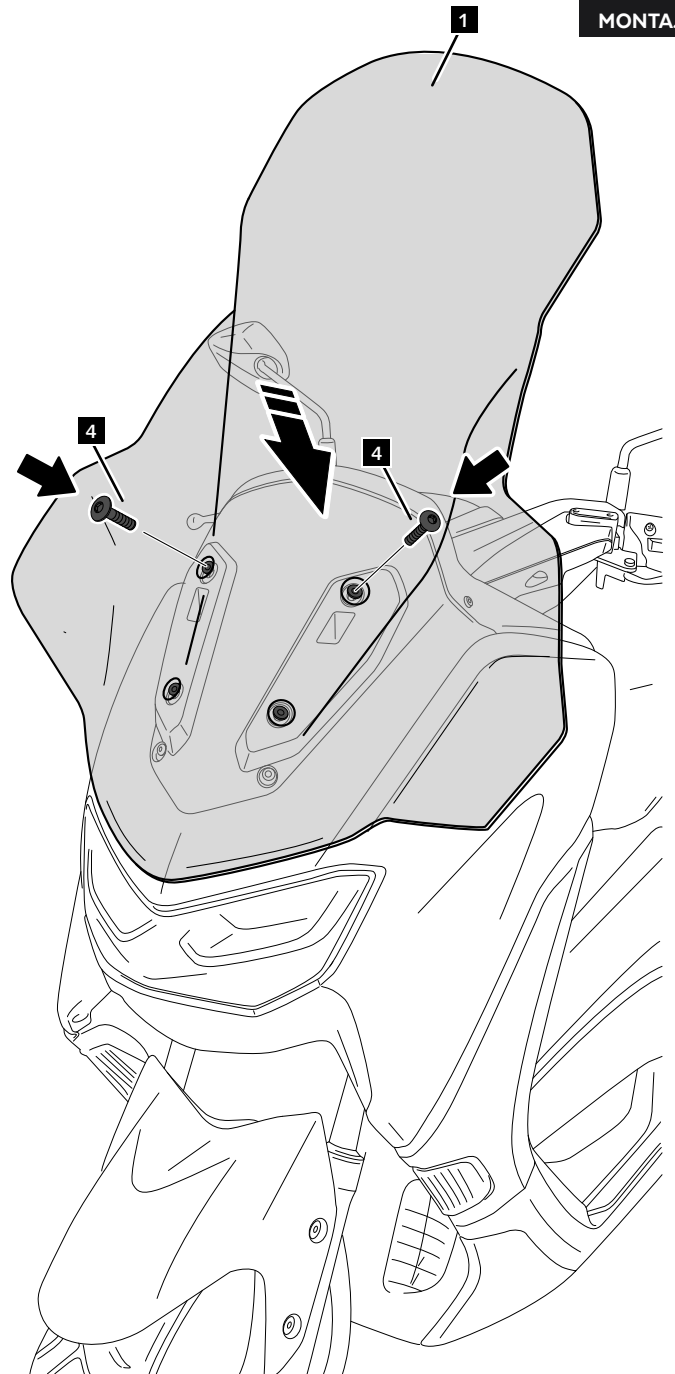

YAMAHA NMAX 125 '21-

INSTRUCCIONES DE MONTAJE - MOUNTING INSTRUCTIONS - MONTAGEANLEITUNG

4

ASSEMBLY
MONTAJE

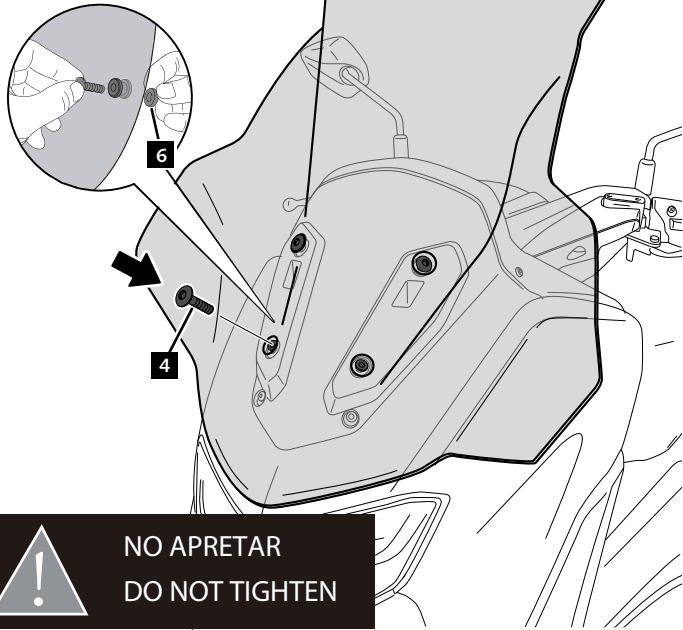

5

ASSEMBLY
MONTAJE

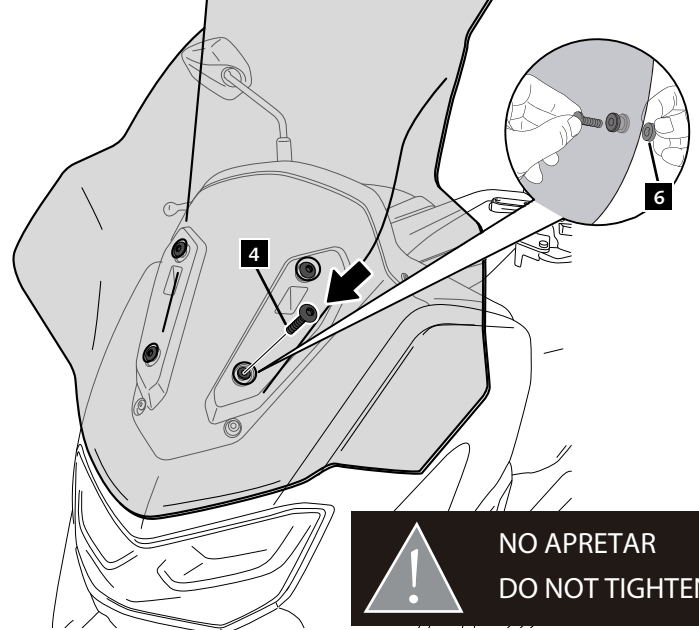

6

ASSEMBLY
MONTAJE



APRETAR LOS TORNILLOS ID4
TIGHTEN ID4 SCREWS

